

ASSEMBLY INSTRUCTION FOR ACME FURNITURE

MODEL#21677EK-HF + 21678EK-R + 21679EK-DRW

Thank you for purchasing the quality product. Be sure to check all packing material carefully for small parts which may have come loose inside the carton shipment. Separate, identify and count all parts and metal hardware. Compare with all parts list to be sure all parts are present. If any part(s) are missing or damaged, please contact your local furniture dealer. For efficient and speedy service, please indicate the model number and code letter of part(s) needed.

*** Do not fully tighten screws until fully assembled ***

Part List		
NO.	Descriptions	Qty.
A	Headboard Panel	1
B	Headboard Leg Left (L)	1
C	Headboard Leg Right (R)	1
D	Footboard	1
E	Bed Rail	2
F	Drawer Slat	1
G	Drawer Slat Support	1
H	Bed Slat 3Holes	3
I	Bed Slat 2Holes	10
J	Bed Slat Support	3
K	Center Slat With 3 Holes	1
L	Drawer	2
M	Slat Cover	1
N	Drawer Slat Support Stopper	1
Hardware Pack Headboard & Footboard		
NO.	Descriptions	Qty.
1	CSK M4 x 16mm 	7
2	CSK M4 x 32mm 	30
3	JCBC SCREW M6 x 30mm 	6
4	JCBC SCREW M6 x 50mm 	3
5	SPRING WASHER Ø1/4" 	6
6	FLAT WASHER Ø1/4" x 13mm 	6
7	L KEY M4 x 110mm 	1
8	L KEY M5 	1

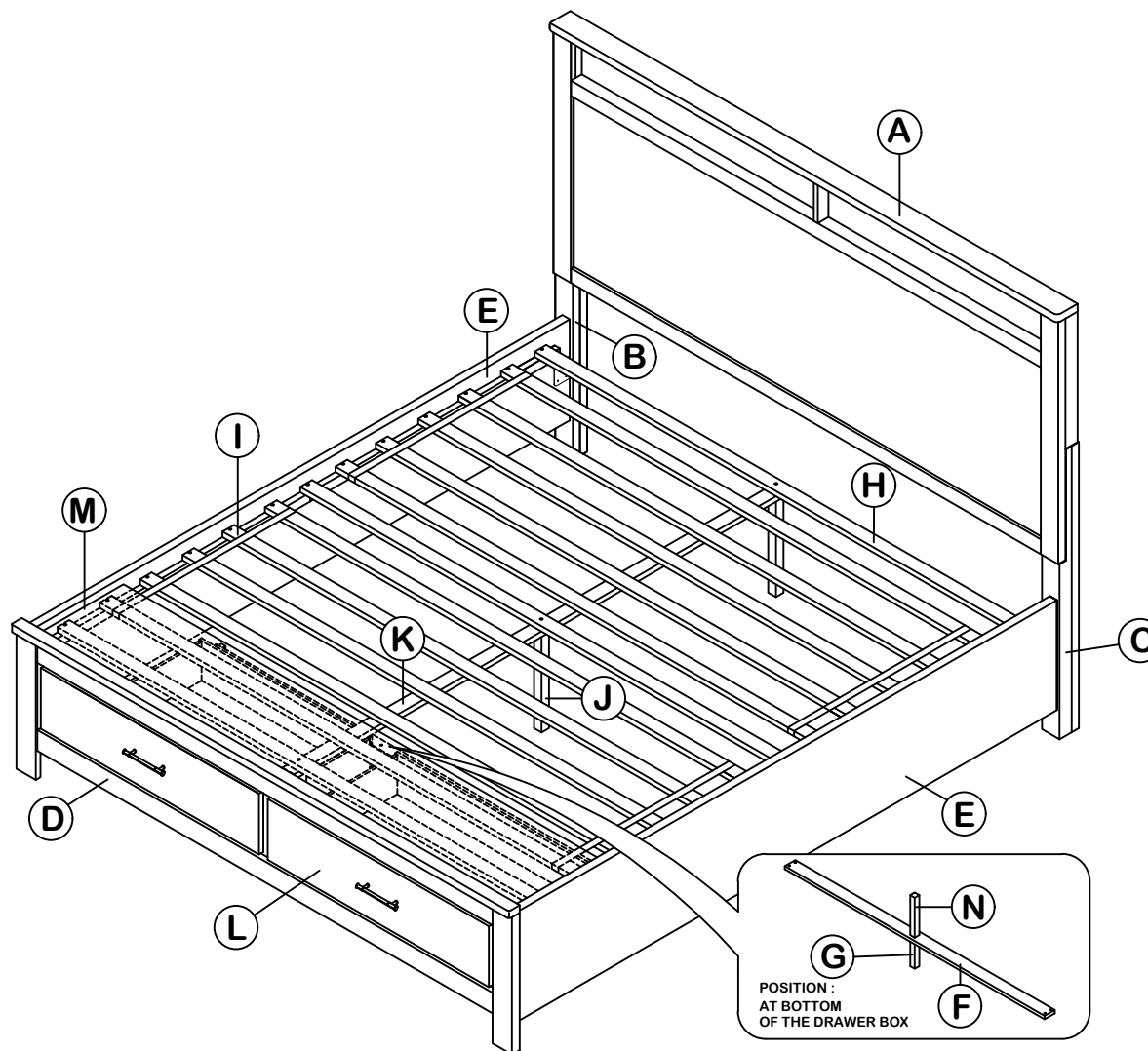

Attention

*** Some number parts listed on the instruction sheet may not be in parts bag as they may already be assembled. Carefully check parts and packing materials prior to ordering replacements.

ASSEMBLY INSTRUCTION FOR ACME FURNITURE

STEP 1.1: Align and fasten Headboard Leg (B) & (C) to Headboard Panel (A) using JCBC M6 x 30mm (3), Spring Washer $\varnothing\frac{1}{4}$ " (5) and Flat Washer $\varnothing\frac{1}{4}$ " x 13mm (6) and tighten with L Key M4 (7).

****Please note the marking on the leg and headboard****

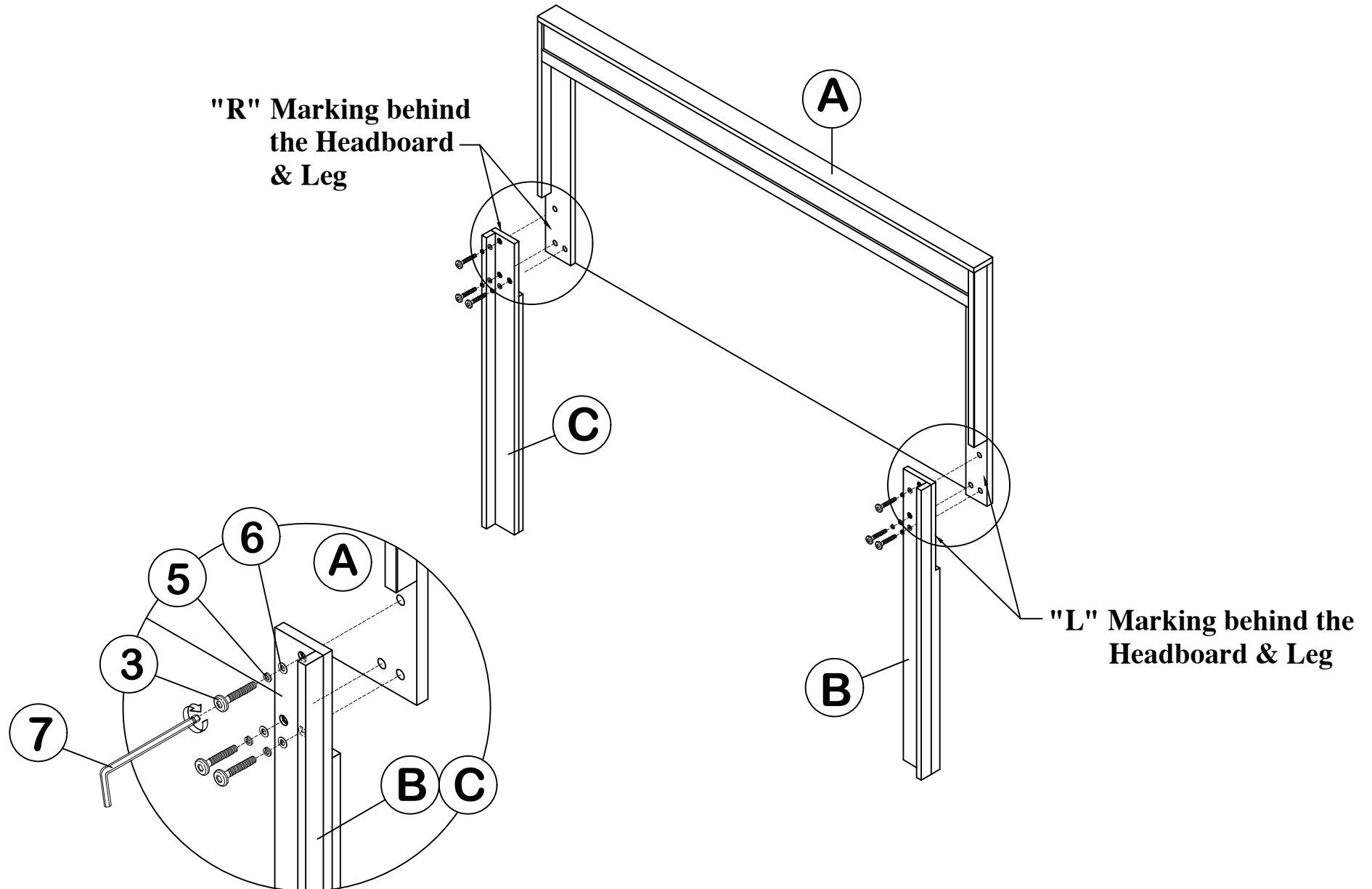

ASSEMBLY INSTRUCTION FOR ACME FURNITURE

STEP 2.1: Attach the Bed Rail (E) to Headboard Leg.

STEP 2.2: Tighten SCREW on Headboard Leg by using L KEY M5 (8) & repeat the same step on Footboard (D).

STEP 2.3: Move the bed to the desired position.

STEP 2.4: Attach the Drawer Slat (F) each to a Drawer Slat Support (G) and fix with Drawer Slat Support Stopper (N).

STEP 2.5: Fix the Drawer Slat (F) to Bed Rail (E) with CSK M4 x 32mm (2).

STEP 2.6: Move 'T' Runner at Footboard (D) to Drawer Slat (F).

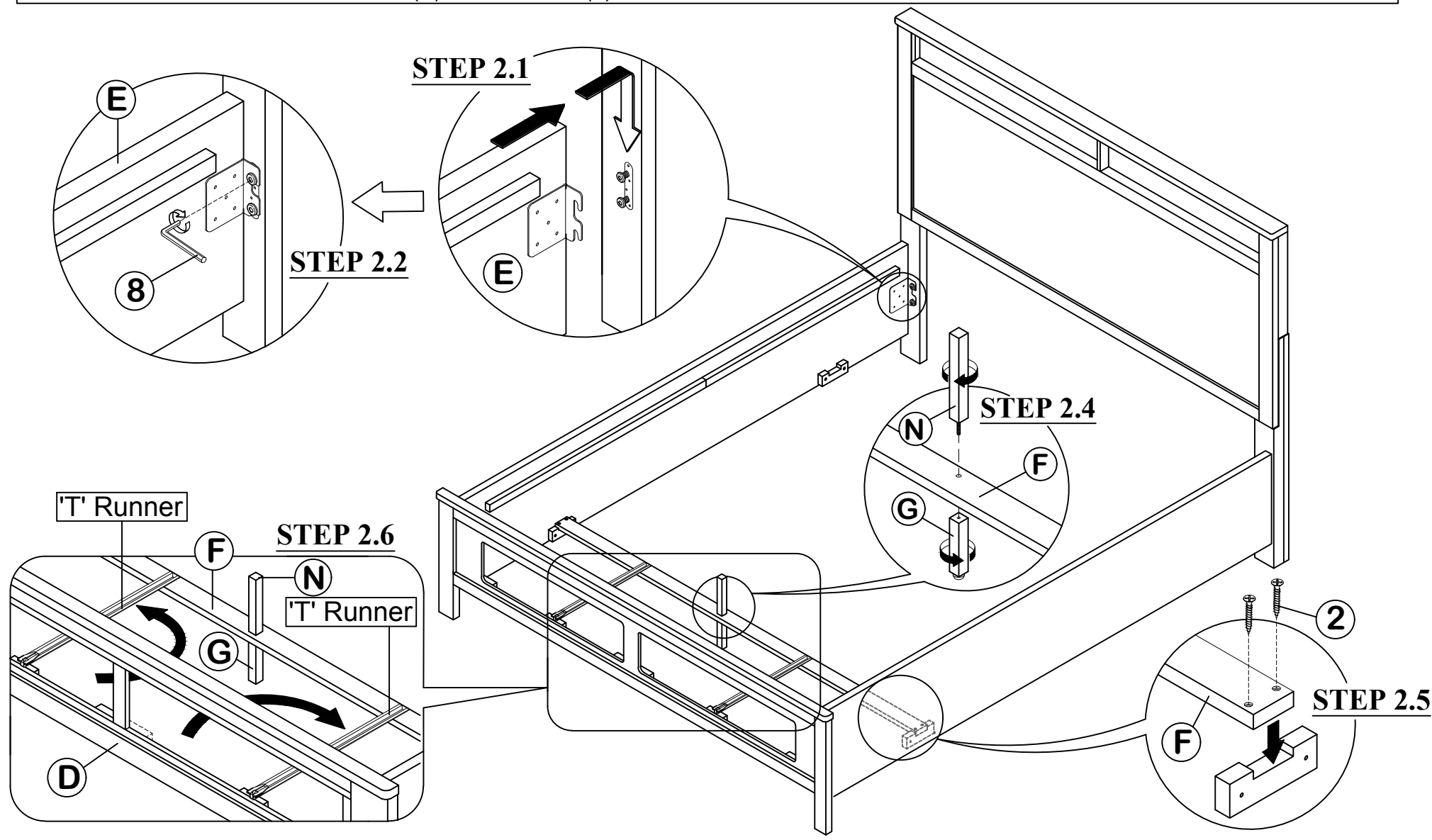

ASSEMBLY INSTRUCTION FOR ACME FURNITURE

STEP 3.1: Insert Drawer (L) to Footboard (D) until completely closed.

STEP 3.2: Tighten 'T' Runner at Footboard (D) to Drawer Slat (F) with CSK M4 x 16mm (1).

STEP 3.3: If Drawer (L) does not close properly, adjust the adjuster at the bottom of Drawer Slat Support (G) up or down until the Drawer (L) closes tightly.

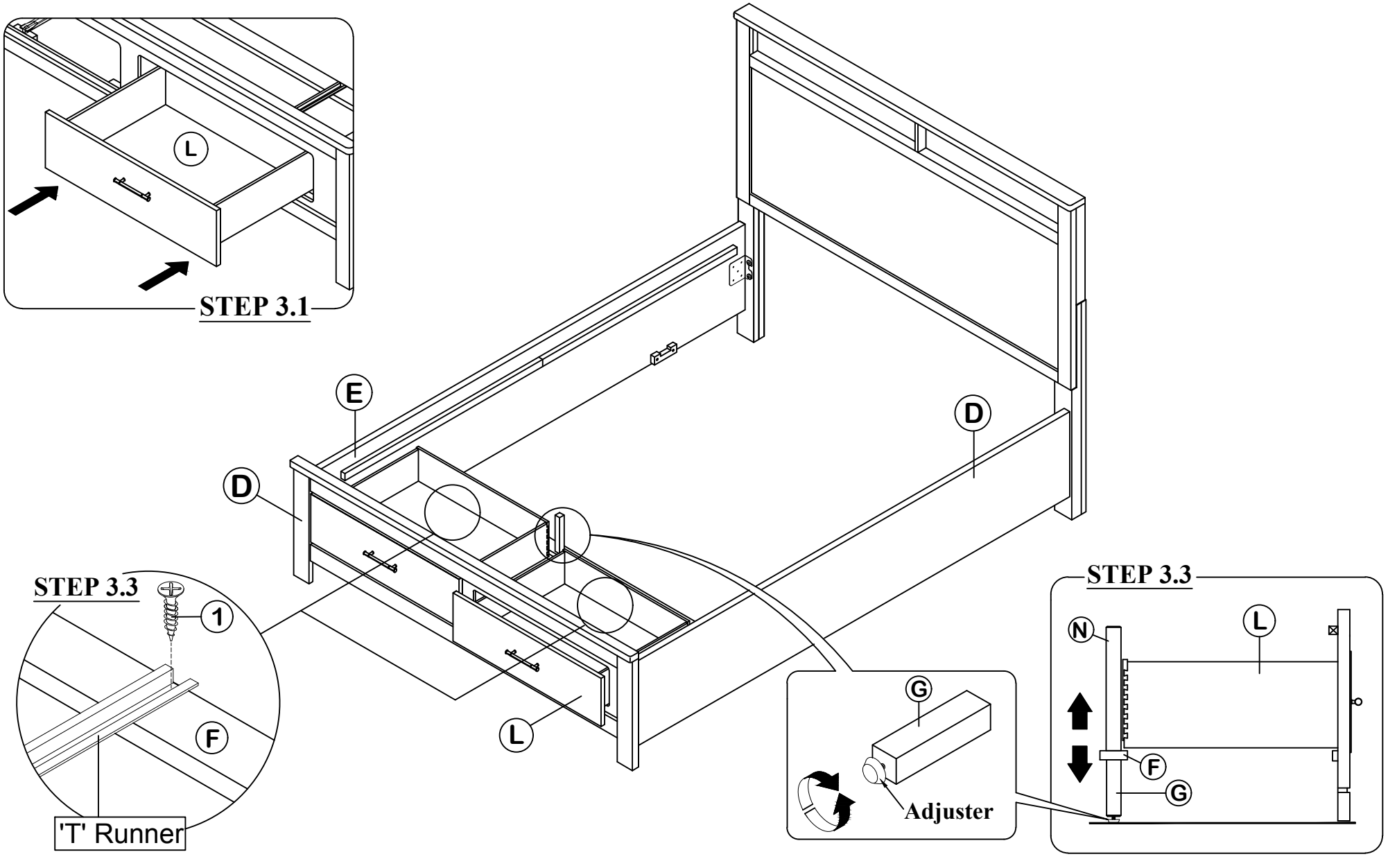

ASSEMBLY INSTRUCTION FOR ACME FURNITURE

STEP 4.1: Attach the Center Slat (K), Bed Slat (H) to Bed Slat Support (J). Tighten with JCBC M6 x 50mm (4) by using L KEY M4 (7).

STEP 4.2: Attach Bed Slat (H) & Bed Slat (K) and tighten to Bed Rail (E) with CSK M4 x 32mm (2).

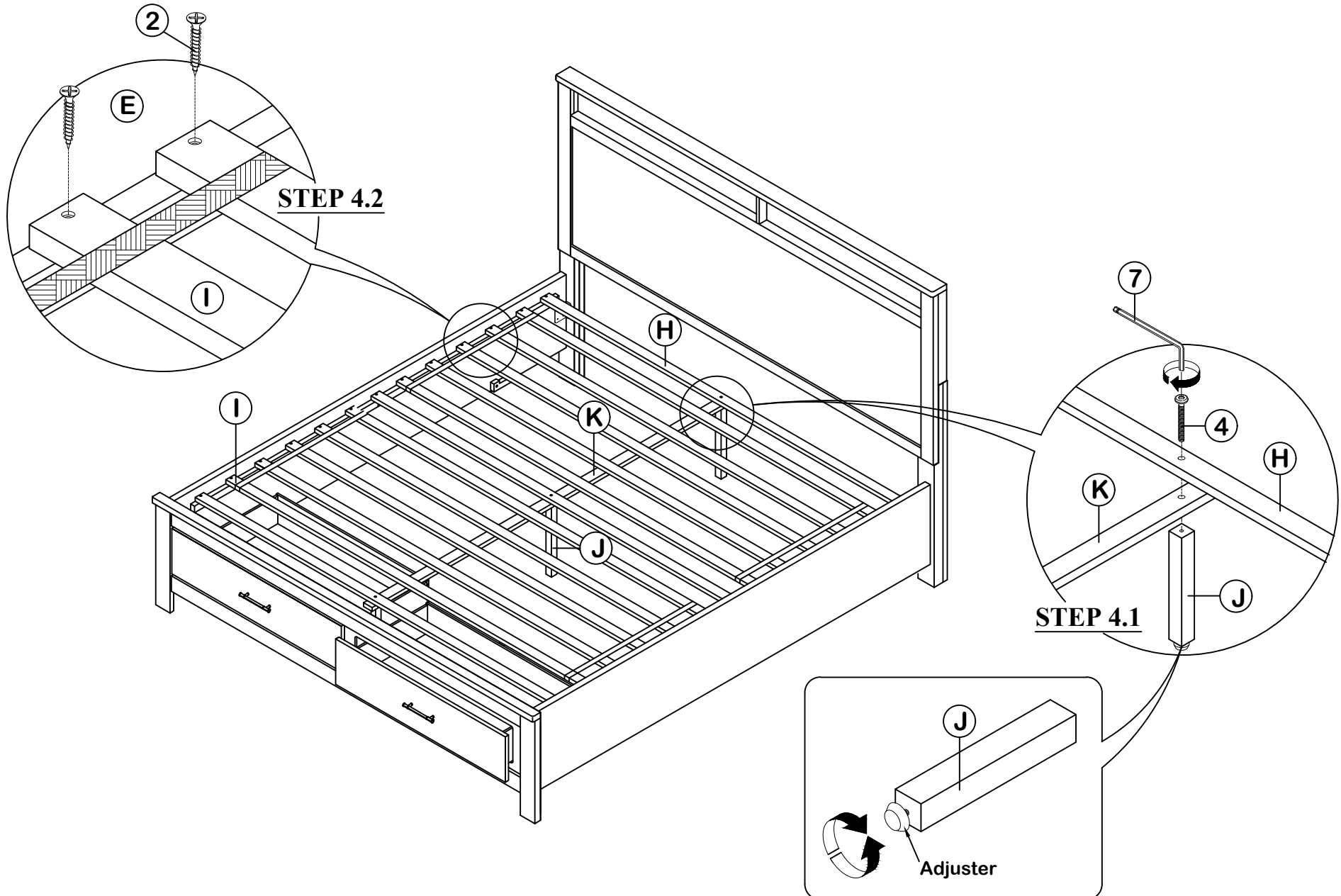

ASSEMBLY INSTRUCTION FOR ACME FURNITURE

STEP 5.1: Attach the Slat Cover (M) to top Bed Slat (H & I) .

STEP 5.2: Close the distance Slat Cover (M) to Footboard (D). Tighten Slat Cover (M) to Wood at Footboard (D) with CSK M4 x 16mm (1).

