

INSTALLATION MANUAL

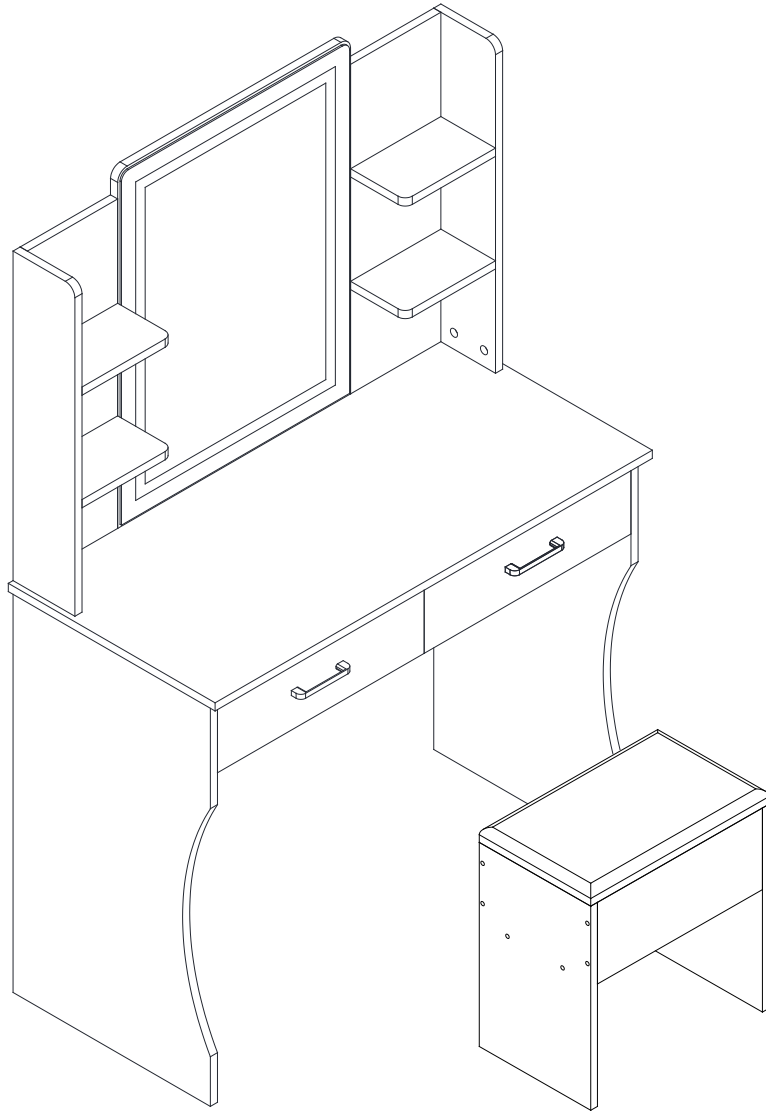

Thank you for purchasing the goods in our store this time
Please read this manual carefully before using it
Please keep this manual properly

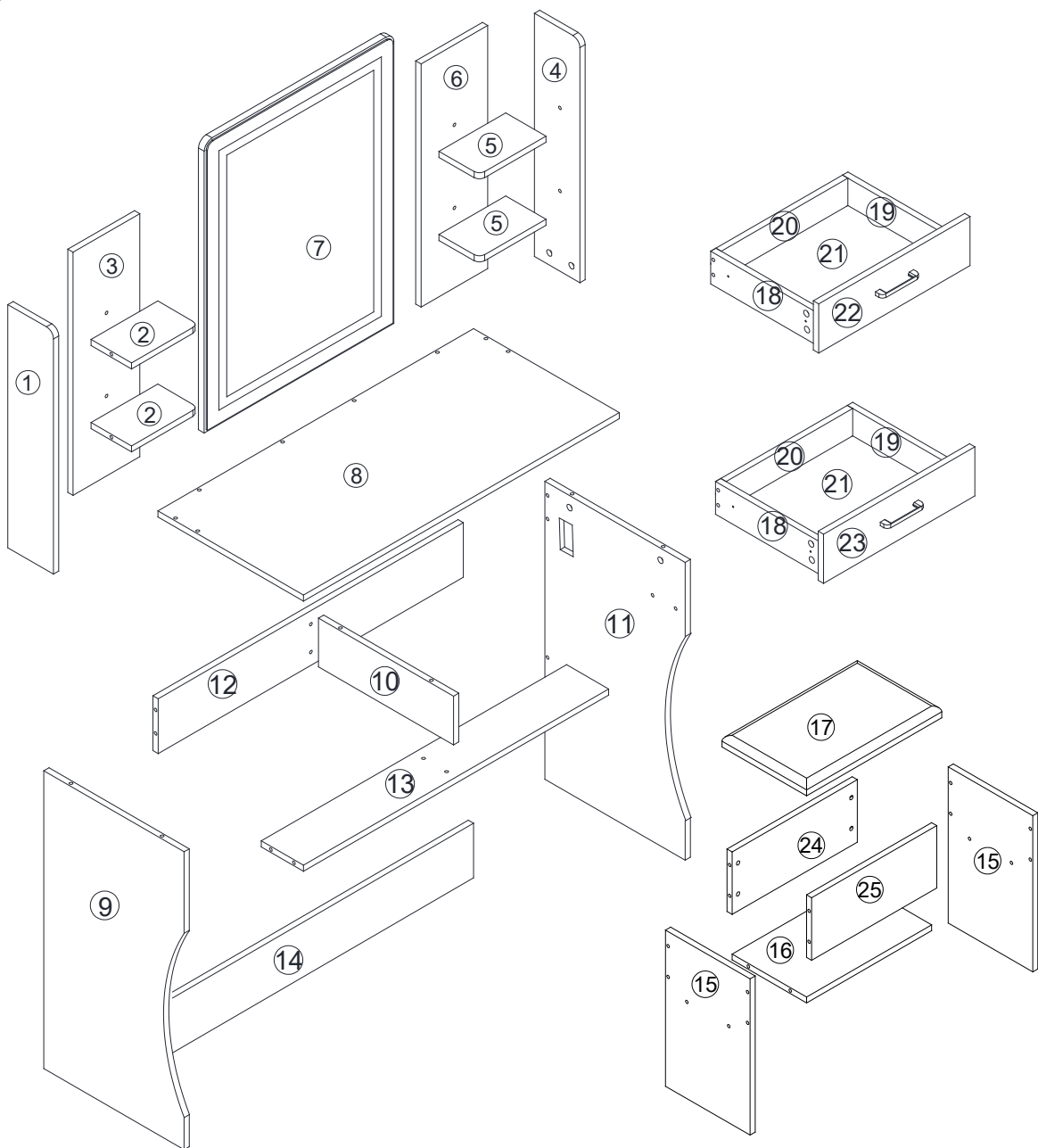

1 - x1	6 - x1	11 - x1	16 - x1	21- x2
2 - x2	7 - x1	12 - x1	17 - x1	22- x1
3 - x1	8 - x1	13 - x1	18 - x2	23- x1
4 - x1	9 - x1	14 - x1	19 - x2	24- x1
5 - x2	10 - x1	15 - x2	20- x2	25- x1

HARDWARE

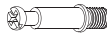

A	SCREW & PLASTIC LOCK	x38
---	----------------------	-----



B	SCREW & METAL LOCK	x38
---	--------------------	-----



C	SCREW	x48
---	-------	-----

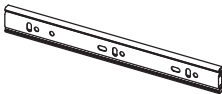

D	RAIL	x4
---	------	----



E	HANDLE	x4
---	--------	----

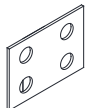

F	L PLATE	x4
---	---------	----



G	SHAKE HANDS	x2
---	-------------	----

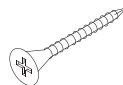

J	SCREW	x20
---	-------	-----



K	SCREW	x20
---	-------	-----



M	SCREW	x8
---	-------	----

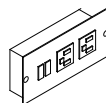

N	SOCKET	x1
---	--------	----

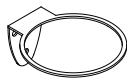

O	HAIR DRYER HOLDER	x1
---	-------------------	----

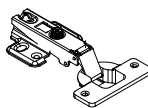

P		x2
---	--	----

1. Screw installation method

When the screw is installed, please keep it in line with the board, and do not tighten it too tightly

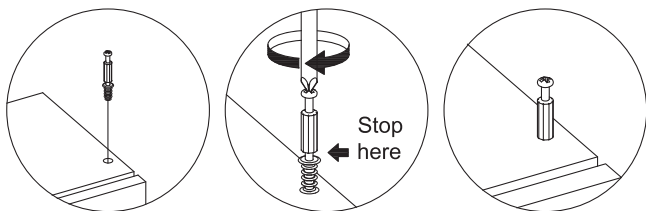

2. Check the Nut direction

This direction of the marked nut is consistent with the direction in which the screw is inserted

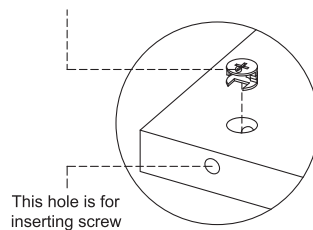

3. Installation on the board with fixing screws

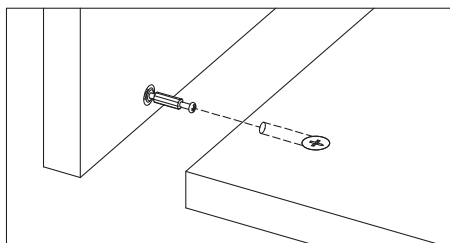

3. Rotate slowly until it stops

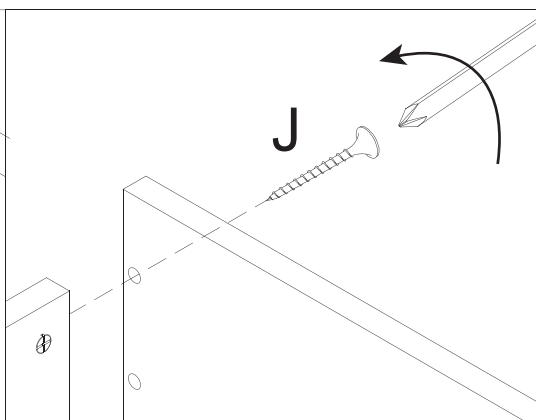
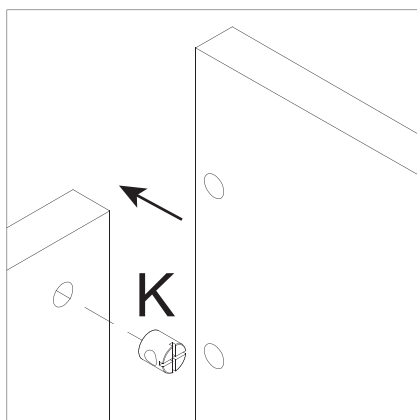
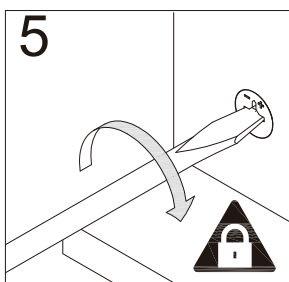
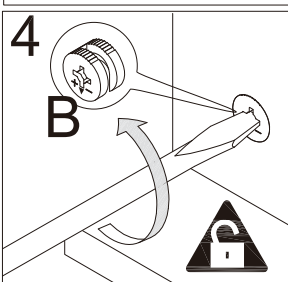
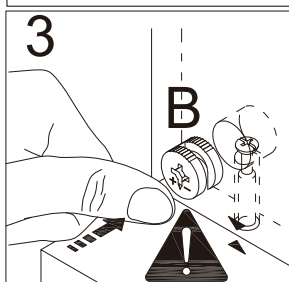
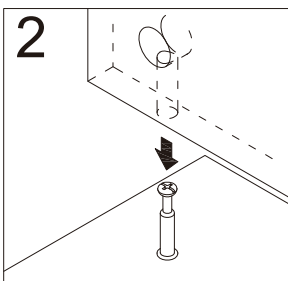
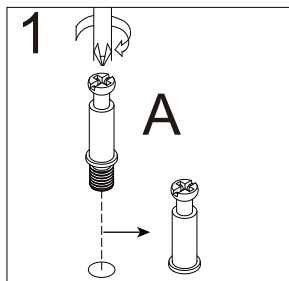
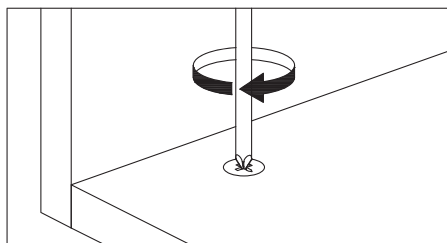

Step 01

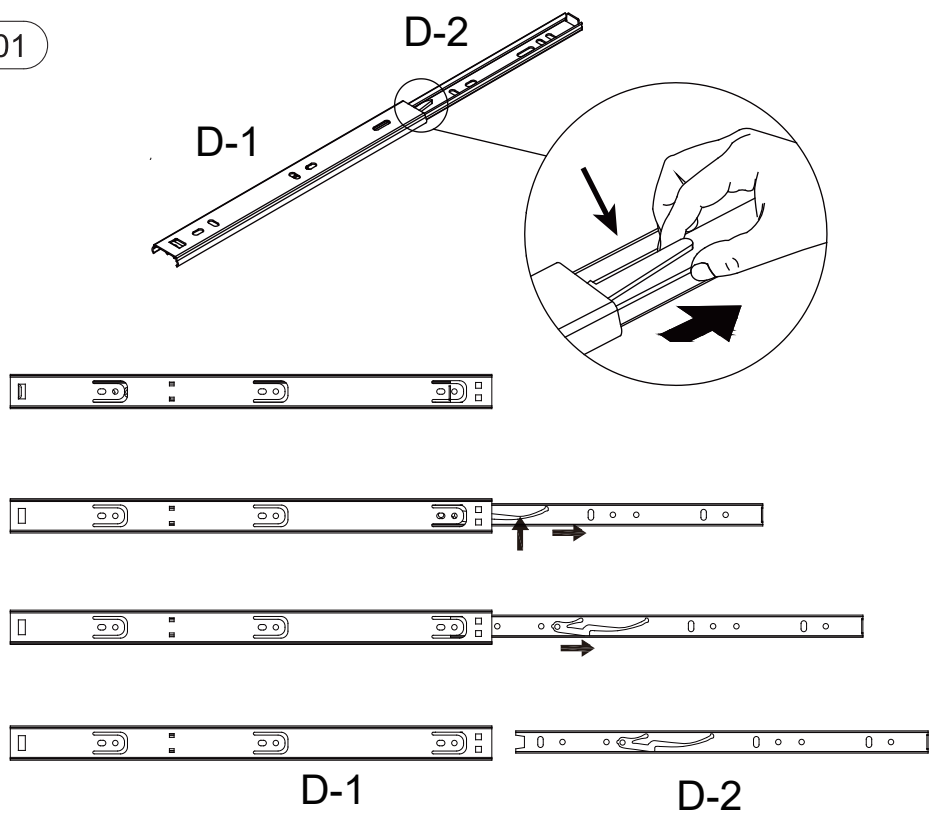

Step 02

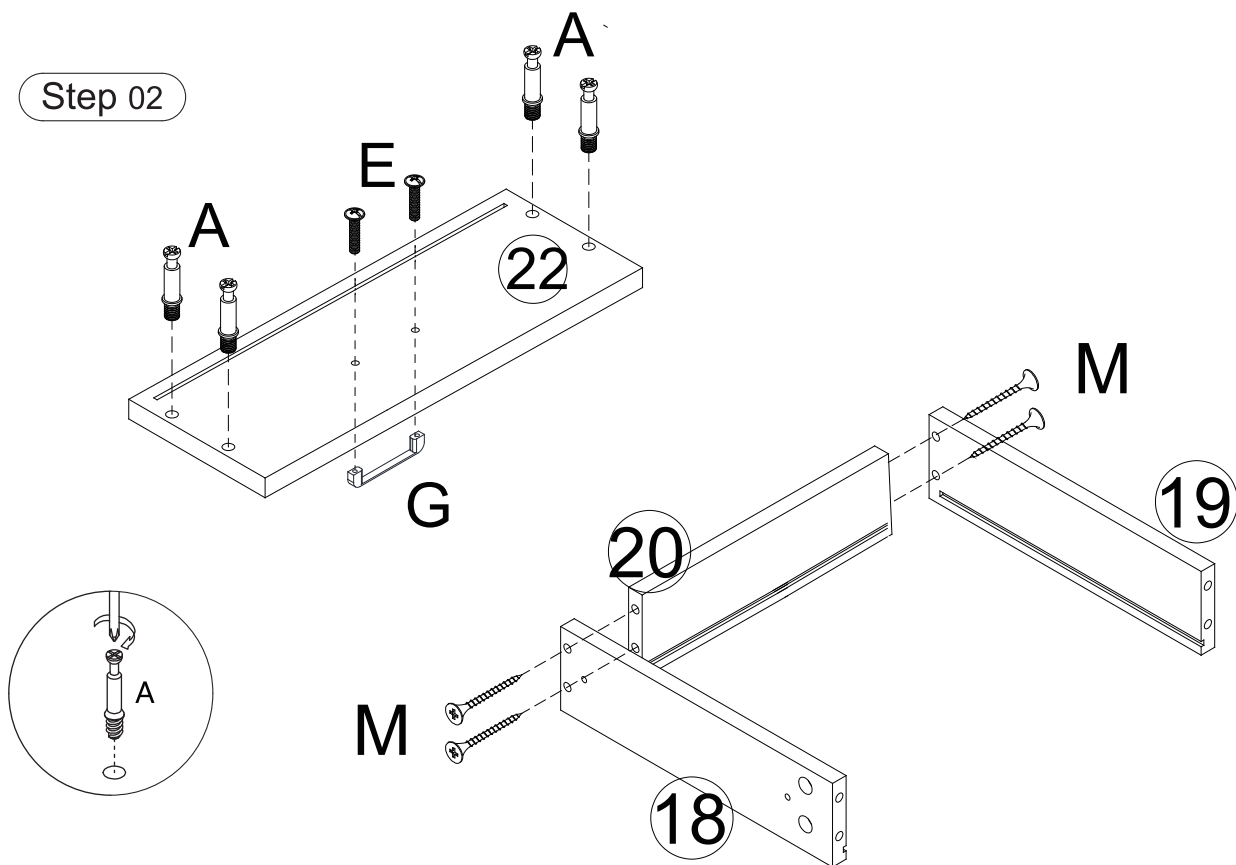

Step 03

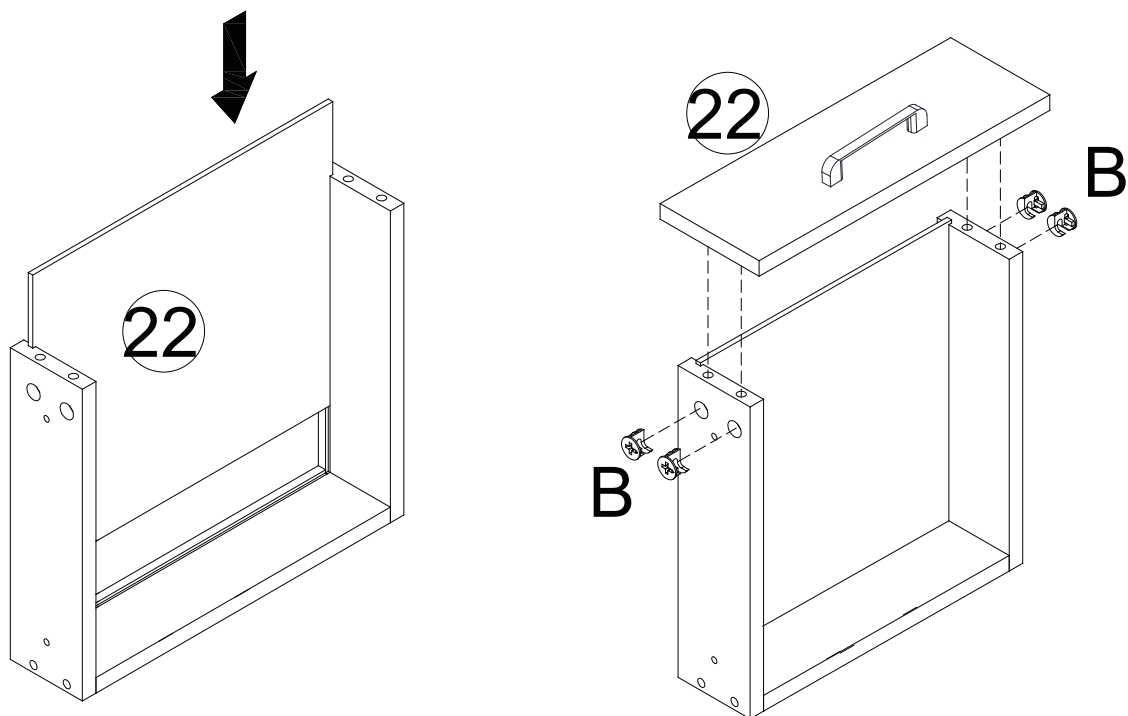

Step 04

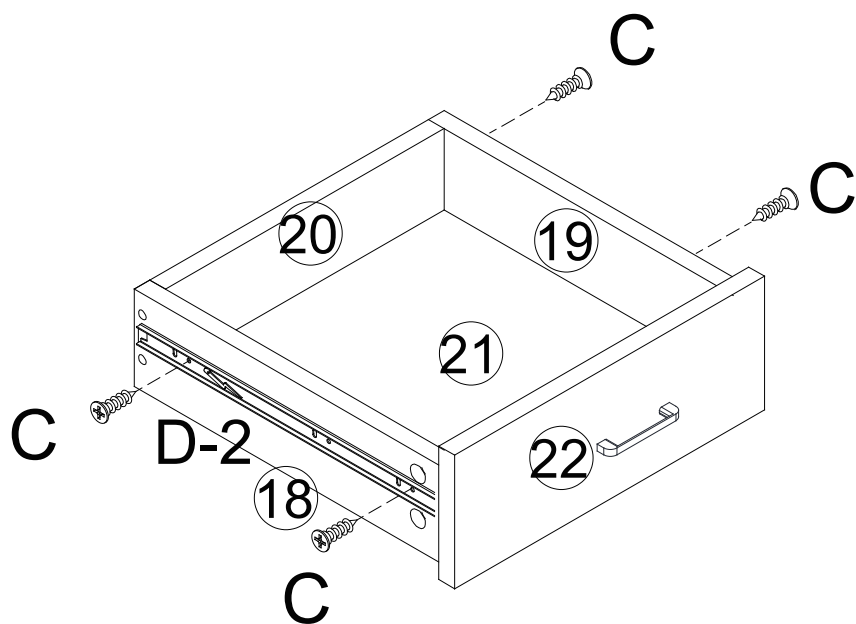

Step 05

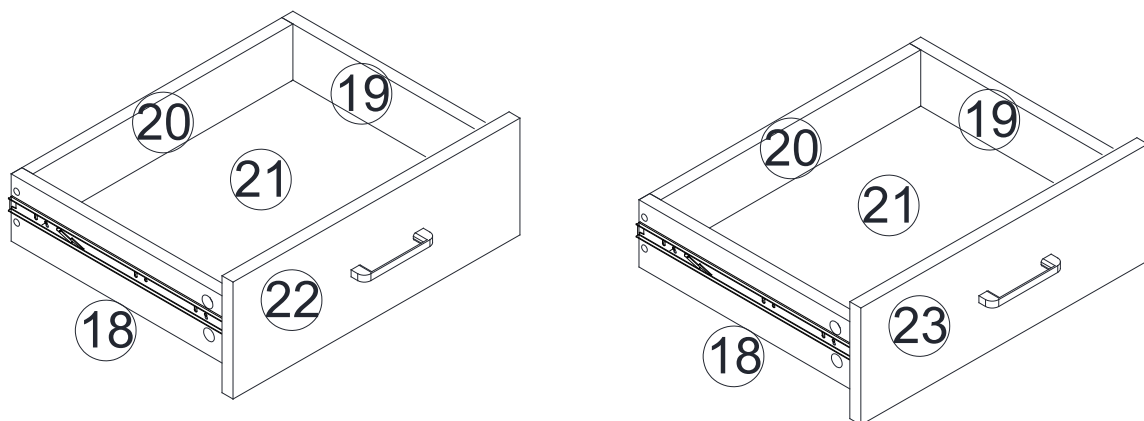

The two drawers are installed the same way

Step 06

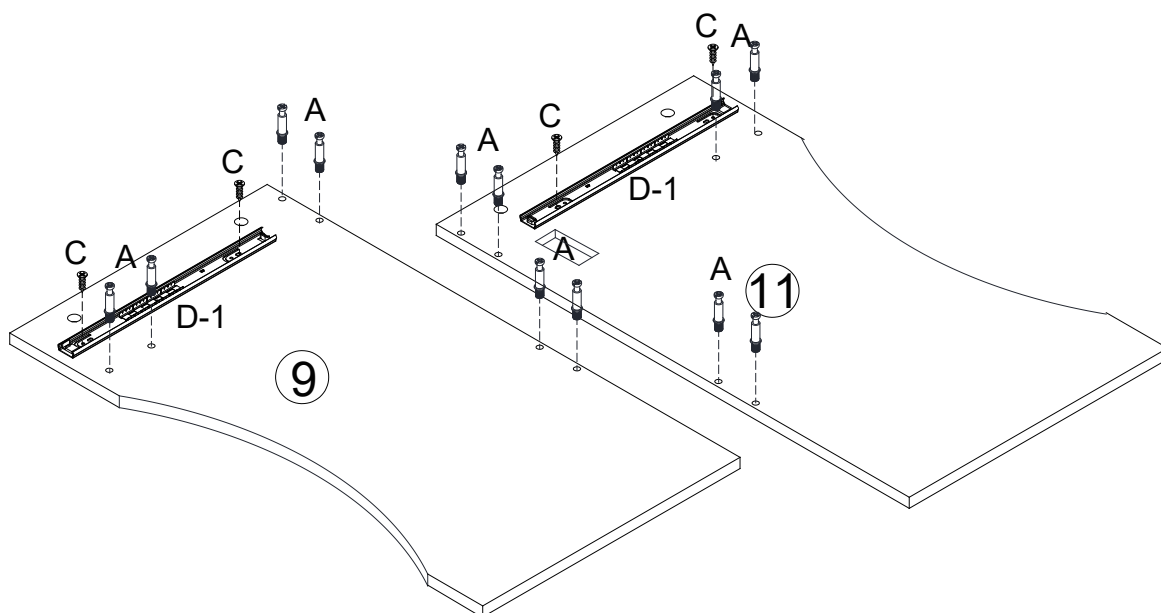

Step 07

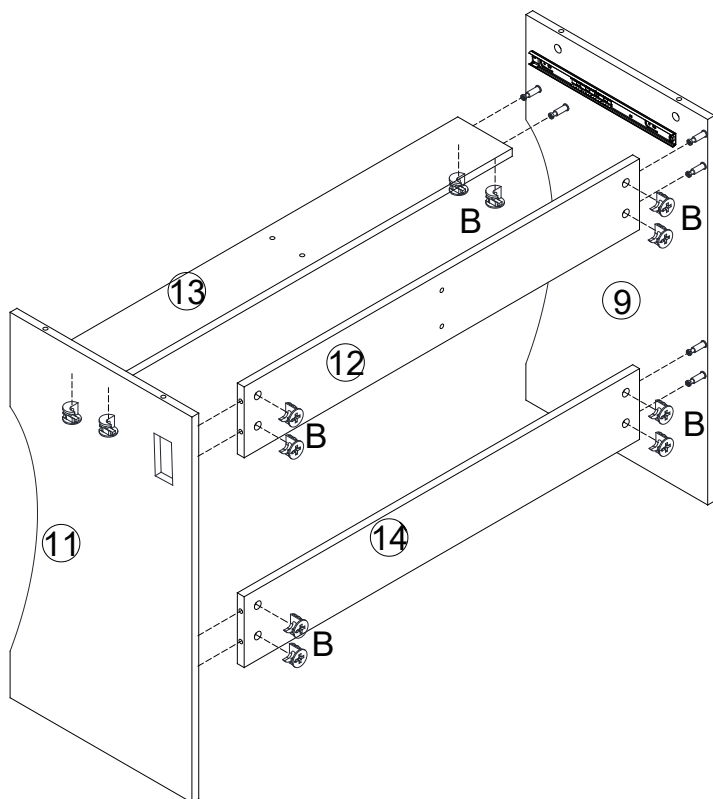

Step 08

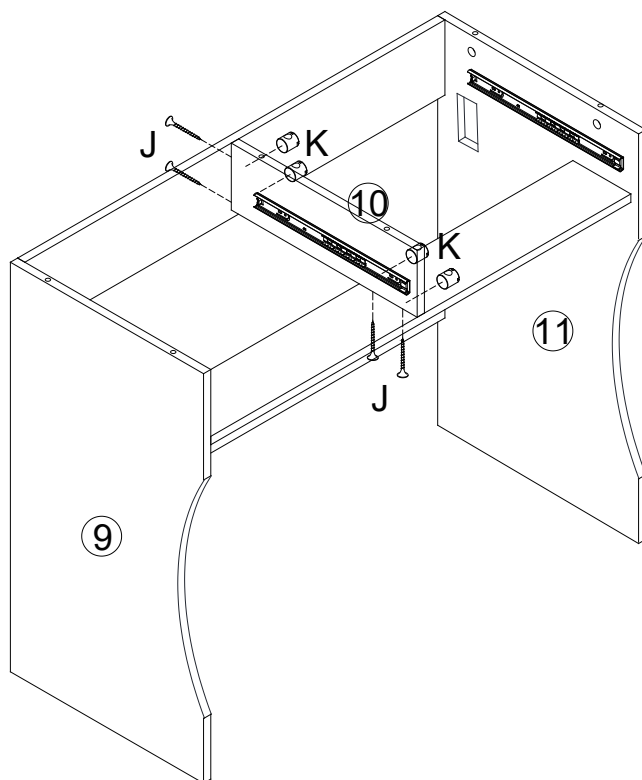

Step 09

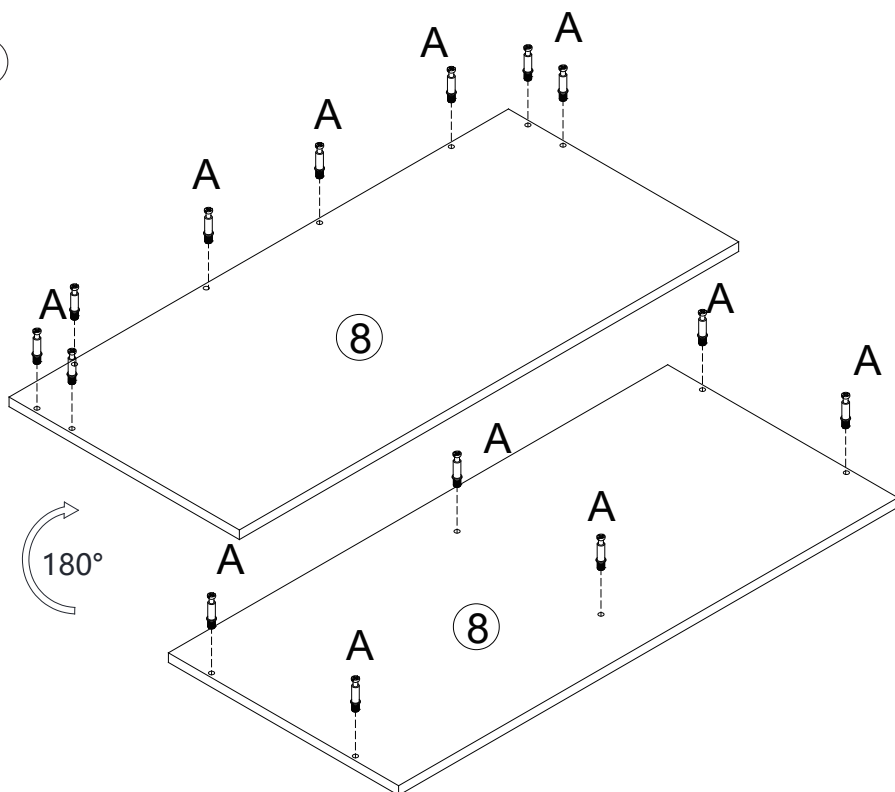

Step 10

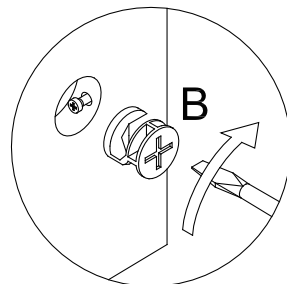
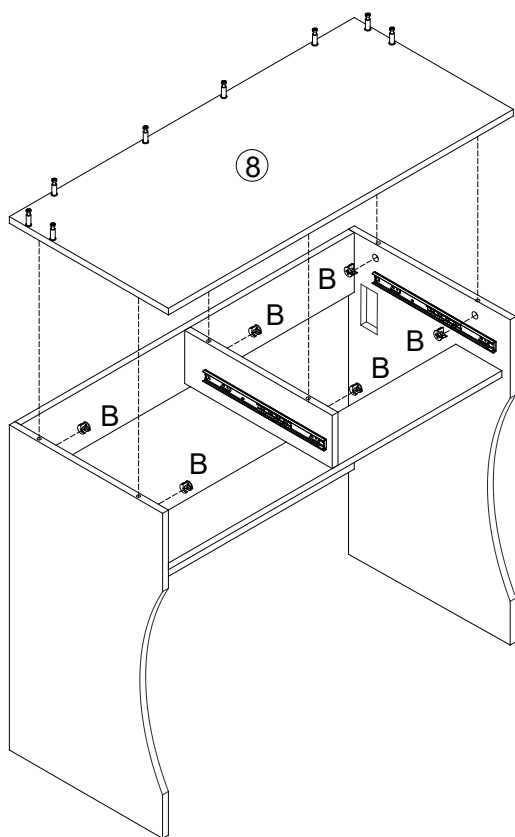

Step 11

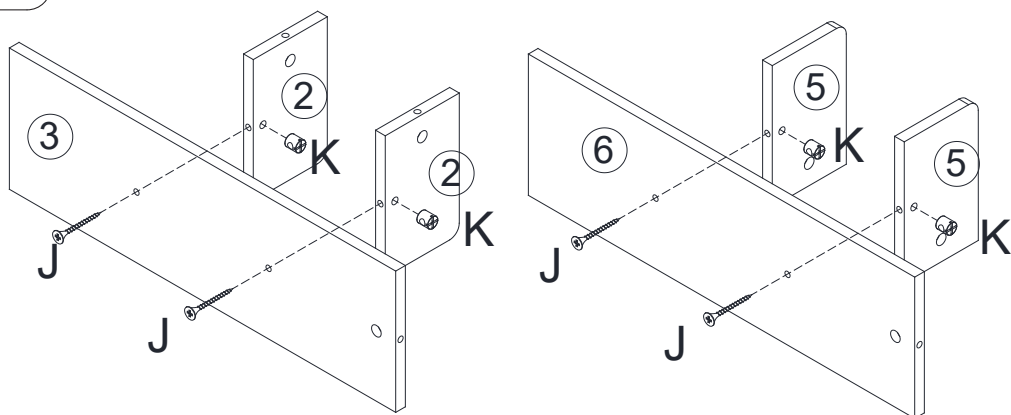

Step 12

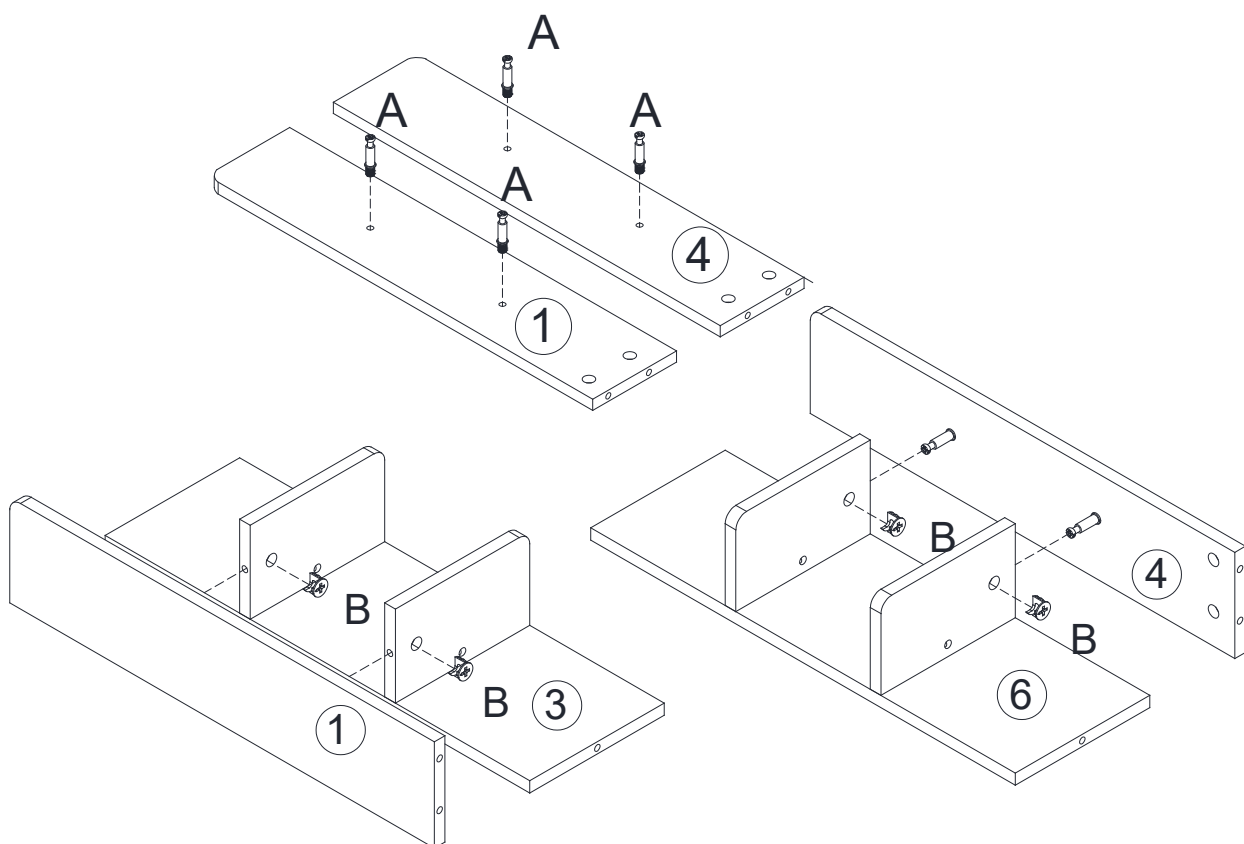

Step 13

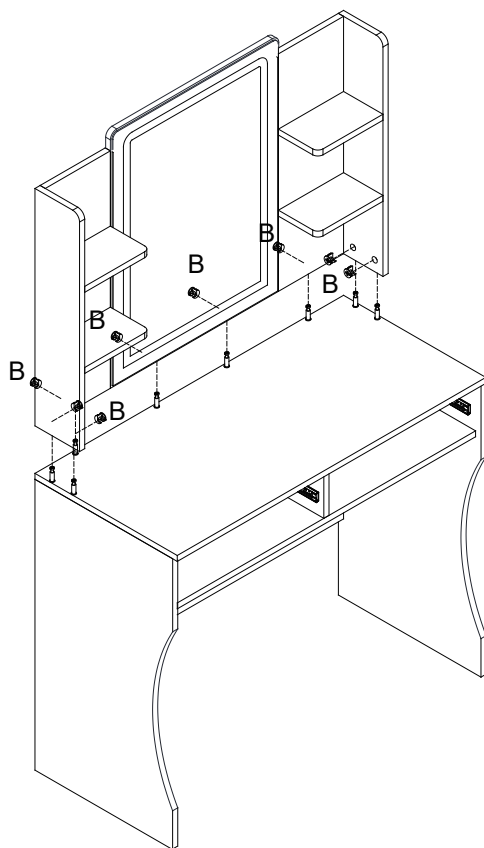

Step 14

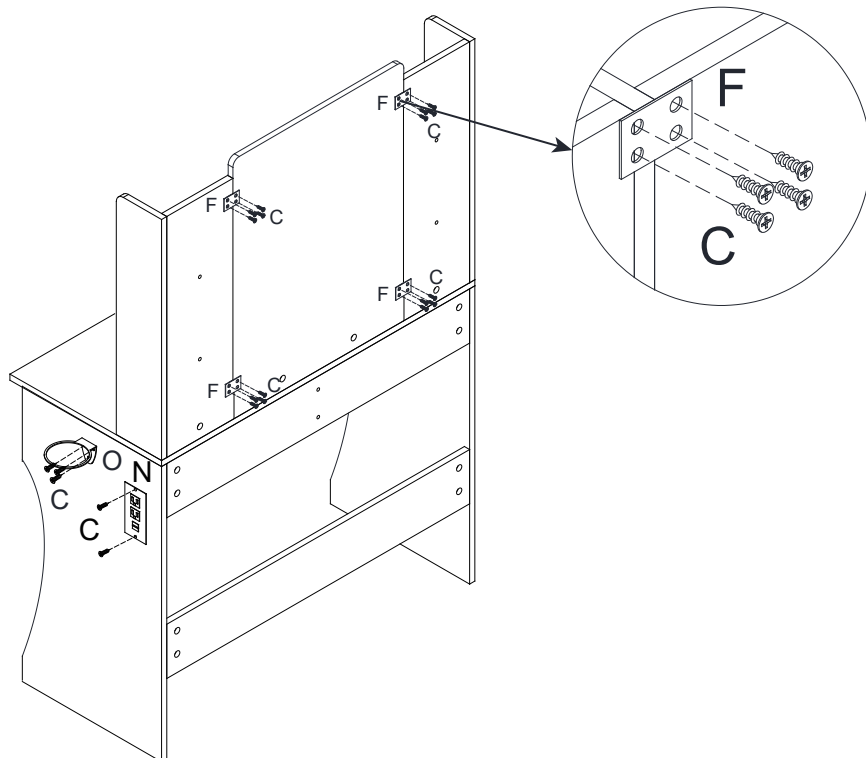

Step 15

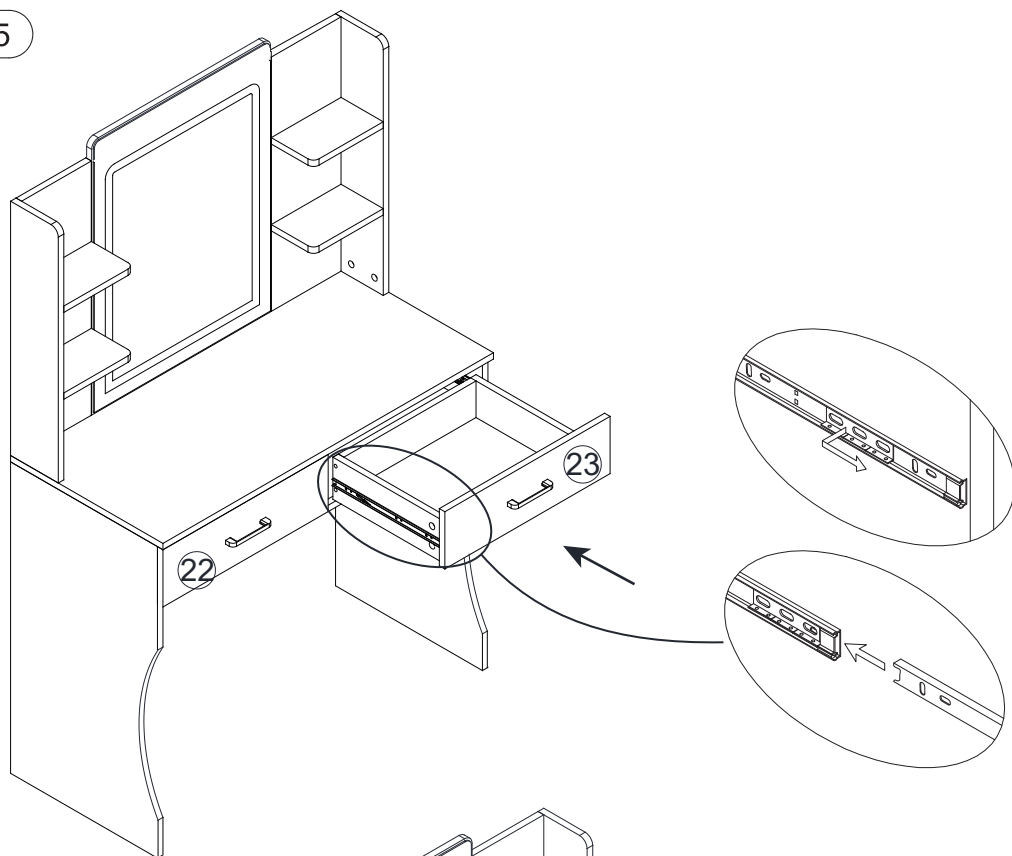

Step 16

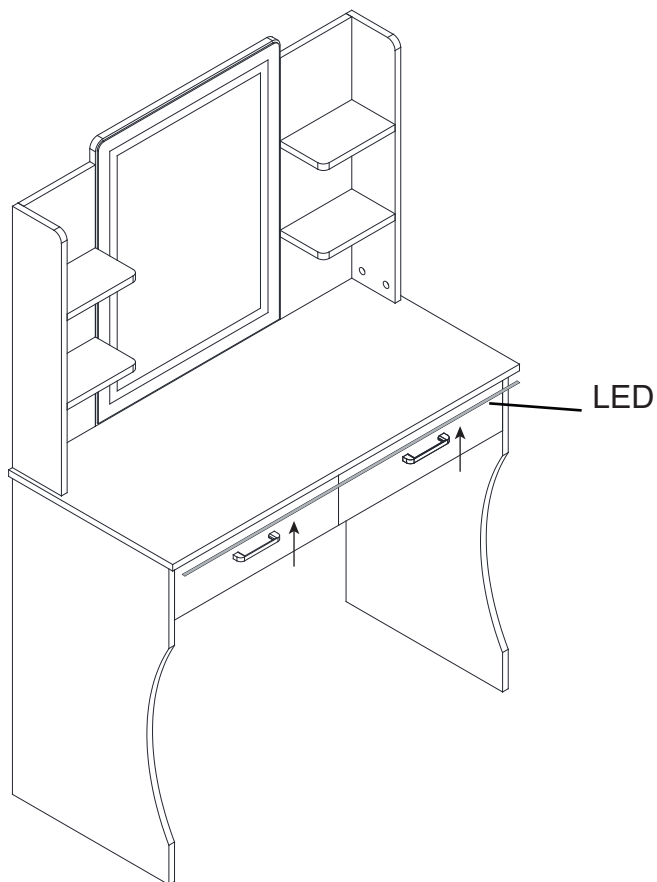

Step 17

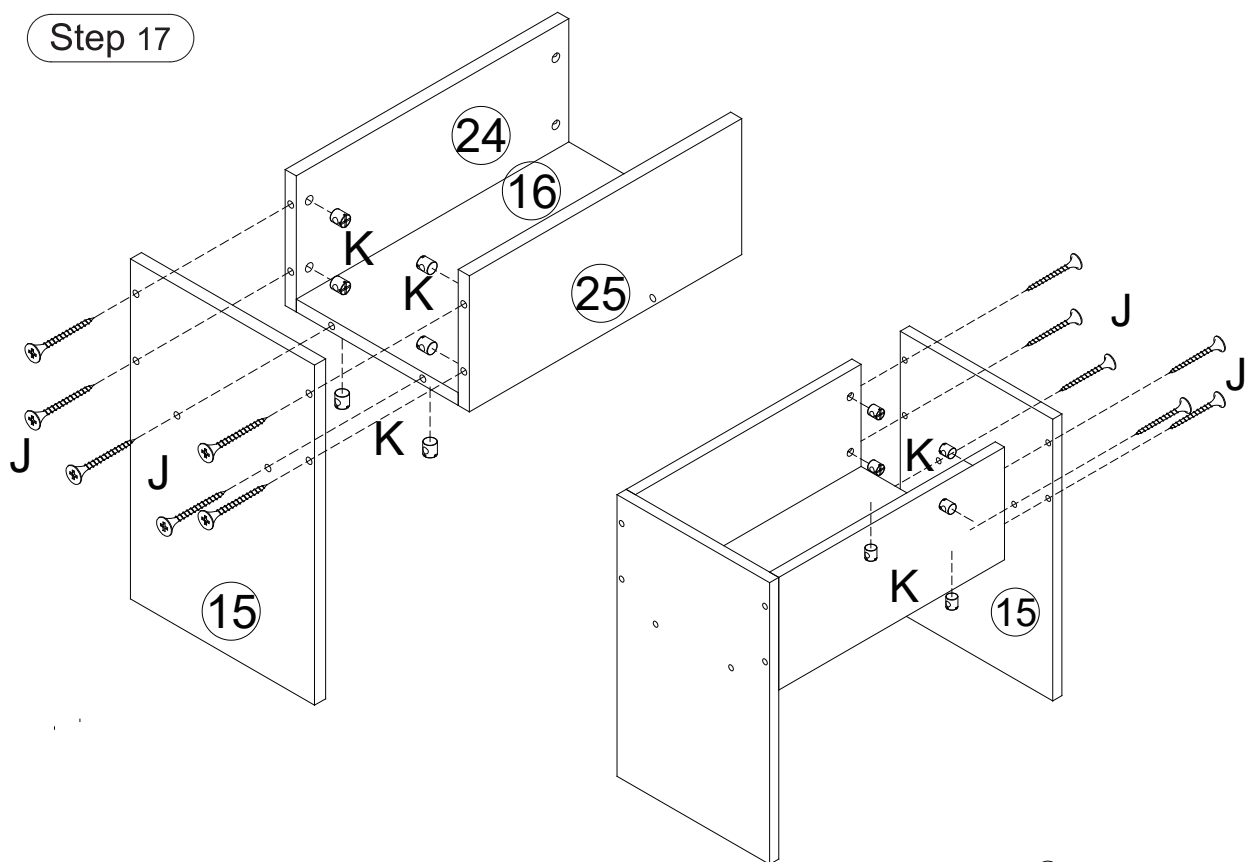

Step 18

