

OWNER'S MANUAL

READ AND SAVE THESE INSTRUCTIONS

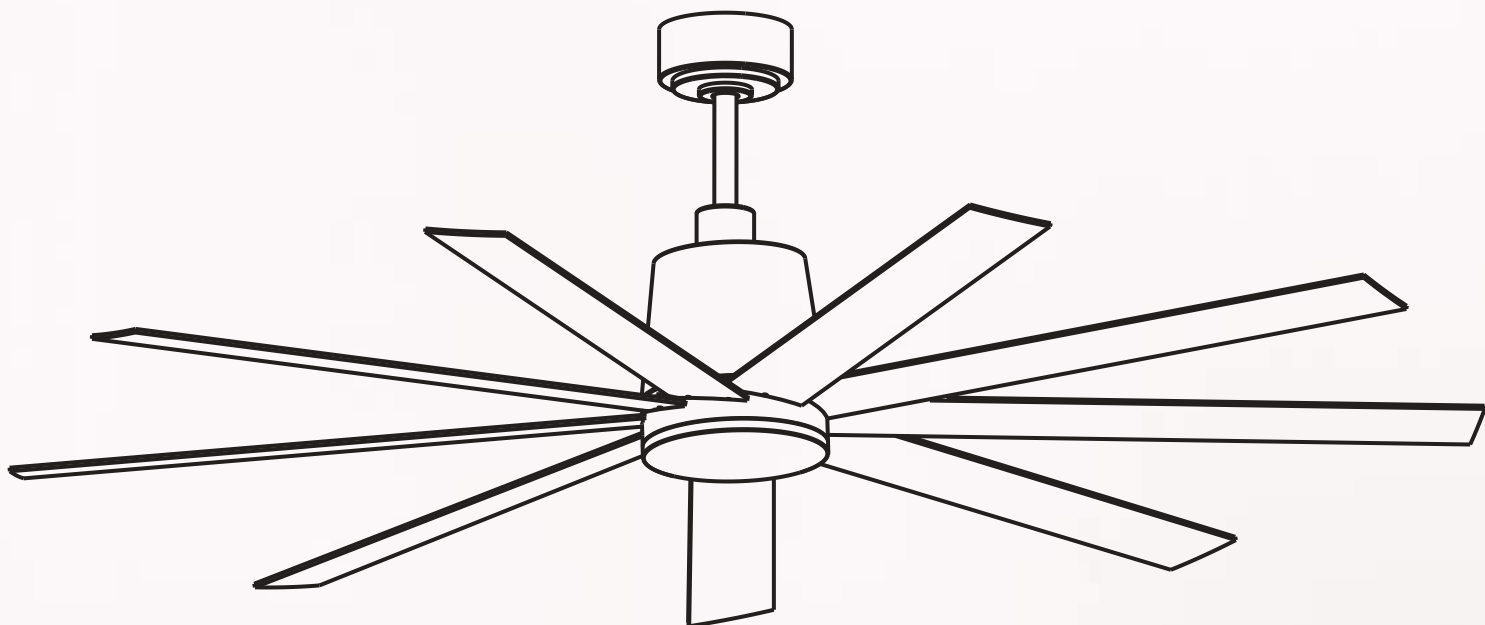

8223-72Black/72White

CONTACT INFORMATION

Feel free to reach out to us if you encounter any issue when using our products.

E-mail: uroadmin@urogoo.com

Phone: (657) 384-1547



WARNING

WARNING: To avoid fire, shock and serious personal injury, please read the following instructions carefully.

Important Safety Instructions

1. Read all instructions and safety information before installing your new fan. Review the accompanying assembly diagrams.
2. Before installing the fan, disconnect the power by removing fuses or turning off circuit breakers.
3. Make sure all electrical connections comply with local codes, ordinances, or National Electrical Codes. Hire a qualified electrician or consult a do-it-yourself wiring handbook if you are unfamiliar with installing electrical wiring.
4. Make sure the installation site you choose allows the fan blades to rotate without any obstructions. Allow a minimum clearance of 7 feet from the floor to the trailing edge of the blades.
5. If you are mounting the fan on a ceiling outlet box, use a metal outlet box. Secure the box directly to the building structure. The outlet box and its support must be able to support the moving weight of the fan (at least 50 lbs.). Do not use a plastic outlet box. Attach the mounting bracket by using the hardware supplied with the ceiling outlet box.
6. If you are mounting the fan to a joist, make sure it is strong enough to support the moving weight of the fan (at least 50 lbs.)
7. After installing the fan, make sure all the connections are secured. This will prevent the fan from falling.
8. Do not insert anything into the fan blades while the fan is operating.
9. Turn the fan off and wait for it to stop before reversing fan direction.
10. To reduce risk of electrical shock and personal injury, do not install the fan on a sloped ceiling.
11. To reduce the risk of electrical shock and personal injury, do not use this fan with any solid-state.
12. To reduce risk of personal injury, use only the two steel screws and lock washers provided with the fan for mounting the outlet box.



WARNING

- Do not install the fan with wet hands.
- Do not insert foreign objects between the rotating fan blades.
- Do not bend the fan blades when installing or cleaning the fan.
- Do not disassemble or modify this product or use non-original parts without permission.
- Keep children away from your working area.
- Properly dispose of the fan's packaging material.
- Make sure the ceiling fan is firmly secure to the ceiling. Double check all connections before you restore power.
- Turn off the fan and wait for the blades to stop completely before performing any maintenance or cleaning.

Preparation

Tools required for assembly(not included)



Step Ladder

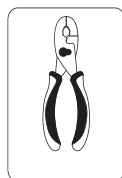

Power Drill



Screwdriver

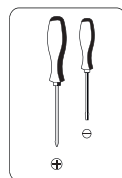

Wire Stripper



Electrical Tape

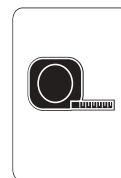

Wrench

Installation Location

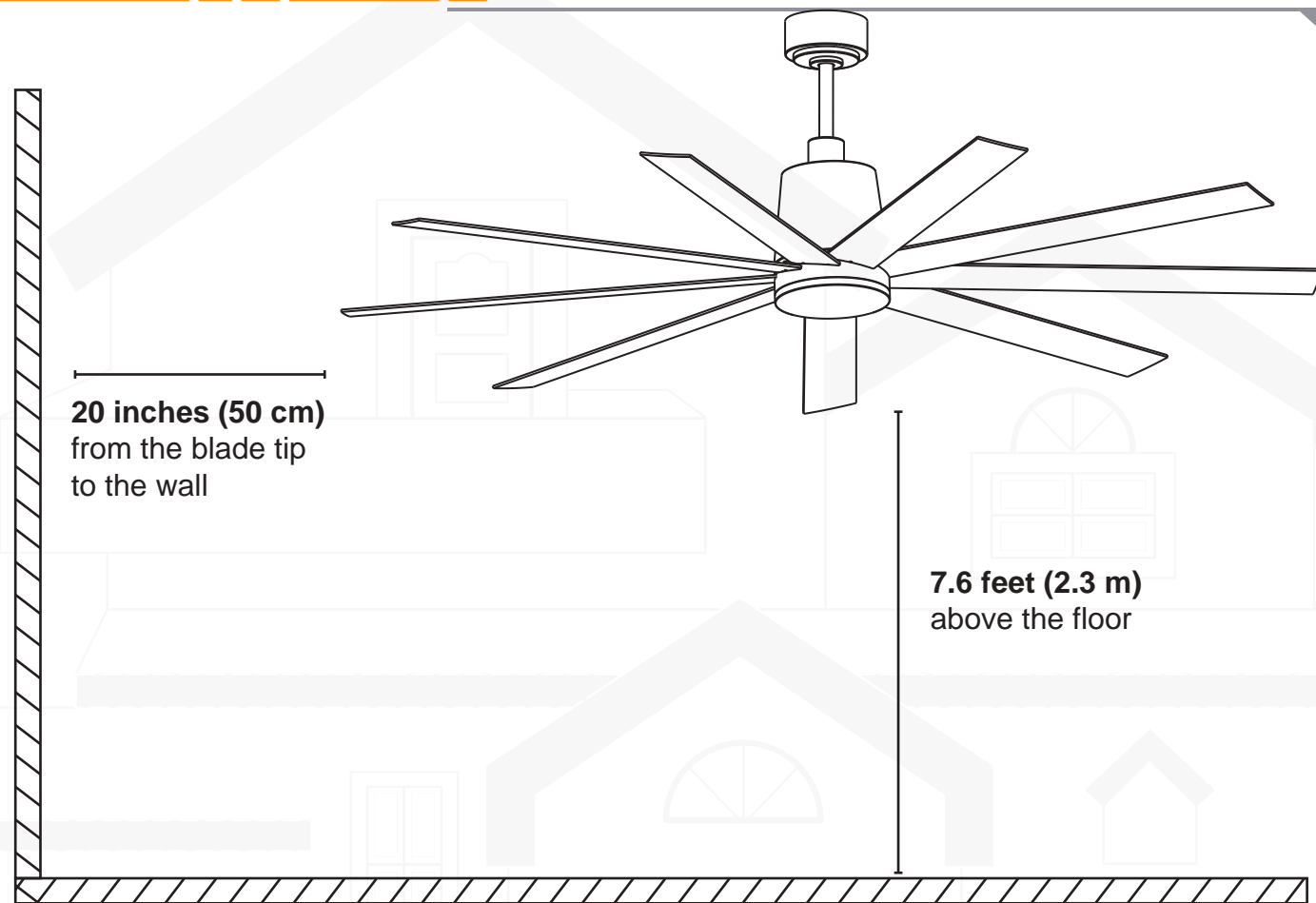

Part List

Unpack your fan and check the contents. Please check each item prior to installation. To reduce the chance of marks or possible damages, please remove the parts when required for installation.

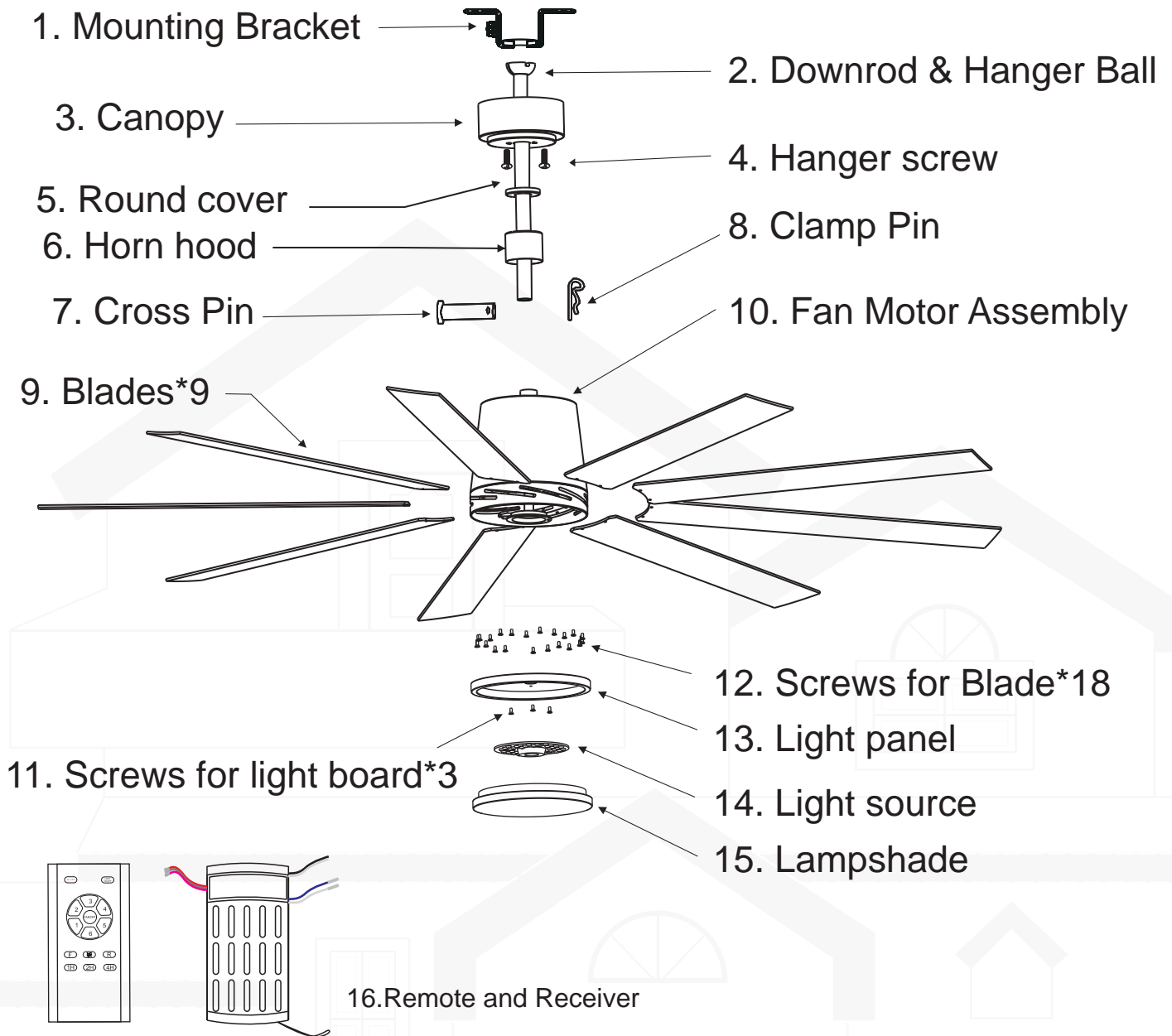

Installation kit

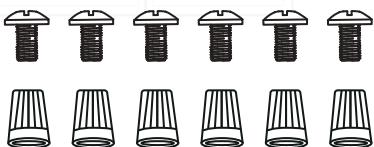

Hanging head screw

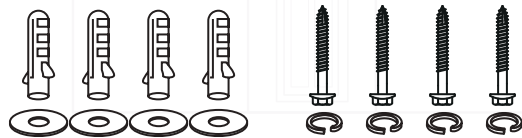

Down rod screw

Instructions manual

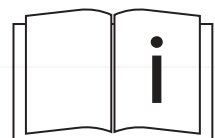

Ground Assembly

Step1: Fan Blade Installation

① Assemble the blade assembly with the screws provided.

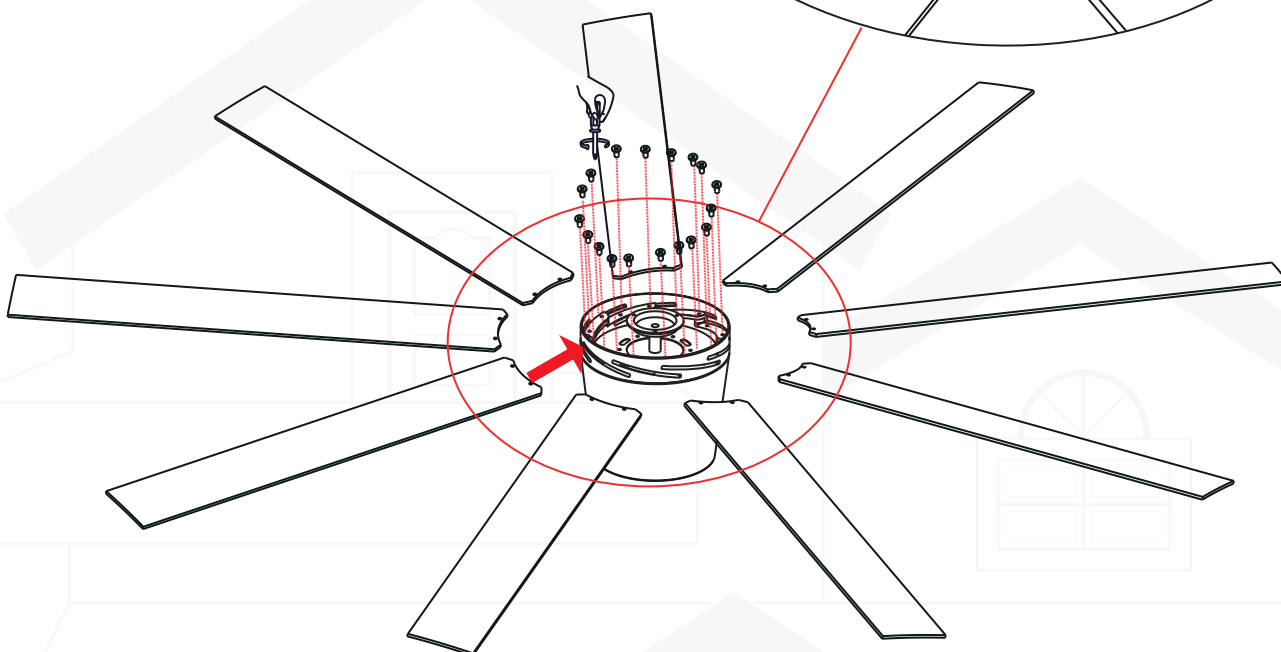
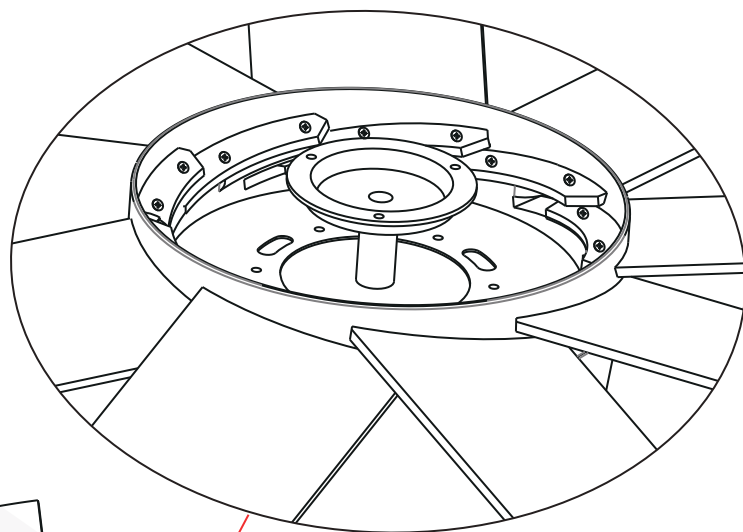

Ground Assembly

Step 2: Led Board Installation

① Install the light panel to the motor with screws provided.

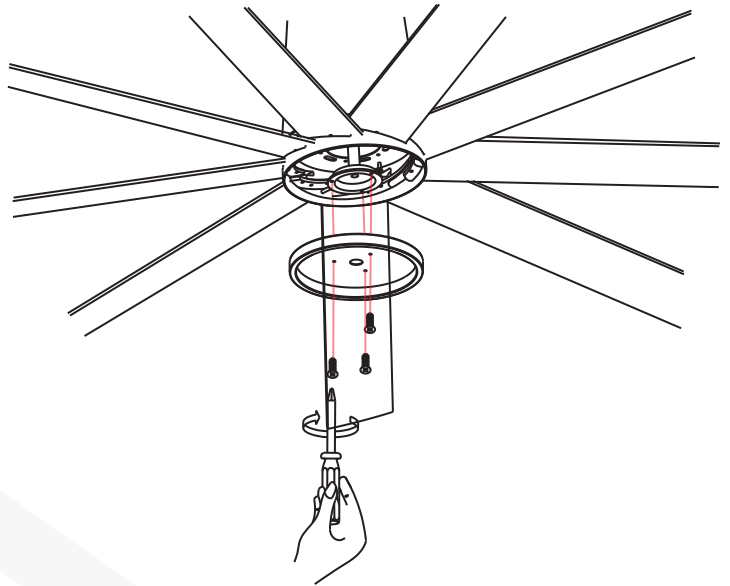

② Connect the light source terminal with the motor terminal.

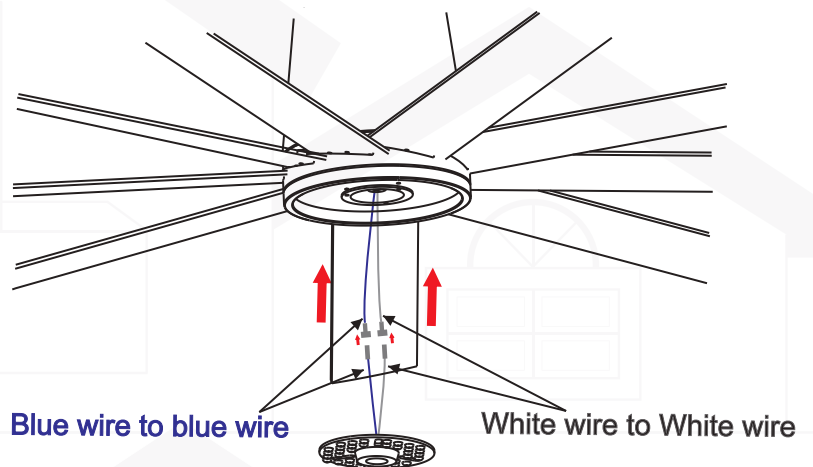

③ Install the lampshade.
(Turn clockwise to tighten.)

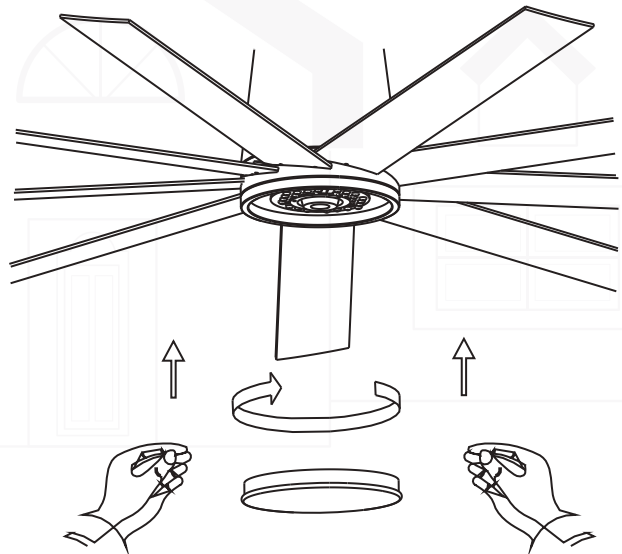

Ground Assembly

Step 3: Downrod Installation

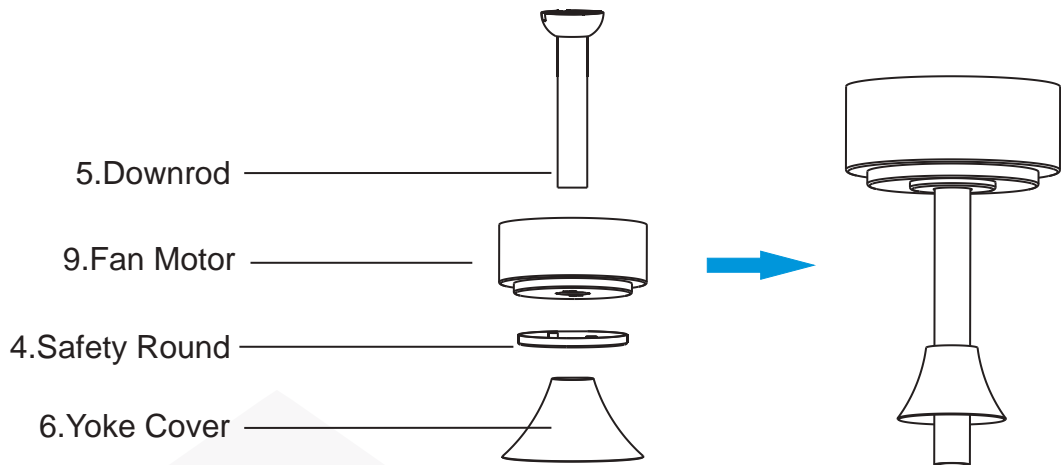

(Figure 1)

❶ Assembly the canopy, safety round, yoke cover in turn.
(Figure 1)

❷ Remote the clevis pin and hairpin clip from the top of the motor and loose the screws on both sides. (Figure 2)

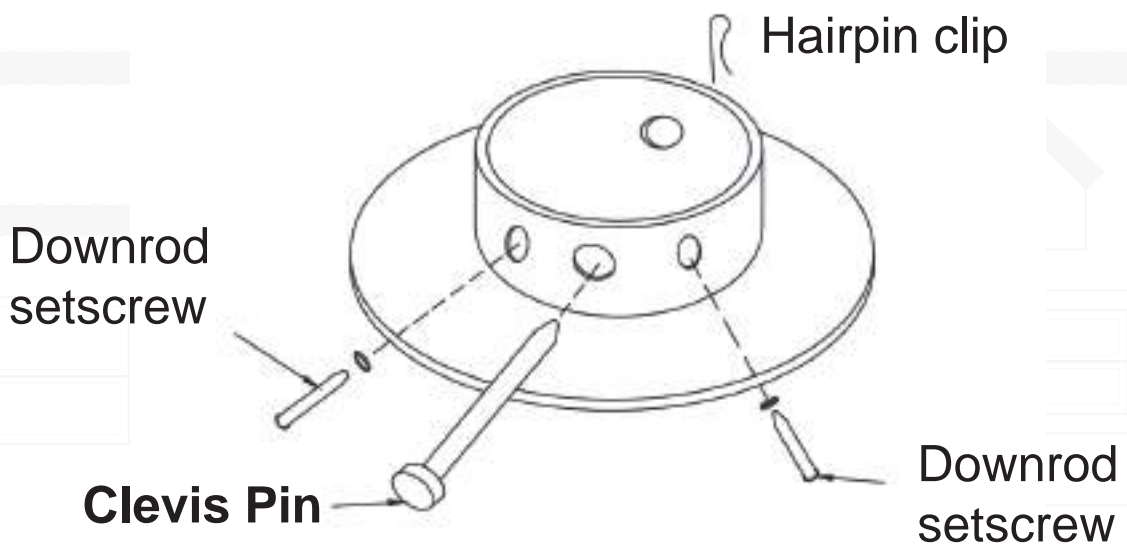

(Figure 2)

Ground Assembly

① Thread the motor wire through the lower pull rod(Figure 3), lock the screw with the clevis pin, and tighten the motor screw(Figure 4).

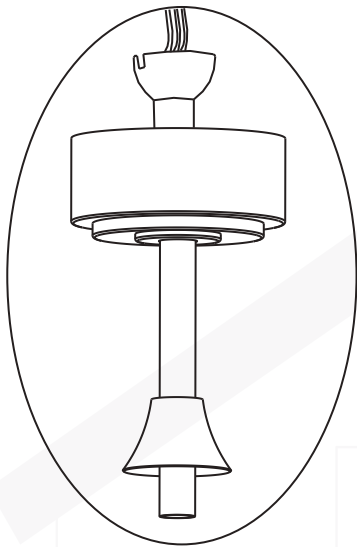

(Figure 3)

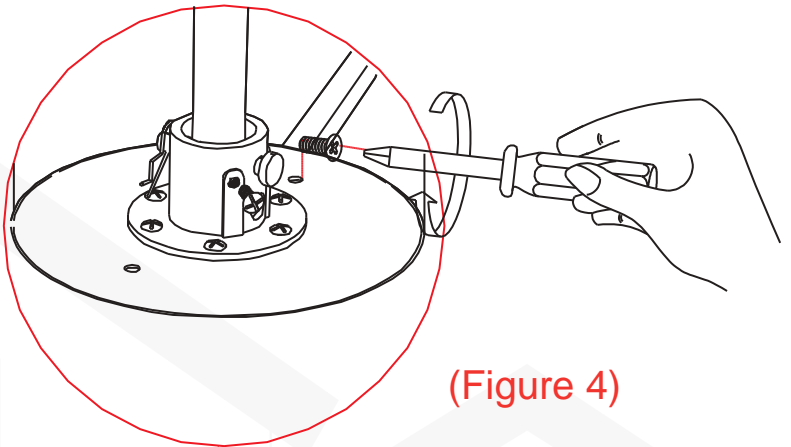

(Figure 4)

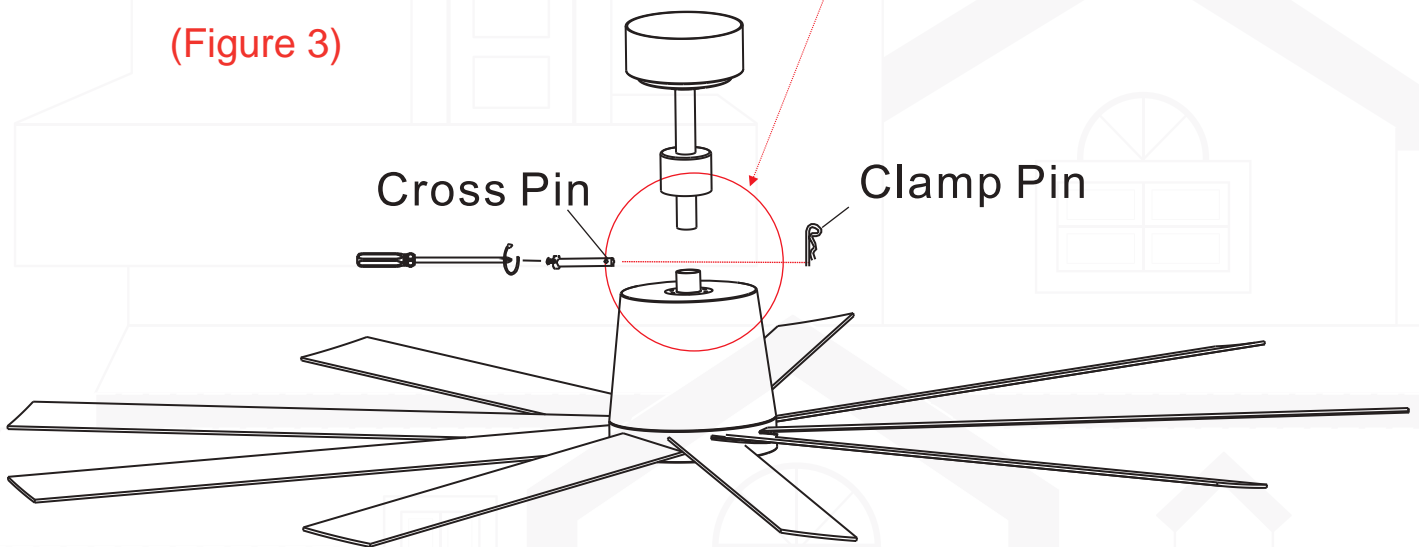

Suspension

Step 4: Mounting Bracket

Choose the following installation methods according to the actual situation of the roof.

Cement roof

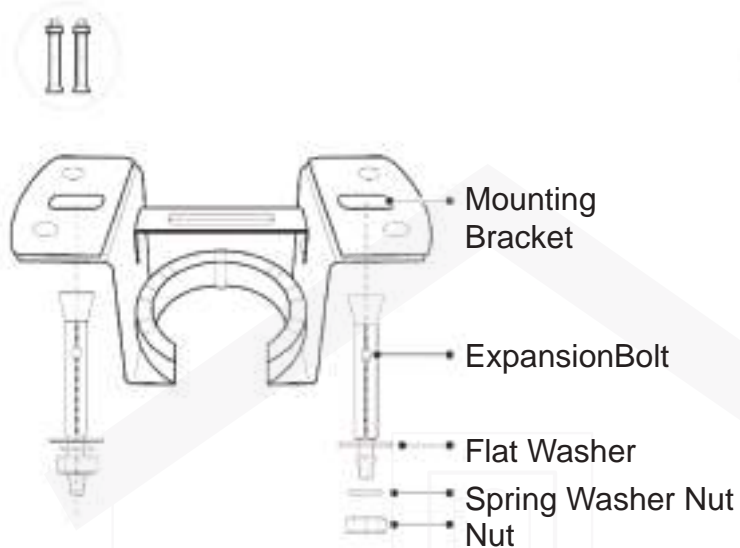

1. Drill holes with electric drill (ø8 mm)
2. Use expansion screws to fix the mounting bracket to the ceiling.

Solid wood roof

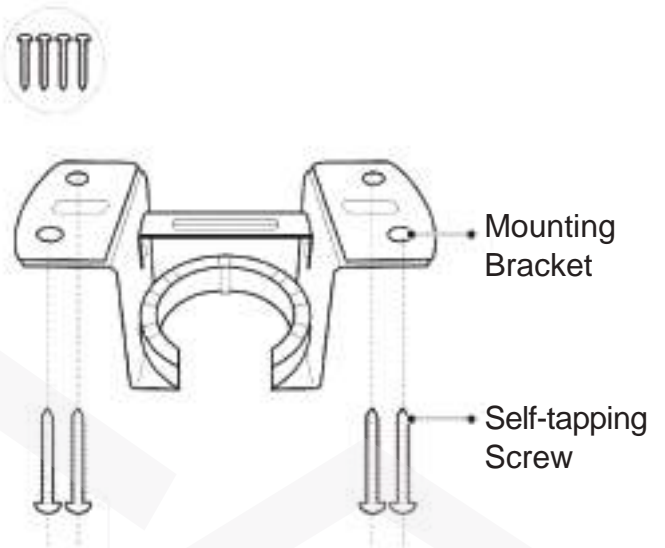

Fasten the mounting bracket to the ceiling with self-tapping screws.

Step 5: Mount Fan to Bracket

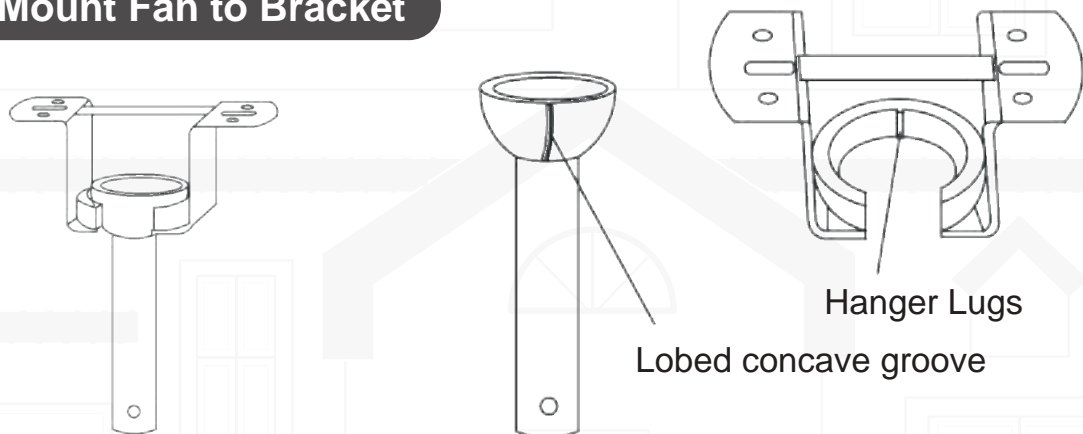

Lift the fan assembly onto the mounting bracket, ensure the registration slot of the hanger ball is positioned on the stopper of the mounting bracket to prevent the fan from rotating when in operation.

Tips:

Seek the help of another person to hold the stepladder and hang the fan body for you.

Step 6: Connecting the wires

Important Note: The motor wires and receiver wires have unique matching interfaces while the neutral, live, and ground wires should be connected according to the markings on the wires. (Figure 6)

① Connect the light wire, motor wire, neutral wire, and live wire according to the instructions in the diagram on the right (Figure 6).

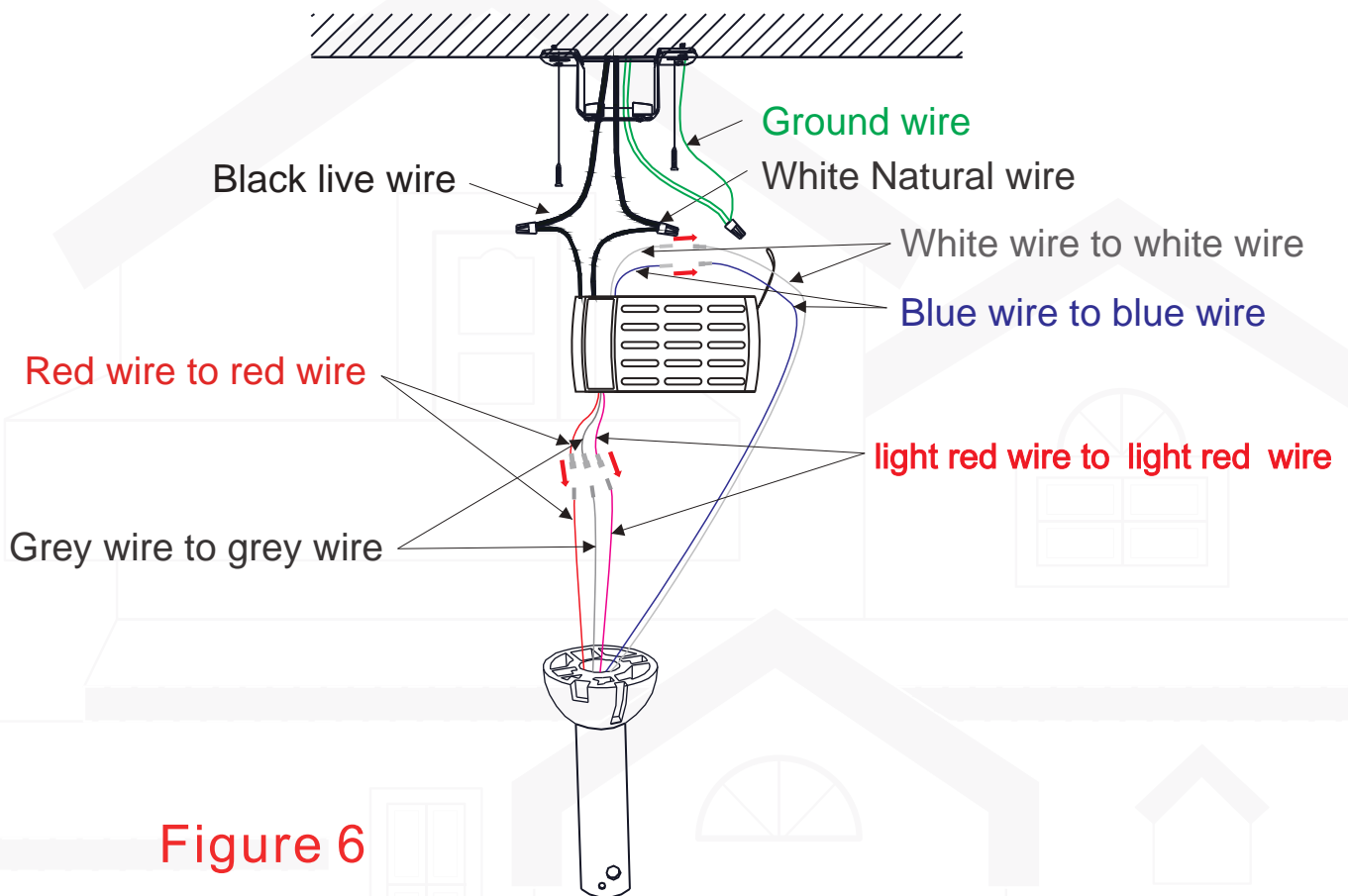

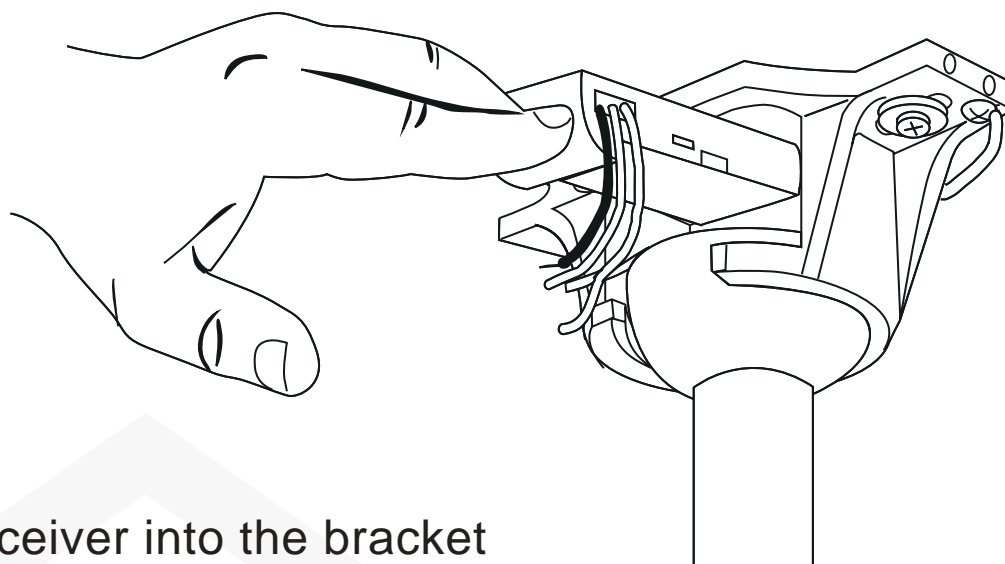

- ② Put the receiver into the bracket and arrange the wires.

- ③ Fix the downtube and screw in the canopy bolts.

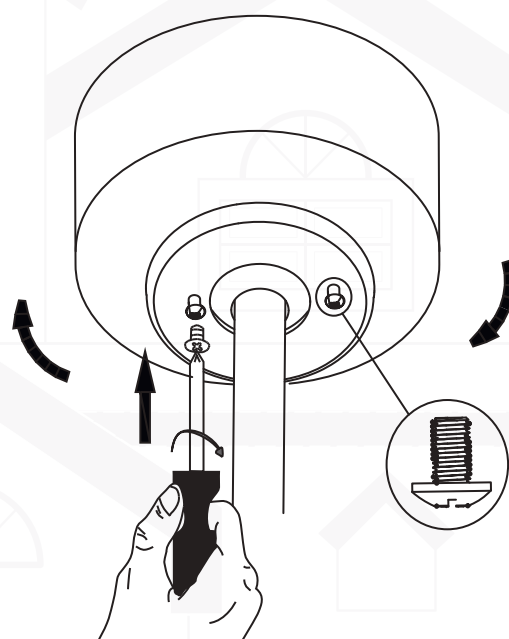

Change Downrod

Step 7: Change Downrod(OPT)

How to choose different lengths of downrod

1. The ceiling distance of the house is 100 inches, which is suitable for installing a 5-inch downrod
2. The ceiling distance of the house is 110 inches, which is suitable for installing a 10-inch downrod

If you need to change different length downrod, please follow these steps:

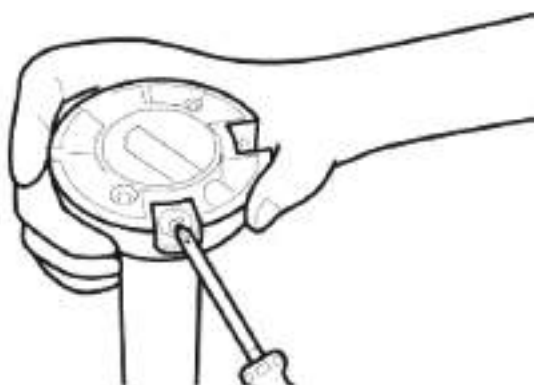

① Loosen the screws on the hanging ball.

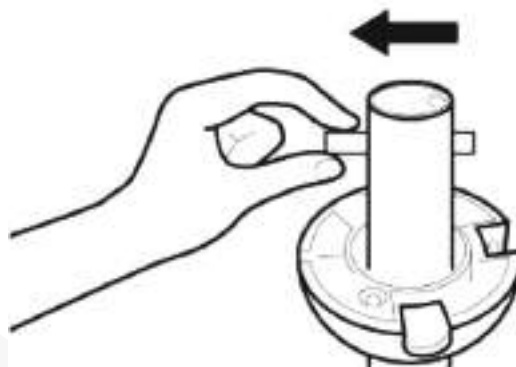

② Remove the metal bar.

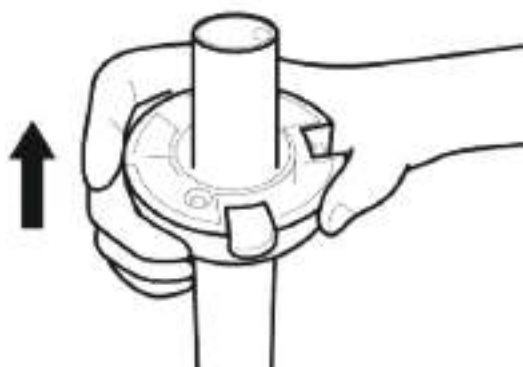

③ Take off the hanging ball from the original downrod.

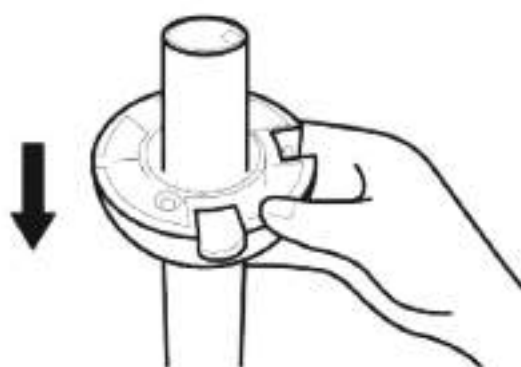

④ Install the hanging ball to an appropriate downrod.



⑤ Insert the metal bar and tighten the screws.

Remote Control

Step 8: Function Instruction

1. Restore electrical to the outlet box by turning the electricity on at the main fuse box.
2. Remove the battery cover from the remote control transmitter, install the battery, and replace the cover.
Note:
 - 1). Use AAA 2 1.5V battery to replace battery.
 - 2). If not using for long periods of time, remove the battery to prevent damage to the remote transmitter, and store the remote transmitter away from excess heat or humidity.
3. The buttons on the remote control transmitter control the fan speed and light as follows.

Remote Control (Esmmitter) Operation

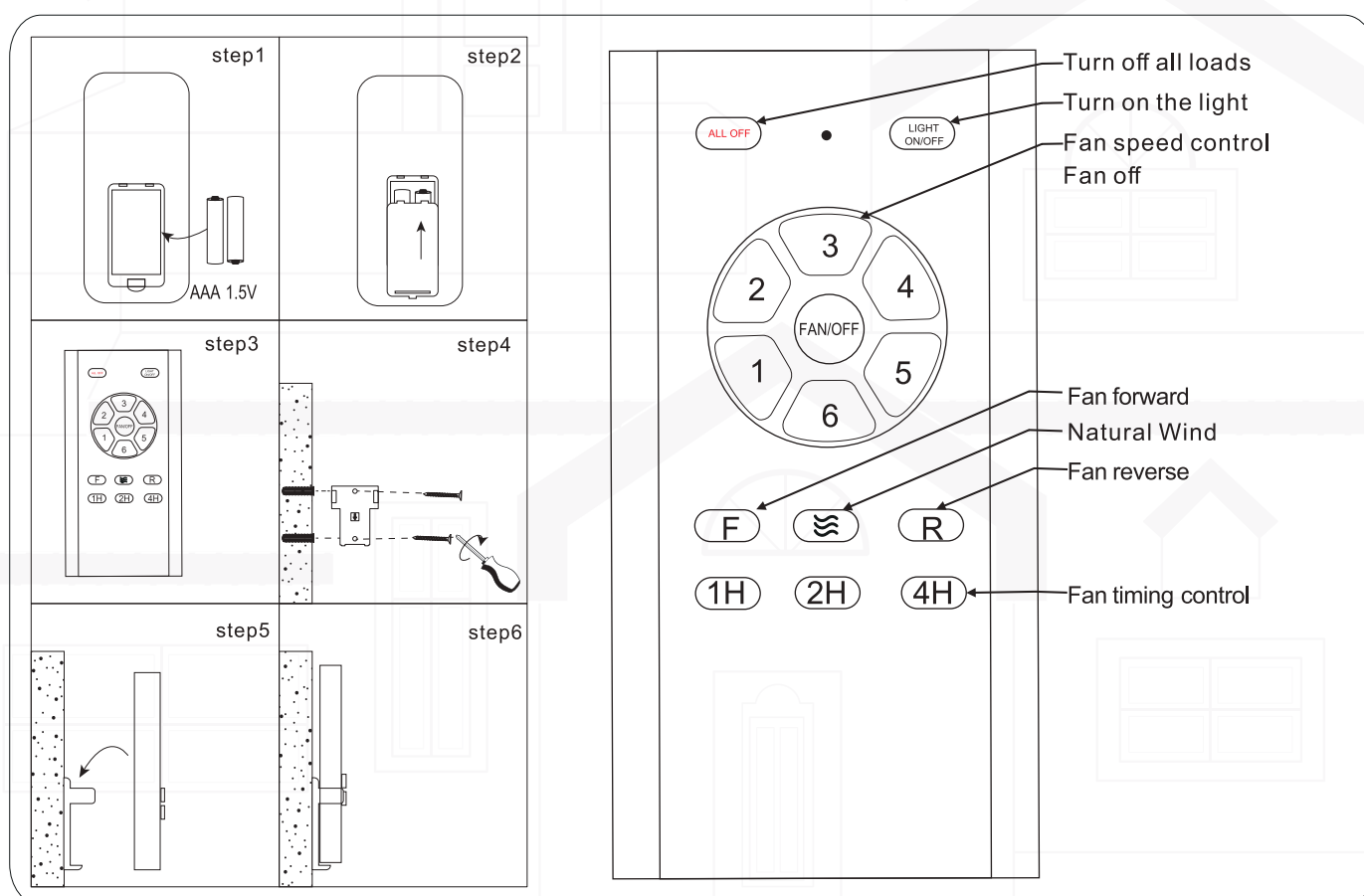

Operating Your fan

Note:

Sensing Distance: 33 ft 49 ft (10 m - 15 m)

Direction of the fan / Reverse Switch.

Reversible Function:

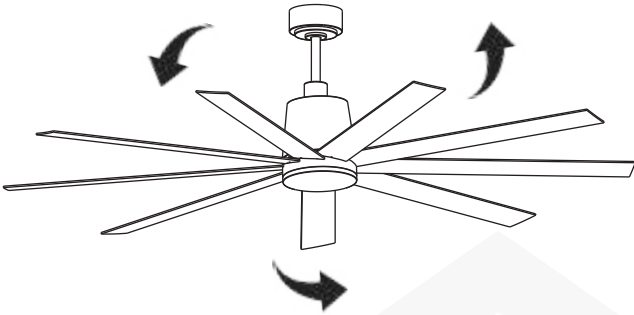

Summer (Forward):

A downward airflow creates a cooling effect.

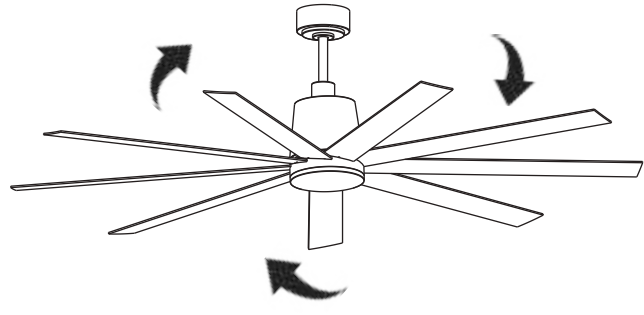

Winter (Reverse):

An upward airflow increases the indoor temperature.

PS: If you want to change the fan's rotation direction, please press the button while the fan is running.

Maintenance

TROUBLESHOOTING

If there is a problem with the fan during use, please check the following tips for solutions. If the problem still cannot be solved, please contact our after-sales team.

The Fan Does Not Respond to the Remote Control.

- Check that all wire connections are correct and secure.
- Verify that the power is turned on and reaching the receiver.
- Verify that the batteries of the remote control are installed with the correct polarity, making sure to install the + (positive) end of the batteries on the solid end and the - (negative) end on the spring.

The Fan Makes a Humming Noise.

- Make sure the controls you use are supplied with your fan.
- Make sure all accessories are securely fastened. Loose parts often cause a vibrating noise or buzzing sound.
- Disassemble the fan and reinstalling it can sometimes remedy this resonant vibrating noise.

The Fan Wobbles.

- Make sure the mounting plate and hardware at the ceiling are firmly fastened.
- Make sure all screw fittings on the fan are tight.
- If necessary, use the self-tapping screws provided to further secure the bracket to the joist.

BALANCING FAN / WOBBLING TROUBLE SHOOTING

Please note that all ceiling fans are not the same, even in the same model—some may move more or less than others.

Movement of a couple of centimeters is quite acceptable and does not suggest the fan will fall down.

Even though all blades are weighted and grouped by weight, it is impossible to eliminate wobble altogether. This should not be considered a fault. Ceiling fans tend to move during operation due to the fact that they are not generally rigidly mounted.

TRY THE FOLLOWING TO REDUCE A WOBBLING FAN;

1. Check that all of the blade mounting screws are tightened and secure.
2. Wobbling problems may result from inconsistent blade level. To check the blade level, measure the distance from each blade tip to the ceiling. Note: If measurements are inconsistent:
 - Be sure the blade mount screws are not too tight or too loose, which may cause wobbling due to an unlevel blade tip
 - An out of shape blade can cause wobbling. Check by removing the blade and placing on a flat surface.
3. Blade tracking may be checked simply by use of a household ruler. Place the ruler vertically against the ceiling and even with the outside leading edge of a blade. Note the distance of the edge of a blade compared to the others. Turn the blade slowly by hand to check the remaining blades.
If a blade is not in alignment, the blade is either out of shape, warped or the blade screws are not evenly tighten or either loose.

BALANCING KIT

A Balancing Kit has been provided to assist with reducing a wobble. Please retain the kit as it may become useful should the fan develop a wobble in the future.

Step 1. Clamp the balance clip to the middle position marked A of any fan blade. Turn on the fan and check if the vibration of the fan blades is reduced. Proceed to step 3 if the shaking is reduced. If shaking increases go to step 2.

Step 2. Take out the balance clip, clip it to the middle mark B of the clockwise adjacent blades, and so on until you find the fan blade that can reduce the shaking.

Step 3. When we found the fan blade that can reduce the shaking. Move the balance clip on the fan blade towards the center or edge and turn on the fan to see if the wobble is reduced. If the balance clip cannot fully counteract the shaking of the fan blade at the center or edge position, you can add an additional balance clip near the center or edge position for adjustment.

Step 4. When the fan blade no longer shakes, use a balance patch to stick to the position where the clip on the back of the fan blade is clamped to replace the balance clip. (1 balance patch instead of 1 balance clip)

Step 5. The adjustment is complete.



MADE IN CHINA