

Before Assembly:

- ★ Please carefully read all instruction steps.
- ★ Retain this manual for future reference.
- ★ Unpack and inventory all parts and hardware.
- ★ Read each step carefully and follow the correct installation sequence.
- ★ To avoid losing parts during assembly, we recommend not moving the fixture until assembly is complete.
- ★ Keep all small parts and packaging materials of this product away from infants and children, as they may cause serious injury.

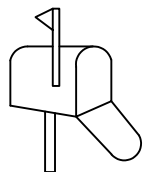

Email:  
**Lighting@yxtservice.com**  
Please contact us if you have any questions  
And wish you a happy life !



5 Star Rating  
Thank you

★ Product Specifications:

lamp holder : LED      Wattage : 50W (Single)      Color Temperature : 3000K

Installation Instructions

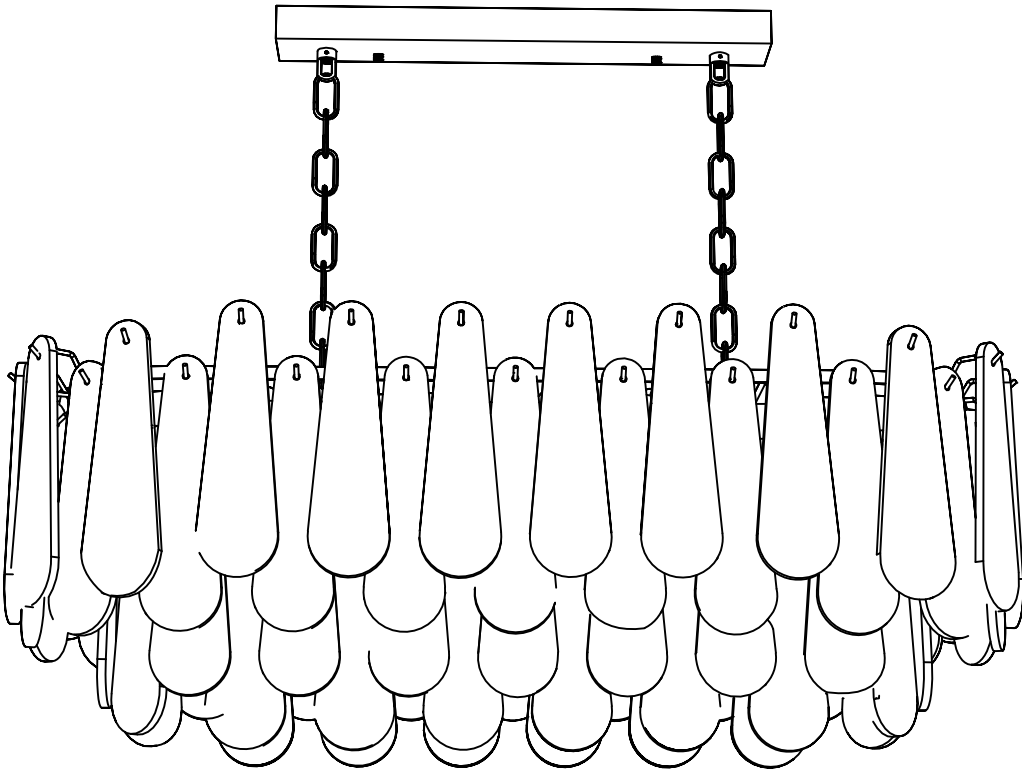

# Fittings list

A\*2



B\*3



C\*11



D\*76



E\*3

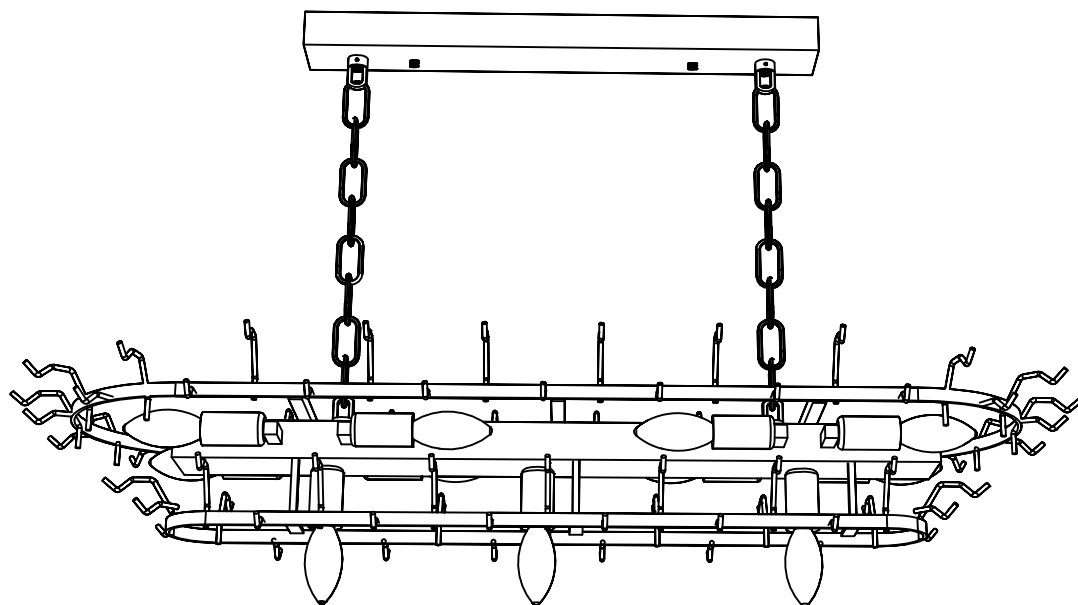
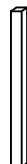

**Chandelier body\*1pcs**

Installation video with product url.

YouTube URL: <https://www.youtube.com/watch?v=-5f7Tmhwuos>

Scan QR code to view :



# Alabaster piece assembly:

- (1)Hook the light body hanging ring with hanging chain movable buckle.
- (2)Screwing the first and second layers to the square supports.
- (3)Fix the E12 light source to the lamp head.
- (4)Try to light up the light source.
- (5)Hang the alabaster piece to the hooks of 1,2,3 layers.
- (6)Installation completed.

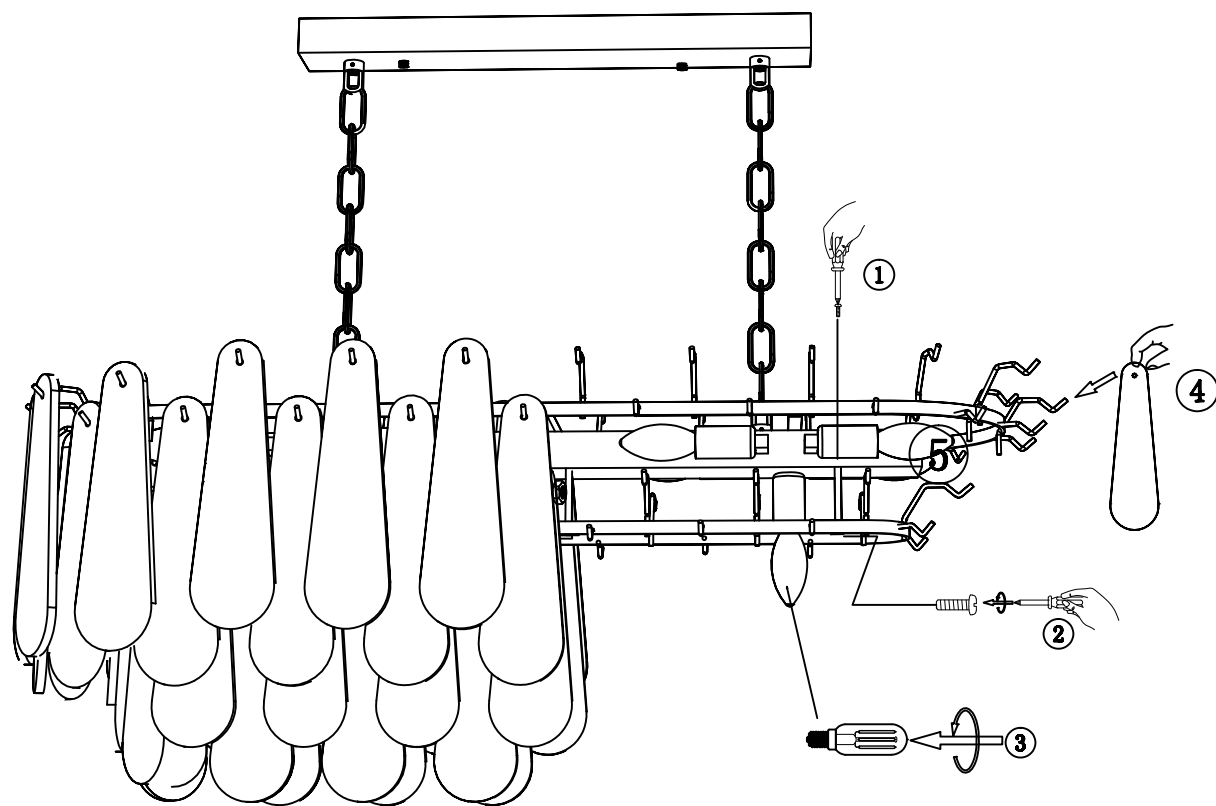

## Packaging Schematic

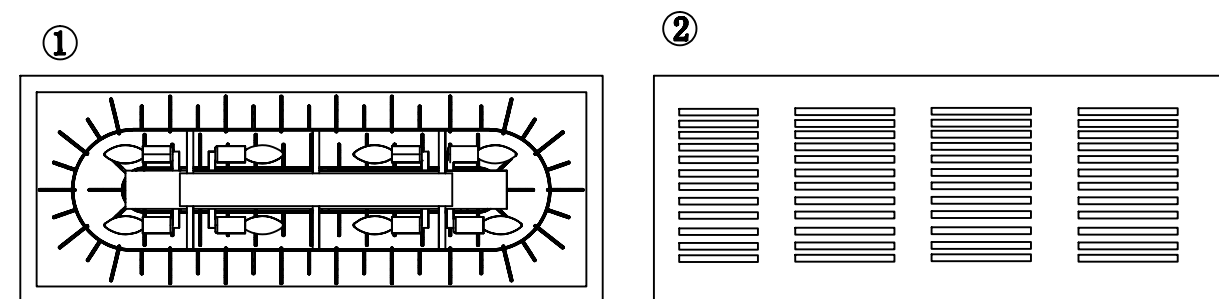
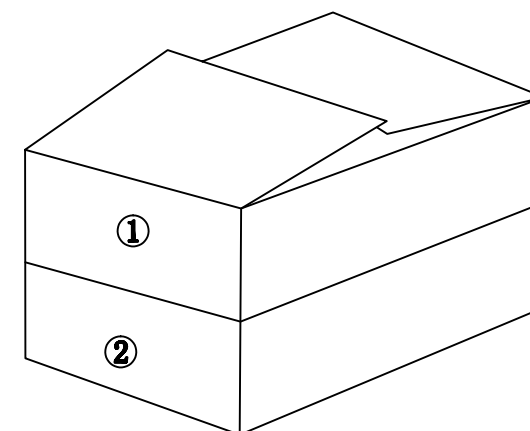

### Internal packing list:

- 1.The first layer of the lamp body main frame & accessories package
- 2.The second layer of lucite sheet

**Pegboard installation: take out the pegboard and fix it with screws on the ceiling where you need to install it.**

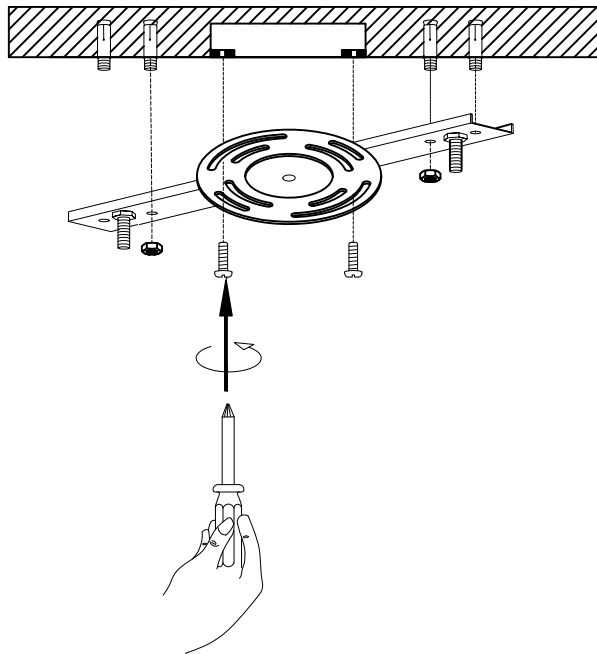

**Chandelier body installation:**

- 1. Take out the chandelier body**
- 2. Connect the main cable and power cable of the light body.**
- 3. Fix the ceiling cover to the hanging board with the hanging chain, and hook the hanging chain with the movable buckle.**
- 4. Adjust the height of the hanging chain**

