

# Installation Instructions

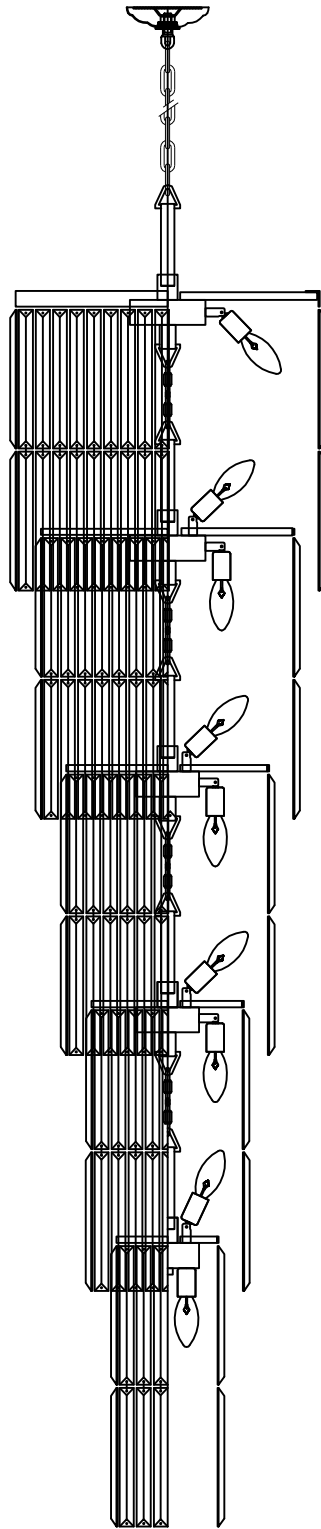

# Package

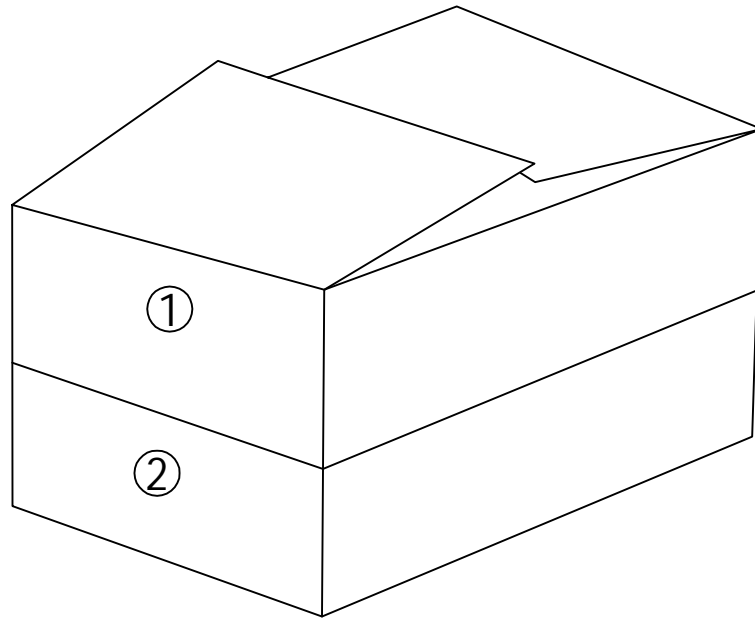

①

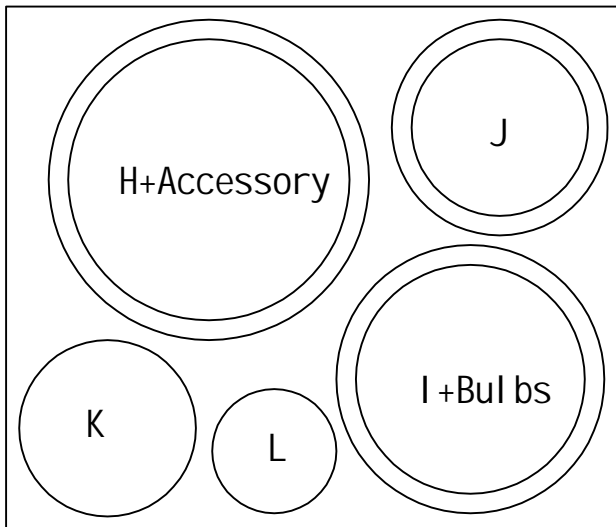

①

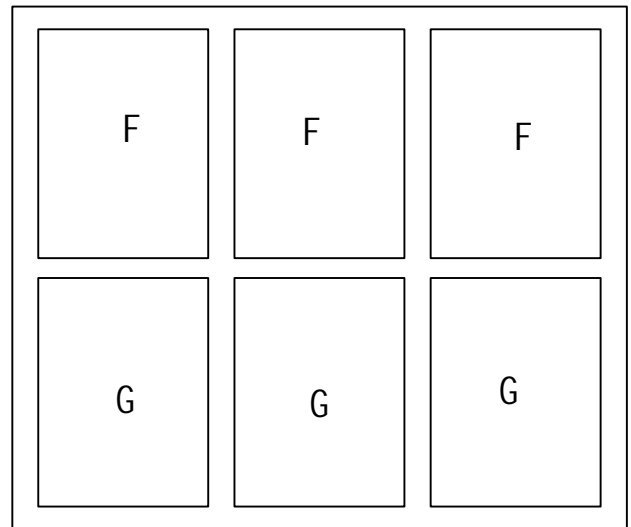

## Packaging List:

1, First Layer: Lamp Body + Components + Bulbs

2, Second Layer: Crystal

## Before assembly:

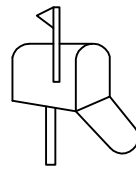

★Email:

[Lighting@yxtservice.com](mailto:Lighting@yxtservice.com).

If you have any questions,  
please feel free to contact us.

Wishing you a pleasant day!

★ Please read all the instructions carefully

★ Keep the instruction manual for future reference.

★ Separate and inventory all parts and hardware

★ Read each step carefully and follow the correct installation sequence

★ To avoid losing any parts during assembly, we recommend not moving the lamp before completing the assembly. Always place the product on a flat, firm, and stable surface

★ Keep all small parts and packaging materials of this product away from babies and children, as they may cause serious injury

★ ★ ★ ★ ★

5-star rating

Thank you



### ★ Product Specifications:

Bulbs: E12\*29pcs

Wattage: 5W (Single)

Color Temperature: 3000K

## Installation Video and Product URL:

YouTube URL: <https://www.youtube.com/watch?v=ewyELSvIGoI>

Scan the QR code  
to view the installation video:



# Accessory list

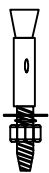

4pcs



4pcs

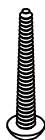

4pcs

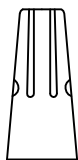

2+2pcs

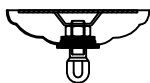

A. Canopy-1pcs

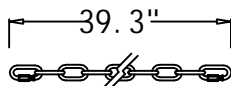

B. Chain-1pcs

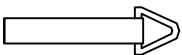

C. Rod-5pcs

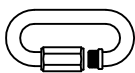

D. Locking Clips-8pcs



E. Bulbs-29+2pcs

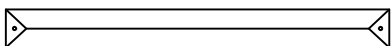

F. Single-hole Crystal -196+4pcs

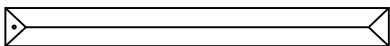

G. Double-hole Crystal -196+4pcs

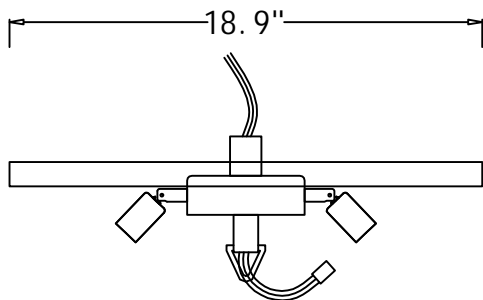

H. Lamp Body-1pcs

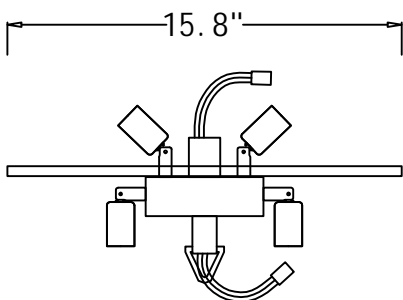

I. Lamp Body-1pcs

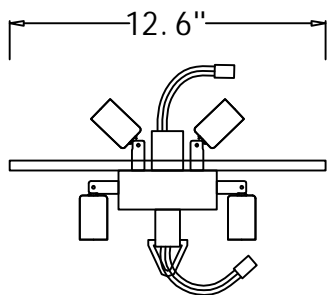

J. Lamp Body-1pcs

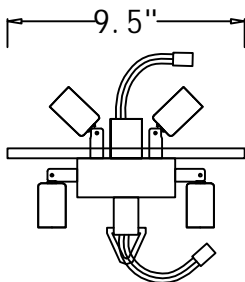

K. Lamp Body-1pcs

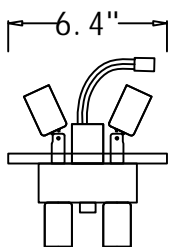

L. Lamp Body-1pcs

# ① Fixture Assembly:

- (1), Attach the mounting plate to the ceiling.
- (2), Pass the power cable through the C rod and tighten it onto the H lamp body.
- (3), Use the E chain to connect the H lamp body to the canopy, then insert the power cable into the C canopy.
- (4), Connect the main power line to the fixture's main power line and secure the canopy.

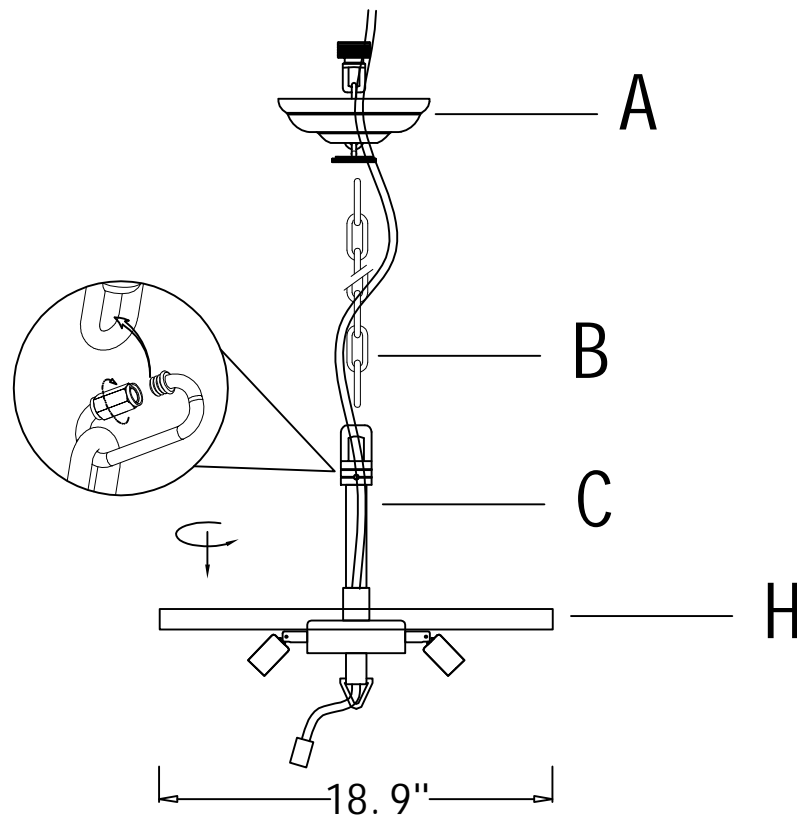
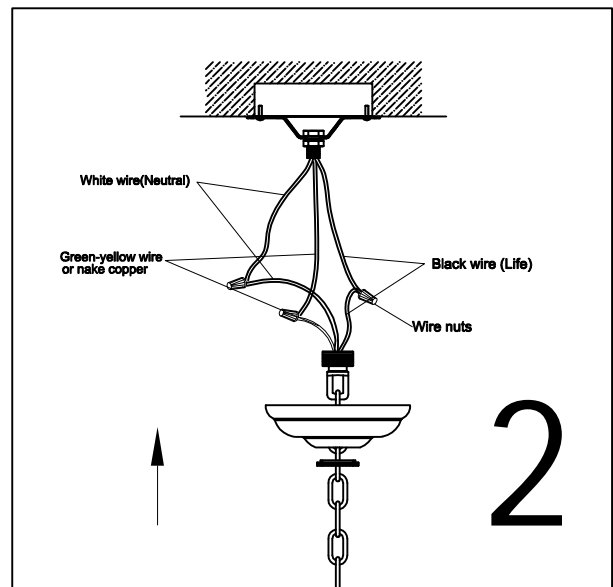
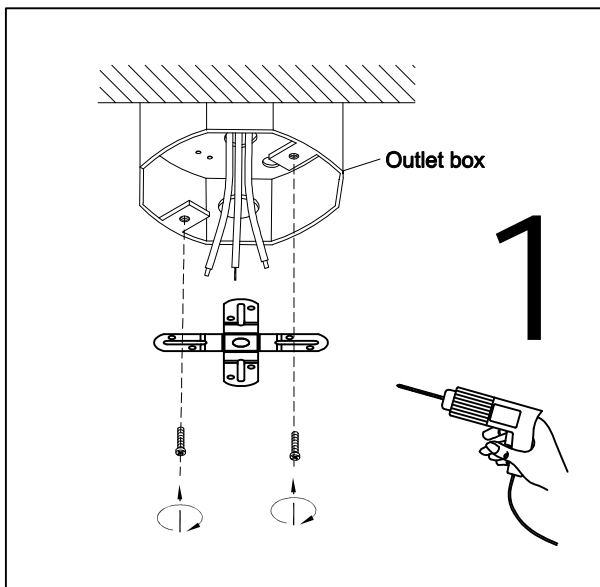

## ② Fixture Assembly:

- (1), Locate the lamp body from the sorting list.
- (2), Assemble the lamp body according to the diagram by connecting the C rod and D locking clips, and connect the main power line.
- (3), Screw the 29 E12 bulbs into the sockets.
- (4), Hang the crystals on the corresponding holes of the fixture (start with the smallest size crystals).
- (5), Assembly is complete.

