

LEFTON

INSTALLATION MANUAL



Pull-Down Kitchen Faucet with Temperature Display **KF2501**

Diagram and Parts List

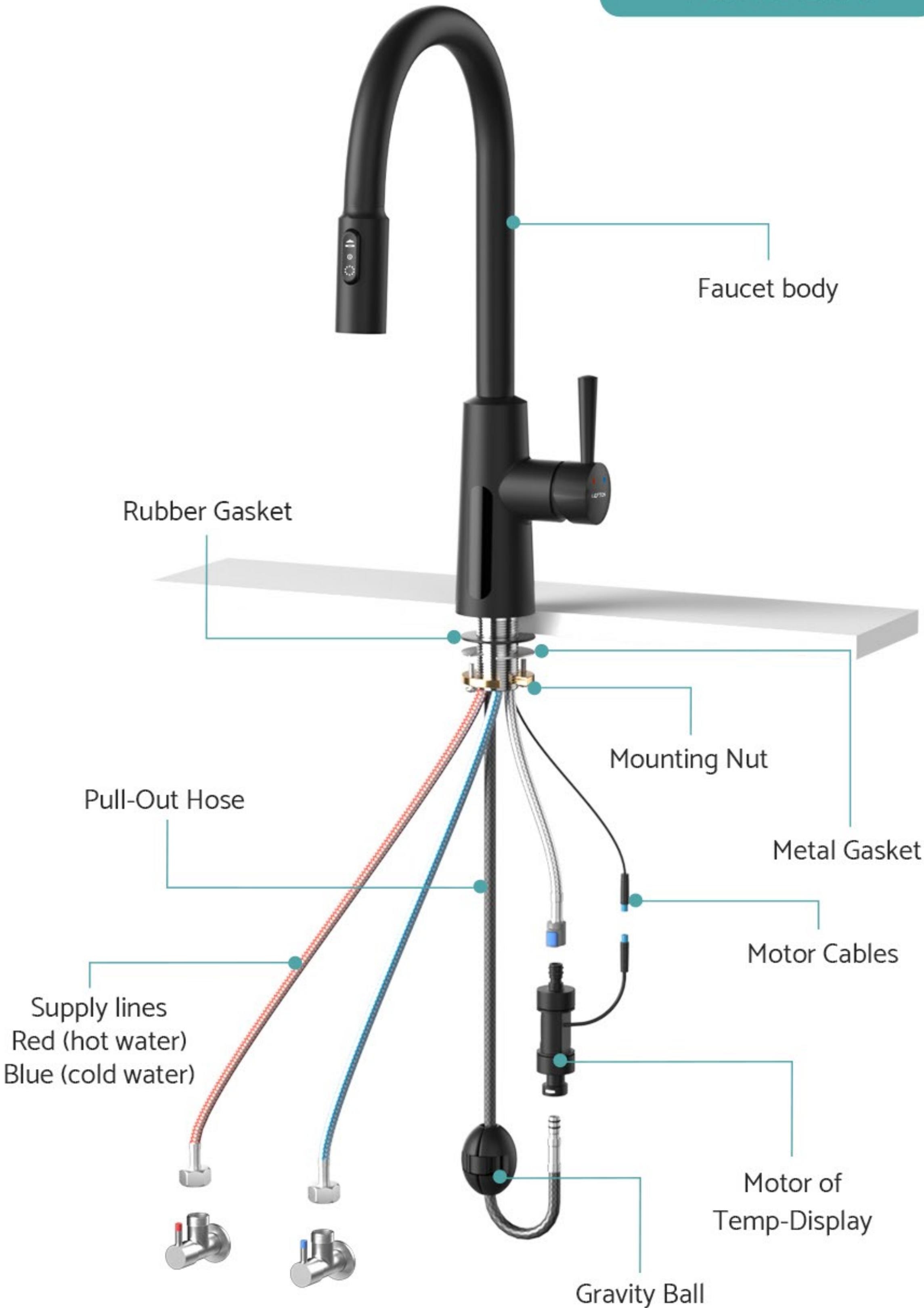

STEP 1:

Install the faucet to the countertop.

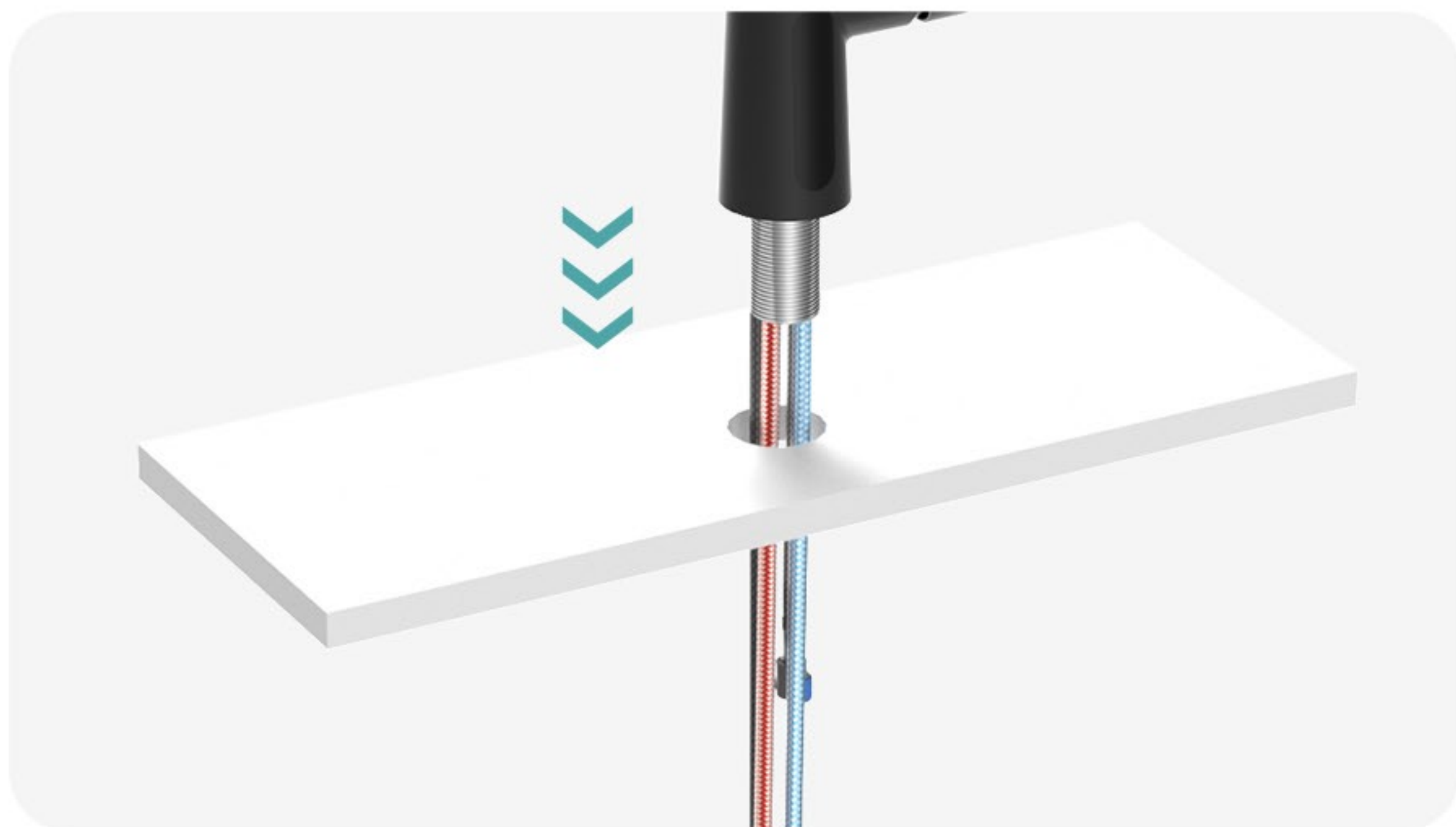

STEP 2:

Install gaskets, nut and fasten the screws.

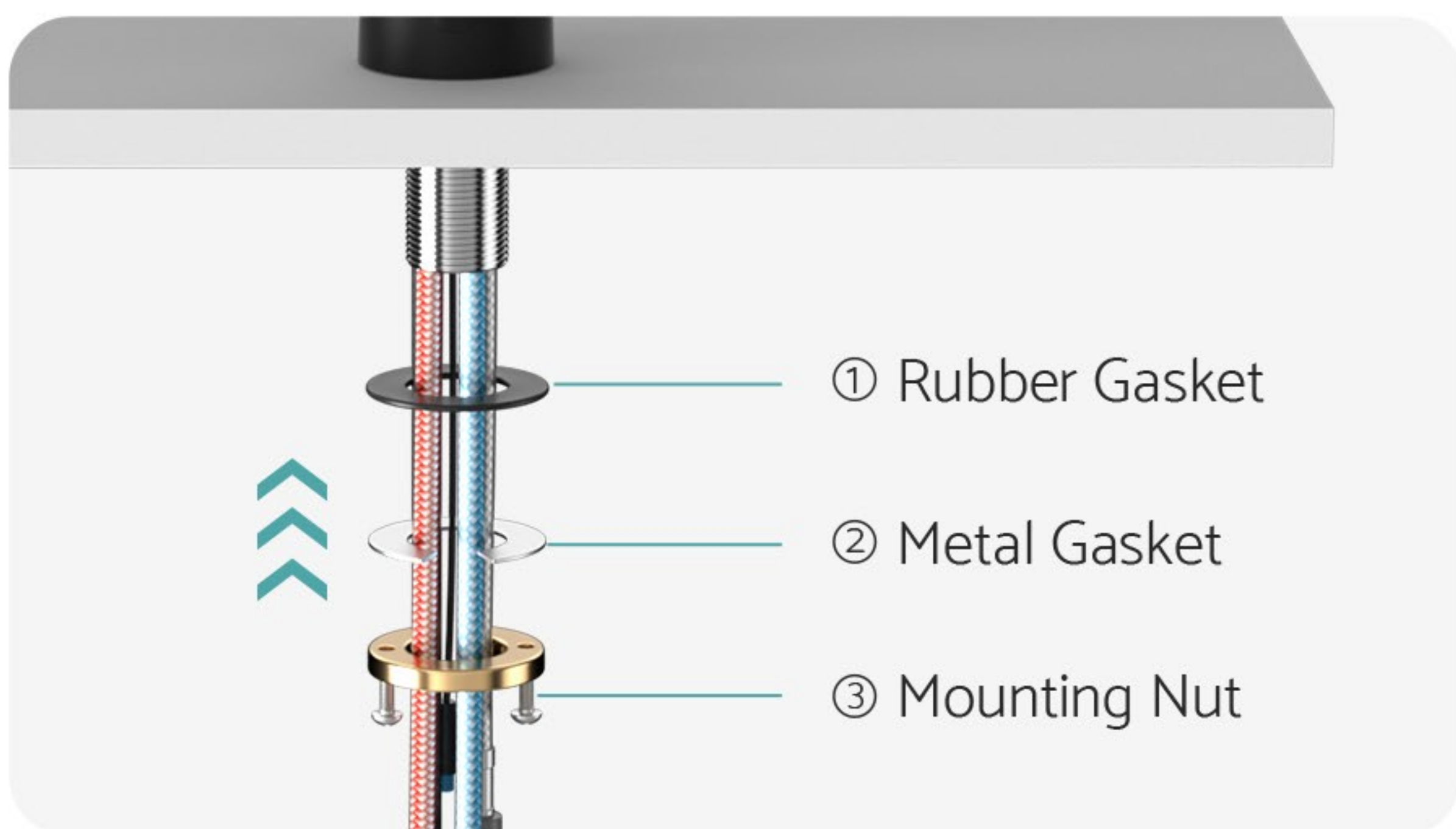

STEP 3:

Fasten the screws with the screwdriver.

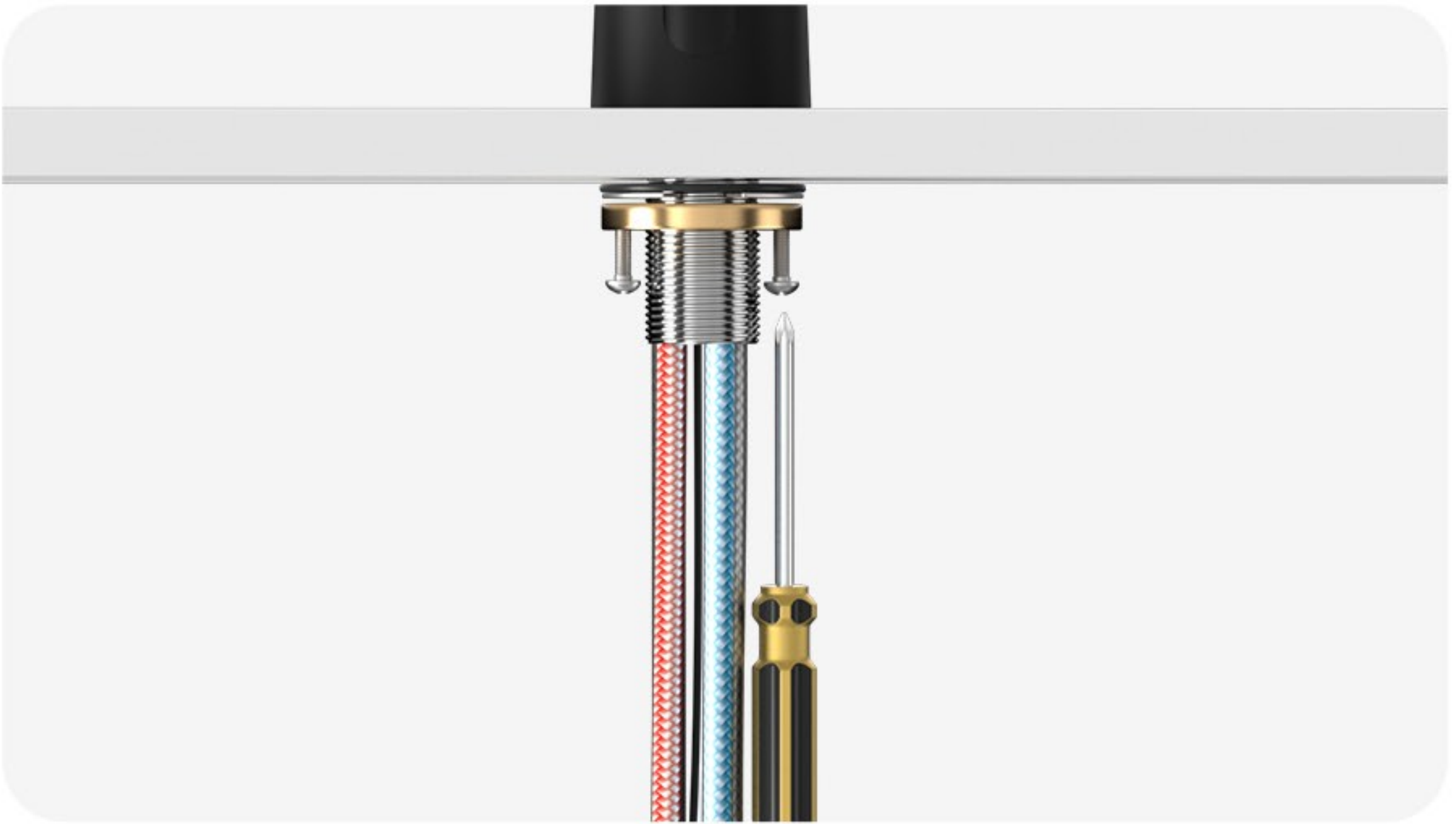

STEP 4:

Connect the hot, cold water lines, and tighten them clockwise.

Red hose (hot water)
Blue hose (cold water)

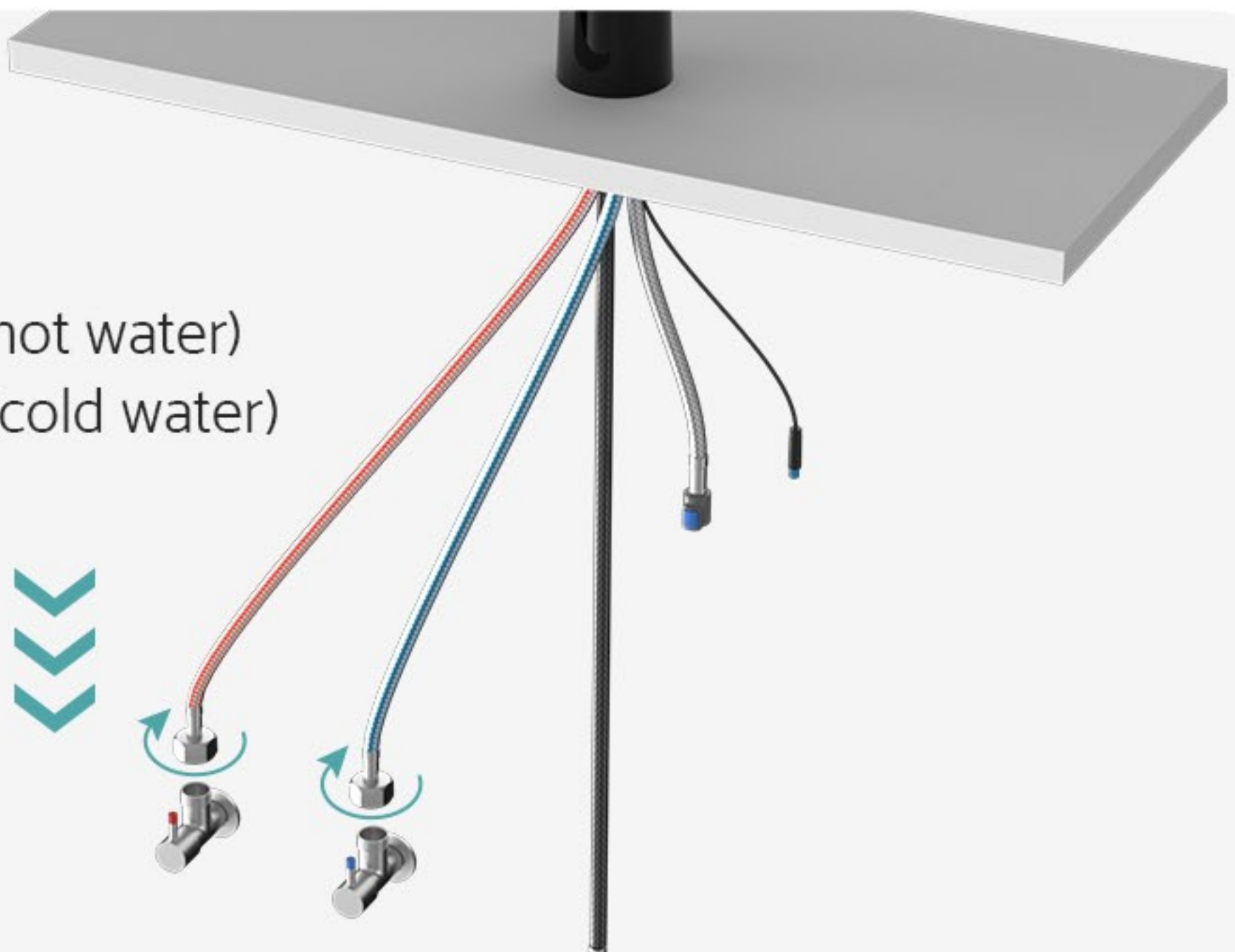

STEP 5:

Connect the motor cables and hose.

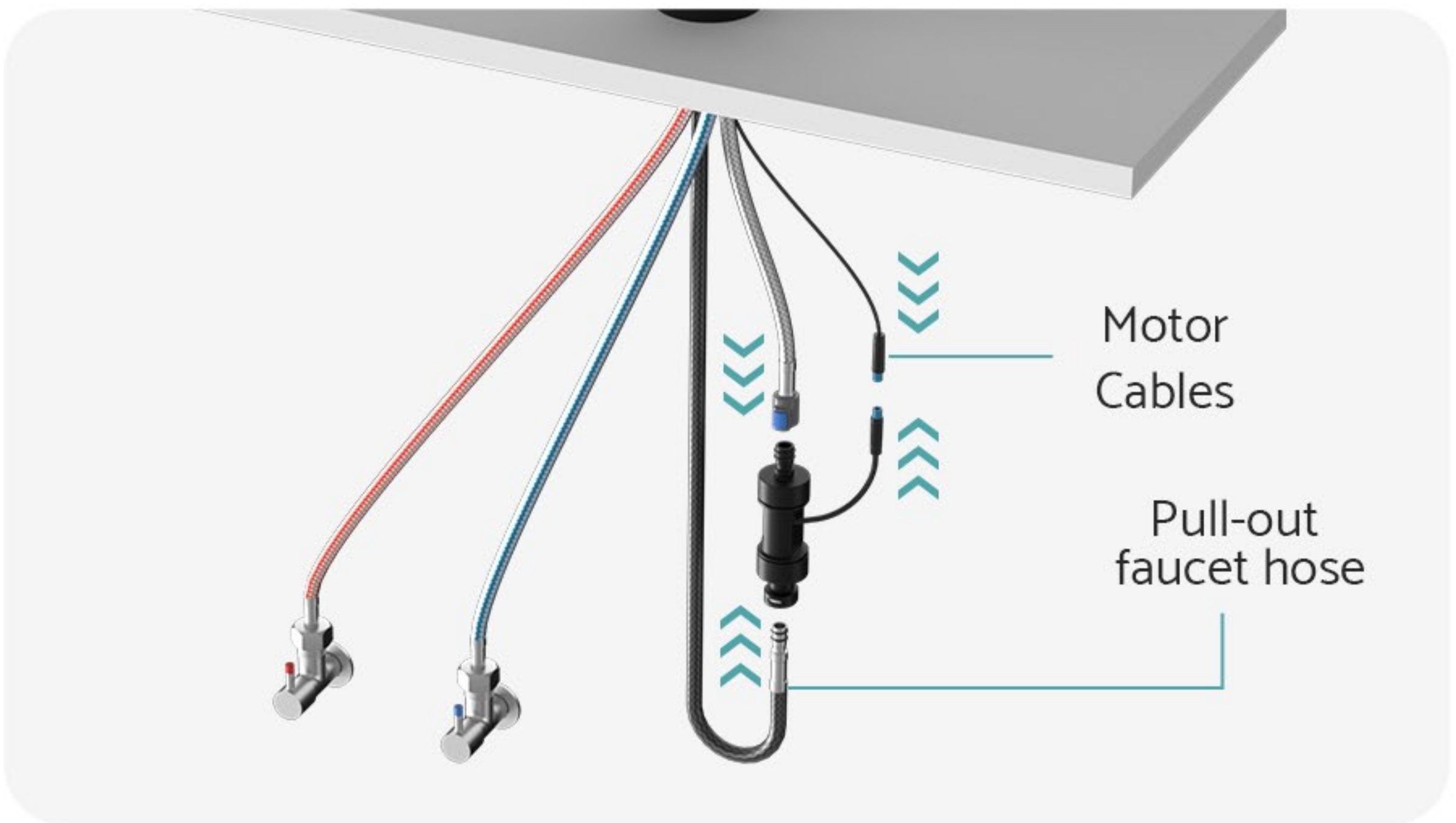

STEP 6:

Attach the gravity ball as shown in the picture below and attach it to the pull-out faucet hose.

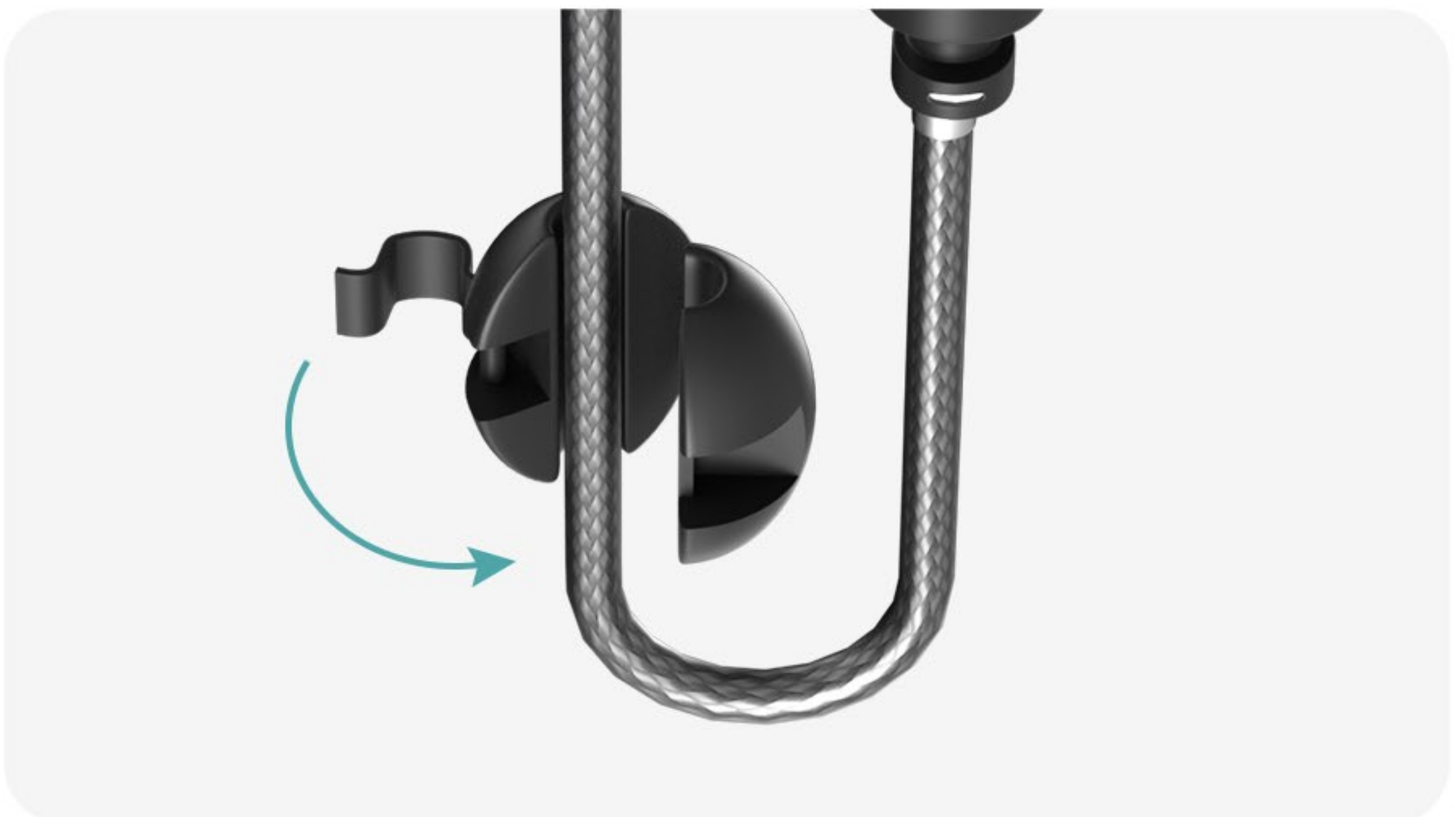

STEP 7:

Turn the faucet on and check for leaks.

