

ZT-DINA-MW-30
ZT-DINA-WH-30

ASSEMBLY INSTRUCTIONS

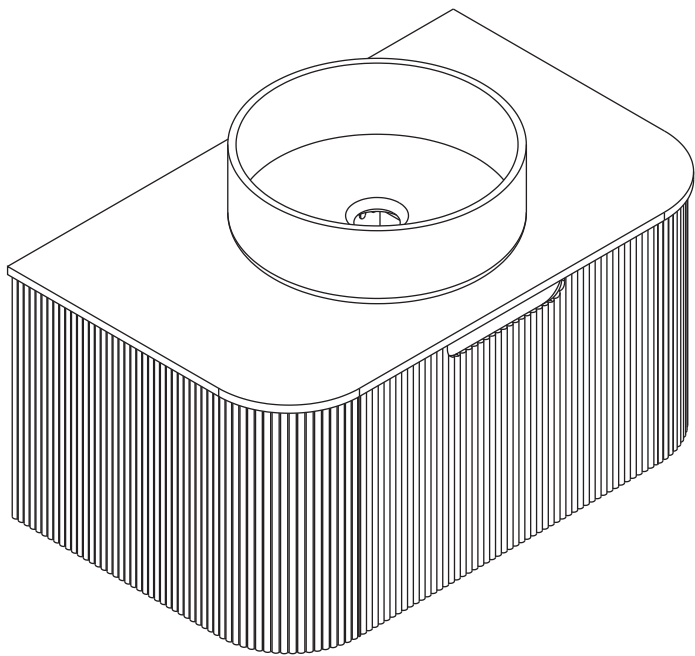

Bathroom Vanity

Notice:

- 1. Follow the installation instructions. Please confirm all accessories are preset before installation.
- 2. Do not fully tighten the screws during initial assembly. Fully tighten screws only once all pieces which are correctly assembled.
- 3. If you encounter any problems during installation, please contact our customer service.
- 4. Please unbox the item from the side with an open-label and put a carpet on the floor to avoid scratching it.



Recommended installers : 2

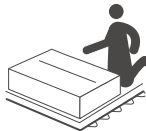

Put a carpet on the floor before unpacking

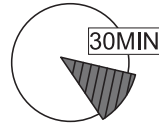

Estimate installation time:
30 minutes

Item no.	Reference Image	Qty
A		x1
B		x1
C		x1
1		x4

Item no.	Reference Image	Qty
2		x4
3		x4
4		x6

1

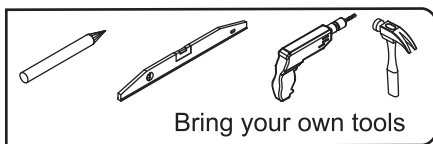
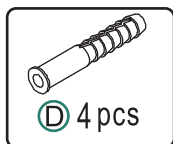

Solid color cabinet hanging
hole size

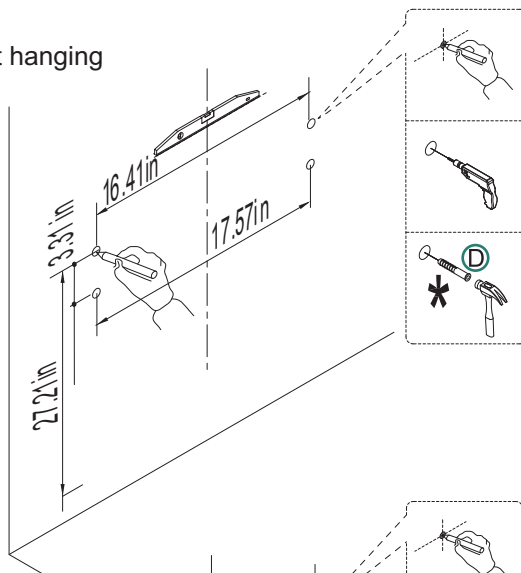

Wood grain cabinet hanging
wall hole size

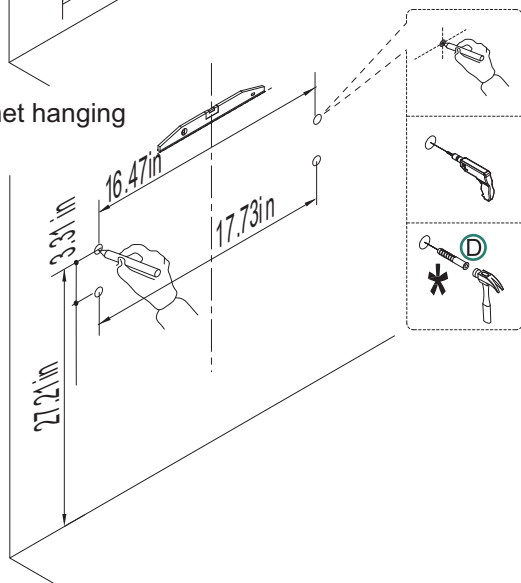

WARNING: To prevent tipping over, this product must be used with the included wall mounting device.

WARNING: Evaluate the suitability of the wall to ensure that the fixtures can withstand the forces that occur.

2

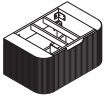

① 1pc



② 4pcs

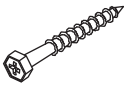

③ 4pcs

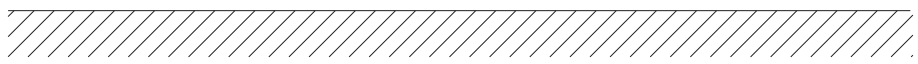
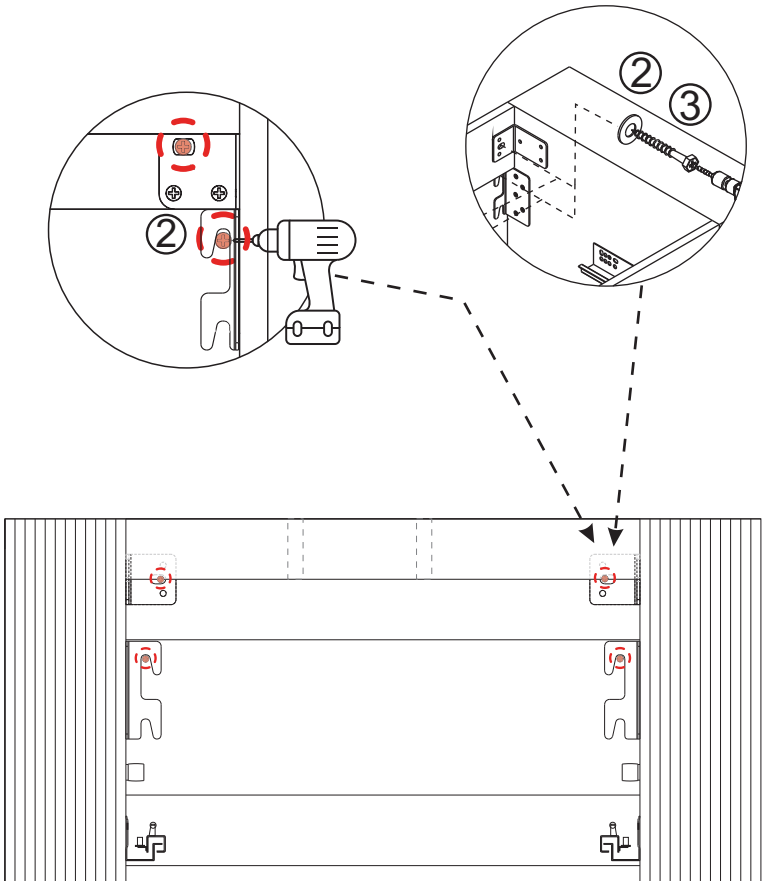

3



Ⓐ 1pc



Ⓑ 1pc

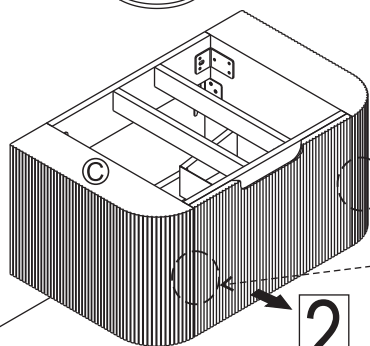
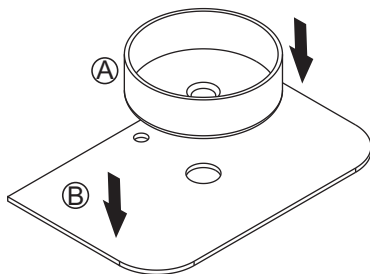

1

2

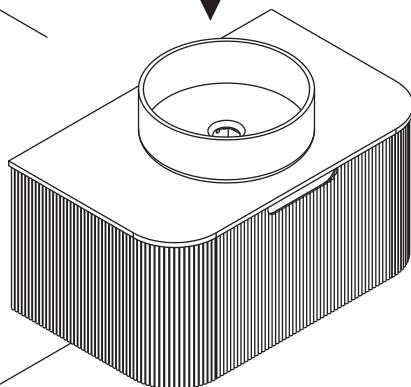
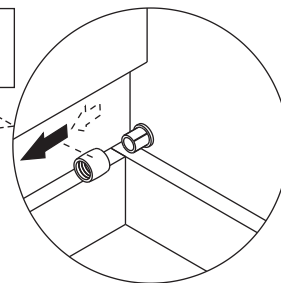
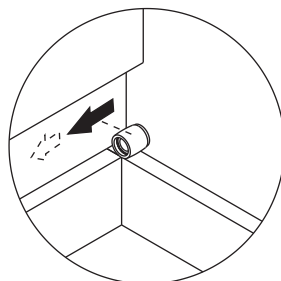

Installation completed

4

Installation of drain assembly

Turn the screw at the bottom of the guide rail counterclockwise!

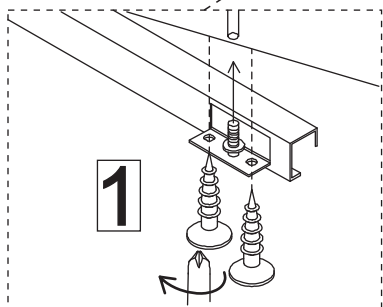
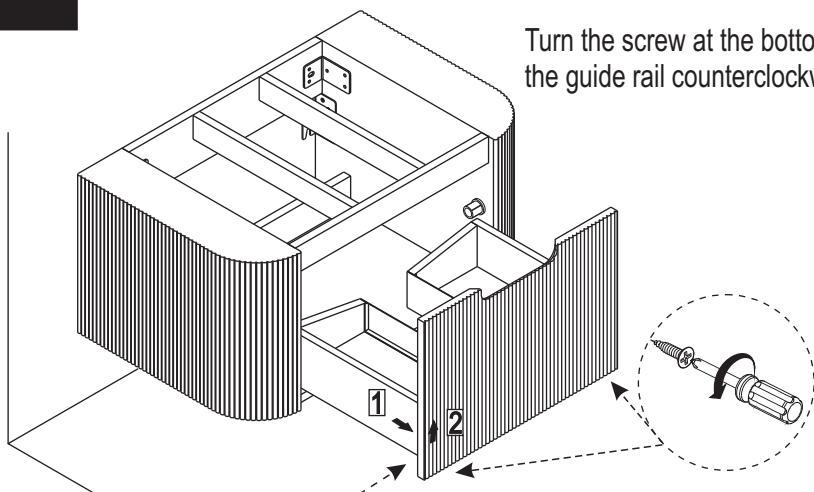

Move out the drawer

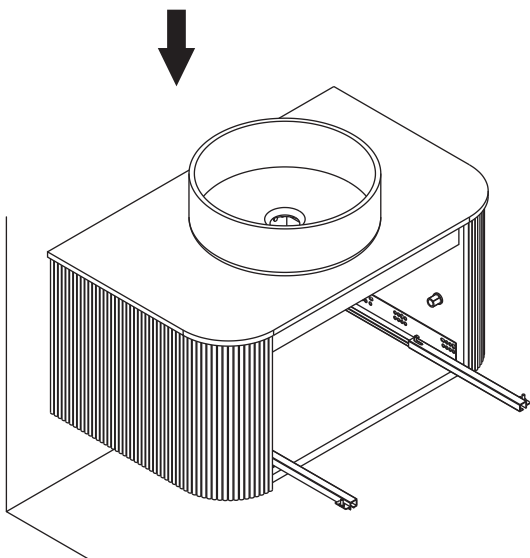

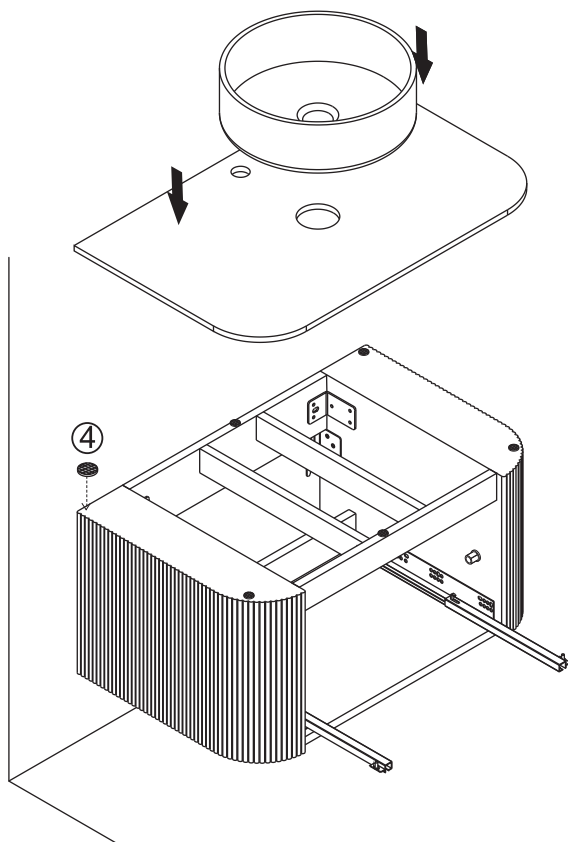

Installation of drain assembly

6

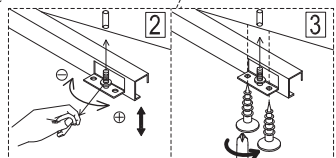
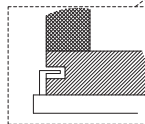
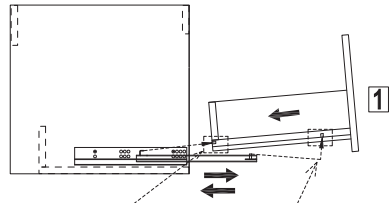
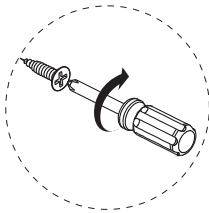
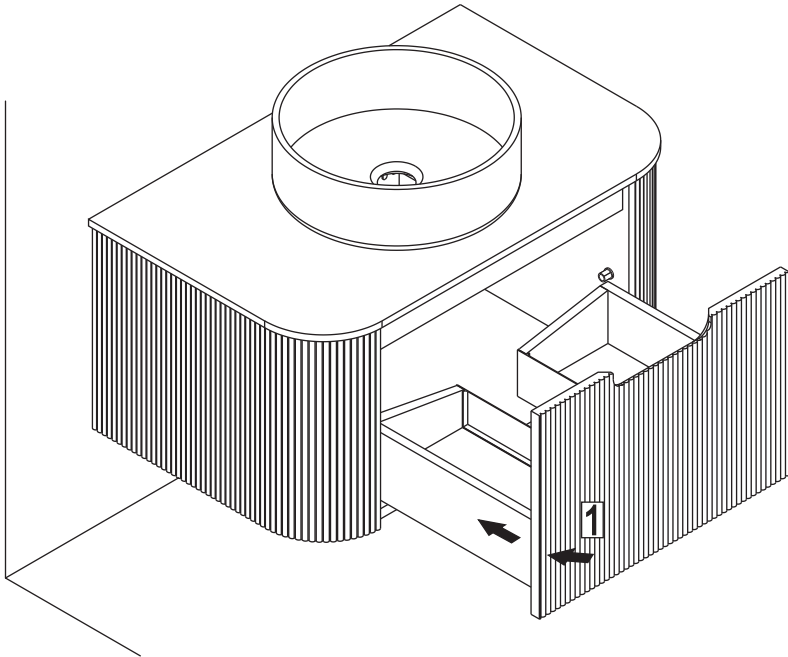

Installation completed