

DREAMS

IDEA

Instruction Manual



DREAMS/DEA

NO.CH0058

ABOUT US

*D*REAMSIDEA IS A ONE-STOP HOME

FURNISHING AND SERVICE COMPANY BASED IN USA.

WE ARE DEDICATED TO BRINGING YOUR DREAM HOME TO LIFE.

OUR SERVICES COVER FROM DESIGN, PRODUCTION,

DIRECT SELL, STORAGE, AND TRANSPORTATION.

IF REALITY IS THE NEAR SHORE

AND IDEALISM THE FAR SHORE,

*D*REAMSIDEA

AS THE FERRY BETWEEN THEM,

EAGER TO ACCOMPANY YOU ON A JOURNEY

TO YOUR IDEAL HOME.

ITEM NO.CH0058

WARRANTY

We strive to offer high quality product and we also try our best to satisfy each customer that order from us, no matter on products or services as needed. Each customer receives a record of their order, such as the order number or item receipt. For any items that are out of warranty period, you may still be able to purchase the replacement parts from our company if they are available.

Are you having difficulty
with assembly? Missing parts?
Please contact us: info@firstopintl.com
Tel: (562)-781-3327

send an email with your order No. to us
For return, please check the return policy with
the retailer or platforms you bought from.
Appreciate your purchasing from us.
Pop up your life by our furniture !

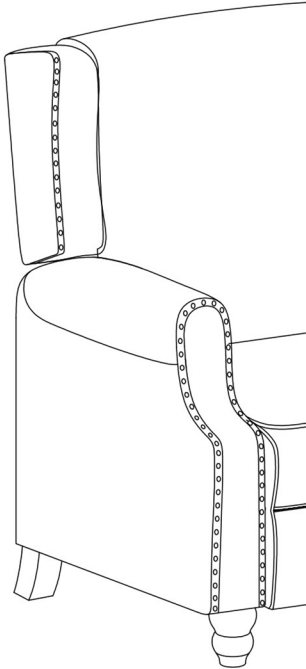

MAINTAINANCE AND WARNING

Please read the manual thoroughly
before you start installing.

Please keep the product away from
sharp object.

Packaging and small parts may have
chocking hazard, please keep them away
from children and pets.

Please clean the product according to each
clean code, check the product description
for more information.

Please keep the product away from
fire.

If you have any other questions, please
contact us, we will be glad to help you out.

If the product is placed under direct
sunlight, the pattern or color might fade
away overtime.

Check the product periodically to make
sure everything is secured and tightened.

Always use proper tools for installation.

Do not jump on the product.

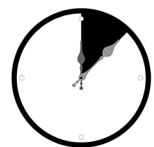
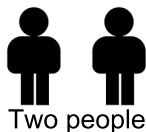
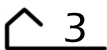

Around 45 min

PRDOUCT DESCRIPTION

Soft cotton linen fabric: Provides a cozy, breathable seating experience perfect for long hours of relaxation.

Vibrant floral and botanical design:
Adds a natural touch to your home
decor, enhancing the ambiance of
any room.

Reclining backrest: Allows you to
adjust the seat to your desired angle
for ultimate comfort.

Automatic footrest extension: Simply
recline and the footrest automatically
extends to support your legs,
making it easy to find your perfect
lounging position.

Solid wood legs: Offer both
durability and stability, ensuring the
chair lasts for years to come while
adding a sophisticated touch.

Dream



House



EXPLODED VIEW

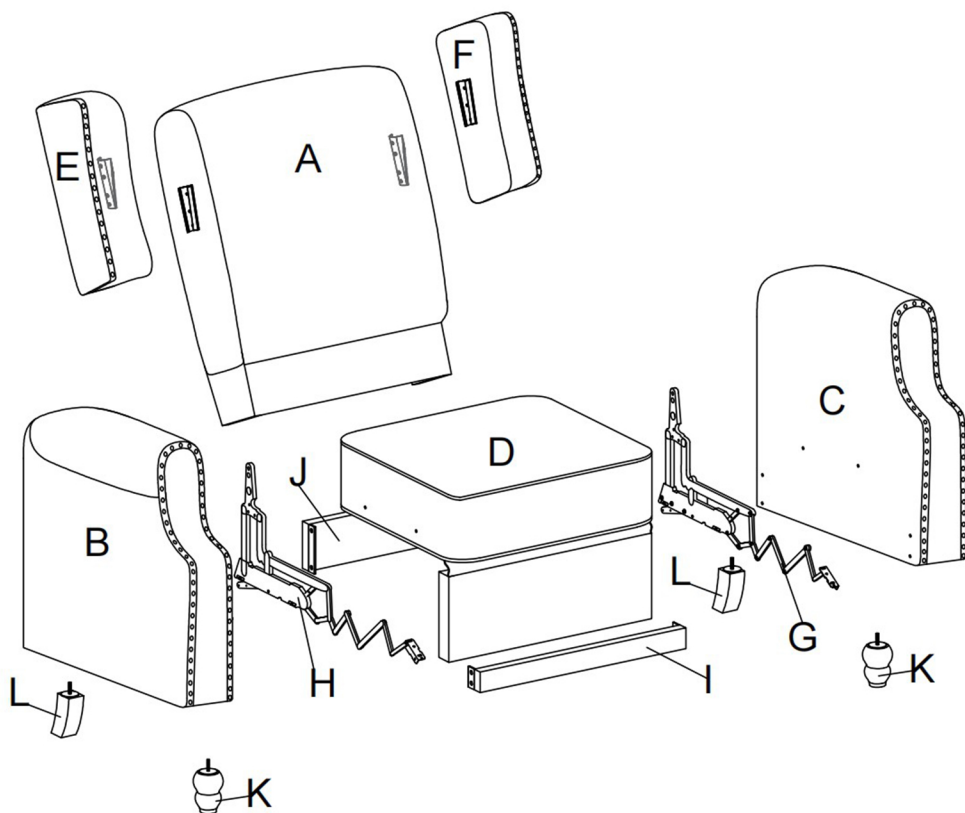

the product's left and right are
determined by sitting posture

PARTS

A*1



Backrest

B*1

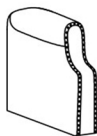

Armrest-Right

C*1



Armrest-Left

D*1

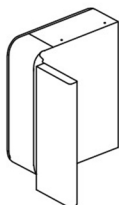

Seat frame

E*1



Right ear

F*1



Left ear

G*1



Sofa metal functional support-left

H*1



Sofa metal functional support-right

I*1



Connecting part-Front

J*1



Connecting part-Back

K*2



Wood leg -front

L*2



Wood leg -back

HARDWARE

TOOL LIST

NOTE: Designated with (★) We provide additional spare parts in the hardware package

①*1



Allen key

②*8



★ Bolt

③*20



★ Bolt

④*4

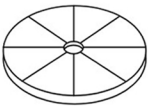

Plastic washer

⑤*8



★ Flat washer

Please make sure all hardware&packing material fitting the list.
Especially some small accessories may be missing during transportation. Please contact us if you have any question.

step 1

Remove the pre-drilled bolts (2) from both sides of the seat frame (D), then place the seat frame on its side on a clean surface as shown. Align the holes on the functional rack (G & H) with the holes on seat frame, use the allen wrench (1) to tighten the bolts (2). Repeat the same step for the other side.

1.

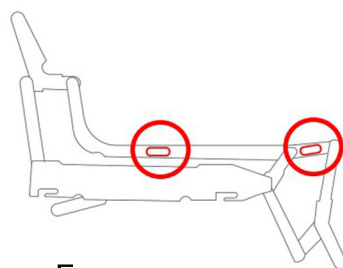
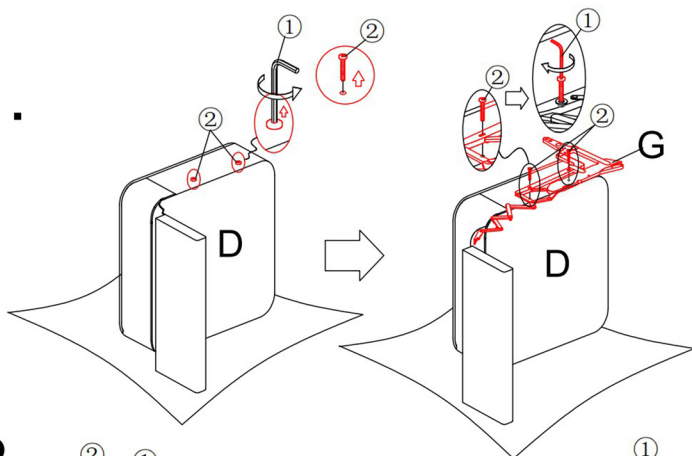

FUNCTIONAL RACK

2.

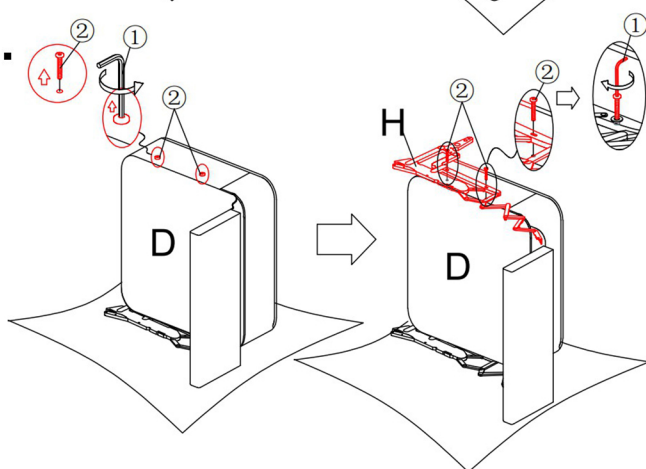

!
Please be careful while installing the functional rack, DO NOT damage or dirty the fabric of the seat frame.

!
The bolt holes on the functional rack is long oval shaped, the bolts on both sides should be kept in the corresponding same position

step 2

The board that connect to the seat frame is the foot rest, align the bolt holes on the foot rest with the bolt holes on the extended part on the functional racks, use the allen wrench (1) to tighten the bolts (3).

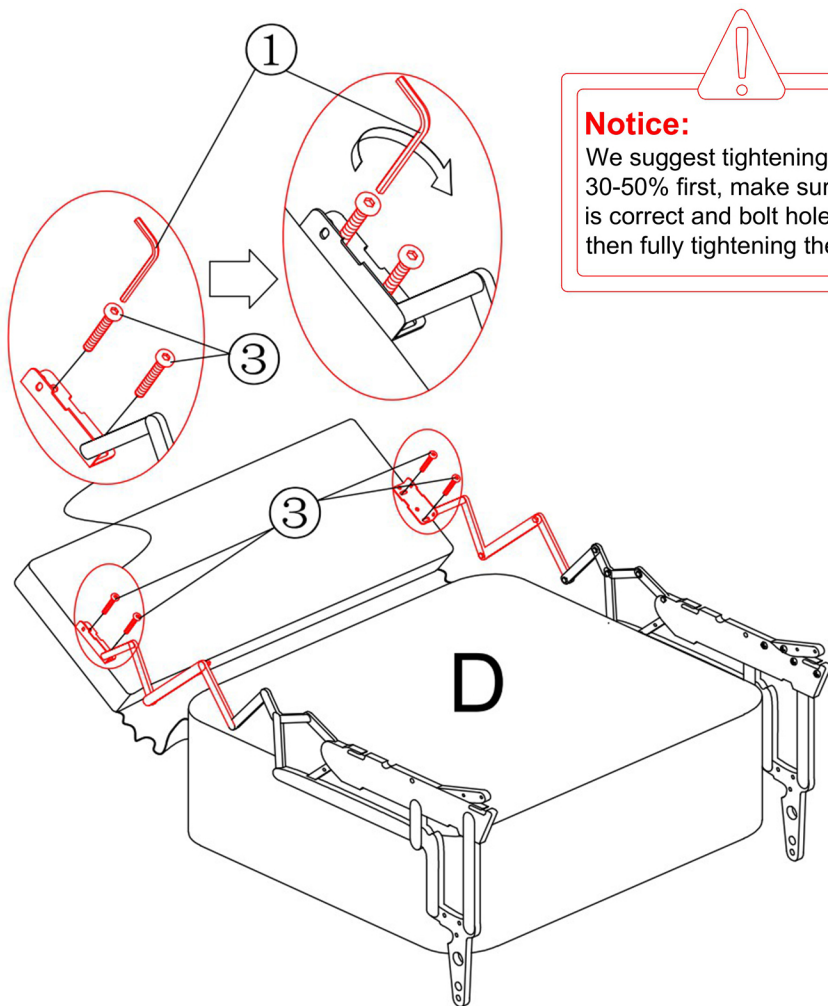

Notice:

We suggest tightening the bolts for 30-50% first, make sure the process is correct and bolt holes are aligned, then fully tightening them all.

step 3

Place the backrest (A) flat on a clean surface as an elevate pad. Then place the pre-installed seat frame from the last step onto the backrest as shown in the figure.

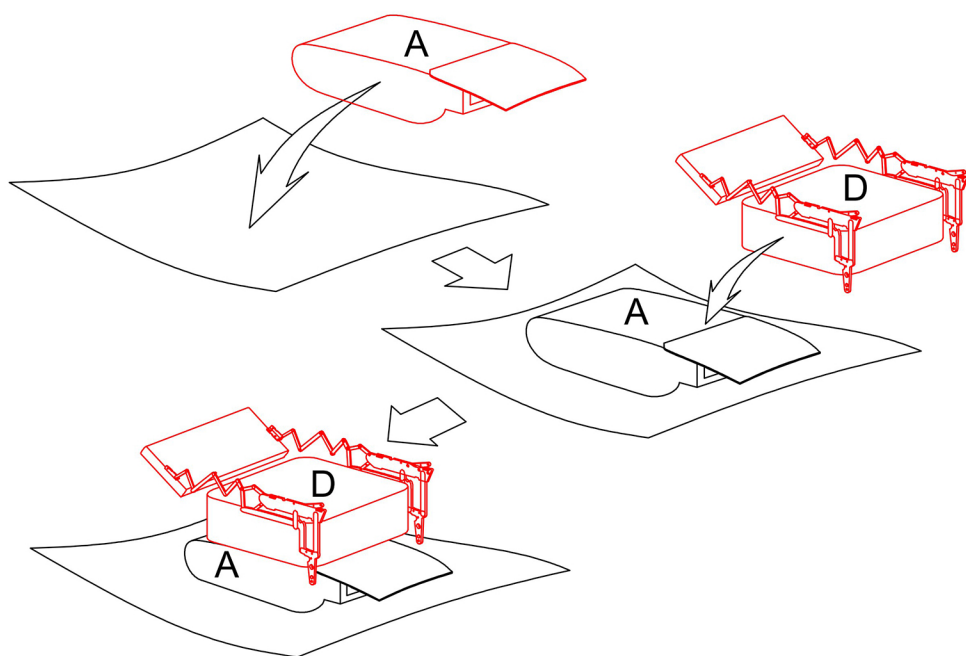

step 4

According to the identification, twist in all the bolts (2) for about 1/3 of their length.

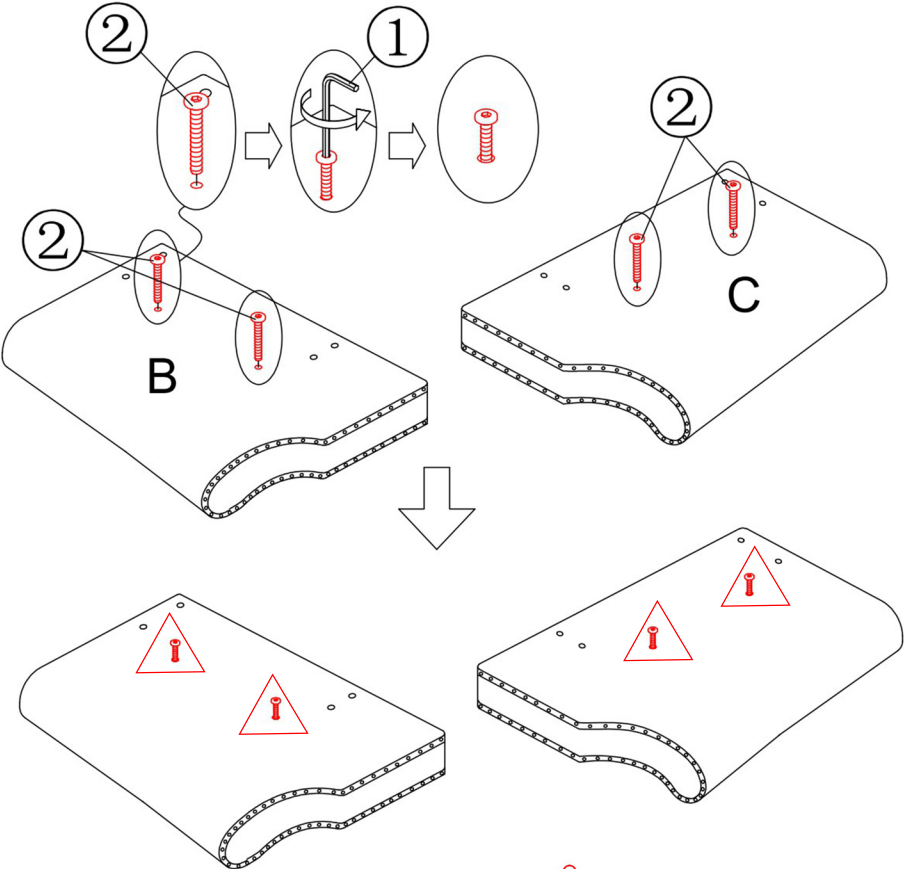



The bolts labeled in triangle
will be used in step 5

step 5

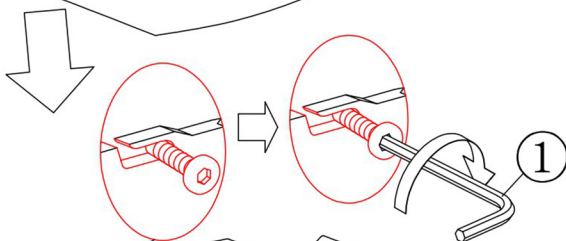
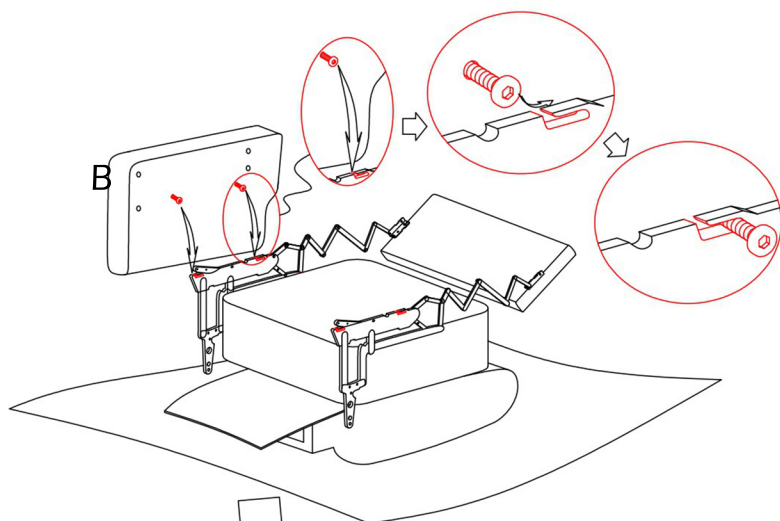
Use the bolts (2) from last step (labeled in step 5) to hang the armrest (B,C) into the hold with a notch on iron frame as shown. Then use the allen wrench (1) provided to tighten both bolts, make sure both bolts are fully tightened before next step.

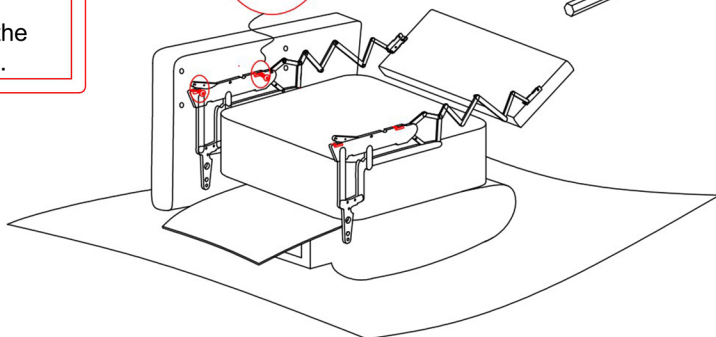

- 1. Place accord the installation guide clearly.
- 2. The armrest point to the foot rest is the front part.



step 6

Use the same method as in step 5, install the armrest on the other side.



1. Place accord the installation guide clearly.
2. The armrest point to the foot rest is the front part.

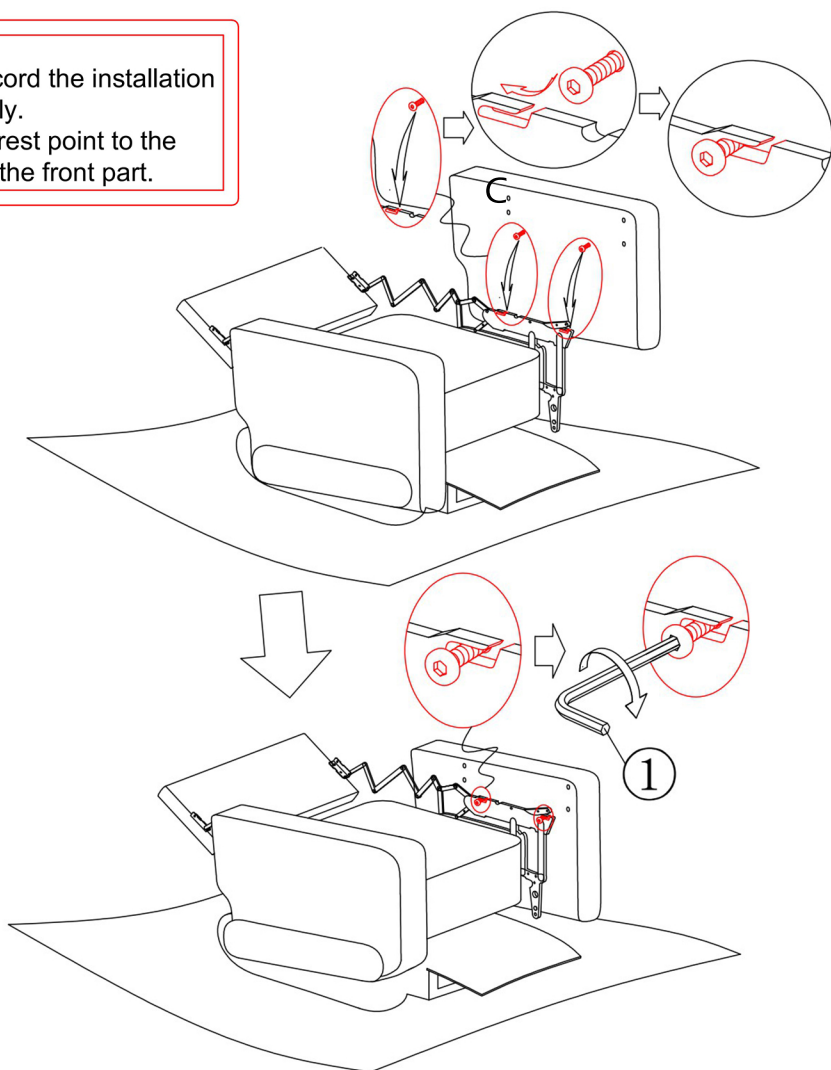

step 7

As the diagram shows, place the bolts through the bolt holes on the metal parts of the front panel, and install to the front part of the armrests. Repeat the same step for the back part of the armrests. Then place one flat washer on each bolt before installing.

Notice:

We suggest tightening the bolts for 30-50% first, make sure the process is correct and bolt holes are aligned, then fully tightening them all.

1. Please accord the installation guide clearly.
2. The armrest point to the foot rest is the front part.

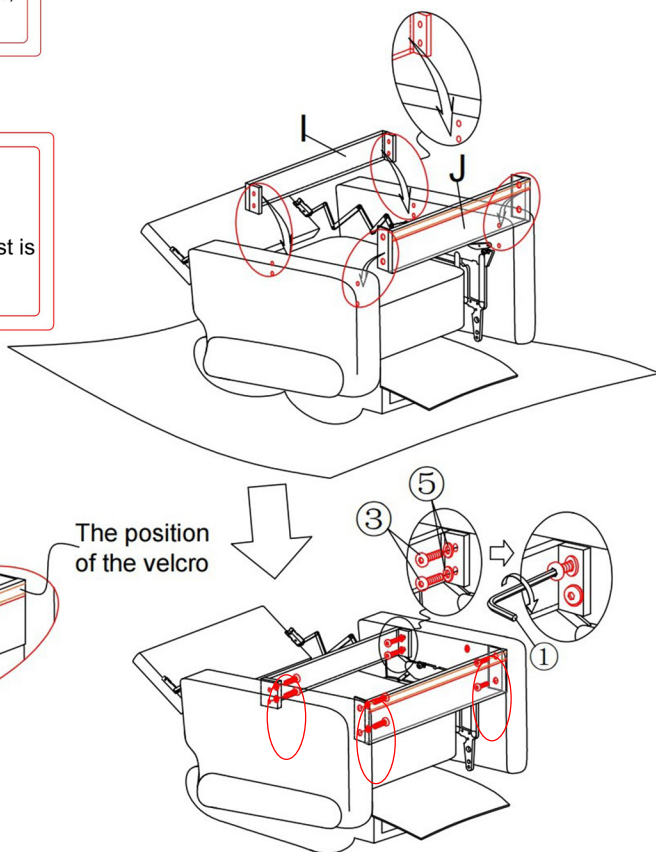

step 8

Place one plastic washer (4) on the bolt part of the wooden legs, then twist in the front and back wooden legs (K&L) into the pre-drilled holes on the bottom of the armrests. Make sure they are fully tightened.



1. Please notice that cylindrical legs are front legs, the square slant legs are back legs, the slanted point should be twisted to the right astern.

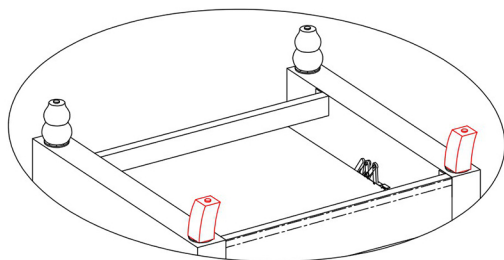
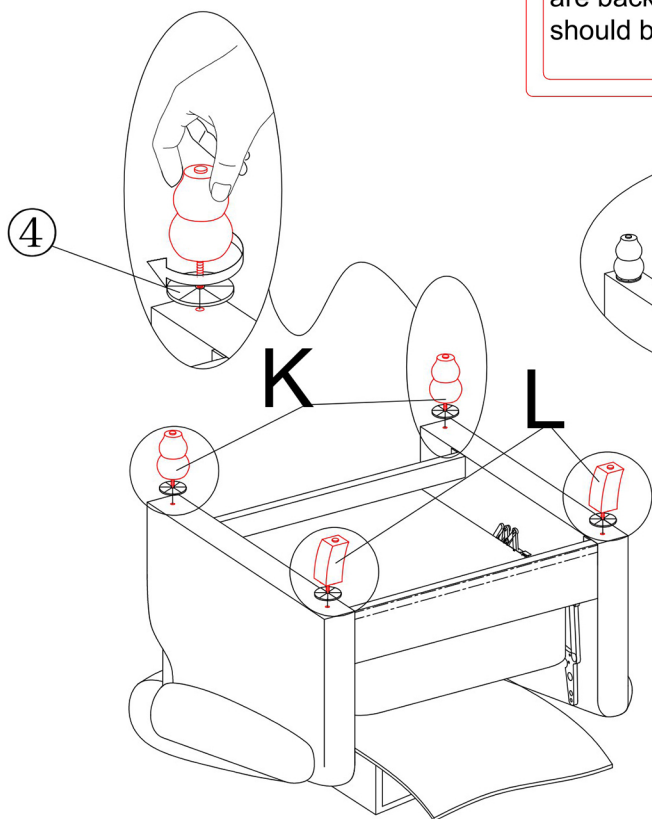

step 9

Take the seat frame (D) and place it straight on the ground. Hold the backrest (A) and uncover the back cloth, align the metal connectors of the inner backrest (A) with the tip part of the functional rack on the seat frame, and push down hard until they interlocked completely.

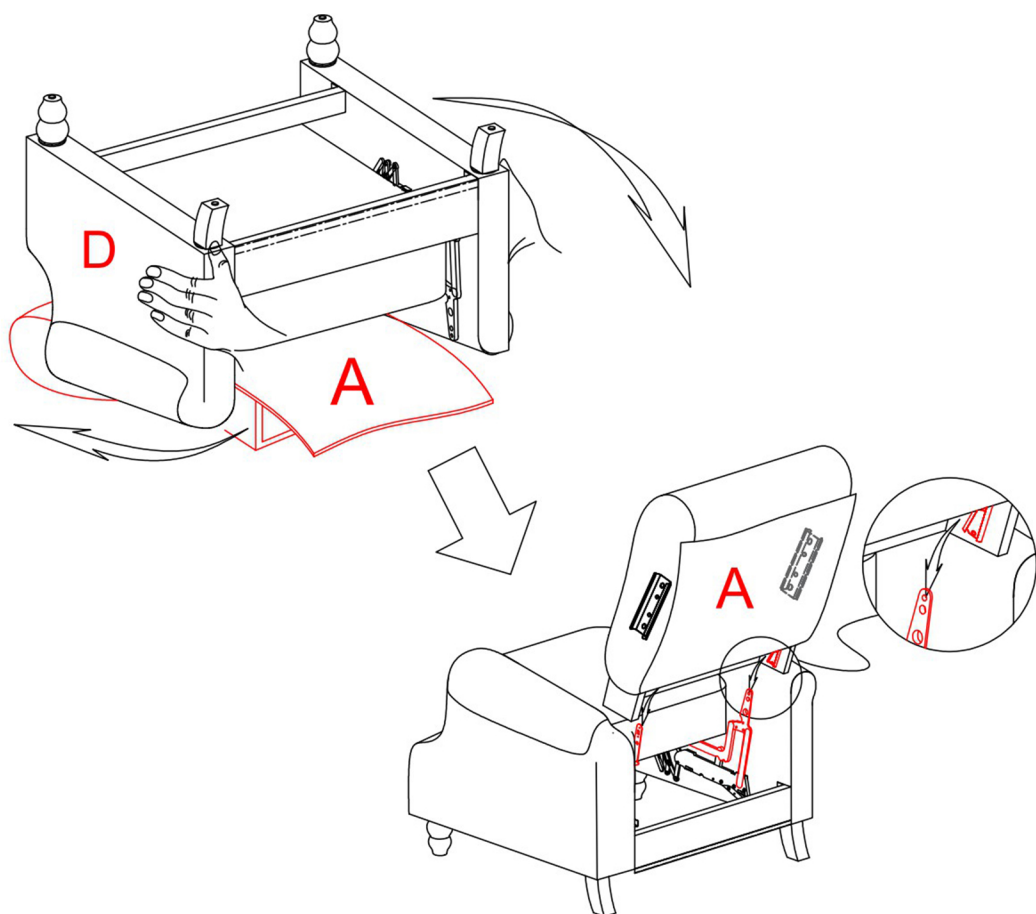

step 10

Uncover the Velcro strip cover on the bottom of the back cloth, and stick the Velcro to the bottom of the back panel. Install the side ears (F&E) to the backrest as shown. Make sure the connector is aligned to the correct slot before pushing down. Repeat this step for both side ears.

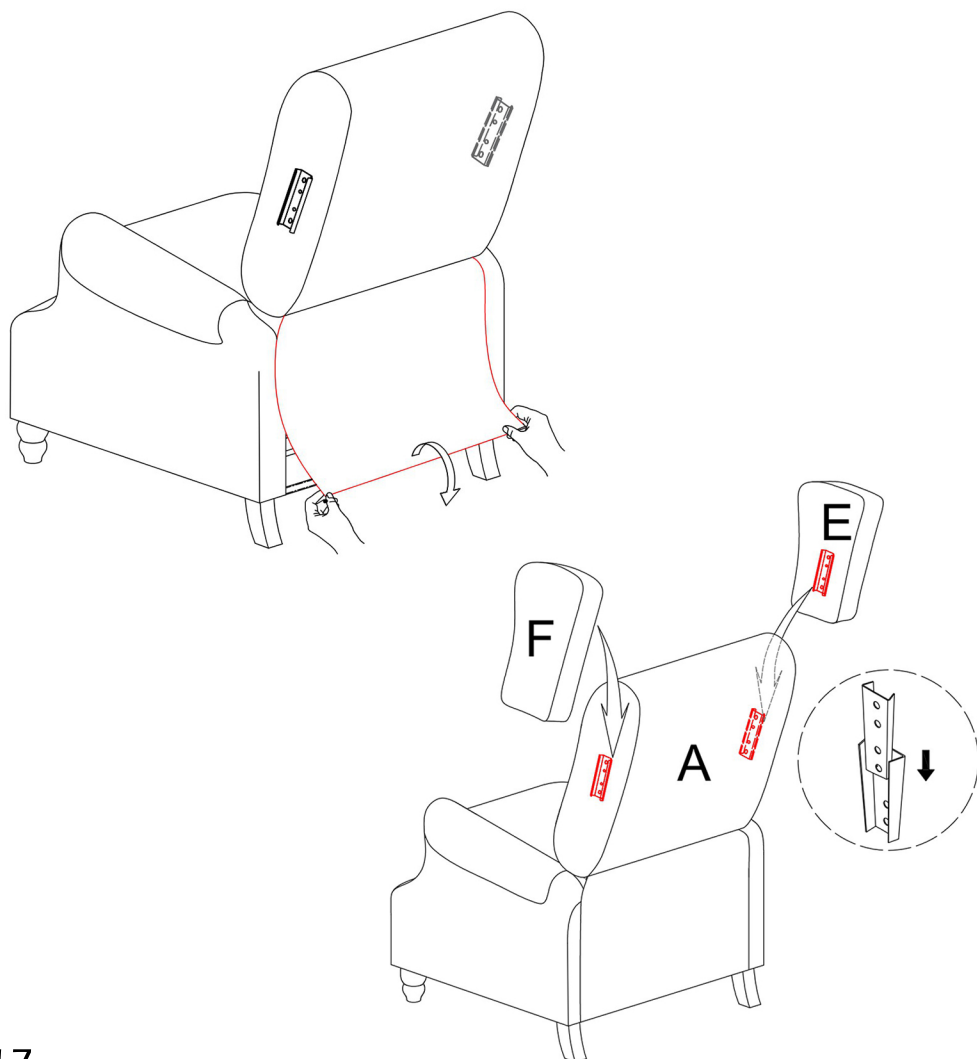

step 11

Congradulations, the assembly is complete! Thank you again for choosing our product! Please enjoy!

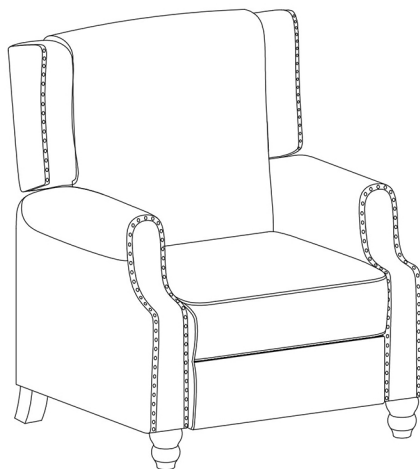

The backrest and the footrest are adjustable, the backrest has recline function. When you lie down and apply force to the backrest, the footrest will lift up while backrest as recling down.

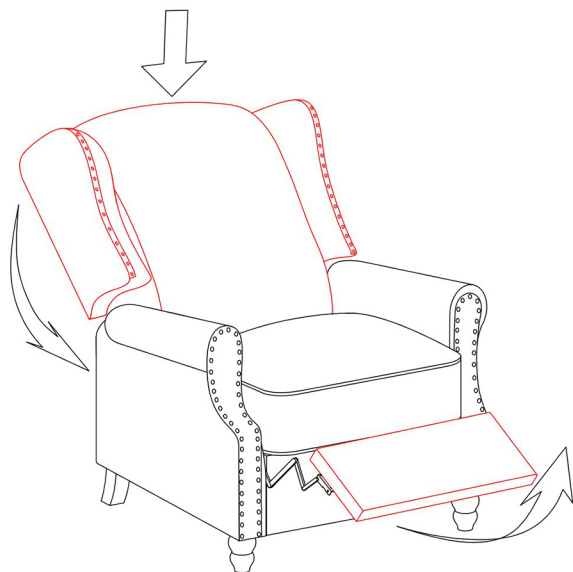



ASSEMBLY INSTRUCTIONS

Tel.(562)-781-3327

Please contact us:info@firstopintl.com

<https://www.dreamsidea.com>