

ASSEMBLY INSTRUCTION

N719P220545

N719P220546

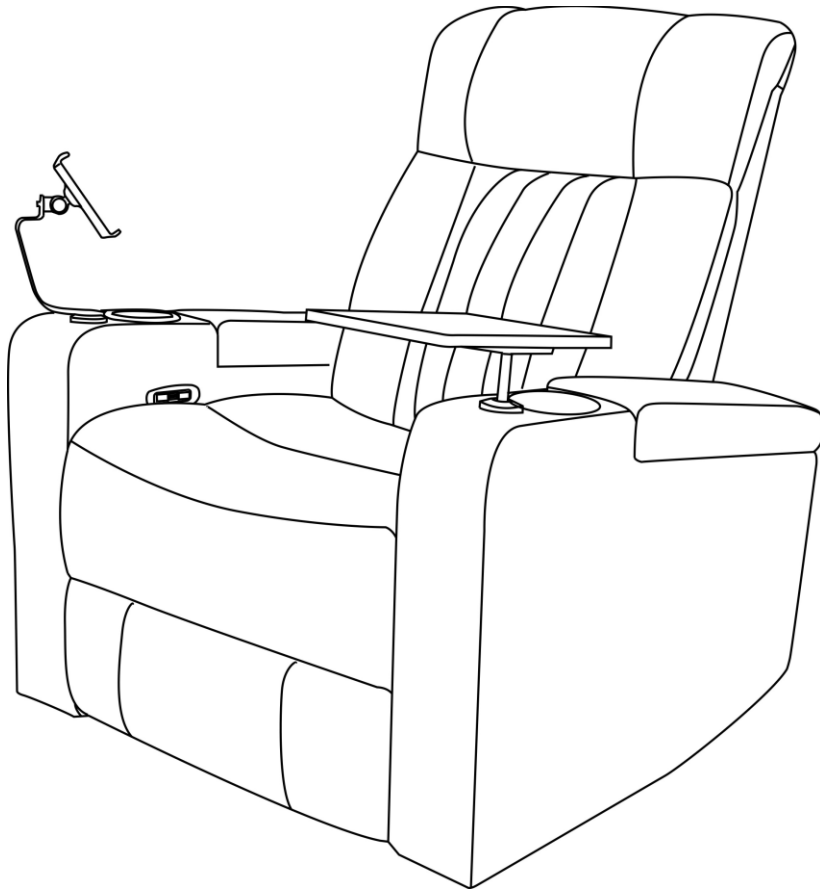

Power Recliner

The chair set is delivered with **2 boxes**. We recommend assembling the set after you receive all the boxes.

COMPONENTS

N719P220545

A*1

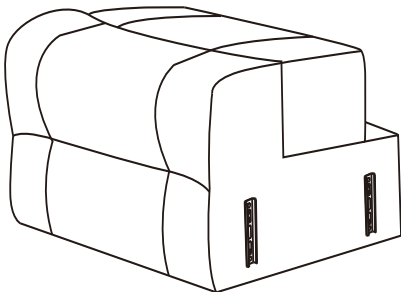

1 PC

N719P220546

B*1

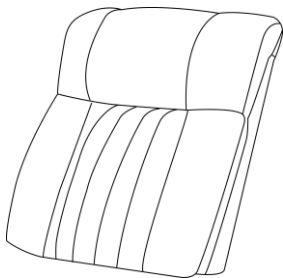

1 PC

C*1

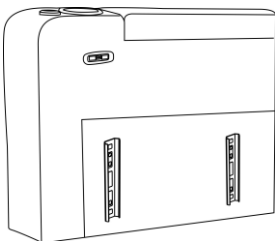

1 PC

D*1

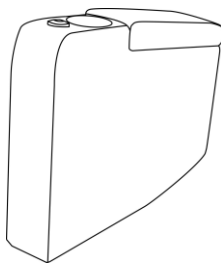

1 PC

E*1

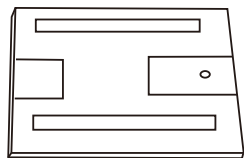

1 PC

F*1

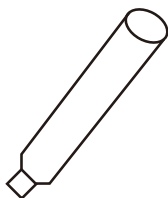

1 PC

G*1

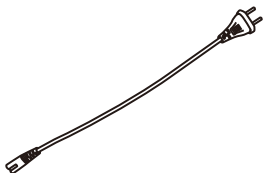

1 PC

H*1

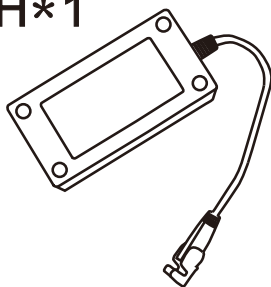

1 PC

I*1

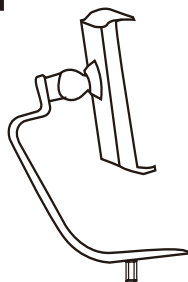

1 PC

ASSEMBLY STEPS

STEP 1

Take out the holder (I), transformer (H) & wire plug (G) from the left arm (C).
Take out the tray table (E) & shank (F) from the right arm (D).

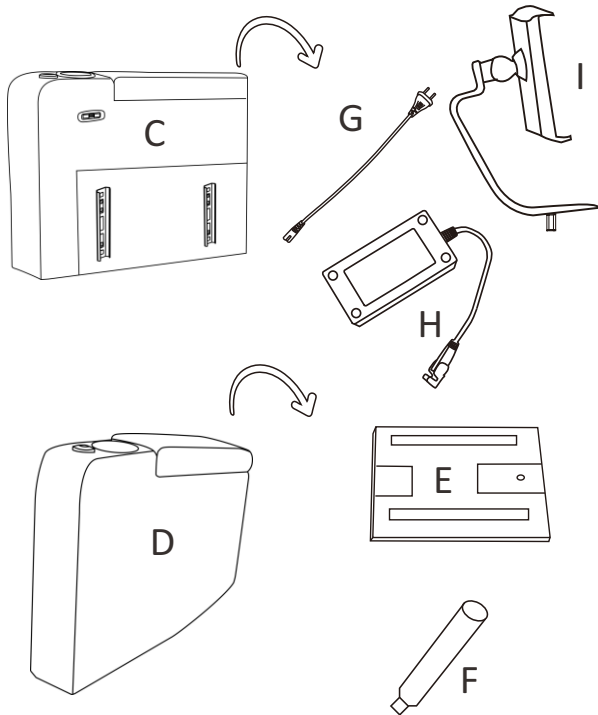

STEP 2

Attach arm (C&D) to seat (A) by aligning the metal grooves on arm to brackets on sides of the seat (A) as shown.

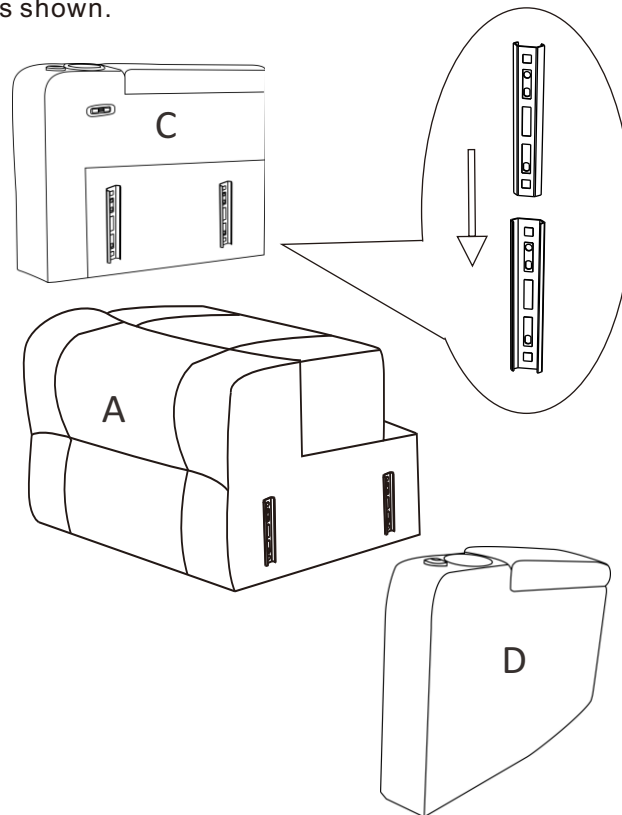

STEP 3

Ensure the backrest (B) slides down fully over the brackets on the seat (A).

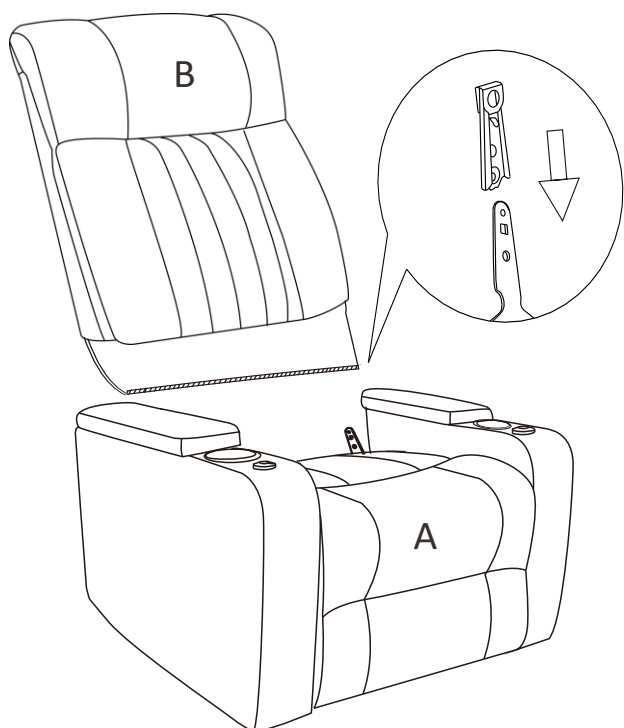

STEP 4

- ① Connect this wire of the light strip.
- ②&③ Attach the transformer (H) to the plug on the back of seat (A).
- ④ Connect the transformer (H) with the wire plug (G) and insert the wire plug into a wall outlet for power.

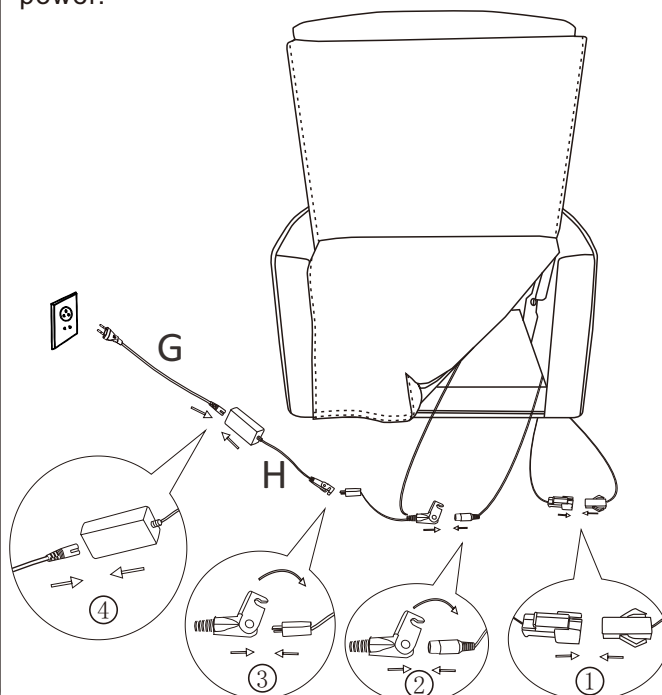

ASSEMBLY STEPS

STEP 5

Tighten the shank (F) onto the right arm, put the tray table (E) on the shank (F). Put the holder (I) onto the left arm.

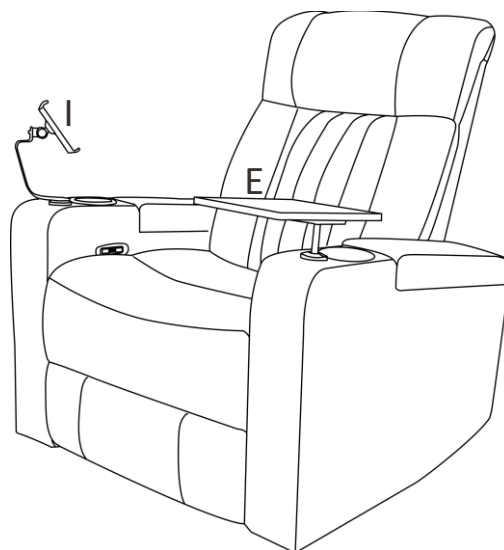
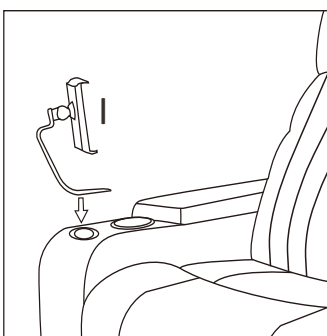
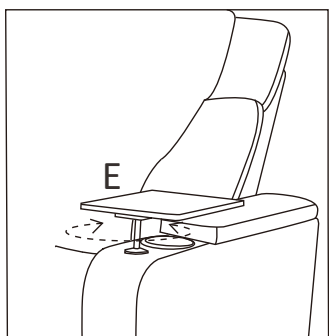
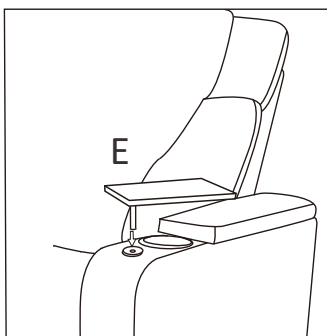
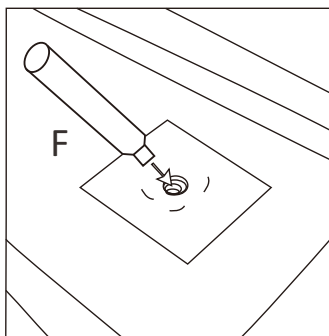

STEP 6

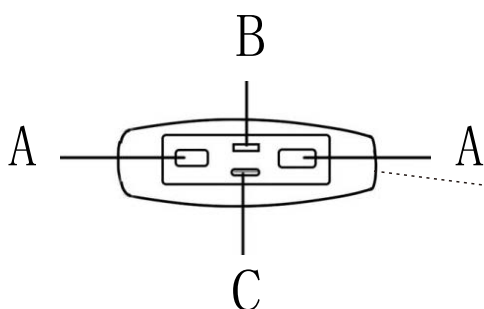

Press the A button to recline the sofa
Press the B button to control the light
C button is used to connect USB

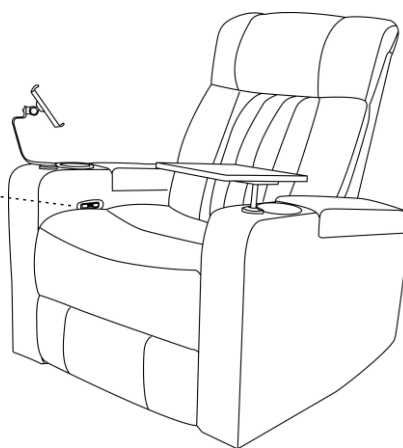

STEP 7

How to Disassemble

Please find a strong tool to prod the small piece of metal grooves, then the backrest will be pulled out. The tool is not included.

