

# DREAMS

IDEA

Instruction Manual



DREAMS/IDEA

NO:CH0058

# ABOUT US

*D*REAMSIDEA IS A ONE-STOP HOME

FURNISHING AND SERVICE COMPANY BASED IN USA.

WE ARE DEDICATED TO BRINGING YOUR DREAM HOME TO LIFE.

OUR SERVICES COVER FROM DESIGN, PRODUCTION,

DIRECT SELL, STORAGE, AND TRANSPORTATION.

IF REALITY IS THE NEAR SHORE

AND IDEALISM THE FAR SHORE,

*D*REAMSIDEA

AS THE FERRY BETWEEN THEM,

EAGER TO ACCOMPANY YOU ON A JOURNEY

TO YOUR IDEAL HOME.



ITEM NO. CH0058

# WARRANTY

WE STRIVE TO OFFER HIGH-QUALITY PRODUCT AND WE ALSO TRY OUR BEST TO SATISFY EACH CUSTOMER THAT ORDERS FROM US WITH PRODUCT OR SERVICE AS NEEDED. EACH CUSTOMER RECEIVES A RECORD OF THEIR ORDER, SUCH AS THE ORDER NUMBER OR ITEM RECEIPT. FOR ANY ITEMS THAT ARE OUT OF THE WARRANTY PERIOD, YOU MAY STILL RECEIVE REPLACEMENT PARTS BY PURCHASING THEM FROM OUR COMPANY IF THEY ARE AVAILABLE.

Are you having difficulty  
with assembly? Missing parts?

Please contact us : [info@firstopintl.com](mailto:info@firstopintl.com)

Tel.5627813327

send an email with your order No. to us

For return, please check the return policy with  
the retailer or market place you bought from.

Appreciate your purchasing from us.

Pop up your life by our furniture !

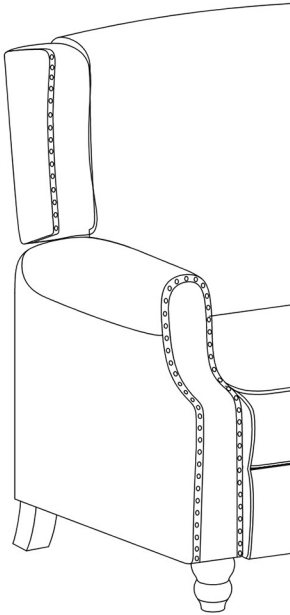

# MAINTAINANCE AND WARNING

Please read the manual thoroughly before  
you start install.

Please always use proper tools for  
installment.

Packaging and small parts may have  
chocking hazard, please keep them away  
from children and pets.

Please clean the product with dry clean  
cloth, some of the parts may be able to  
wash directly. Check with the product  
description!

Please keep the product away  
from fire.

Please keep the product away from  
sharp objects.

IF the product is placed under direct  
sunlight, the pattern or color might  
fade away.

Do not jump on the product.

Check the product periodically to make  
sure everything is tightened.

If you have any questions else, please  
contact us, we will be glad to help  
you out.



Two people

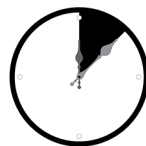

Around 60 min

# PRDOUCT DESCRIPTION

This multifunctional lounge chair adapts to your comfort needs with an adjustable recline and footrest.

Available in breathable linen for a soft, airy feel or sleek leather for a refined, vintage aesthetic.

A generously sized backrest with dual layer support ensures relaxation, even for extended sitting sessions.

Featuring a spring pack, high density foam, and fiber filling for optimal softness and elasticity.

Crafted with a sturdy solid wood frame and legs, providing stability and long lasting durability.

Dream



House



# EXPLODED VIEW

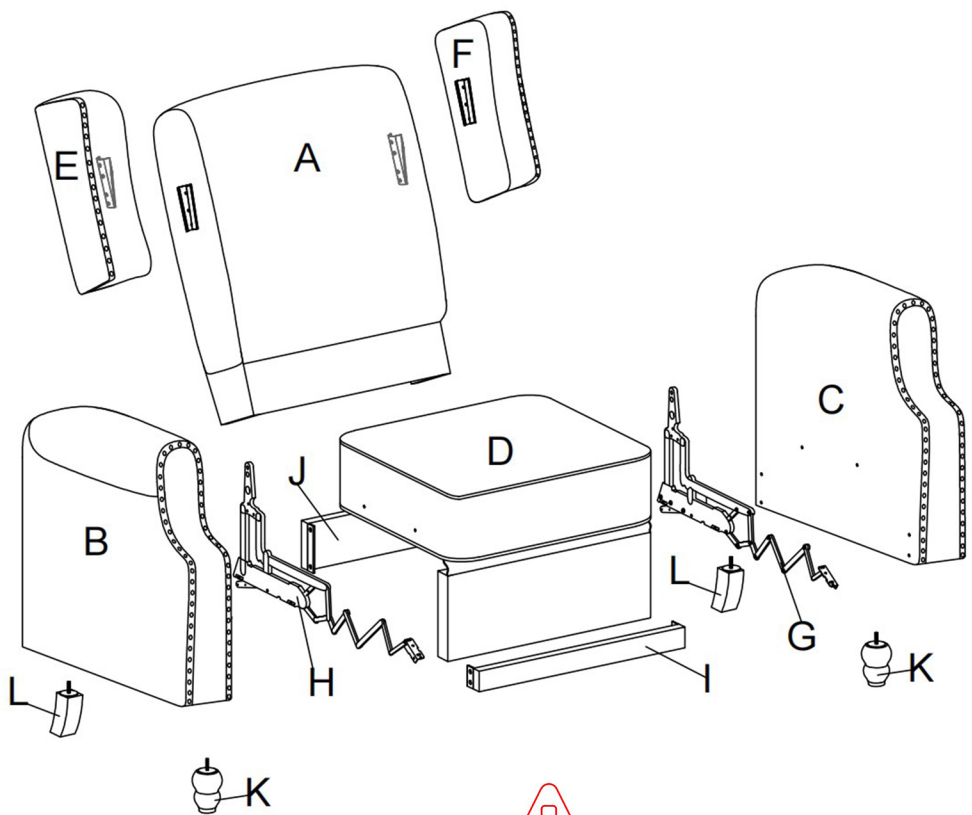

the product's left and right are determined by sitting posture

# PARTS

A\*1



Backrest

B\*1

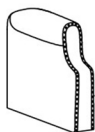

Armrest-Right

C\*1

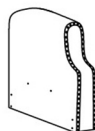

Armrest-Left

D\*1

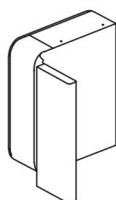

Seat frame

E\*1



Right ear

F\*1



Left ear

G\*1



Sofa metal functional support-left

H\*1



Sofa metal functional support-right

I\*1



Connecting part-Front

J\*1



Connecting part-Back

K\*2



Wood leg -front

L\*2



Wood leg -back

# HARDWARE

## TOOL LIST

①\*1



Allen key

②\*8



★ Bolt

③\*20



★ Bolt

④\*4

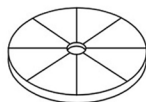

Plastic washer

⑤\*8



★ Flat washer

PLEASE MAKE SURE ALL  
HARDWARE&PACKING  
MATERIAL FITTING THE LIST.  
ESPECIALLY SOMESMALL  
ACCESSORIES MAY BE MISSING  
DURING TRANSPORTATION.  
PLEASE CONTACT US  
IF YOU HAVE ANY QUESTION.

NOTE: Designated with (★) We provide additional spare parts in the hardware package

# step 1

1. REMOVE THE PREDRILLED BOLTS(2) FROM BOTH SIDES OF THE SEAT FRAME (D), THEN PLACE THE SEAT FRAME ON ITS SIDE ON A CLEAN SURFACE AS SHOWN. ALIGN THE HOLES ON THE FUNCTIONAL RACK (G & H) WITH THE HOLES ON SEAT FRAME, USE THE ALLEN WRENCH (1) TO TIGHTEN THE BOLTS.
2. REPEAT THE SAME STEP FOR THE OTHER SIDE.

1.

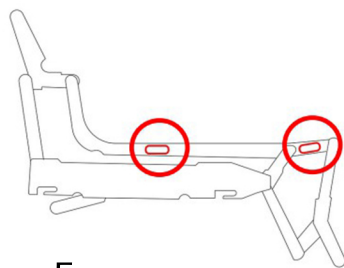
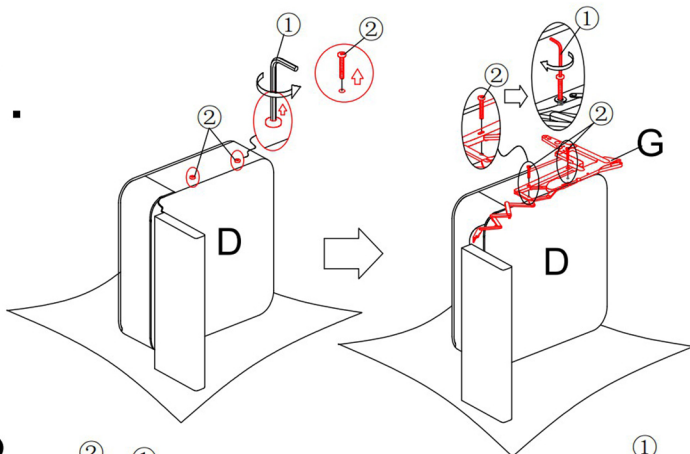

FUNCTIONAL RACK

2.

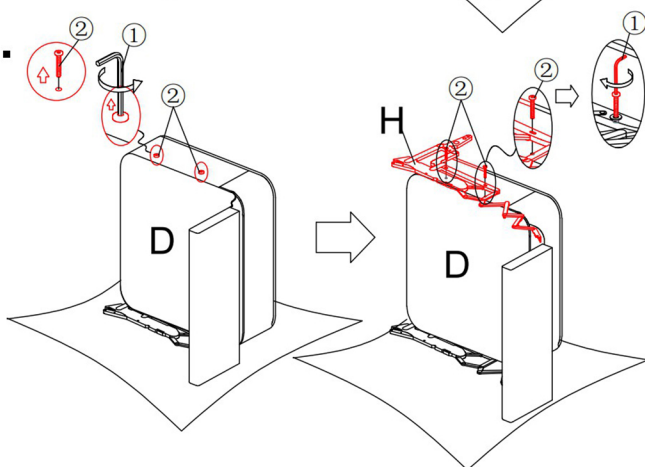

  
Please be careful while installing the functional rack, DO NOT damage or dirty the fabric of the seat frame.

  
The bolt holes on the functional rack is long oval shaped, the bolts on both sides should be kept in the corresponding same position

# step 2

THE BOARD THAT CONNECT TO THE SEAT FRAME IS THE FOOT REST, ALIGN THE BOLT HOLES ON THE FOOT REST WITH THE BOLT HOLES ON THE EXTENDED PART ON THE FUNCTIONAL RACKS, USE THE ALLEN WRENCH(1) TO TIGHTEN THE BOLTS.

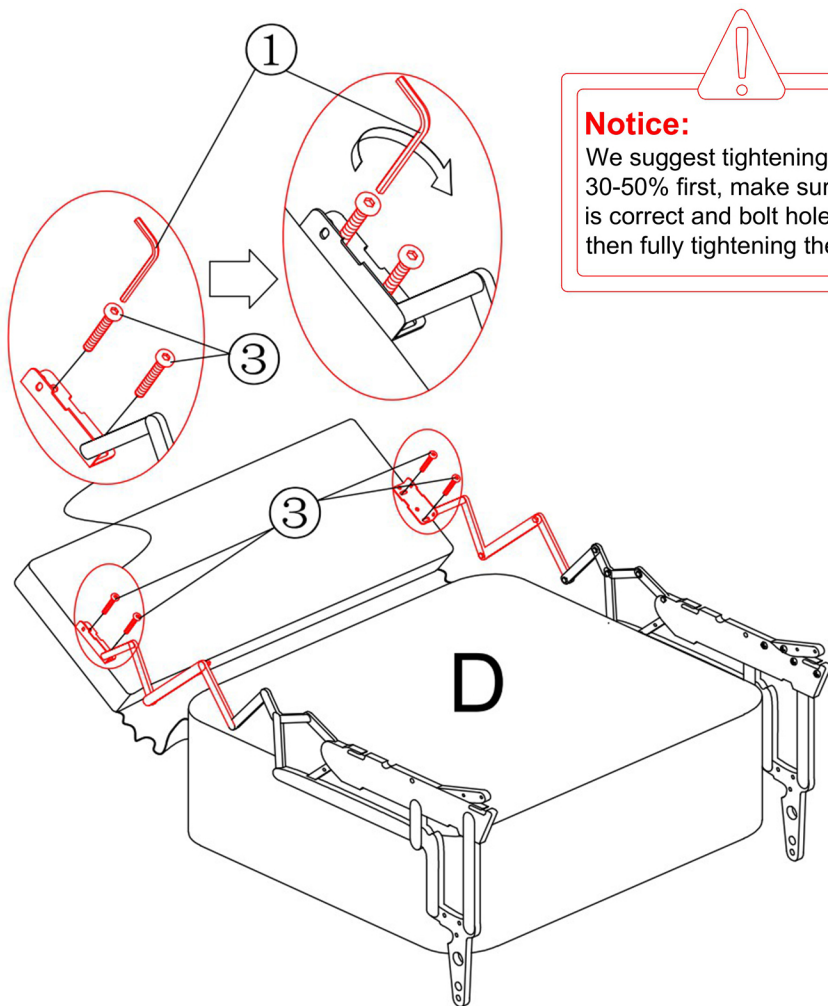

## Notice:

We suggest tightening the bolts for 30-50% first, make sure the process is correct and bolt holes are aligned, then fully tightening them all.



# step 3

PLACE THE BACKREST (A) FLAT ON A CLEAN SURFACE AS AN ELEVATE PAD. THEN PLACE THE PRE-INSTALLED SEAT FRAME FROM THE LAST STEP ONTO THE BACKREST AS SHOWN IN THE FIGURE.

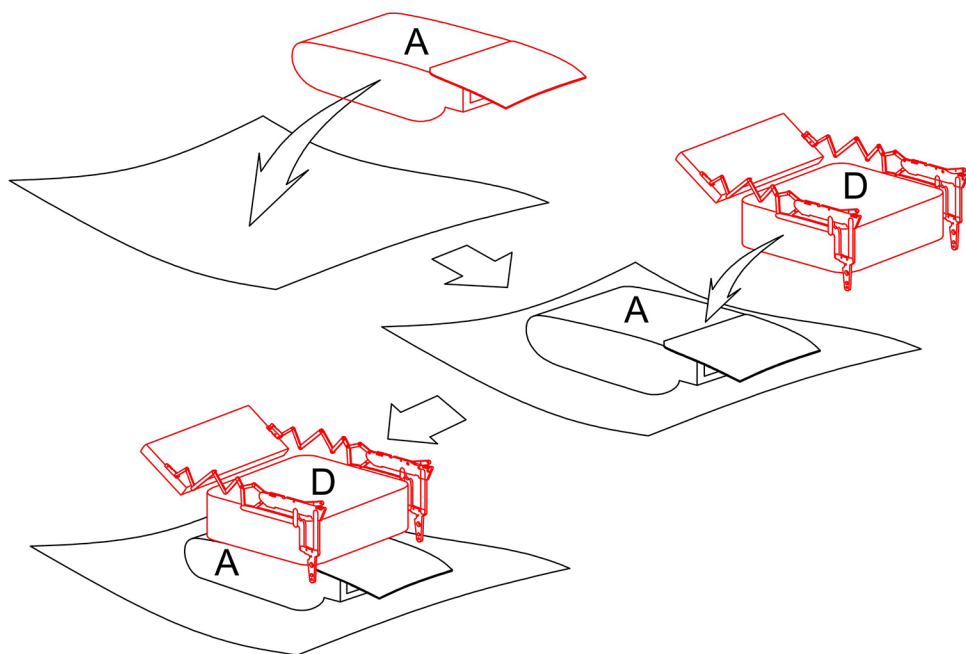

# step 4

ACCORDING TO THE IDENTIFICATION, UNSCREW THE BOLTS AT POSITION 3 FOR 1 CM, WHERE LABELED STEP 5, DO NOT UNSCREW COMPLETELY. THEN REMOVE REST OF THE BOLTS.

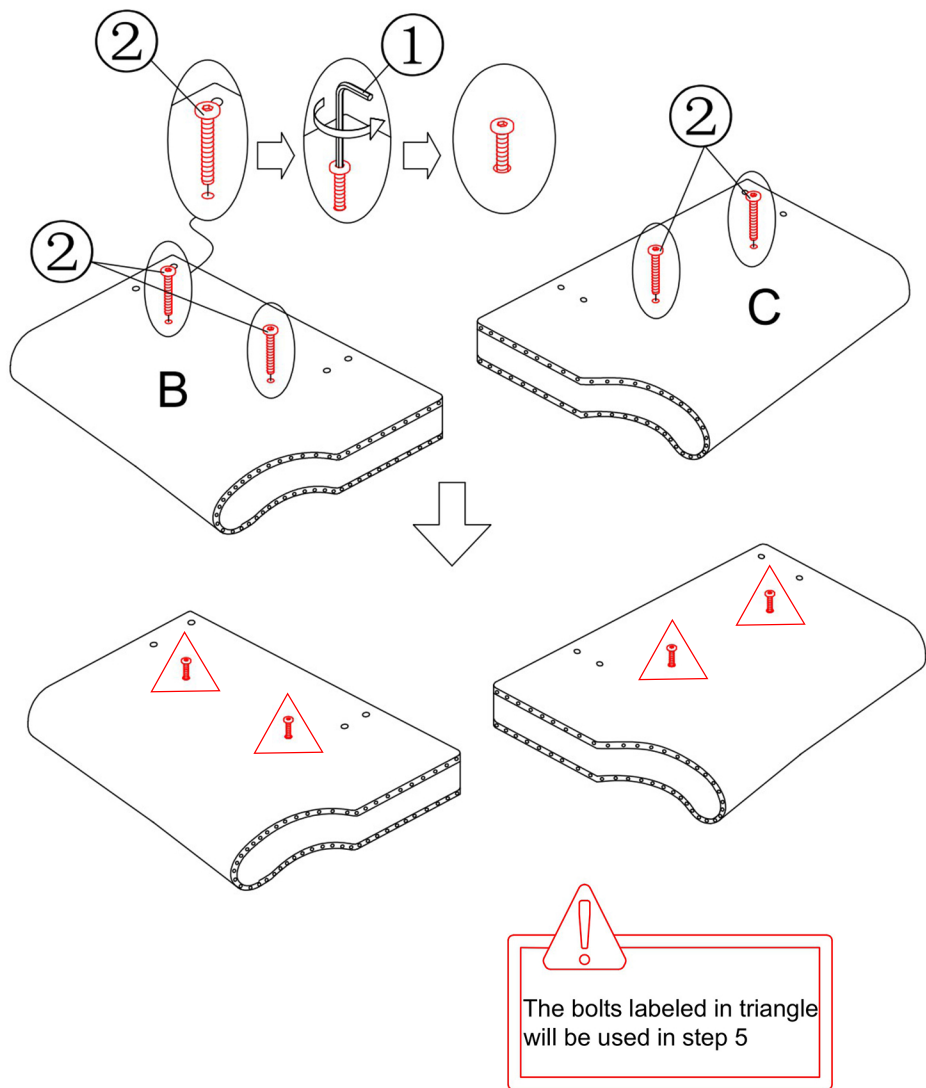

# step 5

USE THE 1 CM SCREW UNCREWED FROM LAST STEP (LABLE STEP 5) TO HANG THE ARMREST(B,C) INTO THE HOLD WITH A NOTCH ON IRON FRAME AS SHOW.

MAKE SURE BOTH OF THE BOLTS ARE CORRECTLY ALIGNED.

USE THE ALLEN WRENCH(1) PROVIDED TO TIGHTEN BOTH BOLTS,

MAKE SURE BOTH BOLTS ARE FULLY TIGHTENED BEFORE NEXT STEP.

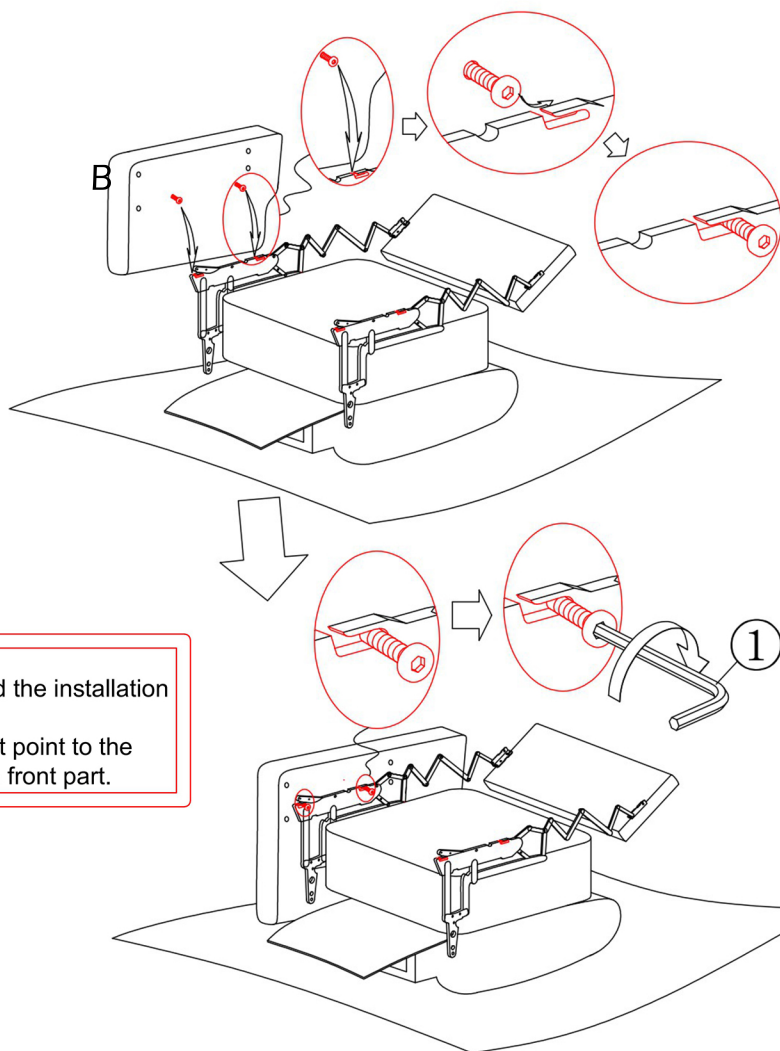

1. Place accord the installation guide clearly.
2. The armrest point to the foot rest is the front part.

# step 6

USING THE SAME METHOD AS IN STEP 5, INSTALL THE ARMREST ON THE OTHER SIDE.



1. Place accord the installation guide clearly.
2. The armrest point to the foot rest is the front part.

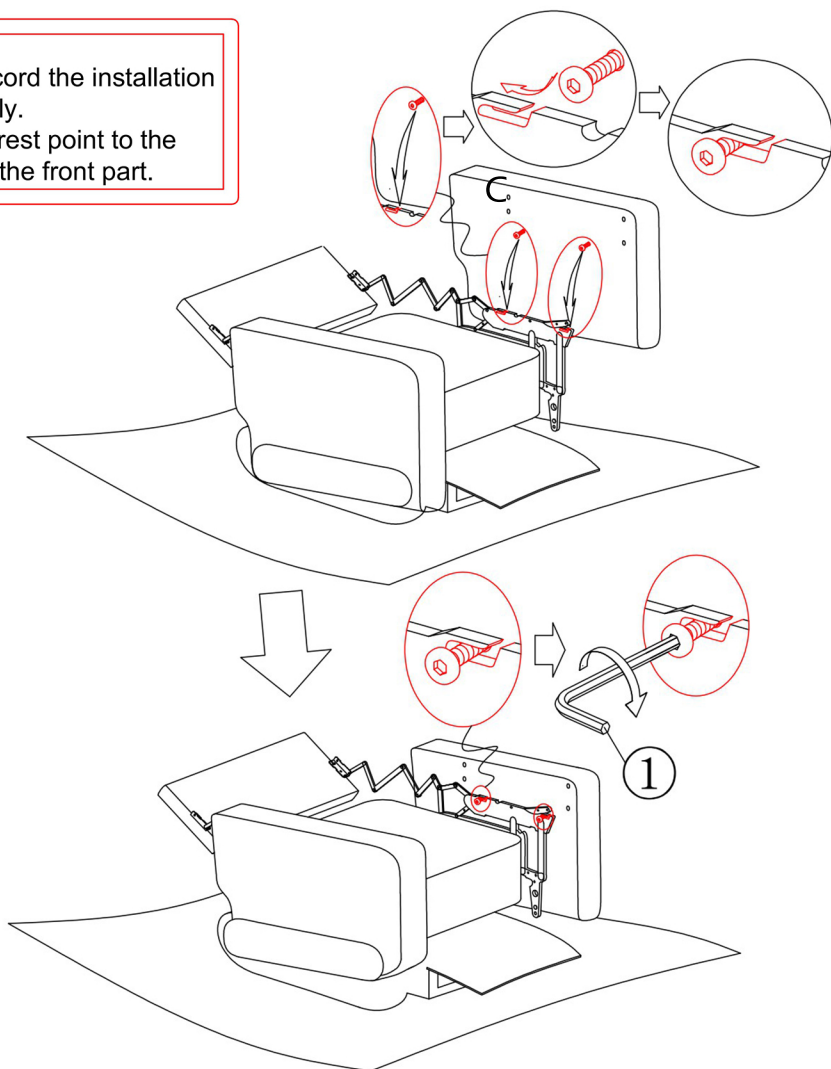

# step 7

AS THE DIAGRAM SHOWS, PLACE THE BOLTS THROUGH THE BOLT HOLES ON THE METAL PARTS OF THE FRONT PANEL, AND INSTALL TO THE FRONT PART OF THE ARMRESTS. REPEAT THE SAME STEP FOR THE BACK PART OF THE ARMRESTS.

FIRST PLACE ONE FLAT WASHER(5) ON EACH BOLT(3), THEN ALIGN THE BOLT HOLES ON BOTH CONNECTING PART OF THE FRONT PANEL(1) AND BACK PANEL THEN USE ALLEN WRENCH PROVIDED TO TIGHTEN ALL BOLTS BY 30-50%, MAKE SURE BOLT HOLES ON BOTH ARMRESTS AND FRONT PANEL ARE CORRECTLY ALIGNED BEFORE FULLY TIGHTENING.



1. Please accord the installation guide clearly.
2. The armrest point to the foot rest is the front part.

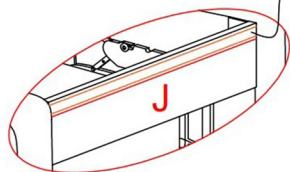
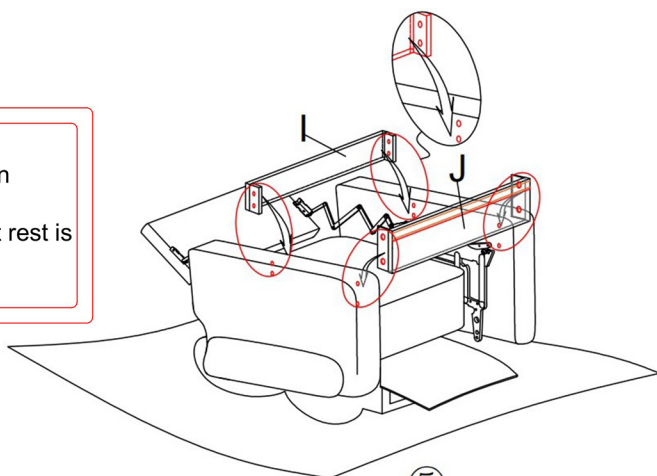

The position  
of the velcro

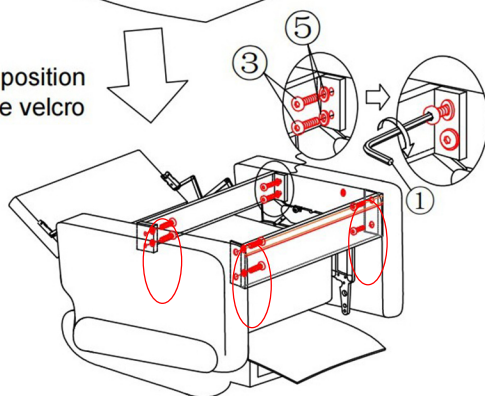

# step 8

PLACE ONE PLASTIC WASHER(4) ON THE BOLT PART OF THE WOODEN LEGS, THEN TWIST IN THE FRONT AND BACK WOODEN LEGS (K&L) INTO THE PRE-DRILLED HOLES ON THE BOTTOM OF THE ARMRESTS.

MAKE SURE THEY ARE FULLY TIGHTENED.



1. Please notice that cylindrical legs are front legs, the square slant legs are back legs, the slanted point should be twisted to the right astern.

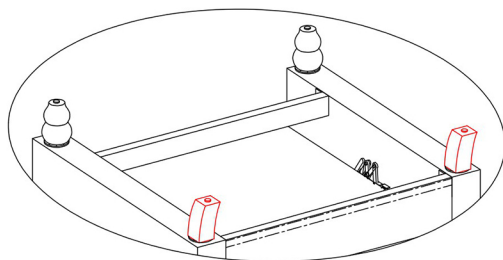
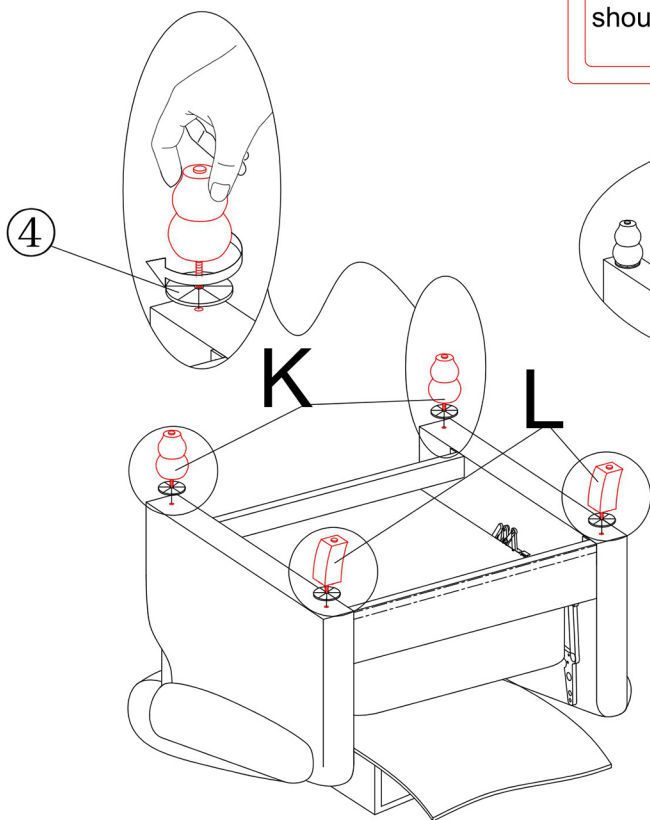

# step 9

TAKE THE SEAT FRAME(D) AND PLACE IT STRAIGHT ON THE GROUND. HOLD THE BACKREST (A) AND UNCOVER THE BACK CLOTH, ALIGN THE METAL CONNECTORS OF THE INNER BACKREST(A) WITH THE TIP PART OF THE FUNCTIONAL RACK ON THE SEAT FRAME, AND PUSH DOWN HARD UNTIL THEY INTERLOCKED COMPLETELY.

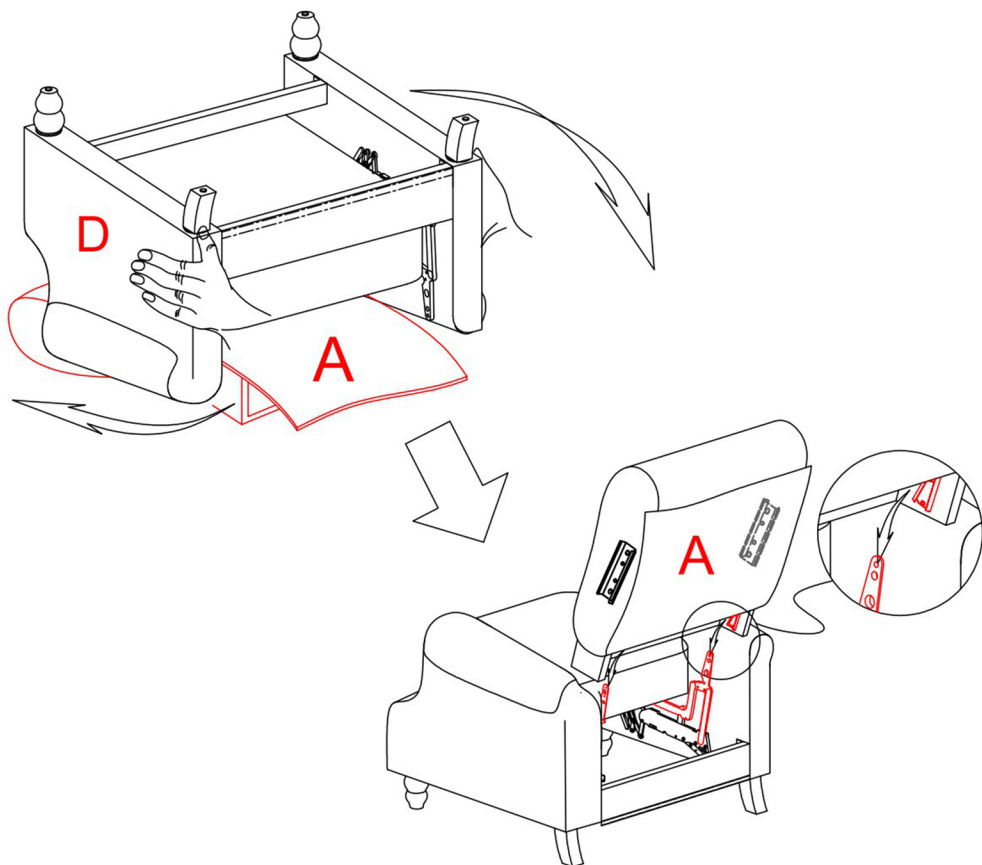

# step 10

UNCOVER THE VELCRO STRIP COVER ON THE BOTTOM OF THE BACK CLOTH, AND STICK THE VELCRO TO THE BOTTOM OF THE BACK PANEL.

INSTALL THE SIDE EARS(F&E) TO THE BACKREST AS SHOWN. MAKE SURE THE CONNECTOR IS ALIGNED TO THE CORRECT SLOT BEFORE PUSHING DOWN.

REPEAT THIS STEP FOR BOTH SIDE EARS.

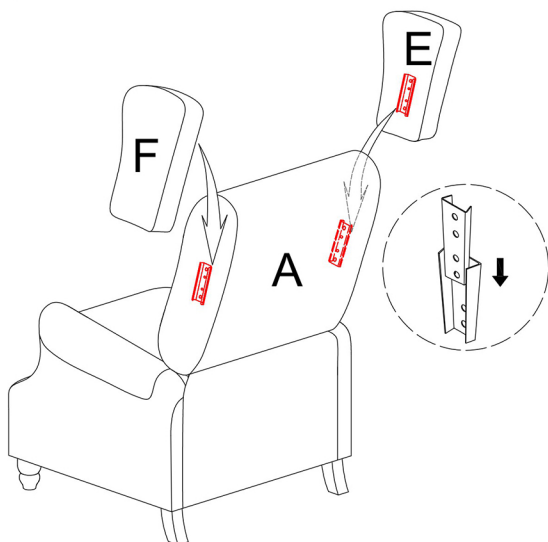
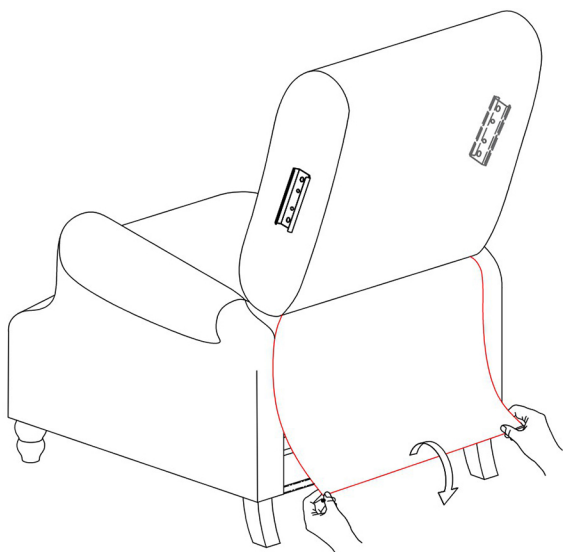



# step 11

CONGRADULATIONS, THE ASSEMBLY IS COMPLETE! THANK YOU AGAIN FOR CHOOSING OUR PRODUCT! PLEASE ENJOY!

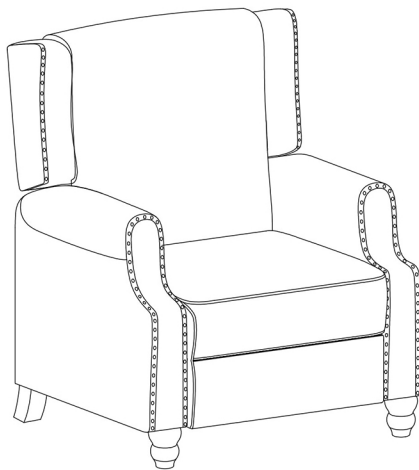

THE BACKREST AND THE FOOTREST ARE ADJUSTABLE, THE BACKREST HAS RECLINE FUNCTION. WHEN YOU LIE DOWN AND APPLY FORCE TO THE BACKREST, THE FOOTREST WILL LIFT UP WHILE BACKREST AS RECLINING DOWN.

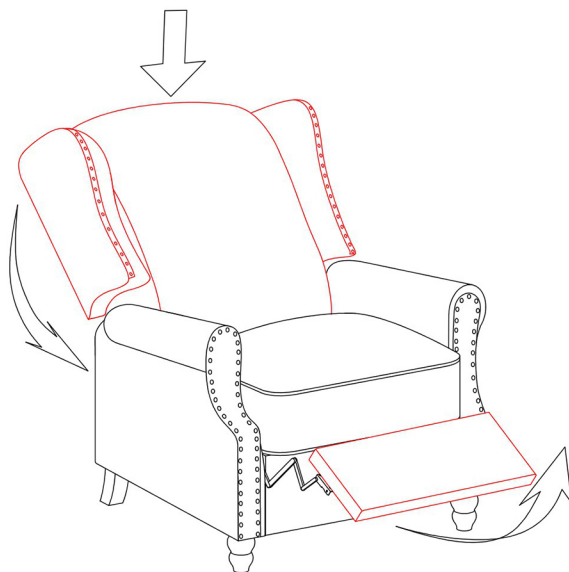



ASSEMBLY INSTRUCTIONS

Tel.5627813327

Please contact us: [info@firstopintl.com](mailto:info@firstopintl.com)

<https://www.dreamsidea.com>