

# ASSEMBLY INSTRUCTIONS

## SKU:VK-102

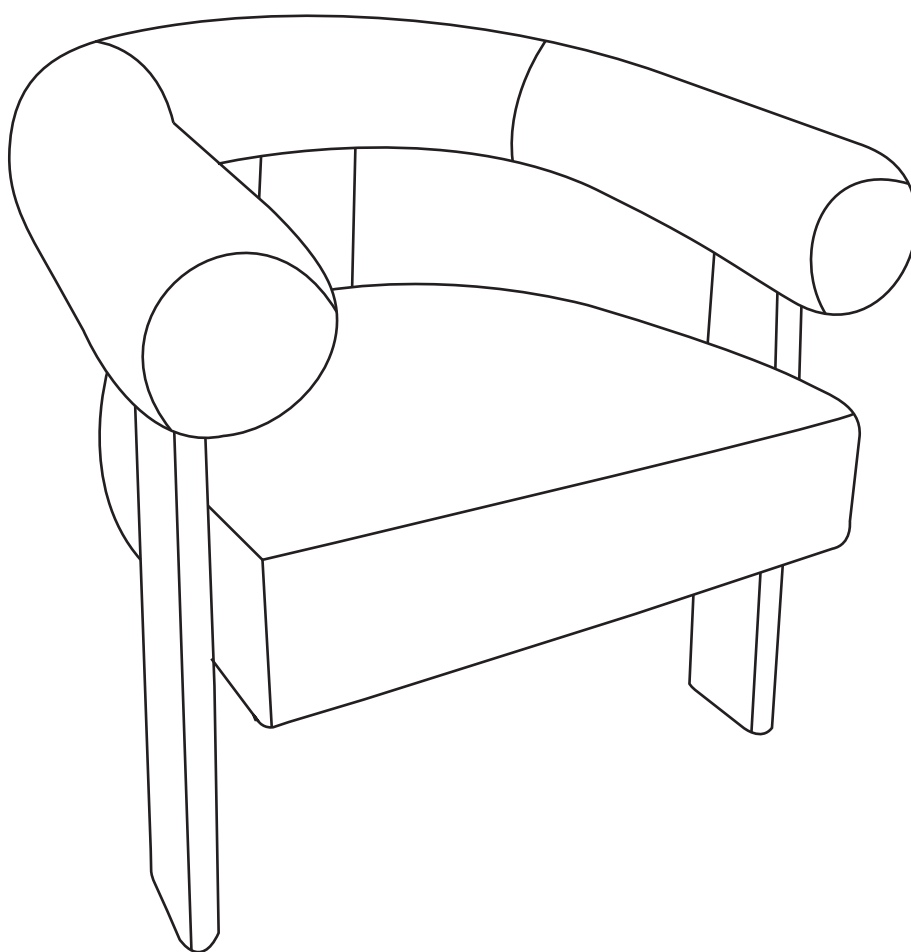

## WARNING



Please read the instructions carefully and follow the assembly steps.

Do not tighten bolts or screws completely until all hardware is lined up and inserted into the holes.

Do not over-tighten screws and bolts to avoid stripping the hardware or cracking the item.

Assemble your item on a flat, carpeted area, with plenty of space to work. This will prevent damage and scratches to your floors or the item while you're assembling the product.

Keep all components and packaging out of reach of children or animals to avoid risk of choking or suffocation.

## ASSEMBLY PARTS AND TOOL



Please use the included wrench instead of an ELECTRIC HAND DRILL in case of damage to the chair leg.

**A**

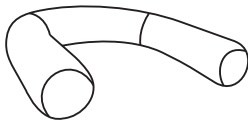

Backrest \*1

**B**

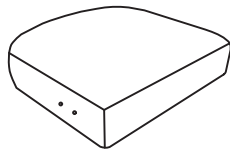

Seat \*1

**C**



Wooden leg \*1  
(Middle)

**D**



Wooden leg \*1  
(Left)

**E**



Wooden leg \*1  
(Right)

**F**

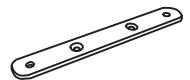

Metal \*3

**G**



Bolt  
M6\*20mm\*6

**H**



Bolt  
M6\*25mm\*6

**I**



Bolt  
M8\*40mm\*5

**J**



Flat washer \*5

**K**

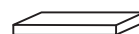

Floor Protector \*3

**L**



Wrench \*1

PLEASE MAKE SURE ALL THE PARTS ARE INCLUDED.

MISSING PARTS? [cs@vknow-online.com](mailto:cs@vknow-online.com)

## ASSEMBLY INSTRUCTIONS

### STEP 1:

- C** Wooden leg \*1  
(Middle)
- D** Wooden leg \*1  
(Left)
- E** Wooden leg \*1  
(Right)
- F** Metal \*3
- G** Bolt  
M6\*20mm\*6
- L** Wrench \*1

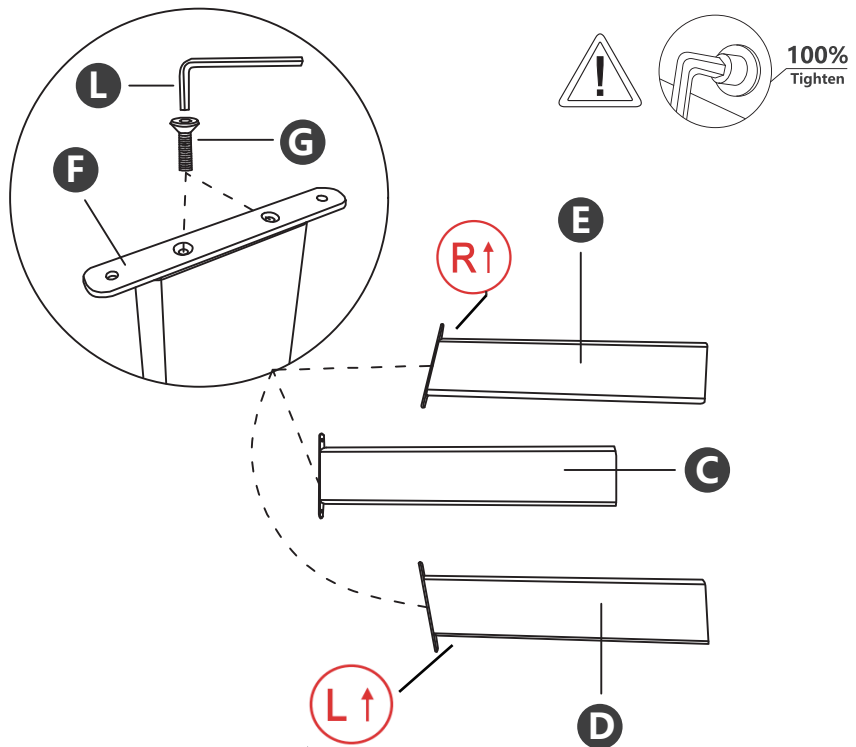

### STEP 2:

- A** Backrest \*1
- C** Wooden leg \*1  
(Middle)
- D** Wooden leg \*1  
(Left)
- E** Wooden leg \*1  
(Right)
- H** Bolt  
M6\*25mm\*6
- K** Floor Protector \*3
- L** Wrench \*1

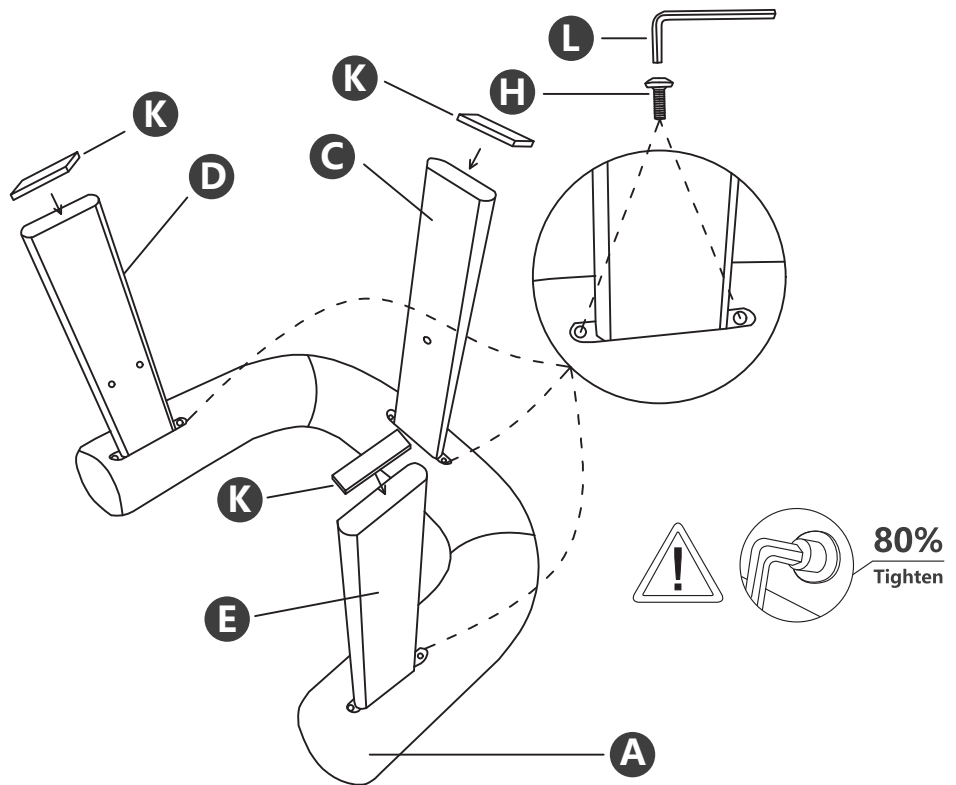

### STEP 3:



Backrest \*1

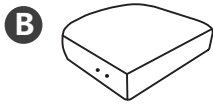

Seat \*1



Bolt  
M8\*40mm\*5



Flat washer \*5



Wrench \*1

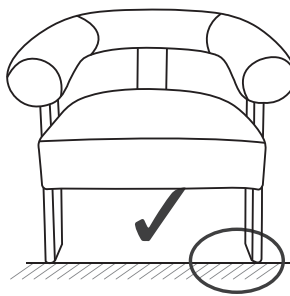
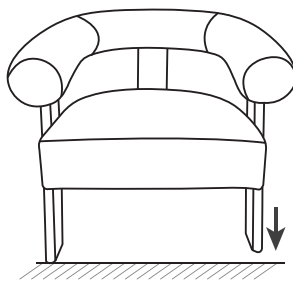
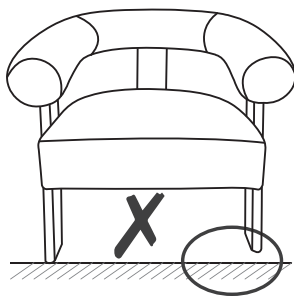
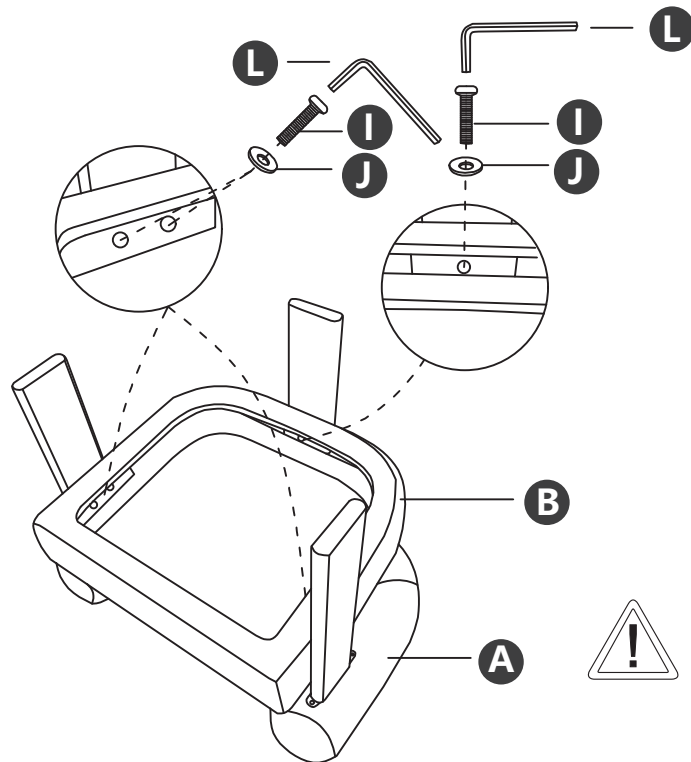

100%  
Tighten

Place the chair on a flat surface, adjust the chair so that it becomes stable, then tighten all screws to 100%.

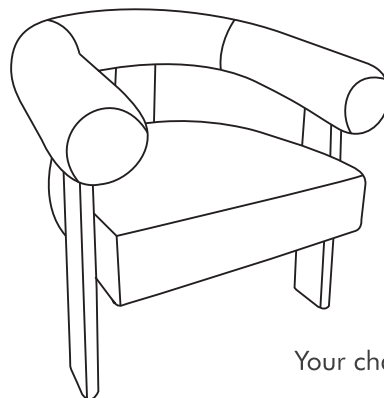
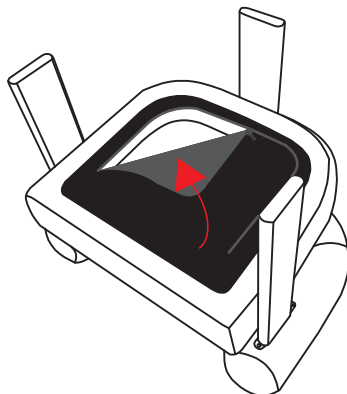

Your chair assembly is complete!

### CARING FOR YOUR ITEM

Indoor use only

Not contract grade.

Clean using a non-abrasive cloth and a mild cleaner.

Never use harsh chemicals, as they could damage the finish or integrity of the item.