

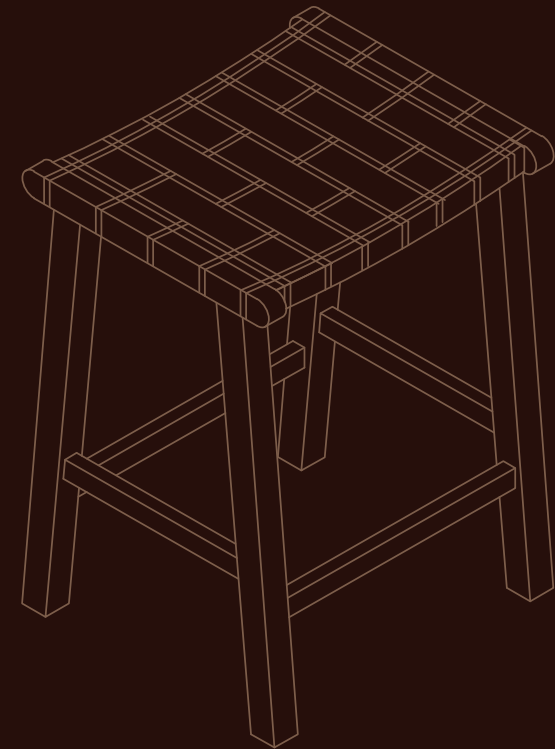

# NOAH

NOAH BACKLESS STOOL



MAVENLANE.COM  
 @mavenlanehome

NOAH BACKLESS STOOL



## ABOUT US

As unique individuals, we all have our own ways of expressing ourselves. Through expression, we open doors to new opportunities and communicate to the world.

At Maven Lane, we understand the profound impact that home design can have on personal expression. Our homes serve as our nests, reflecting our individual styles, personalities, and values. They are the spaces where we create meaningful memories and moments of comfort and peace.

With this in mind, we set out to bring the finest in design, materials, and customer service directly to our customers, all at an attainable price point. Whether you're seeking to elevate your mornings with a cozy sanctuary or host laughter-filled dinners with loved ones, we are dedicated to helping you create a space that truly reflects who you are and what you aspire to be.

MAVENLANE.COM

 @mavenlanehome



## NOAH BACKLESS STOOL

# ASSEMBLY INSTRUCTIONS

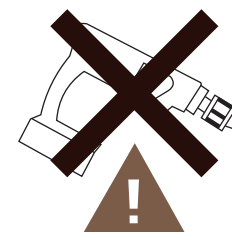
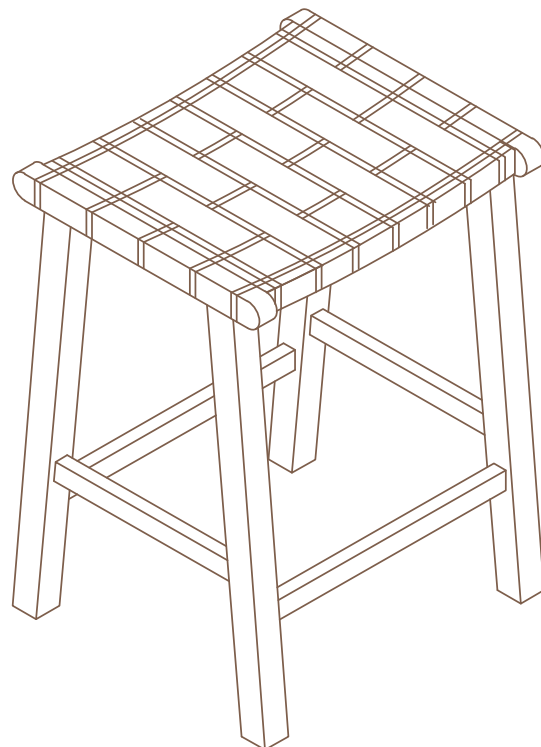

The use of power tools to assemble this product could lead to damage, making it unsafe

Please assemble on a clean, level surface to avoid damage and ensure proper assembly

### Tools Required

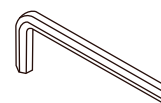



Allen Key  
(included)

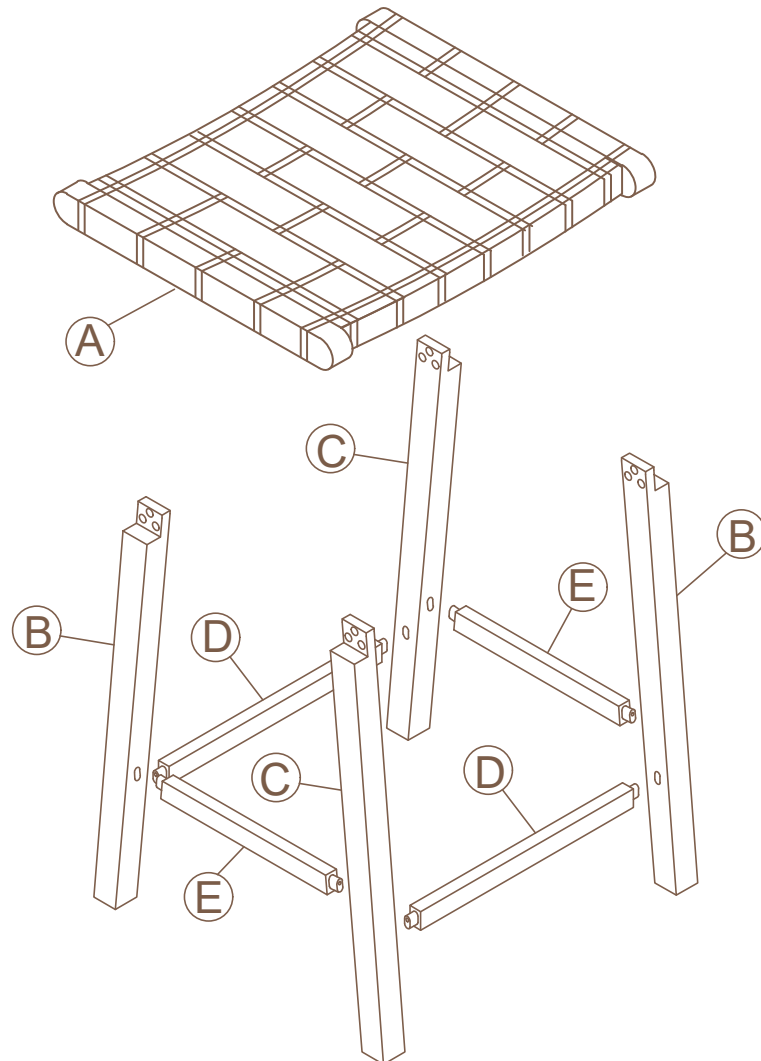

(unincluded)

# PARTS LIST



**F Bolt**  
  
 Qty 12  
 Ø1/4"x45mm

**G Lock Washer**  
  
 Qty 12  
 Ø1/4"

**H Flat Washer**  
  
 Qty 12  
 Ø1/4"x13mm

**I Pan Head Screw**  
  
 Qty 8  
 #4x45mm

**J Allen key**  
  
 Qty 1  
 M4

**K Felt Pads**  
  
 Qty 1

Scan for additional  
 information



# ASSEMBLY

## STEP 1

Attach legs (B&C) to seat chair (A) with bolts (F), lock washers (G), flat washers (H) using allen key (J). At the same time, attach stretcher (E) to legs (B&C) with screws (I).

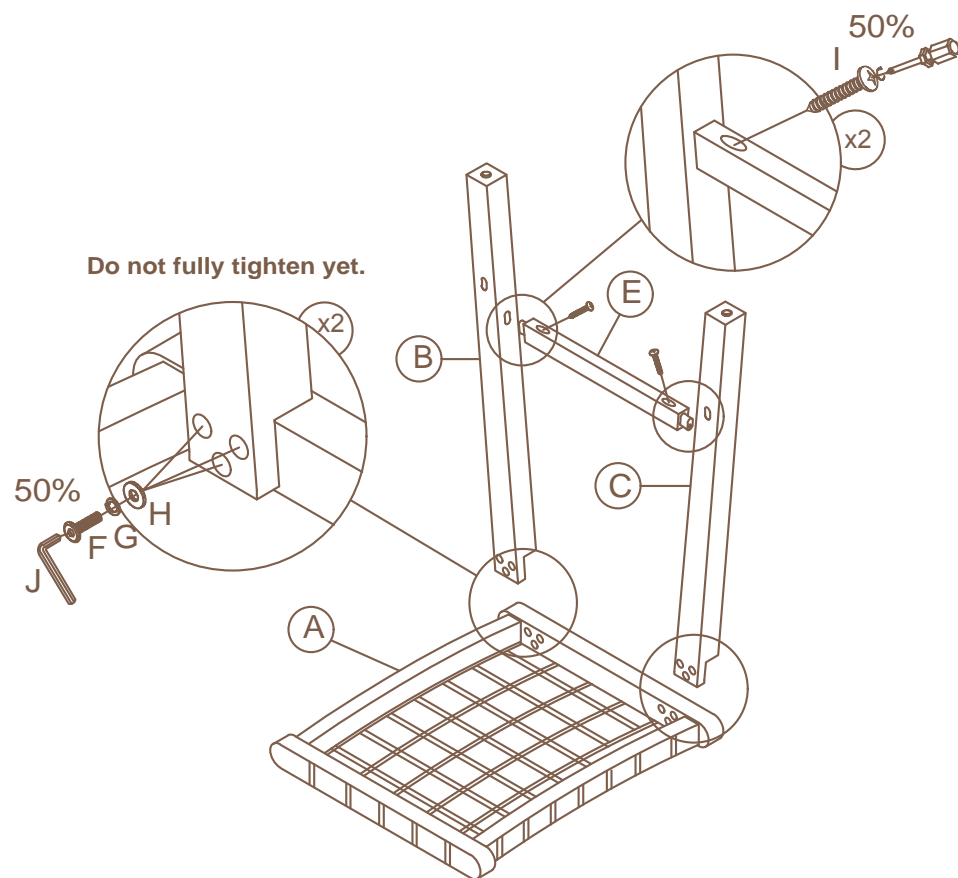

## STEP 2

Attach legs (B&C) to seat chair (A) with bolts (F), lock washers (G), flat washers (H) using allen key (J). At the same time, attach stretcher (D&E) to legs (B&C) with screws (I).

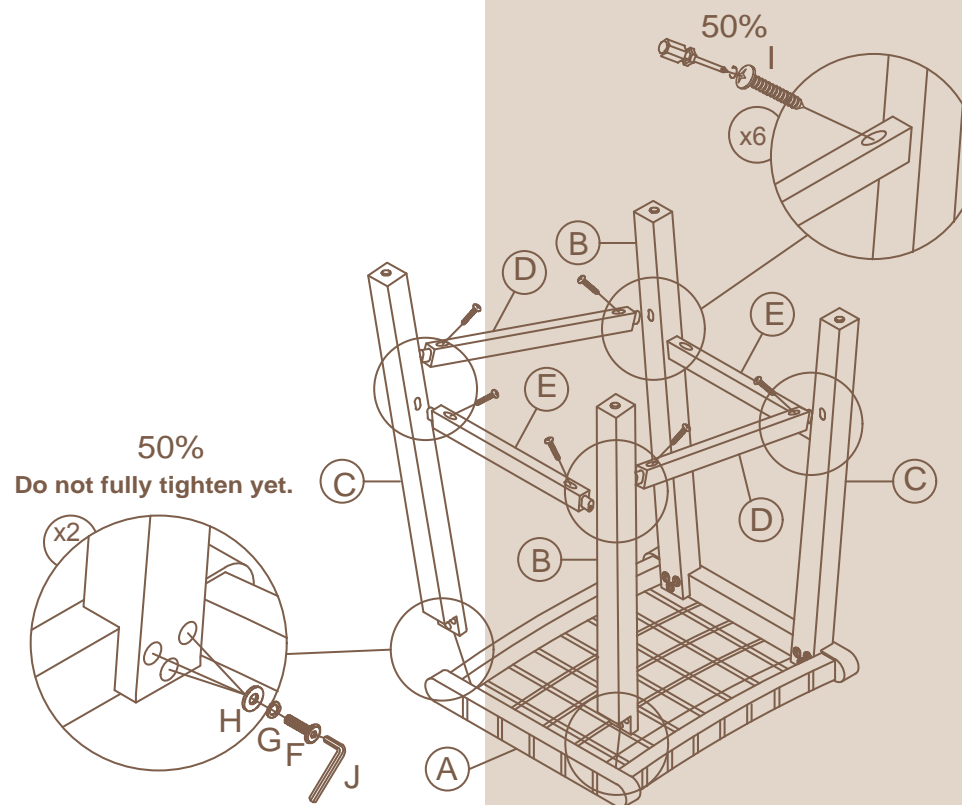

## ASSEMBLY

### STEP 3

Face the chair on the flat surface then tighten all bolts and screws.

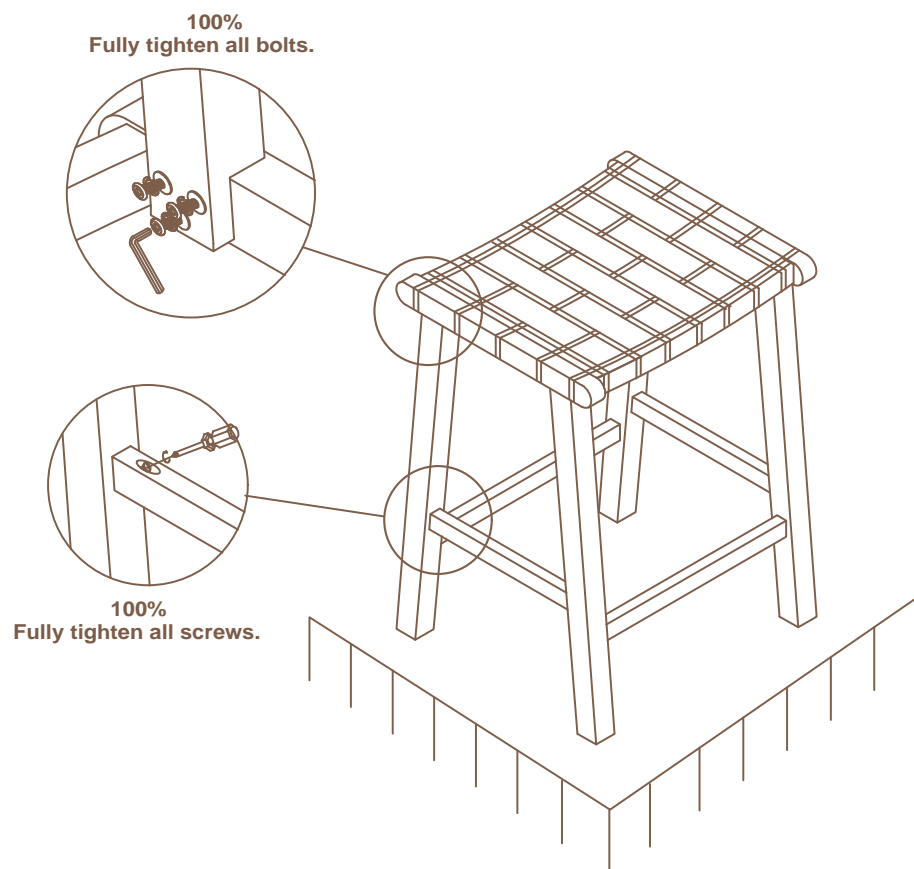

### STEP 4: Felt Pad Application (optional)

1. Wipe any dust from the surface for best adhesion
2. Gently peel the felt pad from the paper
3. Firmly apply a felt pad to each of the feet

