

# INSTALLATION & USER MANUAL

## Ceiling Fan With Light

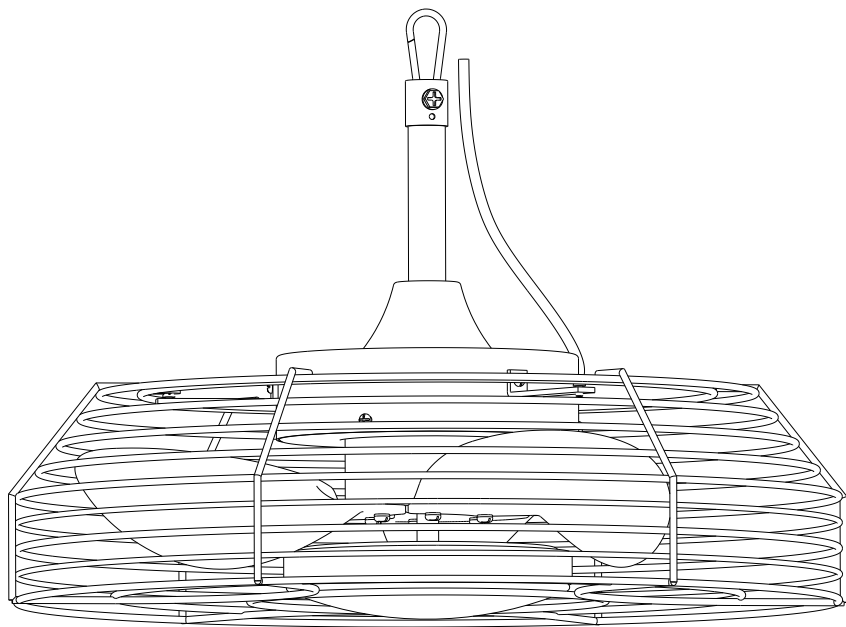

Item: 39004-BK





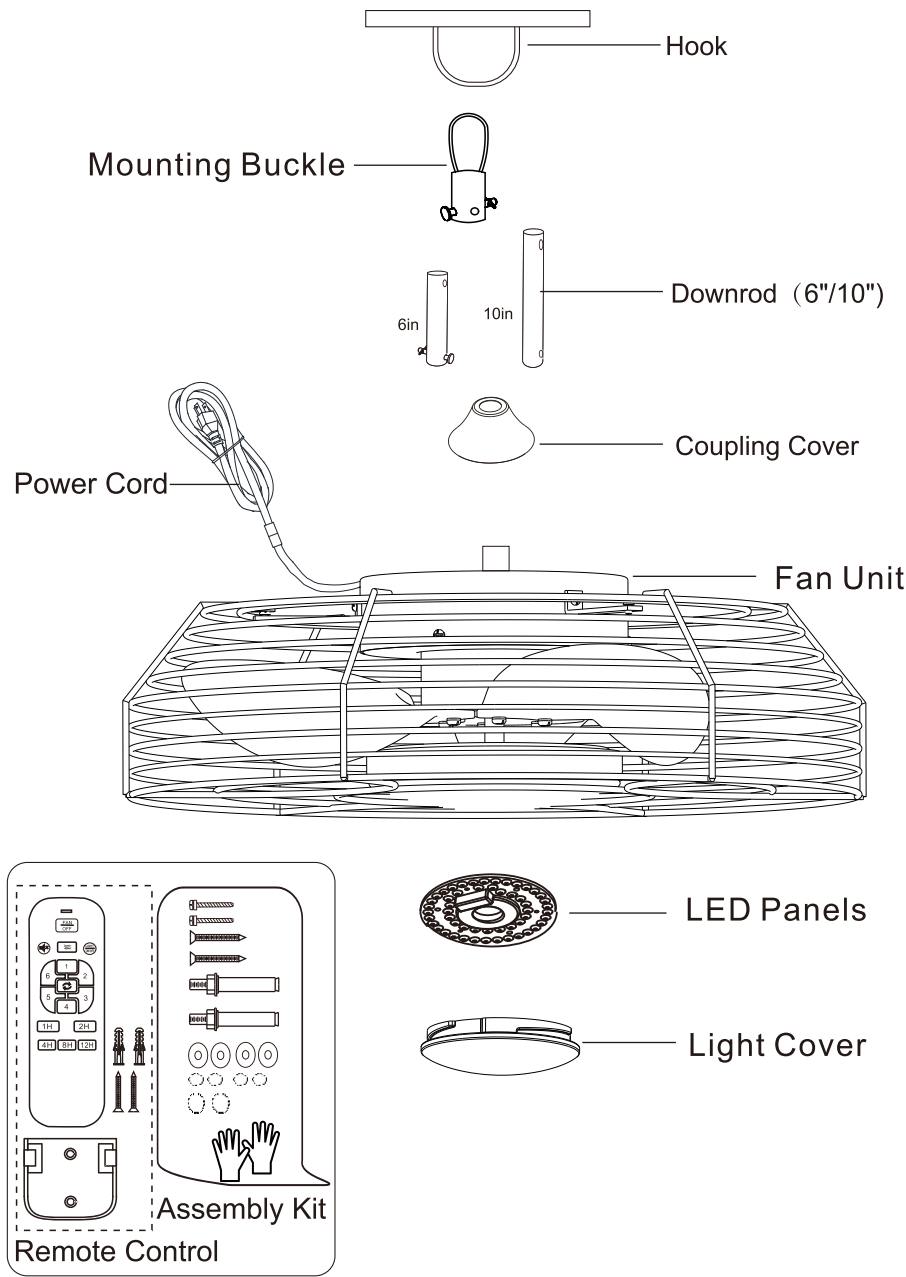

Customer Service: [support@ceilingfanhelp.com](mailto:support@ceilingfanhelp.com)

# 01.Parts List and Tools

## 1.Parts List



## 2.Tool Required

					
Electrical Adhesive tape	14 mm Open Spanner	Slotted Screwdriver	Philips Screwdriver	Telescoping Ladder	Pliers

### WARNING

- (1). To avoid the risk of electric shock, ensure the power is turned off at the main fuse box before wiring. Installation must be performed by a licensed electrician.
- (2). This fan is not compatible with dimmer switches or variable-speed solid-state wall controls.

### Maintenance

- (1). It is recommended to inspect all connecting parts at least once a year- including the mounting bracket, downrod fasteners, and fan blades -to ensure they are secure and functioning properly.
- (2). Clean the fan blades regularly to maintain performance and reduce dust buildup.
- (3). The motor bearings are pre-lubricated with grease. Do not apply additional oil or lubricants to the motor.

# 02.installation Guide

Note: The fan light is not compatible with dimmer switches or variable-speed solid-state wall controls.

## 1.Before You Start

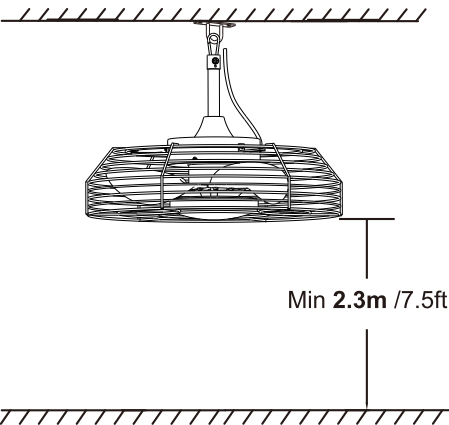

1A: Wear protective gloves during installation.

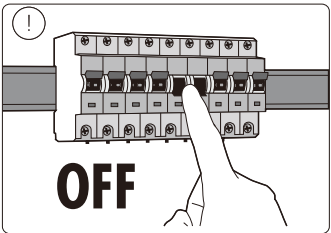

1B: Ensure a minimum clearance of 2.3 meters (7.5 ft) from the fan to the floor.

1C: Turn OFF the power at the main fuse or circuit breaker before installation.

## 2.Install the Bracket

### FOR CONCRETE CEILING

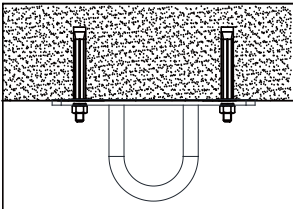

### FOR WOOD CEILING

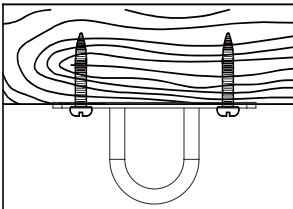

### FOR OUTLET BOX

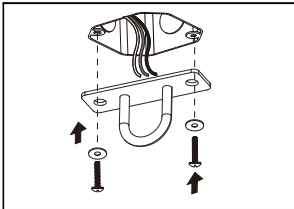

Choose the appropriate fasteners based on your ceiling material.

### 3. Install the Downrod and Coupling Cover

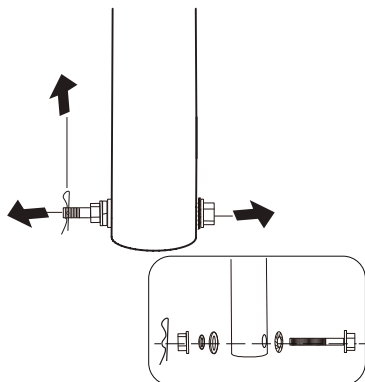

Loosen the components at the yoke of the downrod assembly.

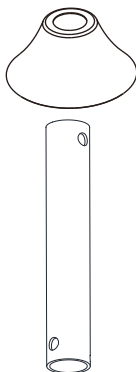

Slide the canopy and the collar cover onto the downrod.



Assemble the downrod with the canopy and collar cover as shown in the figure.

### 4. Install the Fan

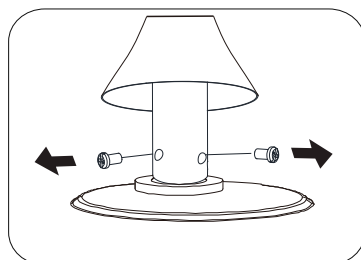
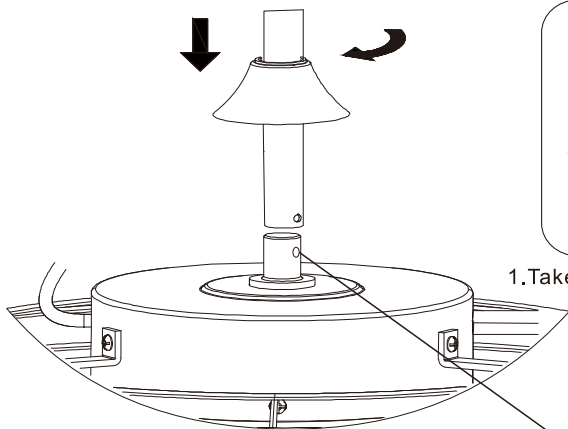

1. Take out the two screws on the downrod

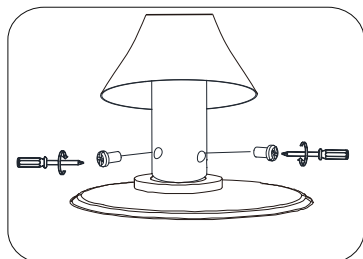

3. Tighten the two screws on the lifting rod

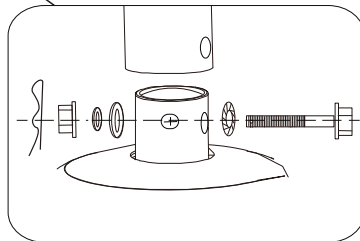

2. Mount the downrod onto the machine and pin and screw as shown in the illustration

# 5. Installation of Suspension Steps

## 5a. Install hanging buckle

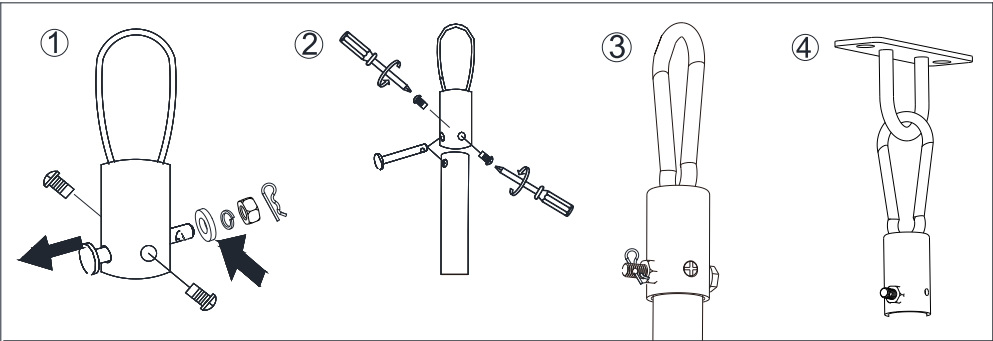

## 5b

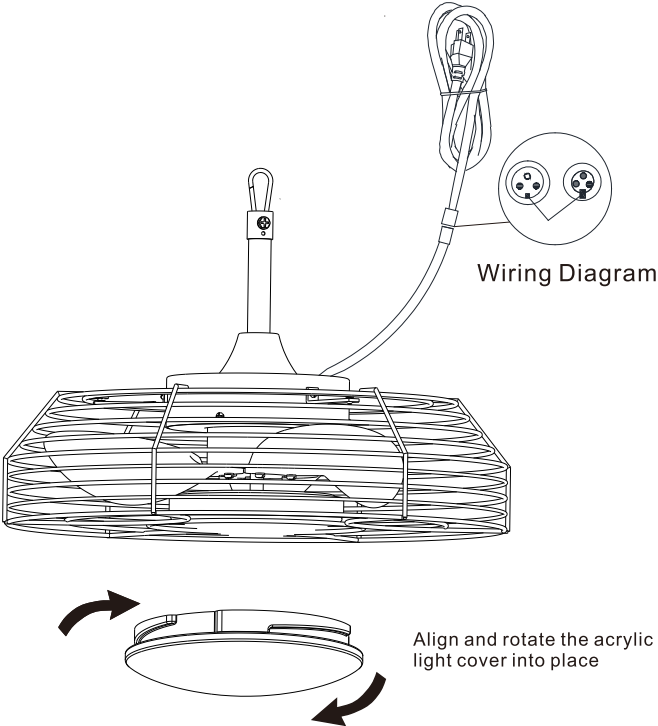

5c

OPTION 1: Drill Method

2a:Masonry/  
Concrete / Brick

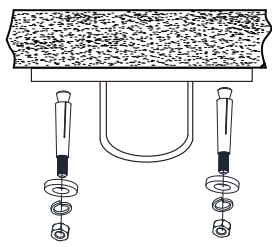

EXPANSION ANCHORS

2b:wood

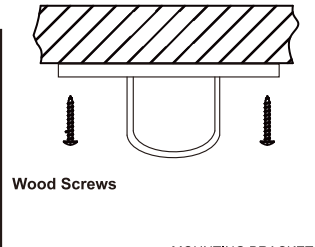

Wood Screws

MOUNTING BRACKET

2c:Outlet box

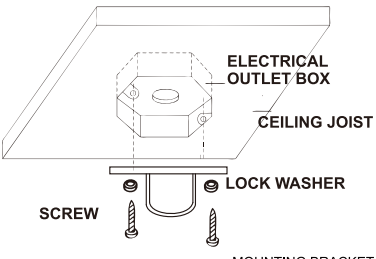

MOUNTING BRACKET

The mounting bracket must be securely fastened to a structural ceiling member.

1 Mark the Hole Pattern

1. Hold the mounting bracket in its final position.
2. Use the bracket as a **template** and mark the centre of both holes with a pencil or centre-punch.

2 Select Your Surface & Fastener

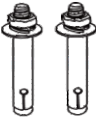
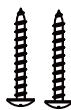
OPTION A    Masonry / Concrete / Brick	OPTION B    Wood Joist / Timber
<b>Hardware (supplied)</b> M6 × 50 mm <b>EXPANSION ANCHORS</b> – 2 pcs 	<b>Hardware (supplied)</b> M6 x 35 mm <b>SELF-TAPPING SCREWS</b> – 2 pcs 
<b>Drill-bit</b> Ø8 mm (5/16") masonry	<b>Pilot-bit</b> Ø 2 mm wood (optional)
<b>Hole depth</b> 55 mm (50 mm anchor + 5 mm clearance)	Drill a pilot hole to the full length of the 35 mm screw (optional)
<b>Steps</b>	<b>Steps</b>
<ol style="list-style-type: none"><li>1. Hammer-drill perpendicular to surface.</li><li>2. Blow out or vacuum any dust from the hole.</li><li>3. Insert anchor through bracket, tighten 10 mm nut ( with 10mm wrench) until bracket no longer moves.</li></ol>	<ol style="list-style-type: none"><li>1. Drill 2 mm pilot hole to prevent splitting.</li><li>2. Drive self-tapping screw through bracket until washer is flush—<b>do not overtighten.</b></li></ol>

3 Final Safety Check

- Pull on the bracket—**no movement** means the anchors/screws are set.

**Tip:** If an expansion anchor spins, the hole is oversize—re-drill with a fresh **8 mm** bit.

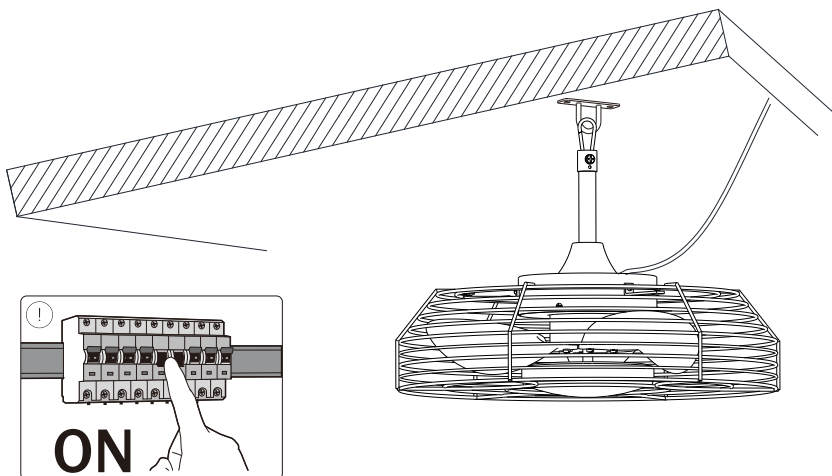

Make sure the installation is correct before turning on the power.

## 03.Remote control operation

### Power Specifications

Size	Voltage	Fan Power	LED Light	Color Temperature
19"	110–240V / 50Hz–60Hz	22W	24W	3000K / 4000K / 6000K

### Remote Control Functions

Icon	Button	Description
	Fan Off	Fan OFF button
	Light ON/OFF	Turns the light on or off.
	Natural Wind	Activates natural breeze mode.
1~6	Fan Speed	Adjusts fan speed (1 = low, 6 = high)
	Fan Forward / Reverse	Changes fan rotation direction.
	Silent mode	Long press the key to enter the mode
1H 2H 4H 8H 12H	Timer	Sets timer for 1H, 2H, 4H, 8H, or 12H.

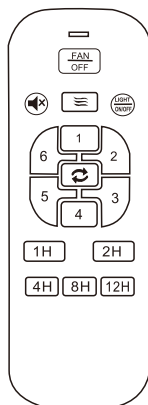

### Remote Re-Pairing Instructions

If your remote control loses connection with the fan, follow the steps below to re-establish the link:

After the black receiver is powered on, the music will ring. Within three seconds after the music is played press the "" fan stop button, and "ding" and "ding" will ring twice. The code matching is successful. When operating the memory function of the light and fan, it is required to press the key and wait for five seconds when the memory object is selected, then turn off the power and turn on the power switch again, so that the memory function can work normally.