

Installation Instructions

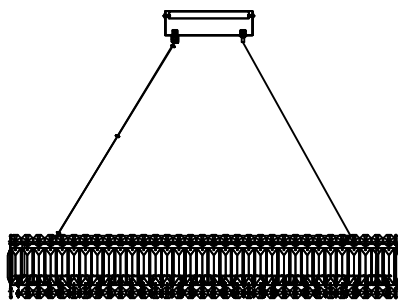

Packaging Schematic

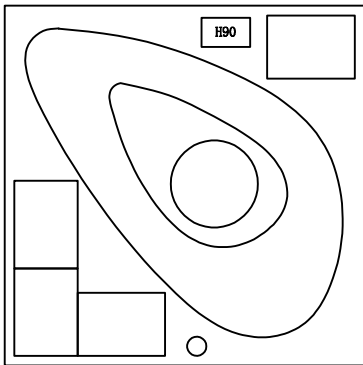
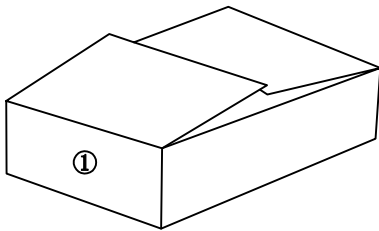

Internal packing list

1. Lamp stand body + crystal packing box + accessory kit

Before assembly

- ★ Please read all instruction steps carefully.
- ★Keep the instructions for future reference.
- ★Separate and list all parts and hardware.
- ★ Read each step carefully and follow the correct installation sequence.
- ★ To avoid losing fittings during the assembly process, we recommend that you complete the assembly work before
- ★Do not move the fixture and always place the product on a flat, firm, stable surface.
- ★Keep all small parts and packaging materials of this product away from infants and children as they may cause serious injury.

Email: [Lighting@yxtservice.com](mailto:Lighting@yxtservice.com)  
If you have any questions please contact us

★★★★★  
Five-star Rating

Thank you

Installation video with product url:

YouTube URL:<https://www.youtube.com/watch?v=wbl5urVJEao>

Scan the QR code to watch.



Accessory List

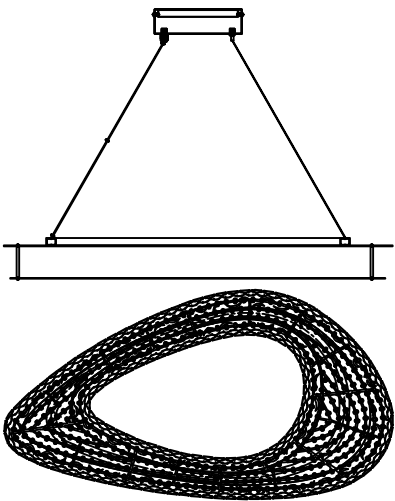

A.Main Lamp Holder-1pcs

- 22#Octagonal Beads Double Hole / Clear / 2PCS
- 22\*76 Rectangular piece with double holes /clear light/1PCS
- B (128/PCS)
- 14#Octagonal Beads Double Hole /Clear / 2PCS
- C (416/PCS)

① Ceiling tray assembly.

- (1)Take out the hanging plate and link with the wall.
- (2) Link the main power cable with the main cable of the light body and lock the ceiling plate.Installation is complete.

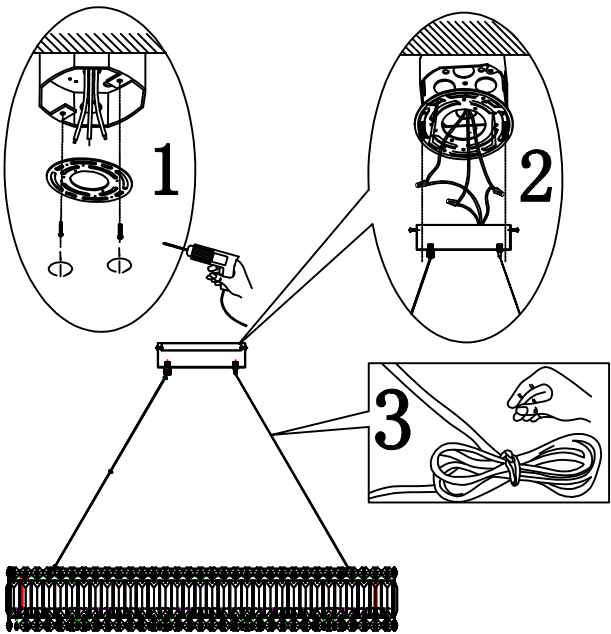

②Lamp body assembly.

- (1) Connect the power cord inside the lamp to the main power cord.
- (2.3)Hang the crystal in the slot.

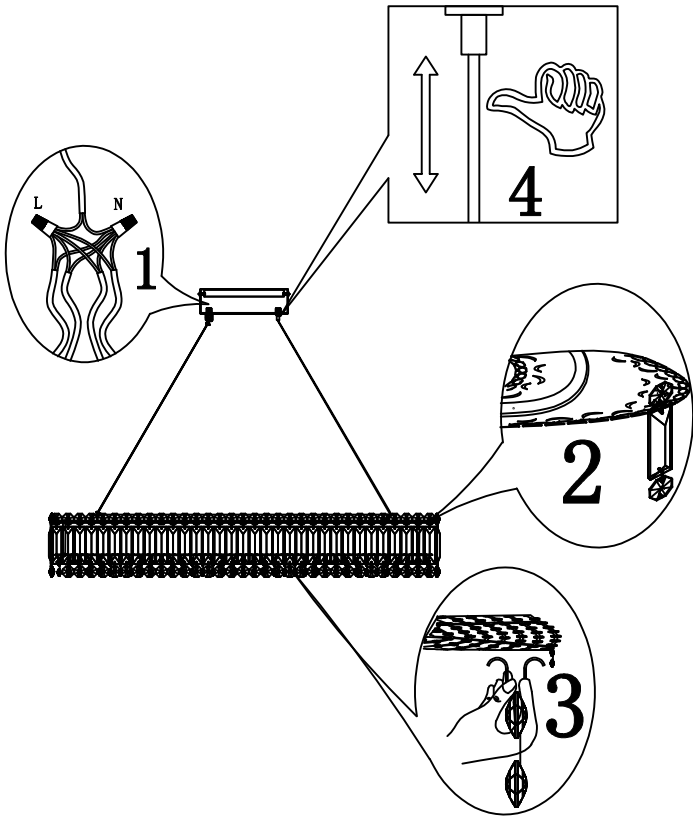

If dust is found in the crystal, wipe it with matching gloves