

Read this instruction carefully. See hardware and furniture part list for guidance. Be sure all parts are complete, before you assemble. Place all wooden furniture parts on a clean and flat soft surface to prevent from being scratched. Follow the figure to start assembling.

CAUTIONS : 1. Do not FULLY - TIGHTEN the nut or nut bolt until all nut or bolt is ready assembled.
2. Do not OVER - TIGHTEN the nut or bolt to avoid causing damages to the thread.
3. Keep all hardware parts out of reach of children.

NOTE : THE LIST AND QUANTITY SHOWN ARE FOR 1 UNIT ASSEMBLY.
Tool needed : Screwdriver & Rubbr Mallet (not provider).

PART LIST			
ITEM	DESCRIPTION	BOX	QTY
A	BACK	1	1 PC
B	LEG - LEFT	1	1 PC
C	LEG - RIGHT	1	1 PC
D	SUPPORT WOOD - FRONT	1	1 PC
E	SUPPORT WOOD - BACK	1	1 PC
F	SEAT	1	1 PC

HARDWARE LIST (BOX : 1)		
ITEM	DESCRIPTION	QTY
1	JCBC BOLT M6 x 45mm	4 PCS
2	JCBC BOLT M6 x 35mm	4 PCS
3	JCBC BOLT M6 x 20mm	4 PCS
4	M6 FLAT WASHER	8 PCS
5	M6 SPRING WASHER	12 PCS
6	WOOD SCREW M4 x 32mm	6 PCS
7	M4 ALLEN KEY (BALL SHAPE)	1 PCS
8	WOOD SCREW M4 x 25mm	4 PCS

STEP 1

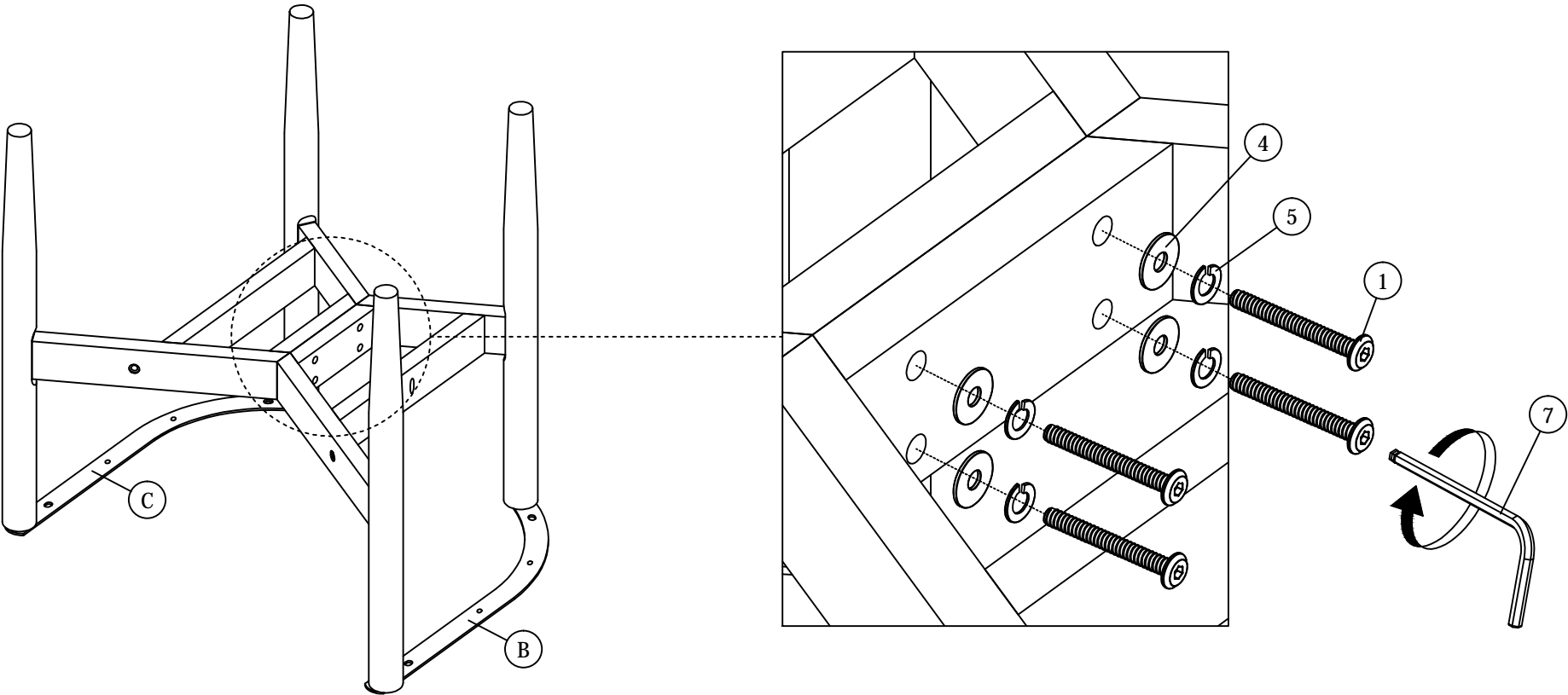

ASSEMBLY INSTRUCTIONS

2 of 3

STEP 2

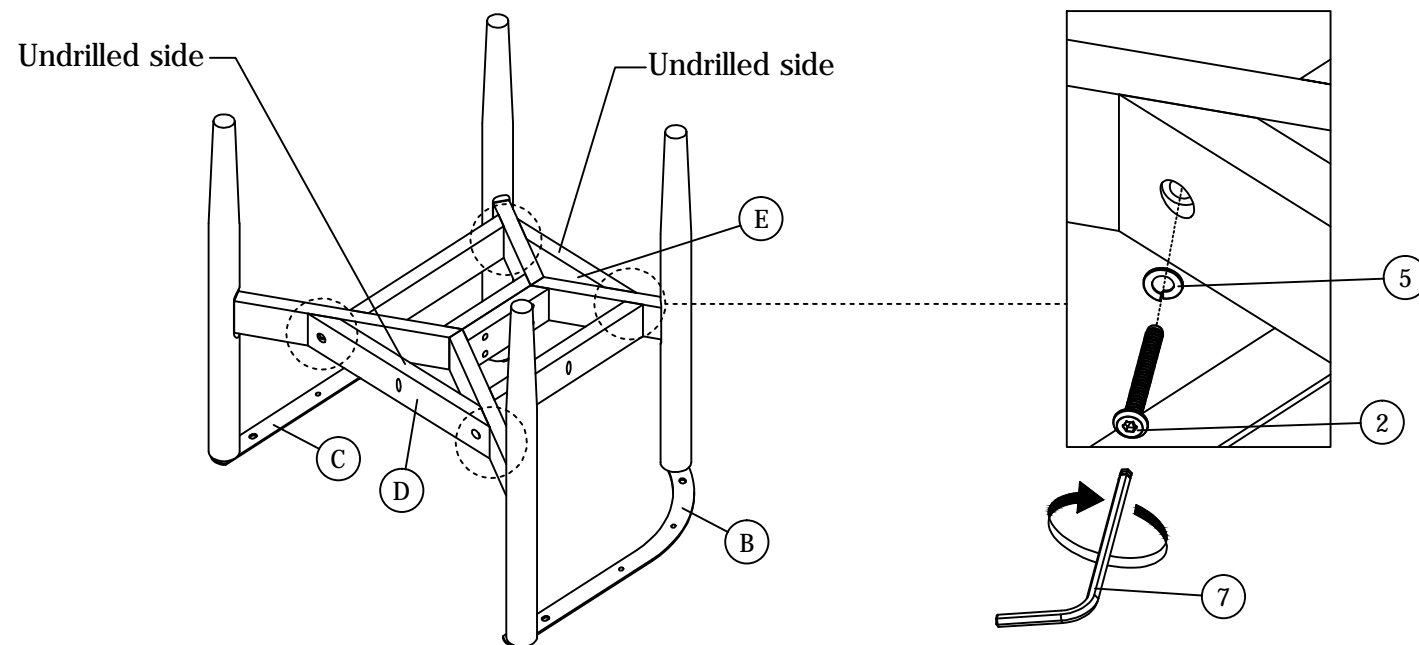

STEP 3

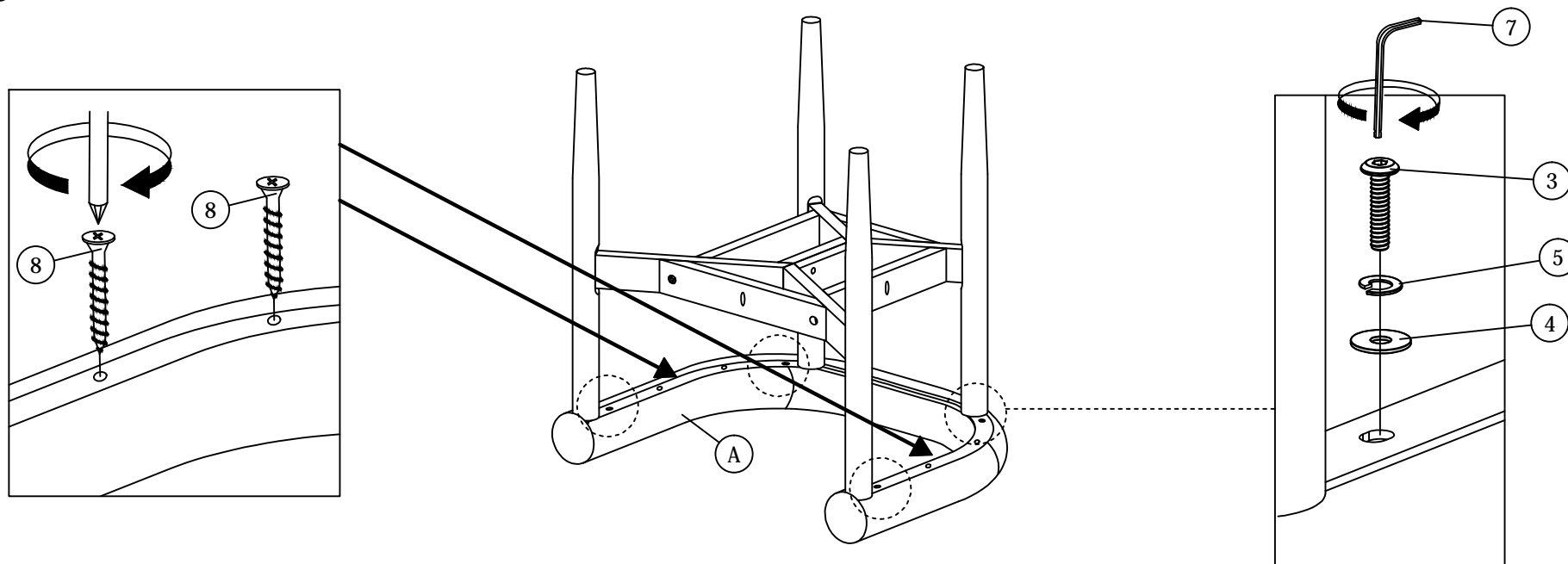

ASSEMBLY INSTRUCTIONS

3 of 3

STEP 4

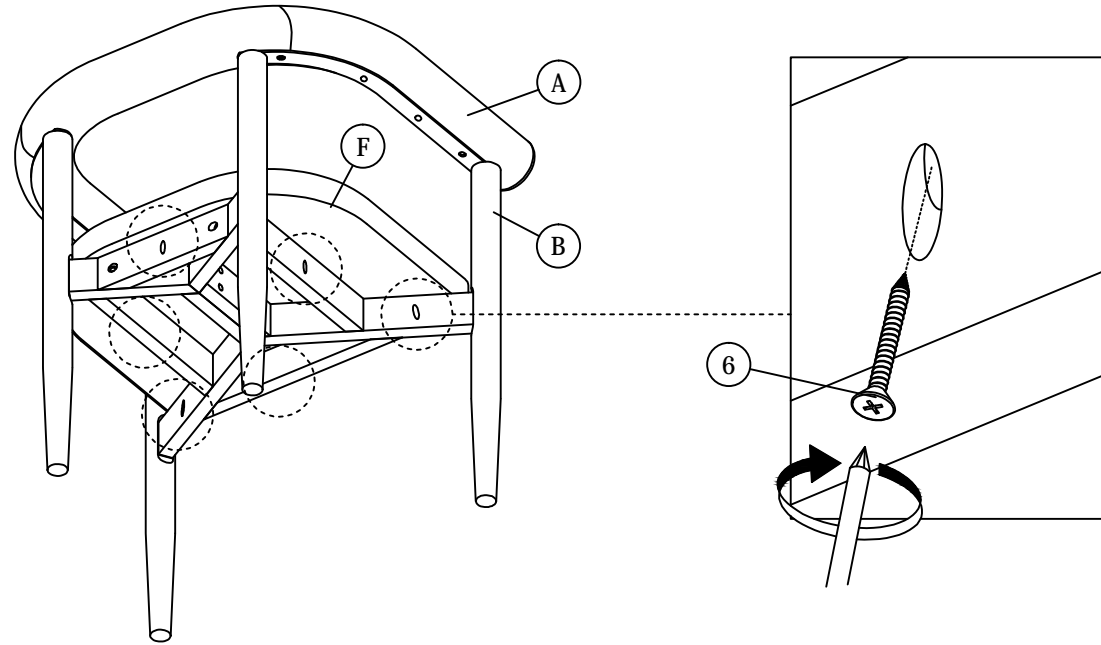

STEP 5

