

“ —————

*When you drag your tired body,
exhausted all the energy,back home.*

*If you have our recliner chair
with upholstery fabric and stylish
appearance,*

*I believe
that our chair can quickly help you
relieve the fatigue state,
and rejuvenated.*



WALL HUGGER

POWER RECLINER

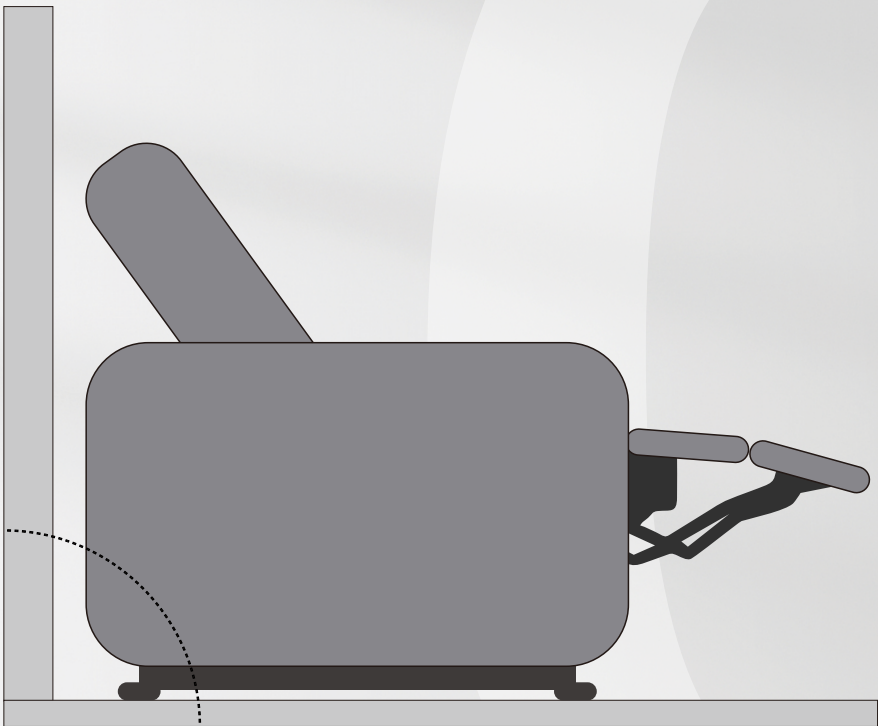

INSTALLATION INSTRUCTIONS

PACKAGE PARTS



- | | |
|-----------------|-----|
| ① Armrests | X 2 |
| ② Backrest | X 1 |
| ③ Seat base | X 1 |
| ④ Power adapter | X 1 |



SOFA INSTALLATION



Step 1: Install the right and left arms firmly as shown.



Step 2: Insert the metal clip as the above pic shows. Then insert the back to the seat firmly.

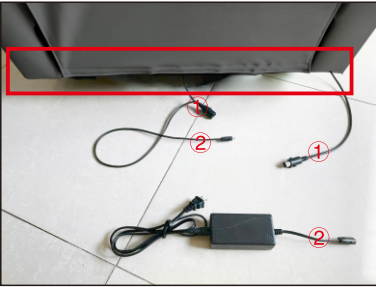

Step 3: Connect relative cords for side button and power adapter.
(There are 2 cords/jacks at the back of the seat base.① is for side button,and the ② is for power adapter.)



MAINTENANCE



- 1) To avoid being damaged, please carry and move the sofa carefully.
- 2) Wipe the dirt or dust away with sponge or clean cloth gently.
- 3) Do not put it in direct-sunlight area or in front of an air conditioner,because this will fade the upholstery and make it brittle.

WARNING



Keep kids away from the chair when in use.



No sitting on the back or extended footrest.



No sitting on the arm.



No jumping.
No standing up when the chair is reclined.

CUSTOMER SERVICE

Thank you very much for purchasing this product.
For any problems in installation and use,please reach us through the platform.
Our customer service will reply you with in 24 hours.

