

DREAMS

IDEA

Instruction Manual



DREAMS/DEA

NO:CH0049X

ABOUT US

*D*REAMSIDEA IS A ONE-STOP HOME

FURNISHING AND SERVICE COMPANY BASED IN USA.

WE ARE DEDICATED TO BRINGING YOUR DREAM HOME TO LIFE.

OUR SERVICES COVER FROM DESIGN, PRODUCTION,

DIRECT SELL, STORAGE, AND TRANSPORTATION.

IF REALITY IS THE NEAR SHORE

AND IDEALISM THE FAR SHORE,

*D*REAMSIDEA

AS THE FERRY BETWEEN THEM,

EAGER TO ACCOMPANY YOU ON A JOURNEY

TO YOUR IDEAL HOME.

ITEM NO.CH0049X

WARRANTY

WE STRIVE TO OFFER HIGH-QUALITY PRODUCT AND WE ALSO TRY OUR BEST TO SATISFY EACH CUSTOMER THAT ORDERS FROM US WITH PRODUCT OR SERVICE AS NEEDED. EACH CUSTOMER RECEIVES A RECORD OF THEIR ORDER, SUCH AS THE ORDER NUMBER OR ITEM RECEIPT. FOR ANY ITEMS THAT ARE OUT OF THE WARRANTY PERIOD, YOU MAY STILL RECEIVE REPLACEMENT PARTS BY PURCHASING THEM FROM OUR COMPANY IF THEY ARE AVAILABLE.

Are you having difficulty
with assembly? Missing parts?
Please contact us : info@firstopintl.com
Tel.5627813327

send an email with your order No. to us
For return, please check the return policy with
the retailer or market place you bought from.
Appreciate your purchasing from us.
Pop up your life by our furniture !

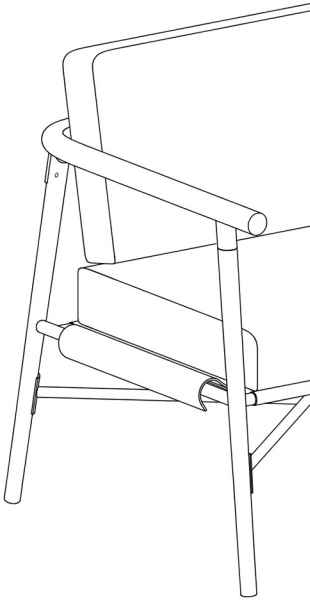

MAINTAINANCE AND WARNING

Please read the manual thoroughly before
you start install.

Please always use proper tools for
installment.

Packaging and small parts may have
chocking hazard, please keep them away
from children and pets.

Please clean the product with dry clean
cloth, some of the parts may be able to
wash directly. Check with the product
description!

Please keep the product away
from fire.

Please keep the product away from
sharp objects.

IF the product is placed under direct
sunlight, the pattern or color might
fade away.

Do not jump on the product.

Check the product periodically to make
sure everything is tightened.

If you have any questions else, please
contact us, we will be glad to help
you out.



Two people

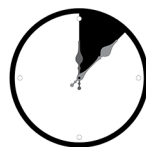

Around 45 min

PRODUCT DESCRIPTION

Choose between luxurious water resistant leather or breathable cotton fabric for a comfortable and durable option.

High density foam padding offers the perfect balance of softness and support for everyday comfort.

A strong, cross braced metal frame ensures stability and durability, built to last, with weight capacity of 250 lbs.

Equipped with adjustable foot pads to provide stability on different floor types, preventing wobbling.

Fresh, vibrant colors and a minimalist design make this chair a stylish addition to any space, easy to assemble and versatile.

Dream



House

EXPLODED VIEW

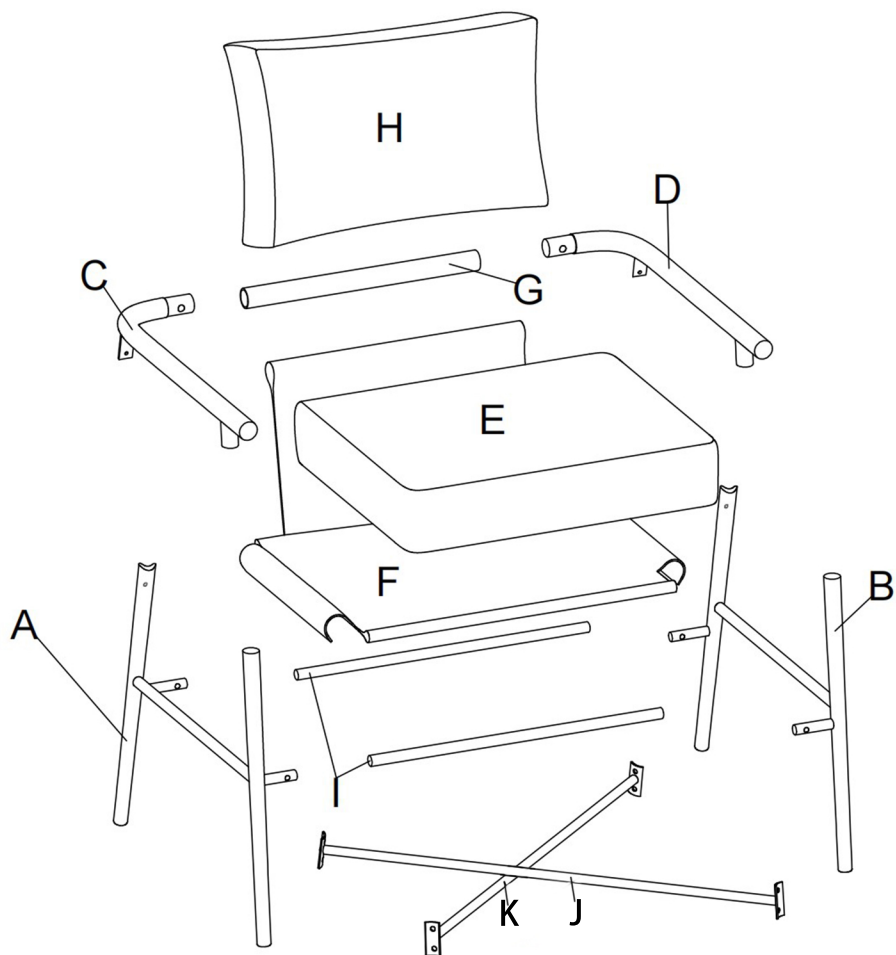

PARTS

A*1



Right leg

B*1



Left leg

C*1



Right arm

D*1



Left arm

E*1



Seat cushion

F*1

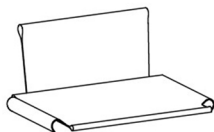

Cloth cover

G*1



Cross rail

H*1



Back cushion

I*2



Fine rail

J*1

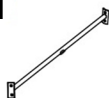

Support rail

K*1

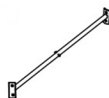

Support rail

HARDWARE

TOOL LIST

①*18



★ M6*15mm
Bolt

②*19



★ Flat washer

③*1



Allen key

④*1



★ M6*30mm
Bolt

PLEASE MAKE SURE ALL
HARDWARE&PACKING
MATERIAL FITTING THE LIST.

ESPECIALLY SOME SMALL
ACCESSORIES MAY BE MISSING
DURING TRANSPORTATION.

PLEASE CONTACT US
IF YOU HAVE ANY QUESTION.

NOTE: Designated with (★) We provide
additional spare parts in the hardware package

step 1

INSERT RIGHT ARM AND LEFT ARM (D & C) INTO THE RIGHT LEG AND LEFT LEG (A & B) AS SHOWN. MAKE SURE THEY ARE ALIGNED AND INSTALLED CORRECTLY.

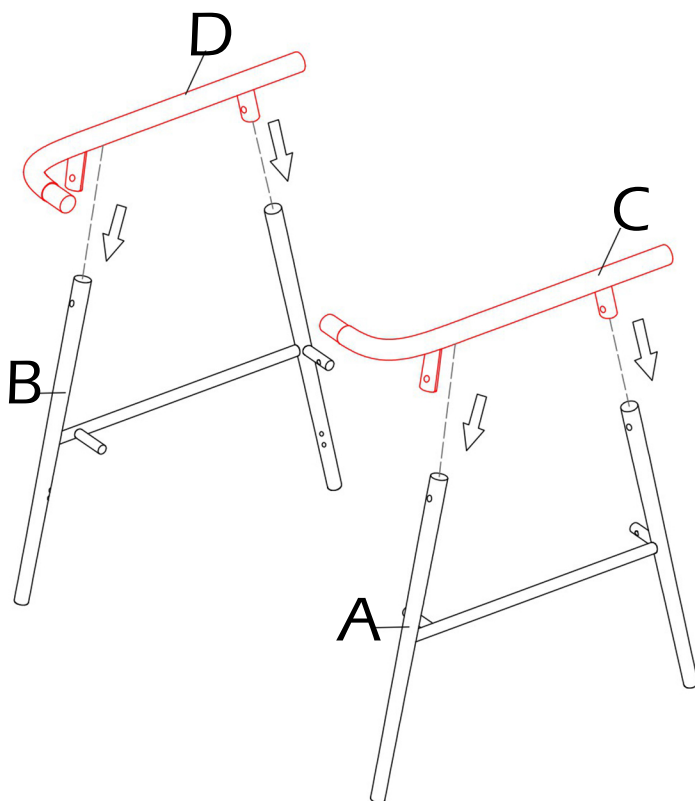

step 2

FIRST, ADD ONE WASHER (2) ON EACH SCREW (1) AS SHOWN, THEN ALIGN THE SCREW HOLES ON BOTH ARMREST AND CHAIR FOOT, THEN USE THE ALLEN WRENCH(3) PROVIDED TO TIGHTEN ALL SCREWS BY 30% -50% AT FIRST, ENSURING THAT ALL SCREWS ARE ALIGNED CORRECTLY BEFORE TIGHTENING ALL SCREWS.

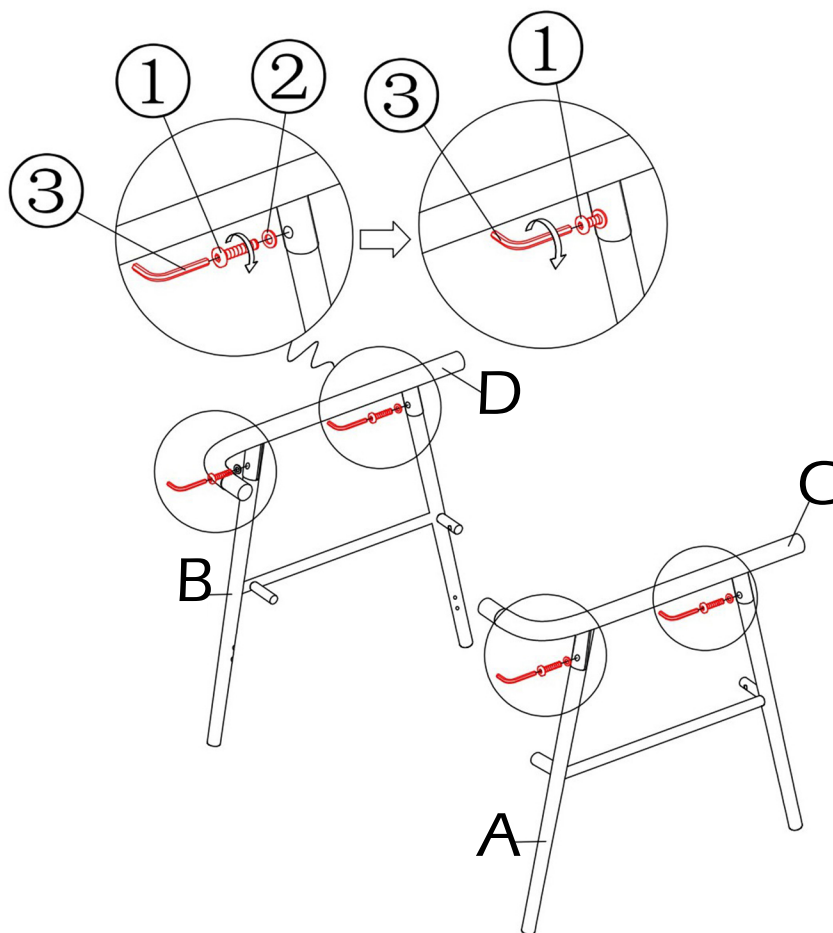

step 3

AS SHOWN IN THE FIGURE, FIRST LAY THE CHAIR FRAME FLAT ON THE GROUND, AND THEN CONNECT THE THREE FINE RAILS (I) AND ONE CROSS RAIL (G) TO THE LEFT ARM REST PART (C).

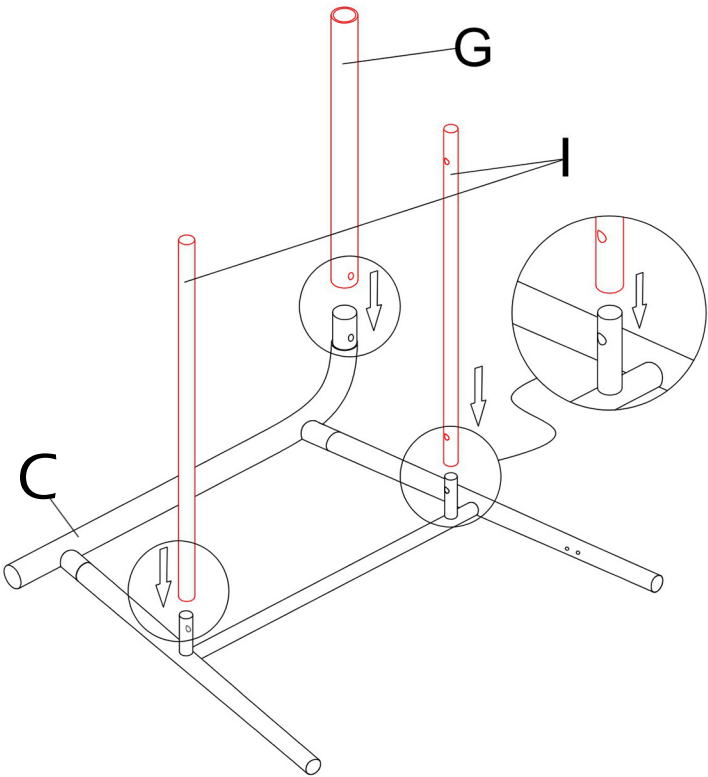

step 4

FIRST, ADD ONE WASHER (2) ON EACH SCREW (1) AS SHOWN, THEN ALIGN THE SCREW HOLES ON BOTH RAILS AND ARMREST PART, THEN USE THE ALLEN WRENCH(3) PROVIDED TO TIGHTEN ALL SCREWS BY 30% -50% AT FIRST, ENSURING THAT ALL SCREWS ARE ALIGNED CORRECTLY BEFORE TIGHTENING ALL SCREWS.

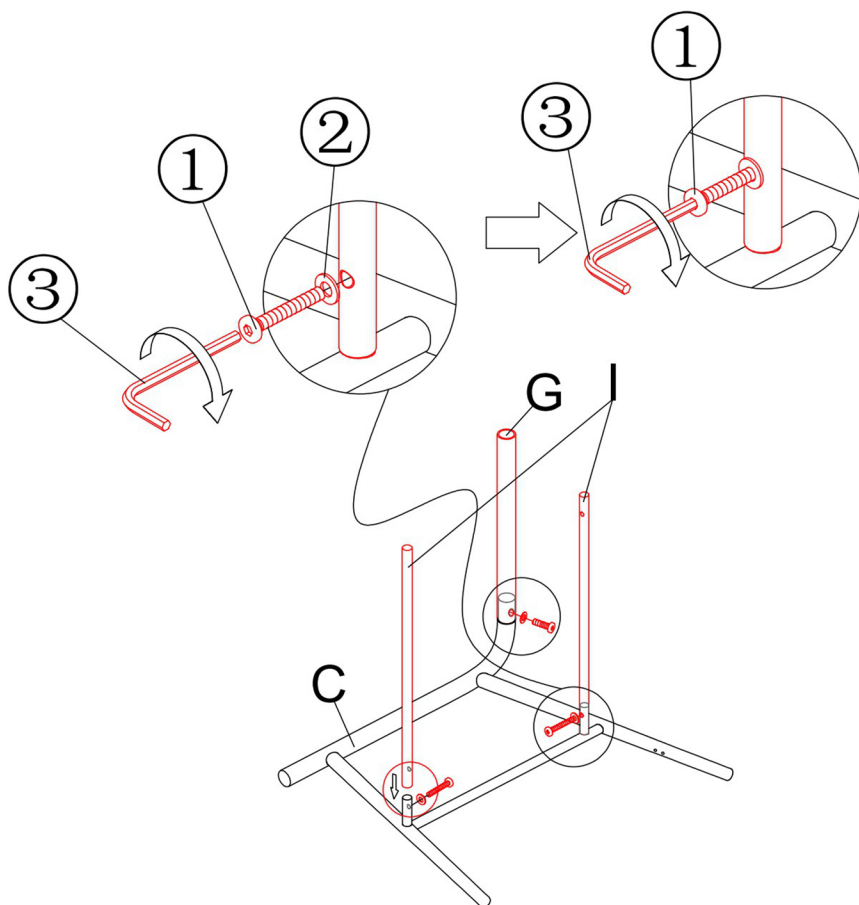

step 5

ALIGN THE RAILS WITH THE HOLES ON THE CLOTH COVER (F) AS SHOWN, THEN INSERT ALL RAILS IN TO THE CORRESPONDING HOLES, MAKE SURE THEY ARE ALIGNED CORRECTLY.

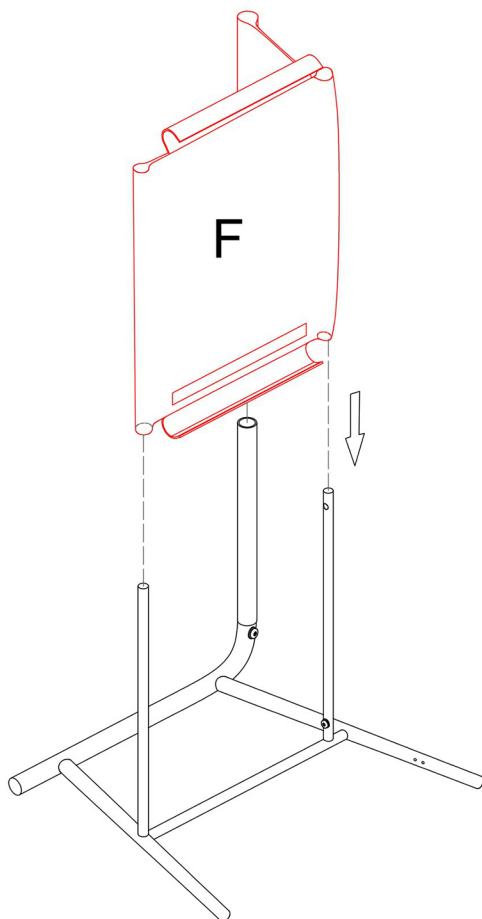

NOTE:PLEASE NOTICE, THE FACE WITH VELCRO TAPE IS THE BOTTOM OF THE CLOTH COVER.

step 6

CONNECT THE RIGHT ARMREST PART (B) WITH THE PREVIOUS PARTS AS SHOWN,
MAKE SURE THEY ARE ALIGNED.

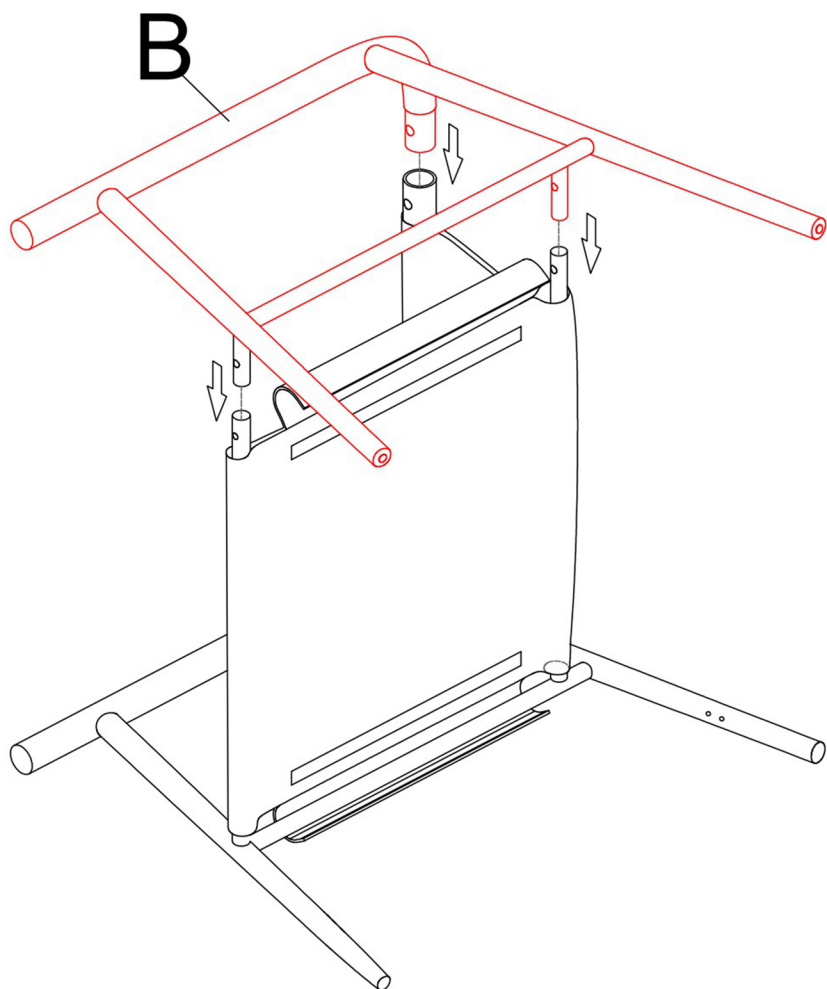

step 7

FIRST, ADD ONE WASHER (2) ON EACH SCREW (1) AS SHOWN, THEN ALIGN THE SCREW HOLES ON BOTH RAILS AND ARMREST PART, THEN USE THE ALLEN WRENCH(3) PROVIDED TO TIGHTEN ALL SCREWS BY 30% -50% AT FIRST, ENSURING THAT ALL SCREWS ARE ALIGNED CORRECTLY BEFORE TIGHTENING ALL SCREWS.

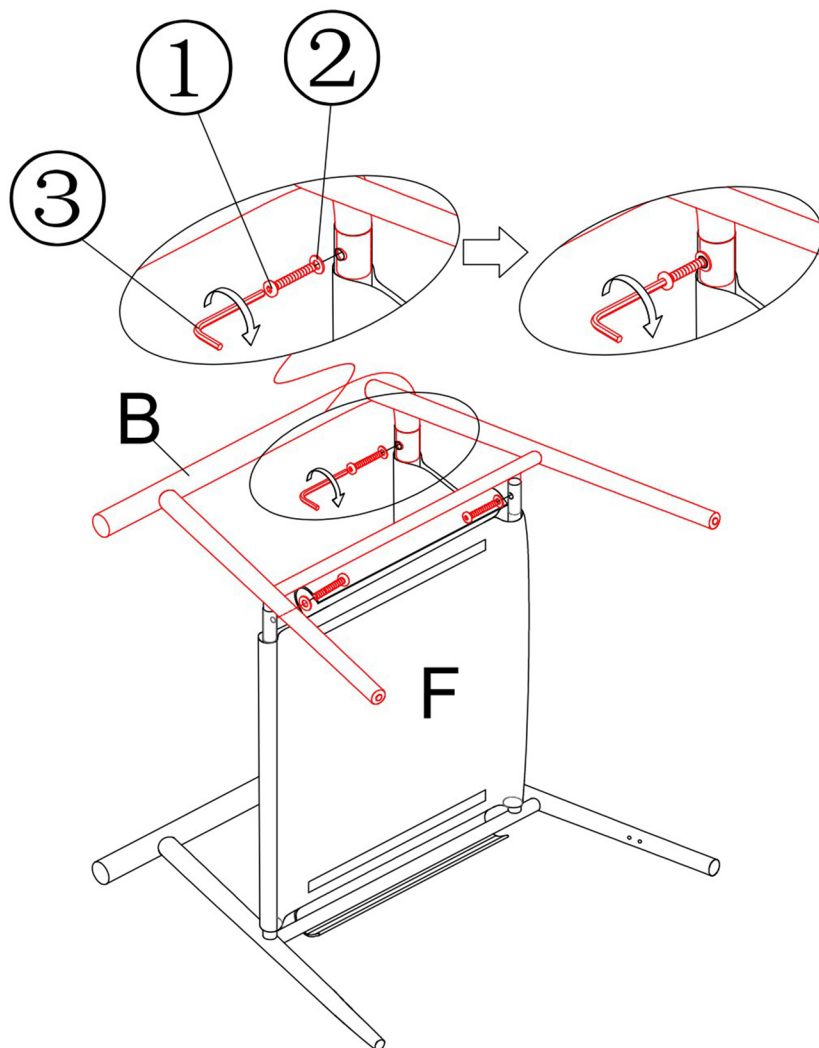

step 8

STICK THE VELCRO COVER UNDERNEATH THE CLOTH COVER (F) AS SHOWN.

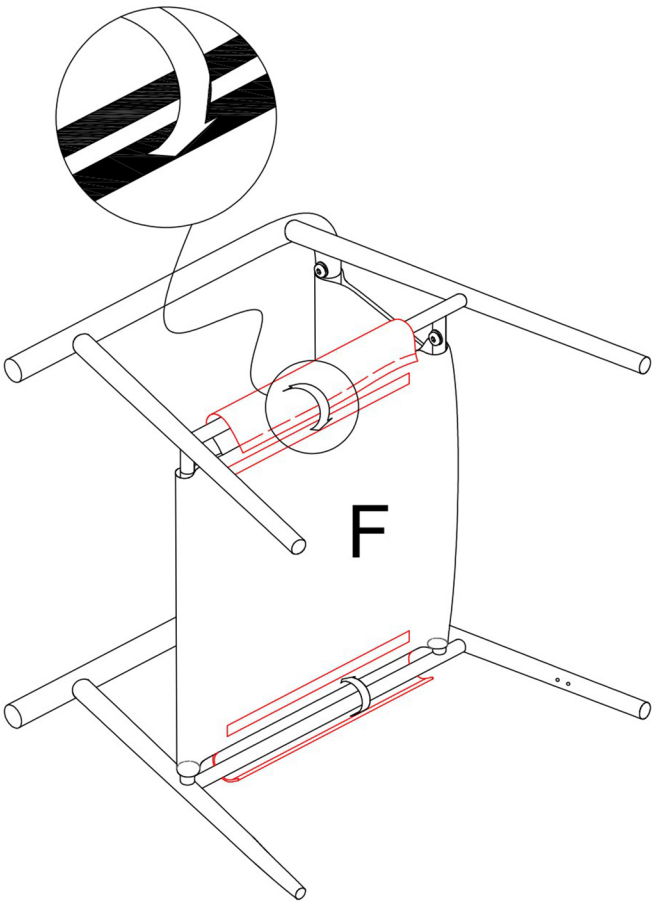

step 9

FIRST, ADD ONE FLAT WASHER (2) ONTO EACH BOLT (1), THEN USE THE ALLEN WRENCH (3) PROVIDED TO CONNECT TWO SUPPORT RAILS (J)&(K) IN CROSS SHAPE ONTO THE CHAIR LEGS AS SHOWN. THEN USE THE BOLT (4) TO FIX BOTH OF THE RAILS ON THEIR CROSS POINT, MAKE SURE ALL THE BOLTS ARE CORRECTLY ALIGNED.

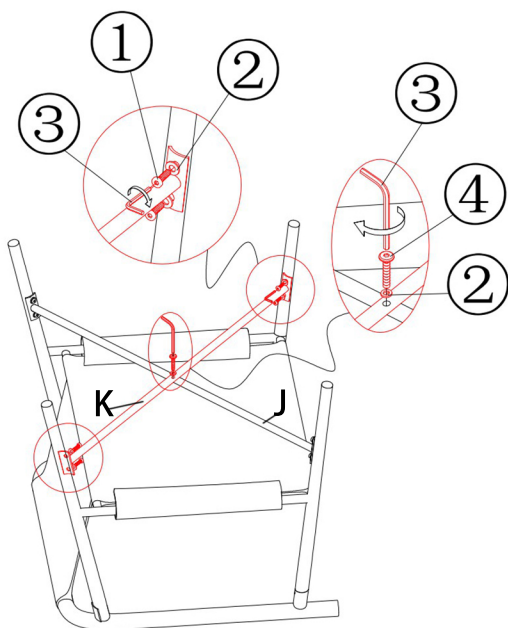
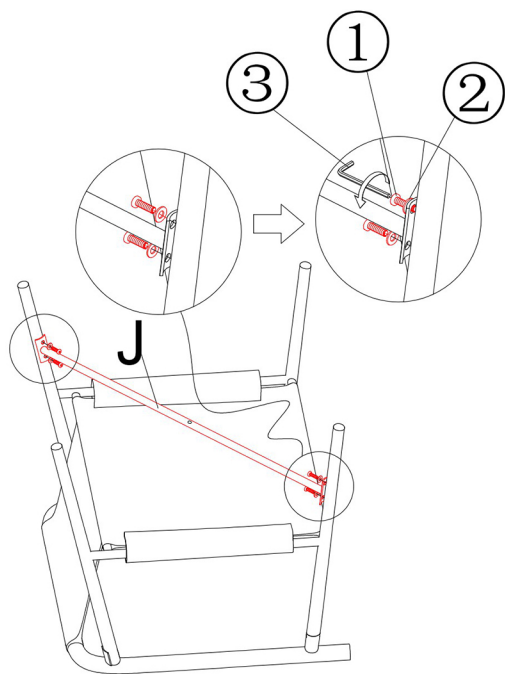

step 10

PLACE THE SEAT CUSHION (E) ONTO THE CHAIR.

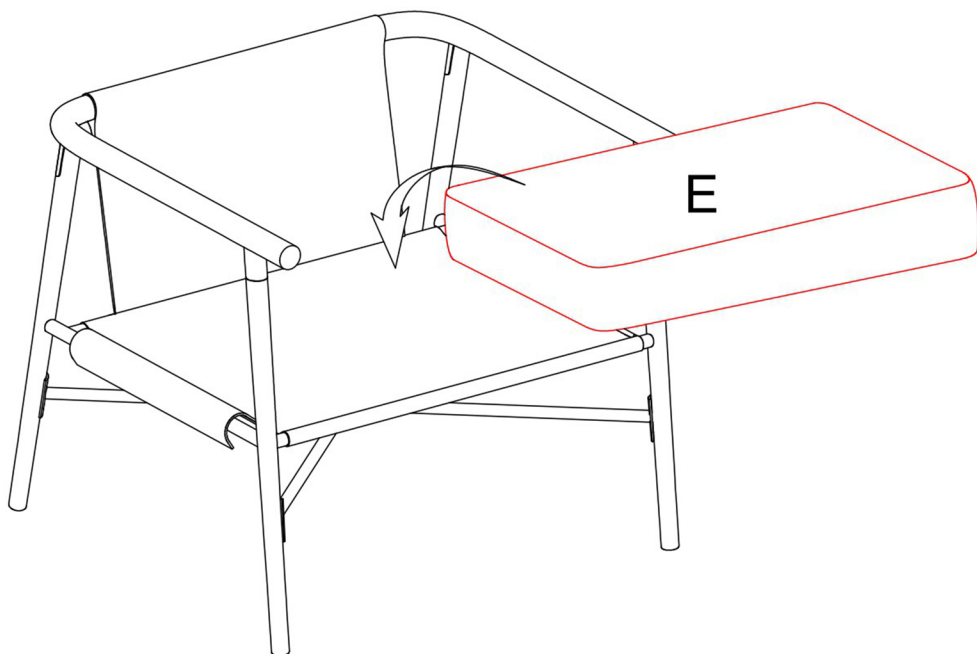

step 11

PLACE THE BACK CUSHION (H) ONTO THE CHAIR.

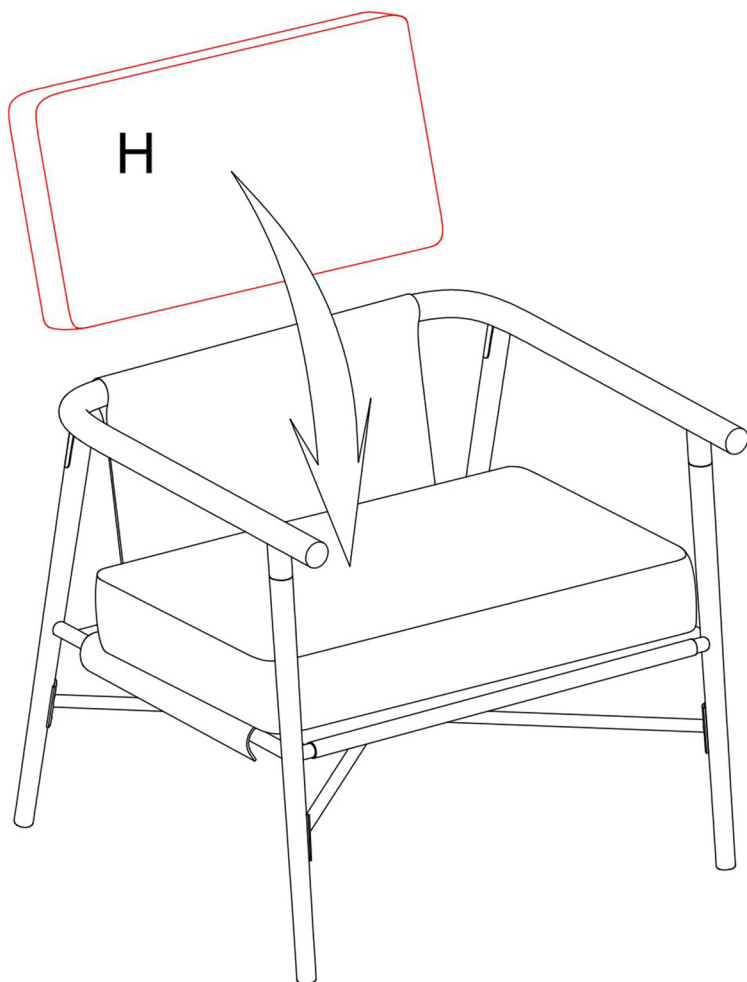



ASSEMBLY INSTRUCTIONS

Tel.5627813327

Please contact us: info@firstopintl.com

<https://www.dreamsidea.com>