

WARRANTY

We strive to offer high-quality product and we also try our best to satisfy each customer that orders from us with product or service as needed.

Each customer a record of their order such as the order number ,or item receipt for any items that are out of the warranty period you may also still receive replacement parts by purchasing them with our company if they are available.

If you are having difficulty while using our product or during assembly, please feel free to contact us.

Email Address: info@firstopintl.com

Telephone number: (562)-781-3327

Send us an email with your order number, please describe the problem you are encountering, or attach pictures of the problem, we will respond you as soon as possible.

If you are returning your product, please check the return policy with the retailer, or the website you bought from.

Thank you for shopping from us, we treat every customer as our friend, hope to see you in near future.



ITEM NO.S-CS0003-ARM CHAIR

NOTE:

This instructions contains IMPORTANT safety info. Please read before installation and keep it for future reference.

MAINTAINANCE AND WARNING

- 1. Keep the furniture away from fire
- 2. Keep the furniture away from sharp objects
- 3. DO NOT clean the furniture with irritant chemicals, cleansers or polish. DO NOT use detergents, solvents, abrasives, spray packs or leather cleaner. Please use soap with warm water to clean(1:10 soap to water)
- 4. IF place the furniture direct under sunlight, the pattern or color might fade away.
- 5. DO NOT jump on the furniture, for your own safety concerns.
- 6. Packaging and small parts have CHOKING HAZARD, please keep them away from children.
- 7. Please follow the instructions to assemble, and use the furniture properly, if you have any questions, Please contact us.



WEIGHT
CAPACITY
400LBS

PARTS LIST

A*1

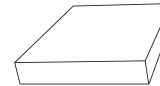

Sofa frame

C*1

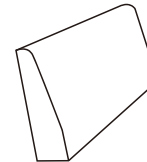

Armrest frame

E*1



Armrest cushion

G*1



Pillow

B*1

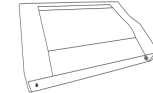

Back frame

D*1



Back cushion packed
in compression bag x1

F*1

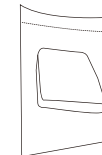

Seat cushion packed
in compression bag x1

HARDWARE and TOOL LIST

H*4



Legs

I*1



Hook

J*8



Screw&shim&Hex nuts
One of them is a backup

K*1



Hexagon socket wrench
M17*85

***Make sure you have everything in the box before assemble. Be aware of the small parts, do not let children use or touch, CHOKING HAZARD. If anything is missing, please contact us.**

ASSEMBLY INSTRUCTIONS

step1

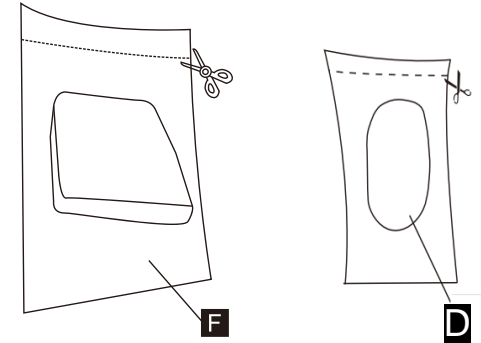

Take out the cushions(D & F)from air compression bag and wait for it to recover, it takes up to 24 hours to be fully recovered, you may gently slap on it to speed up the process.

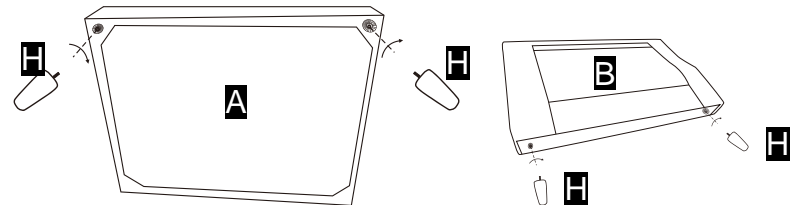

Place the sofa frame (A) upside down on a clean surface , align the wooden legs(H) to the holes on each corners as shown, and twist in clockwise, make sure they are all fully tightened before next step.

step2

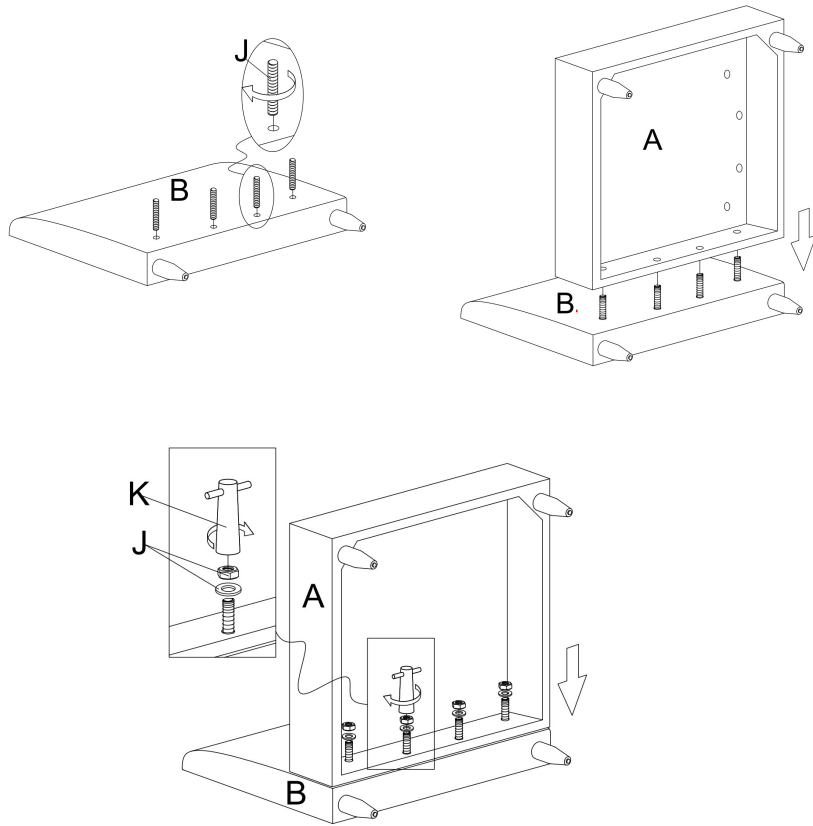

Using hand to twist four bolts(J) into the holes on back frame as shown, make sure all bolts are twisted in. Then align the holes on seat frame(A) with the bolts on the back frame(B) as shown. Use the hexagon socket wrench(K) provided to tighten them with the bolt nuts, make sure all the nuts are fully tightened on the bolts.

step3

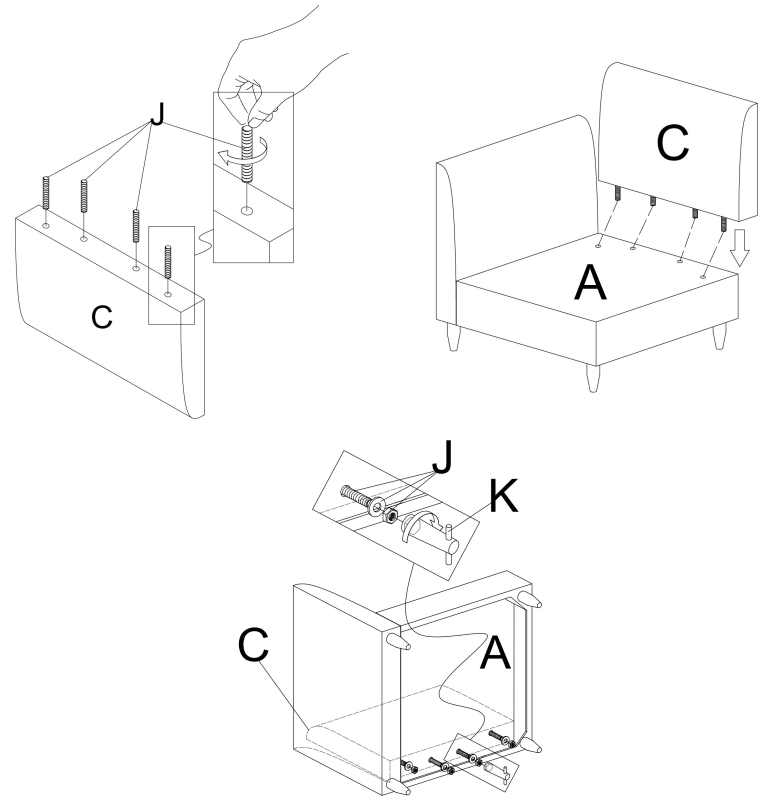

Using you hand to twist the bolts (J) into the holes on the armrest (C) as shown, then insert the bolts into the seat frame (A) as shown. Make suer all the bolts are correctly aligned, then use the hexagon socket wrench (K) provided to tighten the bolts and bolt nuts (J) from the bottom of the seat frame, make sure they are fully tightened before next step.

step4

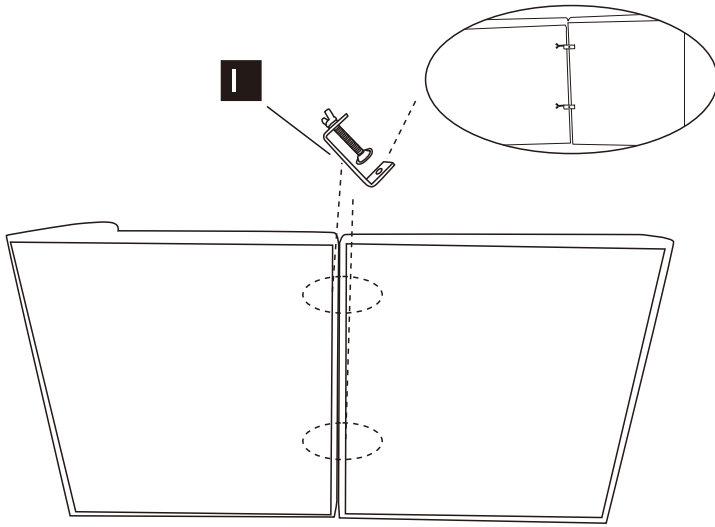

There is a metal connector for armless sofa and corner sofa, you may use it when you need to connect both sofa together. Place the sofas on their sides as shown, and place the connectors on the frames of both sofas and tighten the connectors. There is a sponge part outside the frame of the sofa, so please twist as tight as you could when you use the connectors.

step5

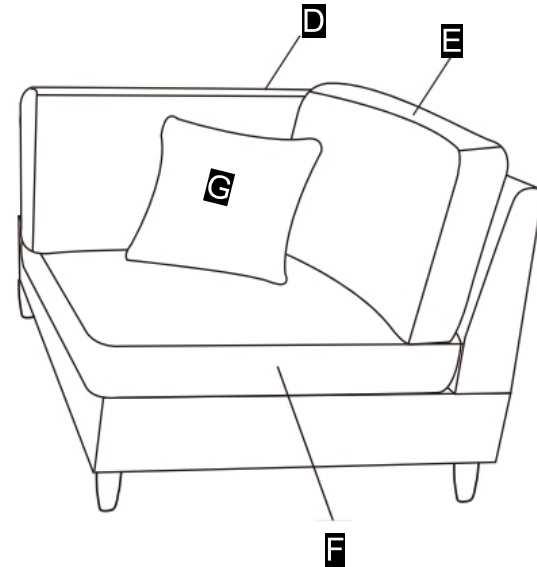

Clean up the excessive threads on sofa. Take off the Velcro tape cover on the bottom of the cushion, and align the edge with the sofa before placing it on. Then place the armrest cushion and back cushion onto the sofa.