

ASSEMBLY INSTRUCTION
ITEM:N715P243100
CANOPY

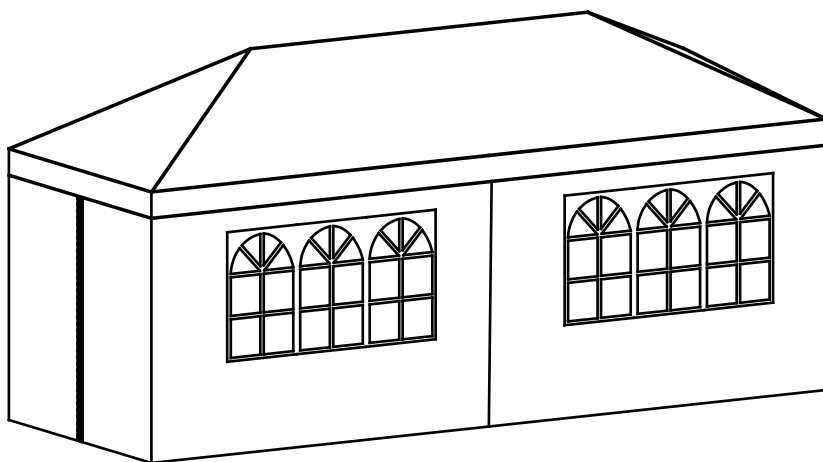

ASSEMBLY INSTRUCTION

ITEM: N715P243100

Please read this instruction manual carefully before attempting to install.



We recommend 2 or more people to install.



The expected assembly time is 0.5 h.



Not intended for use by children.



Keep away from fire or other heat sources.



We recommend wearing protective gloves.

Please follow the instruction manuals and use a pad to avoid damage during assembly.

Unpack and take out the canopy fabric and the frame storage bag. Other parts are packed in the frame storage bag, please take them out for further assembly.





Note: Please do not use a knife when unpacking to avoid cutting the product and parts accidentally.

ASSEMBLY INSTRUCTION

ITEM: N715P243100

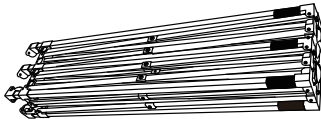
Part List

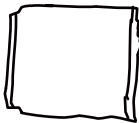
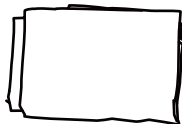
N715P243100

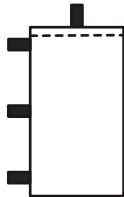
<p>1 Canopy Frame -1pc</p> 	<p>2 Canopy Top -1pc</p> 
<p>3 Roller Bag -1pc</p> 	<p>A Sidewall with Zipper -2pcs</p> 
<p>B Sidewall with Window -4pcs</p> 	<p>C Rope -6pcs</p> 
<p>D Stake -12pcs</p> 	<p>E Sand Bag -4pcs</p> 

ASSEMBLY INSTRUCTION

ITEM: N715P243100

STEP 01

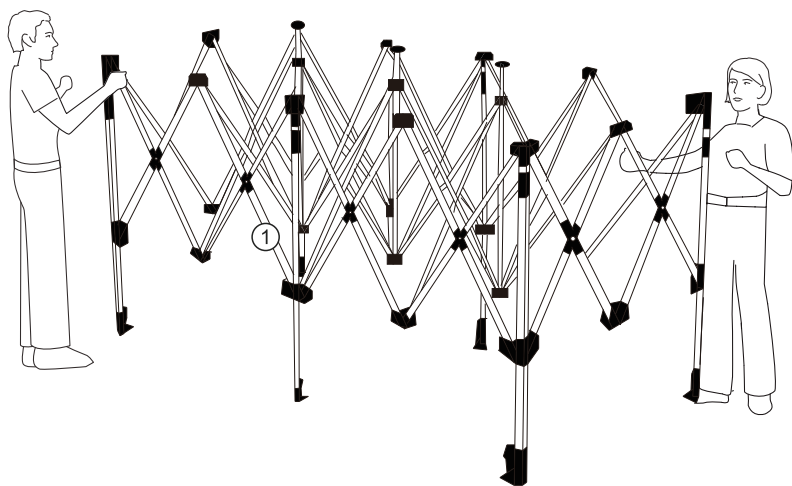

ASSEMBLY INSTRUCTION

ITEM: N715P243100

STEP 02

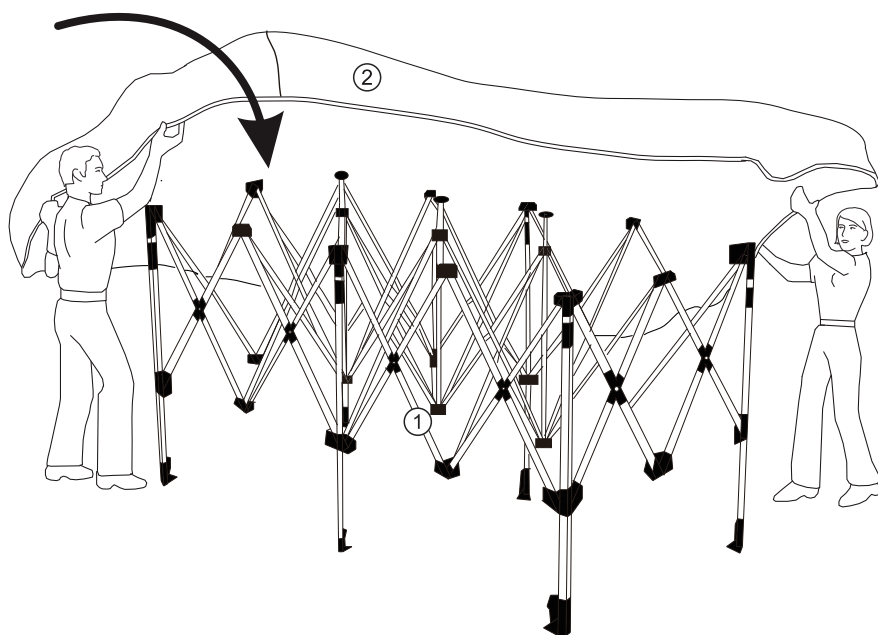

ASSEMBLY INSTRUCTION

ITEM:N715P243100

STEP 03

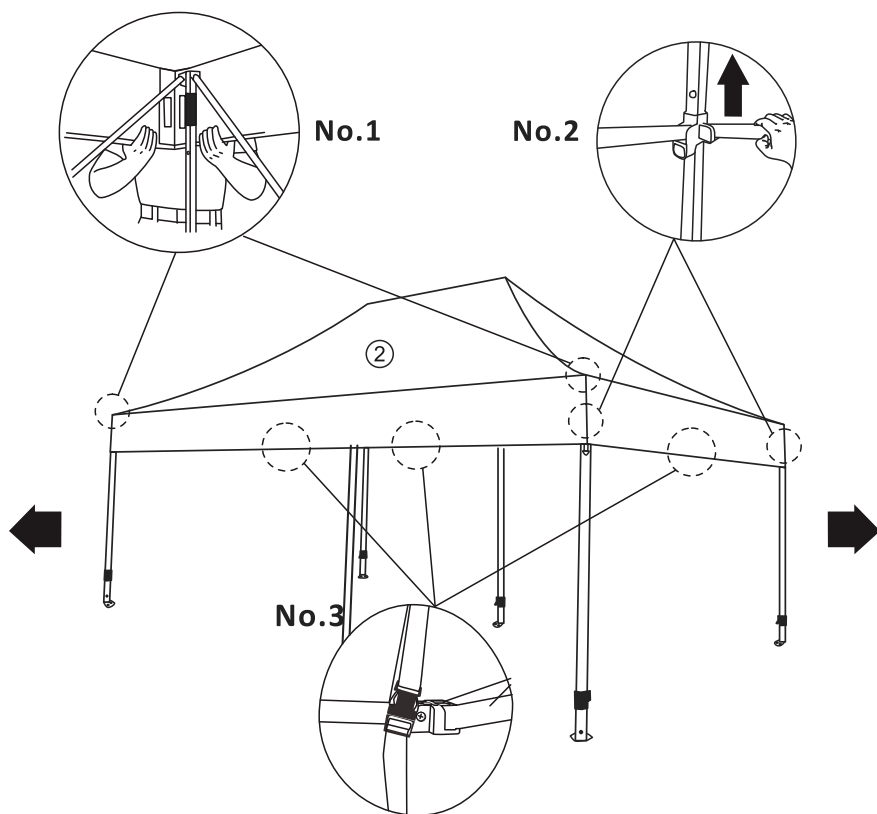

ASSEMBLY INSTRUCTION

ITEM: N715P243100

STEP 04

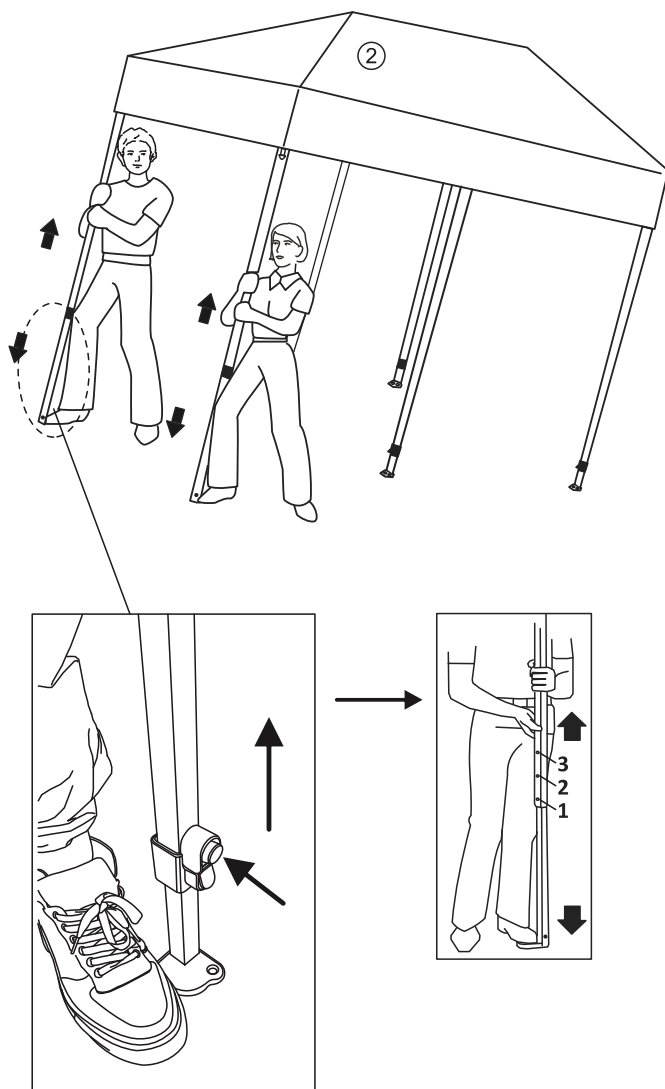

ASSEMBLY INSTRUCTION

ITEM: N715P243100

STEP 05

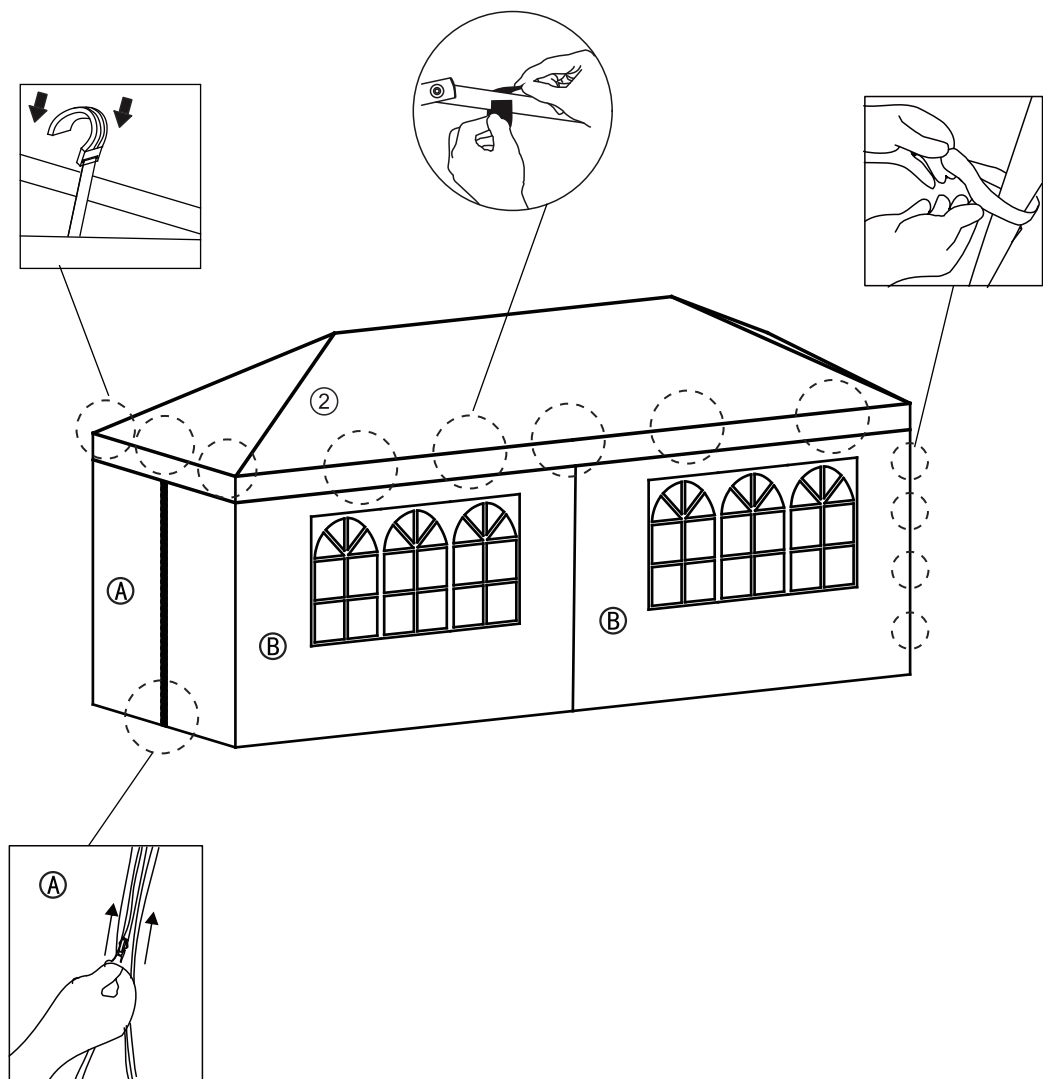

ASSEMBLY INSTRUCTION

ITEM: N715P243100

STEP 06

