

ASSEMBLY INSTRUCTIONS

FOLDING BAR CART WITH TWO DETACHABLE TRAYS

A Bar Cart



1 pc

B Tray



2 pcs

C Caster



4 pcs

D Allen Key
5/32" x 2-1/4"



1 pc

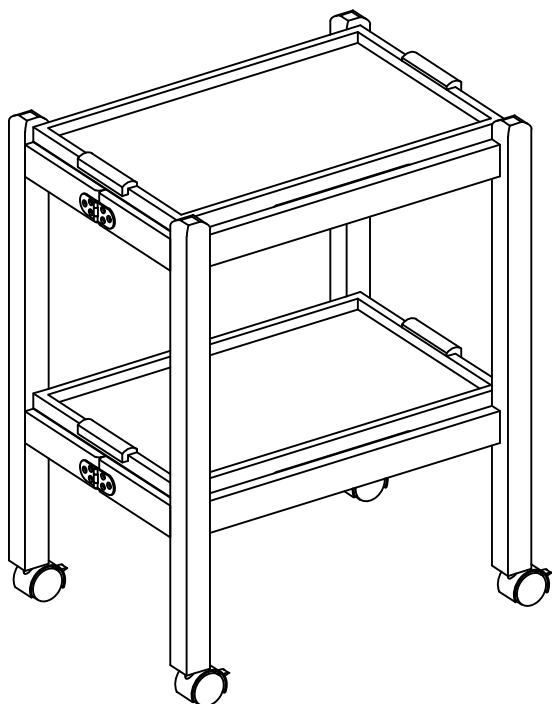

This page lists all the contents included in the box. Please take the time to identify the hardware as well as the individual components to this product. As you unpack and prepare for assembly, place the contents on a carpeted or padded area to protect them from damage.

- 1** Stand the Bar Cart (A) upright and open the hinges.

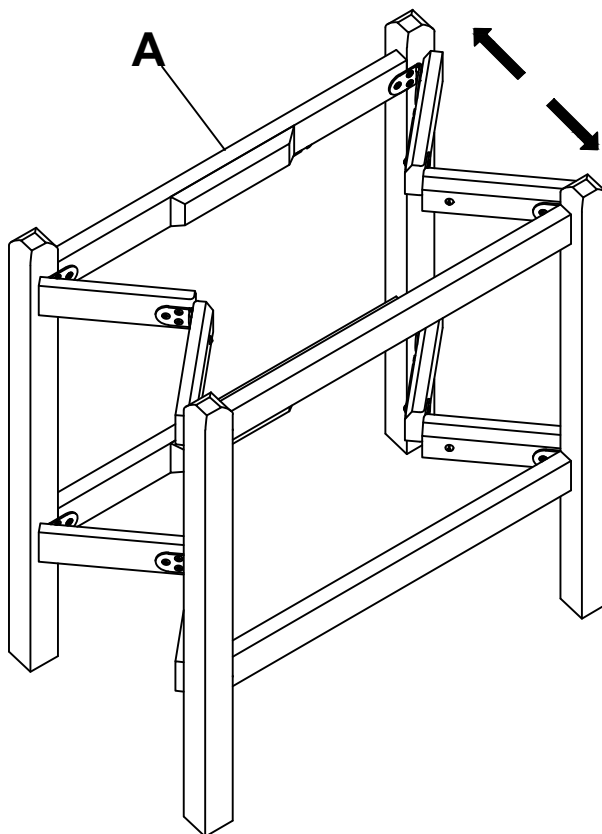

- 2** Loosen the screws on the Bar Cart (A) with a screwdriver. Then turn the lock forward and tighten the screws with a screwdriver (not provided).

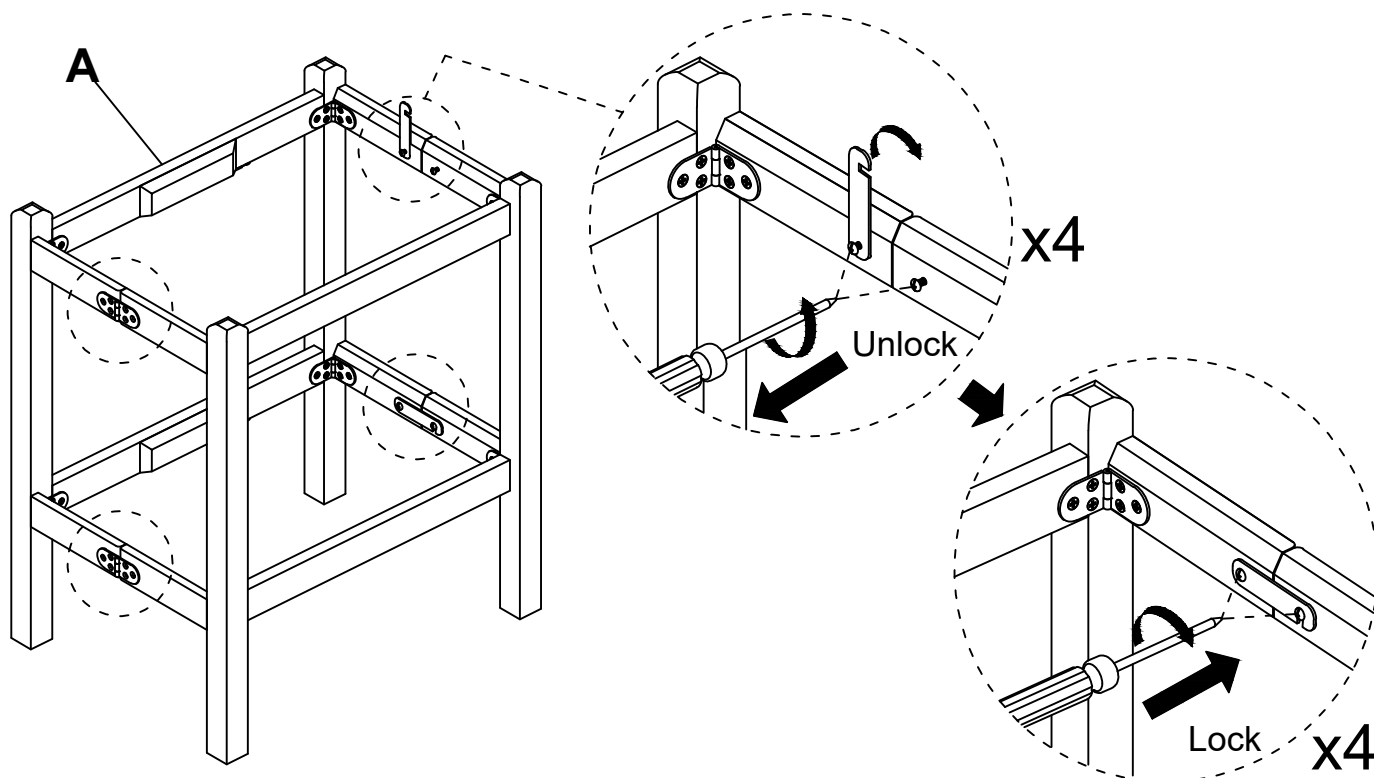

- 3** Place the Bar Cart (A) flat on a carpet or soft mattress to avoid scratching the surface. Then insert the Caster (C) into the bottom of the Bar Cart (A).

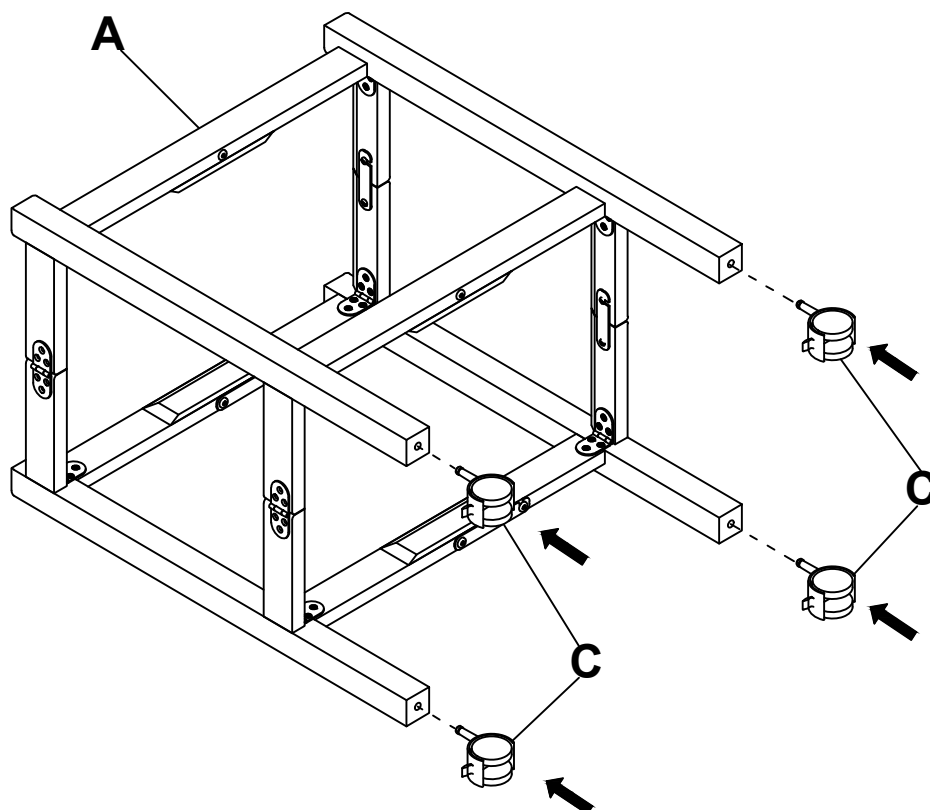

- 4** Place the Tray (B) on the support positions on the Bar Cart (A).

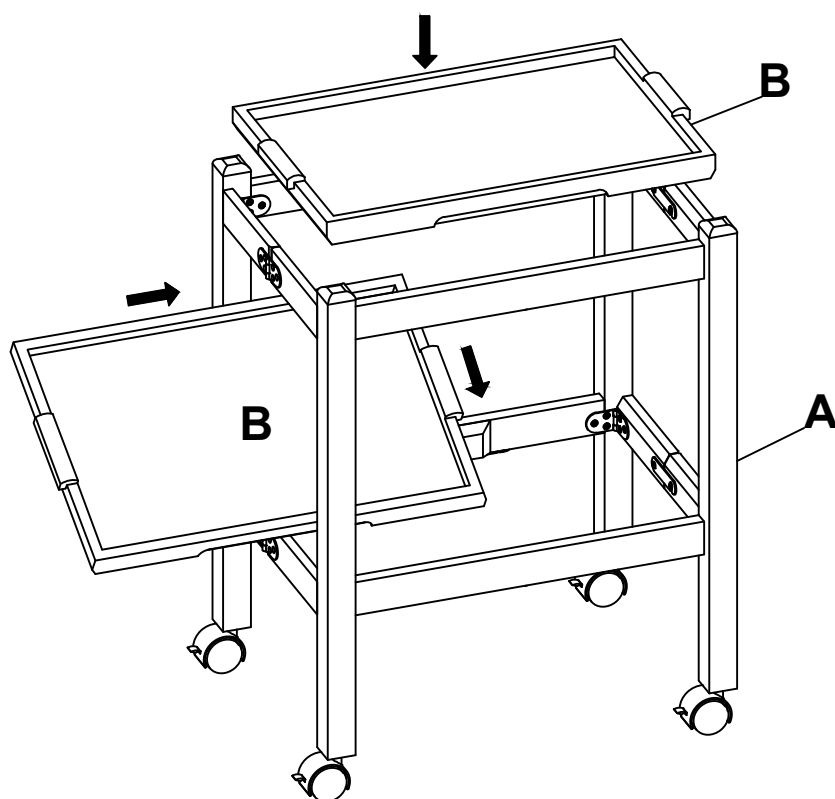

5 Push down to lock the Caster (C).

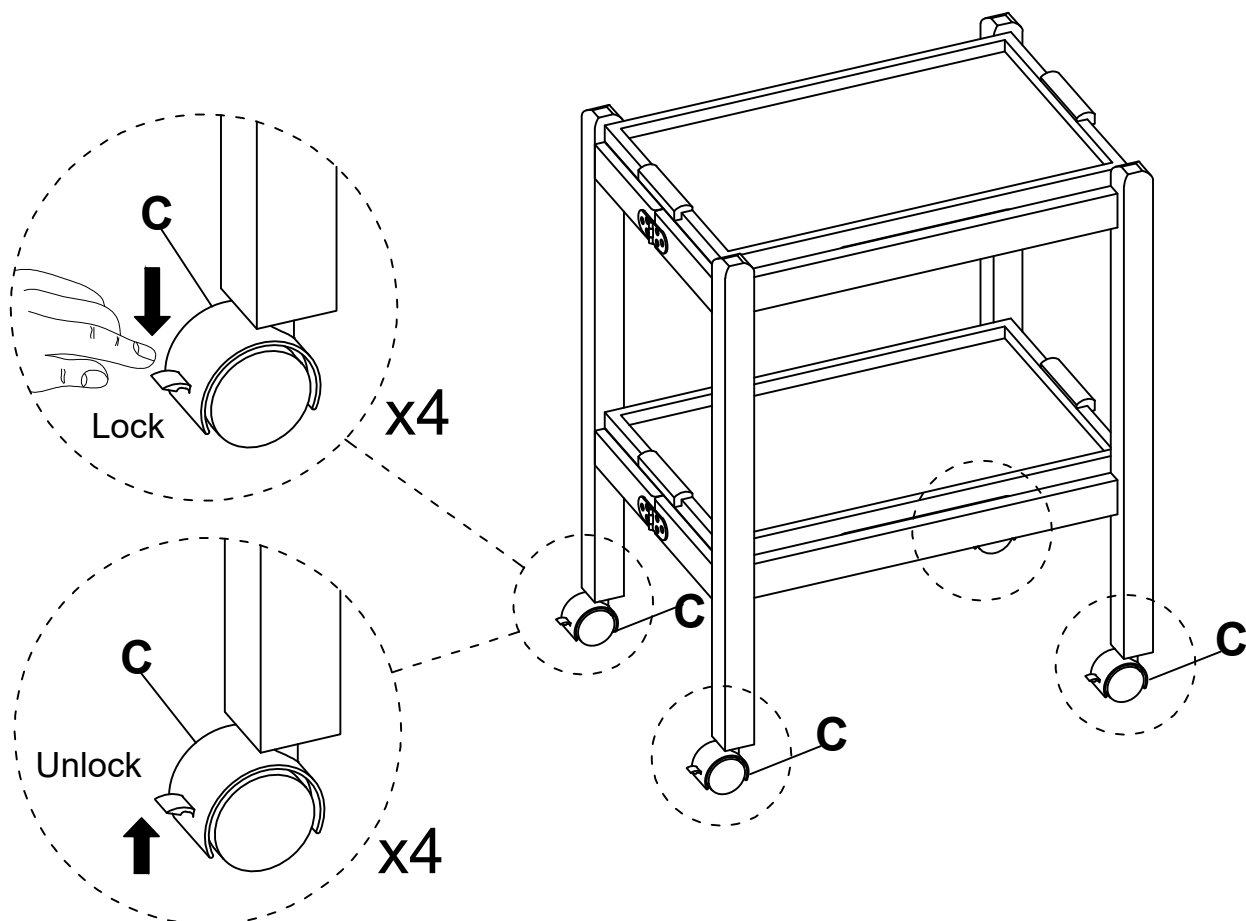

6 When not in use, the Bar Cart can be folded for easier movement. Unlock it with the Allen Key (D) as shown, then place the Tray (B) inside the Bar Cart (A).

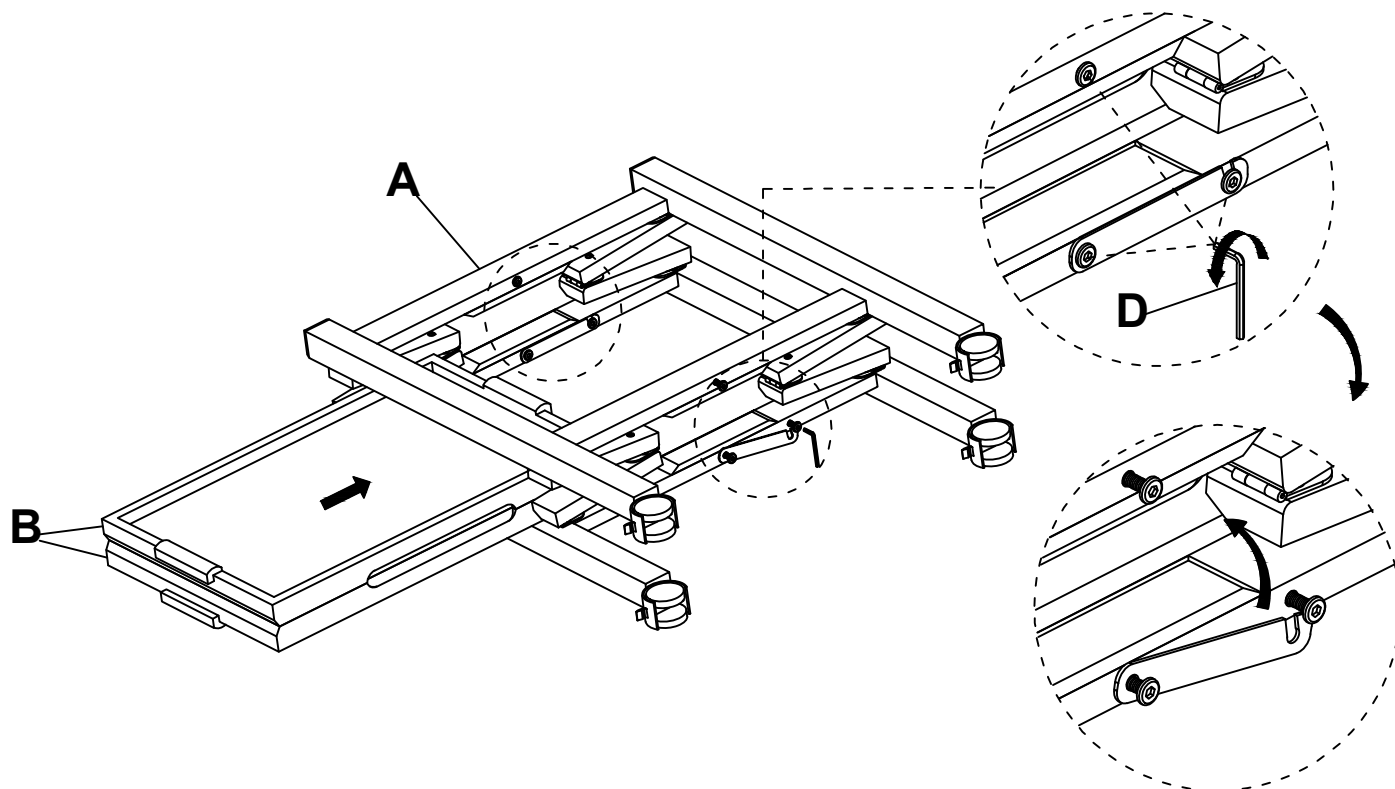

7 Lock the Bar Cart with the Allen Key (D).

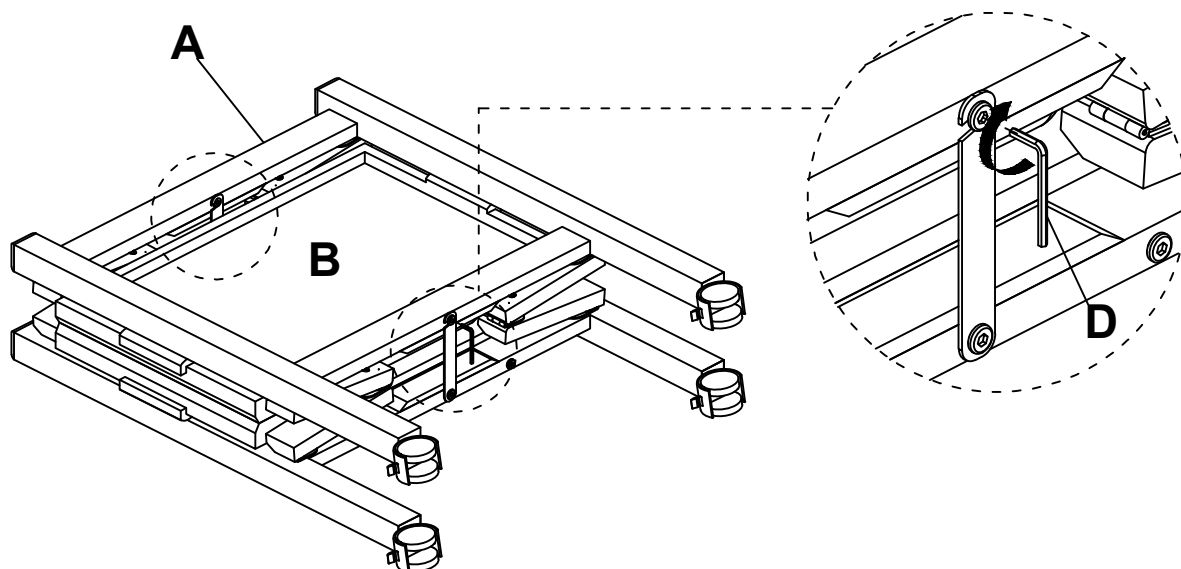

Cleaning & Care

Treat surfaces with care. Surfaces are resistant to scratches but are not scratch resistant. Clean surfaces with a dry or damp soft cloth. Do not use abrasive cleaners. Hardware may loosen over time. Periodically check that all connections are tight.