

200g铜版纸，双色印刷，
蓝色虚线为折痕示意 非印刷内容

540mm

220mm

A181-001-001
COZY CAMPING KIT
FOLDING WAGON + IGT TABLETOP + CANOPY



PRODUCT MATERIAL:
Plastic, Metal, Nylon
PRODUCT SIZE: 980x500x420mm (unfold wagon)
365x500x445mm (folded wagon)
360x250x10mm (tabletop)
2885x2550mm (canopy)

QTY:
Folding wagon x1, Tabletop x1, Canopy x1
WEIGHT:
G.W: 18.79KG, N.W: 16.5KG
maximum load capacity of wagon is 100KG
maximum load-bearing capacity of tabletop is 30KG



Scan the QR code for assembly videos

Email: patio@homeselecting.com

WARNING

For your safety and to avoid any damage or inconvenience, please carefully review the following instructions before using this product.

This product is designed exclusively for adult use. It is not suitable for elderly individuals with restricted mobility to operate or utilize. Additionally, please ensure that children do not ride inside the wagon.

When this product is in use, children must always be under the supervision of an adult.

To ensure the safety and longevity of your product, please avoid overloading, improper folding, or using non-approved parts. Carefully review the provided instructions to ensure proper usage.

When adjusting any movable accessories on this product, please maintain a safe distance from moving parts to prevent injury. For your safety, please avoid using this product in areas with uneven surfaces.

During use, please ensure this product is kept away from fire, high temperatures, pools, power sources, and maintain a safe distance at all times.

This product is designed with a recommended weight capacity of 100KG and is important to distribute items placed within the wagon evenly to ensure optimal balance and stability. Avoid placing this product on roads, ramps, or in hazardous areas to ensure safety.

Exercise caution to prevent fingertip pinching when folding and unfolding this product.

Before placing items, please ensure that the wagon is fully opened. If you detect any damage to this product, cease usage immediately and reach out to customer service for further assistance.

This product is designed for use only at walking speed. This wagon is designed for carrying objects. For personal safety, it is not recommended for adults or children to use it as a ride, as doing so may lead to bumps, scratches, or other accidents. Not suitable for children to ride.

This is NOT a toy.

Avoid Pinch Injury, keep fingers clear of hinged joints when folding and unfolding the wagon.

Maintenance

- When cleaning the fabric, hand wash it with water below 30°C and do not bleach.
- When cleaning the frame, use a soft, dry cloth to wipe it.
- Regularly inspect your wagon and promptly replace or repair any loose or worn parts, fallen materials, or gaps in seams.
- Please avoid excessive exposure of this product to the sun to prevent the vehicle from aging or deforming.
- In the event of rain or moisture, unfold the wagon to allow any water to drain, and fold it up once it's dry.

Warranty

For a period of one (1) year after date of purchase, the Manufacturer will either repair or replace defective components in accordance with this Limited Warranty. This warranty is between the Manufacturer and the original purchaser and is valid only when accompanied by the original purchaser's sales receipt showing original date of purchase.

The manufacturer or its authorized dealer can accept or reject warranty claims based on its findings. This warranty applies in normal residential use only and is not intended for commercial use. The Manufacturer can make substitutions as required of materials, components, and sub-components of comparable value and utility. This warranty is limited to product repair or replacement (to be determined solely by the Manufacturer). Warranty return is limited to only the single affected component.

This limited warranty covers only manufacturing defects and does not cover normal wear and tear, damage due to acts of nature (such as, but not limited to, flooding or high winds), abuse or misuse, including chemical damage from sun oil or other chemicals, exposure to extreme heat or cold, abrasion or excessive weight. This product is intended to be used in standard installations only. This warranty is void if the product is not used for its intended purpose. The Manufacturer disclaims liability for any aspect of installation and any inconvenience caused by a defective part of a component.

Certain items are not covered by this warranty. These include, but are not limited to the following:

- Components subjected to abuse, including abuse intended to simulate failure.
- Damages caused by retailer, shipper or installation error (such as scratches, dents, tears, chips, etc.).
- Any part that only shows normal wear and tear on the surface, including debris, scratches, or material stretching and stitching.
- Tears, punctures, scratches or any damage caused by improper installation or use.

* If you need after-sales service, please provide the original purchase record and a brief description of the problem. Please also provide your email address or mobile number.

HOW TO USE WAGON

Wheel Installation

1. Rear wheel assembly

2. Front wheel assembly

Remove the wheels and frame from the package. Place the two rear wheels without brakes into the wheel seat on the side with the pull handle as indicated. Insert the remaining two front wheels into the wheel seat on the opposite side, as shown.

Note: When installing the wheels, ensure you differentiate between the front and rear wheels. Pay close attention to the installation location and wheel orientation to ensure proper assembly. The front wheel is a universal wheel, and the rear wheel is a directional wheel.

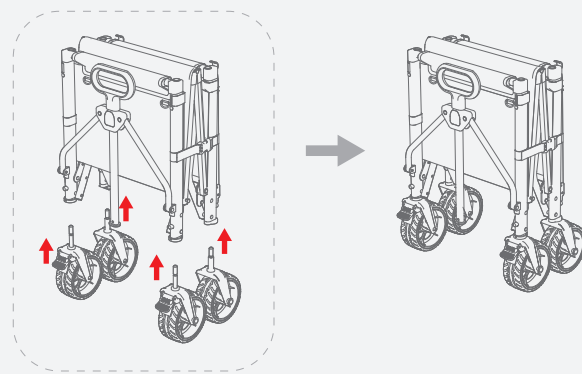

Body Unlock

Unlock from both side, to release the wagon body

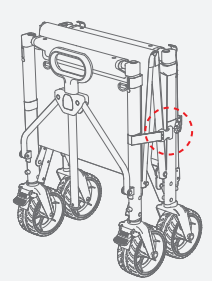

Expand the Wagon

After expanding, remove the baseboard from the inner wall and lay it flat on the bottom to create a solid surface.

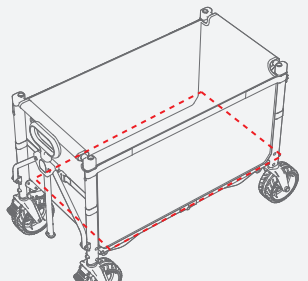
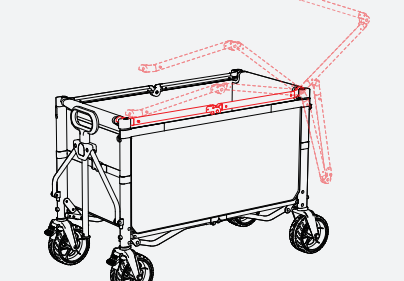

Table Slats Setting

After expanding, rotate the slat at the rear of the wagon to the front and fix it.



Pull Handle Use

- Straps: When you need to tow the wagon, unbuckle the straps.
- Adjustment button: Unlock the handle with one click.

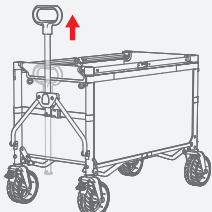

Wheel Brake

Wheel lock: press the "lock" pedal downward

Wheel unlocked: press the "unlock" pedal downward

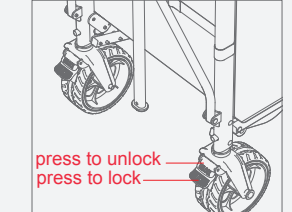

Wheel Quick Release

Wheel quick release: Press and hold the quick-release button on the wheel base's side to remove the wheel.

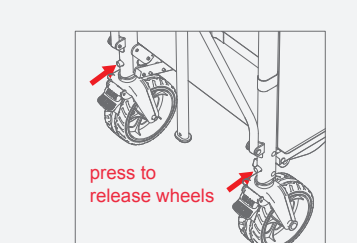

正面

Box Folding

To fold, store all accessories and clear the wagon at first. Lift up the handle from bottom center and push the both side inwards. Lock the buckles after wagon has been folded.

Note: Before folding the wagon, make sure that the baseboard and table slats have been stowed away.

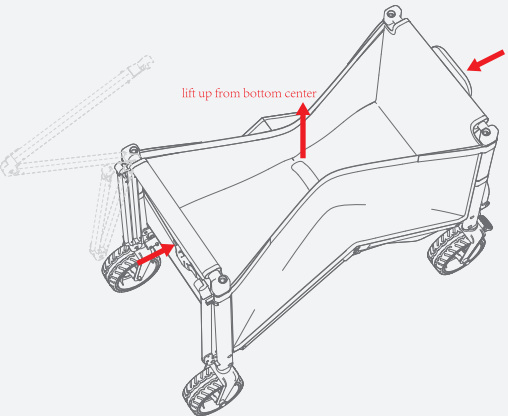

Disassembly and Assembly of Carriage Fabric

To disassemble the carriage fabric, start by detaching each corner of the fabric, both on the top and bottom sections. Repeat in the center of the wagon frame.

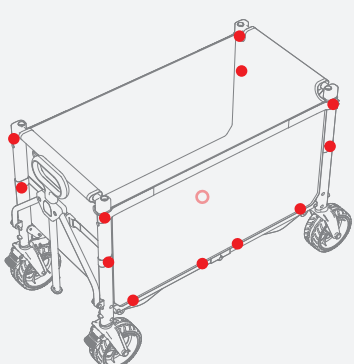
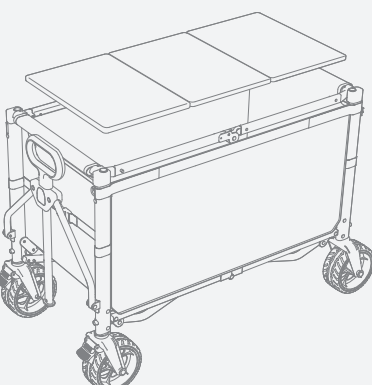

Table Assembly

Place the table slats on the table top, then position the table on top.



220mm

HOW TO SETUP CANOPY

Step 1

Install vertical bar&X cross bar

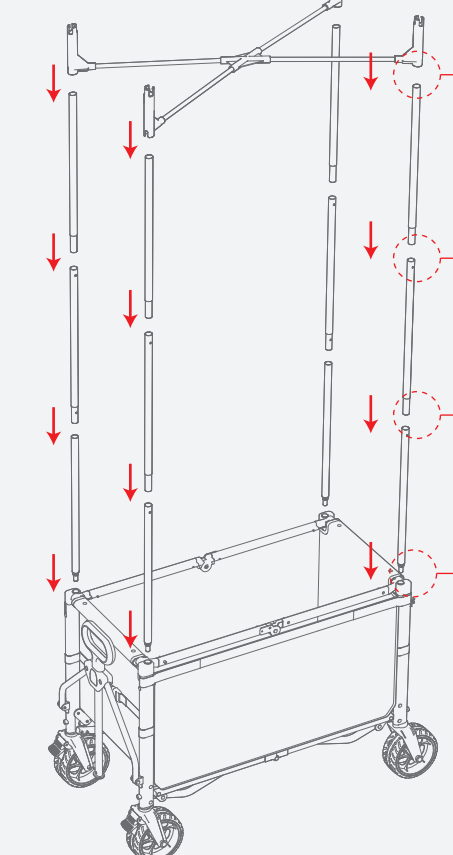

Insert and snap

Insert and lock

Insert, twist and lock

Step 2

Install the top aluminum pole frame

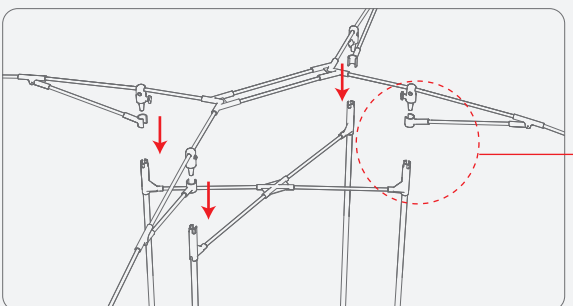

Insert, twist and lock

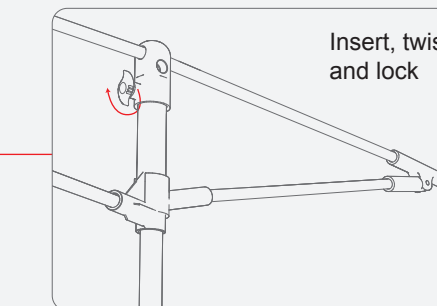

Step 3

Laying canopy fabric

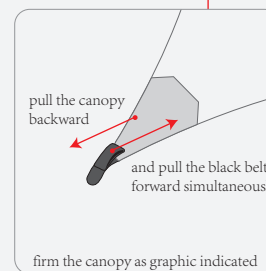
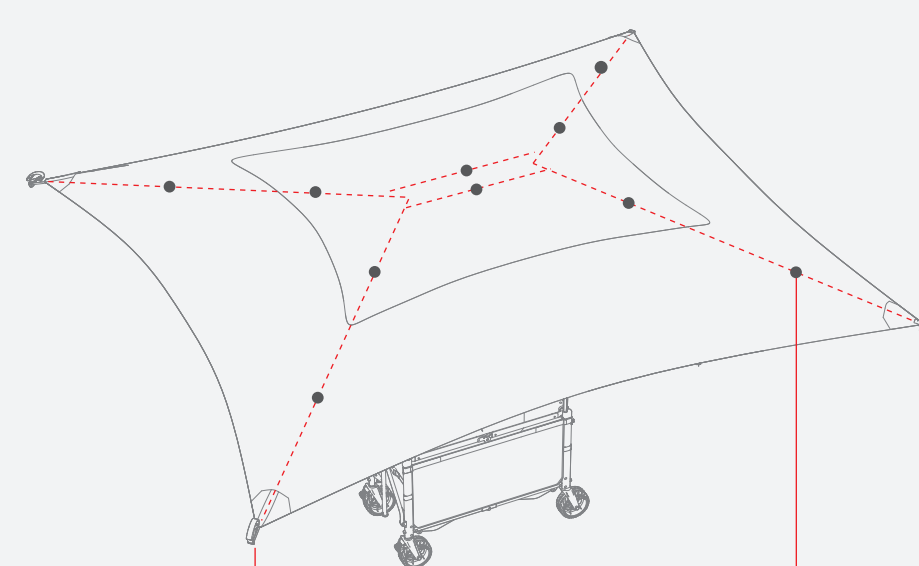

Aluminum bar head featuring embedded webbing holes. Pull the webbing with one hand while holding the aluminum pole with the other.

Note: To ensure your safety and enhance your user experience, please utilize stakes for reinforcement in case of changing weather conditions.

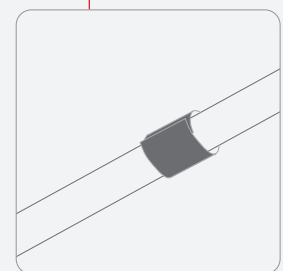

Velcro fastens the pole (10 points)

Note:

- It is not recommended to use this product in bad weather such as strong winds and heavy rains.
- Avoid proximity to open flames, sharp objects, hazardous power sources, and bodies of water, maintaining a safe distance at all times.
- Please check the weather forecast before using this product. If wind speeds reach level 4 or higher, we recommend securing it with stakes for added stability.
- When you notice any damage to this product, cease use immediately and contact our customer service team for assistance.
- This product is intended for operation by adults only. Children and elderly individuals with limited mobility are not permitted to install or use it.
- We advise against using this product on uneven roads.

背面