

DJYC2406

ASSEMBLY INTRODUCTION

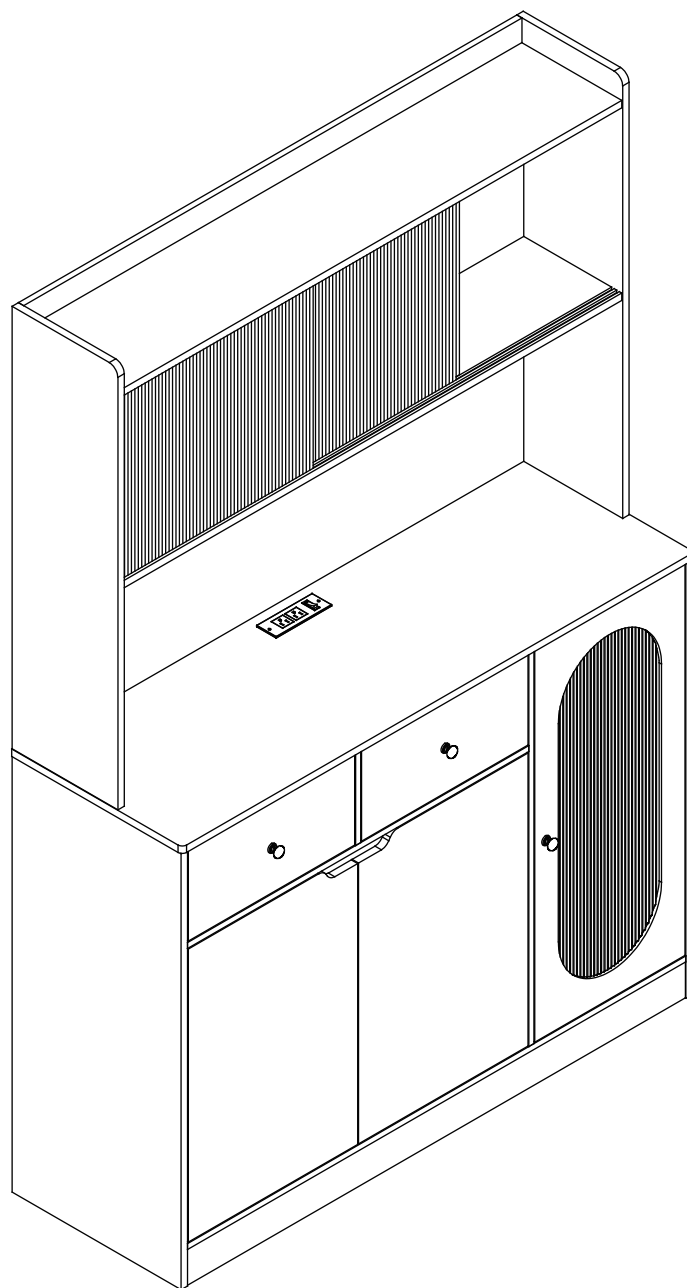

Plate

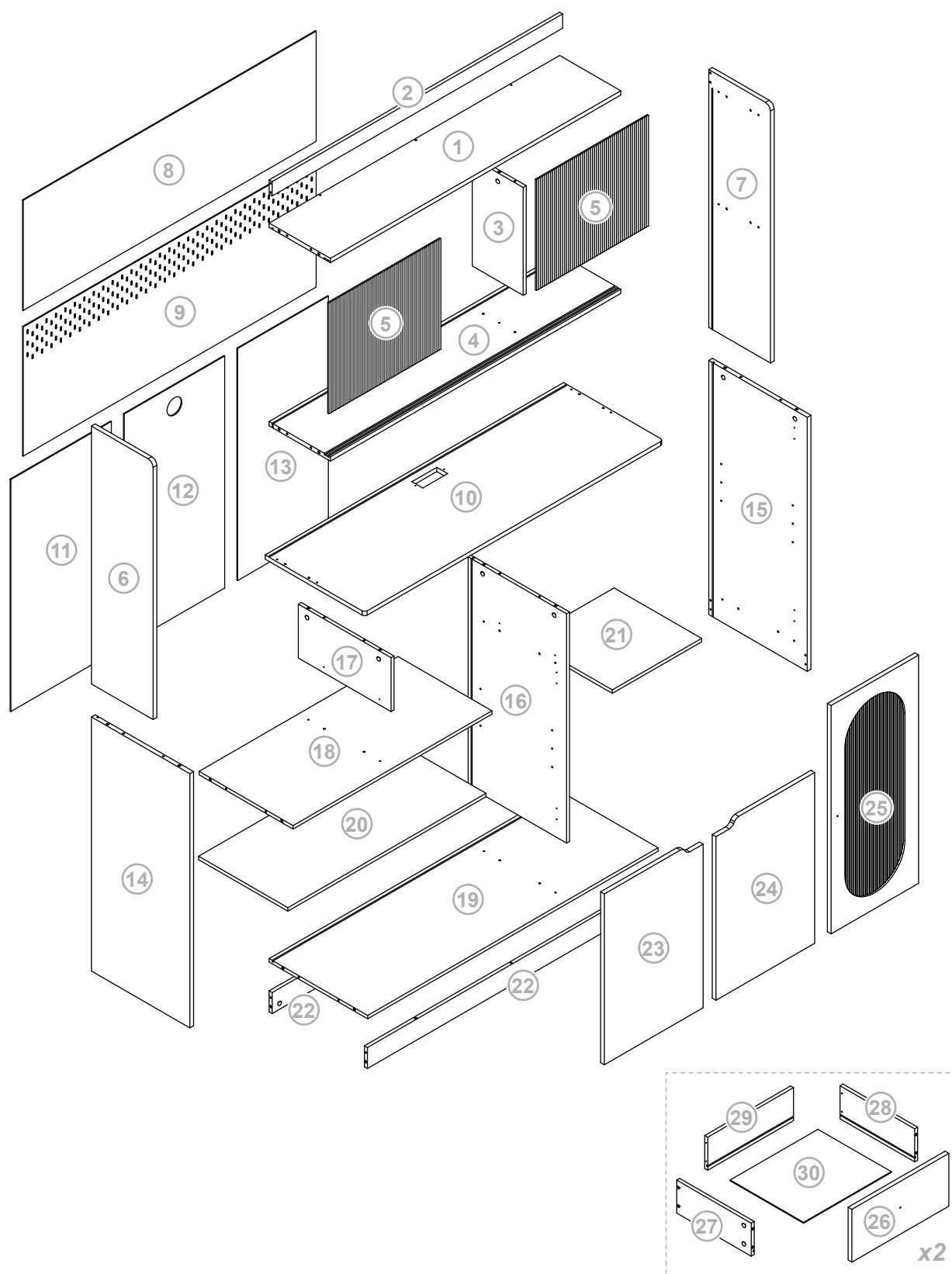

Plate

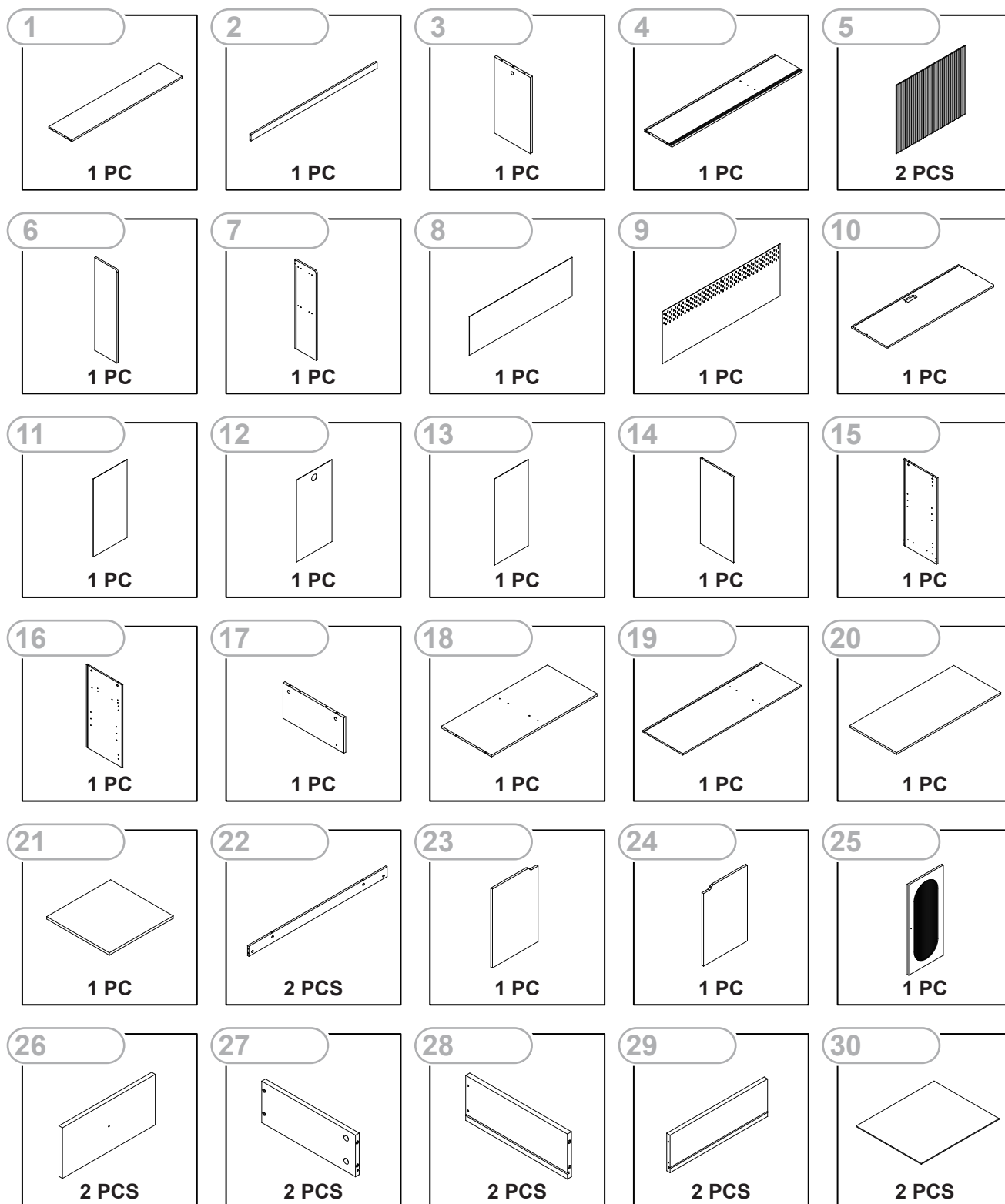

Fitting

A x 41 +2

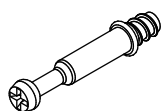

M6 x 35 mm

B x 41 +2



φ15 x 9.5 mm

C x 49 +2

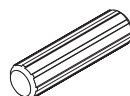

φ6 x 30 mm

D x 13 +1



φ4 x 30 mm

E x 18 +2



φ3 x 12mm

F x 3



32 x 32 x 25 mm

G x 3

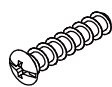

φ4 x 20mm

H x 6

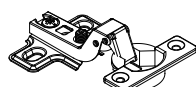

26 mm

I x 8

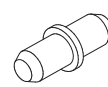

φ6 x 12 mm

J x 16 +2



K x 1

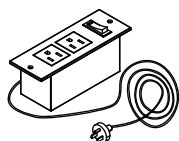

L x 24

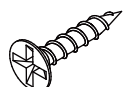

φ4 x 14mm

M x 2

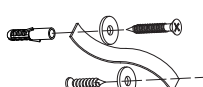

N x 4

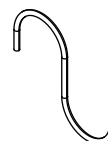

O x 6

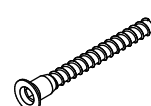

φ7 x 50 mm

P x 1



4 mm

Q x 1

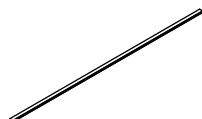

CR x 2

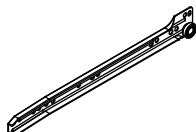

300 mm

CL x 2

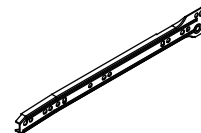

300 mm

DR x 2

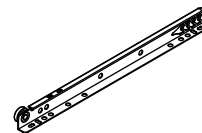

300 mm

DL x 2

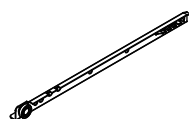

300 mm

1

A x 9

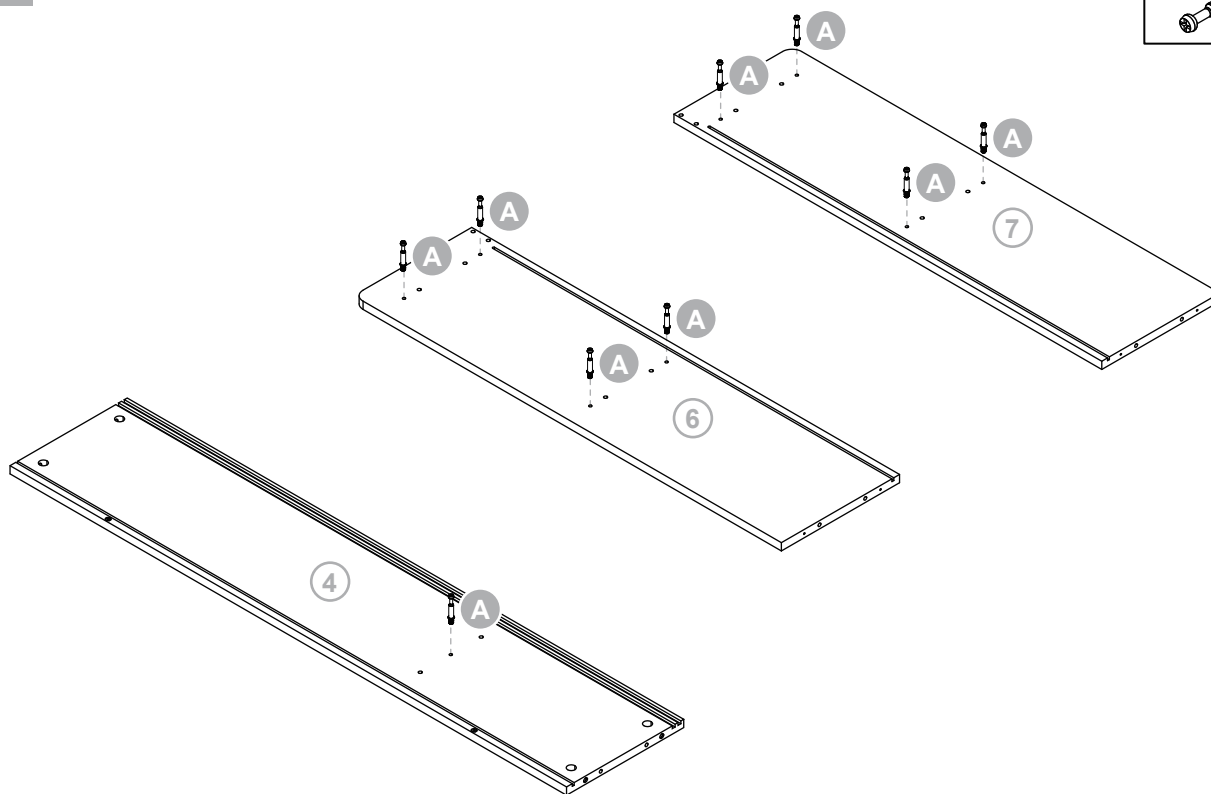

2

C x 1



D x 2

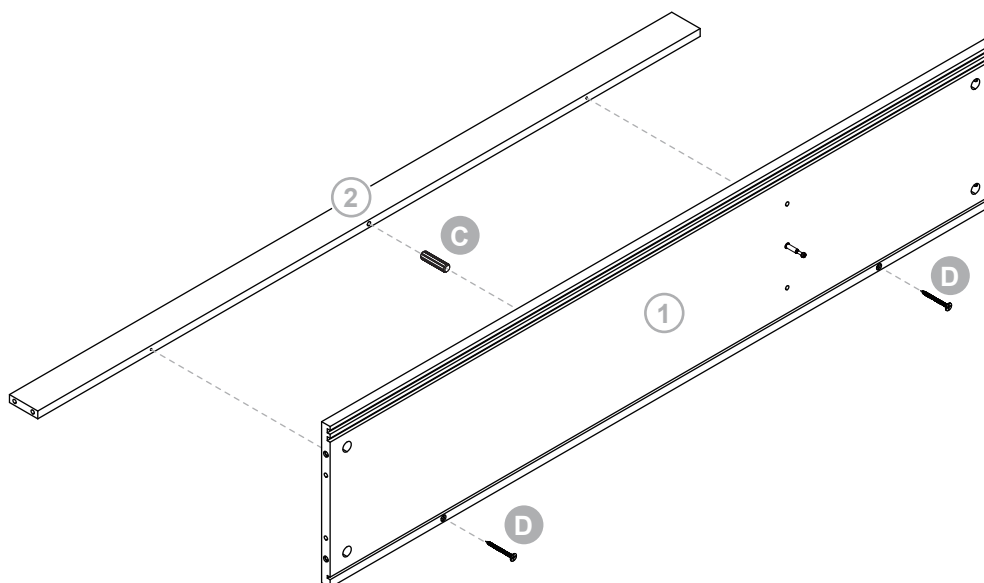

3

B x 1



C x 4



D x 1

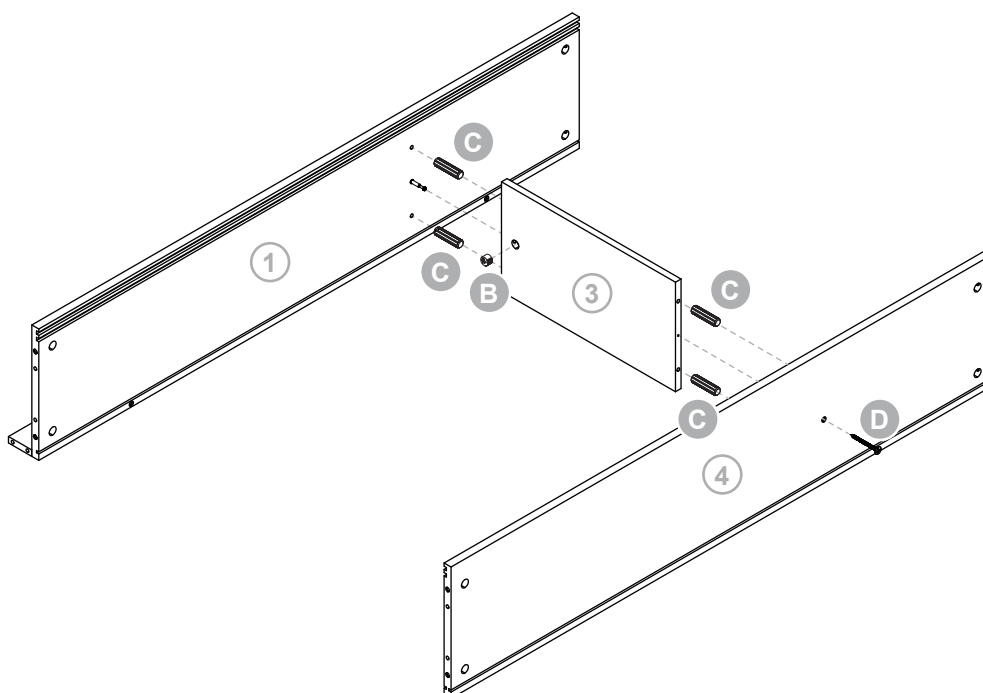

4

B x 4



C x 6

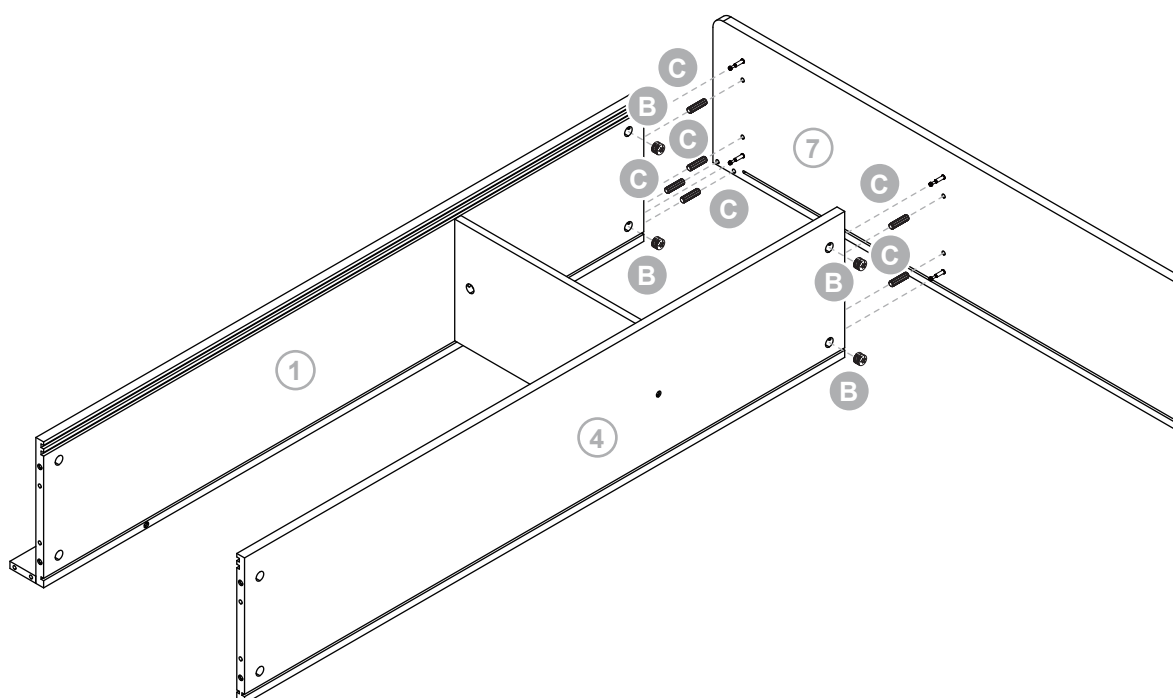

5

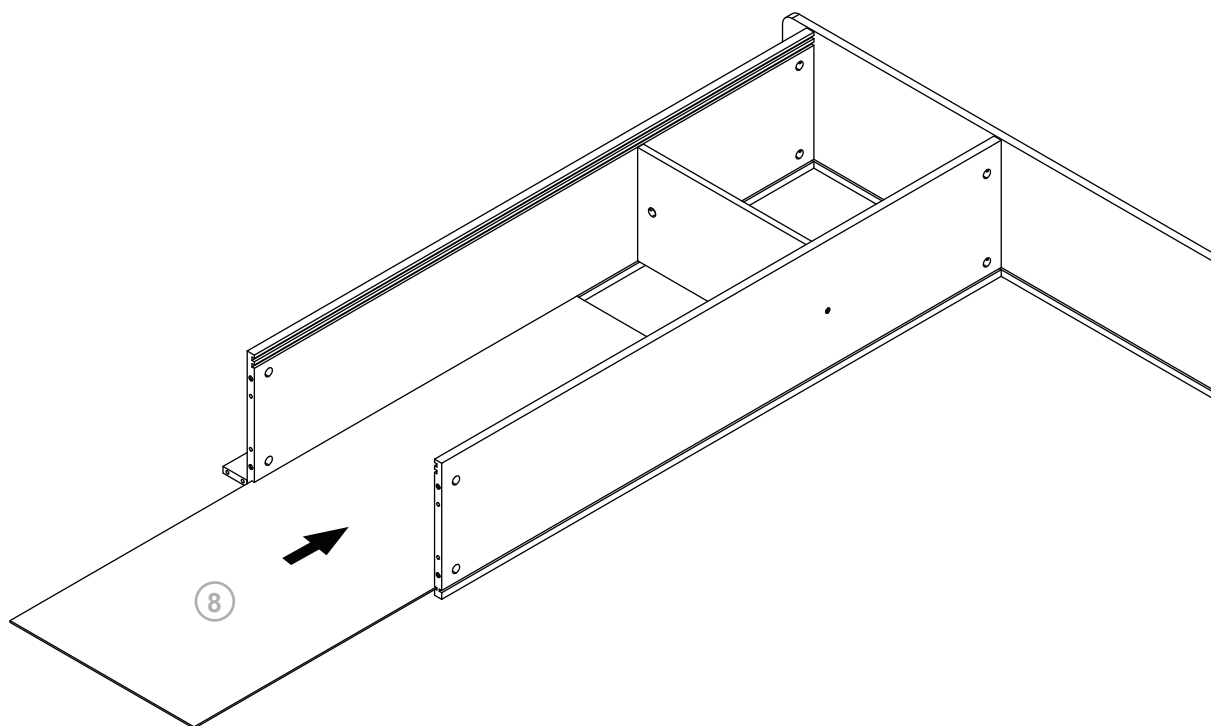

6

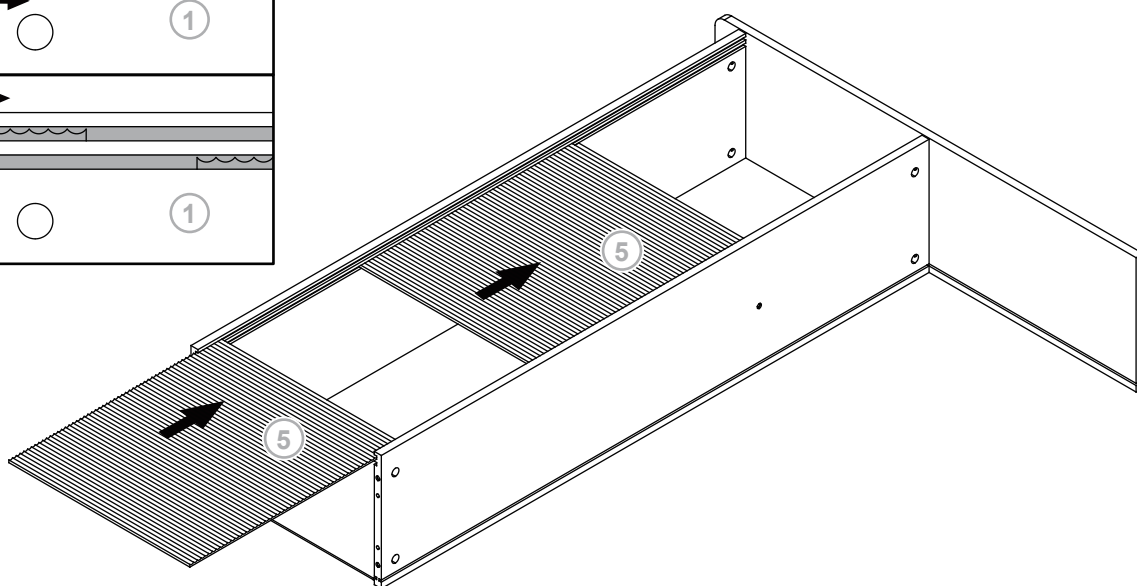
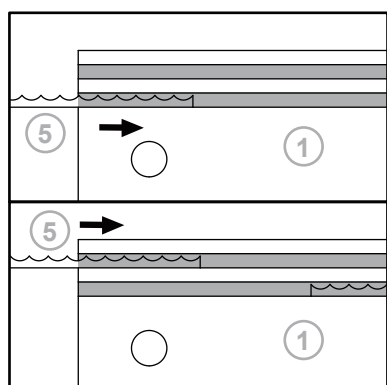

7

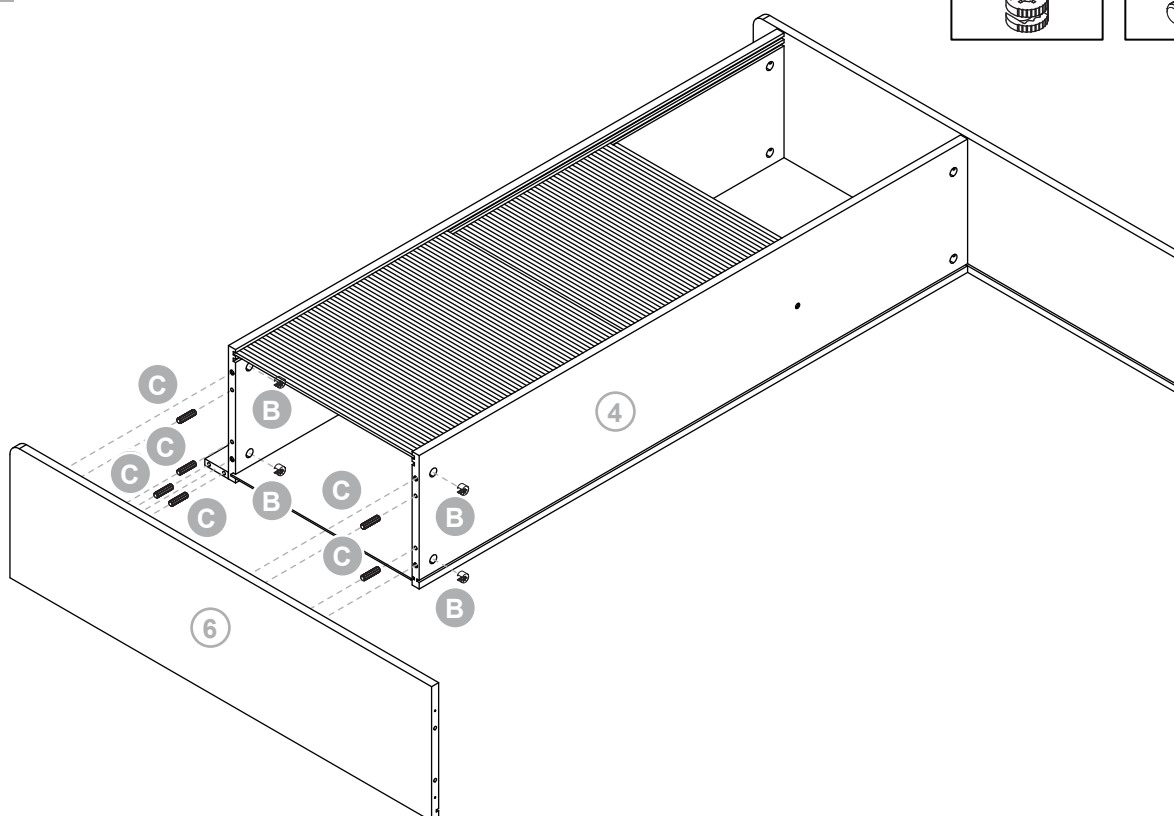
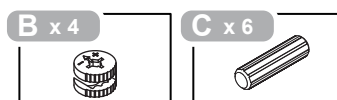

8

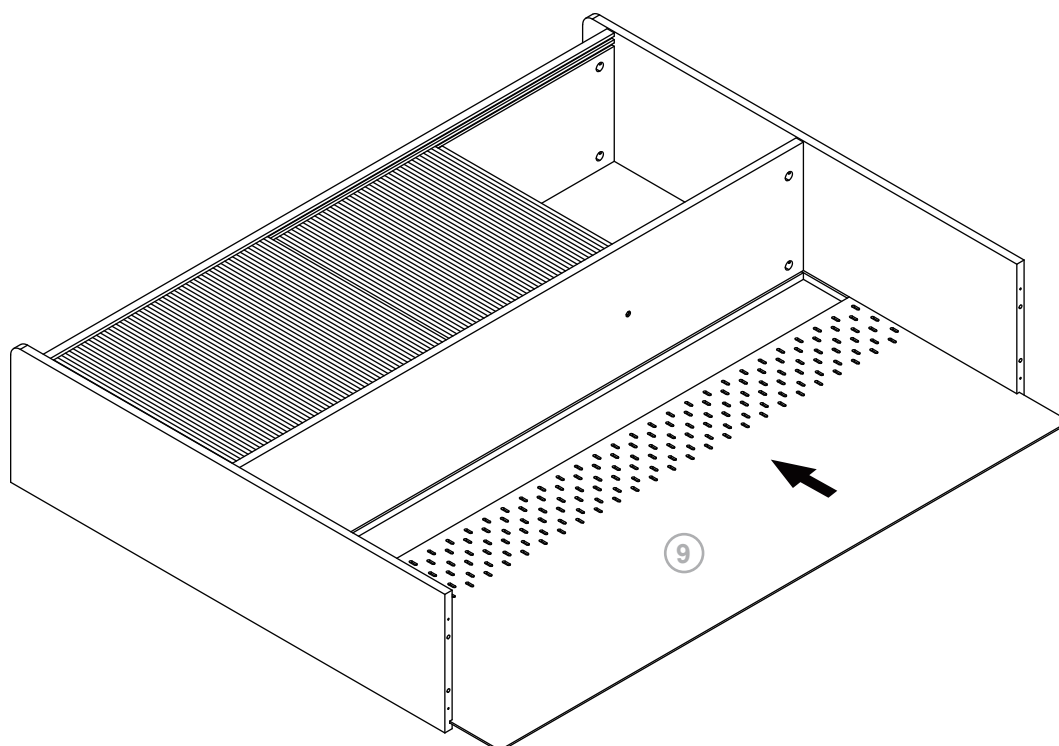

9

A x 8

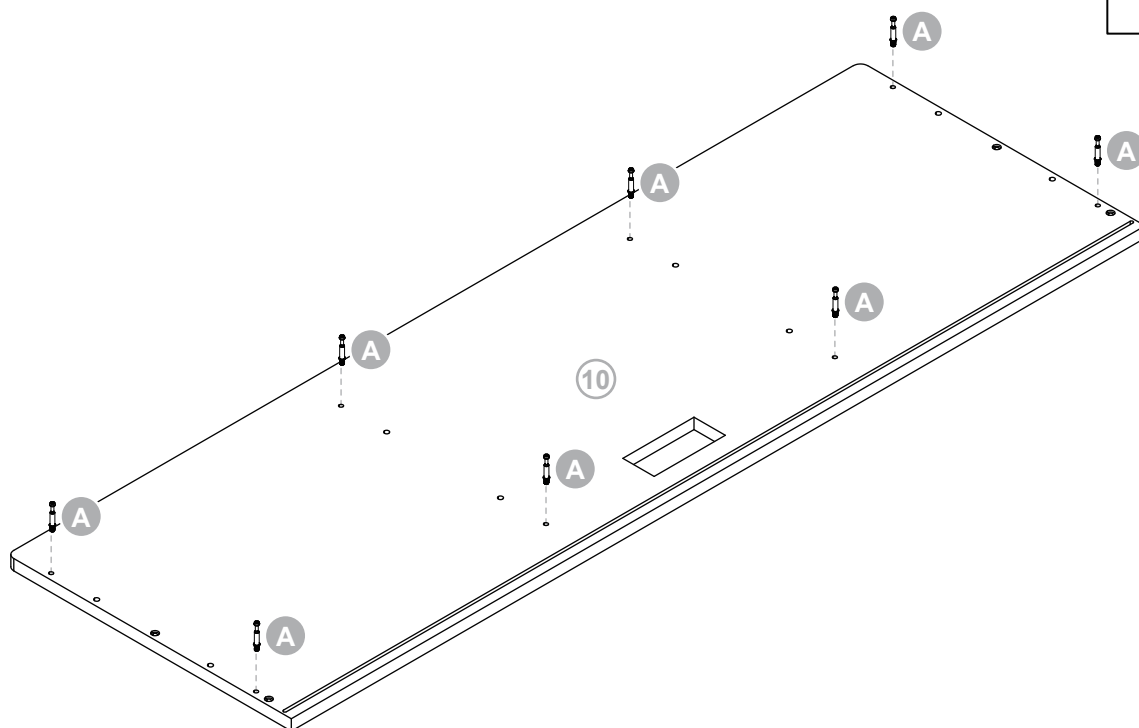

10

C x 4



O x 4



P x 1

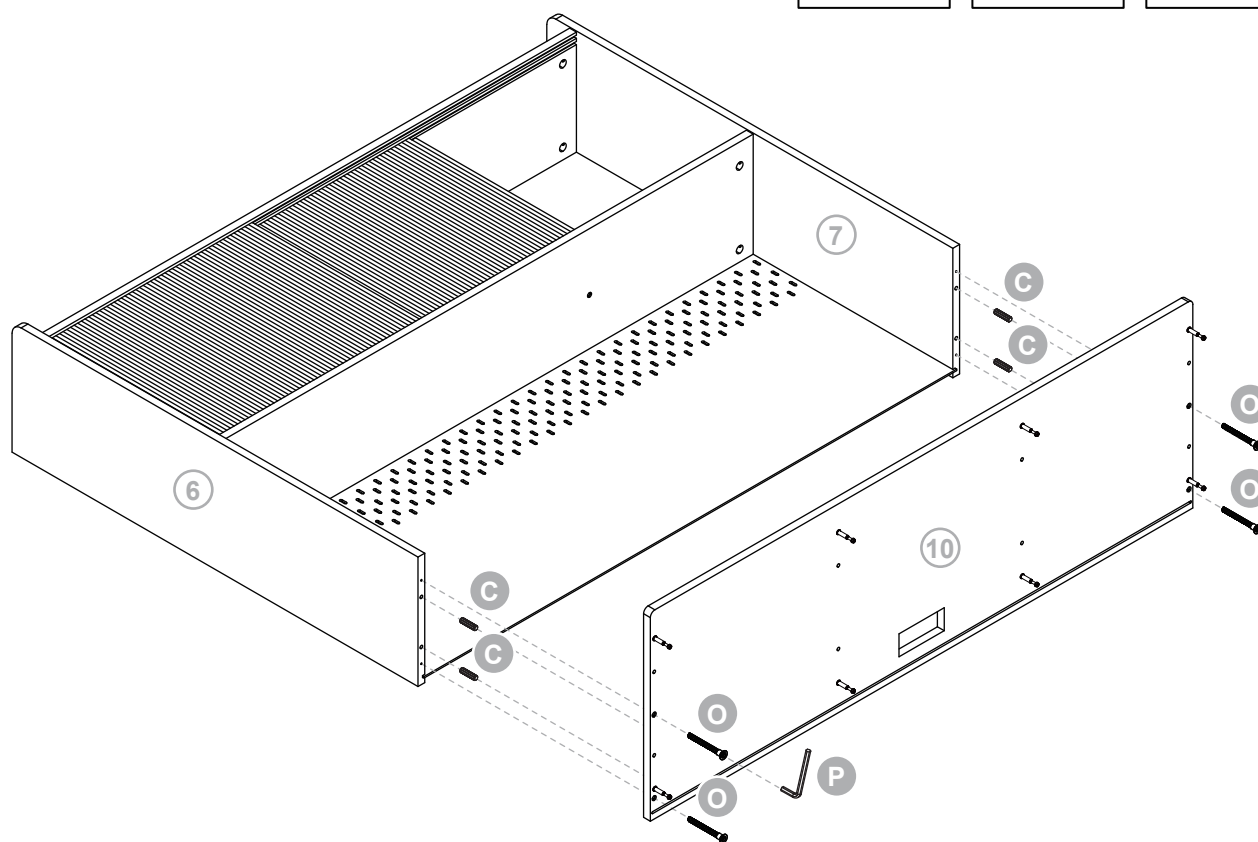

11

A x 4

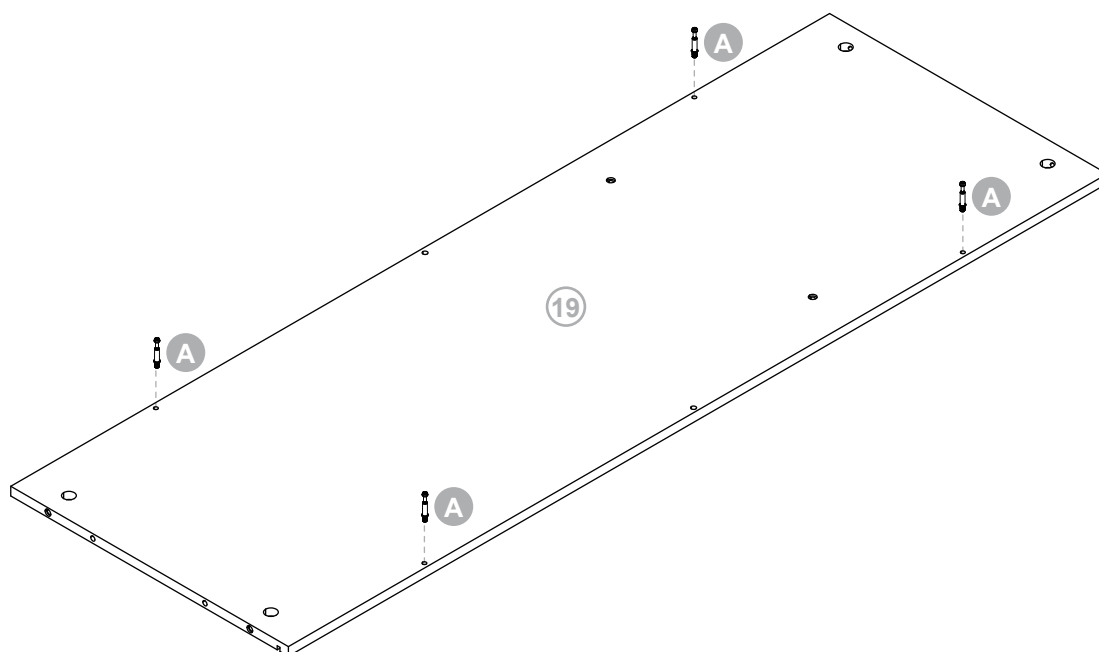

12

B x 4



C x 2

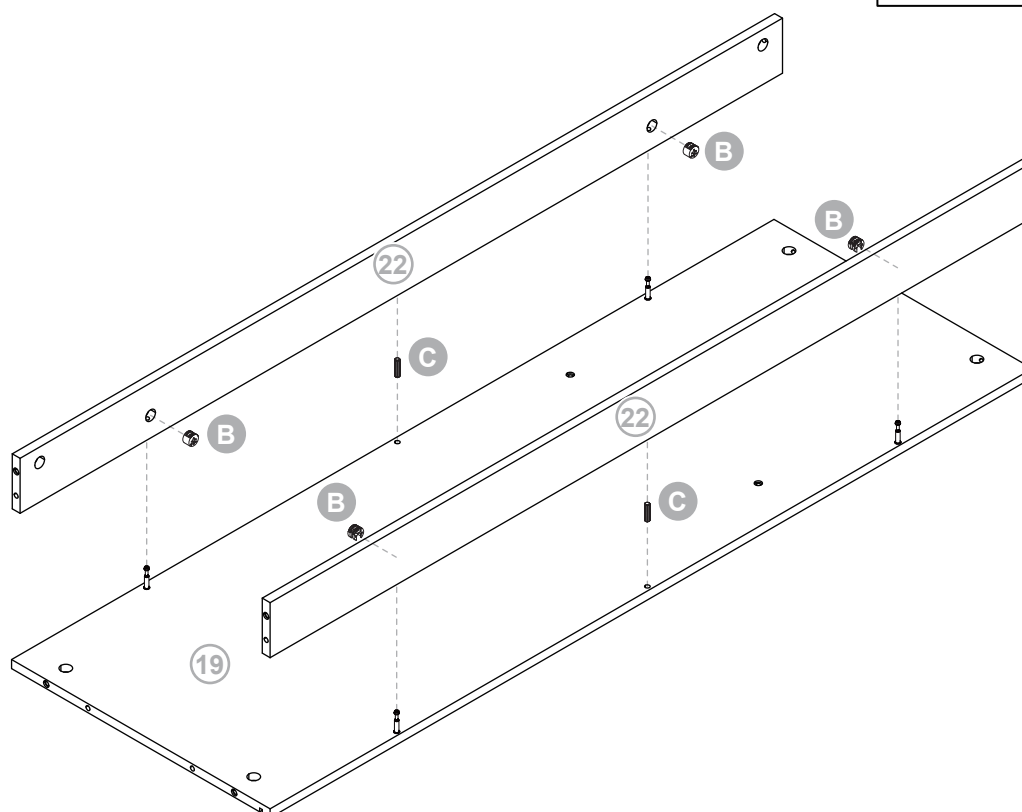

13

A x 2

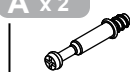

E x 2



CR x 1

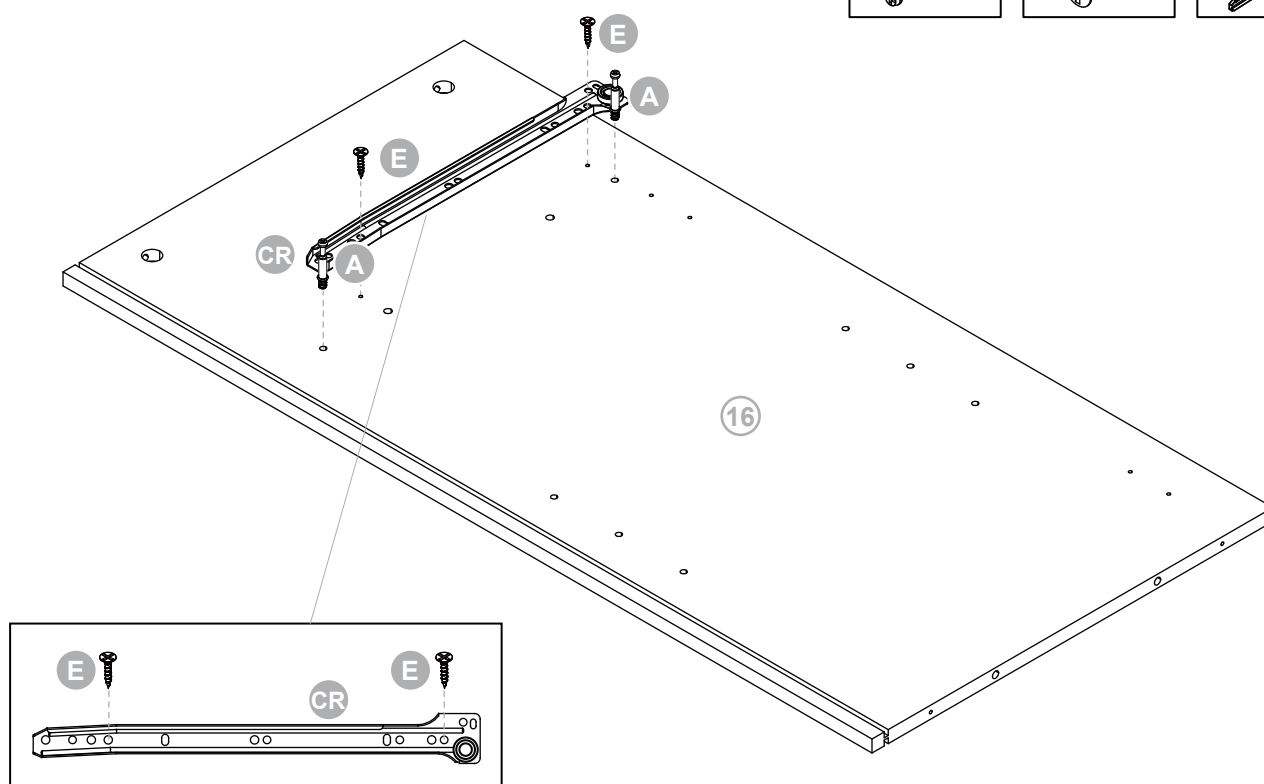

14

C x 4

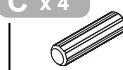

O x 4



P x 1

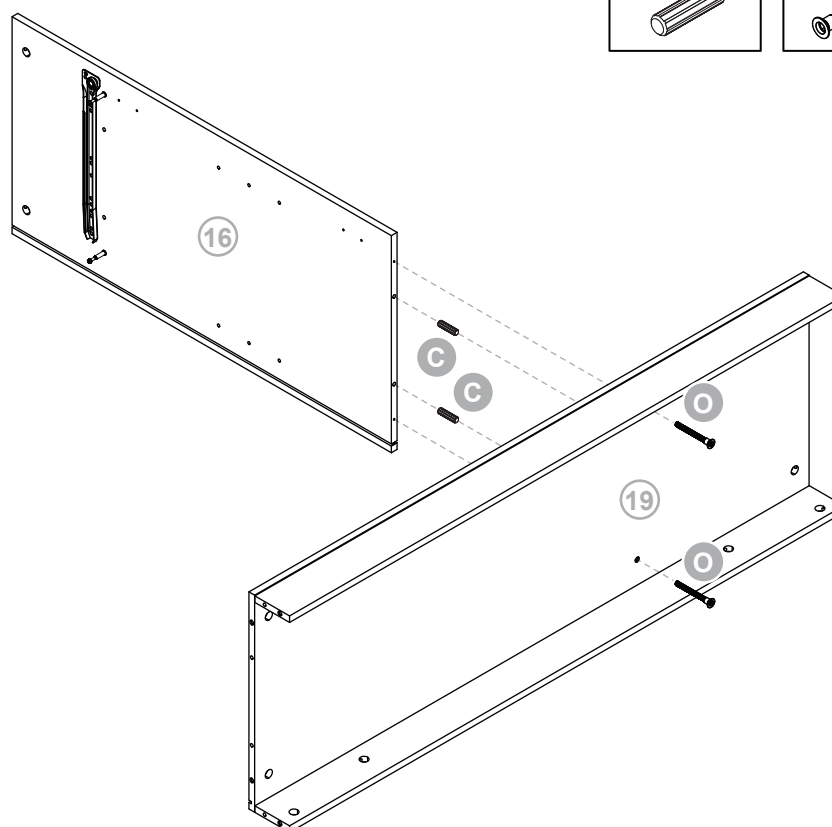

15

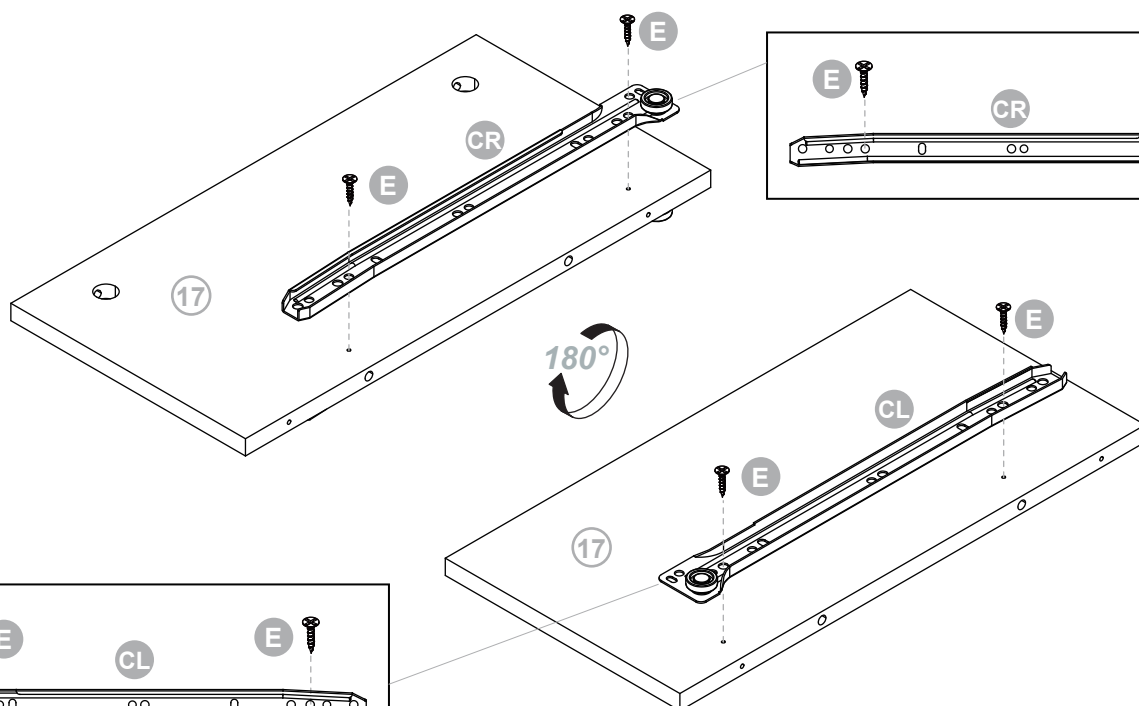
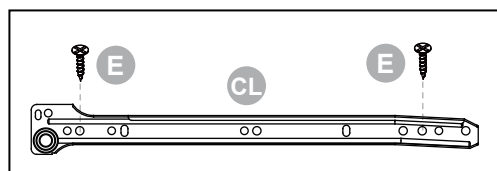
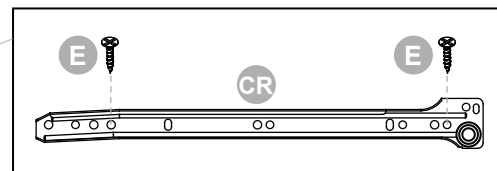
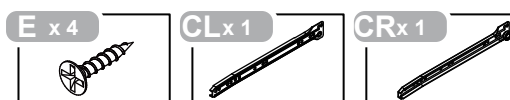

16

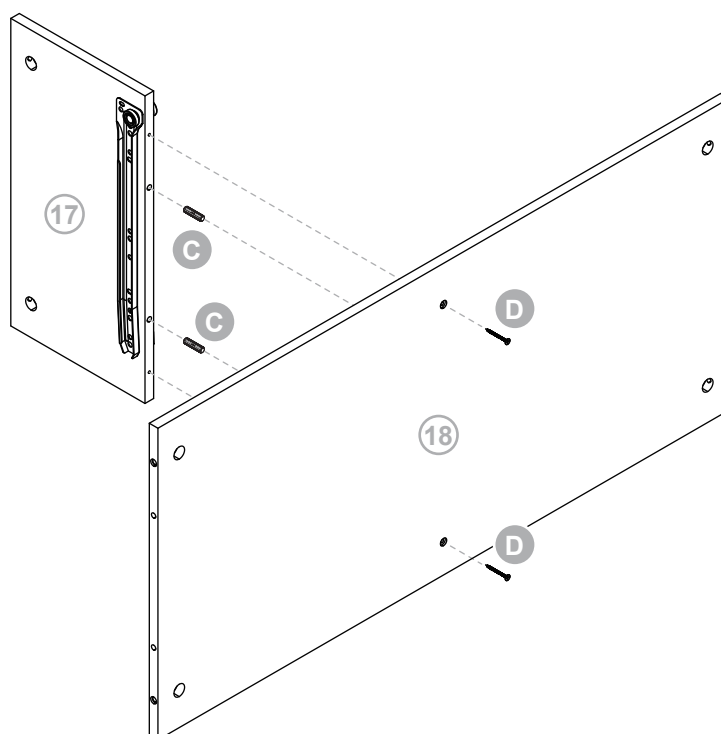
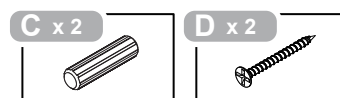

17

B x 2



C x 2

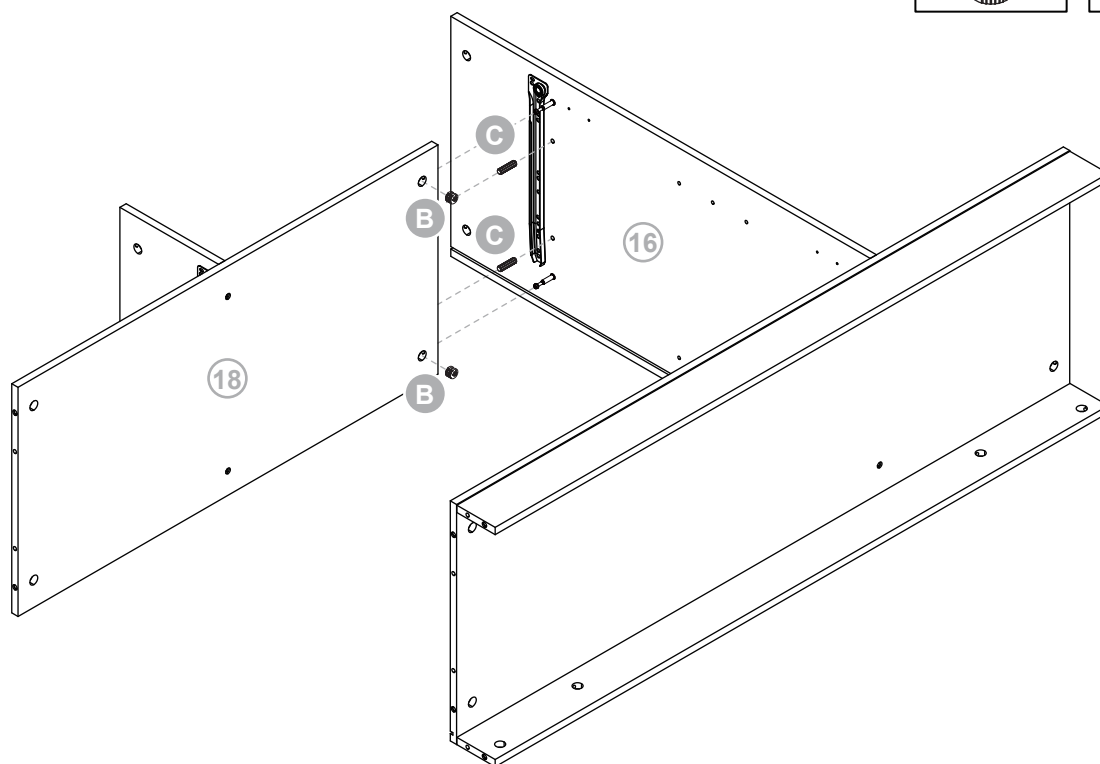

18

A x 10



E x 2



CL x 1

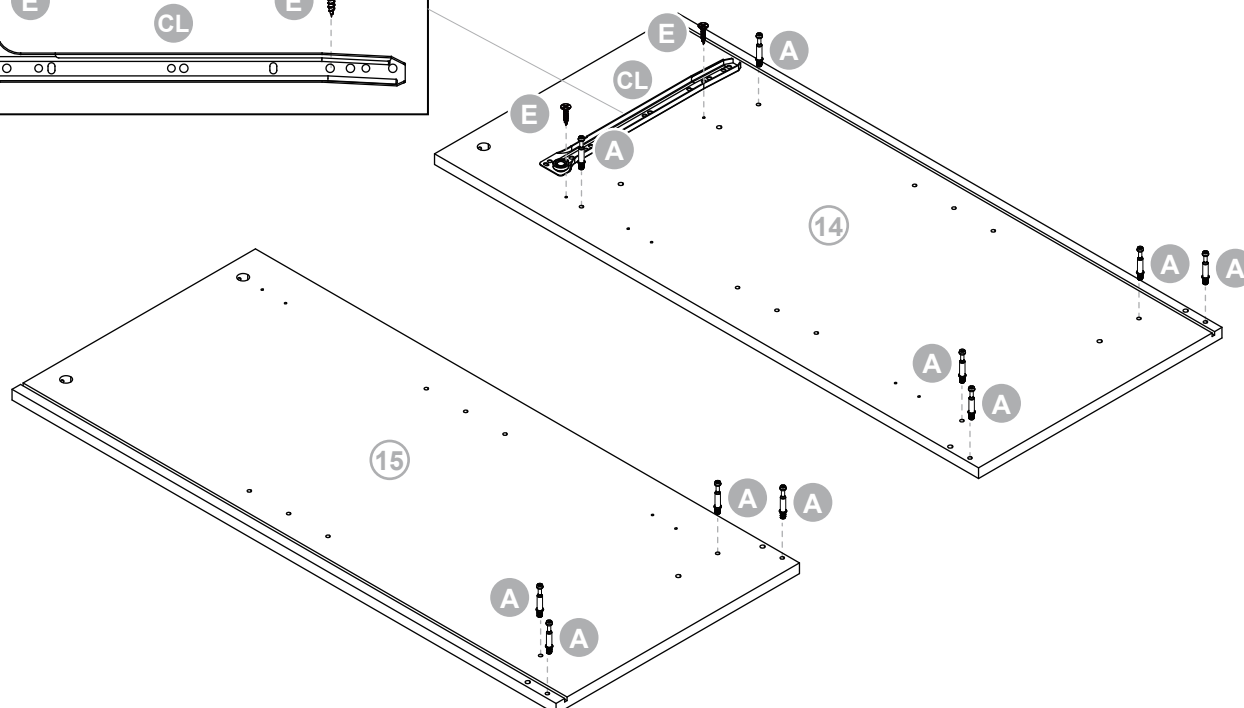
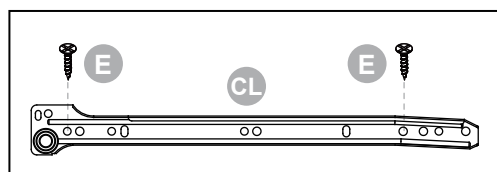
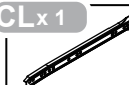

19

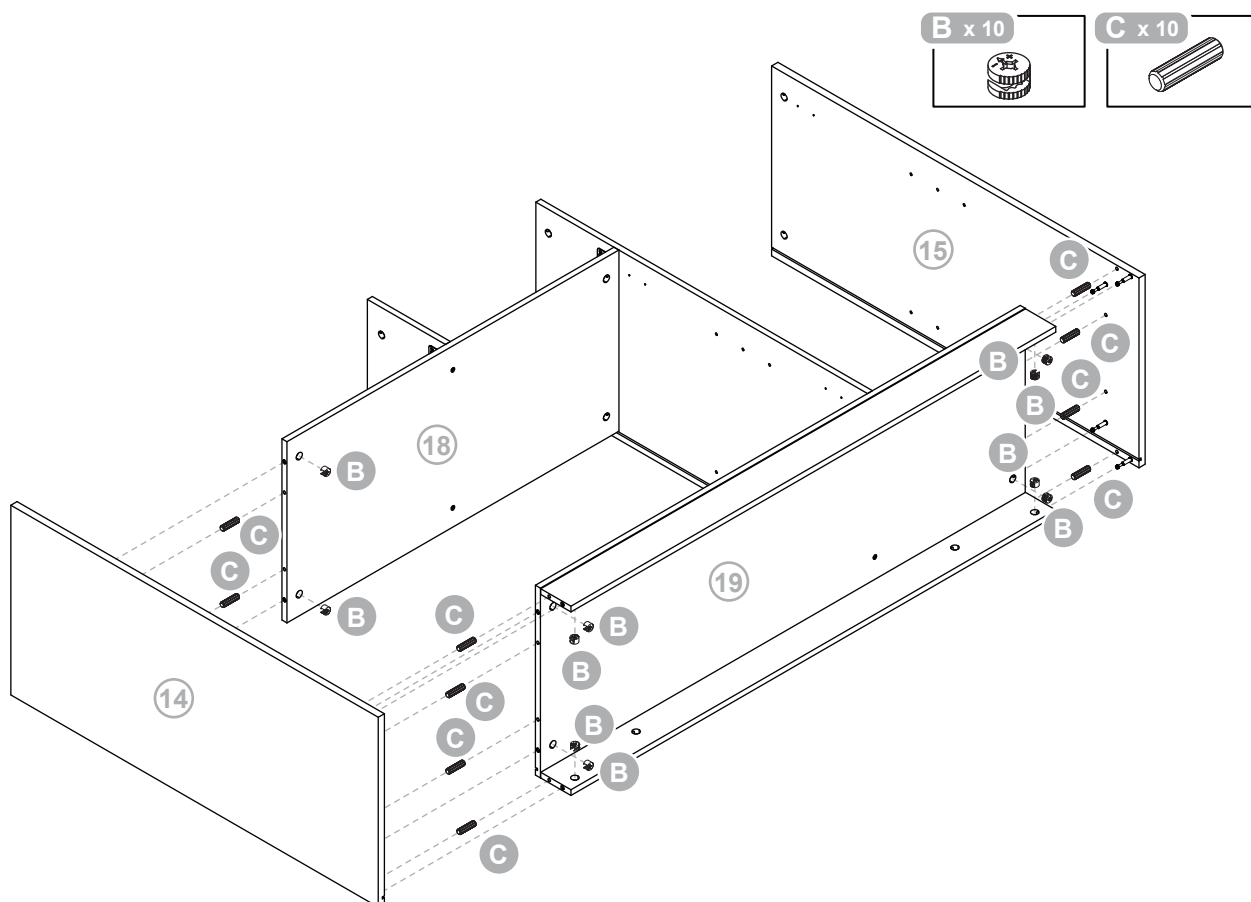

20

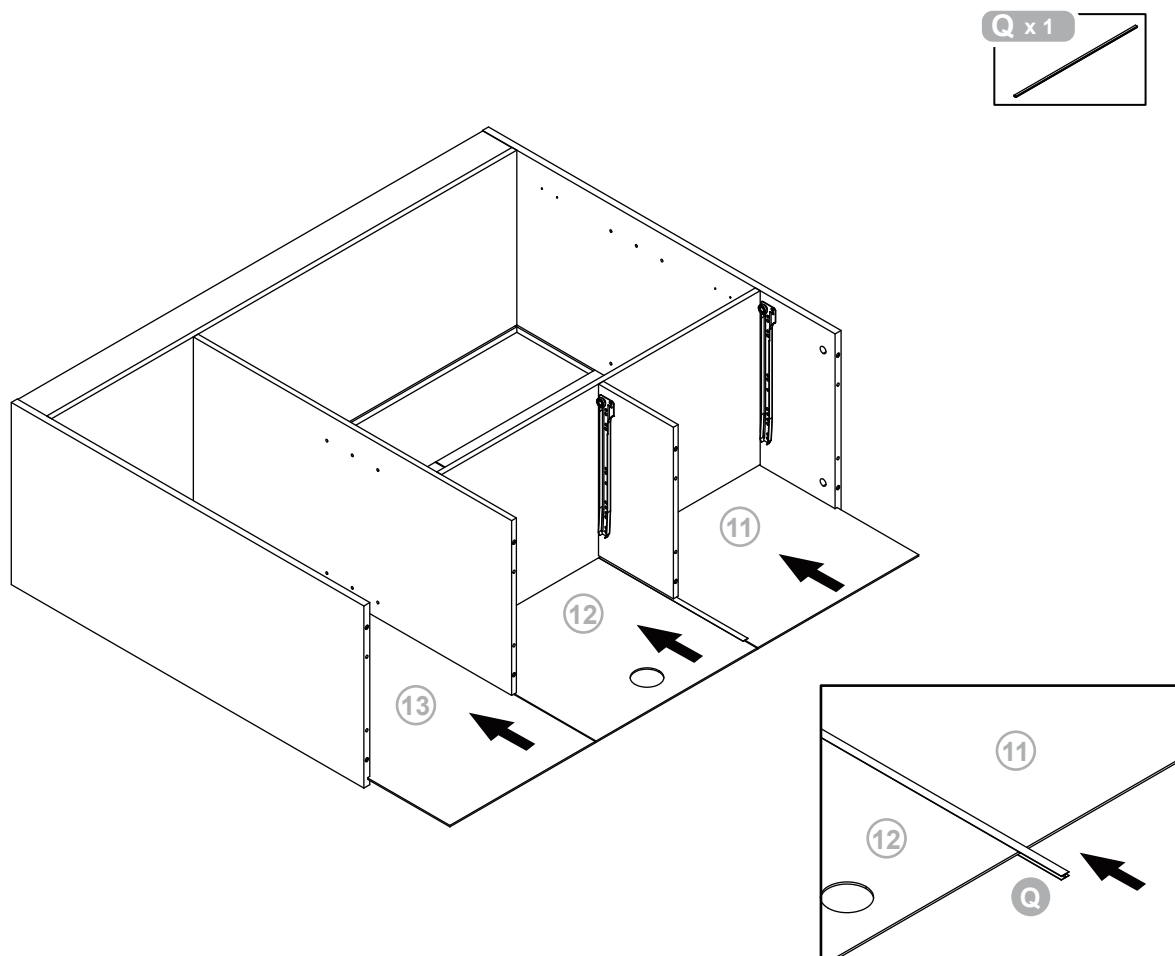

21

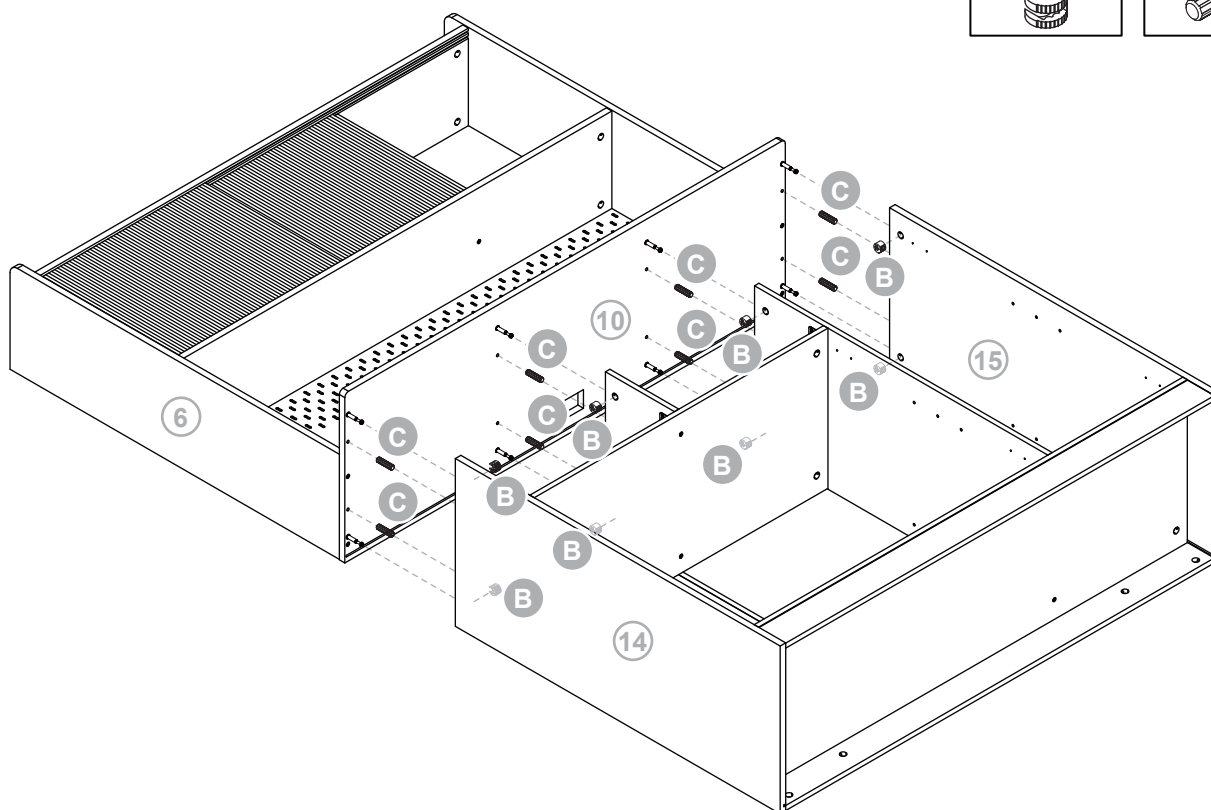
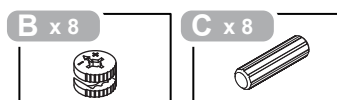

22

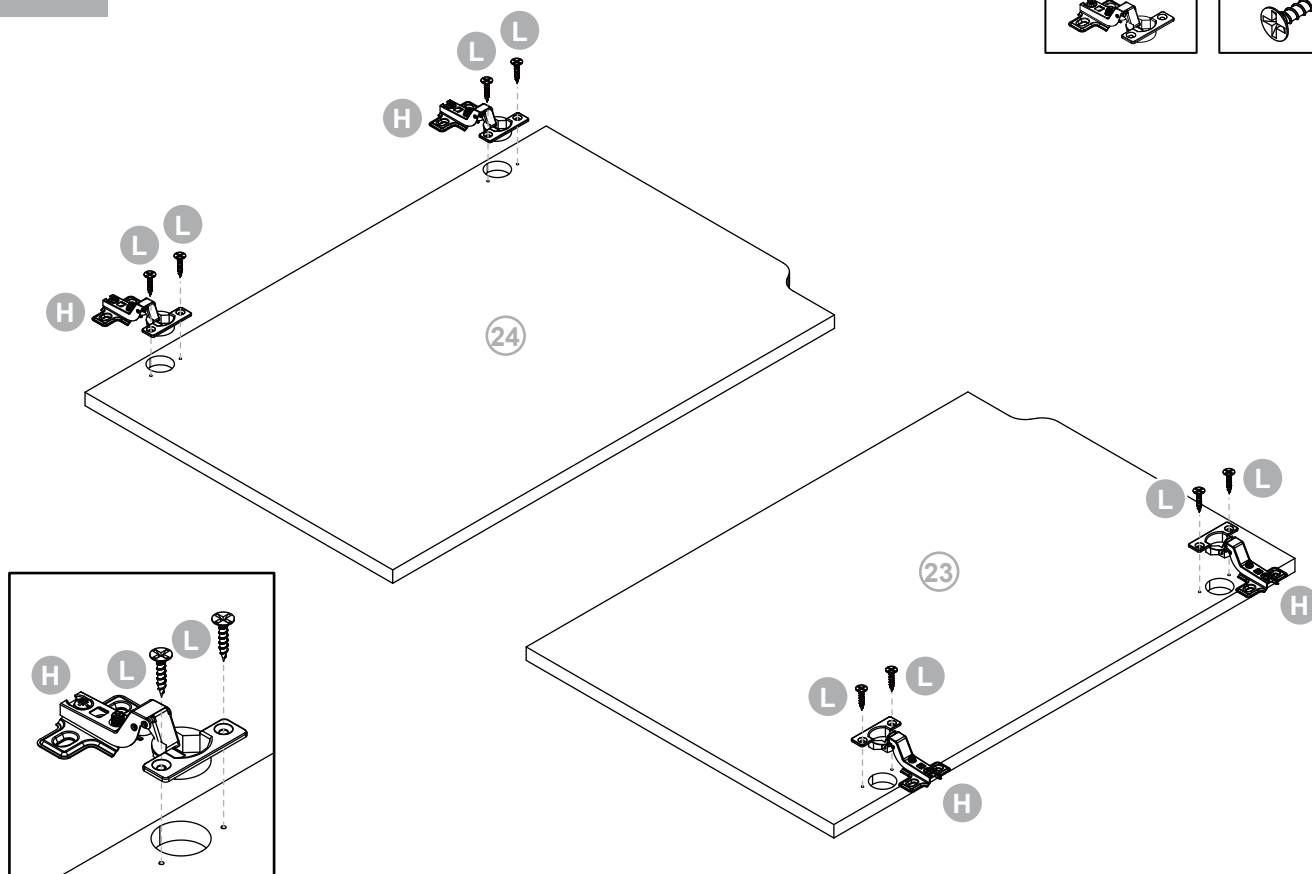
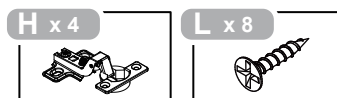

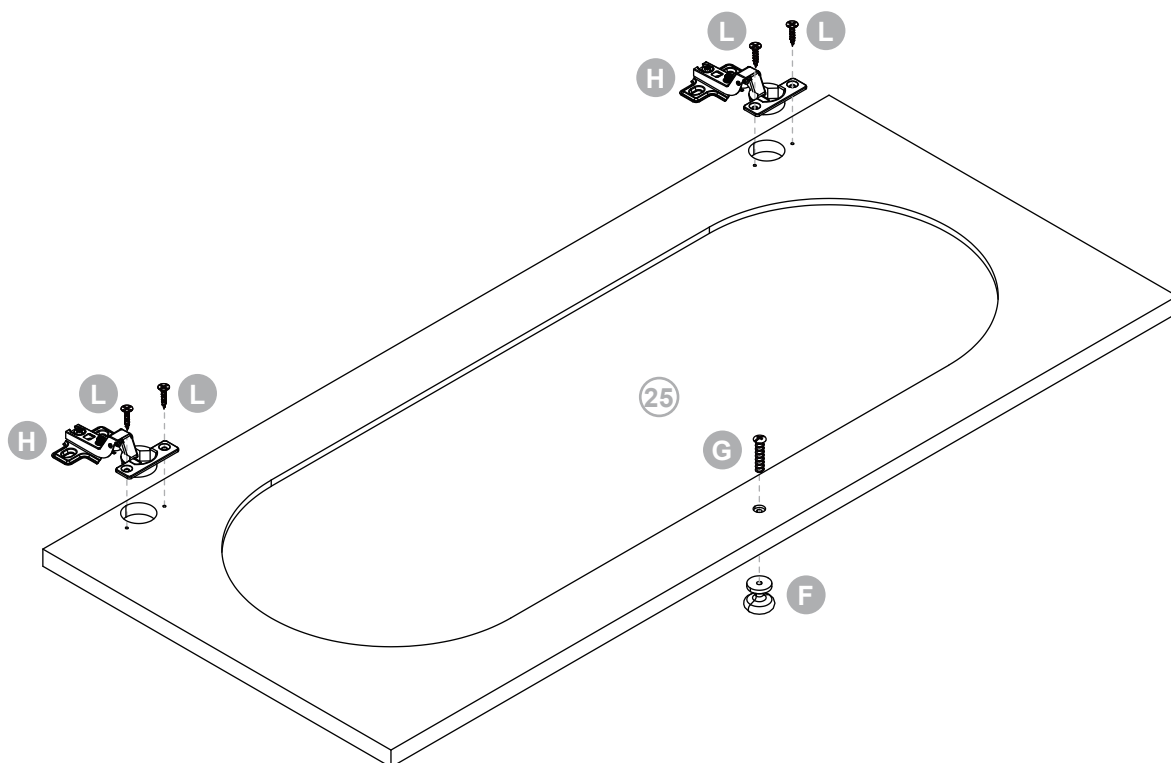

24

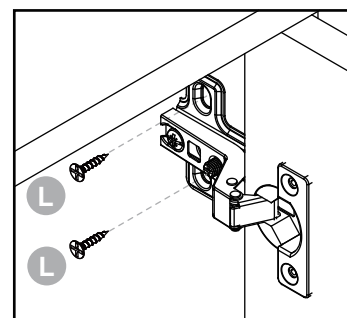
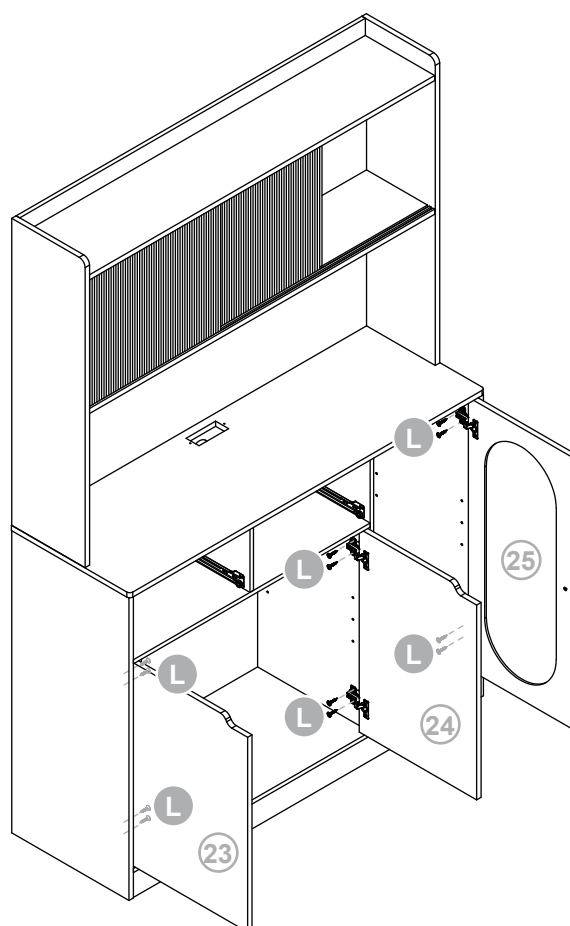

25

I x 8

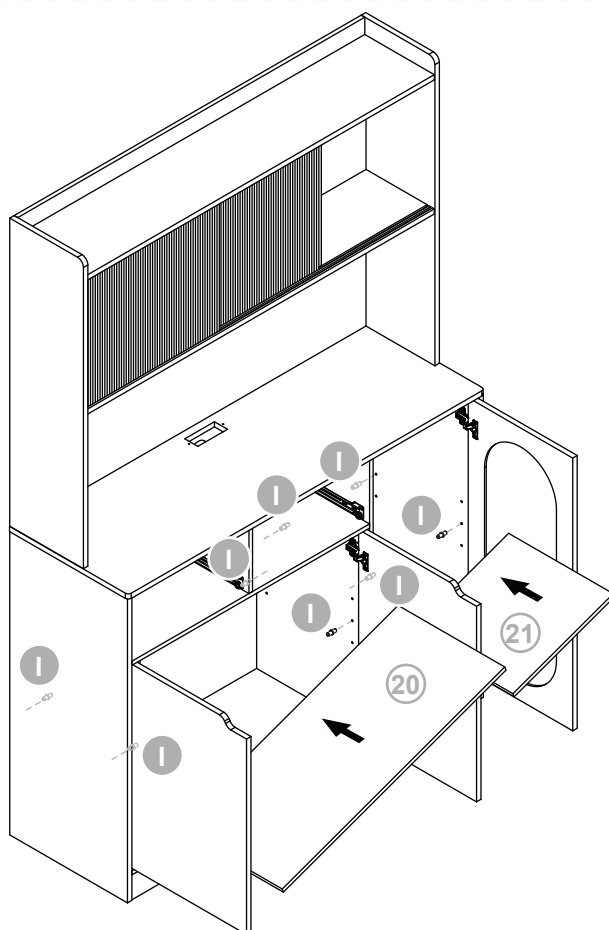

26

D x 8

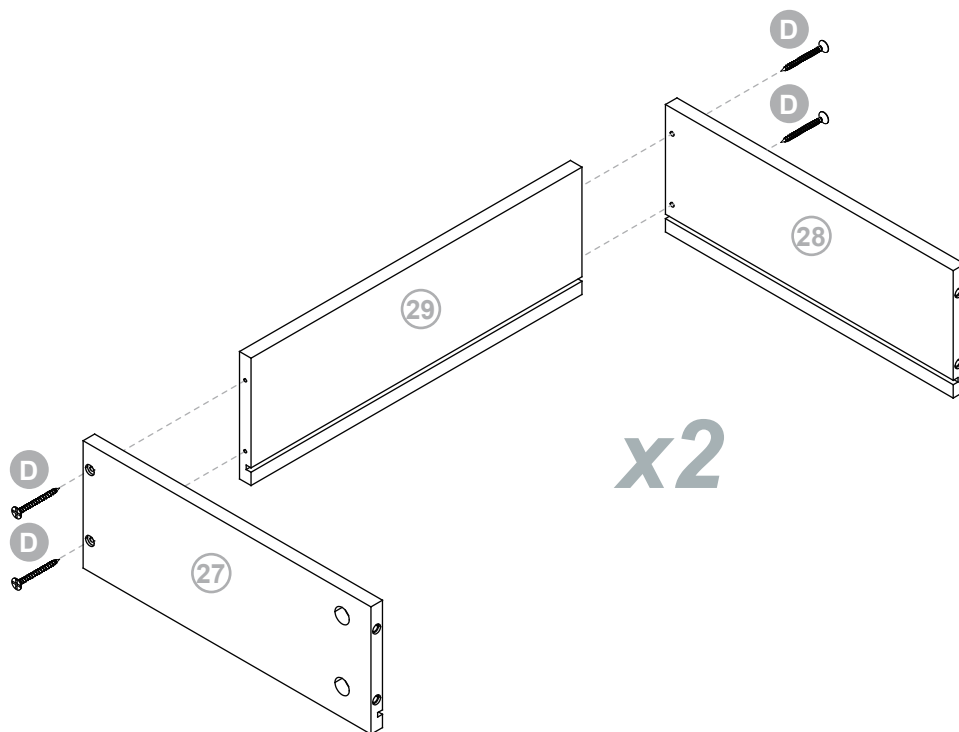
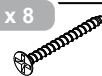

27

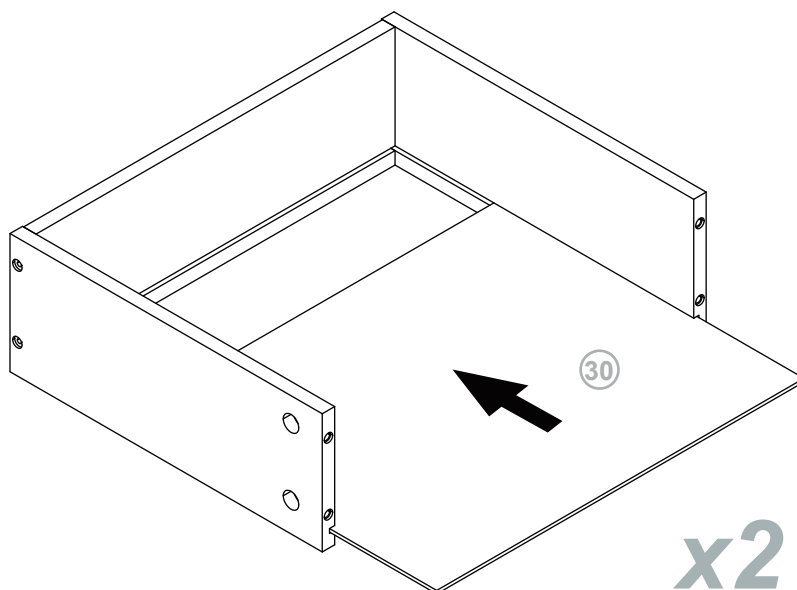

28

A x 8

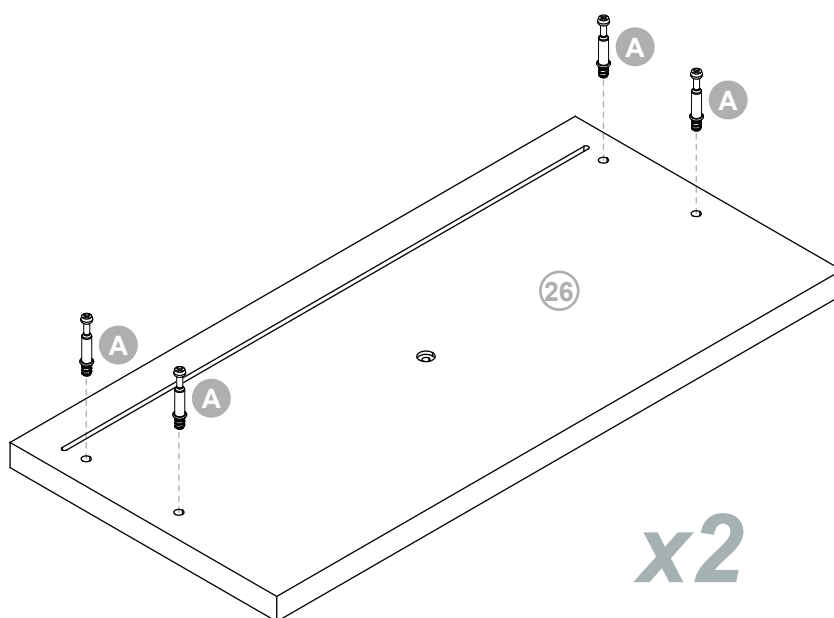

29

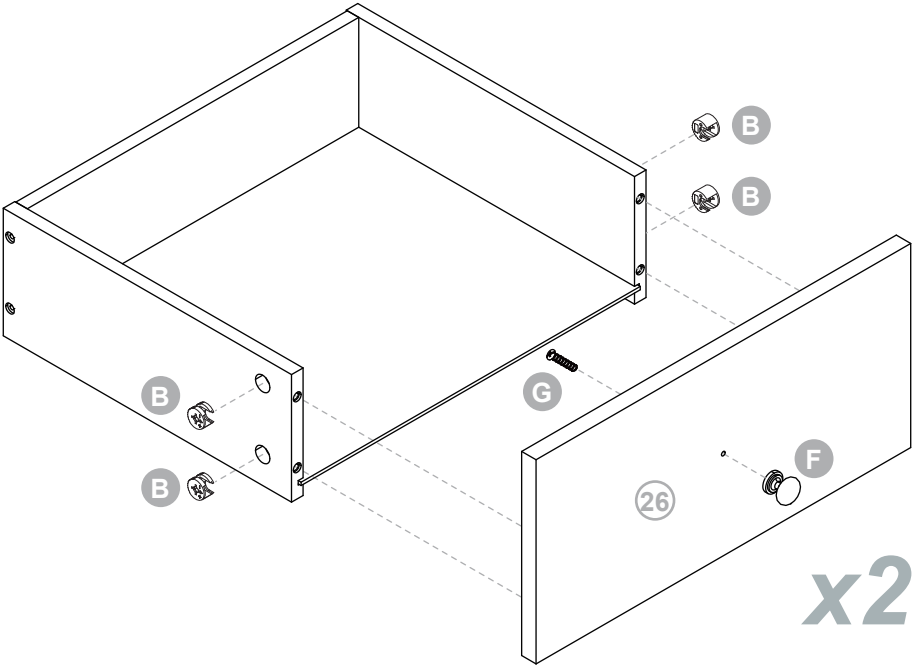
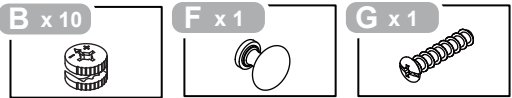

30

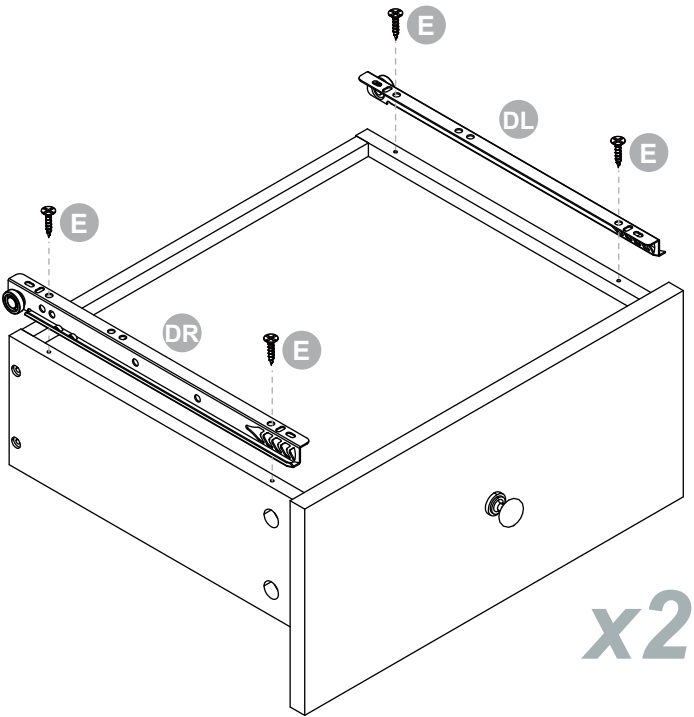
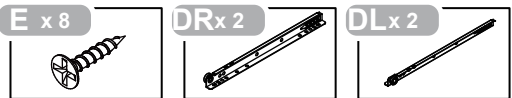

31

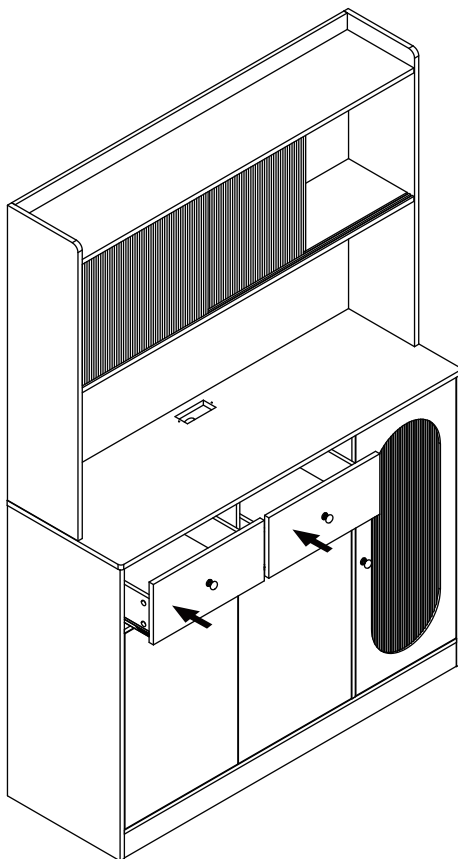

32

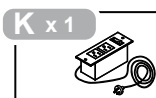
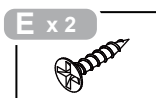
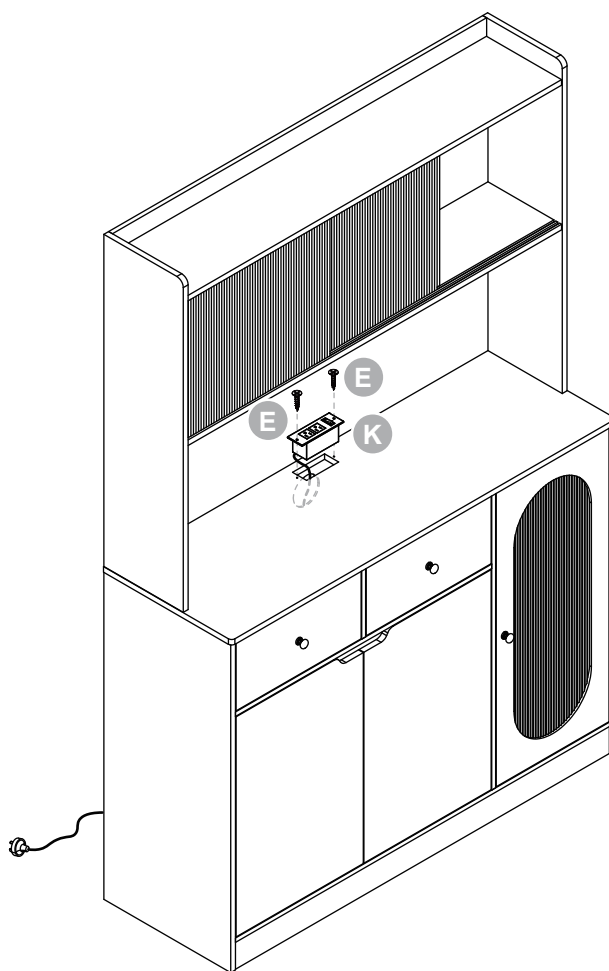

33

J x 16

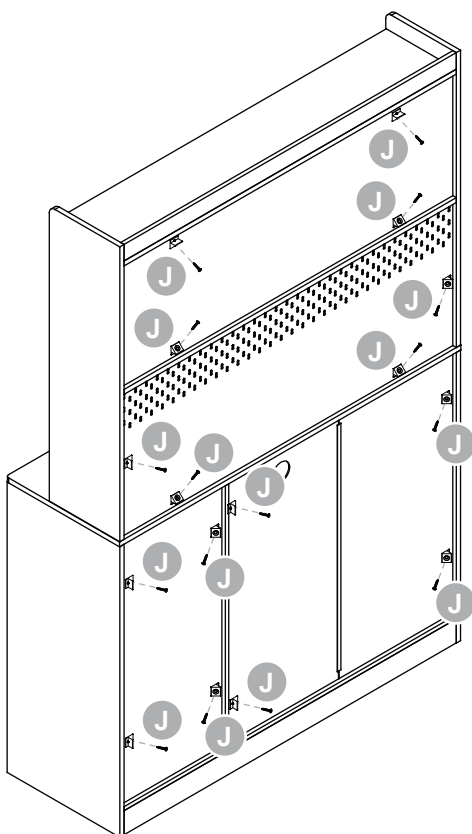

34

N x 4

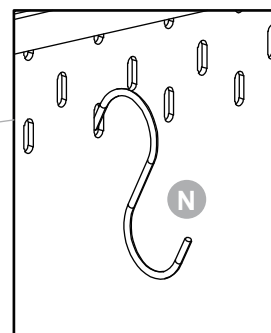
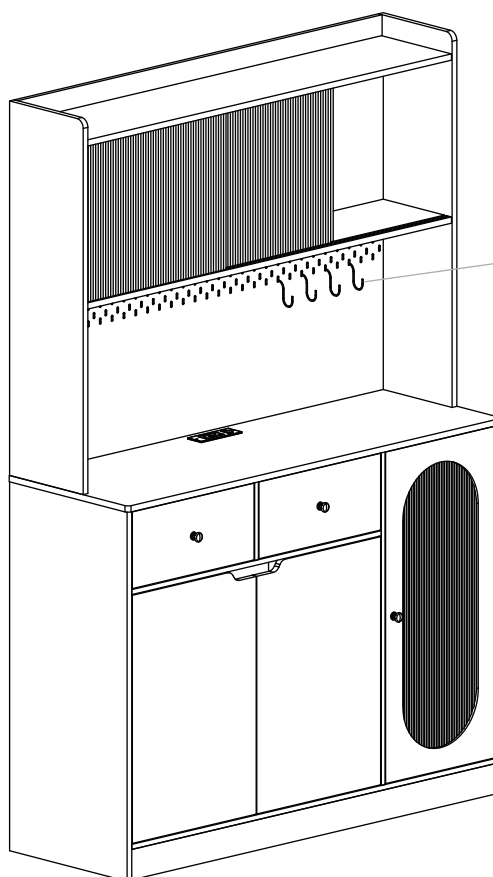

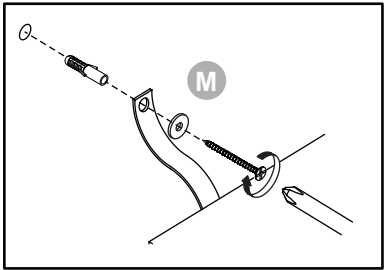
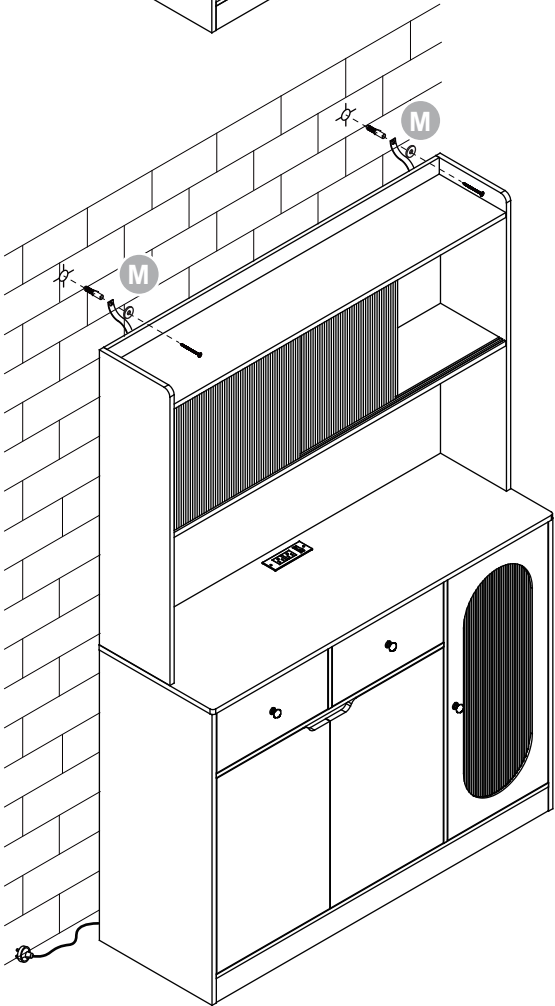
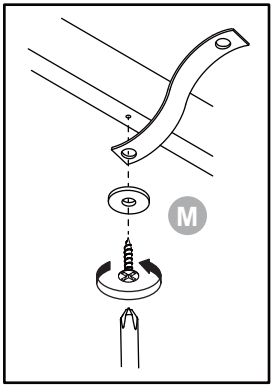
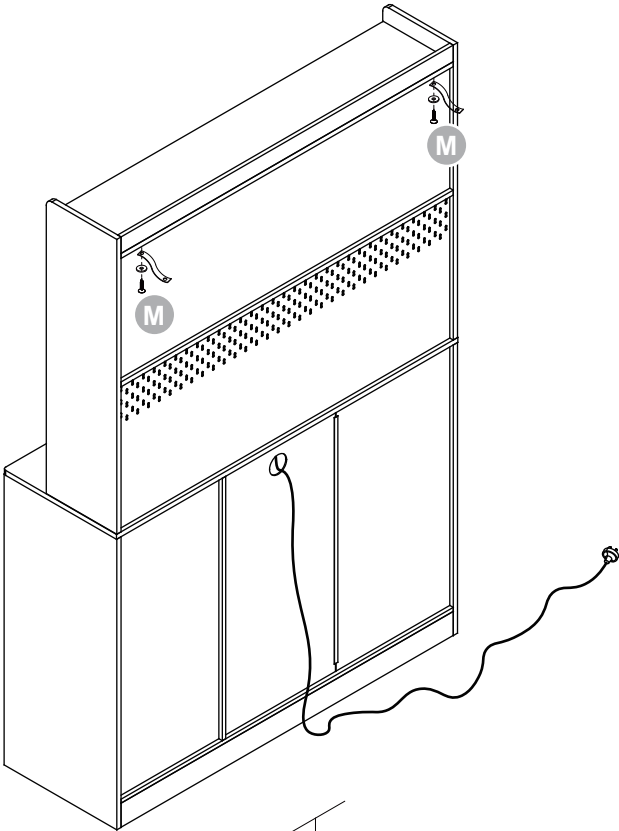
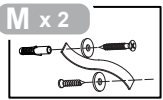

**Customer Attention:**

To align doors and control gap in between doors. Product doors may need adjusting during and after assembly.

This can be done by adjusting appropriate screws. See below illustration.

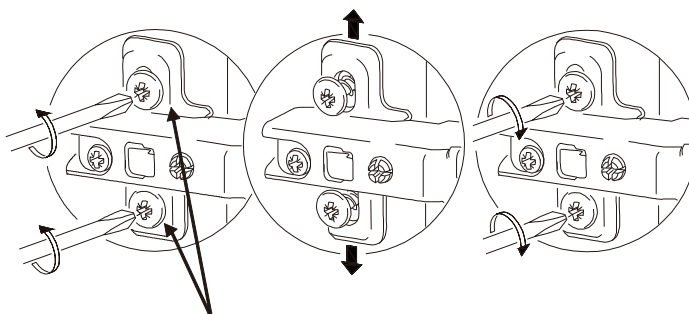
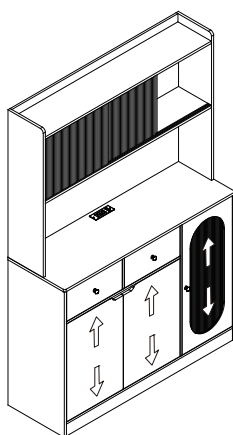
**Vertical Door Adjustment:**

Loosen both screws on all hinges and lift the door to the desired height.

This allows an even space at the top and bottom between the door and frame.

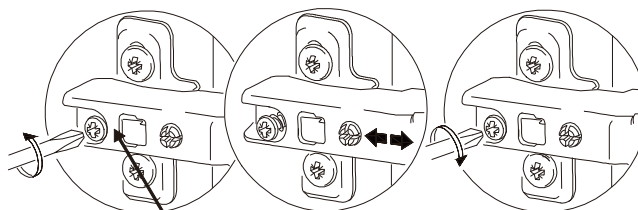
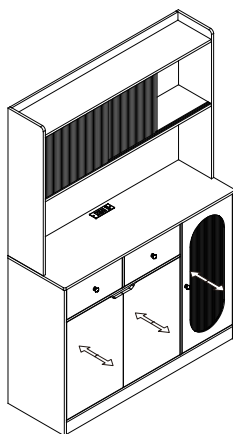
**Lateral Door Adjustment:**

If door is hinge bound, (rubbing on frame as you close or open door) loosening screw shown and move the door in appropriate direction. (In or out)

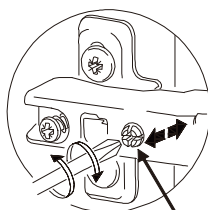
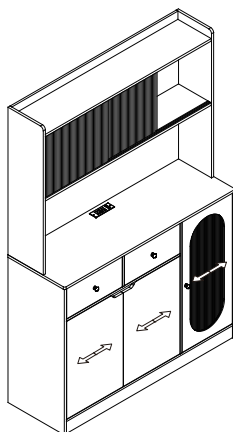
**Horizontal Door Adjustment:**

Rotate Screw clockwise or anticlockwise. This will produce an even gap between doors and frame.