

# ASSEMBLY INSTRUCTIONS

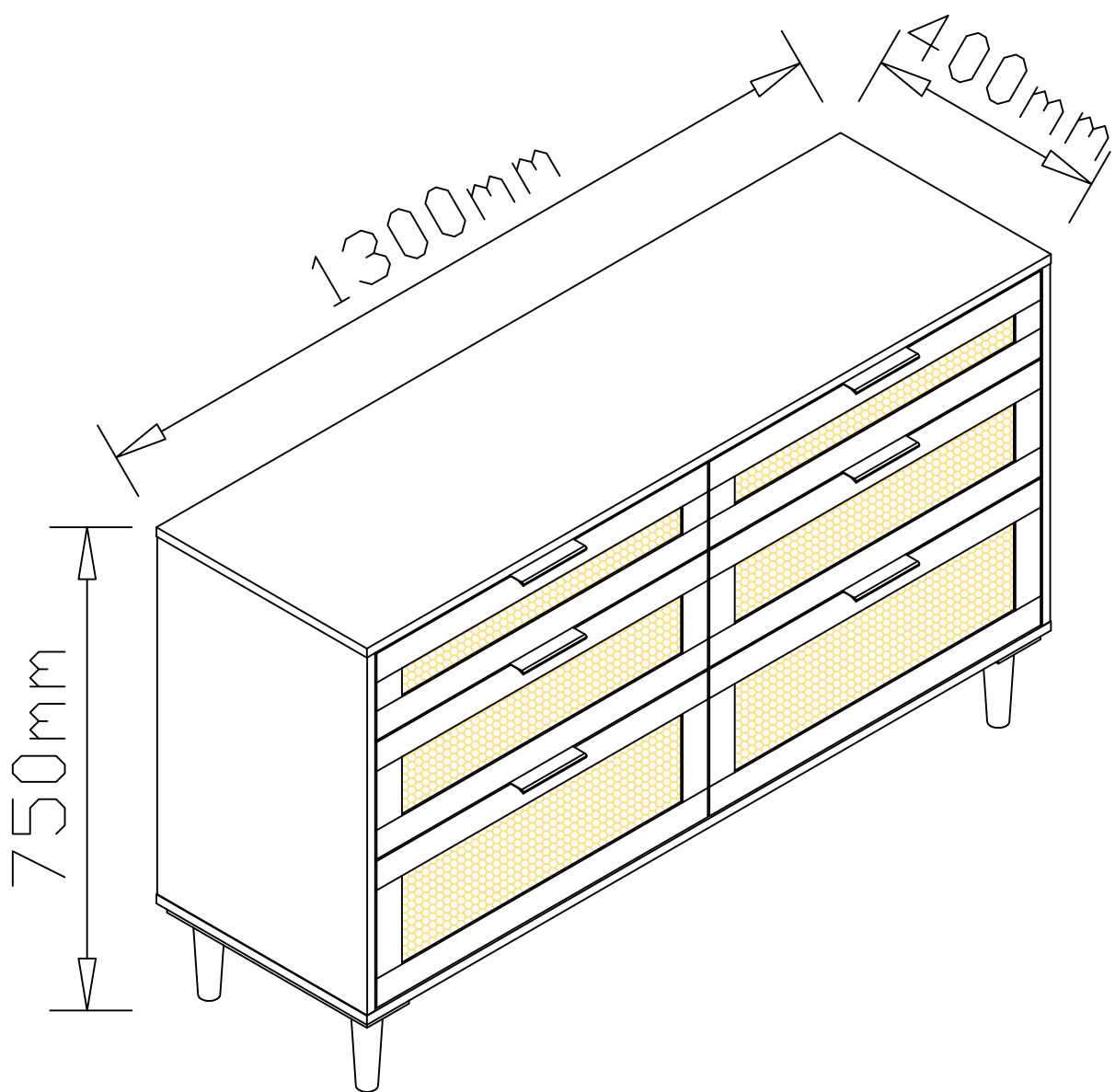

# You will need

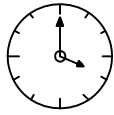

approx. 1 hour

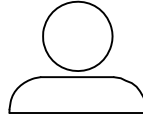

2 person

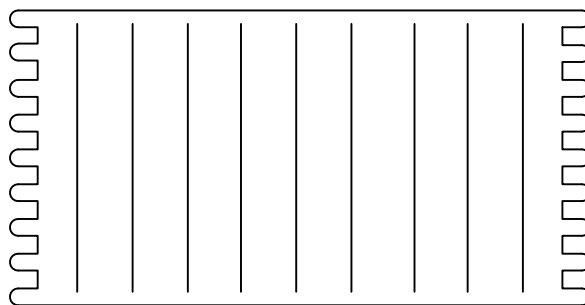
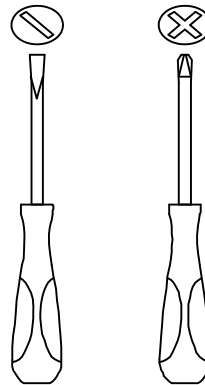
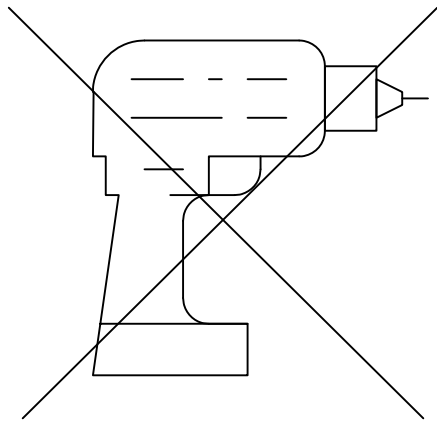

Place your product on a soft surface when assembling



Do you have questions about the  
assembly of your furniture?

Contact your nearest Customer Service !

# PANEL LAYOUT & HARDWARE LIST

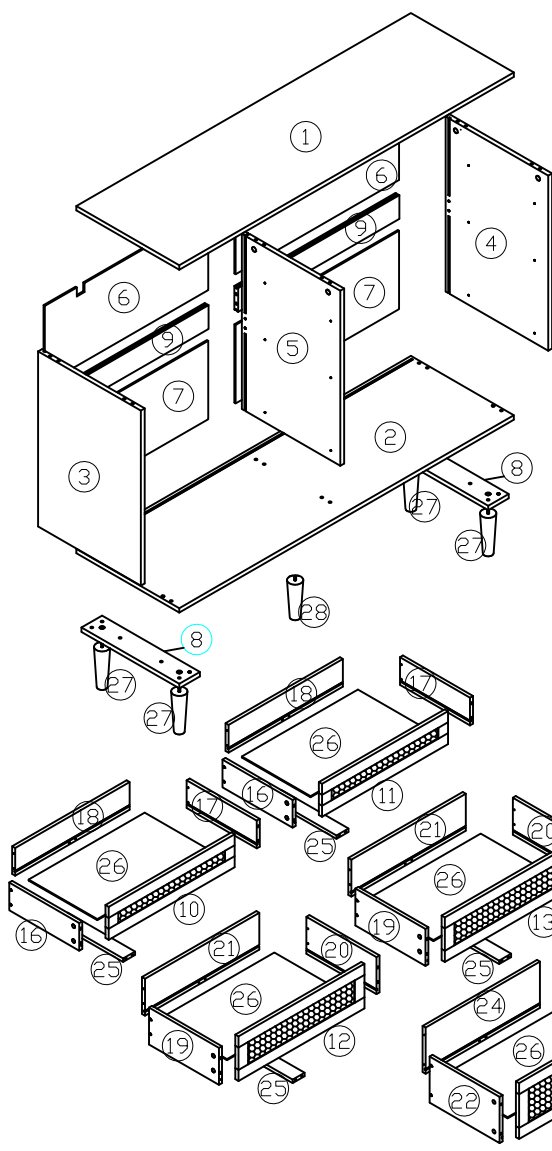

	Antal	mm
1	1	1300*400*15
2	1	1300*400*15
3	1	590*399*15
4	1	590*399*15
5	1	590*382.5*15
6	2	635*264*5
7	2	635*264*5
8	2	380*80*15
9	2	626.5*80*15
10	1	629.5*143*16
11	1	629.5*143*16
12	1	629.5*193*16
13	1	629.5*193*16

	Antal	mm
14	1	629.5*242*16
15	1	629.5*242*16
16	2	350*100*15
17	2	350*100*15
18	2	571.5*100*15
19	2	350*160*15
20	2	350*160*15
21	2	571.5*160*15
22	2	350*200*15
23	2	350*200*15
24	2	571.5*200*15
25	6	336*60*15
26	6	579.5*343*5
27	4	h:115
28	1	h:125

A	B	C	D
E	F	G	H
I	J	K	L
M	N	O	P

Nr	Antal	mm
A	52	Ø6x35
B	52	Ø15x9.5
C	14	Ø8x30
D	6	350
E	1	Ø19xM6x15
F	6	120
G	2	6*30
H	24	15x15x9
I	24	Ø3x16
J	40	Ø4x35
K	62	Ø3.5x12
L	12	M6x25

Nr	Antal	mm
M	6	Ø7x50
N	1	4
O	4	Ø4x12
P	2	75x25x15

d is drawer slide.

CL for the left of cabinet,

CR for the right of cabinet;

DL for the left of drawer,

DR for the right of drawer.

Screwdrivers are not included in the accessories.

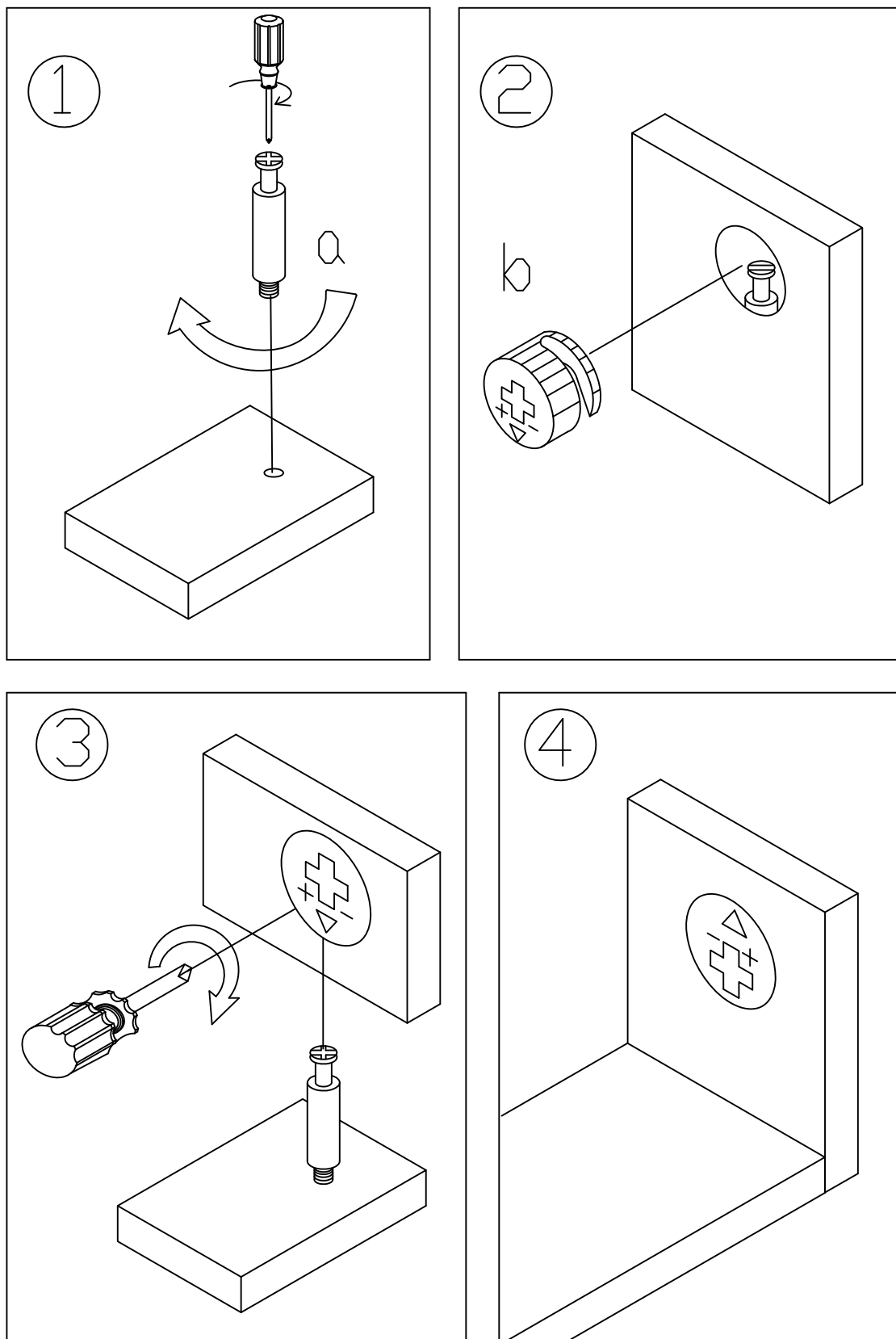

# Assembly

Follow the step-by-step instructions

DON'T FULLY TIGHTEN THE SCREWS  
BEFORE FINISHING ASSEMBLY.

1.

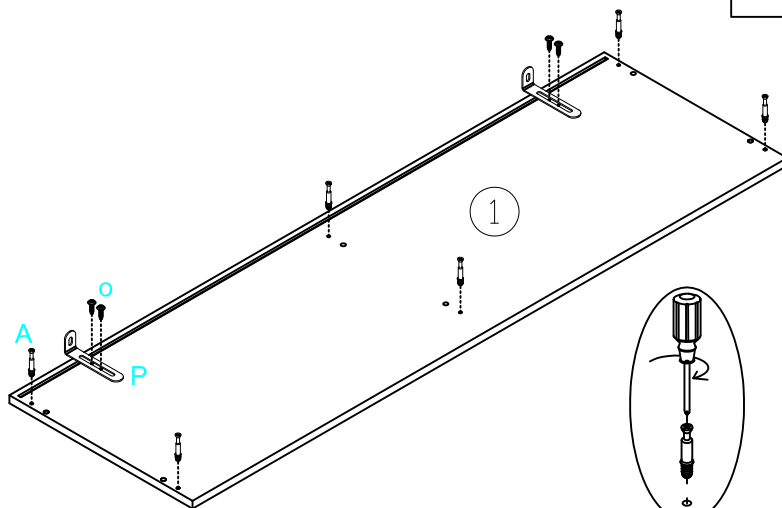
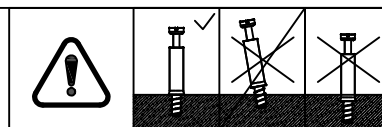

Ax6

(A) x6	(P) x2	(C) x4	

2.

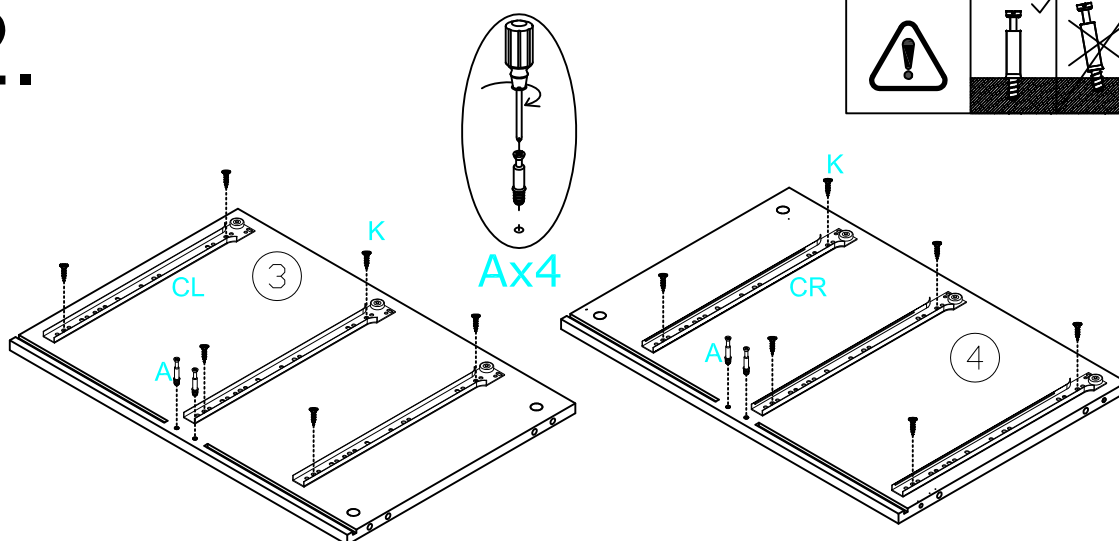
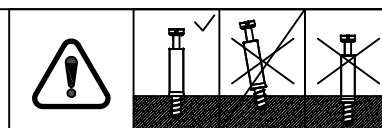

Ax4

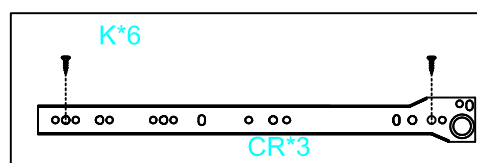
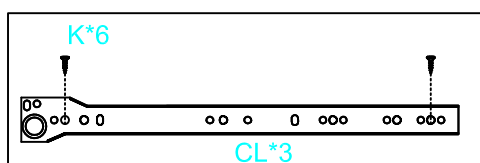

(A) x4	(D) x3	(K) x12	

# 3.

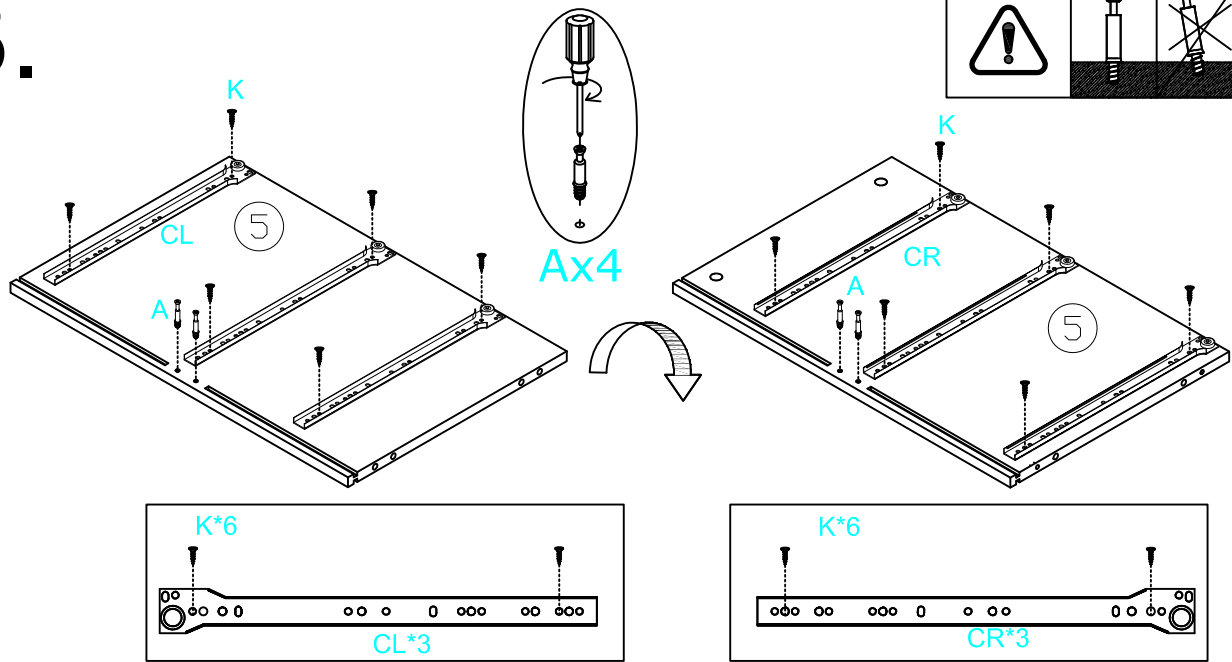

Ⓐ x4	Ⓓ x3	Ⓚ x12	

# 4.

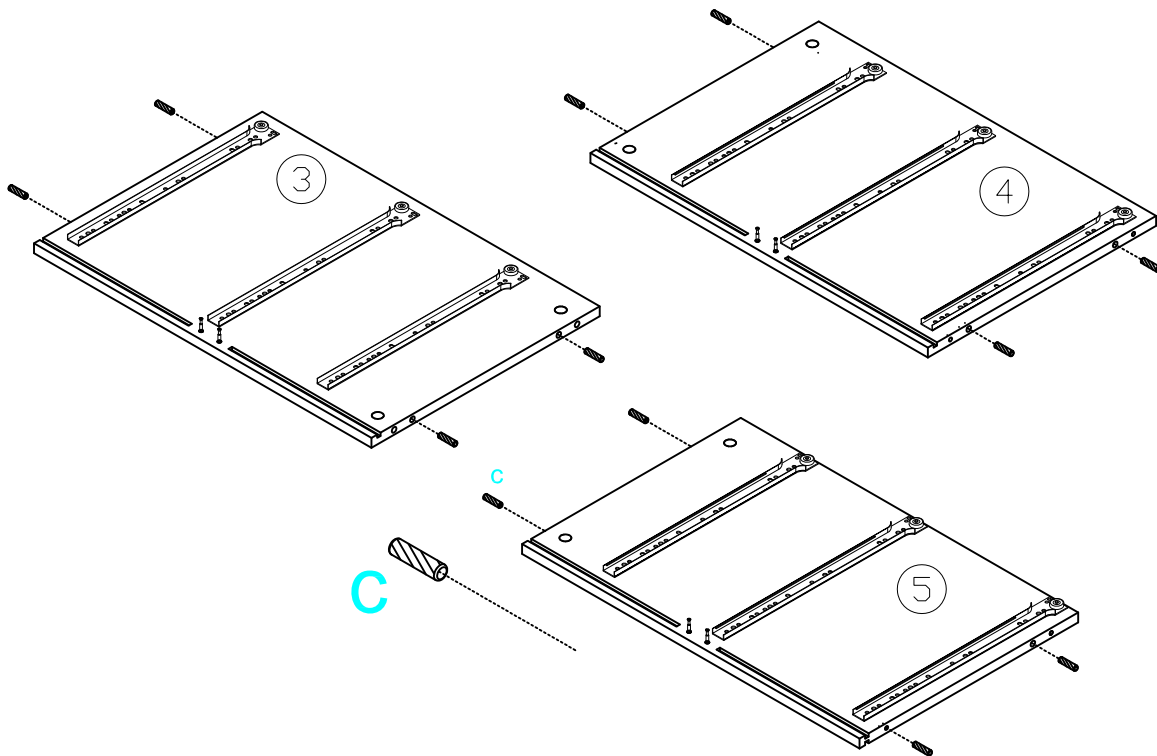

Ⓒ x12	

# 5.

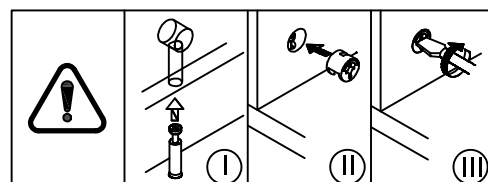
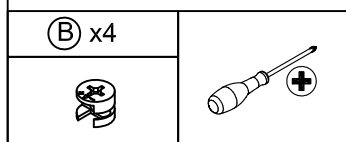
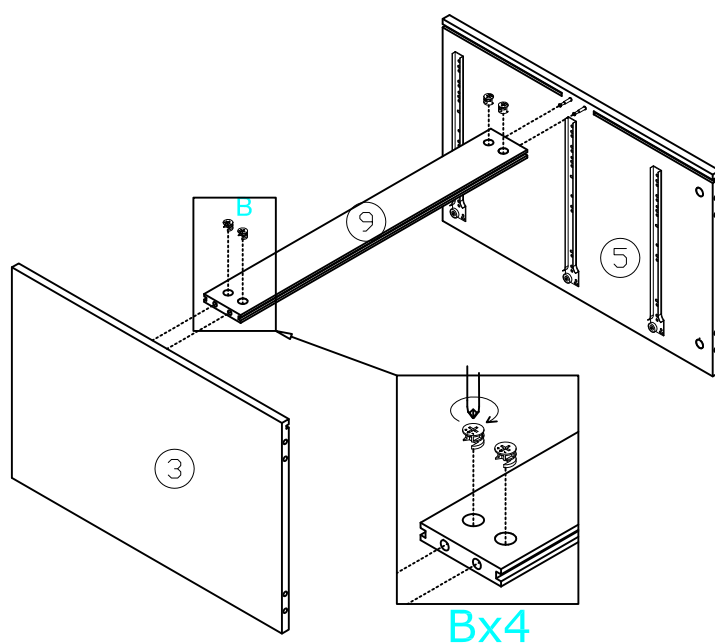

# 6.

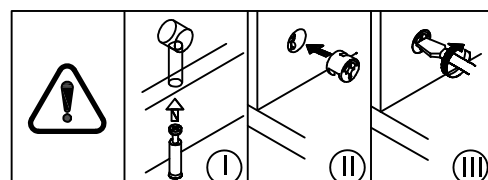
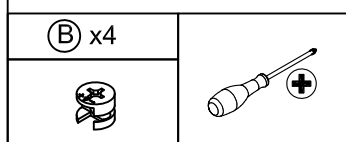
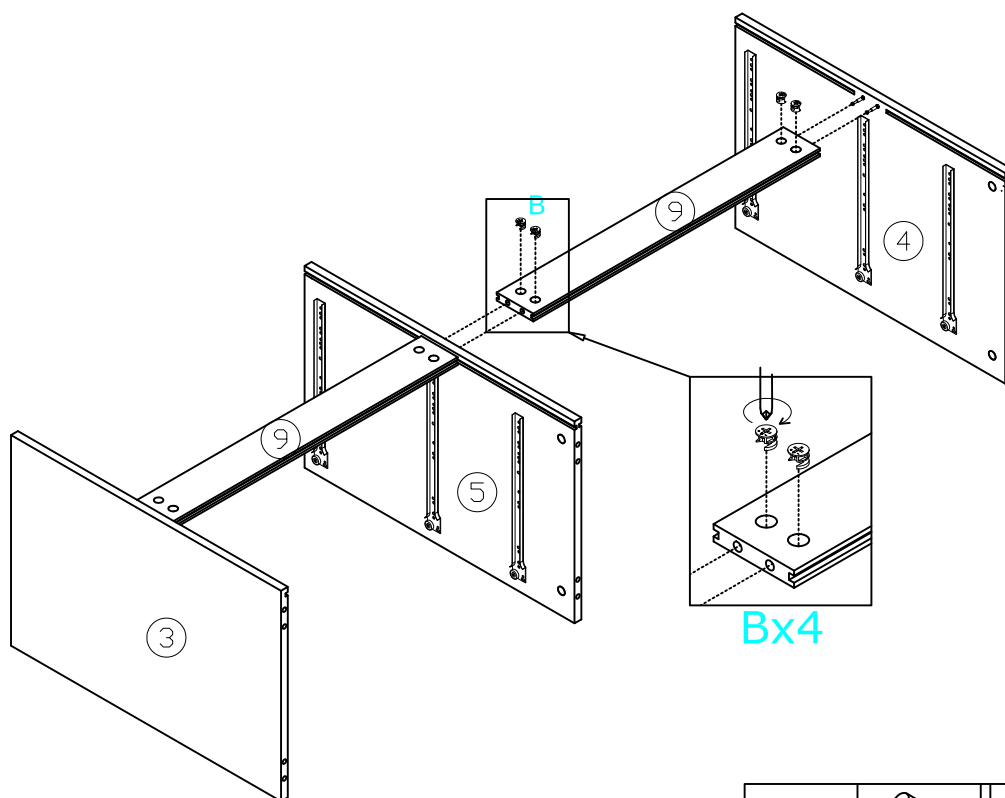

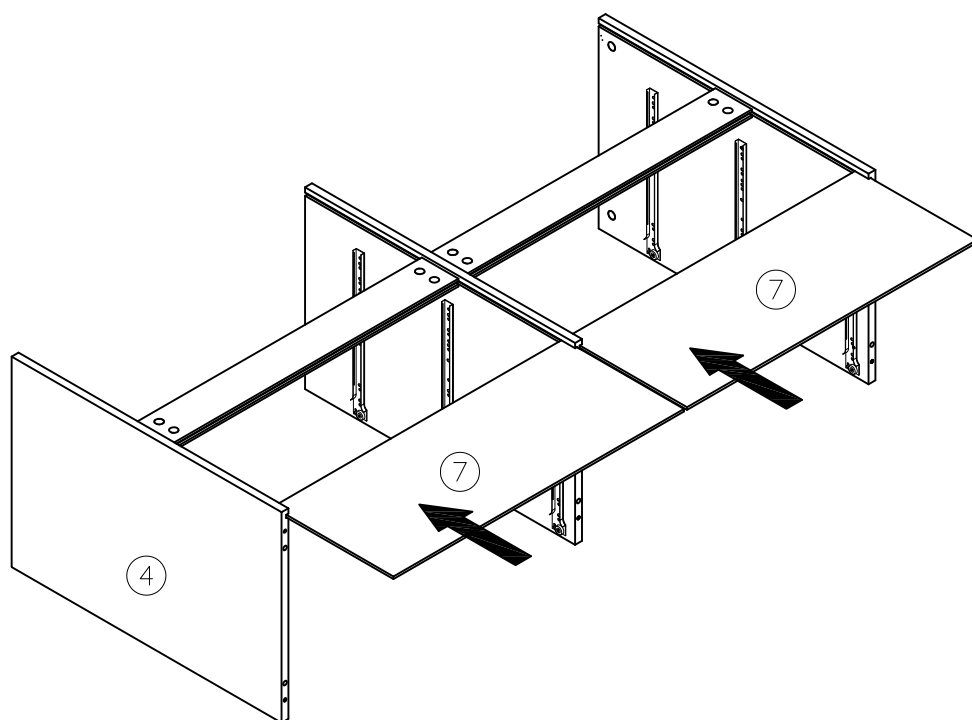

# 7.

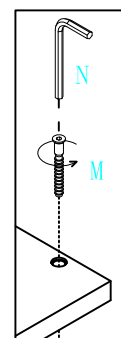
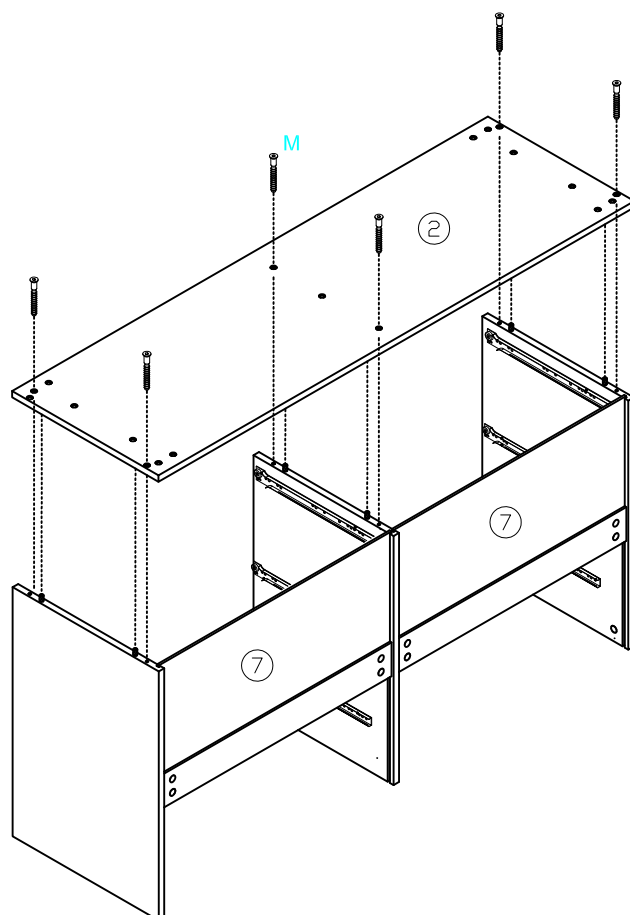

# 8.



(M) x6	(N) x1
	



# 9.

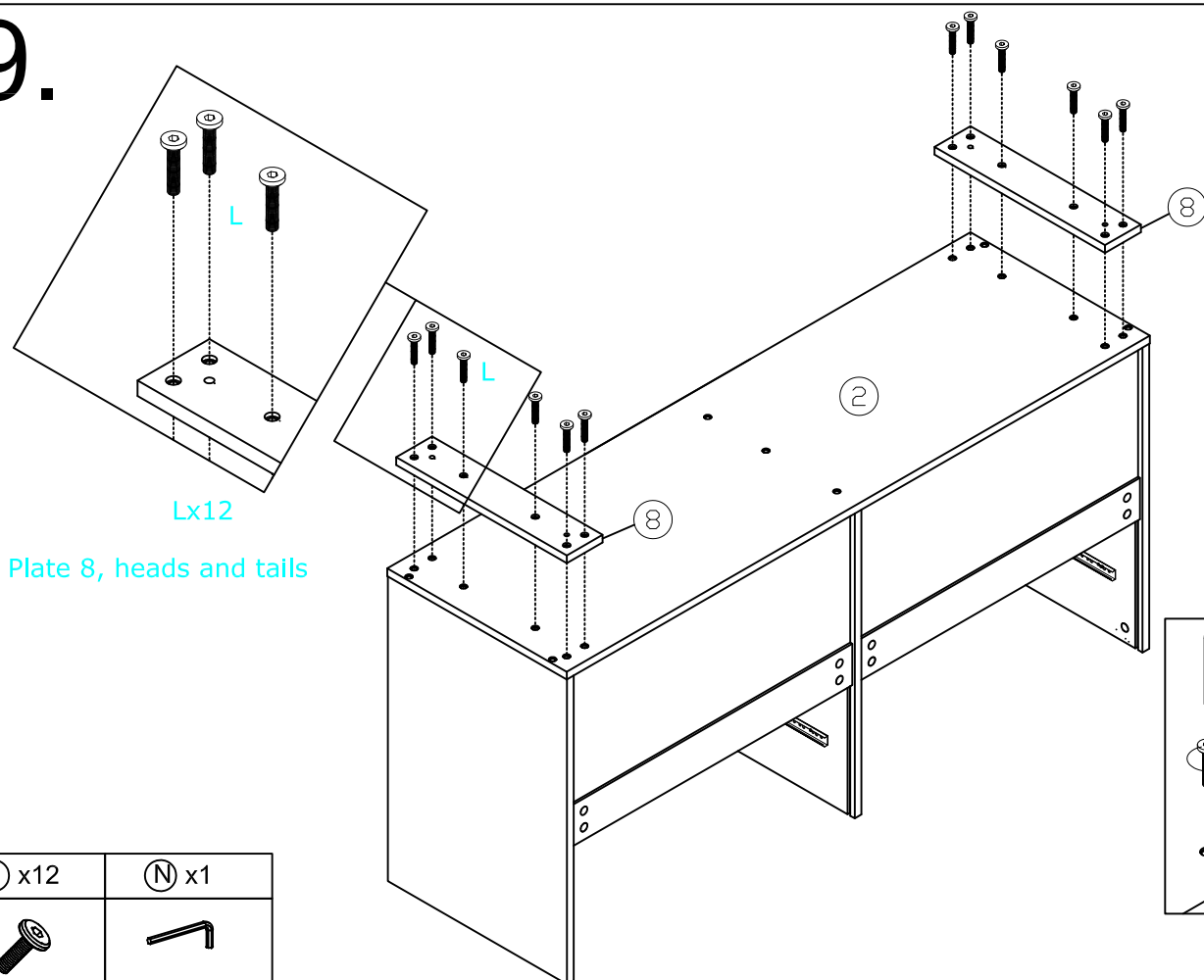

# 10.

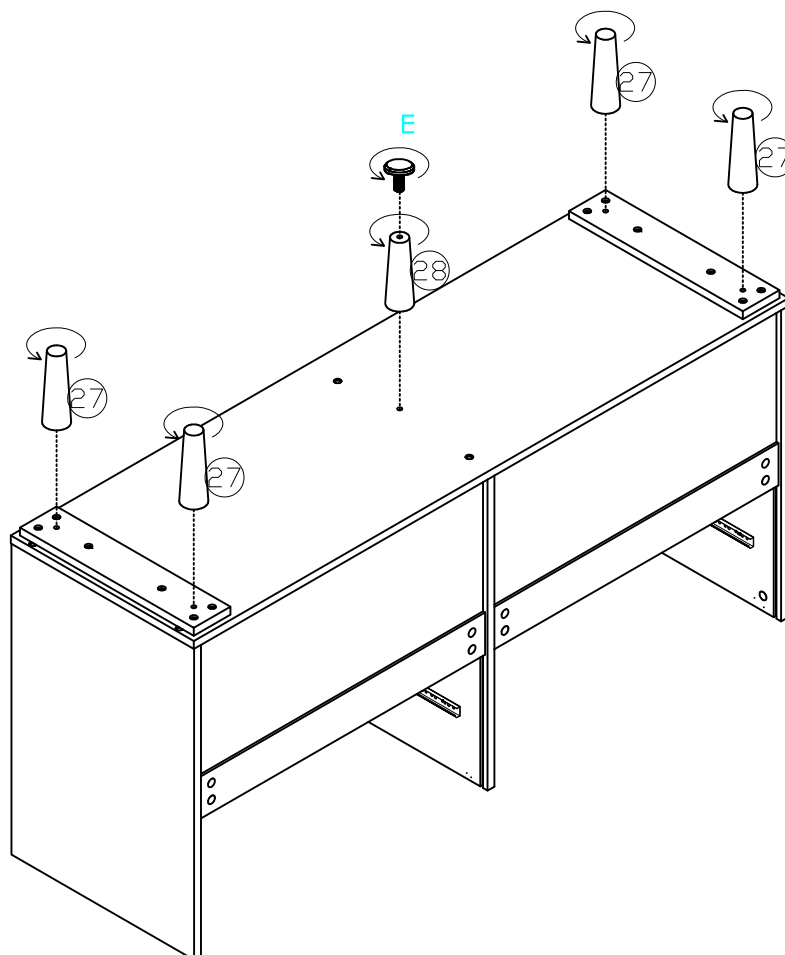

# 11.

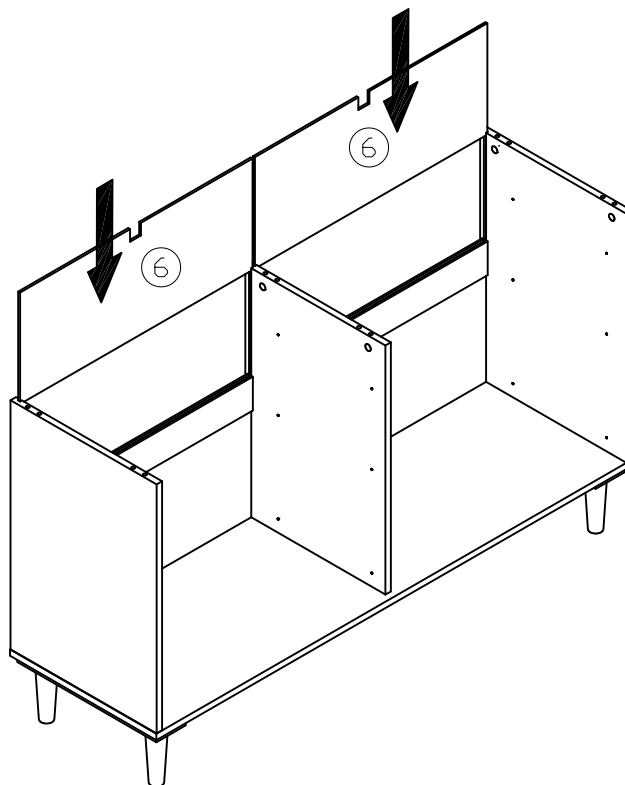

# 12.

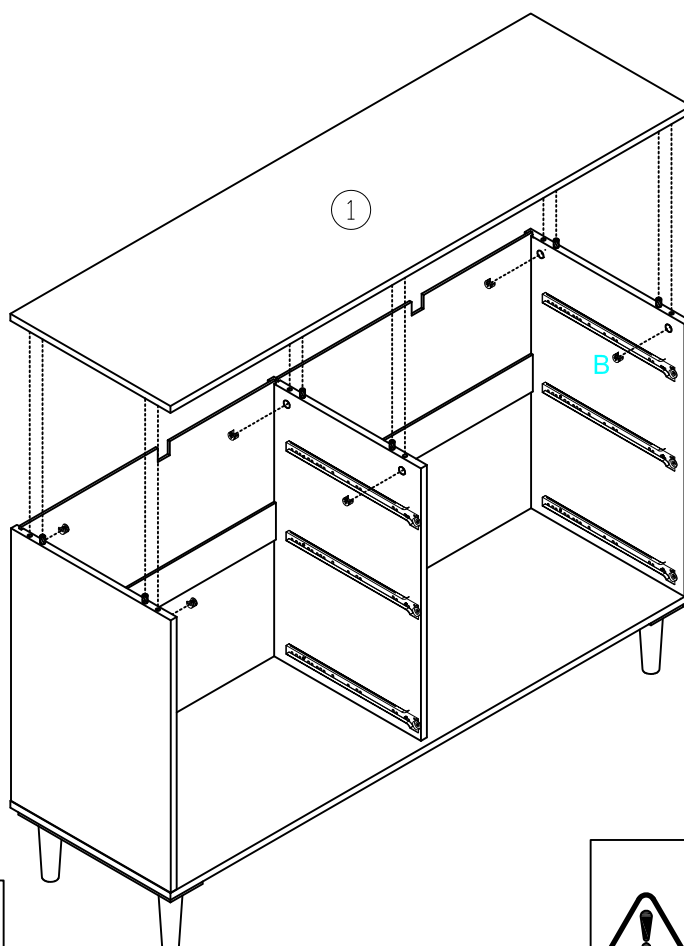

(B) x6

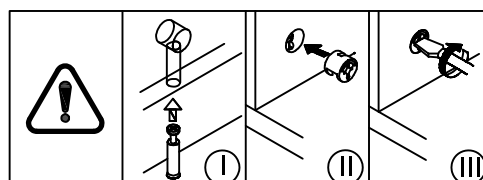
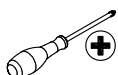

# 13.

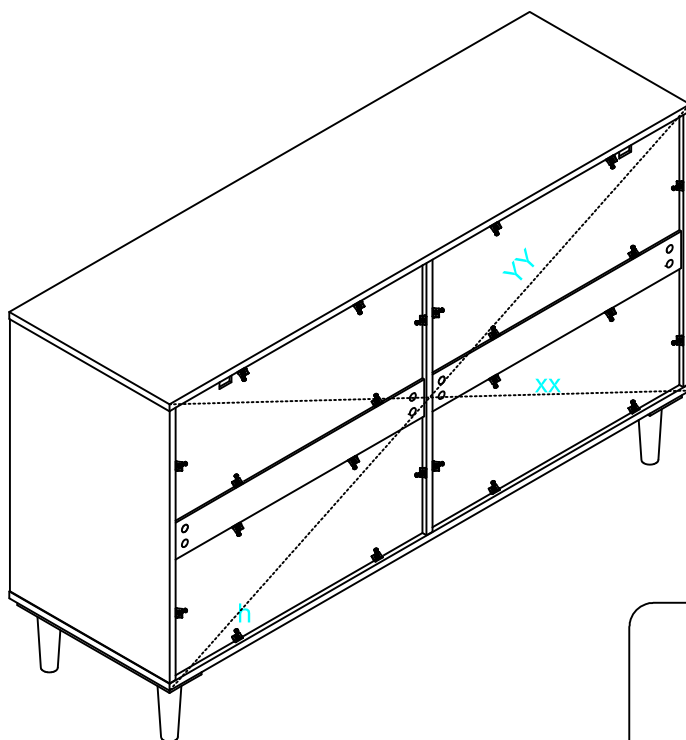

$XX=YY=90^\circ$

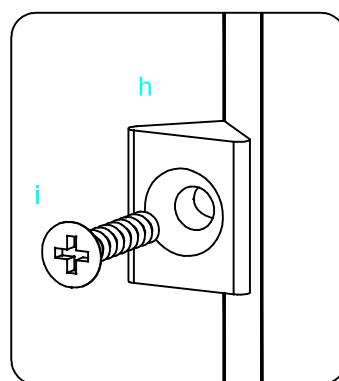

hx24 ix24

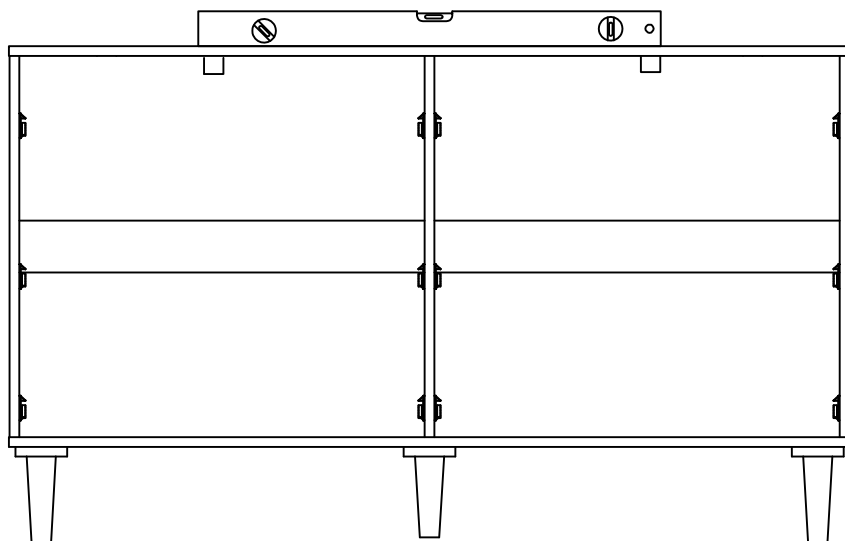

If you have a gradienter in your home, you can use it to adjust the tilt angle of the dresser to keep them at  $180^\circ$  after installing them.

(h) x24	(i) x24			

# 14.

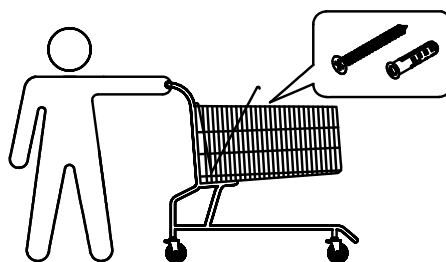
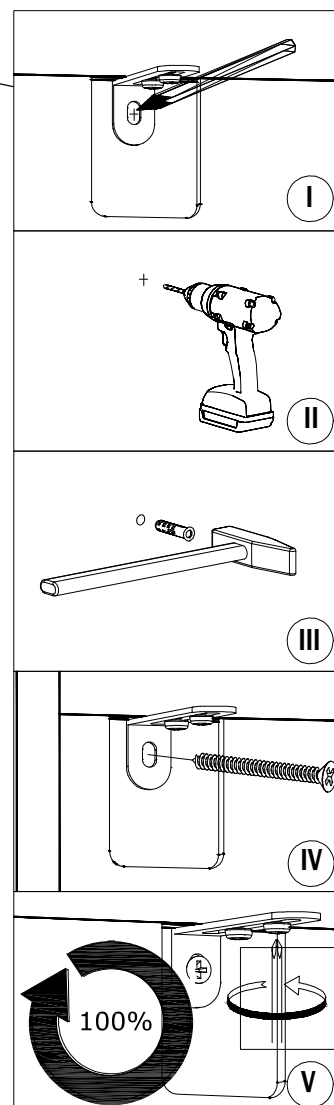
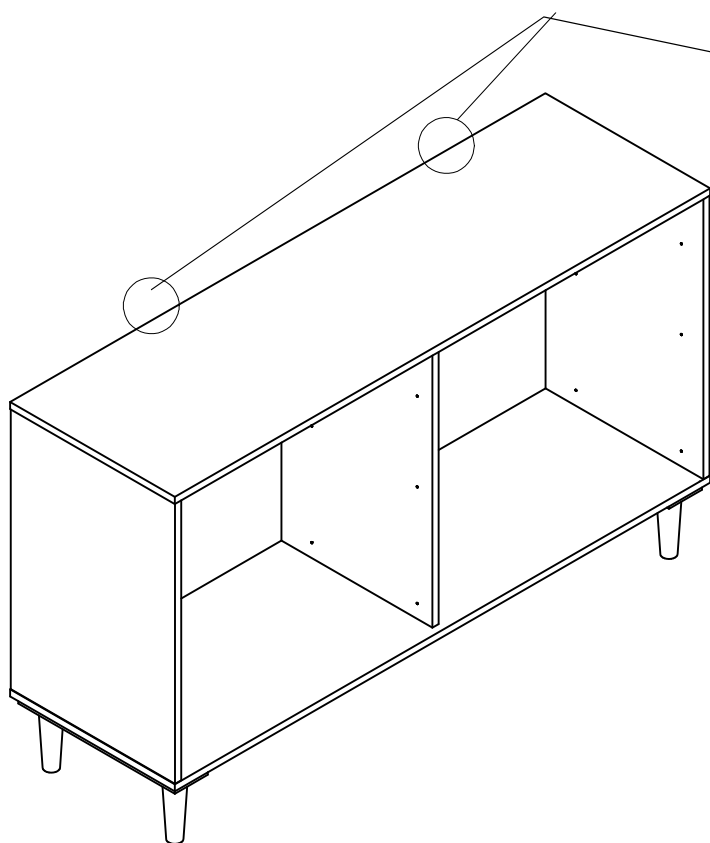
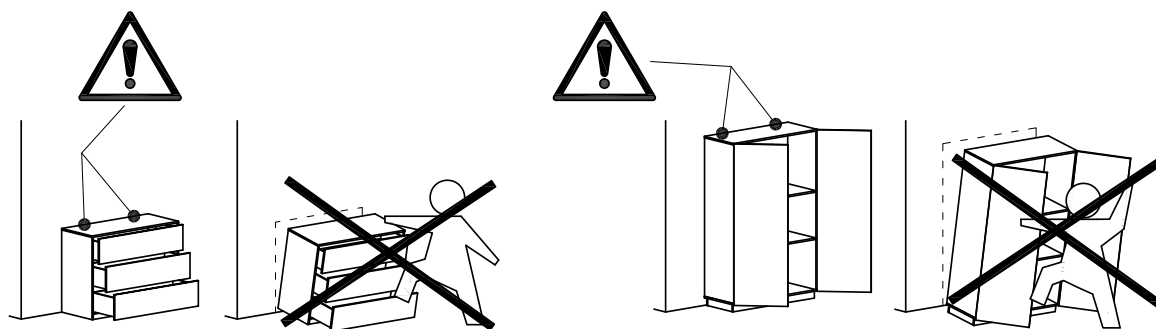

⑨ x2	① x2				

# 15.

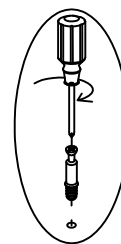
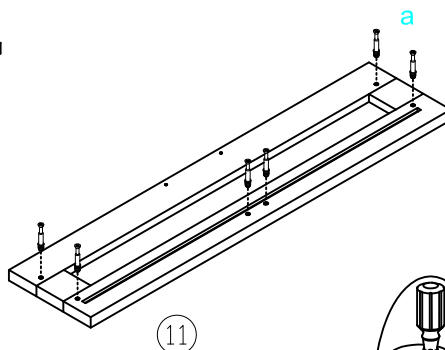
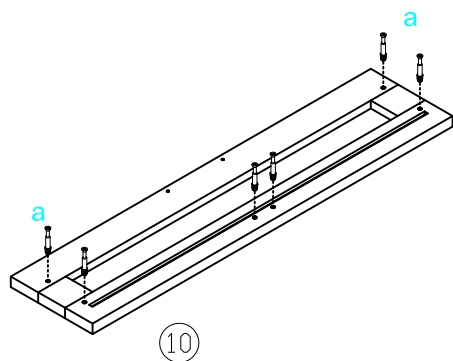
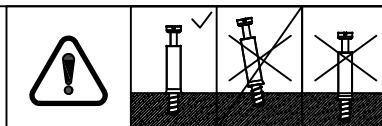

Ax12

(A) x12

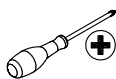

# 16.

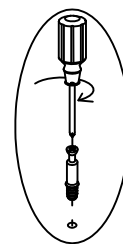
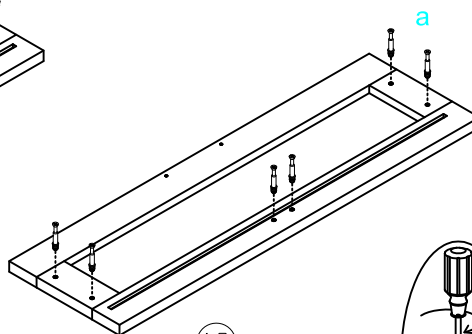
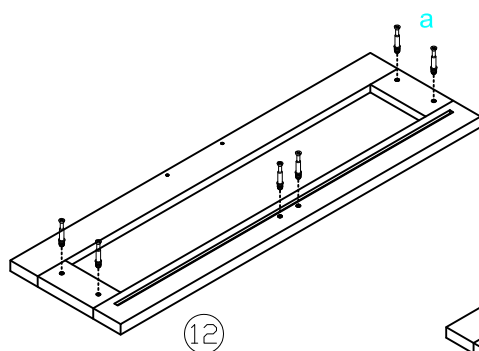
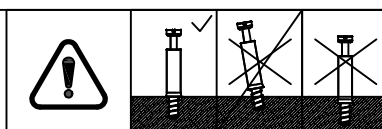

Ax12

(A) x12

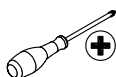

# 17.

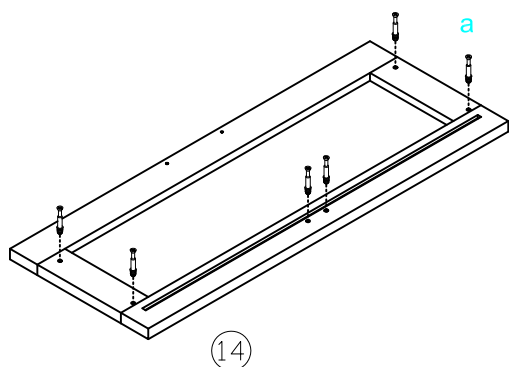
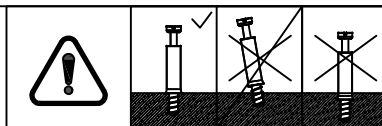

14

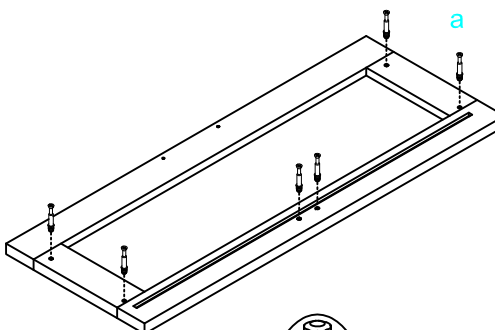

15

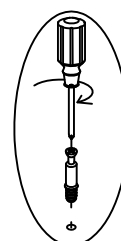

Ax12

(A) x12

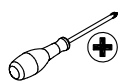

# 18.

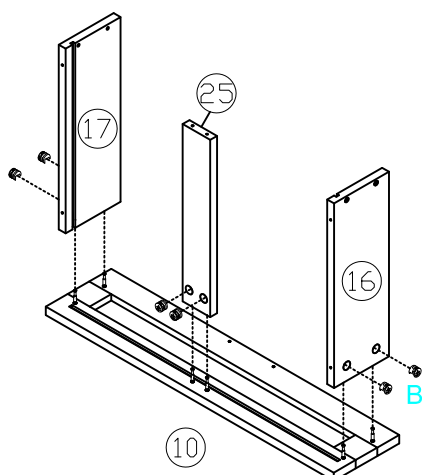

10

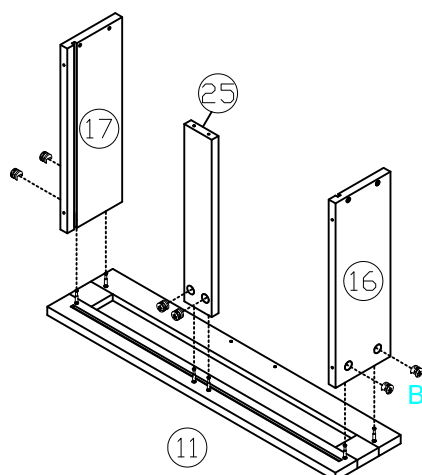

11

(B) x12

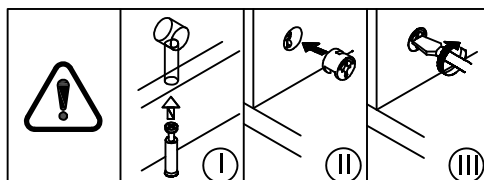
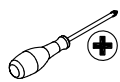

# 19.

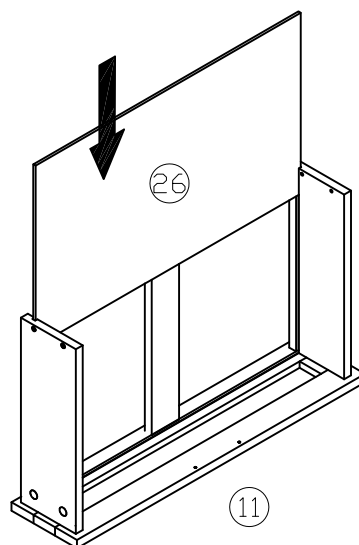
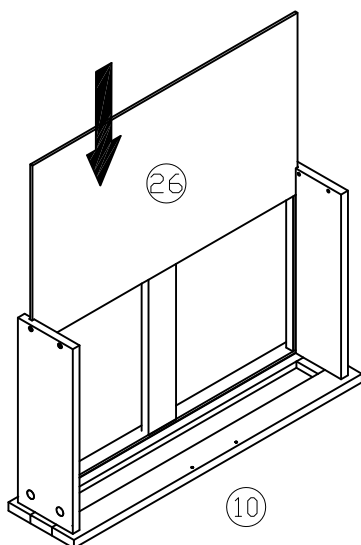

# 20.

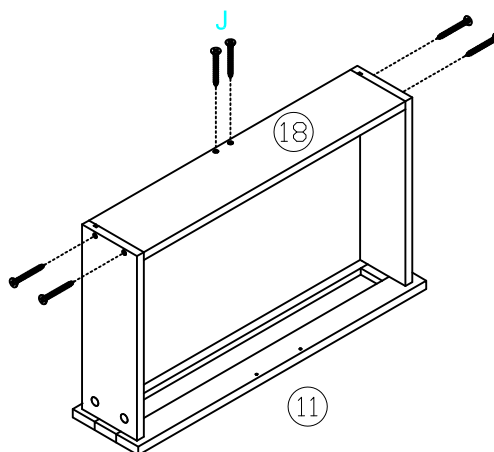
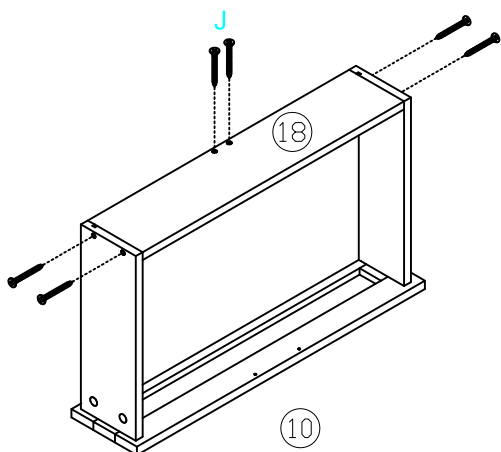

ⓐ x12

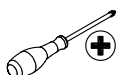

# 21.

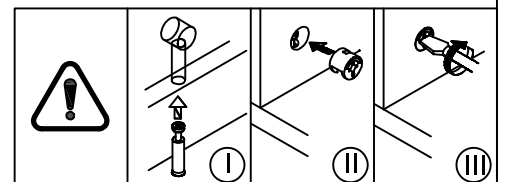
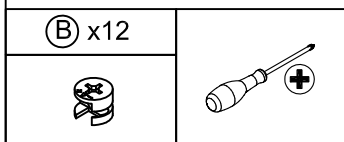
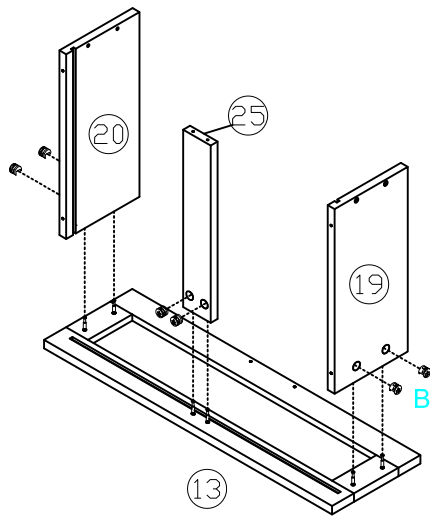
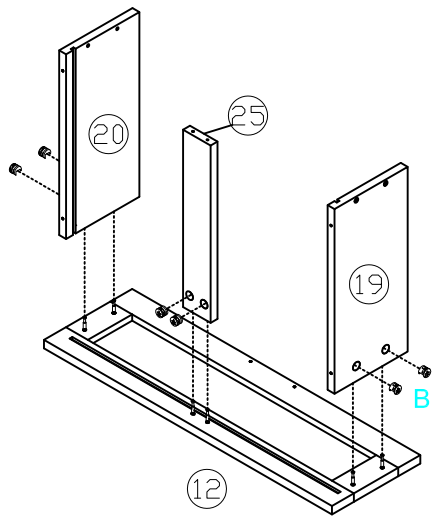

# 22.

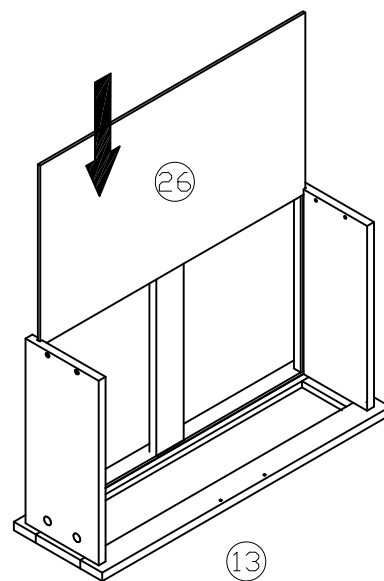
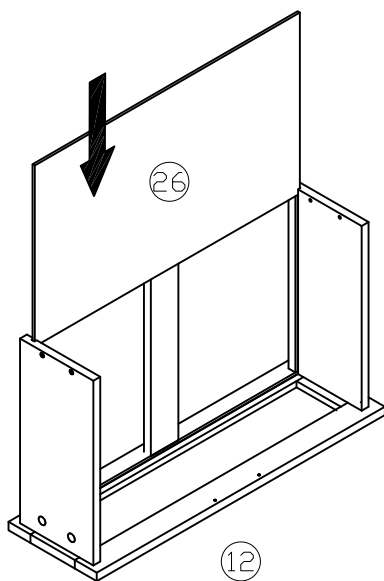



# 23.

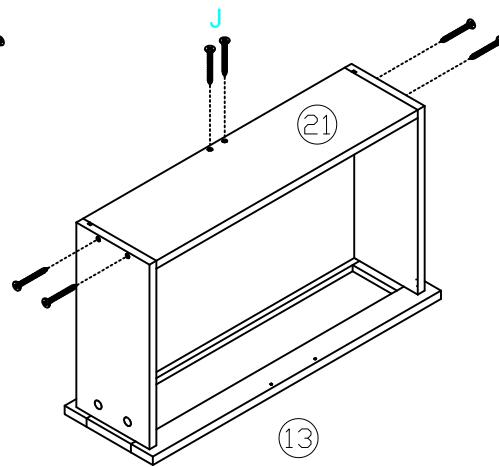
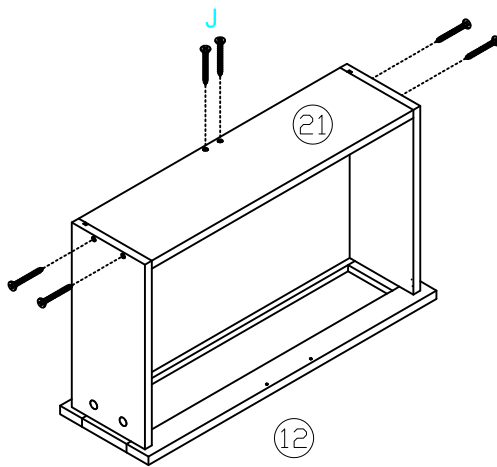

ⓐ x12

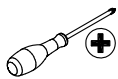

# 24.

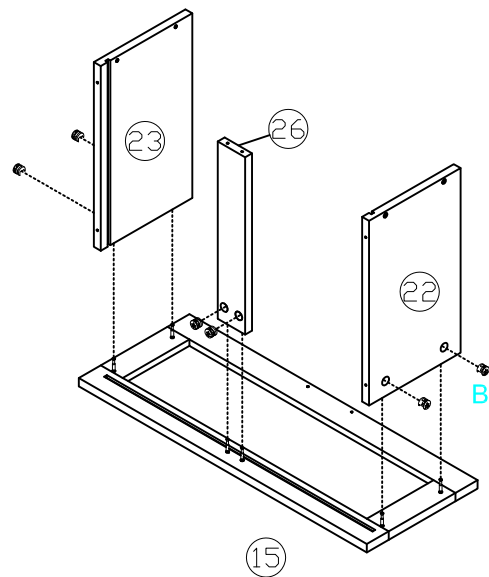
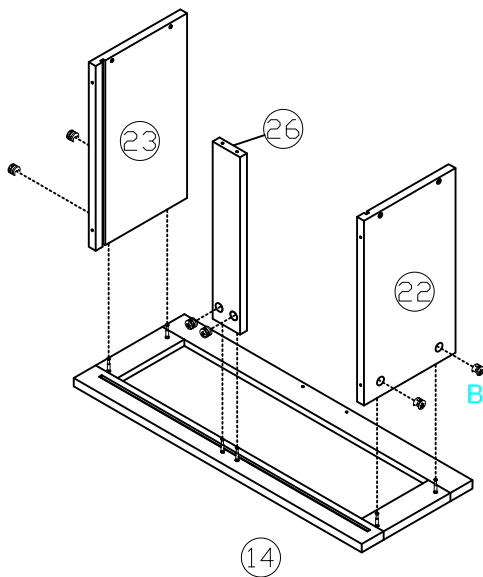

ⓑ x12

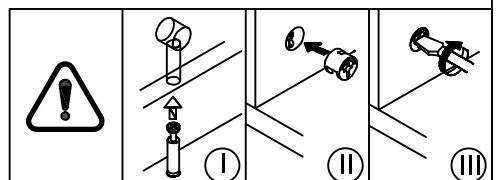
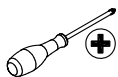

# 25.

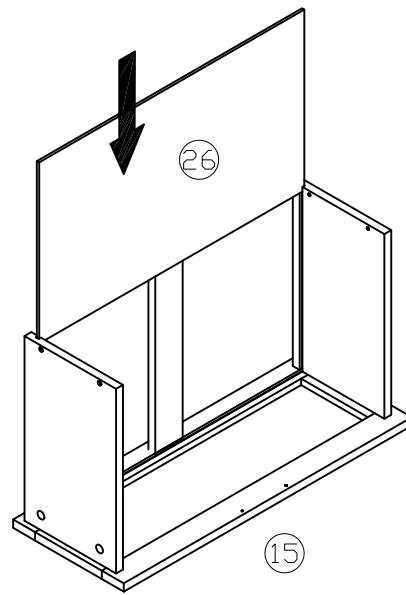
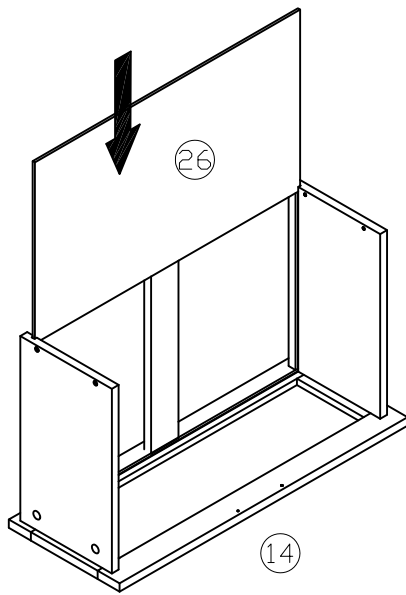

# 26.

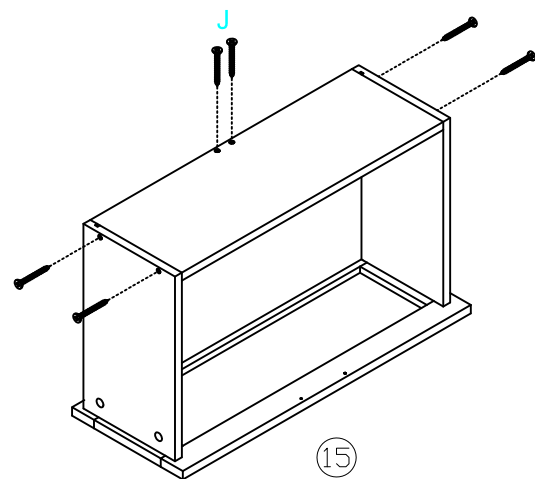
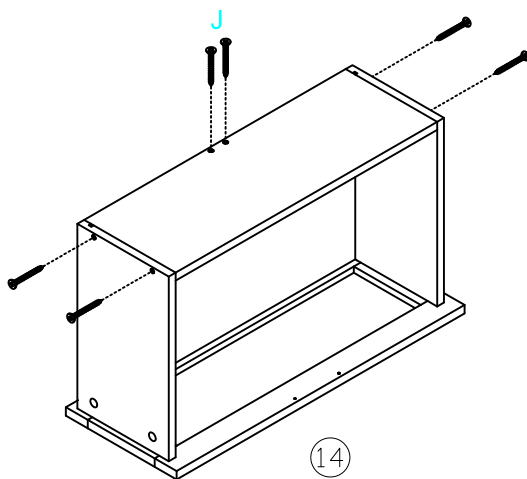

ⓐ x12

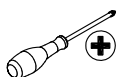

# 27.

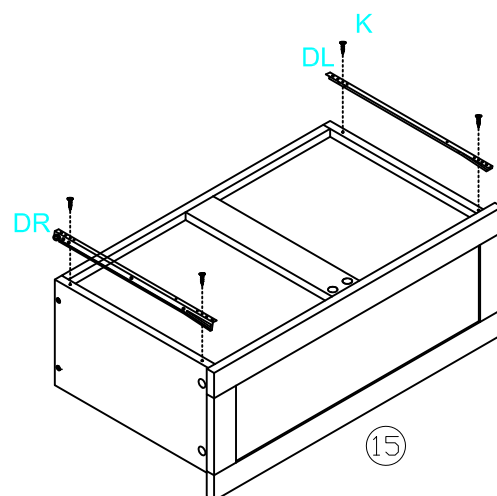
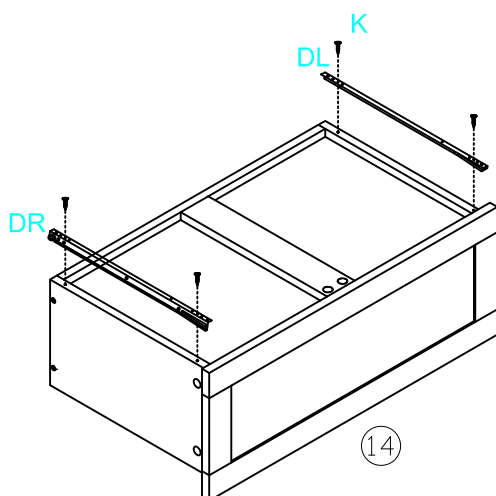
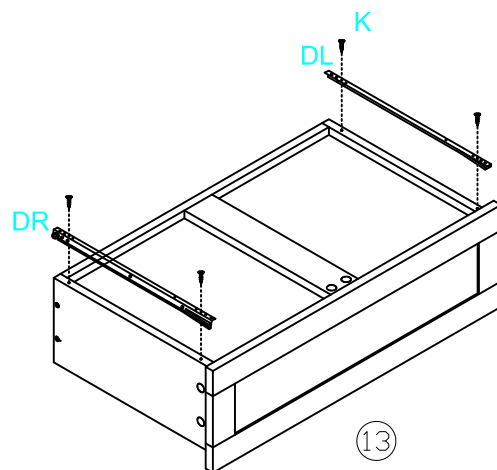
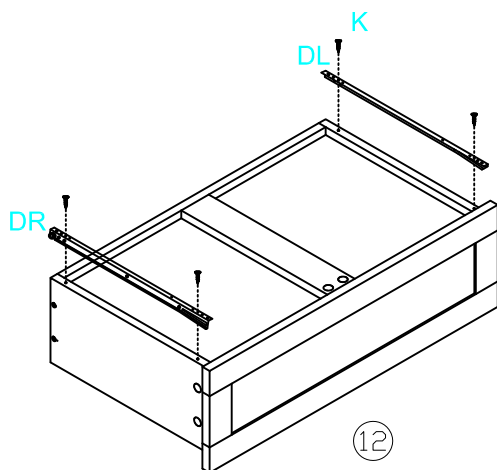
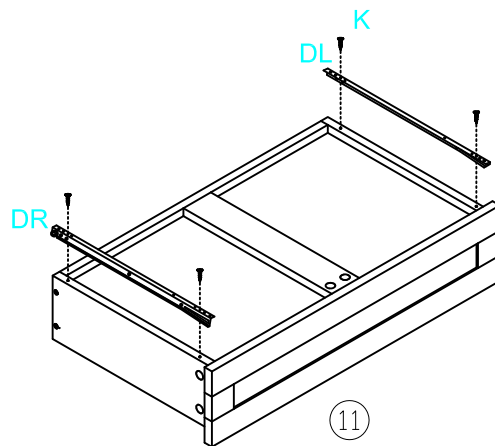
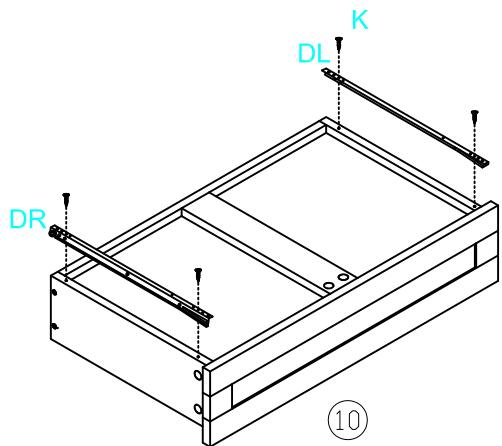

Ⓚ x6	Ⓚ x24	

# 28.

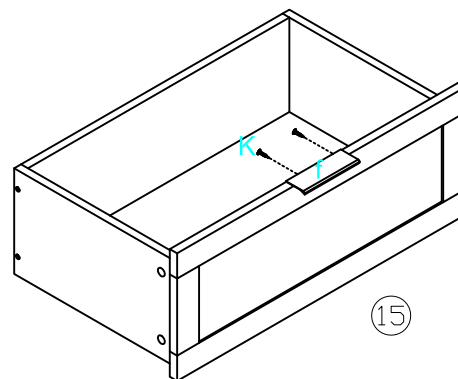
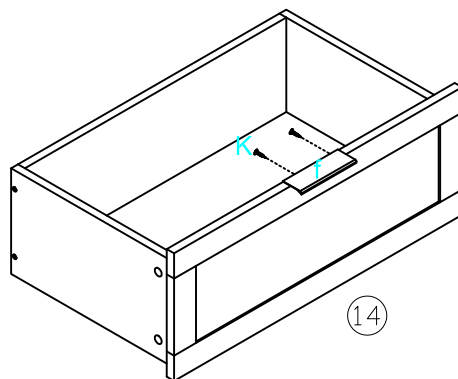
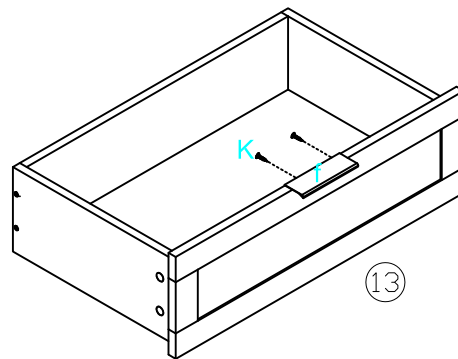
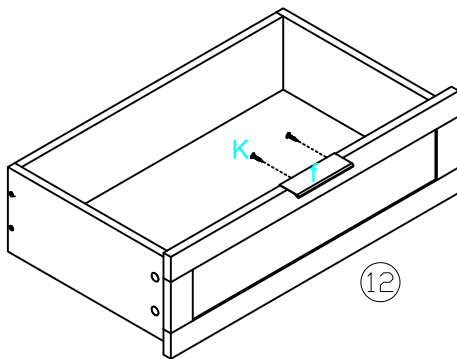
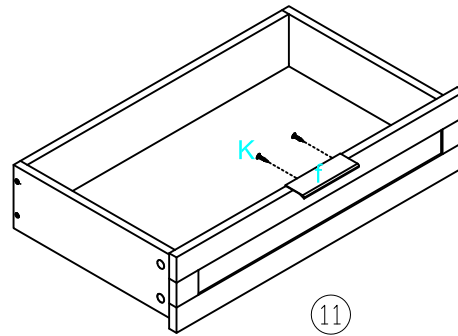
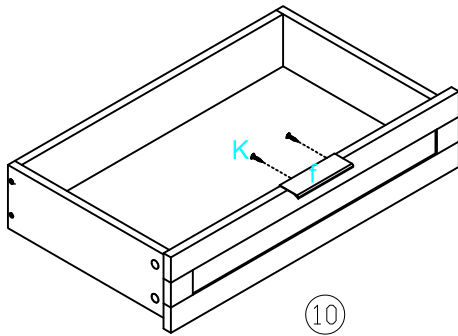

(F) x6	(K) x24	

# 29.

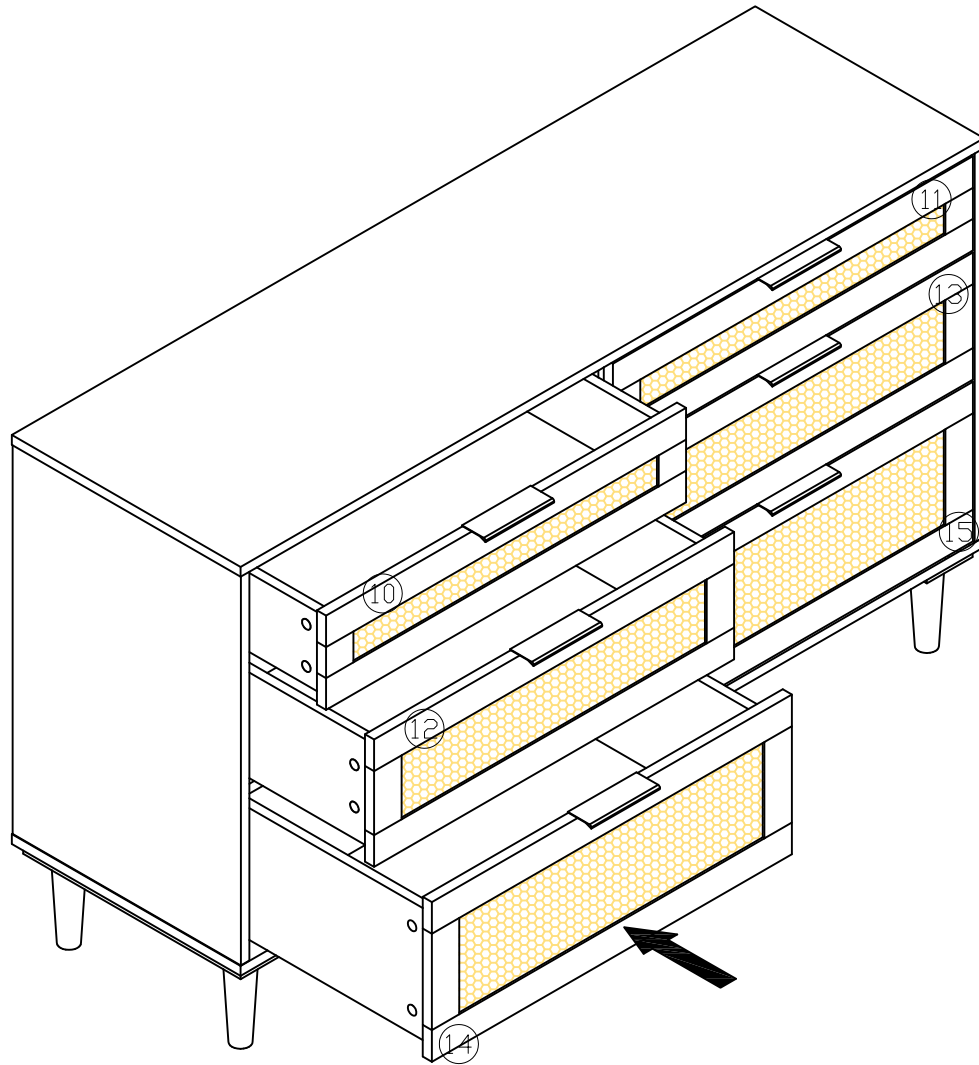

Note: fine-tune drawer up and down, please adjust the track



Maximum weight

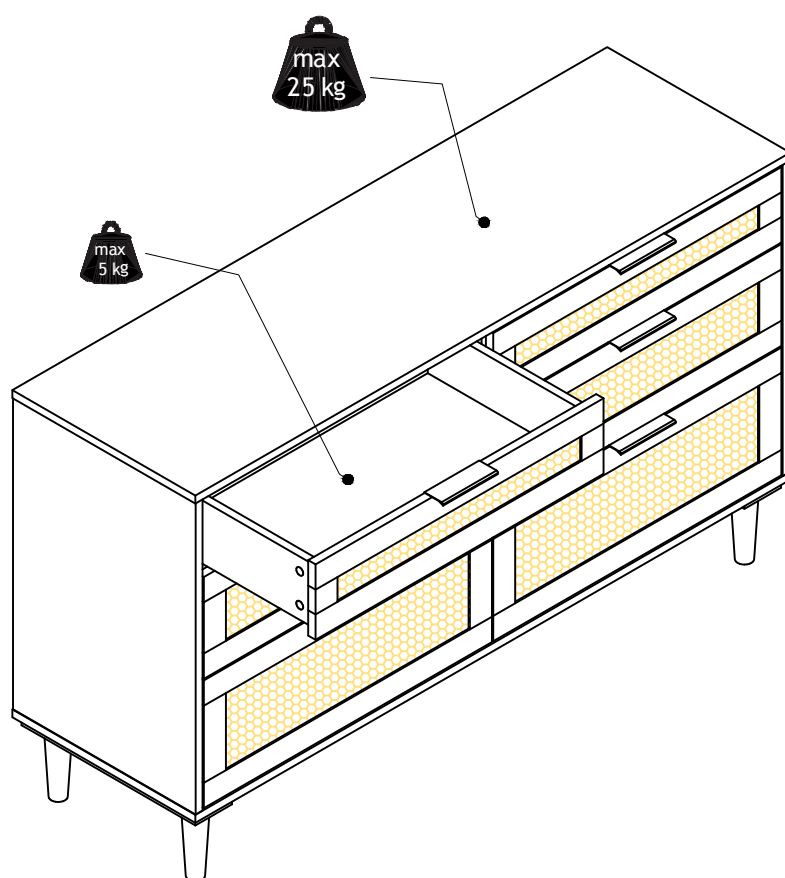

# DECORATE STYLISHLY AND SAFELY!

It is important to feel safe in your home , especially when you have children. Every year there are many accidents caused by falling furniture-accidents that could have been easily avoided. Here are some ways to keep your new furniture from tipping :



A form of anti rollover protection; A strap fixed to the bracket with bolts

## Anchor

the furniture to the wall. Use the anti-tipping device that comes with the furniture (all furniture more than 75 cm high should be supplied with a anti-tipping device). Refer to the assembly instructions, based on the type of wall you have.

## Preventing

a child from climbing on the furniture, or otherwise hanging on it.

## Store

heavy objects as far down as possible, never in the the upper parts of the furniture. Remember that not all furniture is made to support heavy televisions, for example

- There is special media furniture for these.

# WHICH SCREW TO USE?

1. Drywall with wooden studs: Fix the screw directly into the stud.
2. drywall without wooden studs: use plug with screw.
3. Solid concrete wall: Use plugs with screws.
4. Hollow concrete wall: Use folding plug/expander.

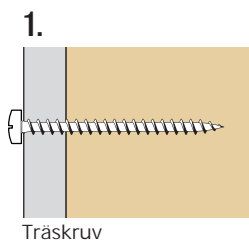

Träskruv

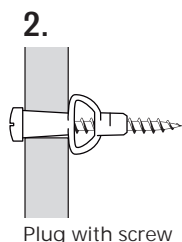

Plug with screw

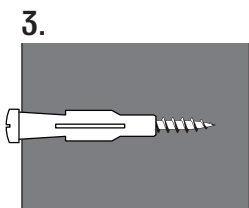

Plug with screw

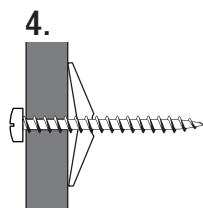

Folding plug/expander with screw

If you are in any doubt about which screws to use, contact a builders' merchant or hardware store.



A form of anti-tipping device; angle iron