

ASSEMBLY INSTRUCTIONS

44" ROUND COUNTER HEIGHT TABLE WITH SHELF

A Table Top

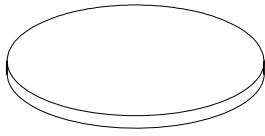

1 PC

B Table Shelf

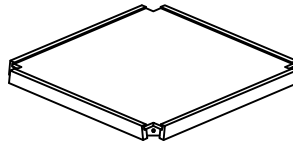

1 PC

C Table Leg



4 PCS

D Bolt
Ø5/16" x 65mm



12 PCS

E Spring Washer
Ø5/16" x Ø13mm x 2mm



12 PCS

F Flat Washer
Ø5/16" x Ø19mm x 2mm

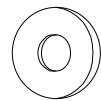

12 PCS

G Allen Wrench
4mm



1 PC

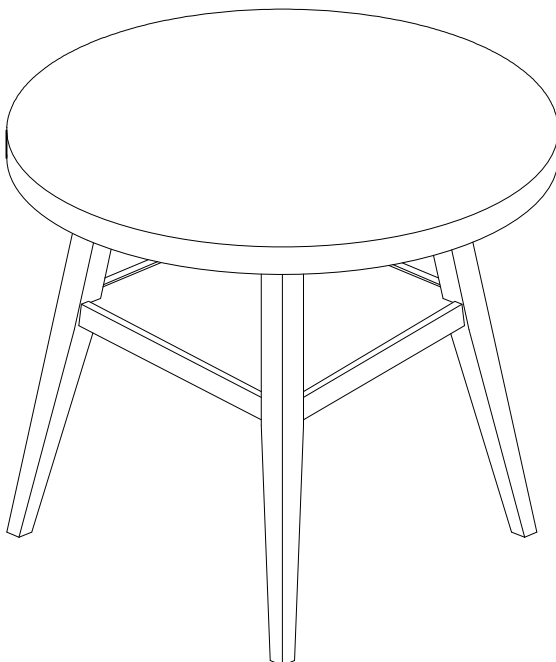

This page lists all the contents included in the box. Please take the time to identify the hardware as well as the individual components to this product. As you unpack and prepare for assembly, place the contents on a carpeted or padded area to protect them from damage.

-
- 1** Attach Table Leg (C) to Table Top (A) using Bolt (D), Spring Washer (E) and Flat Washer (F) with Allen Wrench (G). Do not fully tighten the bolts in this step.

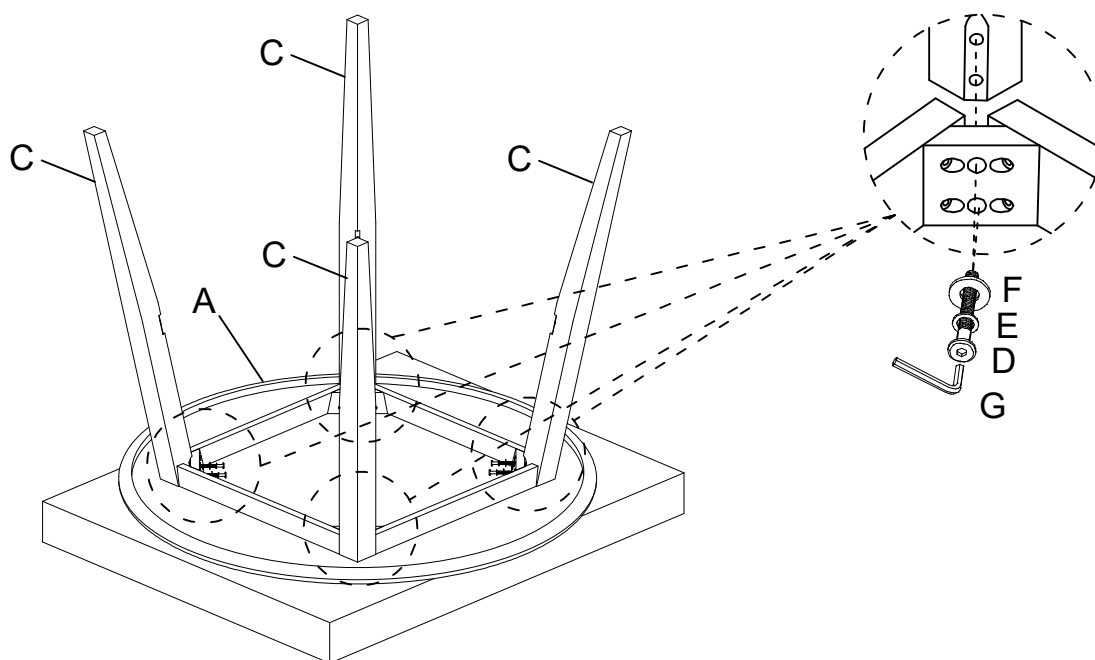

-
- 2** Attach Table Shelf (B) to Table Leg (C) using Bolt (D), Spring Washer (E) and Flat Washer (F) with Allen Wrench (G). Fully tighten all the bolts in this step.

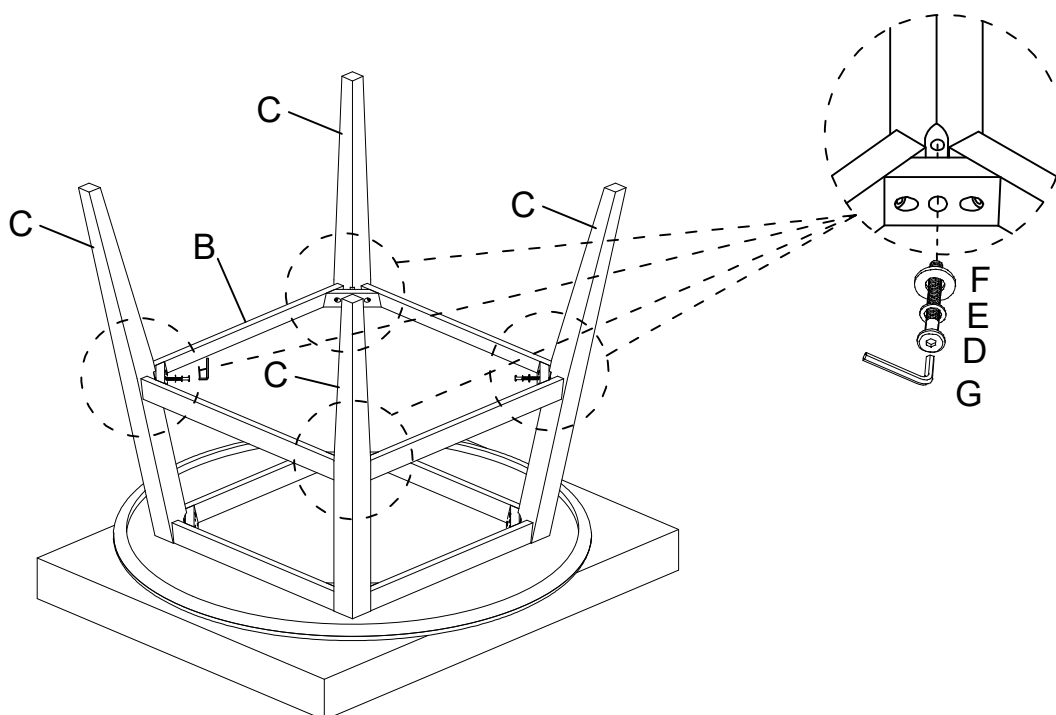

Cleaning & Care

Treat surfaces with care. Surfaces are resistant to scratches but are not scratch resistant. Clean surfaces with a dry or damp soft cloth. Do not use abrasive cleaners. Hardware may loosen over time. Periodically check that all connections are tight.

ASSEMBLY INSTRUCTIONS

COUNTER HEIGHT CHAIR

A Back Leg Frame

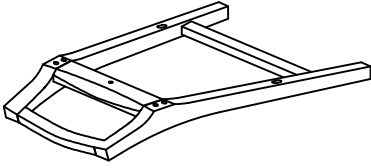

1 PC

B Seat

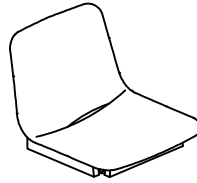

1 PC

C Front Leg - Left



1 PC

D Front Leg - Right

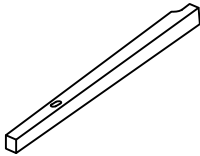

1 PC

E Side Stretcher - Front



1 PC

F Side Stretcher - Left & Right



2 PCS

G Bolt
Ø5/16" x 80mm



H Bolt
Ø5/16" x 65mm



I Bolt
Ø1/4" x 35mm



J 4 PCS
Spring Washer
Ø5/16" x Ø13mm x 2mm



K 4 PCS
Flat Washer
Ø5/16" x Ø19mm x 2mm



L 1 PC
Spring Washer
Ø1/4" x Ø13mm x 2mm



M 8 PCS
Flat Washer
Ø1/4" x Ø19mm x 2mm

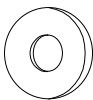

N 8 PCS
Allen Wrench
4mm



O 1 PC
Screw
Ø3.5mm x 38mm



1 PC

1 PC

6 PCS

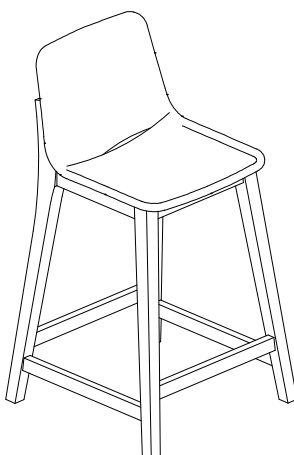

This page lists all the contents included in the box. Please take the time to identify the hardware as well as the individual components to this product. As you unpack and prepare for assembly, place the contents on a carpeted or padded area to protect them from damage.

- 1** Attach Seat (B) to Back Leg Frame (A) using Bolt (G & I), Spring Washer (J & L) and Flat Washer (K & M) with Allen Wrench (N). Do not fully tighten the bolts in this step.

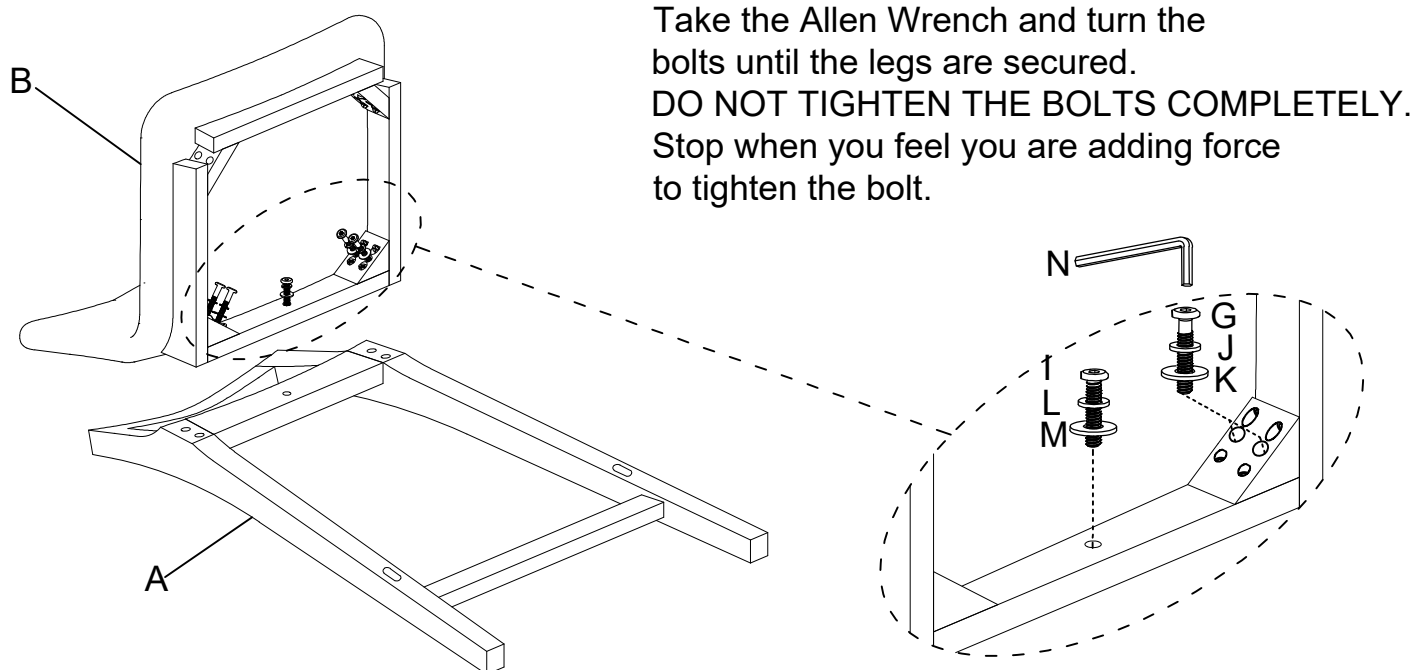

- 2** Attach Front Leg (C & D) to Seat (B) using Bolt (H), Spring Washer (J) and Flat Washer (K) with Allen Wrench (N). Half tighten all the bolts in this step.

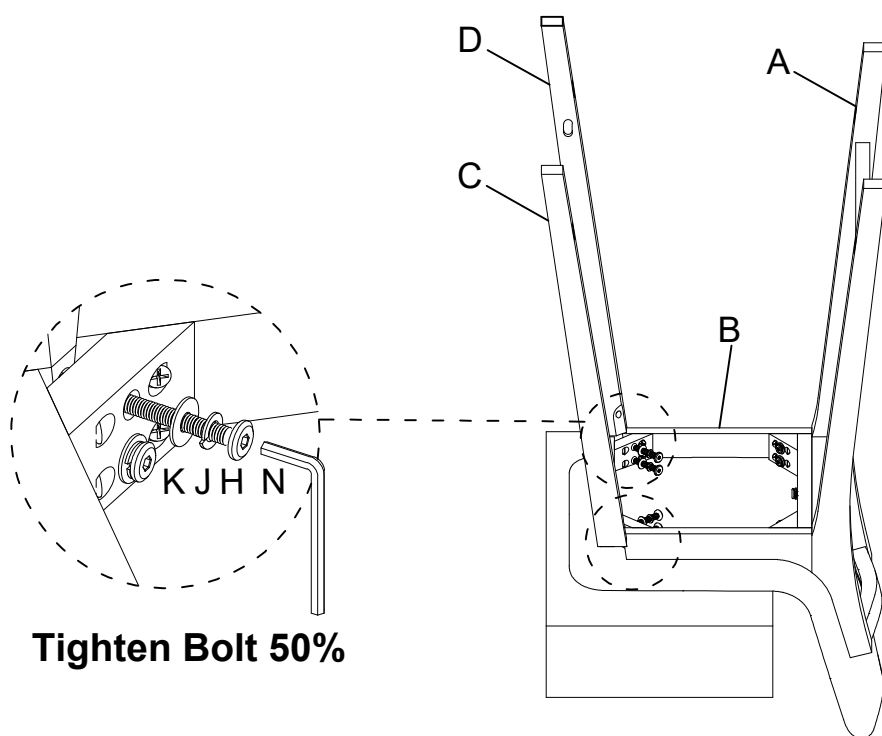

- 3** Attach Side Stretcher (E & F) to Front Leg (C & D) and Back Leg Frame (A) using Screw (O) with Screwdriver (Not Provided). Fully tighten all the bolts and screws in this step.

(Not Provided)

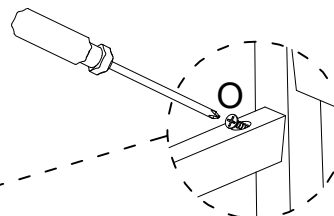

Tighten Screw 100%

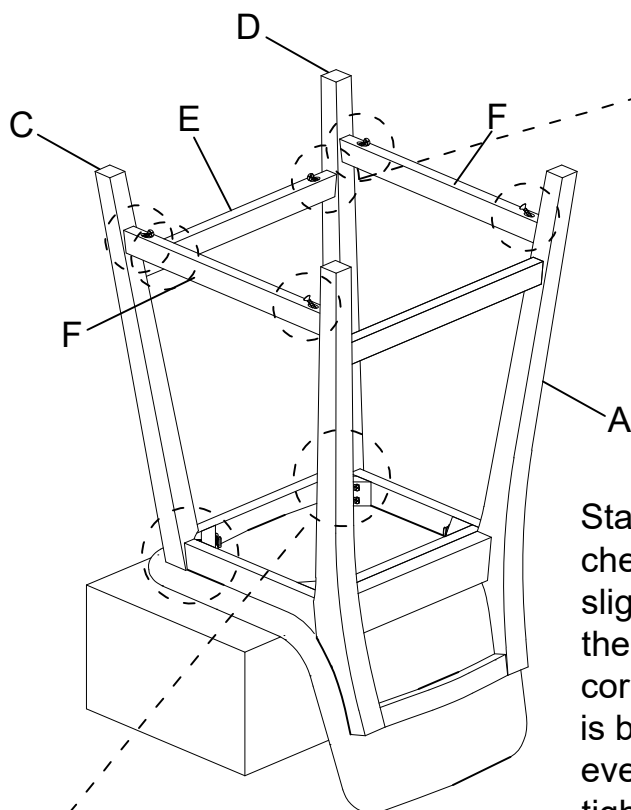

Stand the chair on an even surface and check for balance. If the chair wobbles slightly, apply downward pressure on the uneven leg and tighten the bolts to correct the imbalance. Once the chair is balanced, apply downward pressure evenly in the center of the chair and tighten all bolts, being careful not to over-tighten beyond the hole depth.

Helpful Tip: While tightening the bolts from underneath, have someone sit in the chair.

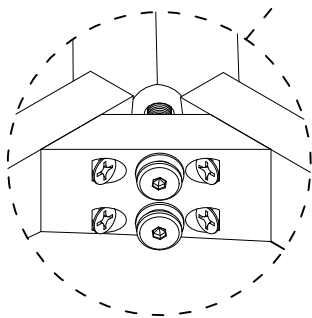

Tighten Bolt 100%

Cleaning & Care

Treat surfaces with care. Surfaces are resistant to scratches but are not scratch resistant. Clean surfaces with a dry or damp soft cloth. Do not use abrasive cleaners. Hardware may loosen over time. Periodically check that all connections are tight.