

## FULL

### ASSEMBLY INSTRUCTIONS

Before assembling your murphy bed, please read through these instructions carefully and familiarize yourself with the different parts.

**ATTENTION!** If you receive a damaged or defective item, please contact afifurnishings at [customerservice@afifurnishings.com](mailto:customerservice@afifurnishings.com) or 1-800-955-3726

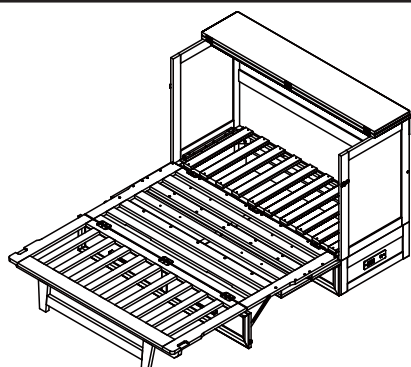
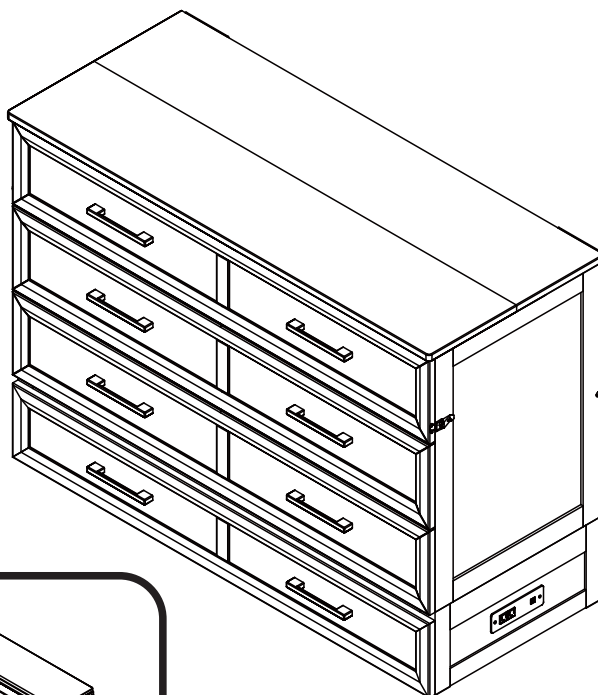

CODE	ITEM
MB-PD-TCN	C-7631X
MB-BL-TCN	C-7632X
MB-TP-TCN	C-7633X

**PO :**

### HARDWARE

NOTE: WE INCLUDE SPARE HARDWARE IN CASE DAMAGE OCCURS DURING ASSEMBLY.

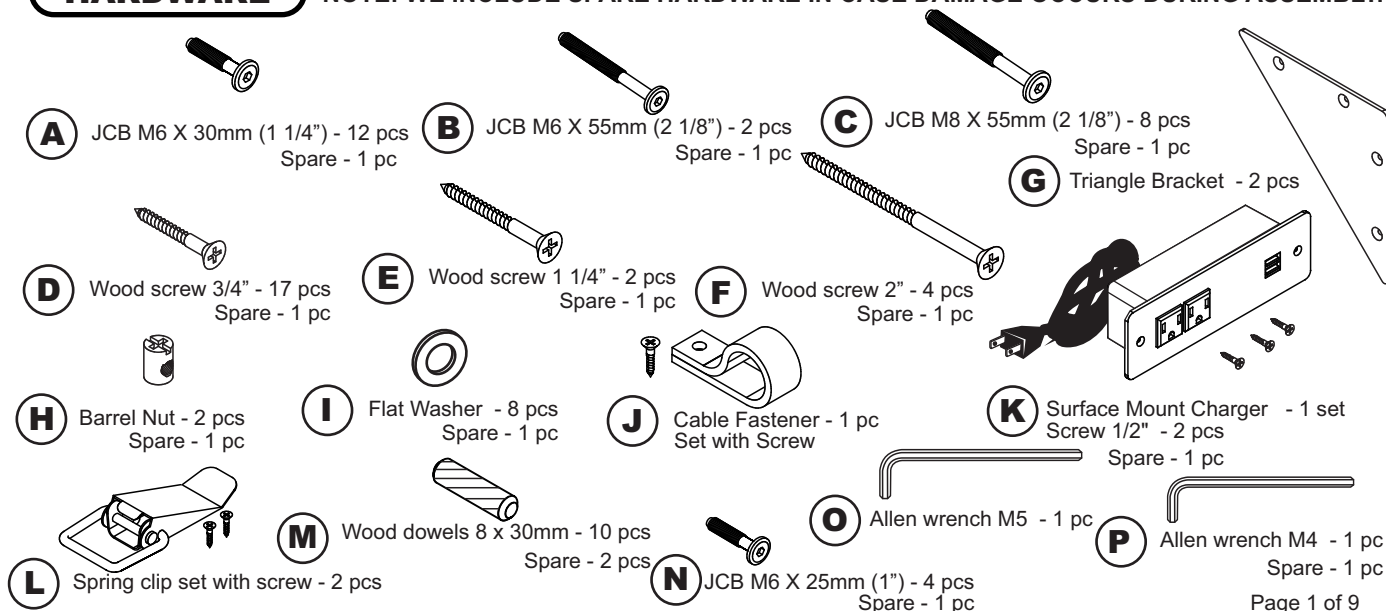

# FULL PARTS LIST

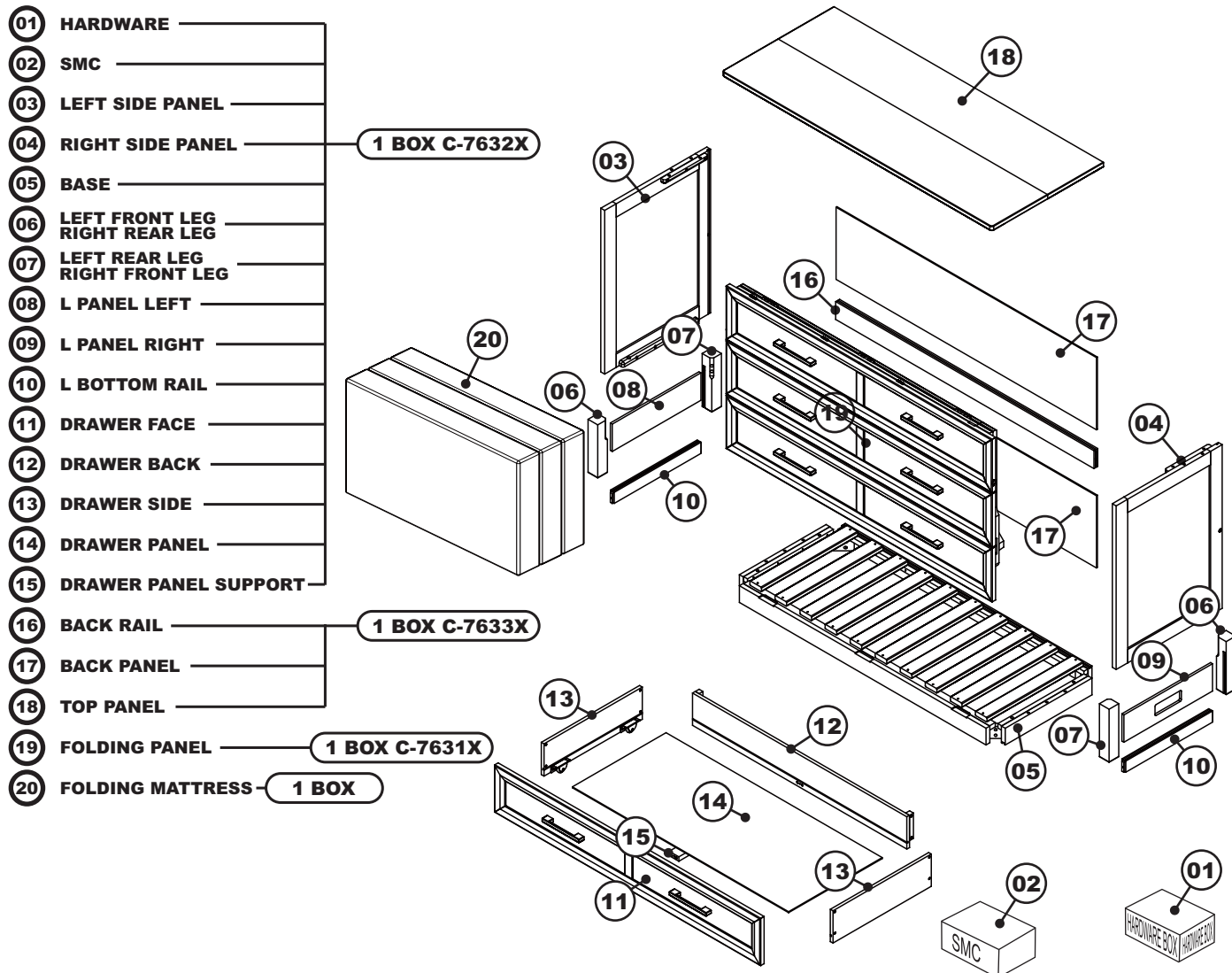

## STEP 1

Insert wood dowels (M) to the side panels(03)(04) as shown below. Install spring clip (L) set with screw to side panels (03)(04). Tighten with phillips head screwdriver. Customer supplied. Attach left side panel (03) and right side panel (04) to the base (05) as shown below. Use JCB (A). Tighten with Allen wrench M4 (P).

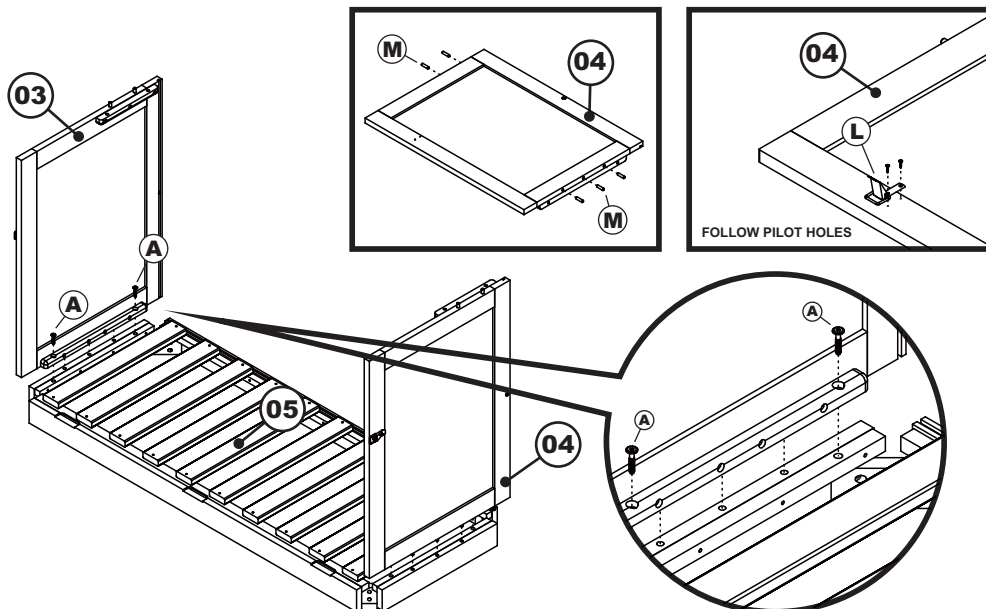

## FULL

### STEP 2

Guide the back panel (17) and back rail (16) in carefully so that it won't jump out of its grooves. Be sure it fits fully into its groove at the back rail before fitting the top panel. Use JCB (B) and barrel nut (H). Tighten with allen wrench M4 (P).

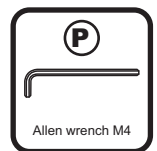
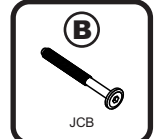
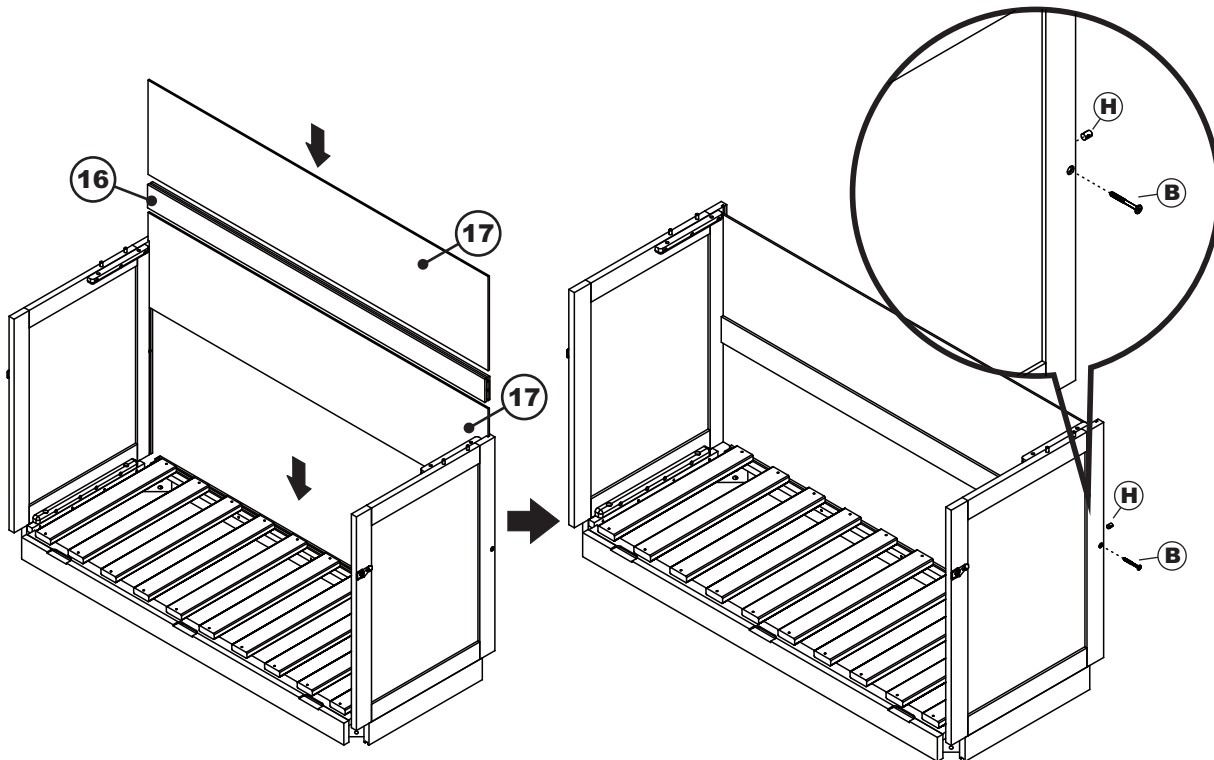

### STEP 3

Attach top panel (18) to cabinet assembly as shown below. Use JCB (N). Tighten with Allen wrench M4 (P)

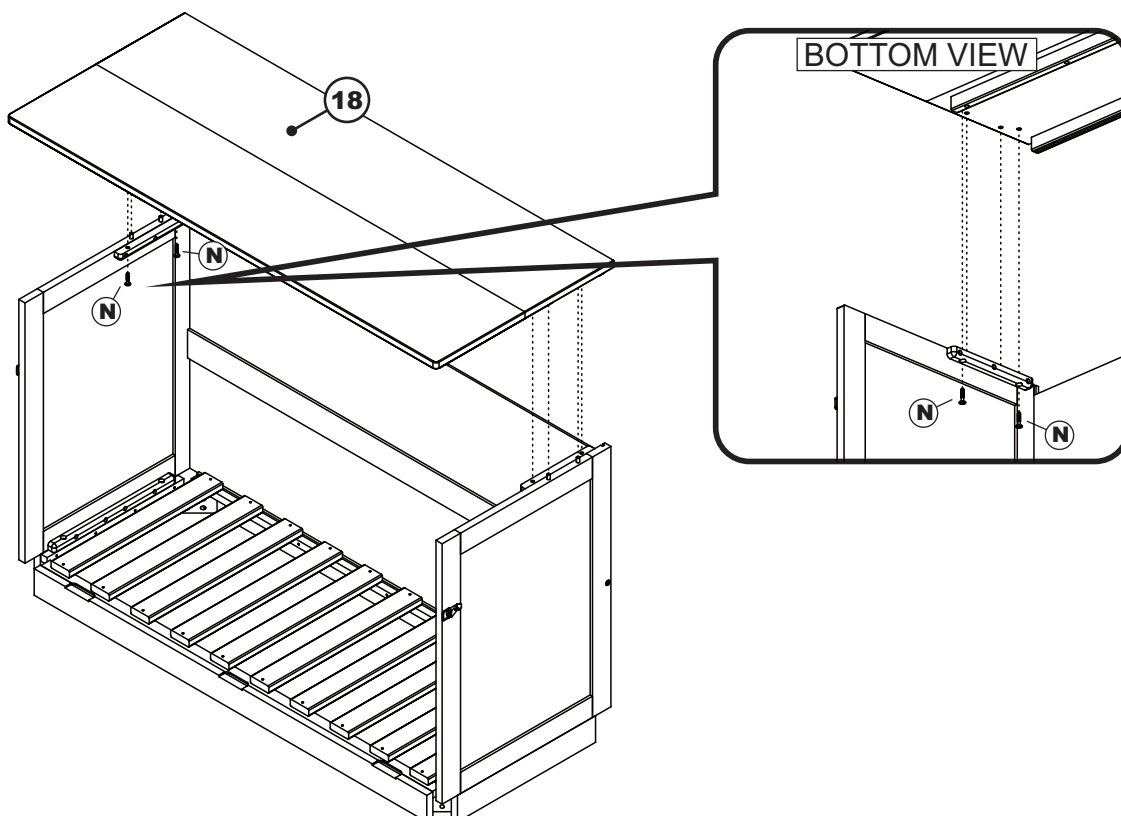

## FULL

### STEP 4

Attach legs (06)(07) to cabinet assembly as shown below. Use flat washer (I) and JCB M8 (C). Tighten with Allen wrench M5 (O)

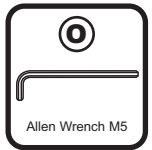
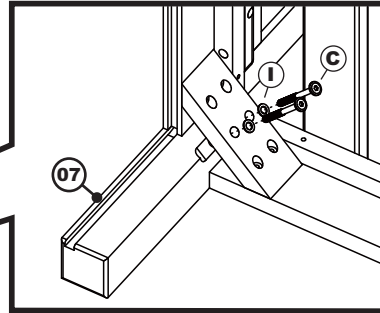
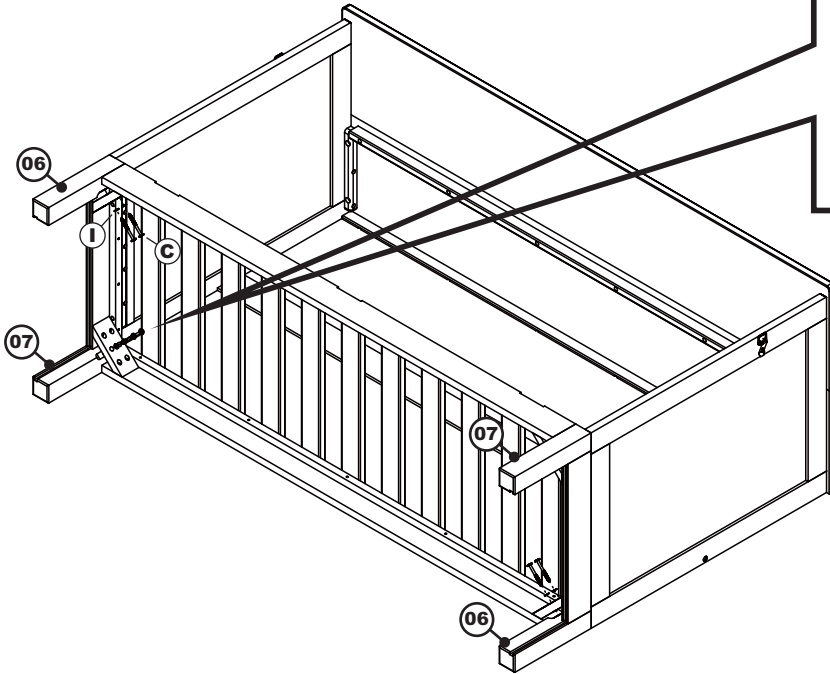

### STEP 5

Guide the L panel (08)(09) and L bottom rail (10) in carefully so that it won't jump out of its grooves. Be sure it fits fully into its groove at the base rail before fitting the L bottom rails (10). Use wood screw (F). Tighten with Phillips head screwdriver. (Customer supplied)

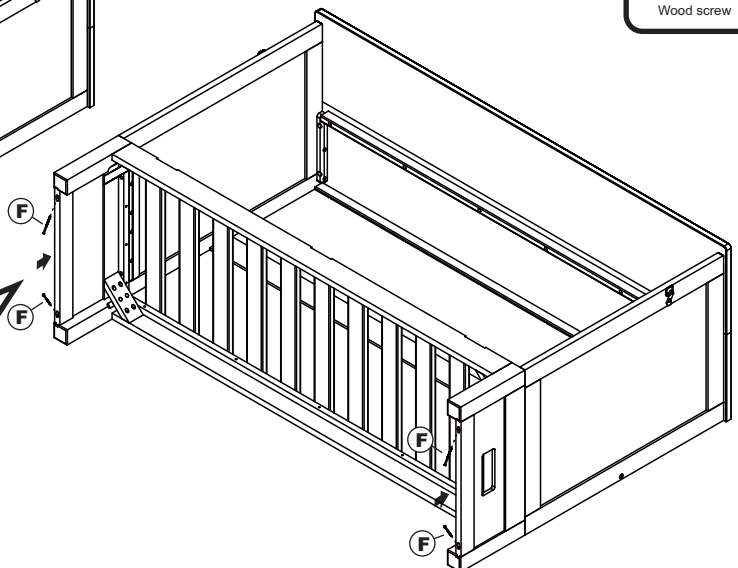
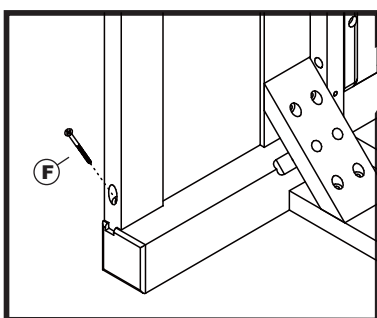
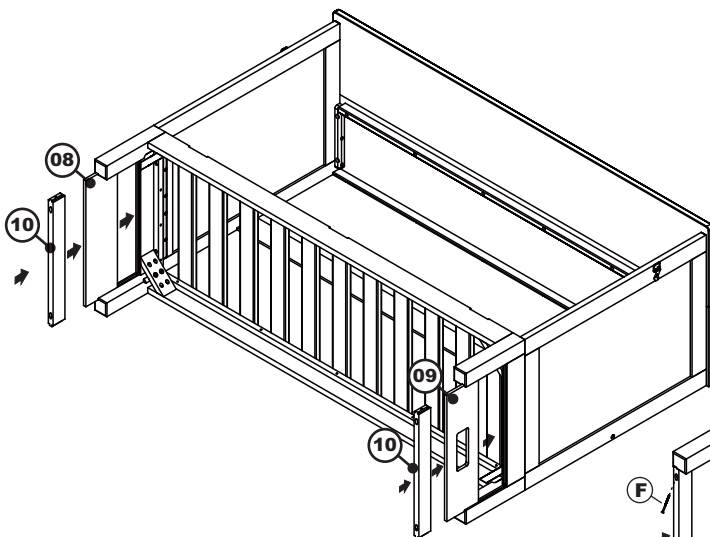

## FULL

### STEP 6

Open top drawer folding leg as shown below. Using metal support and lock to the post.(both side)

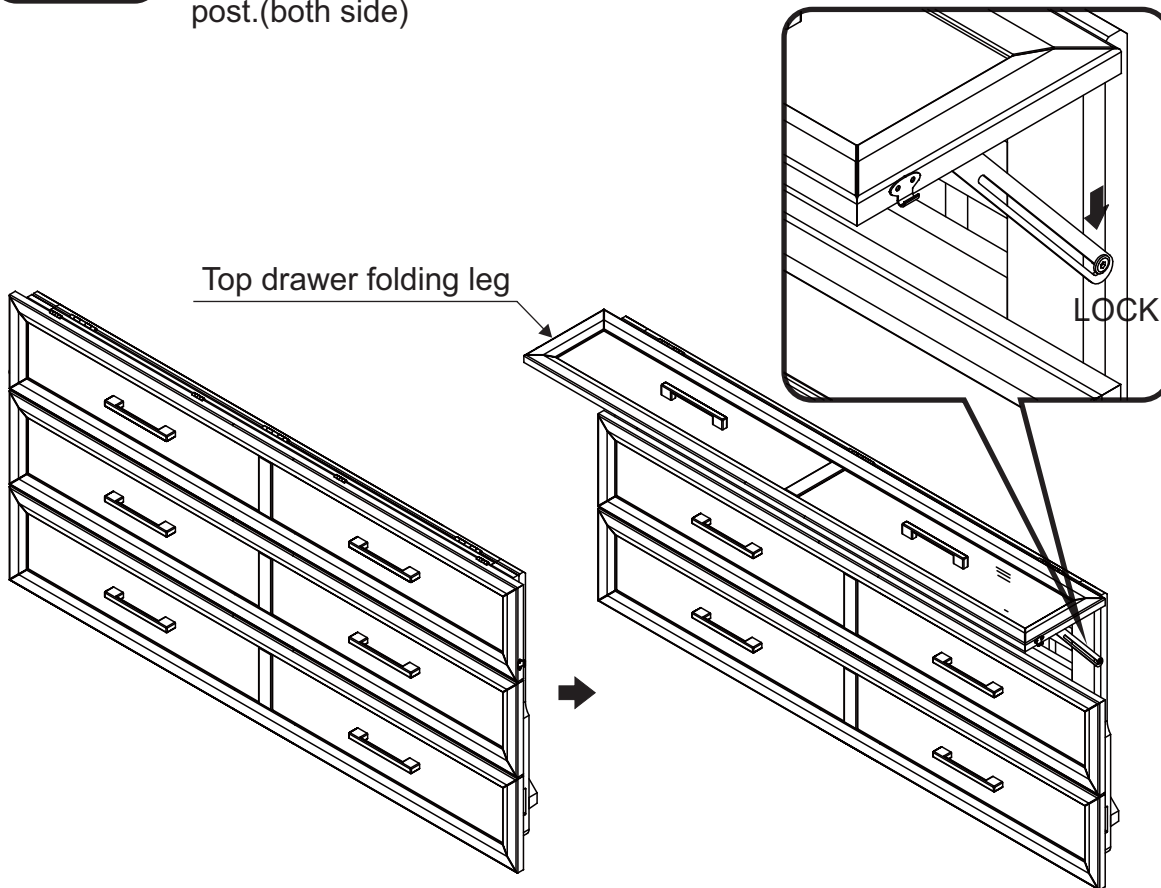

### STEP 7

Attach folding panel assembly (19) to cabinet assembly as shown below. Use wood screw (D). Tighten with Phillips head screwdriver. Customer supplied. Be sure to align with cabinet.

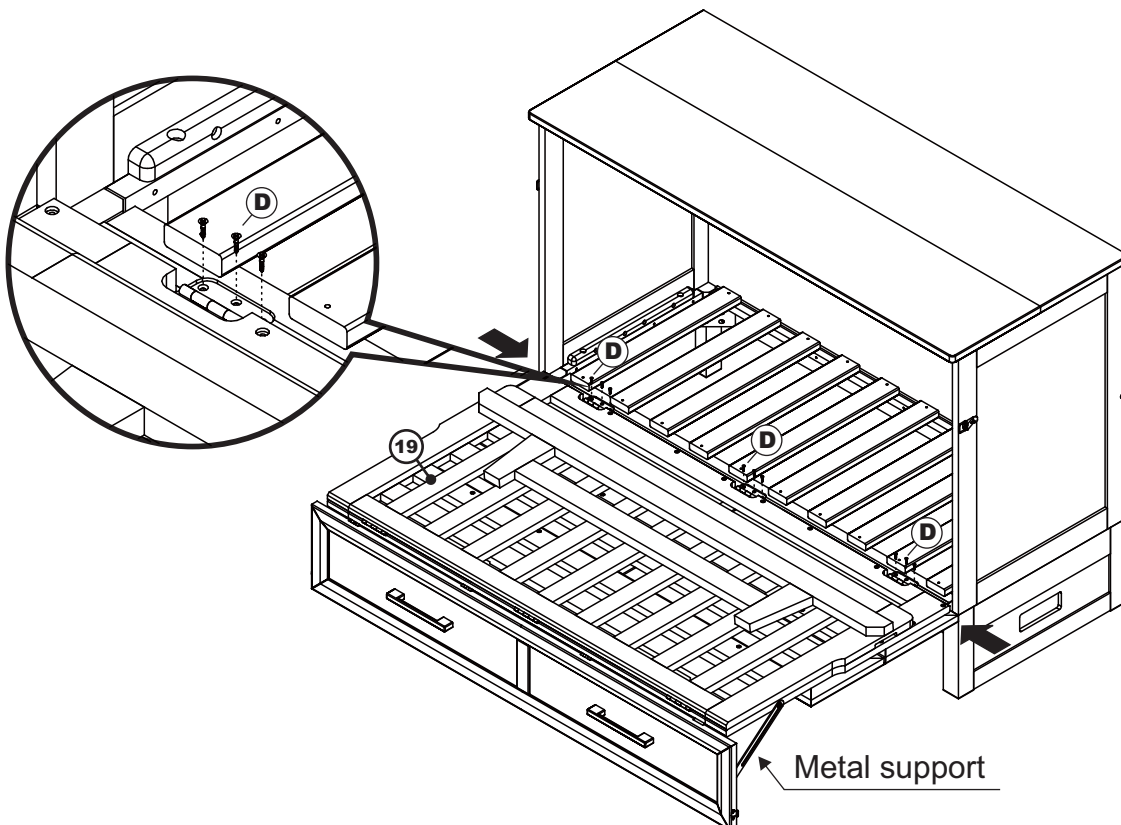

## FULL

### STEP 8

Unlock metal support. Lift the door and latch to side panel. Push the door closed and latch both sides as shown below.

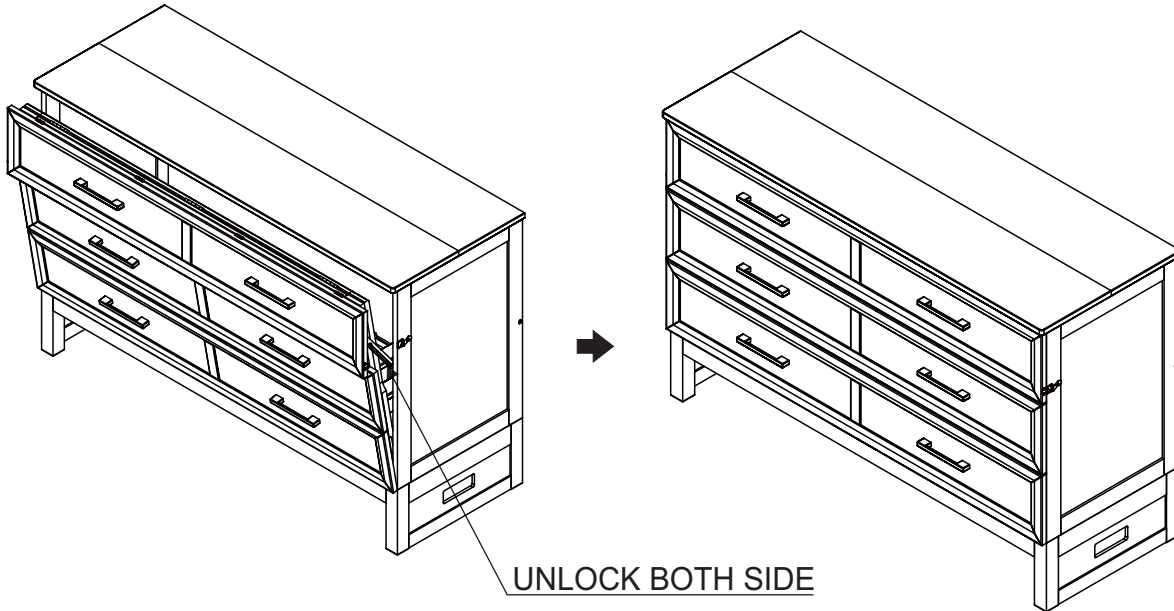
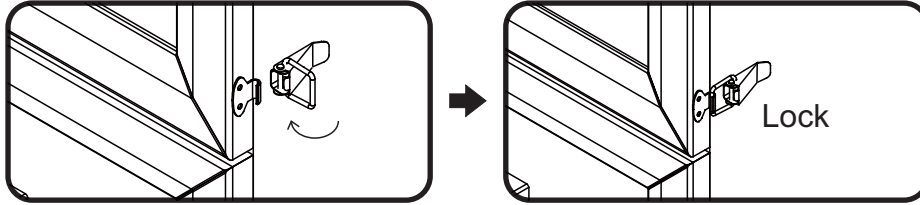

### STEP 9

Attach triangle bracket (G) to the back of cabinet as shown below. Use wood screw (D) tighten with Phillips head screwdriver. (customer supplied).

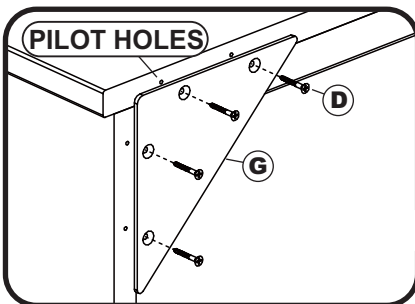

### STEP 10

Install USB charger (K) to the location as shown. Using 1/2" screws and cable fastener (J). Tighten with Phillips head screwdriver. (Customer supplied )

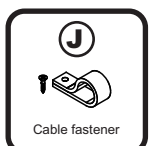
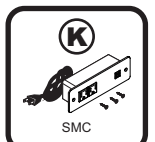
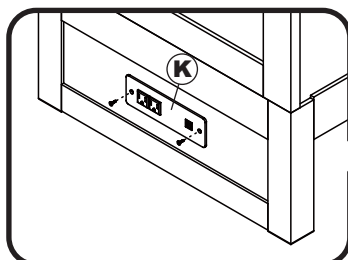

## FULL

### STEP 11

Lay the drawer face (11) on smooth, flat surface so the groove is facing upwards. Fit the drawer side (13) to drawer face (11), Use JCB (A), align groove inside panel with groove in drawer face. Tighten with Allen wrench M4 (P).

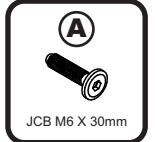
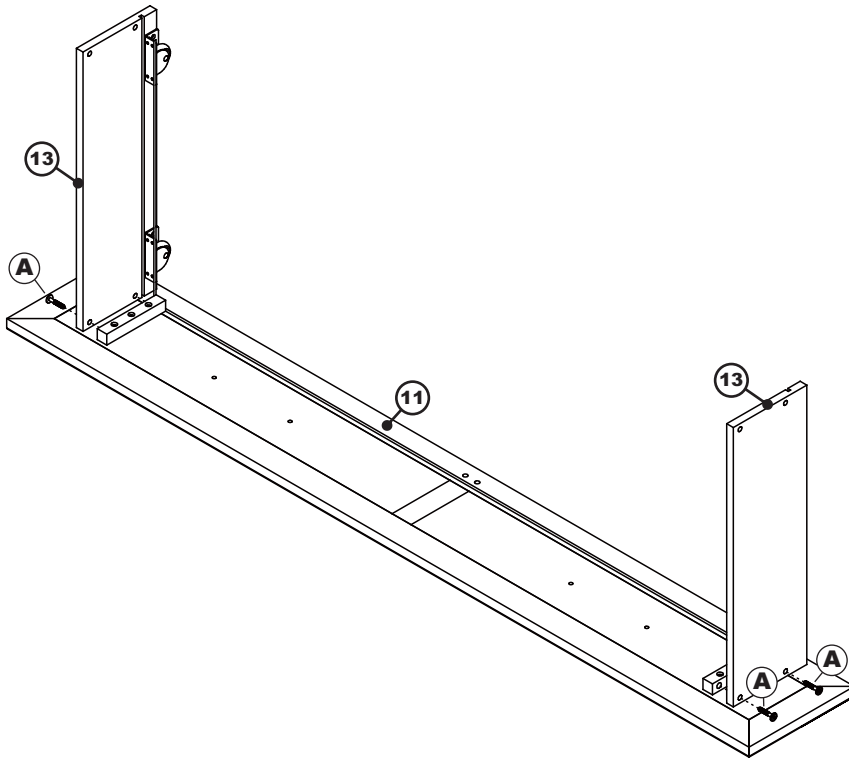

### STEP 12

Guide the drawer panel (14) in carefully so that it won't jump out of its grooves. Be sure it fits fully into its groove at the bottom (in the drawer face) before fitting the drawer back. Attach drawer panel support (15) to the locator holes as shown below.

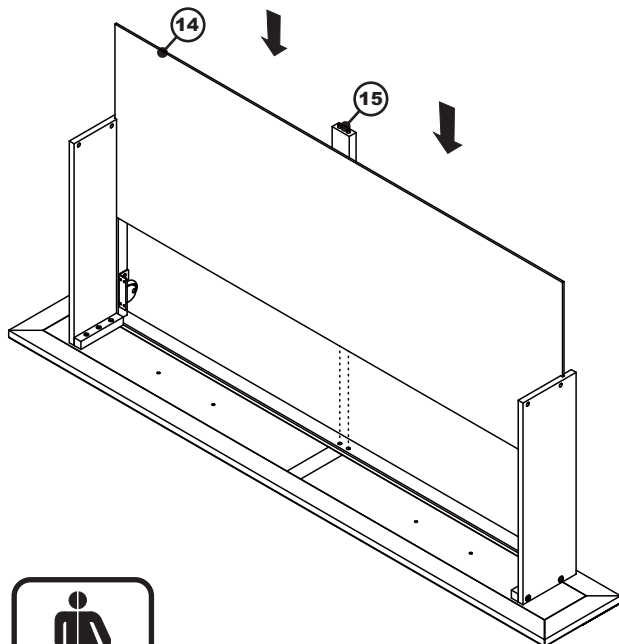

### STEP 13

Attach drawer back (12) to drawer assembly as shown. Use JCB M6 (A) and wood screw (E) Tighten with Allen wrench M4 (P) and Phillips head screwdriver. Customer supplied.

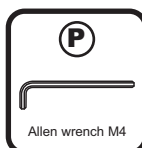
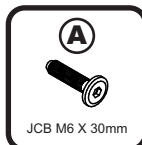
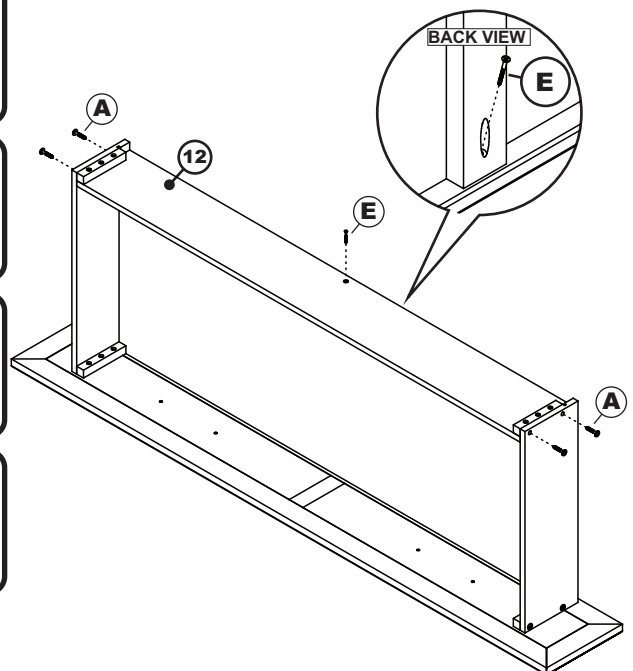

## FULL

**STEP 14** Move the murphy bed assemblies where you want to place them in the room. Insert drawer assembly to the murphy bed assembly as shown below.

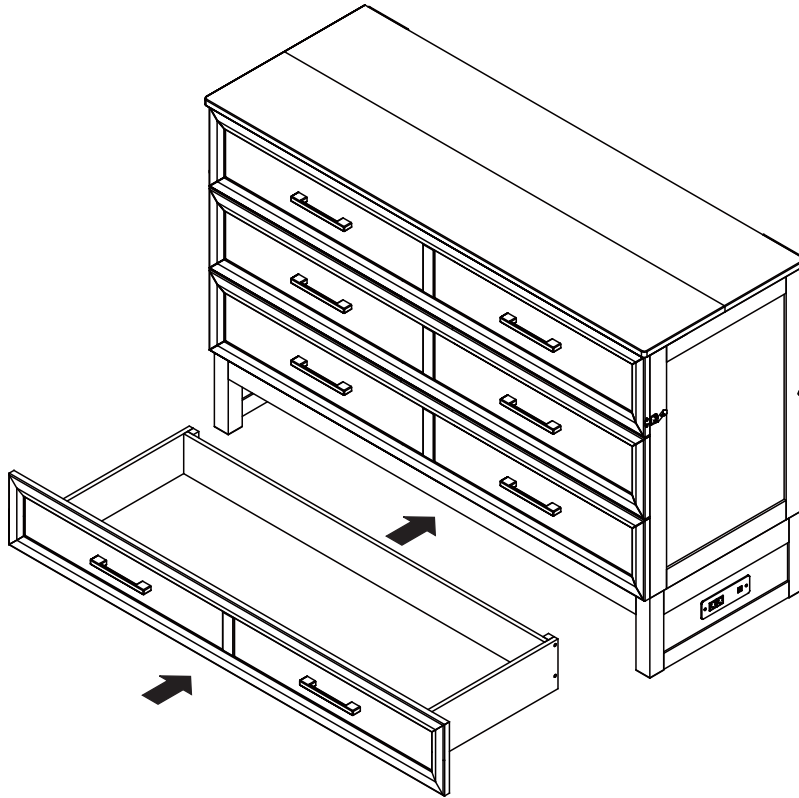

**STEP 15** Unlatch the door and open, folding down and lock metal support to the post as shown.

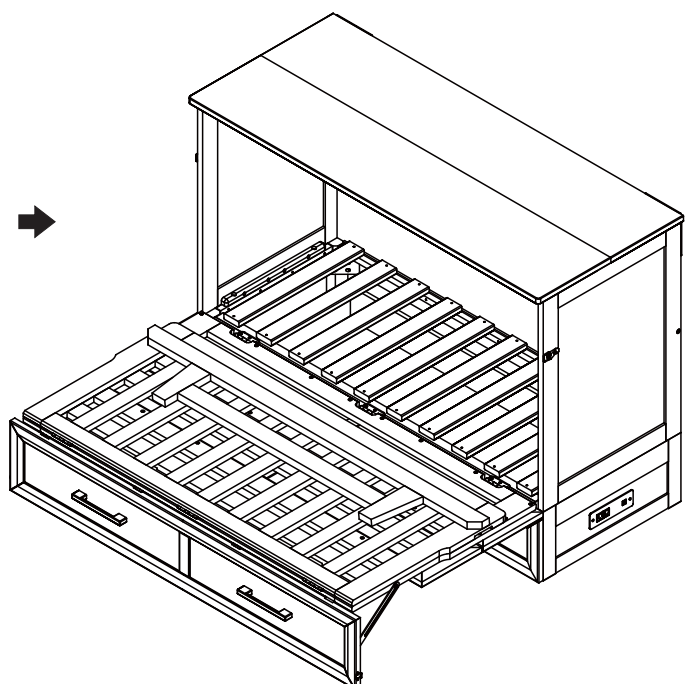
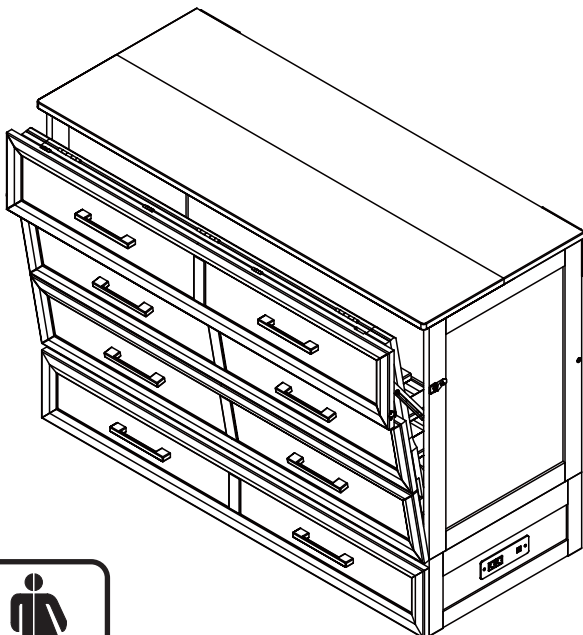
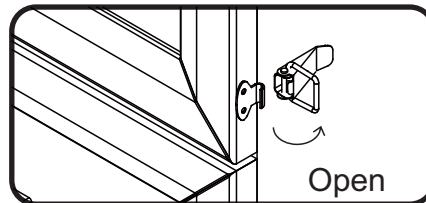
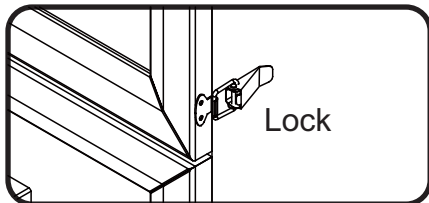

## FULL

**STEP 16** Open and pull footboard frame and open footboard leg as shown below.

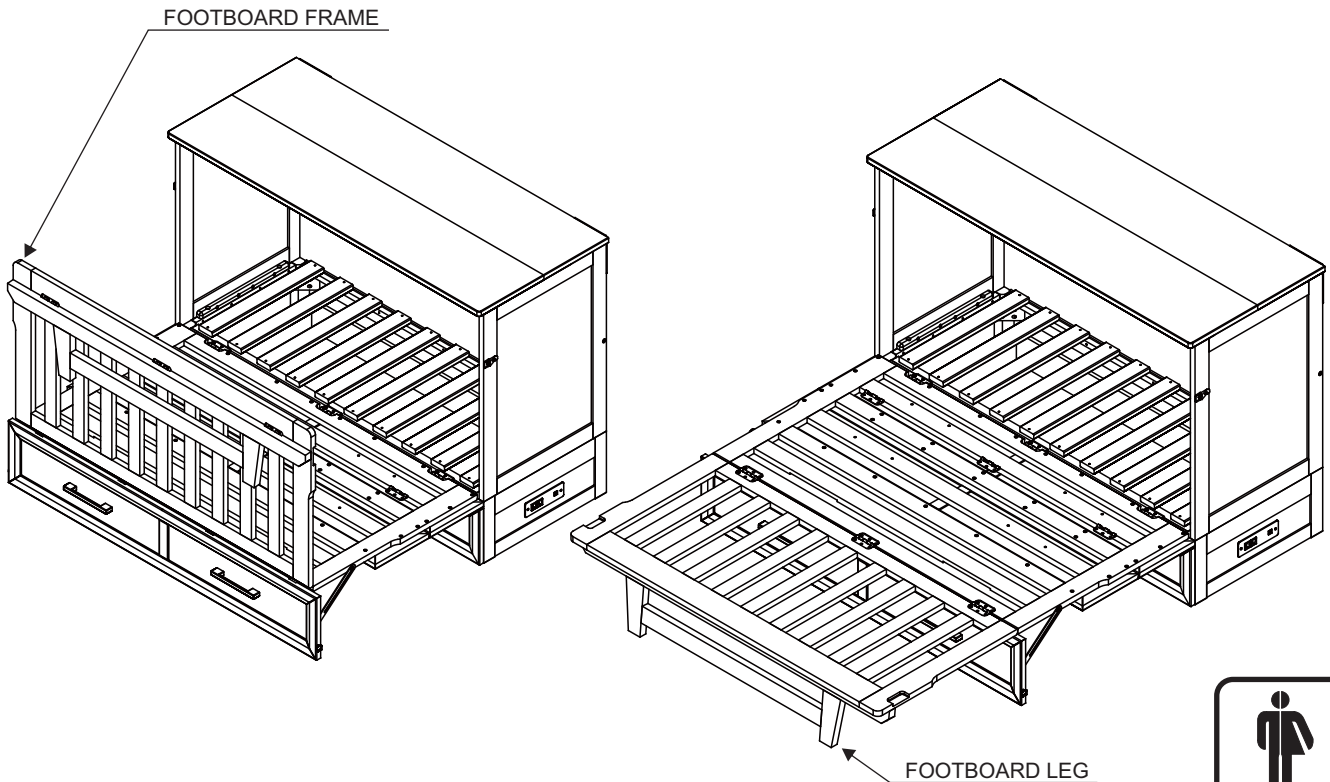

**STEP 17** Install folding mattress (20) to the bed. Open top panel as shown below.

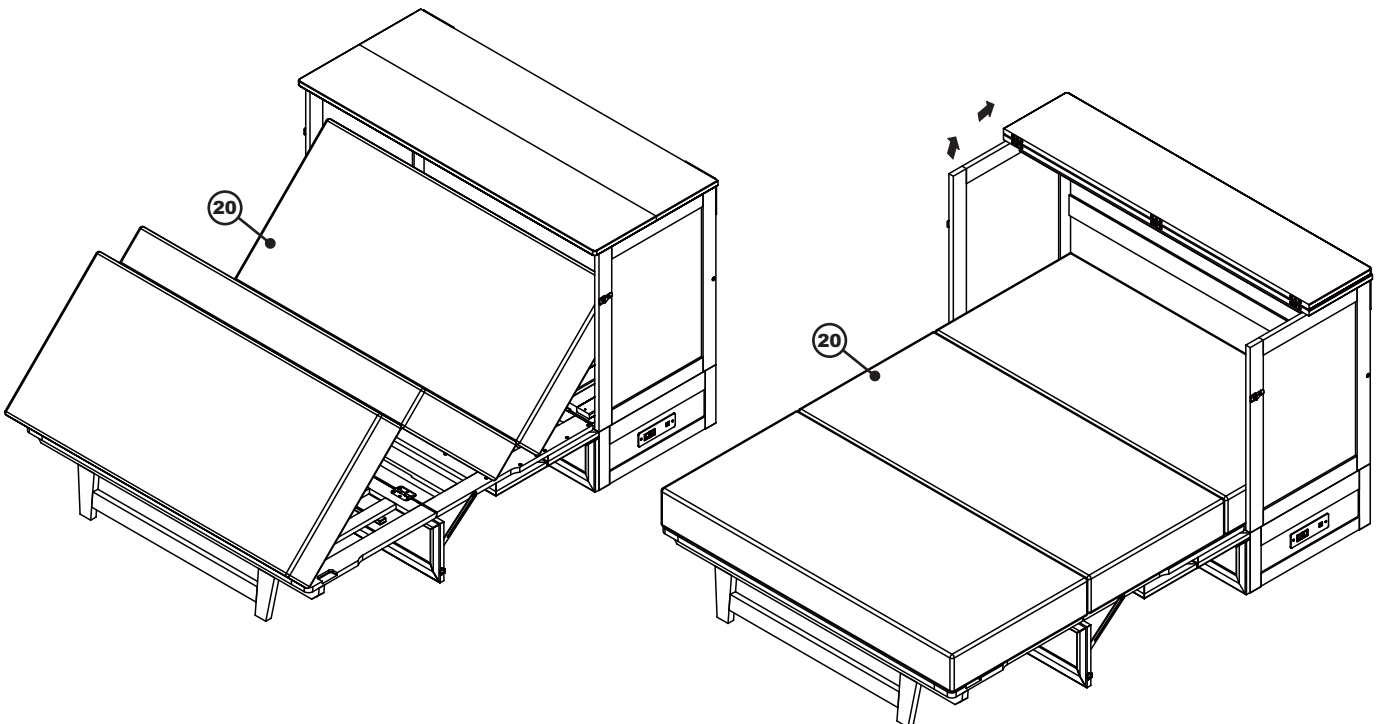

## Congratulations!

Your Murphy bed is now ready for use.

We recommend that you recheck that all screws are tight, and that all parts are secure before use to ensure lasting Safety.