

CONCENTRATE ON PROFESSIONAL SAUNA
SPECIFICATIONS

Product Name	Far Infrared Sauna
Model	LT-907SH
Dimensions	47.24*47.24*75.59 in
Voltage	110-120VCA
Plug Type	15Amps
Wattage	1520W
Number of Heaters	7 pcs
Raw Material	Hemlock
Location	Outdoor/Indoor

LT-907SH Infrared Sauna

Installation & Owner's Manual

Please read this entire manual carefully before start to install and use sauna.



PRECAUTIONS AND INSTRUCTION

ATTENTION

Please read all instructions thoroughly before using.

Serious injury may **caused** if ignore the following warning and instruction.

Basic precautions should **be always followed** when using this electrical equipment.

DANGER

To avoid the risk of causing burns, fire, electric shock, or other injuries:

- Connect the power cord to a properly grounded outlet.
- Using only for its intended use as described in this manual.
- Don't use accessories not recommended by the manufacturer.
- Please **disconnect the power** after using.
- Please keep the electrical cord away from heated surfaces.
- If the sauna is faulty, the supply cord or plug is damaged, please stop using it immediately.

CONNECT TO BLUETOOTH SPEAKERS

- When the sauna power cord is plugged in, the speakers make beeps sound **in 2-3 seconds** telling you the sauna are ready for pairing.
- Activate the blue tooth function of your smart phone/tablet.
- Search and find the sauna Bluetooth speaker "SAUNA BT".
- **Click "SAUNA BT" to link.**
- Before connecting to the Bluetooth speakers, make sure **no other phone** is connected to the speakers.

WARNINGS

- Not recommend **doing sauna over one hour.**
- Don't place the sauna in a **humid** environment.
- Don't touch heating panel directly.
- Don't bring any sharp tool inside sauna, heating panel may **damaged** or caused severe consequence.
- Placing the sauna on a flat surface for lining up installation.
- Don't **disassemble the main box**, wires or other electronic parts without factory authorized. You may get injury or damage the sauna.
- Customer with medical condition should **consult doctor first** before using sauna (Including acute diseases, malignant tumors, high blood pressure, heart disease, allergic dermatitis, pregnancy, etc.)
- This sauna should not be used for person (including children) with **reduced physical, sensory or mental capabilities, or lack of adequate experience knowledge**, unless they have been given supervision or instruction concerning use of

Function and Application:

1. Enter Settings to connect APP Bluetooth (SAUAN BT-APP).

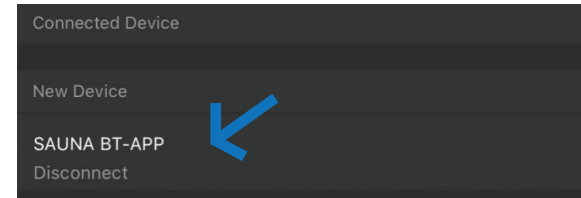

2. Turn on/ off the control panel.

3. Take the sauna working.

- 4. Press color light to activate the chromotherapy light system. After manually switching the all color of the color lamp this system will enter an automatic cyclic mode.

- 5. Turn on/off the reading lamps.

- 6. Turn on/off the Wall lamps.

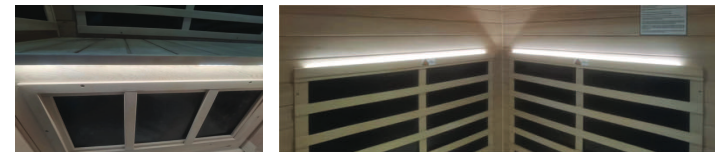

- 7. Take the FM on, according to the TEMP +/- to search the channel and TIME +/- adjust the volume.

- 8. Connect the Bluetooth audio (SAUNA BT) to play the music. According to the TEMP +/- to change the songs and TIME +/- adjust the volume. Insert USB to play music. According to the TEMP +/- to change the song and TIME +/- adjust the volume.

- Notify: if you need to switch song list in bluetooth, or switch FM channel, or switch to USB function, everytime you have to press the related button first (like BT, FM, USB Button on control panel), then press Temp +/- to switch related function.

APP USAGE INSTRUCTIONS



the appliance by a person responsible for their safety.

- Using a sauna after taking alcohol, drugs, or medication can lead to hyperthermia and increase the risk of death.
- If you are feeling uncomfortable, exit the sauna immediately and consult a doctor. Children should be supervised to ensure that they do not play with the appliance.

HYPERTHERMIA

Prolonged exposure in the sauna may cause hyperthermia. Hyperthermia occurs when body's core temperature rises above 98.6F. Symptoms of hyperthermia include a rise in body temperature, dizziness, lethargy, drowsiness, and fainting. The effects of hyperthermia may include:

- a) Failure to perceive heat / Unawareness of impending heat
- b) Failure to recognize the need to exit the sauna
- c) Fetal damage in pregnant women
- d) Physical inability to exit the sauna
- e) Unconsciousness

INSTALLATION GUIDE

Each panel is heavy, especially the top panel. Be careful to avoid injury when installing. This sauna requires at least 2 adults to complete assembly. The panels should be install in the following order:

- First**-----Floor Panel
- Second**-----Right rear Panel
- Third**-----Left rear Panel
- Four**-----Left Panel
- Five**-----Right Panel
- Six**-----Bench Support Panel
- Seven**-----Bench Surface Panel
- Eight**-----Front Panel
- Nine**-----Ceiling Panel

Step 1: Position the Floor Panel

Place the floor panel on a flat surface. Before assembly, make sure the floor is flat so that you can maintain a comfortable subsequent installation. (image1)



image 1

Step 2: Position the Rear Panel

Lift the rear panel into position wedging the bottom of the panel into the channel in the floor panel, you can gently rest the rear panel against the wall of your home. Please note the two holes are closer to the rear panel. (image 2)



image 2

Step 3: Position another Rear Panel

Then place the small panel into the slot of the floor panel and push it towards the bigger rear panel. Check whether the hooks of the fasteners are up or down, and the fasteners are connected together as shown. (image 3)



image 3

1. Turn on/off the control panel.
2. Short press this button to turn the sauna on and off. Long press this button to switch °C&°F.
3. When the sauna working, + / - adjust the temp (up to 65°C/149°F). When the FM/AUX on, + / - adjust the channel. When the BT/USB on, + / - change the song.
4. When the sauna working, + / - adjust the time (up to 90 mins). When the FM/AUX or BT/USB on, + / - adjust the volume.
5. Short press to enter the FM mode for 5 seconds. Long press to enter the AUX mode for 5 seconds.
6. Short press to enter the Bluetooth mode for 5 seconds. Long press to enter the USB mode for 5 seconds.
- Press color light to activate the chromotherapy light system. After manually switching the all color of the color lamp this system will enter an automatic cyclic mode.
7. Press color light to activate the chromotherapy light system. After manually switching the all color of the color lamp this system will enter an automatic cyclic mode.
8. Turn on/off the reading lamps.
9. Turn on/off the outdoor lamps. (This is indoor product so that have no this function)
10. AUX connection port.
11. USB/MP3 connection port.

Mobile APP connection:

Scan the following QR codes to download the different system APP.



Apple APP QR Code



Android APP QR Code



AI APP

Shenzhen EASYWAY
Technology Co., Ltd.



Step 12: Place the Bench Surface Panel

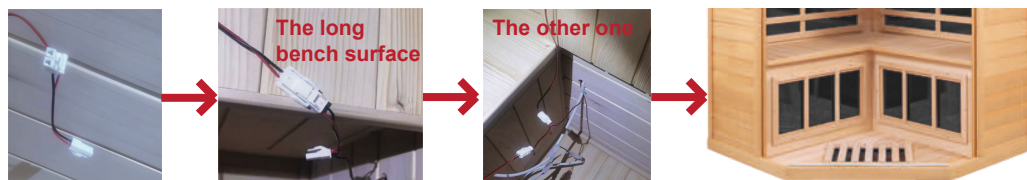

image 13

Step 13: Installing Door Handle

Place the bench surface panel, and connect the connecting wire of the light strip on the bench surface panel with the wire behind the bench support panel (image9).

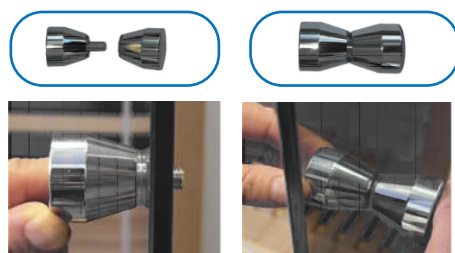

image 14

Finally, install the roof panel, and plug in the power on to operate the Sauna.

Congratulations! Installation completed! Plug in and power on to enjoy your sauna!



image 4

Step 4: Position the Right Side Panel

Place the Left & Right Panels into the slot of the floor panel and push it towards the two rear panel. Please check if there is almost no visible gap, then it is already fixed. (image 5)

Step 5: Place the Bench Support Panel

There are two bench support panels. Please place the longer bench support panel into the tenon of the big rear and left panels firstly, then place the another into the tenon of the longer support panel and right panel. (image 5)



image 5

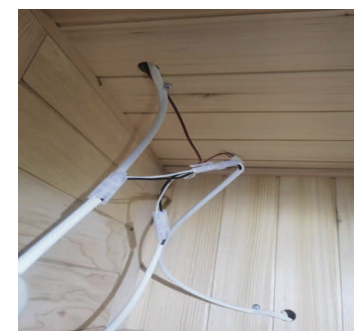

image 6

Step 6: Connect the wires

Every two wires have corresponding unique interface shape, hear a click to indicate that the connection is ready.(image 6)

Step 7: Place the Front Panel

Place the front panel into the slot of the floor panel and push it towards the side panels. Then go inside the sauna and check if the gap is almost invisible. (image 7)



image 7

Step 8: Place the Glass Doors

Please install the glass door carefully, two people are needed for installation. Installation note that the two doors need to be vertically horizontal between them, and then proceed to fix the screws on both sides. (image 8, image 9)



image 8



image 9

Special Note:

If the floor is not level, or there is some inclination, the two glass doors will not be perfectly horizontal and vertical. You can install the sauna on a perfectly level, unangled floor.

Step 9: Waterproof strip

Install the matching waterproof strip on the glass door, please be sure to install it in place. (image 10)



image 10

Step 10: Install Ceiling Panel and Connect the wires

Place the ceiling on top of the sauna. Make sure that all panels are in the slots in the ceiling panel. Make sure that all wires on the side panel pass through the holes. Finally, connect all the wires in the ceiling panel. (image 11)



image 11



Step 11: Install of screws for each part

The screws need to be installed in the places marked in the drawing.

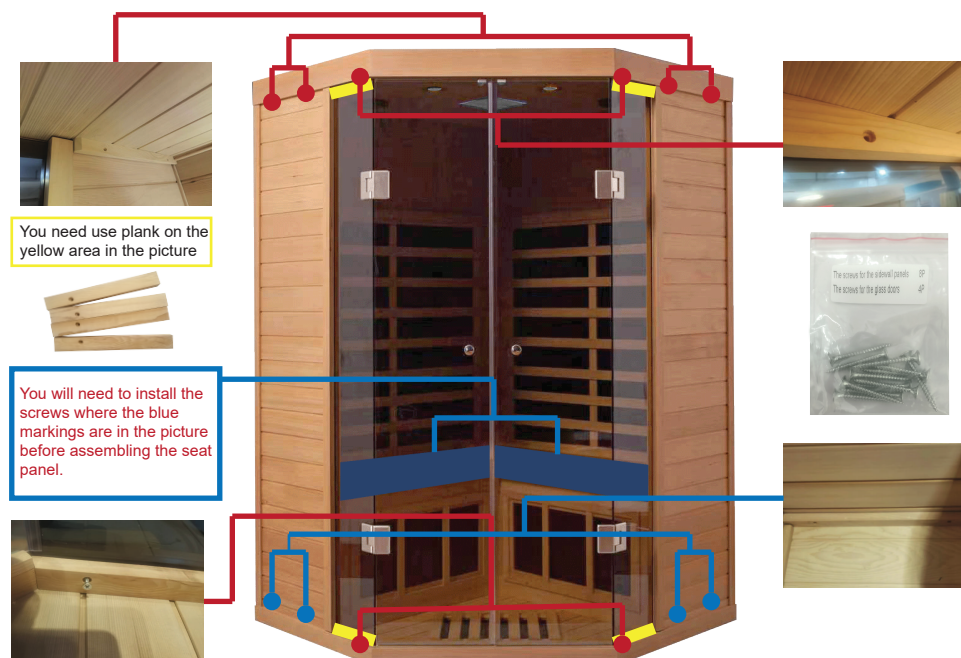

image 12