

DJYC2402

ASSEMBLY INTRODUCTION

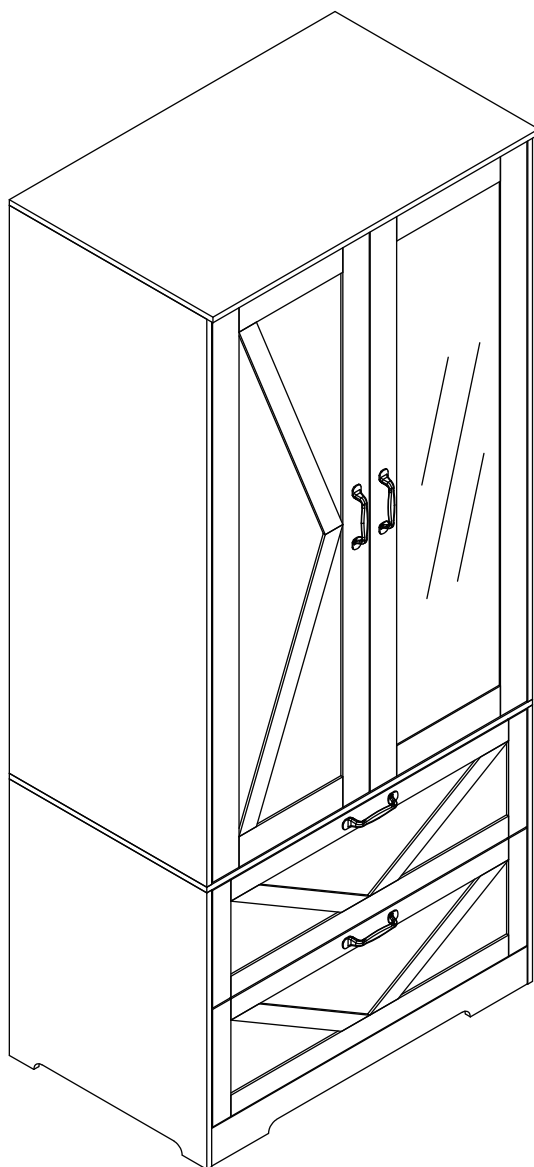

Plate

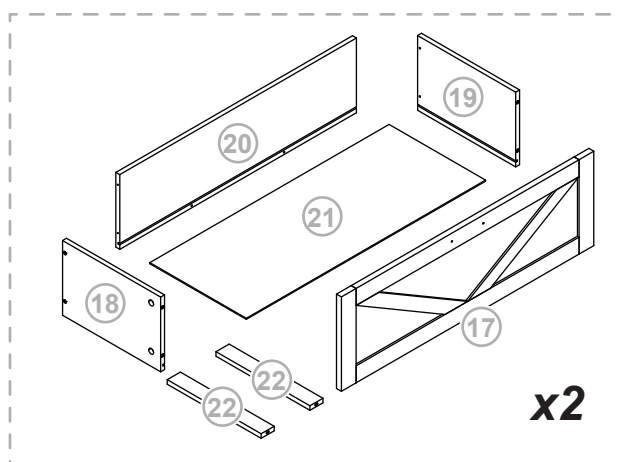
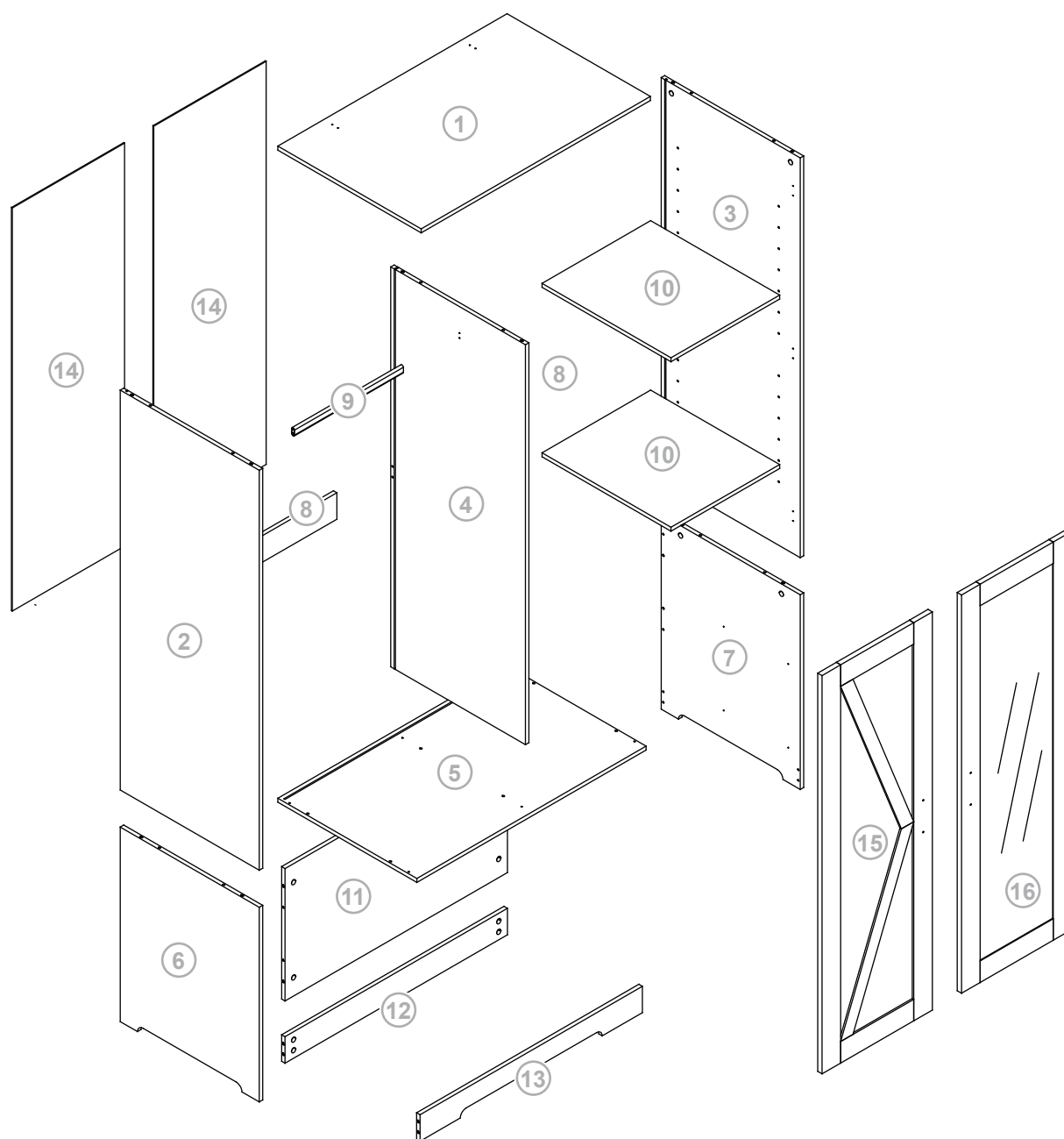

Plate

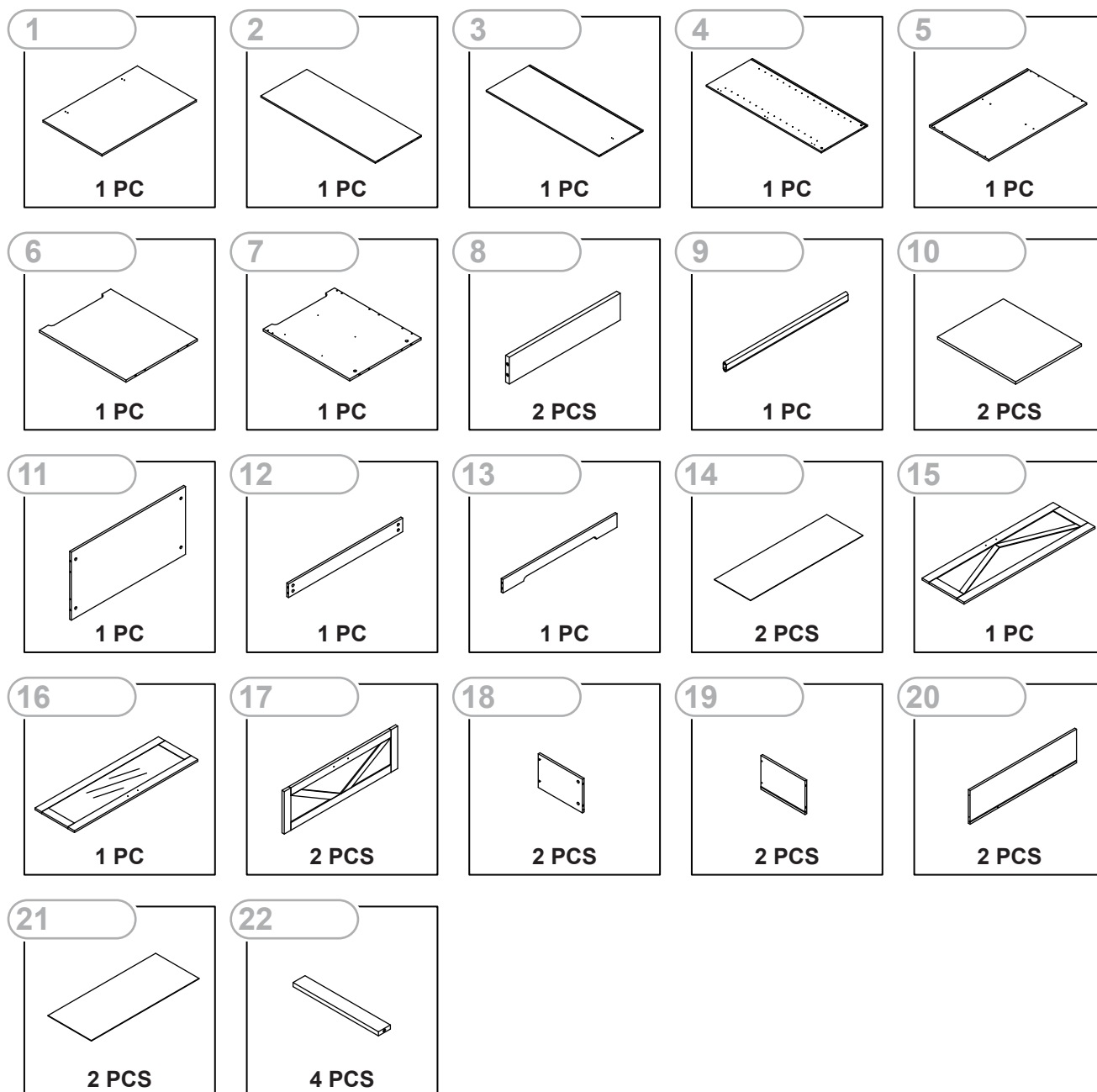

Fitting

A x 42 +2  M6 x 35 mm	B x 42 +2  $\varnothing 15 \times 9.5 \text{ mm}$	C x 20 +2  $\varnothing 6 \times 30 \text{ mm}$	D x 18 +2  $\varnothing 5 \times 45 \text{ mm}$	E x 30 +2  $\varnothing 3 \times 12 \text{ mm}$
F x 4  132 x 13 x 20 mm	G x 8 +1  $\varnothing 4 \times 18 \text{ mm}$	H x 2  $\varnothing 4 \times 17 \text{ mm}$	I x 1  4 mm	J x 3 
K x 2  75 x 15 x 30 mm	L x 6  $\varnothing 35 \text{ mm}$	M x 36 +2  $\varnothing 4 \times 12 \text{ mm}$	N x 1  190 x 30 x 15 mm	O x 8  $\varnothing 5 \times 19 \text{ mm}$
P x 4  $\varnothing 4 \times 12 \text{ mm}$	Q x 12  	R x 2  $\varnothing 6 \times 30 \text{ mm}$	S x 2  $\varnothing 4 \times 35 \text{ mm}$	CR x 2  300 mm
CL x 2  300 mm	DR x 2  300 mm	DL x 2  300 mm		

1

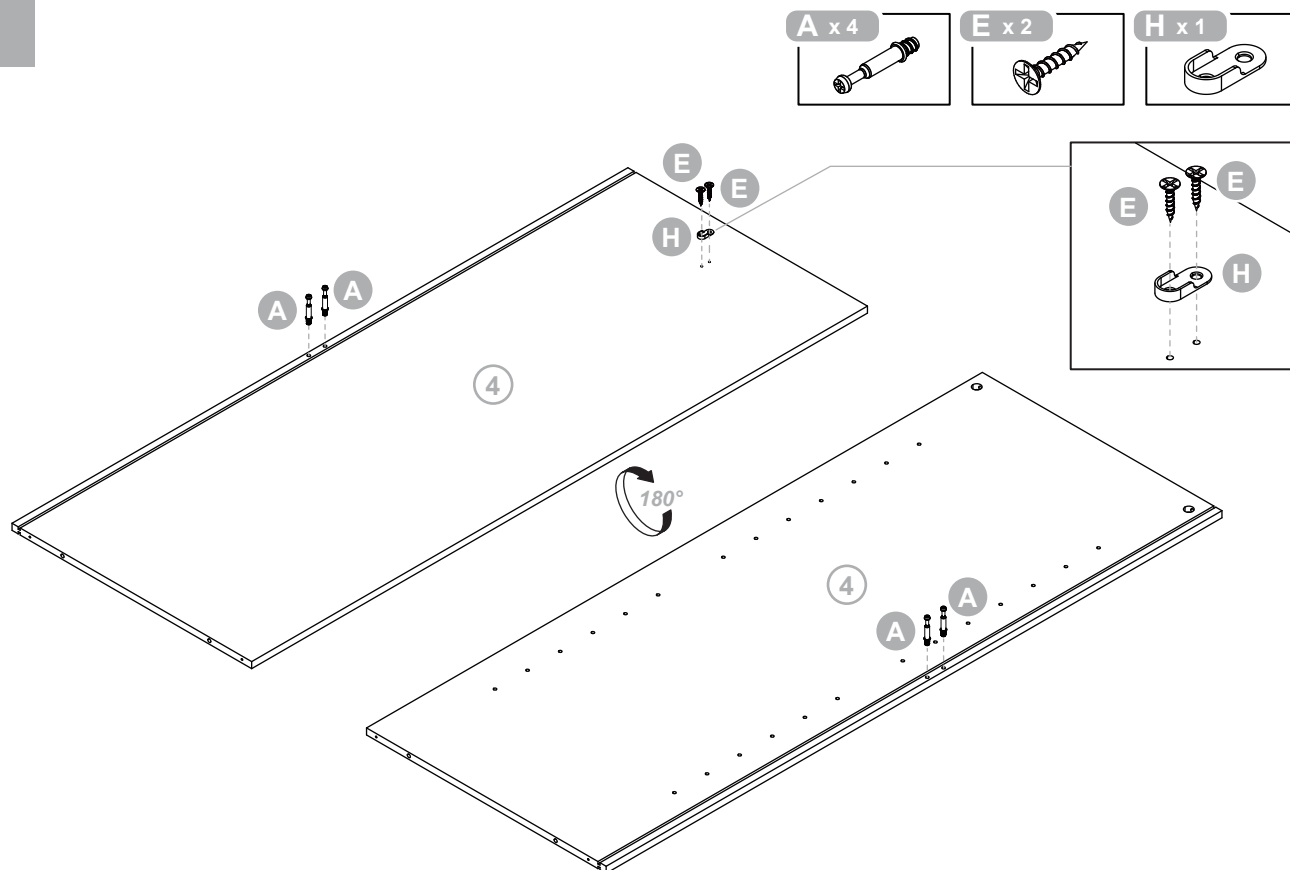

2

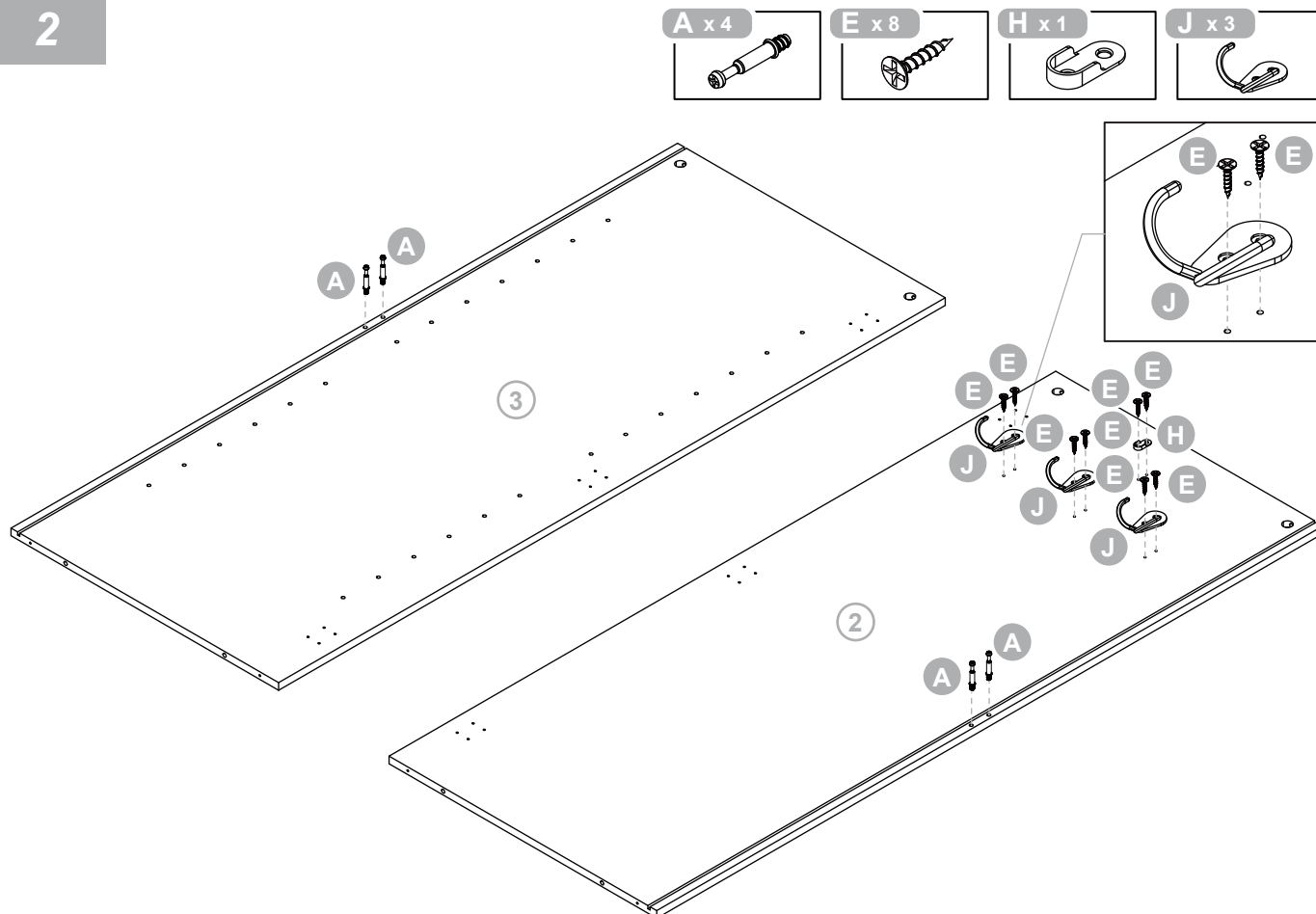

3

B x 8

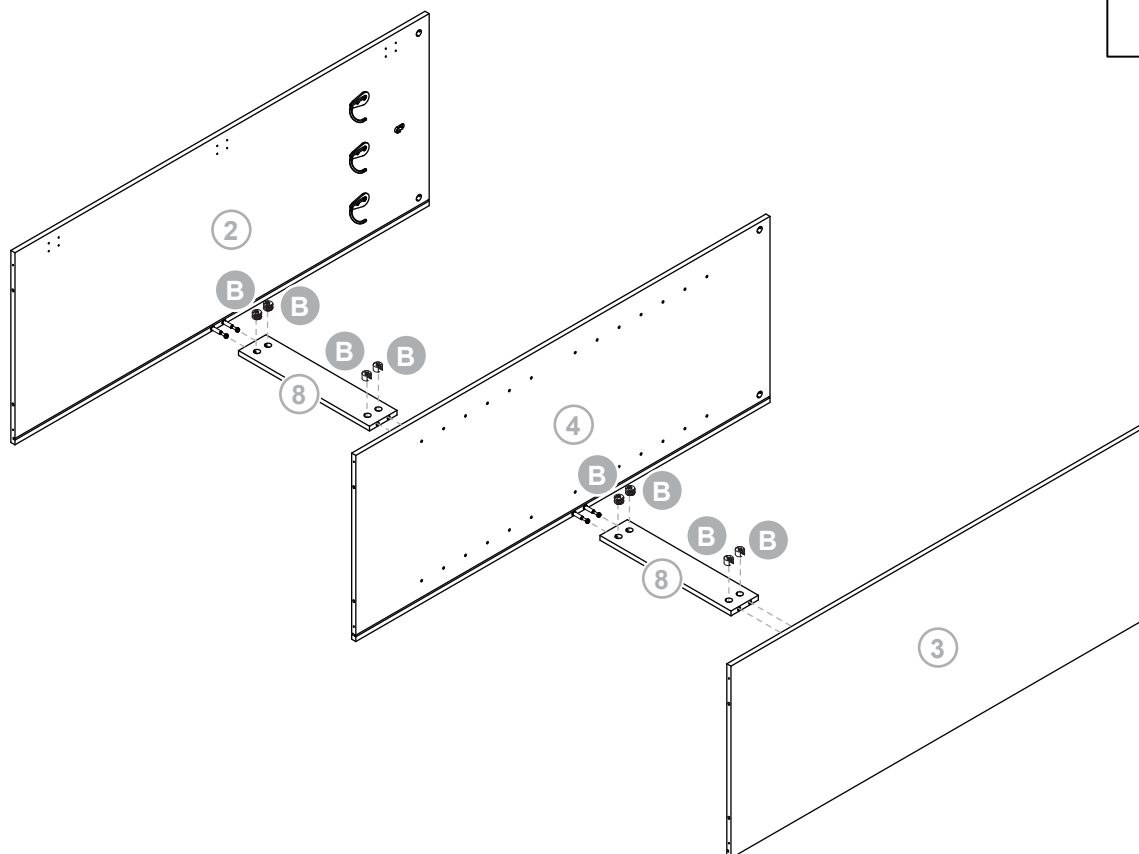

4

A x 6

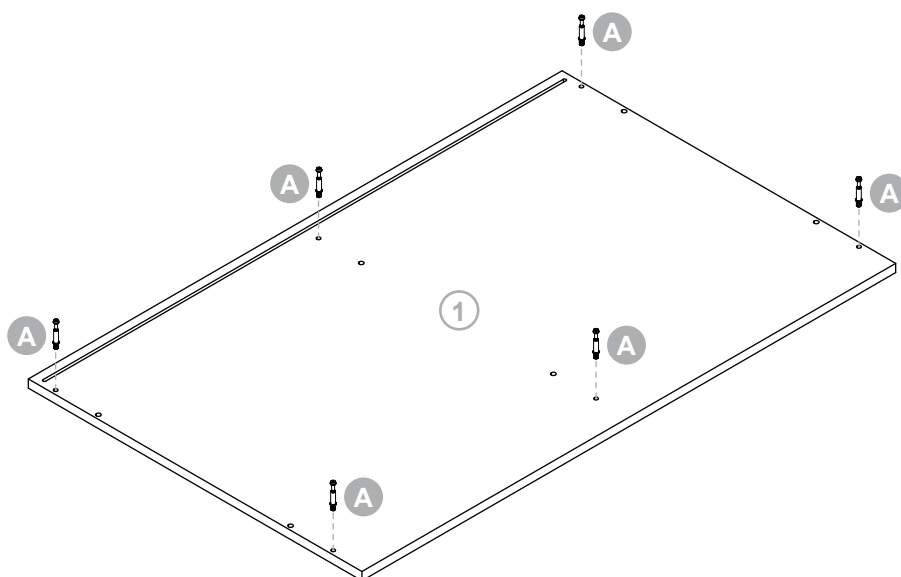

5

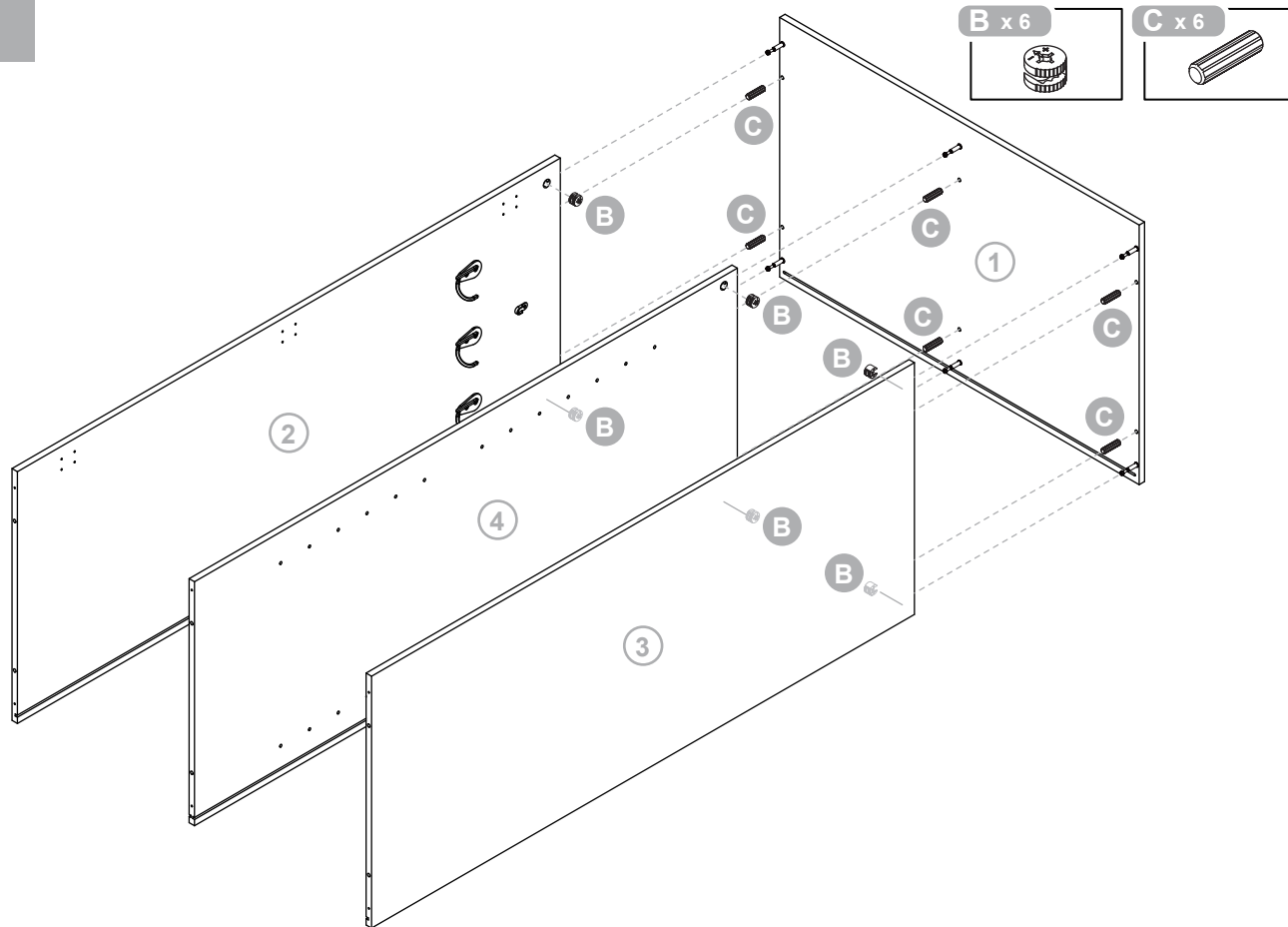

6

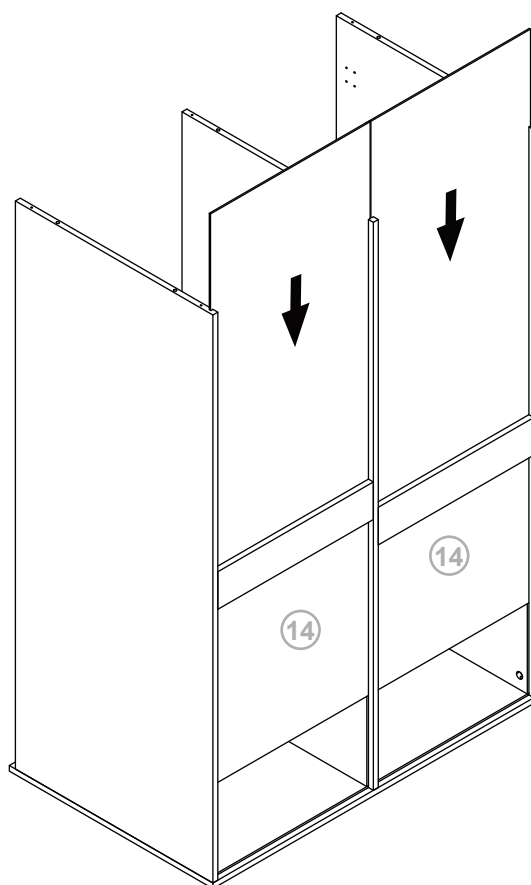

7

A x 4

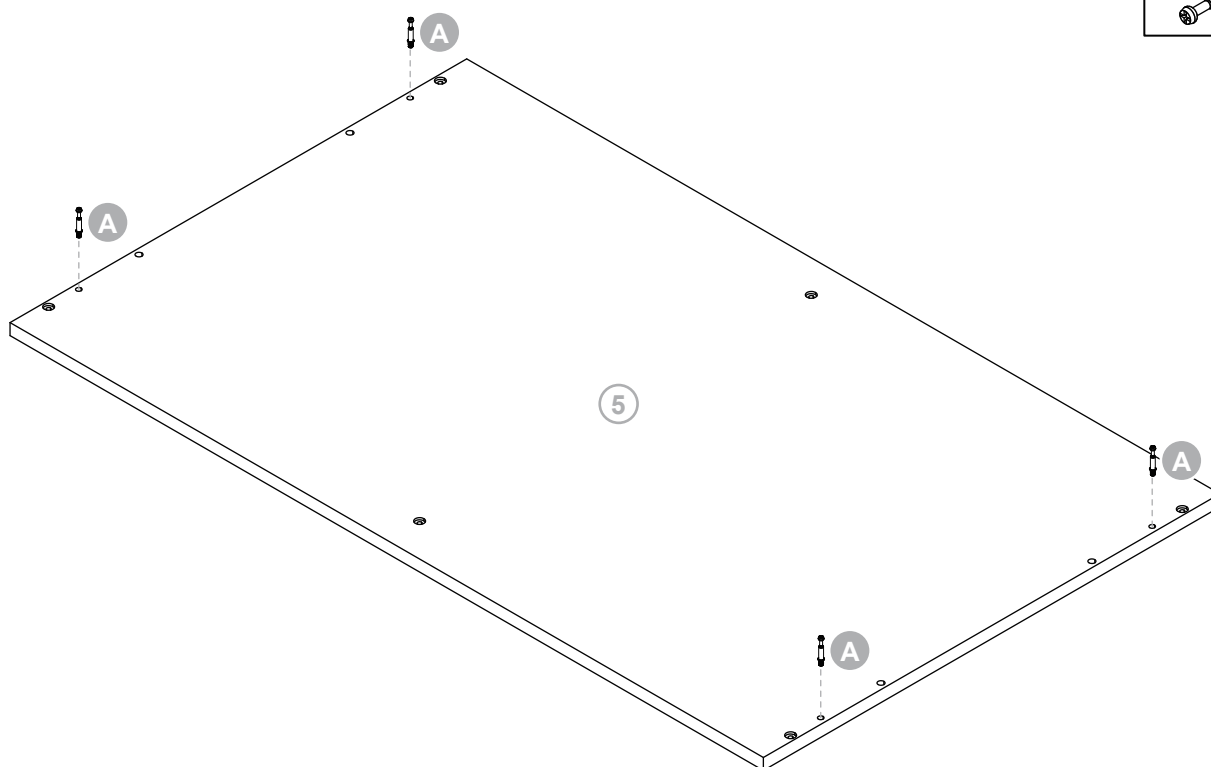

8

C x 6



D x 6



I x 1

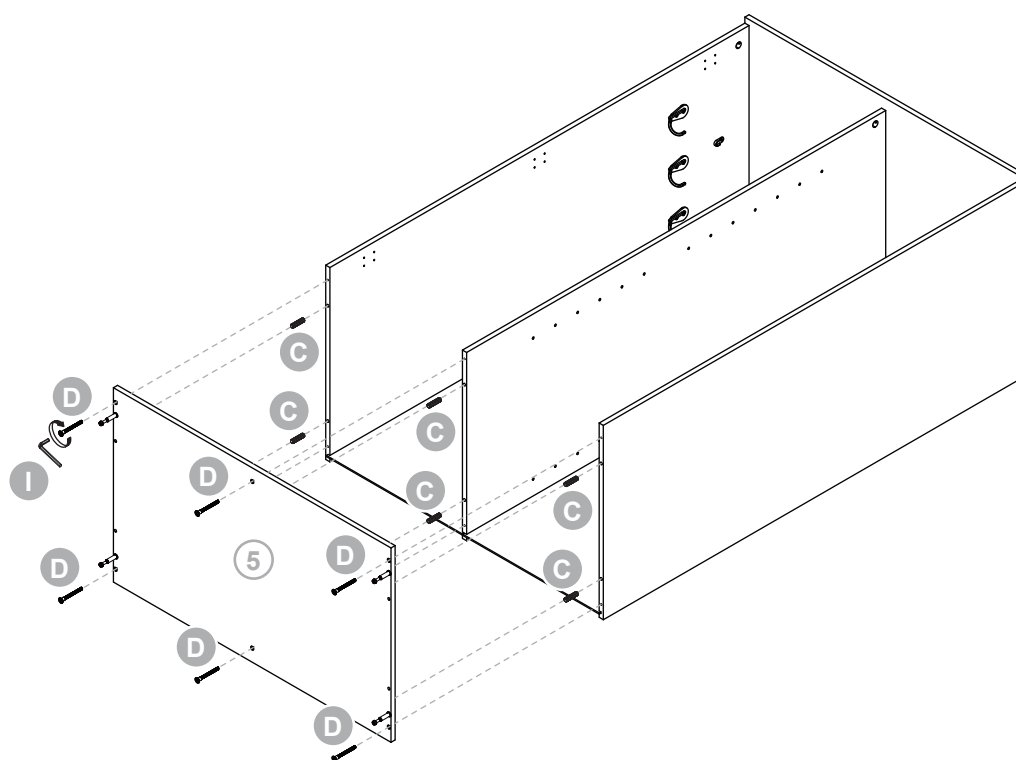

9

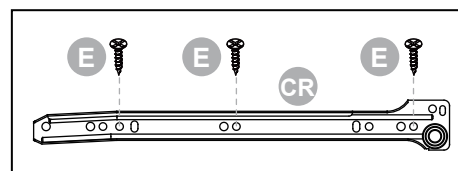
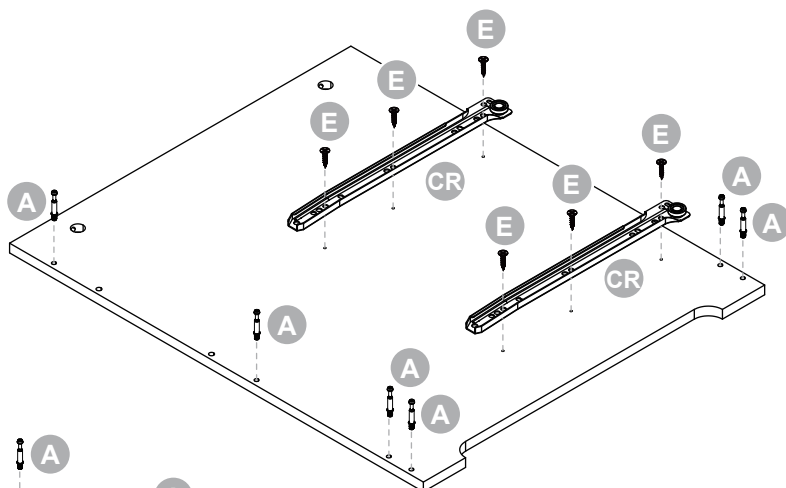
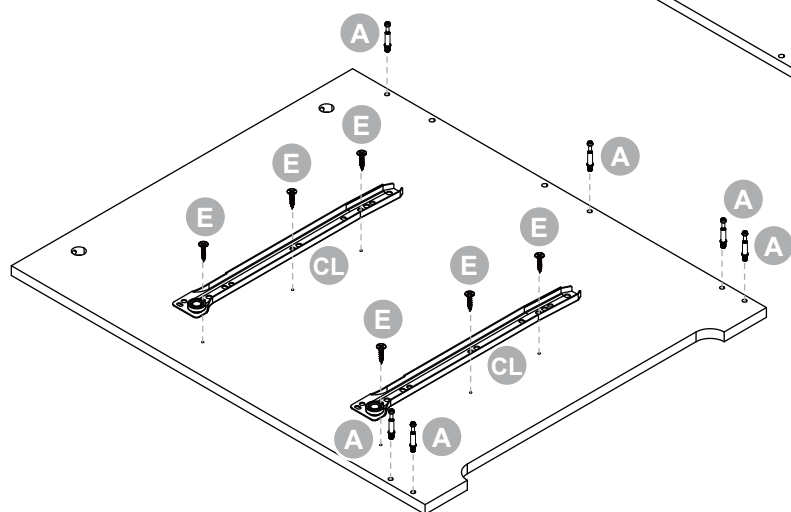
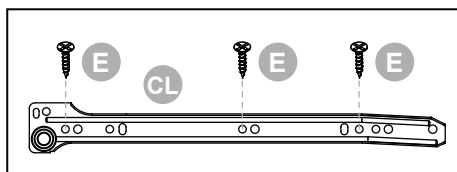

10

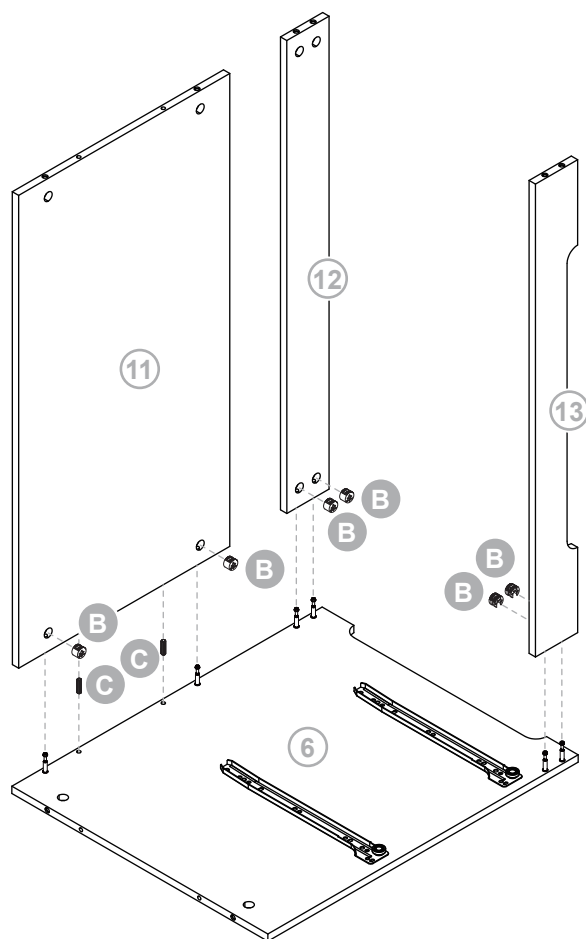
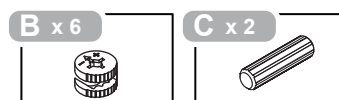

11

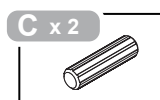
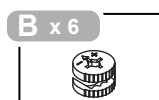
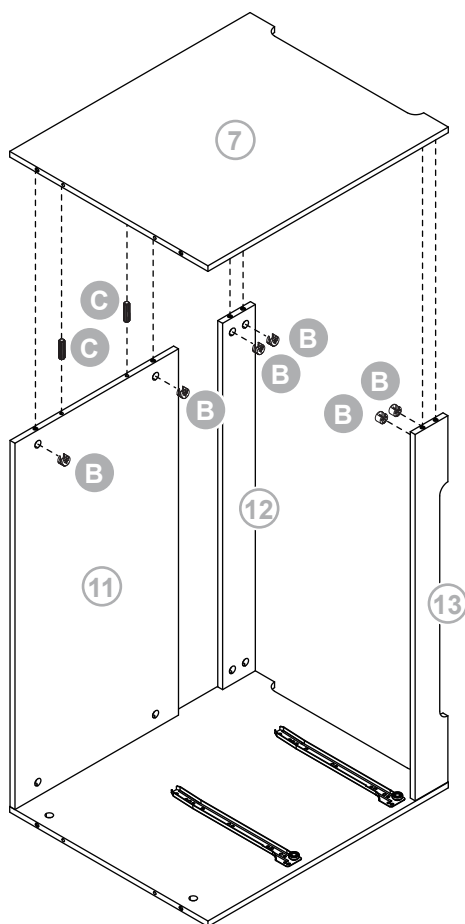

12

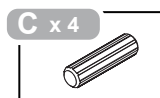
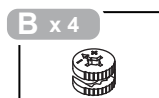
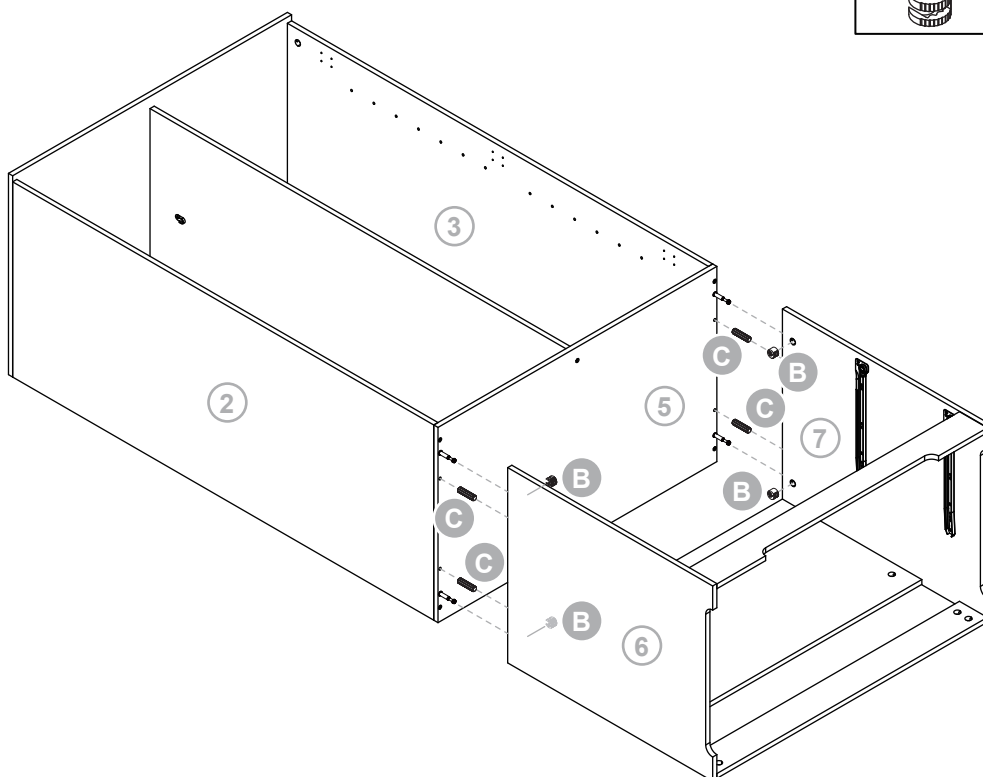

13

Q x 12

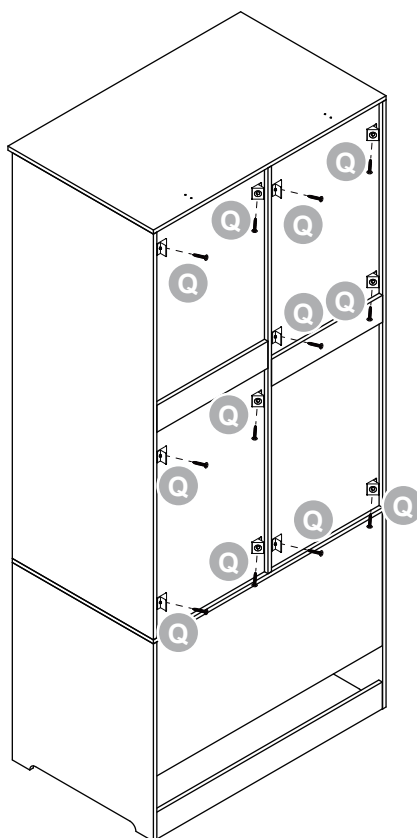

14

F x 2

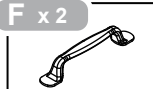

G x 4

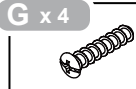

L x 6

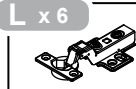

M x 12

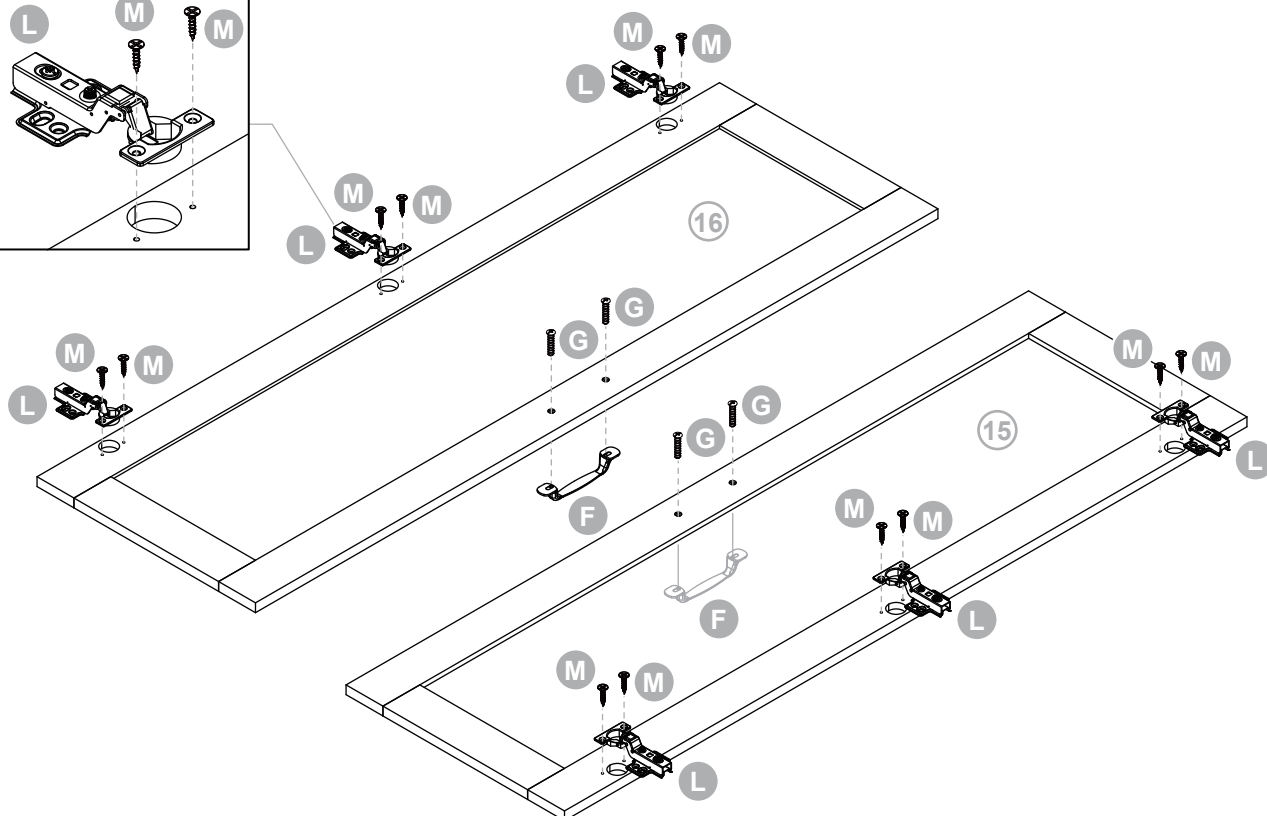
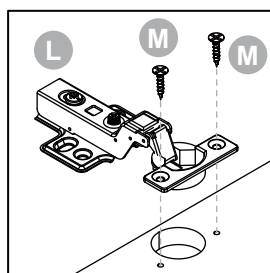
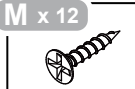

15

M x 24

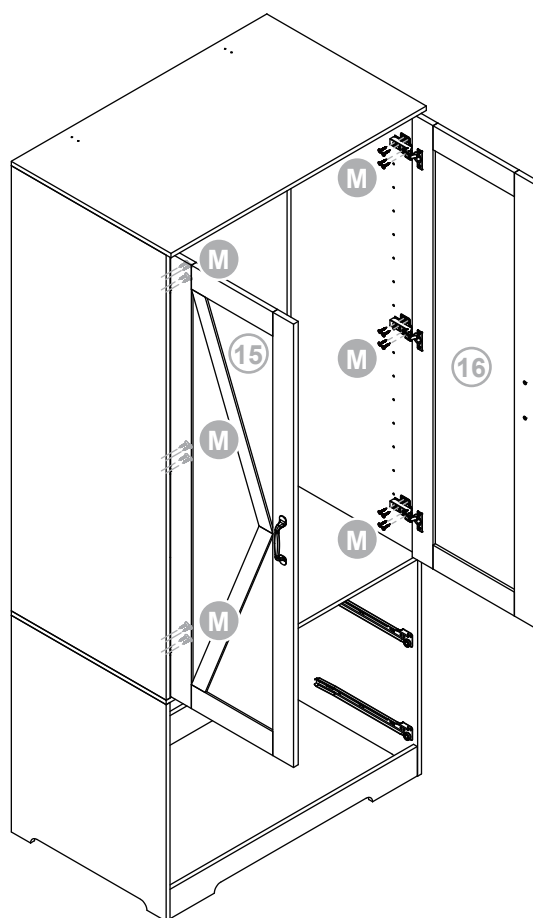

16

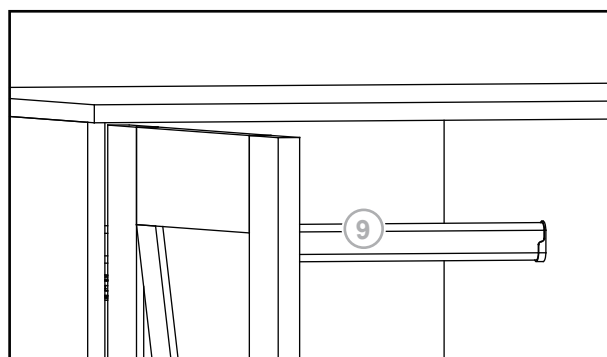
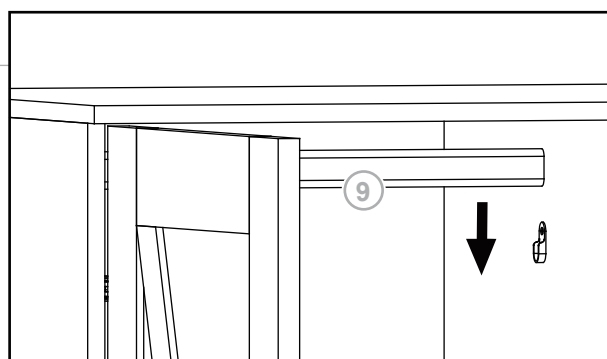
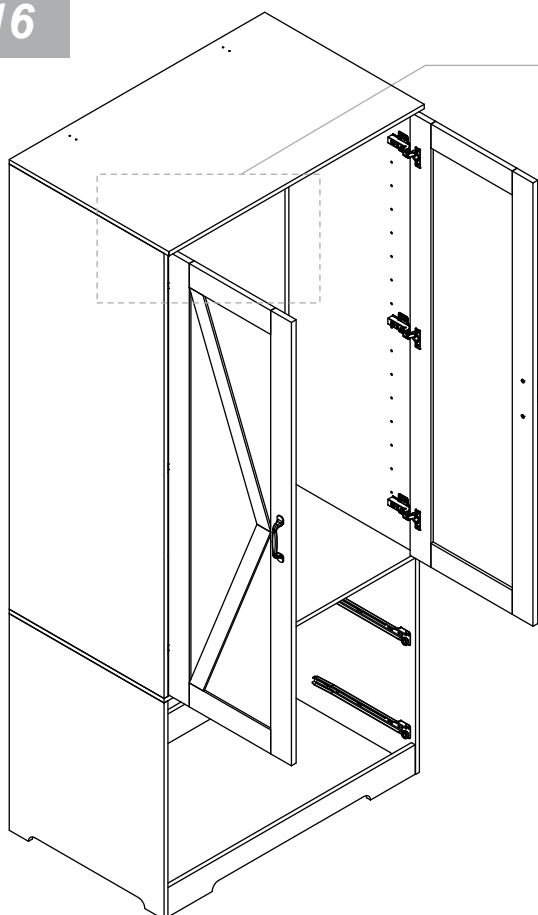

17

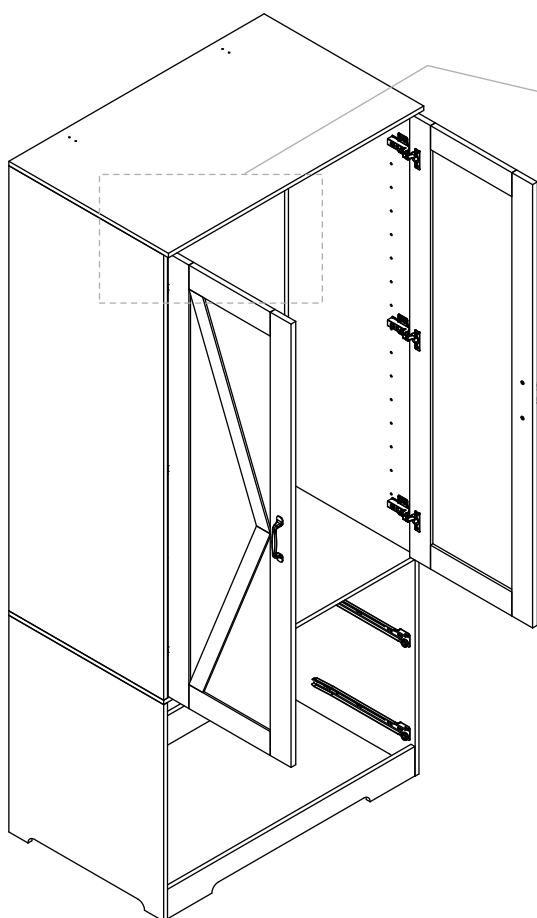

N x 1

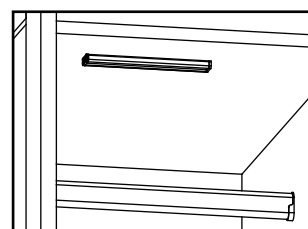
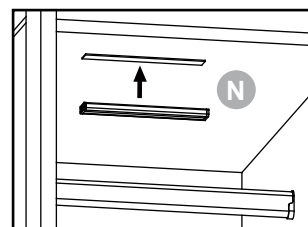
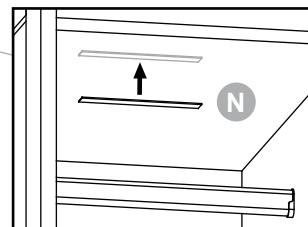

18

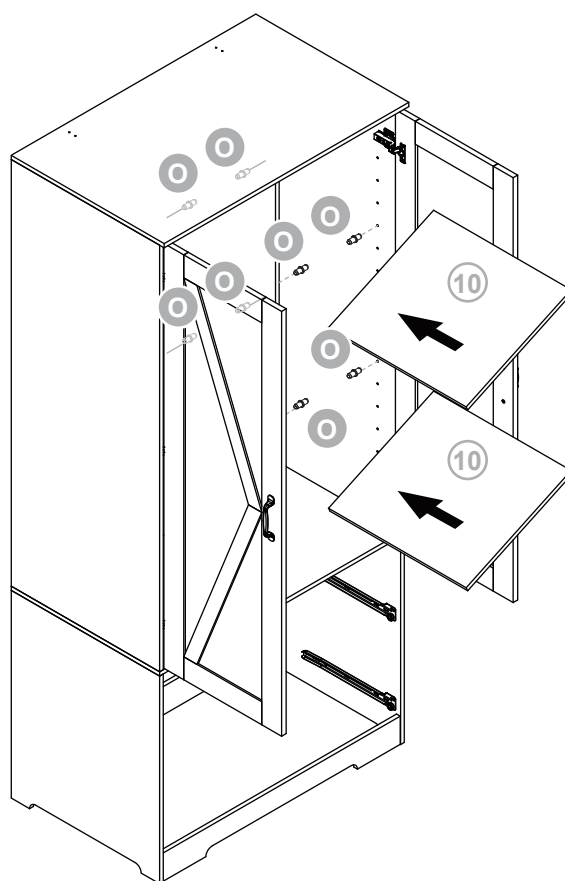

O x 8



19

A x 12

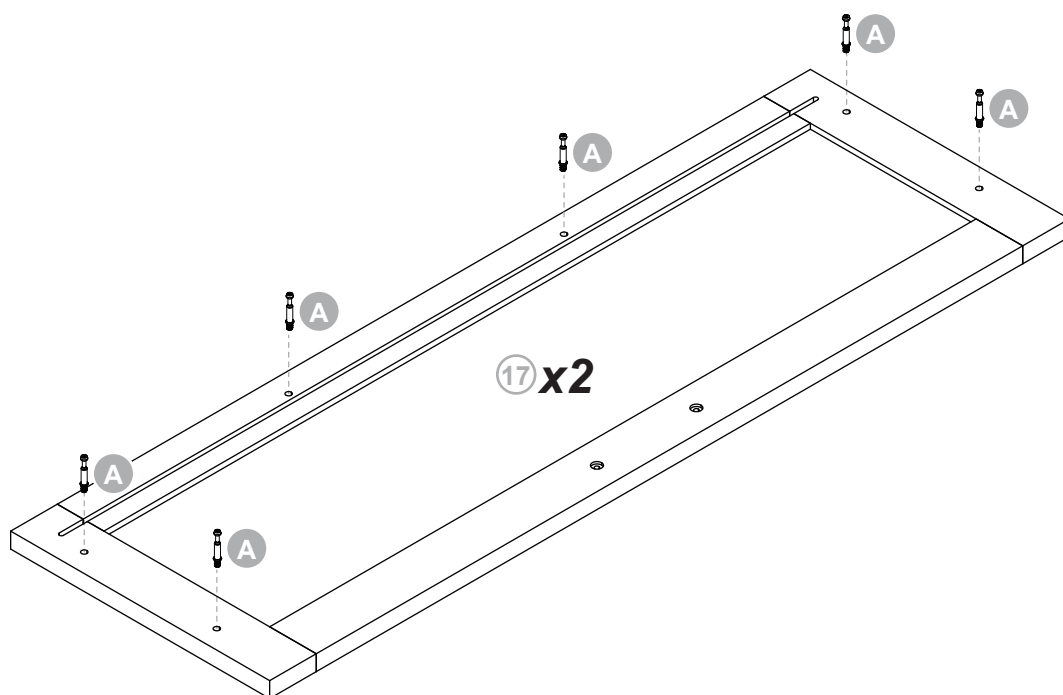

20

D x 12

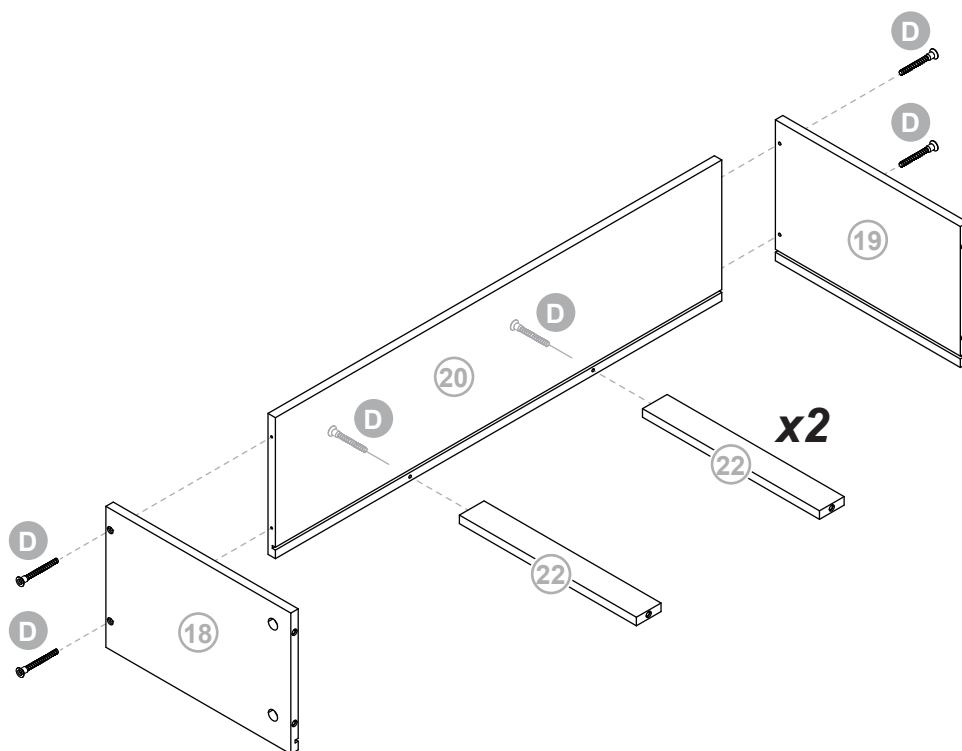

21

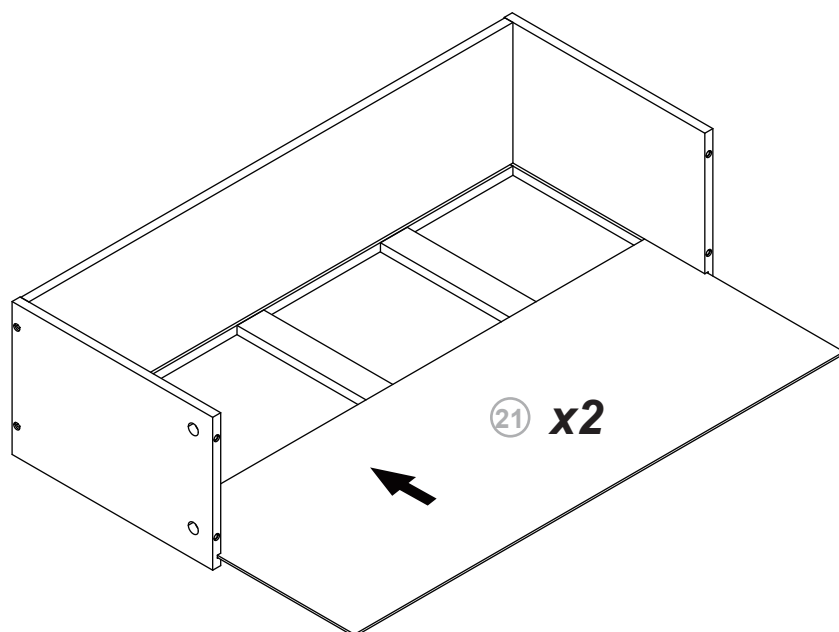

22

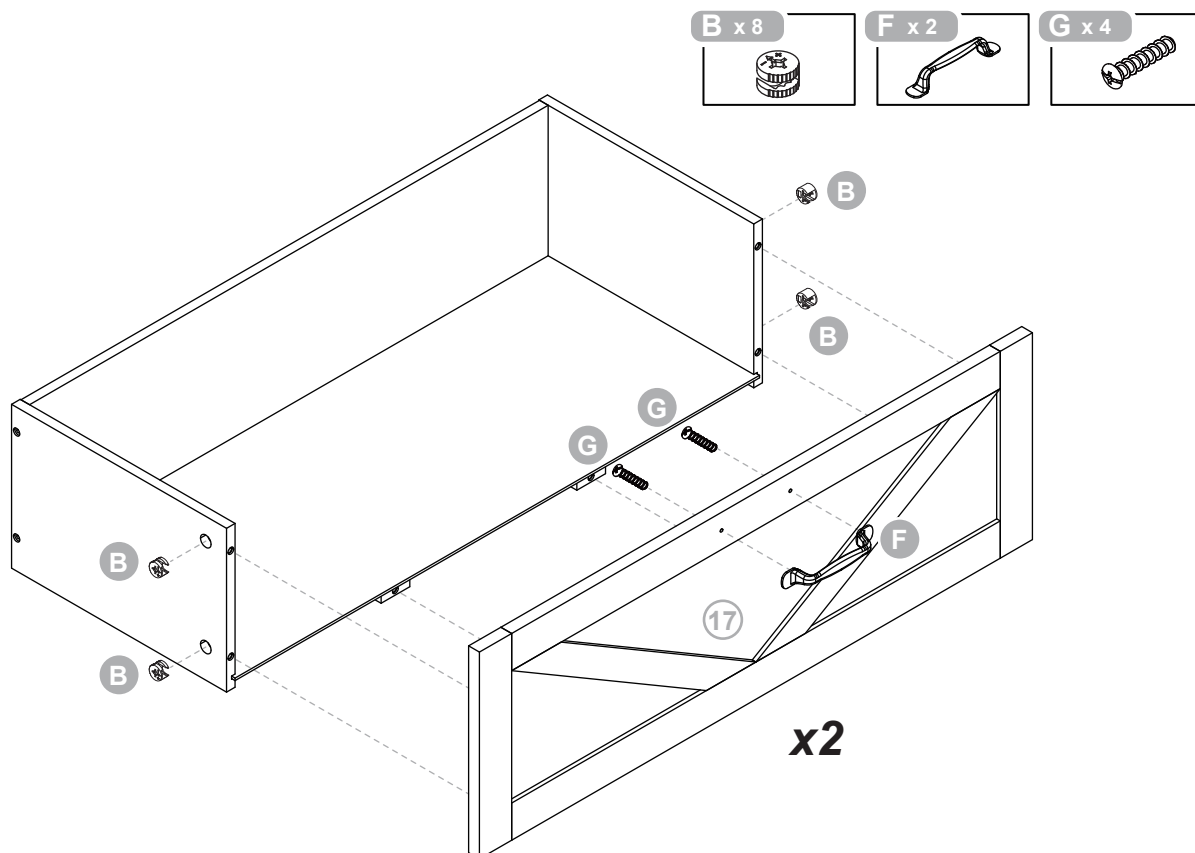

23

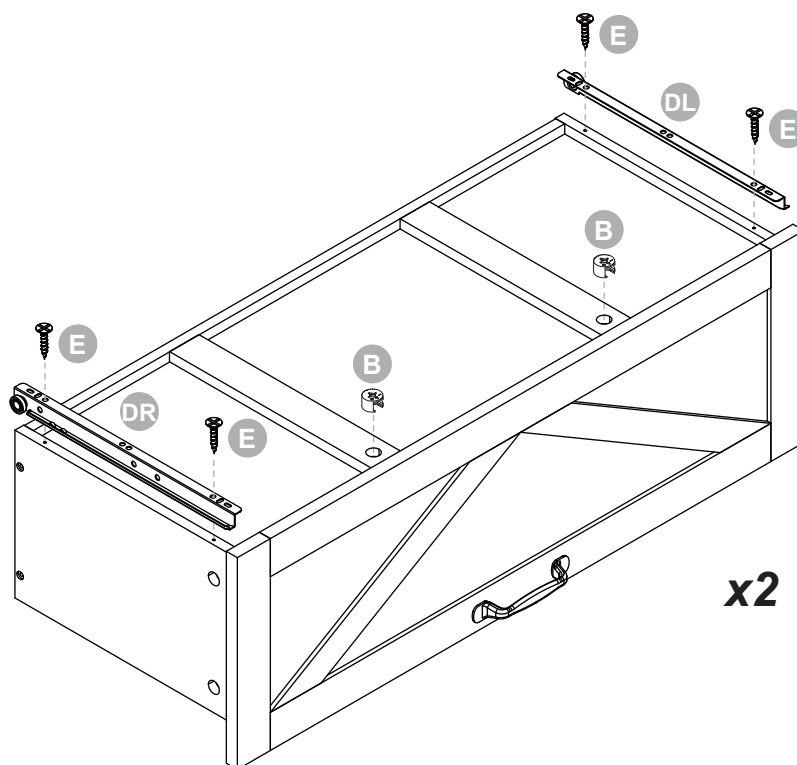

24

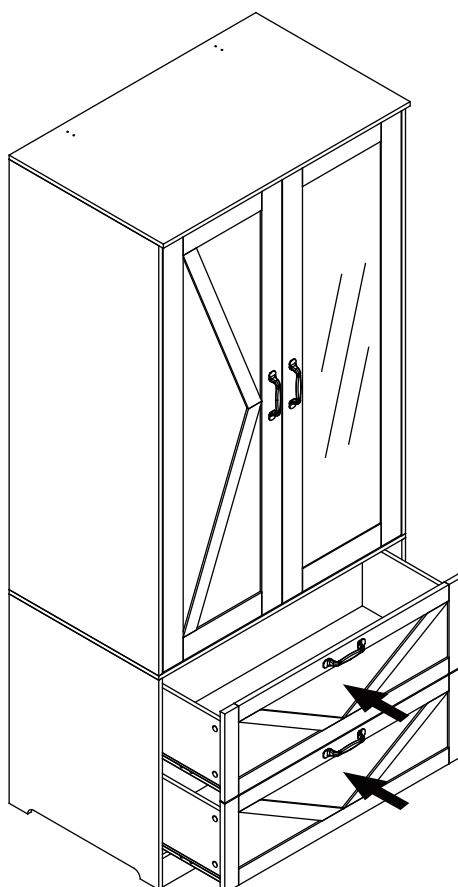

25

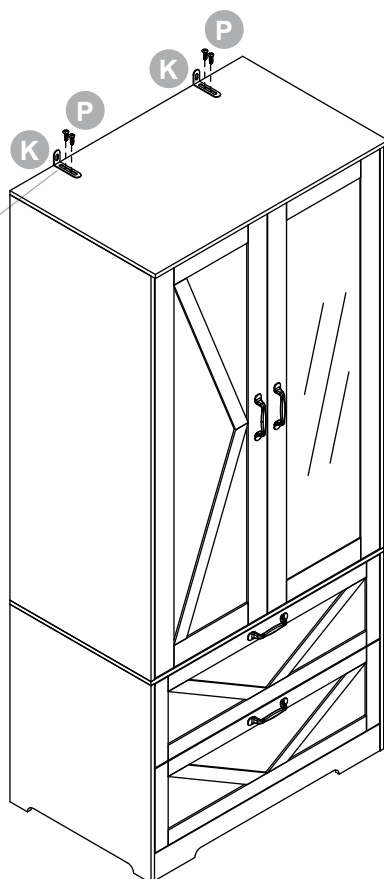
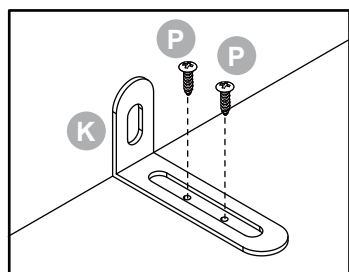

K x 2

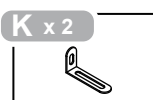

P x 4

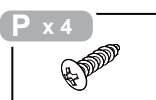

26

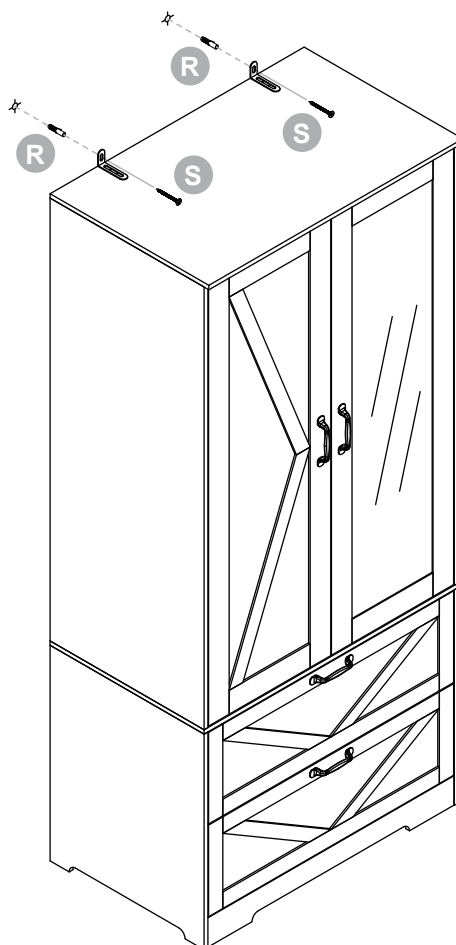

R x 2

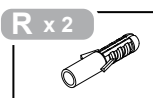

S x 2

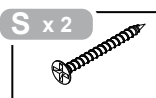

**Customer Attention:**

To align doors and control gap in between doors. Product doors may need adjusting during and after assembly.

This can be done by adjusting appropriate screws. See below illustration.

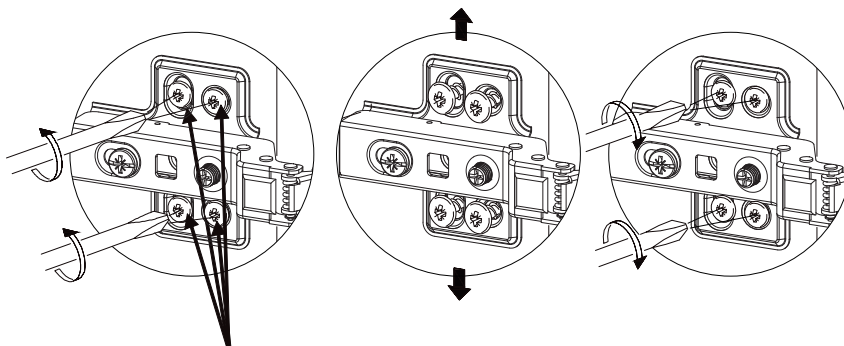
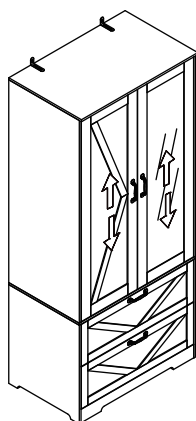
**Vertical Door Adjustment:**

Loosen both screws on all hinges and lift the door to the desired height.

This allows an even space at the top and bottom between the door and frame.

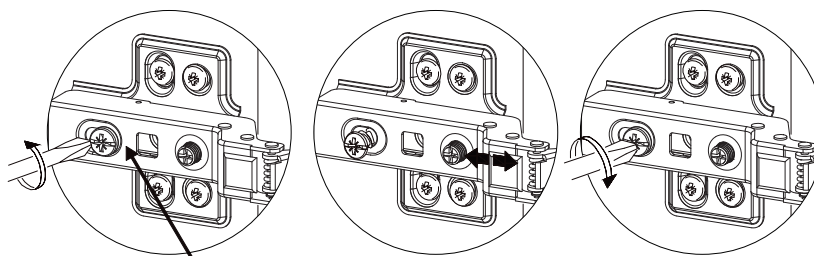
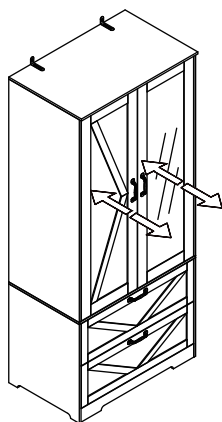
**Lateral Door Adjustment:**

If door is hinge bound, (rubbing on frame as you close or open door) loosening screw shown and move the door in appropriate direction. (In or out)

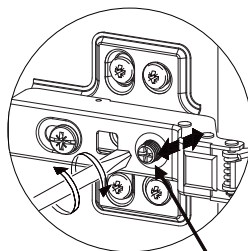
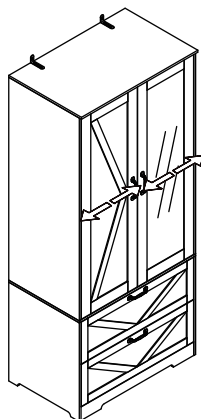
**Horizontal Door Adjustment:**

Rotate Screw clockwise or anticlockwise.

This will produce an even gap between doors and frame.