

INSTRUCTION MANUAL

MODEL:1214LM

Edition:20240301046Z

Congratulations, you now have a new function sofa with massage.

Before enjoy the comfort chair, you have to put it together. This Assembly Guide will take you through the basic assembly process. To make sure your assembly goes smoothly, please follow the assembly instructions, **and especially the important safety information.**

Also, while it is possible to assemble the chair on your own, **having a second person to help you makes it even easier.**

Before you begin, please check if there are any missing parts from the package. Should there be any issues, please don't hesitate to drop us an email and we'll help you out ASAP.

PACKAGE LIST

02

A

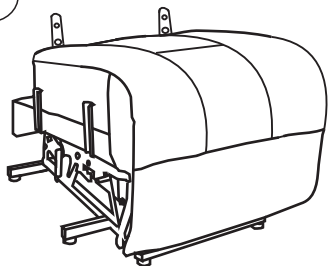

B

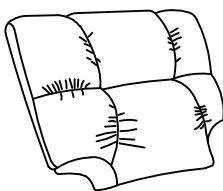

C

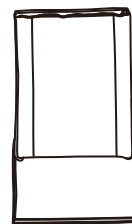

D

D (L) Gray

D (R) Black

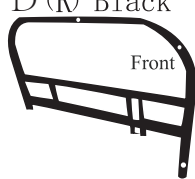
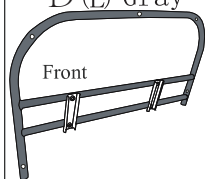

E

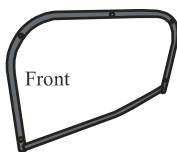

E (L) Gray

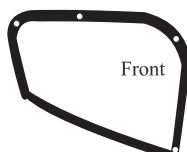

E (R) Black

F



F (L)



F (R)

It was put under the cushion

G

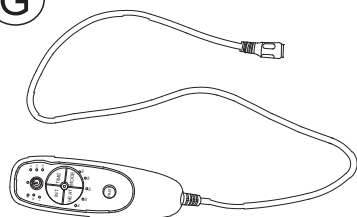

H

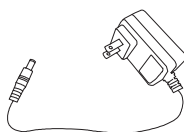

I

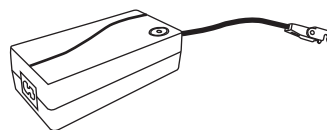

X



Y

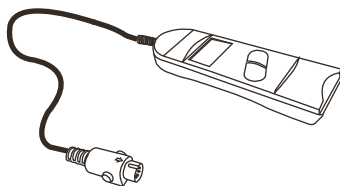

spare



2pcs

PACKAGE LIST

M

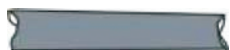

10pcs

N



10pcs

O



J



x2

K



x4

L



x5

Q



ASSEMBLY IN STRUCTION

04

STEP 1: Use spanner O and screw N to pin through the inner iron frame D and the armrest pillar M to the outer frame E of the armrest. Tight all screws, please pay attention to distinguish the front and back of the armrest frame.

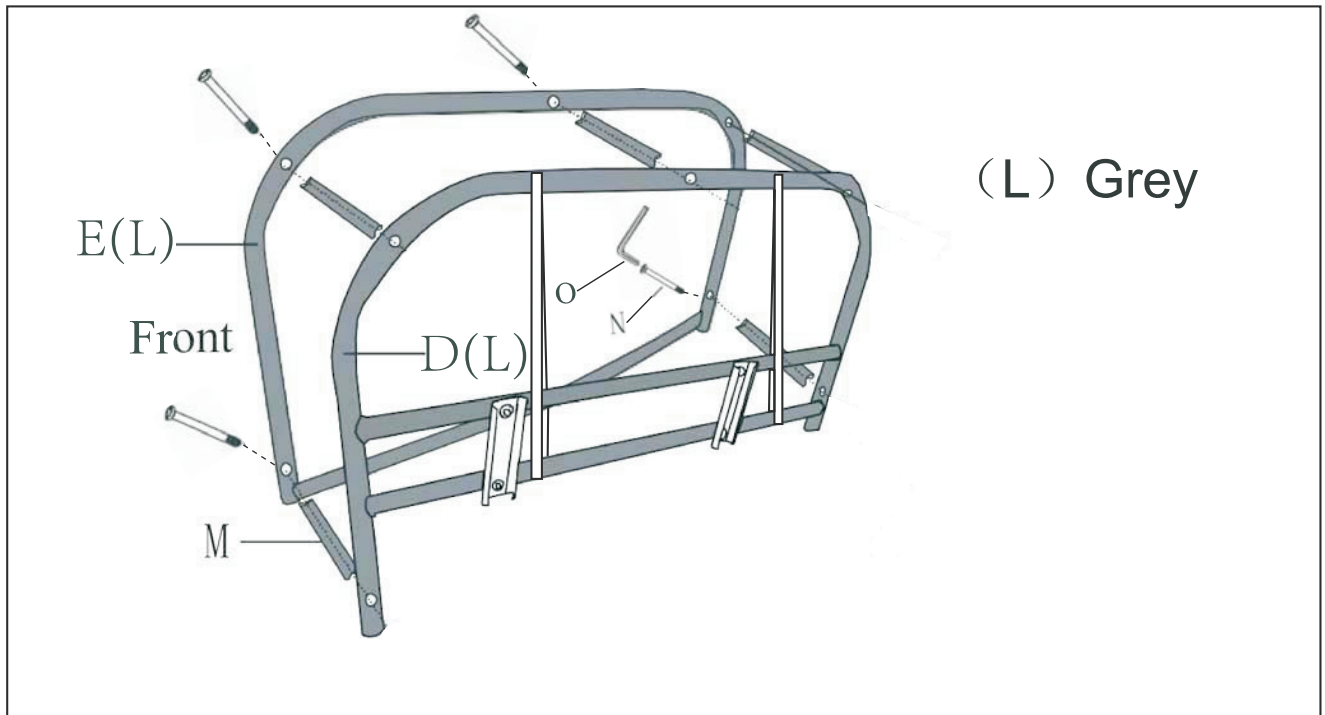

STEP 2: Align the armrest cover to armrest-assembled iron frame in sequence of left and right, back and forward. so that the cloth cover hole is aligned with the insert hole. Pull the zipper after all is OK.

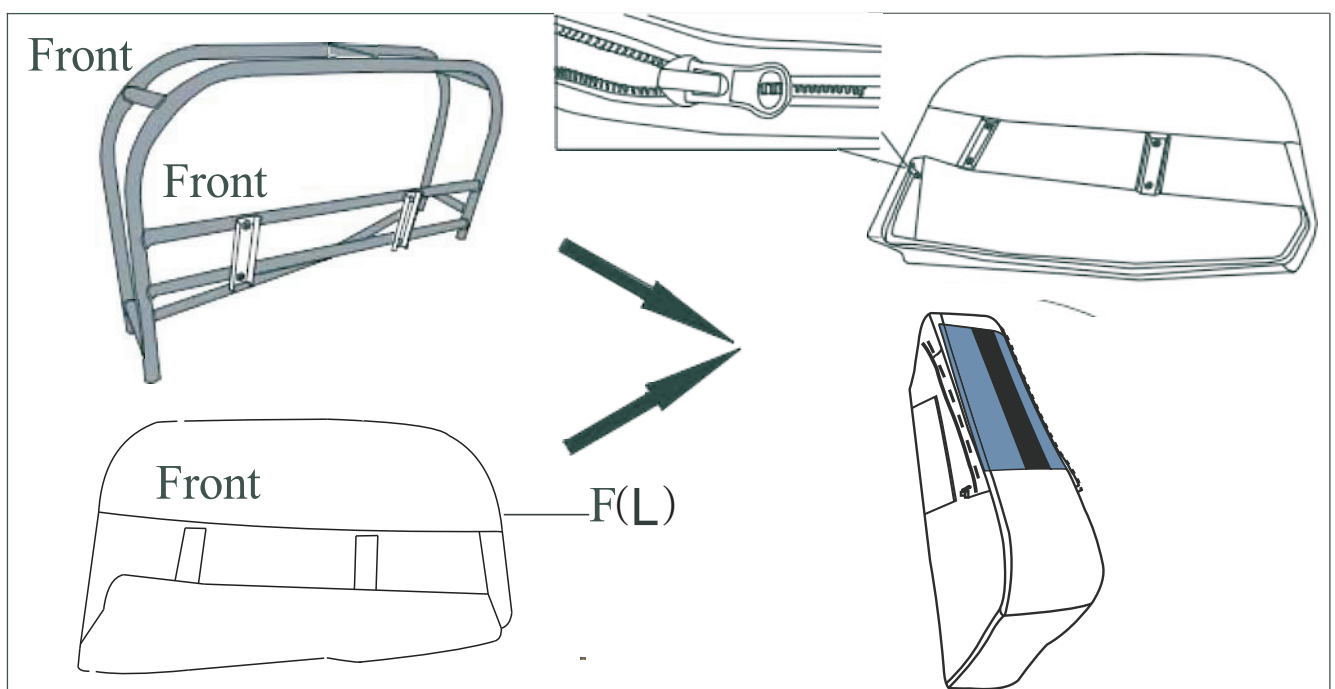

STEP 3: Repeat Step 1.

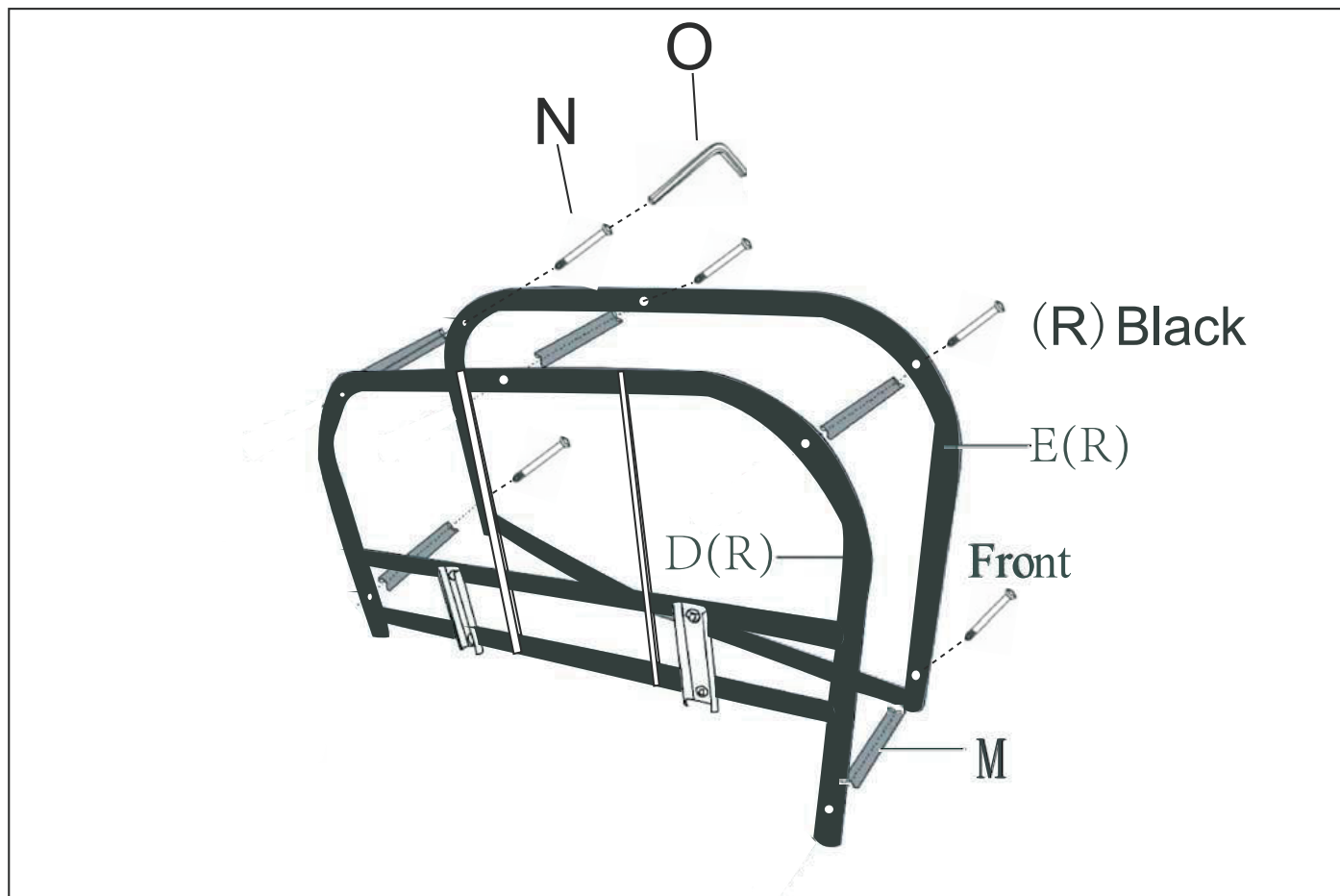

STEP 4: Repeat Step 2.

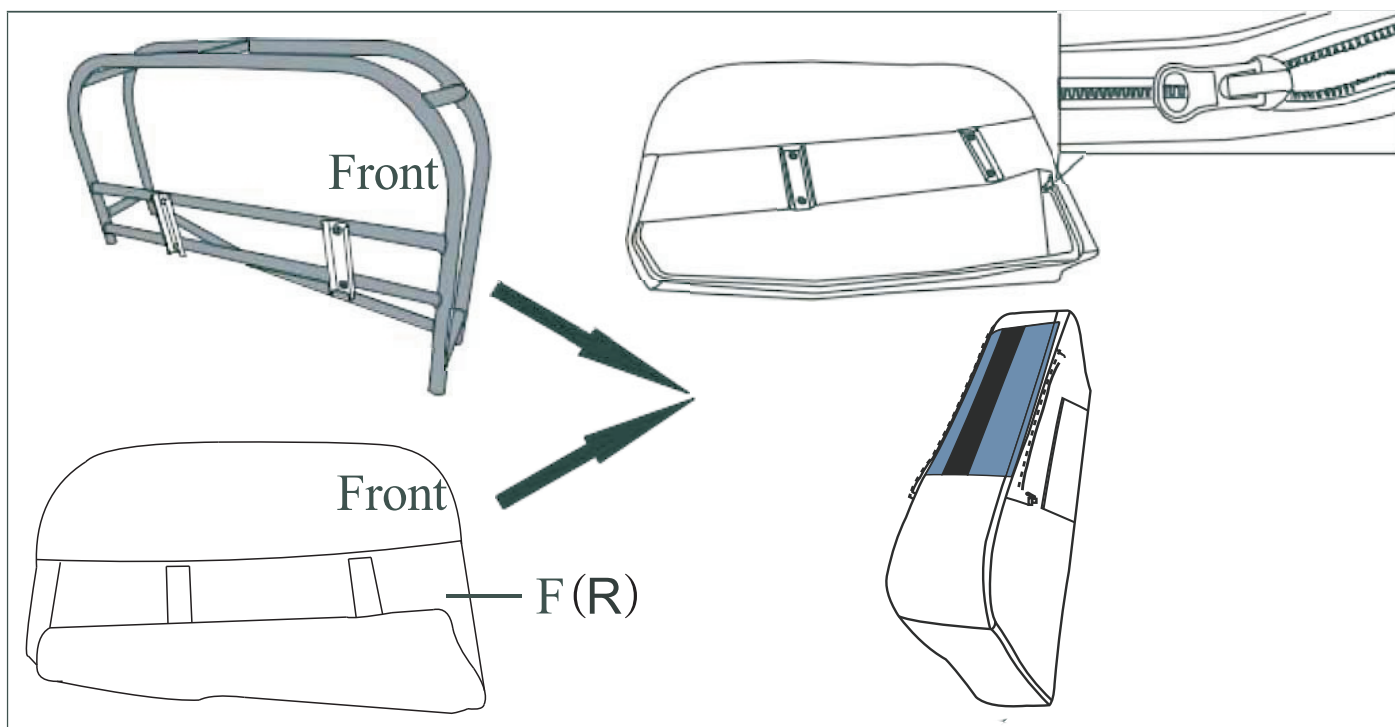

ASSEMBLY IN STRUCTION

Please zip up both sides of the arm cushion

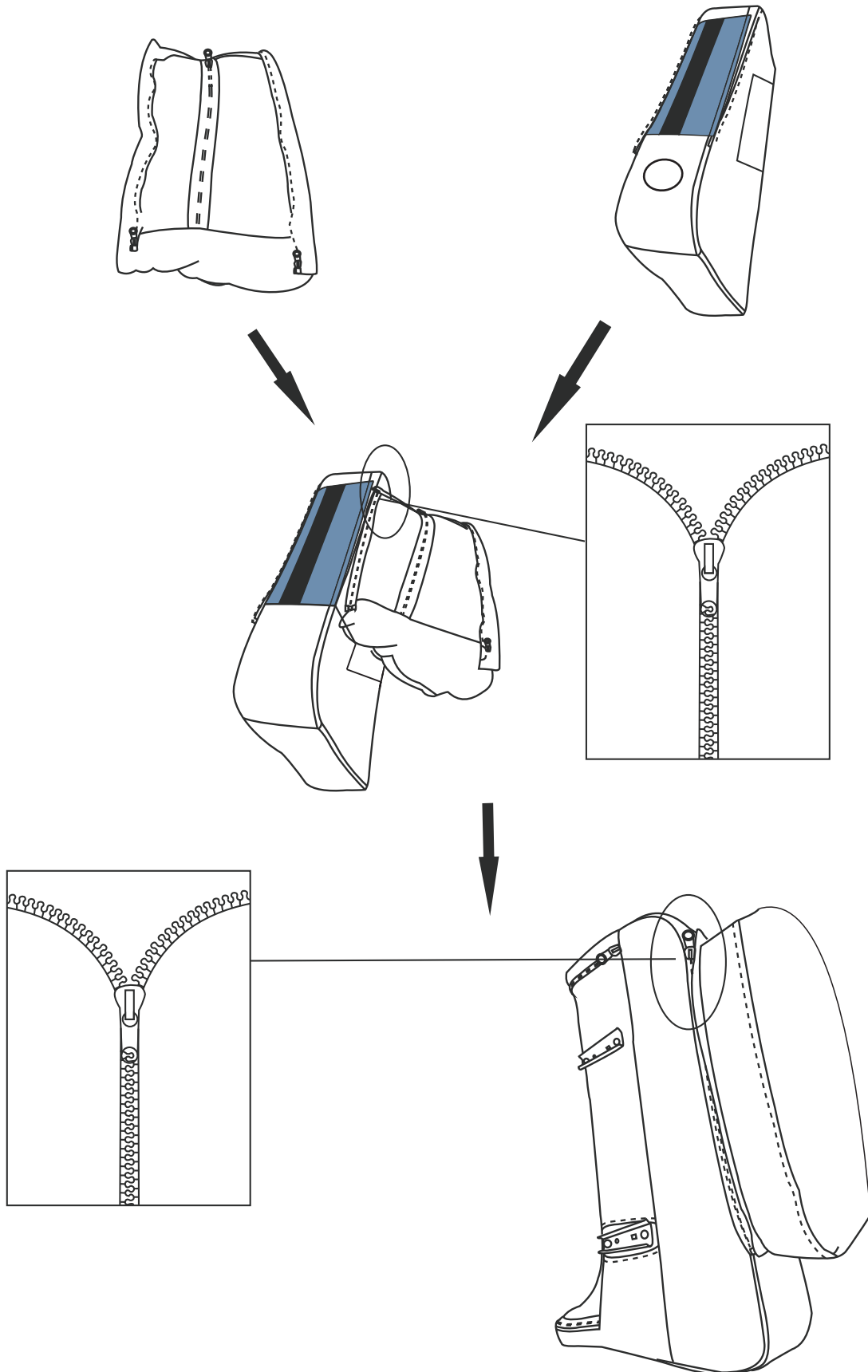

ASSEMBLY IN STRUCTION

07

STEP 5: Thread screw L through the support frame, place L on the support frame in sequence, and then lock it with nut K and screw L.

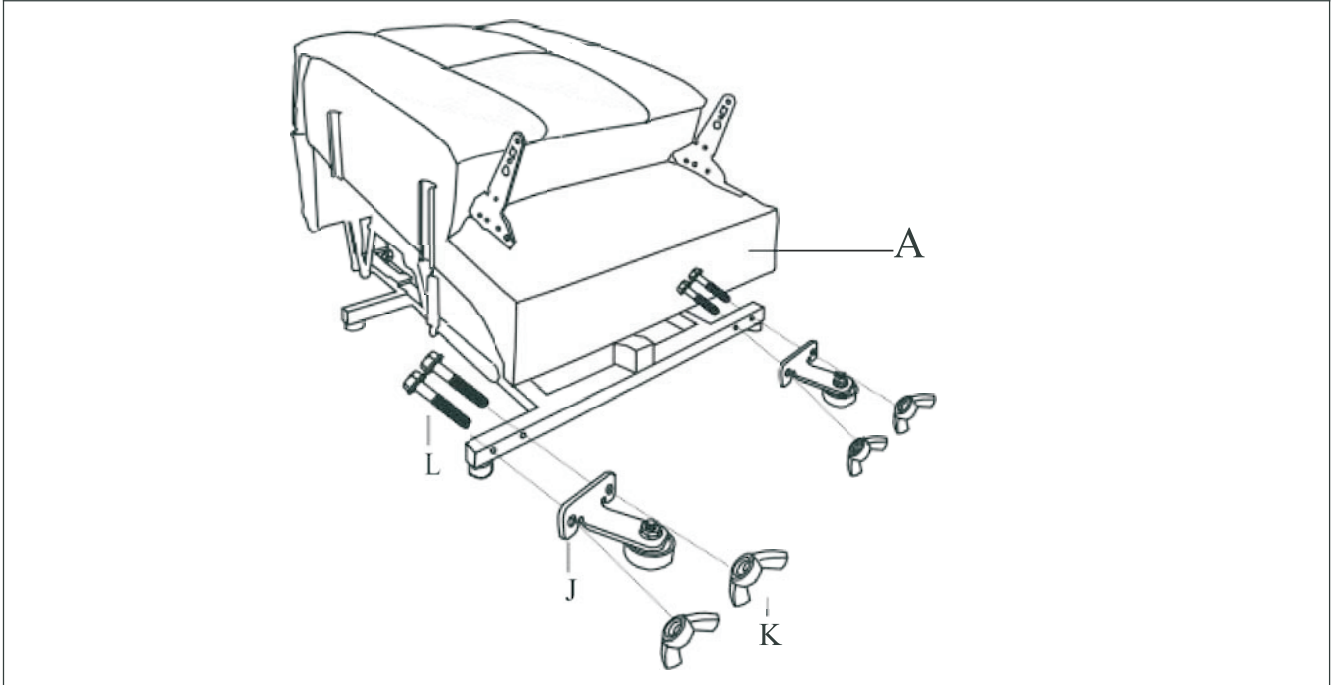

STEP 6 :Insert arms so that they can fit into the seat,you will hear a“ click” when they are engaged.

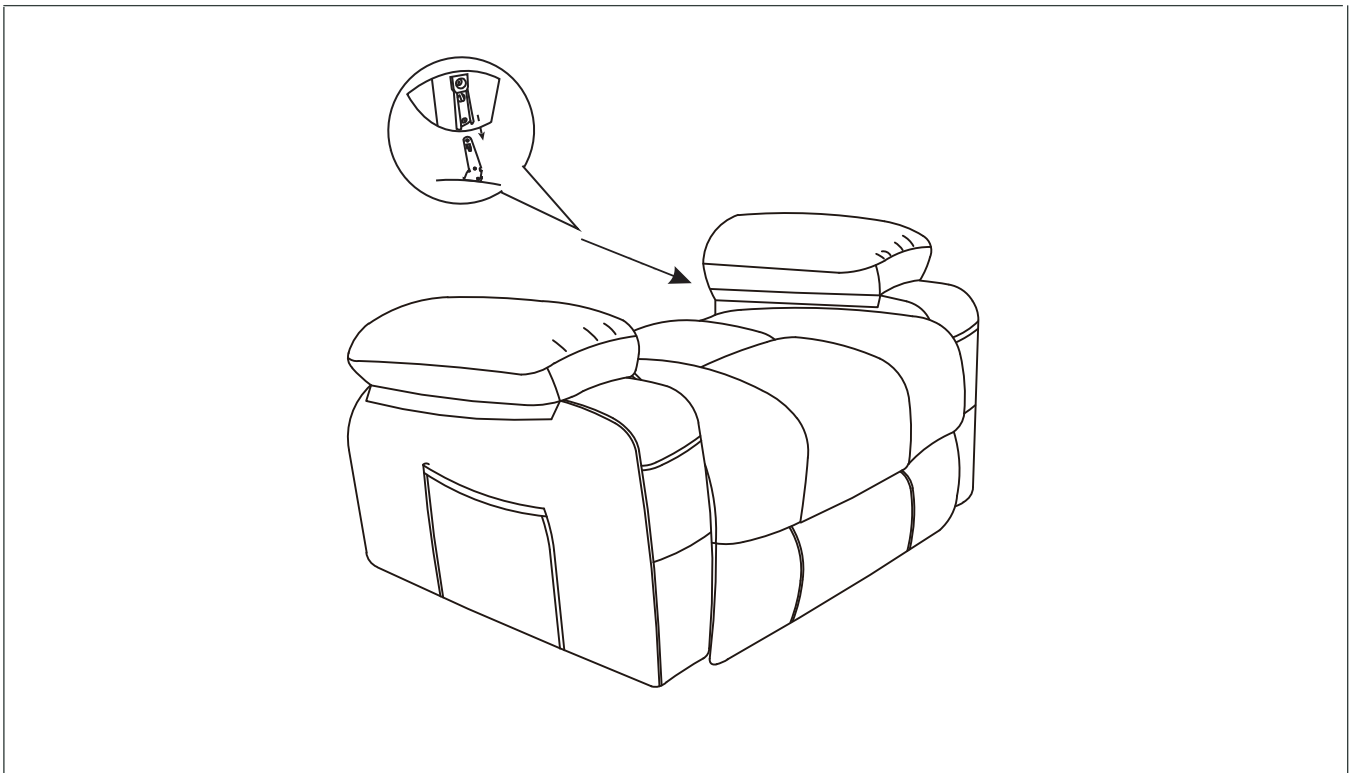

STEP7 :Zip the backpack and back frame, and then connect the backpack and back frame with velcro.

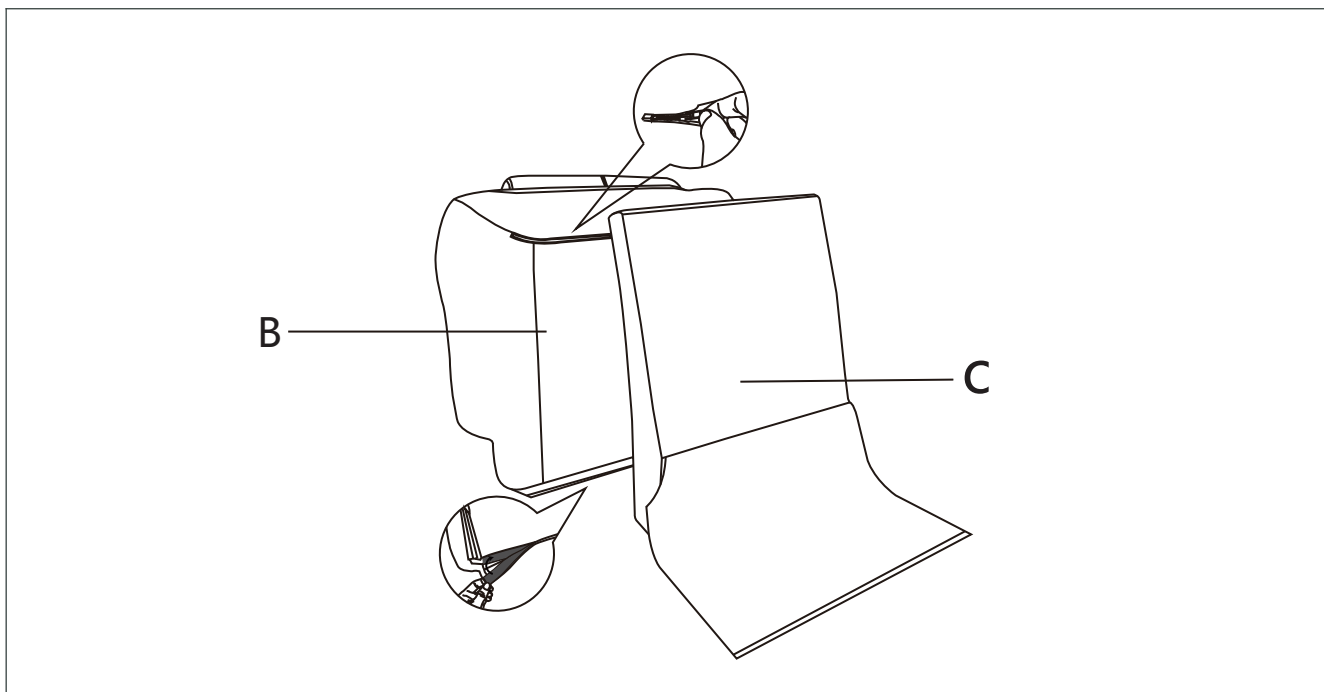

STEP 8 :Plug the back pad into the seat frame, and then connect the massager line white and white, red and red, black and power lines, and the massage line with the hand controller.



ASSEMBLY IN STRUCTION

STEP 9: Connect the controller to the motor cable and lock the latch, connect the power adapter to the motor cable and lock the latch, and then connect the power cord and the power adapter.

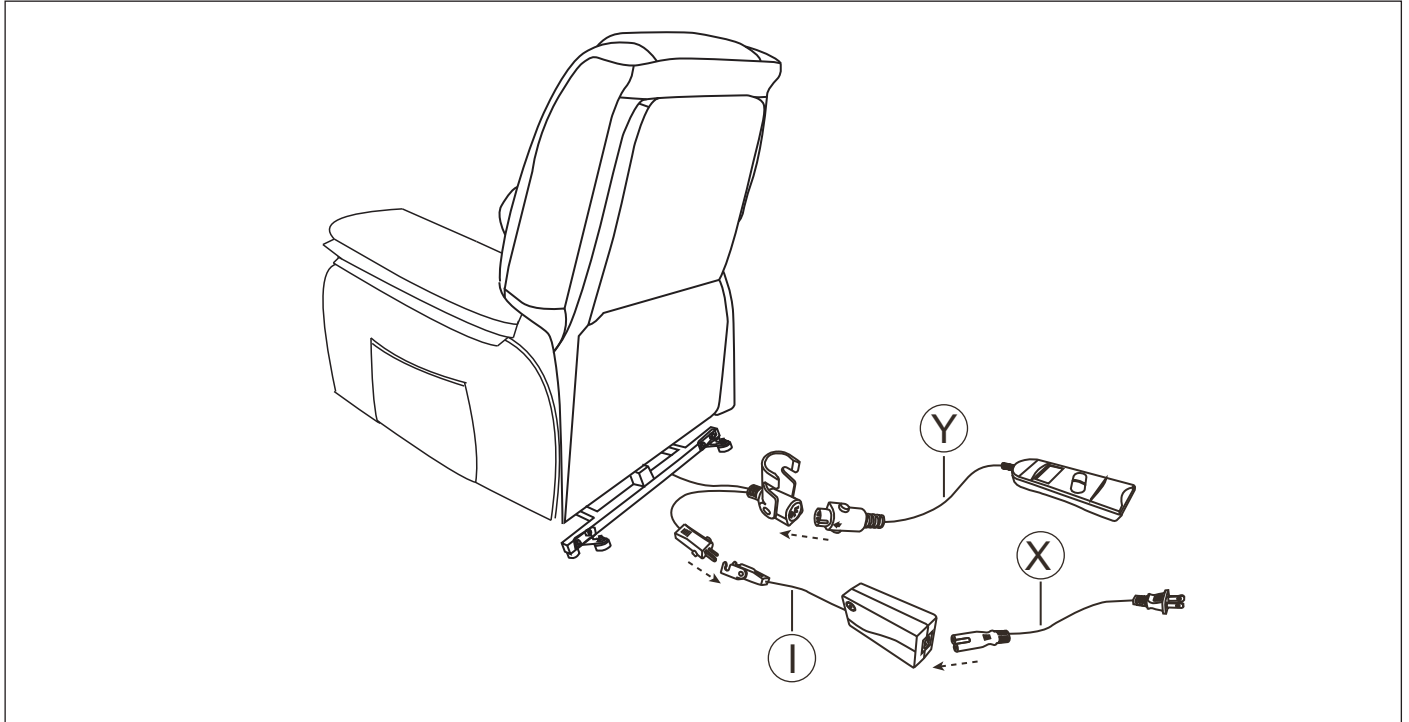

STEP 10: Stick the velcro from the back frame to the seat frame.

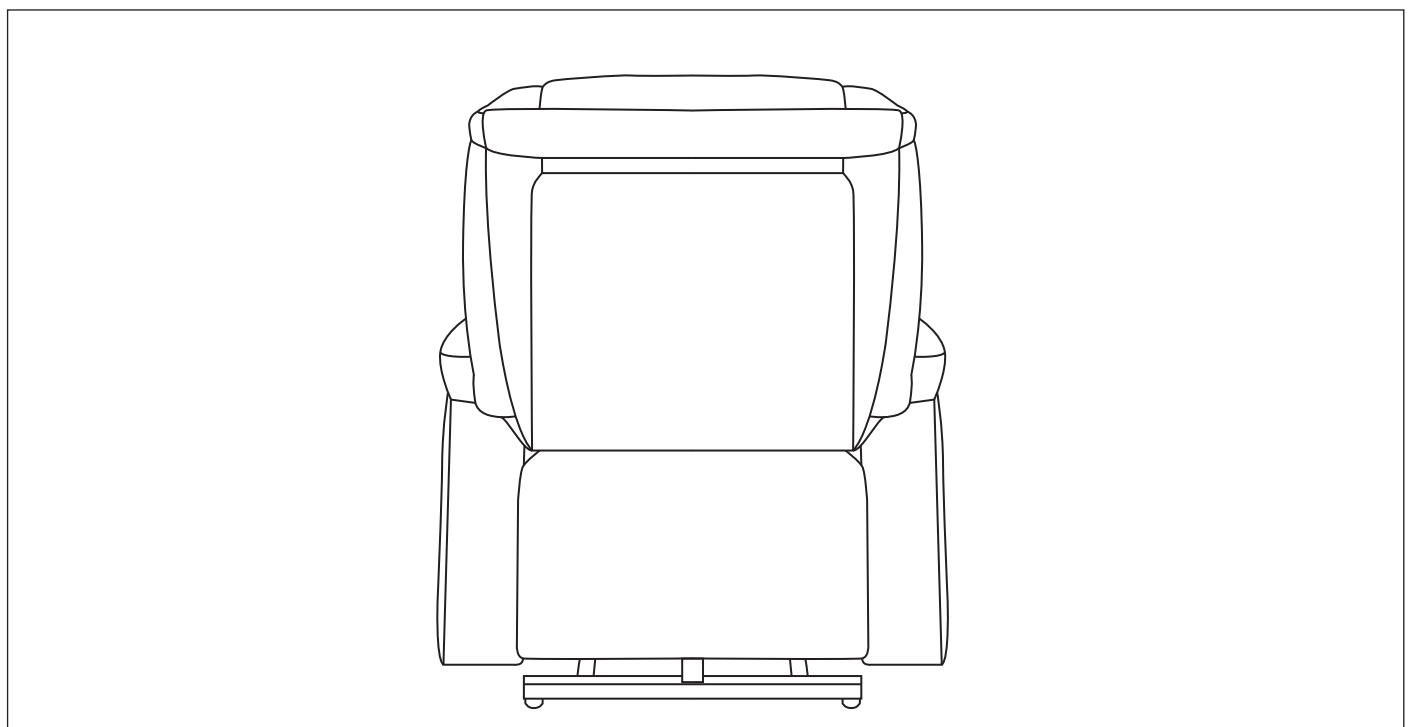

Congratulations! You've assembled Your Sofa!

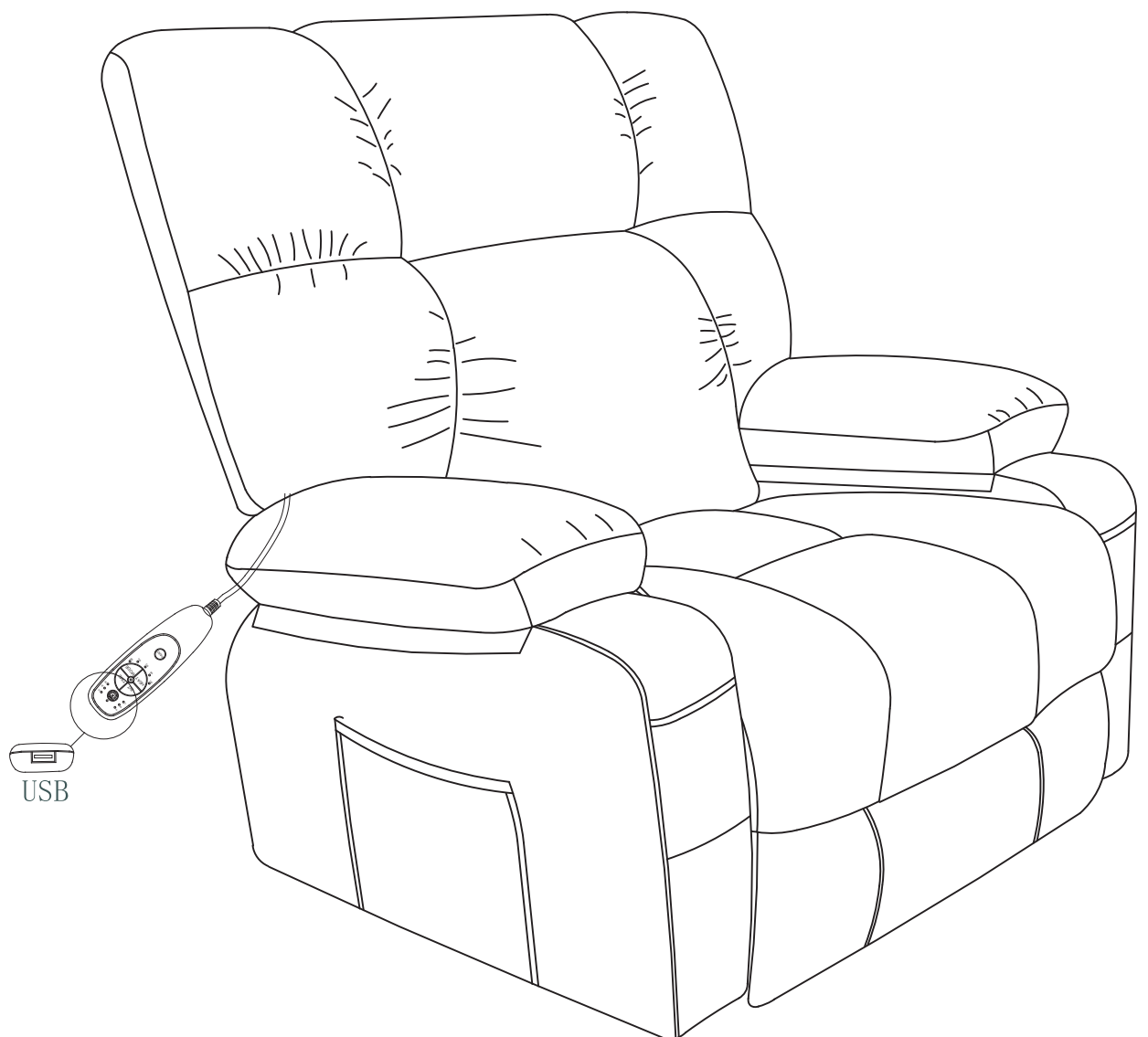

Note: Since the backrest is packed in compression, after the product is installed, you need to tap and adjust the backrest which can help restore fullness. After two days, you will get a Overstuffed Recliners as picture shows.

OPERATING INSTRUCTION

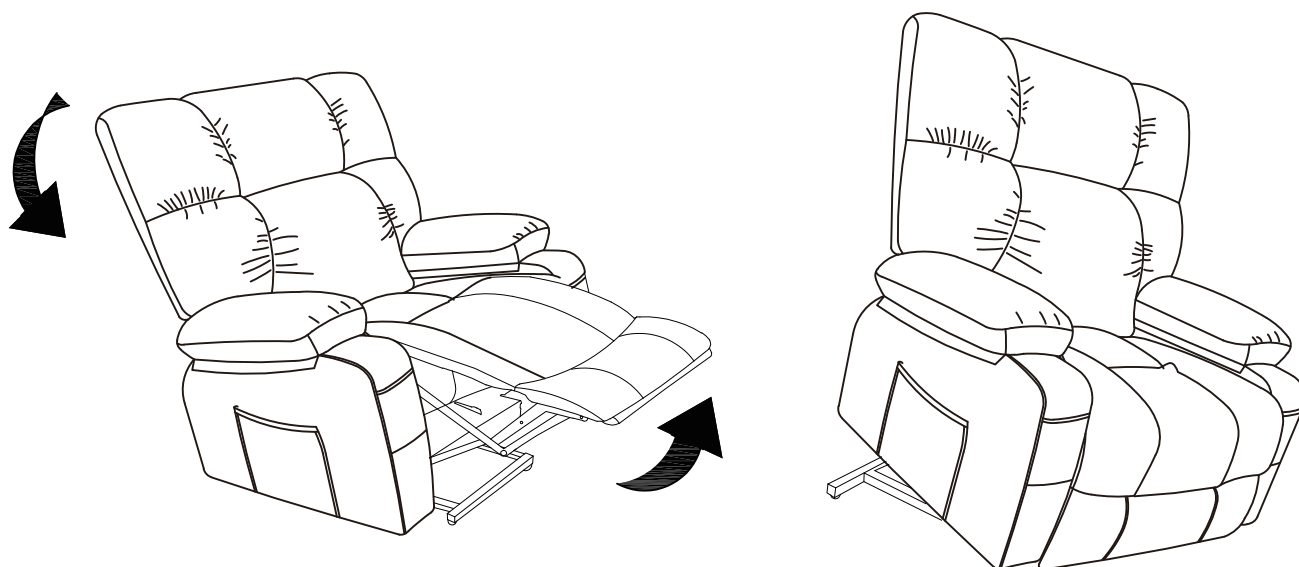

Pull the handle to spread out the SOFA

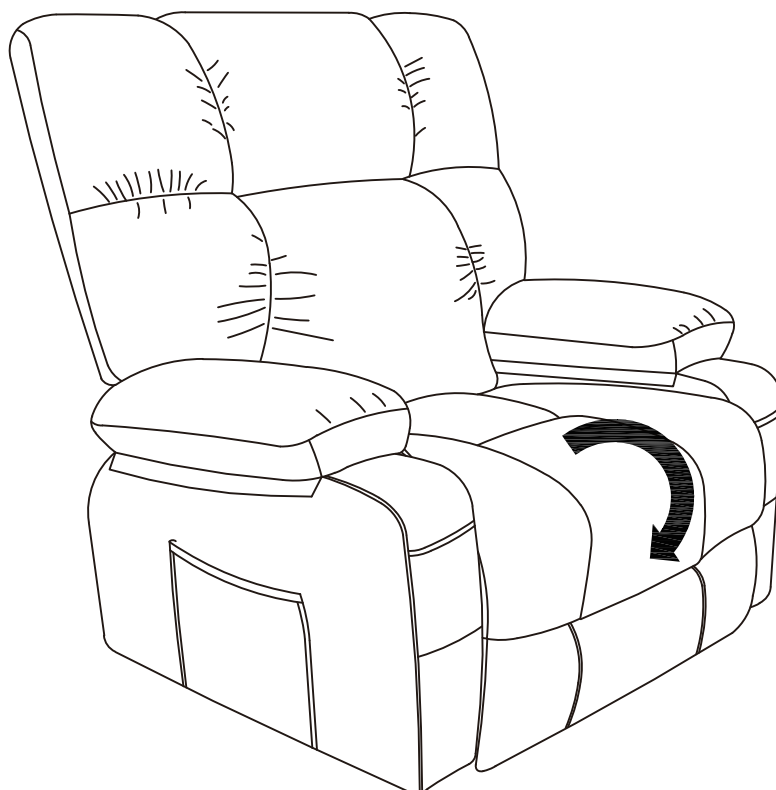

ELECTRIC LIFTING & RECLINING

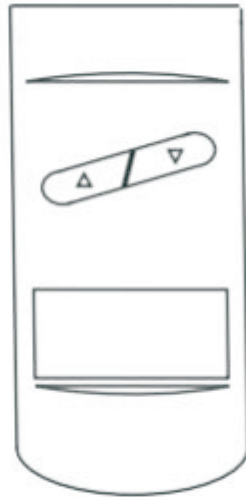

Operation Instructions

- Plug the direct current end of the cord into the AC Adapter outlet, then insert the AC adapter plug into a wall outlet for power.
- Press the button ▼ to recline the chair back and footrest.
- Press the button ▲ to return the chair back and footrest to their original position. Push the button ▲ a second time to lift the entire chair.
- Press the button ▼ to lower the chair and return it to the original position.

**READ ALL INSTRUCTIONS
BEFORE USING THE ITEM**

REMOTE CONTROL

Function of remote

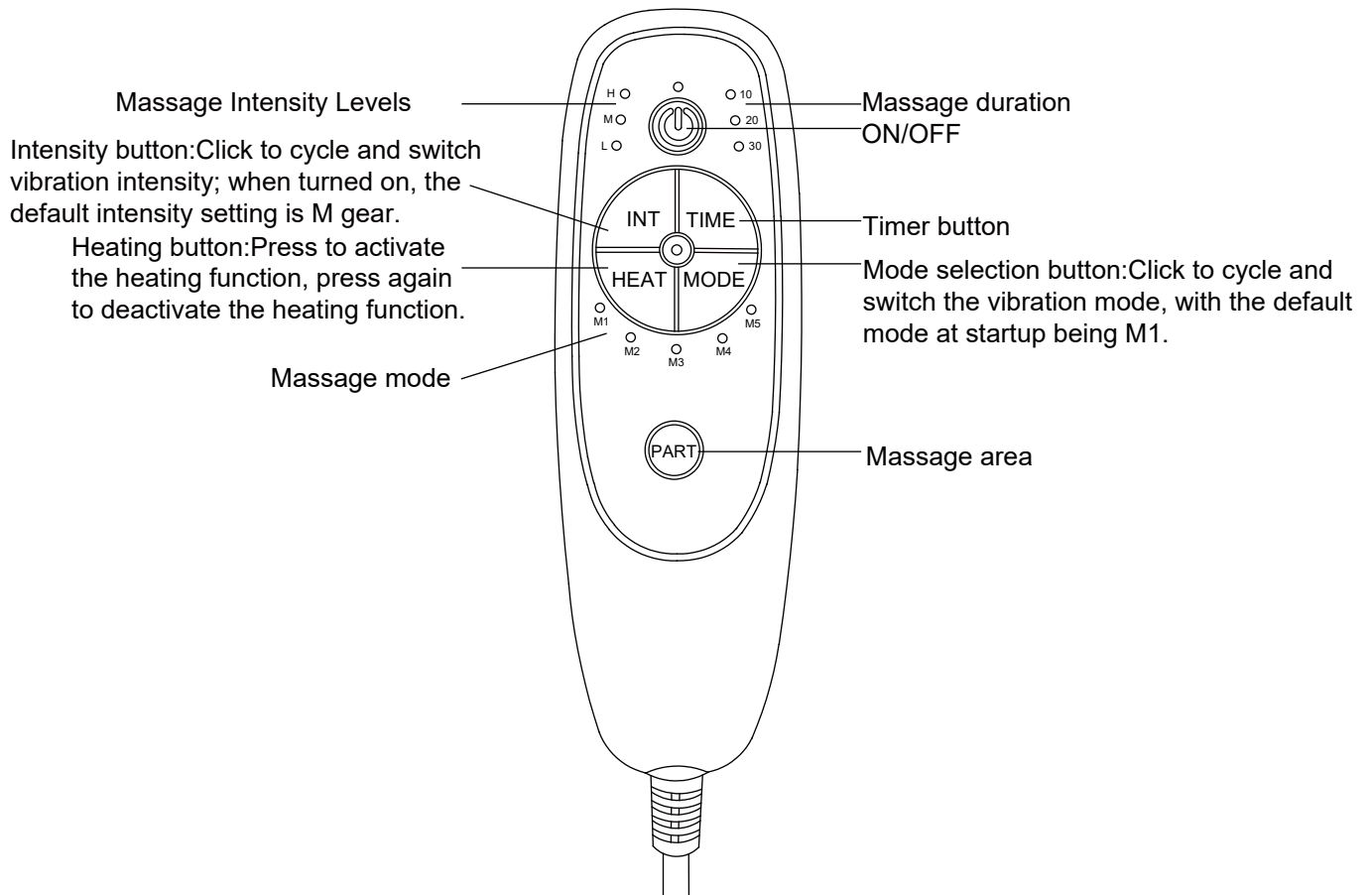
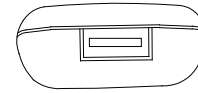

I 、 Specifications of power adapter

Connect the adapter plug to the power cord socket of the center box, and then insert the adapter into the

220V output socket. Power adapter specifications:

Input: AC 100-240VAC, 50/60Hz; Output: DC12V, 1.5A.

II 、 Product features

- 1、 4 parts 8 motor vibration
- 2、 1 heating plate
- 3、 Supports USB charging 5V 2.0A
- 4、 3-segment timed shutdown duration selection
- 5、 Selection of 3rd gear vibration intensity
- 6、 5 vibration modes selection
- 7、 Default scheduled shutdown time 10Min

III、 Function details

- 1、 Vibration on key: Click to turn on the vibration function, then click again to turn off the vibration function (cycle);
- 2、 Vibration intensity key: Press and cycle to switch vibration intensity. When turned on, the default mode is M (middle), M → H → L (cycle);
- 3、 Timed shutdown button: Press and cycle to switch the timed shutdown time. The default time for powering on is 10 minutes; 10min → 20min → 30min (cycle);
- 4、 Heating on key: Click to turn on the heating function of the heating plate, and then click again to turn off the heating function of the heating plate (cycle);
- 5、 Vibration mode key: Click on cycle to switch vibration mode. The default mode for startup is M4 M4 → M5 → M1 → M2 → M3 (cycle);
- 6、 Vibration positioning key: Click to select the vibration location.

Warnings

- Sit down in the chair gently. To avoid tipping over, do not throw yourself into the chair. Move the chair into the reclining position slowly, making sure that no children or pets are in close proximity. Do not allow children to play on or around the chair, particularly when it is in an open position.
- Close the recliner completely before getting out of it.
- Never sit on the footrest when it is open, even if it is a child.
- To eliminate the risk of tipping over, do not sit on the arms or footrest of the chair.
- This chair is designed to be used by 1 adult at a time.
- Please forbid people with the following ailments from using this sofa: Those people with severe symptoms of heart disease, high blood pressure, cerebral thrombosis and others who are sensitive to heat or completely insensitive to heat, those with brittle bones or have issues with waist support pregnant women, children and others where it has been determined they are not suitable to use this product under the guidance of doctors.
- To fully recline the sofa, ensure the sofa well, you need to put the sofa at least 19 inches away from the wall or any other obstacle.
- Product cannot touch water, fire, etc. Product can also not come in contact with sharp objects (knives, nails, etc.)

Maintenance Manual Instructions

- To avoid dropping, you should carry the sofa carefully.
- If you find dirt and or stains on the chair, spray the sofa with a sofa specific cleaner then use a sponge or cloth to wipe the dirt away. Do not use water, soapy water or cleaner with waxed wooden areas. Take care to wipe the sofa carefully and gently.
- Do not put the sofa in an area with direct sunlight and do not put the sofa directly in front of an air conditioner, this will fade the upholstery and make it brittle.

How to Disassemble

Please find a strong tool to prod the small piece of metal grooves, then the backrest will be pulled out. The tool is not included.

