



FEATURES

• PNEUMATIC SEAT HEIGHT ADJUSTMENT

To raise seat remove pressure from seat and pull lever (1) up. To lower seat, sit on chair and pull lever (1) down.

NOTE: It is normal for chair to slightly lower under body weight.

• LOCKING TILT ADJUSTMENT

For individual comfort, this chair has been equipped with an adjustment that will allow the user to change the tension of the tilting feature. Turn knob (2) clockwise to increase tension and counter-clockwise to decrease or ease the tension. To lock, return chair to the upright position and push lever (1) in. To unlock, pull lever (1) out.

NOTE: Do not loosen back tilt adjustment knob (2) completely.

• ARM HEIGHT ADJUSTMENT

To adjust arm height, pull lever (3) up to allow the arms to move up or down freely. Release the lever (3) once the desired height is reached.



WARNING

1. Do not use unless all bolts, screws, and knobs are securely tightened.
2. Check that all bolts, screws, and knobs are tight every three months or as needed.
3. Dispose of packing material properly. Do not use plastic cover as head covering as it may cause suffocation.
4. Do not use this product as a stepladder.
5. Use this product for its intended purpose only.
6. Use only mild detergent for cleaning.

OSP FURNITURE LIMITED PRODUCT WARRANTY

Design Lab Products

- 3 years on gaming desks and chairs
- Upholstery is not warranted against routine scratching and scuffing

*All warranties are limited to the original purchaser for normal commercial usage defined as a standard forty hour work week by persons weighing 250 lbs. or less. This warranty will not cover labor, freight or damage from misuse, abuse, negligence, alteration, accident, vandalism, rusting, acts of nature or any other event beyond the control of Office Star Products. The warranty does not cover cosmetic damage that may result from normal use. Liability for incidental or consequential damages is excluded. The user assumes all risk of injury resulting from use of this product. When usage is more than 40 hours per week, a two year warranty on all parts applies. Fabric and foam is warranted for one year. This warranty gives you specific legal rights, and you may also have other rights which vary from state to state.

It is the customer's responsibility to prepay freight on any components returned to the factory. Return freight on components covered by warranty will be paid by Office Star Products.

Our quality standards are among the highest in the industry. Sometimes, no matter how hard we try, there are times when parts are damaged or missing. Our Parts Department will do everything possible to promptly remedy the problem. Contact us via e-mail parts.department@officestart.net by Fax 1-909-930-5629, or toll free parts number 1-800-950-7262, Monday through Friday 8:00 a.m. - 3:30 p.m. Pacific Time.

PARTS

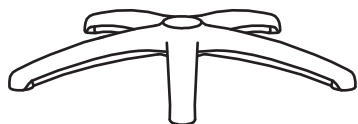

(1) Base (1 Pc)



(2) Caster (5 Pcs)



(3) Pneumatic Cylinder (1 Pc)



(4) Bellows (1 Pc)

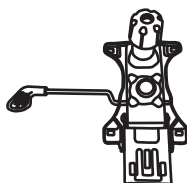

(5) Seat Plate (1 Pc)



(6) Seat Cushion (1 Pc)

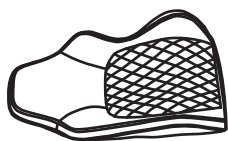

(7) Backrest (1 Pc)

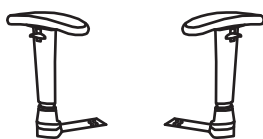

(8L & 8R) Arm (2 Pcs)



(9) Bracket (1 Pc)

HARDWARE

NO	DRAWING	DESCRIPTION	SIZE	QUANTITY
A		Allen Bolt	M8 x 25mm	12 Pcs
B		Allen Bolt	M8 x 20mm	7 Pcs
C		Washer	Ø8 x Ø18	12 Pcs
D		Allen Key	M6	1 Pc

STEP 1

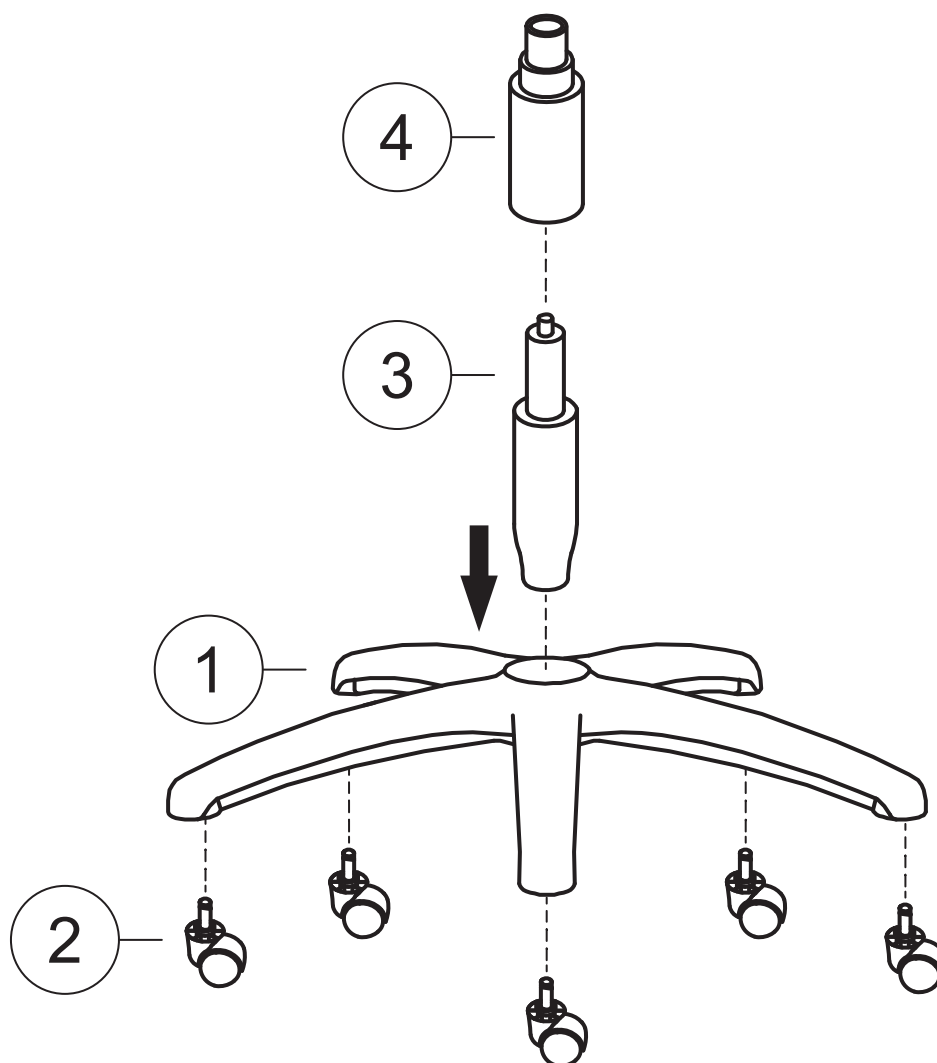

Remove all parts from carton, separate by part numbers indicated on parts list, and verify part quantities.

STEP 1 Insert five Casters (2) into Base (1). Push hard until you feel or hear the Caster (2) snap into place. Insert Pneumatic Cylinder (3) into Base (1) and slip Bellows (4) over Pneumatic Cylinder (3).

STEP 2

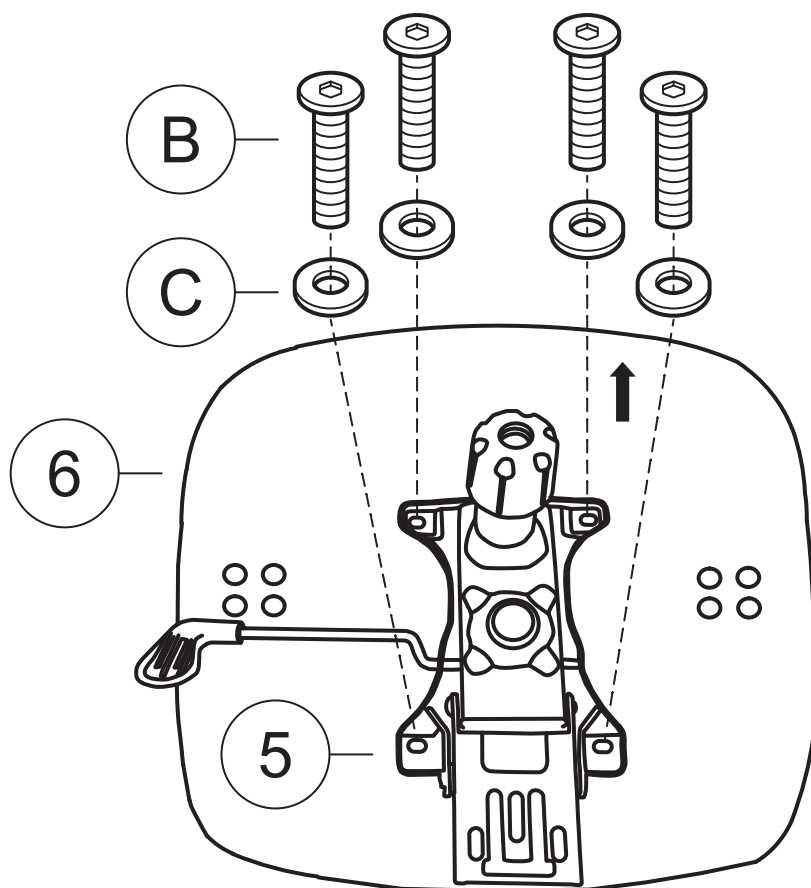

STEP 2 Attach Seat Plate (5) to Seat Cushion (6) with the arrow towards the front of the chair using four Allen Bolts (B) and four Washers (C).
FULLY TIGHTEN ALL BOLTS.

STEP 3

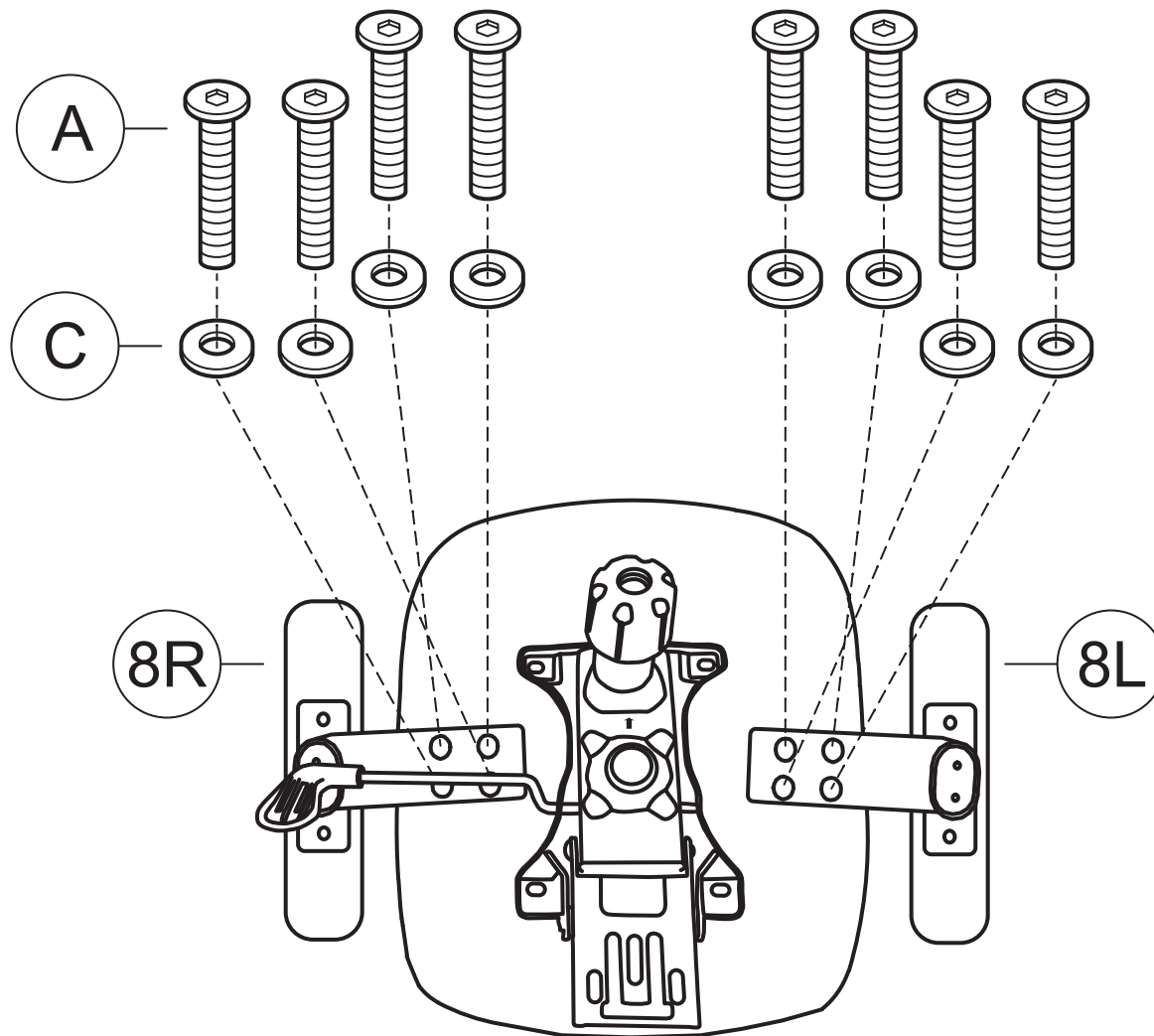

STEP 3 Attach Arms (8L & 8R) to Seat Cushion using four Allen Bolts (A) and four Washers (C) for each Arm (8). **FULLY TIGHTEN ALL BOLTS.**

STEP 4

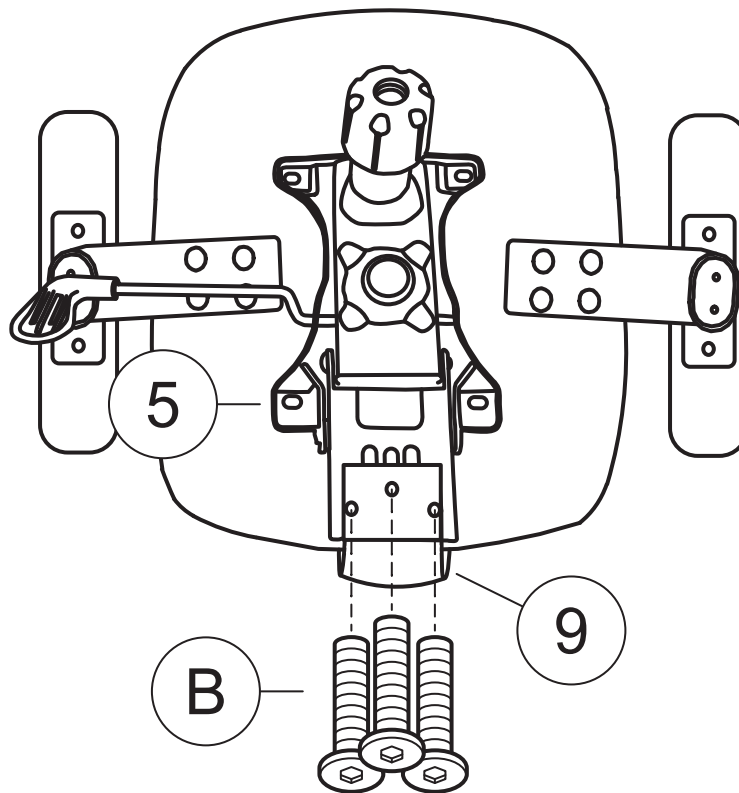

STEP 4 Attach Bracket (9) to Seat Plate (5) using three Allen Bolts (B). **FULLY TIGHTEN ALL BOLTS.**

STEP 5

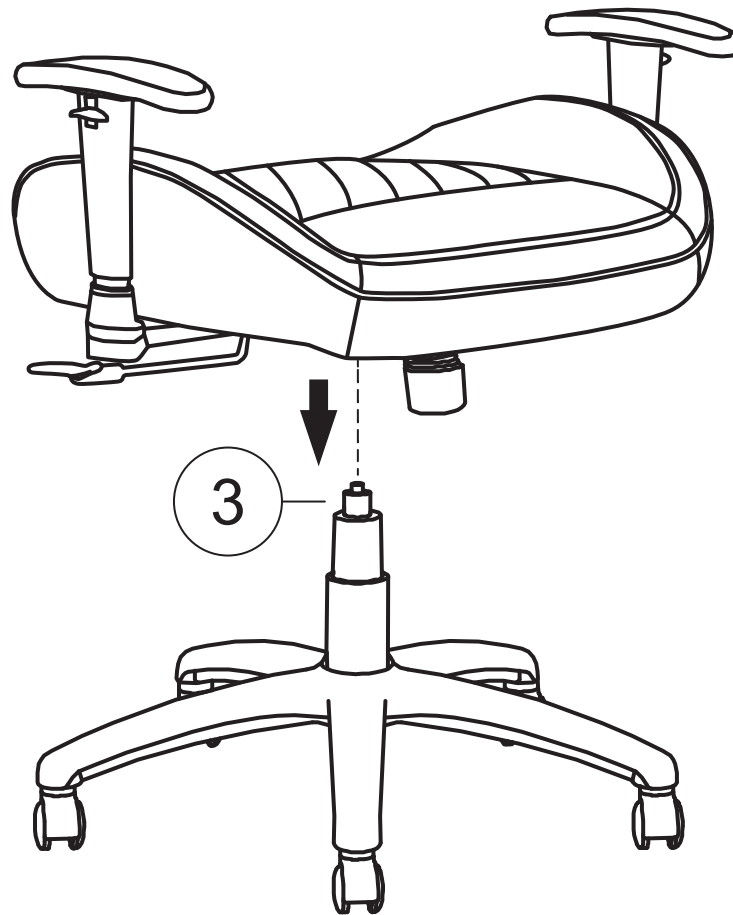

STEP 5 Place the seat on top of Pneumatic Cylinder (3) and apply downward pressure.

STEP 6

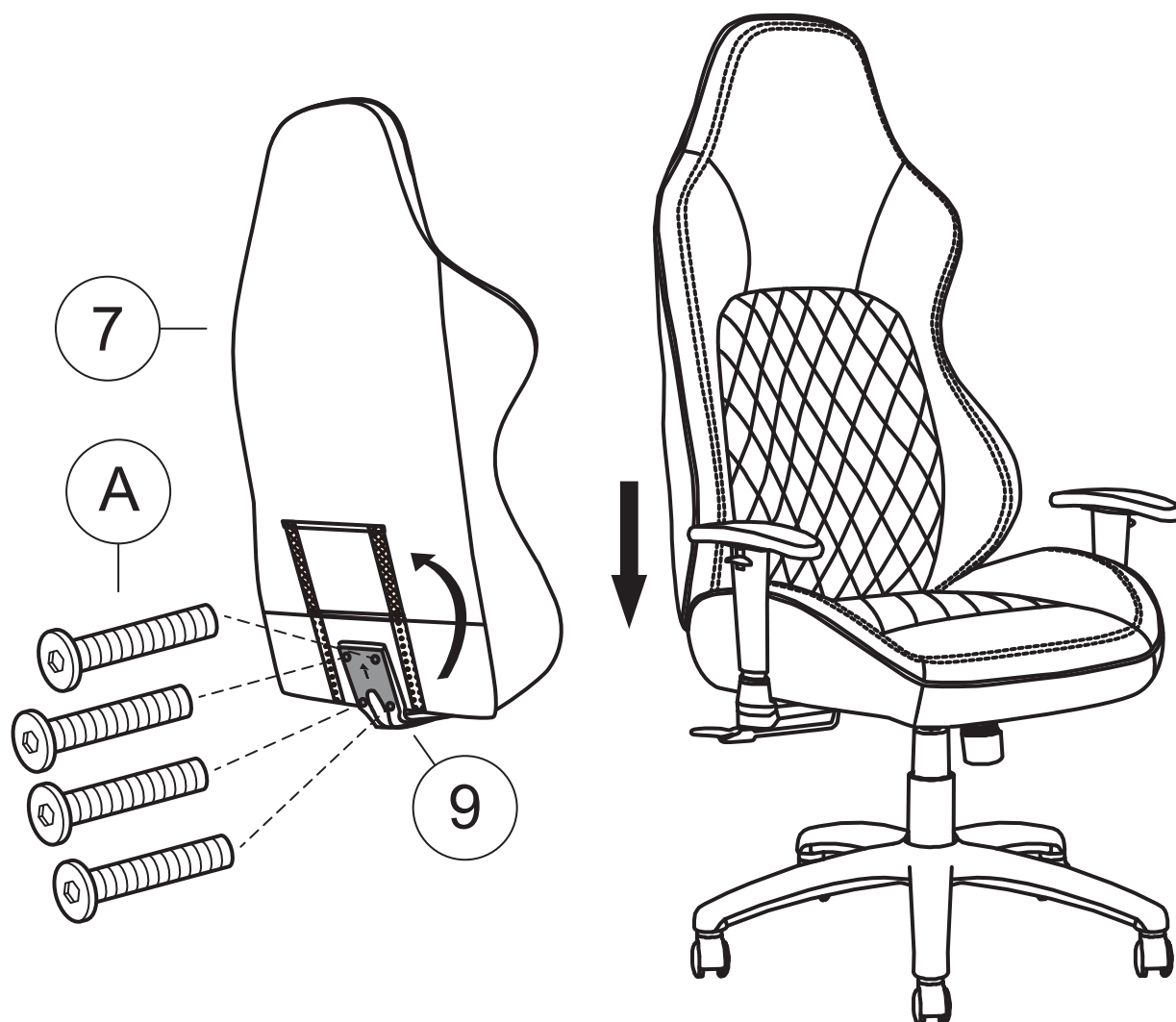

STEP 6 Place Backrest (7) onto Bracket (9) and attach using four Allen Bots (A). **FULLY TIGHTEN ALL BOLTS.**
ATTENTION: MAKE SURE ALL BOLTS ARE FULLY TIGHTENED BEFORE USING CHAIR.