

Let's build the

Paxton Storage Cabinet

SKU 72504

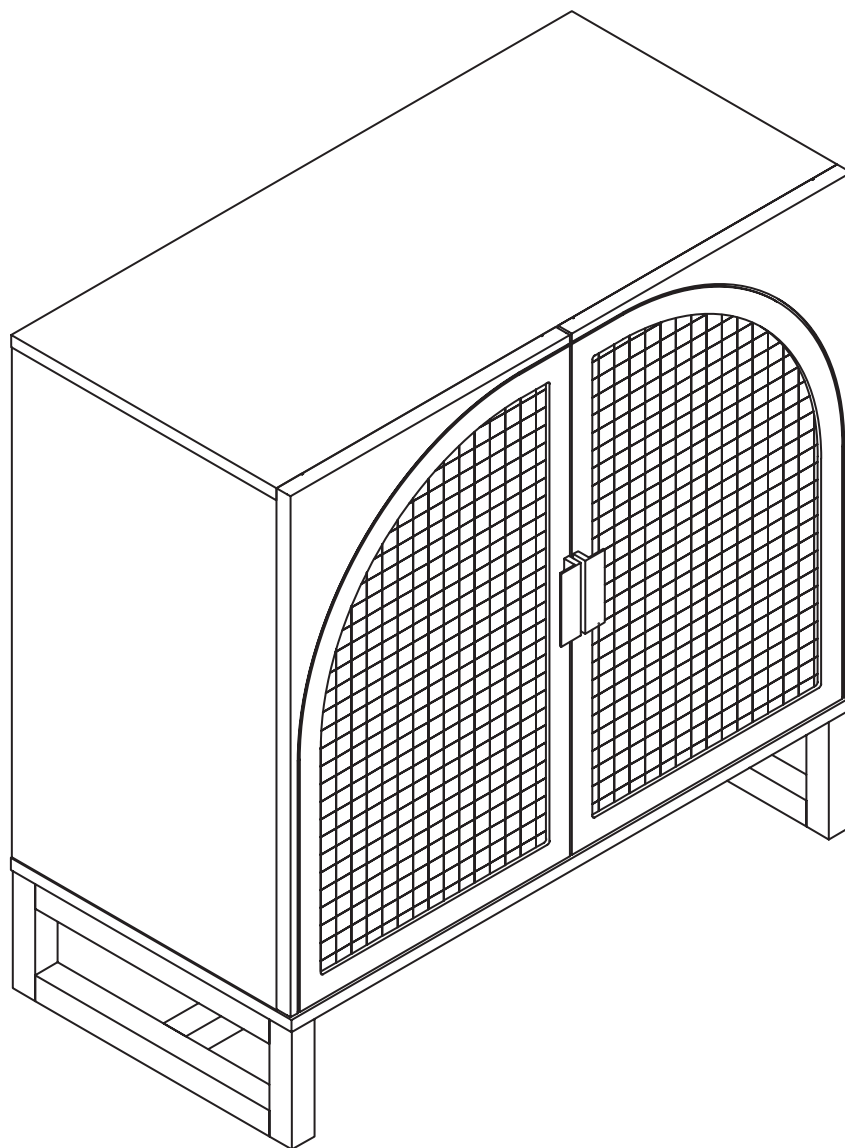

Scan me!

Free Lifetime
Warranty

nathan james

24-0306

Ok, let's get rolling

This should be easy, just follow our instructions and you will be back to Netflix in no time.

Estimated time for assembly



60:00

What you need

- Some bubbly or your preferred relaxant
- Use the packaging carton as a working surface to prevent product damage during assembly
- Phillips head screwdriver

Do not use a drill



Weight Limitation



Top Max. Capacity: 130 lbs.

Top Shelf Capacity: 30 lbs.

Lower Shelf Capacity: 50 lbs.

Toll-free at 1-866-619-1004

Help@nathanjames.com

Nathanjames.com/help

What's included

Description		Qty
A	Top Panel	1
B	Left Side Panel	1
C	Right Side Panel	1
D	Top Front Stretcher	1
E	Top Back Stretcher	1
F	Bottom Back Stretcher	1
G	Back Panel	1
H	Bottom Panel	1
I	Right Leg Frame	1
J	Left Leg Frame	1
K	Leg Frame Top Stretcher	1
L	Leg Frame Bottom Stretcher	1
M	Left Door	1
N	Right Door	1
O	Adjustable Shelf	1

Scan me!

Free Lifetime
Warranty

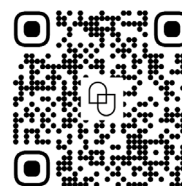

The goods

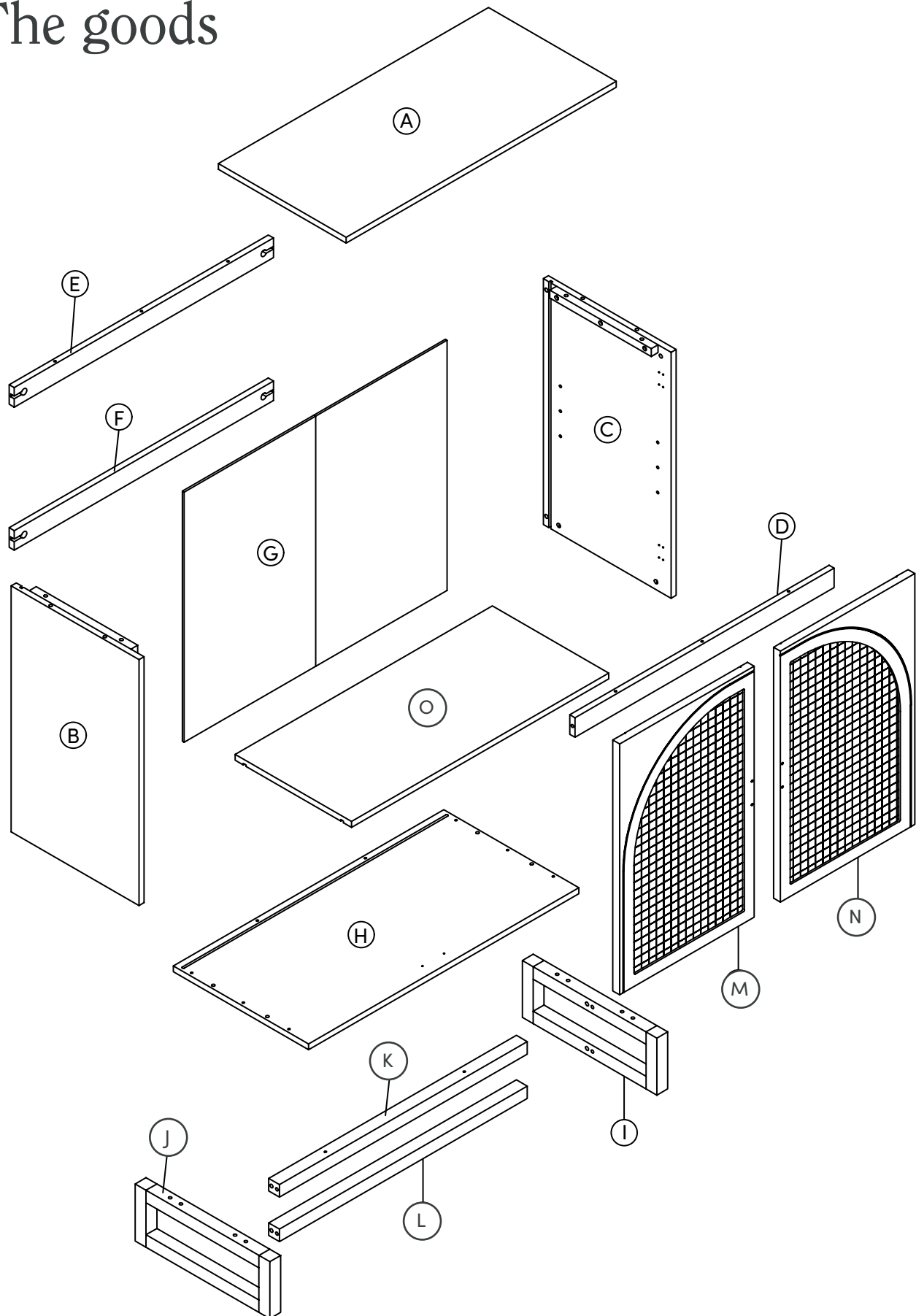

What's included

	Description	Qty
1	M6*35mm Cam Bolt	6
2	1/4"*32mm Hex Button Head Bolt	4
3	1/4"*13mm Flat Washer	10
4	Allen key	1
5	M8*30mm Wooden Dowel	16
6	15*10mm Cam Lock	6
7	M4*40mm Screw	14
8	M3*15mm Screw	4
9	Magnetic Catch	2
10	Wall Anchor	2
11	1/4"* 55mm Hex Button Head Bolt	4
12	1/4"*38mm Hex Button Head Bolt	6
13	Crescent Spacer	4
14	Hinge	4
15	M4*14mm Screw	24
16	5/32"*25mm Hex Button Head Bolt	4
17	Handle	2
18	Shelf Pin	4
19	M3.5*15mm Screw	2
20	Plastic Bracket (for Anti-Tip)	2
21	Plastic Tether (for Anti-Tip)	1
22	M4*40mm Screw	2

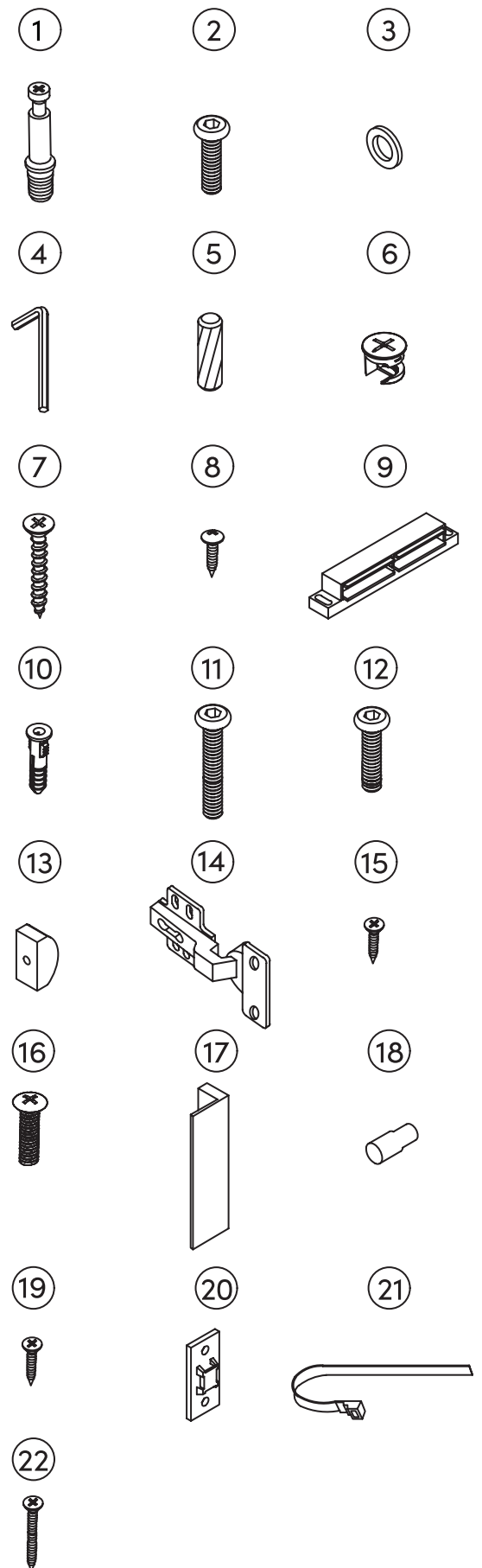

Step 1

Let's get this thing fired up! Lay down packaging carton or use carpet as a working surface.

Start by tightening the Cam Bolts into the Right Side Panel (C) and Left Side Panel (B) using a screwdriver.

1



x6

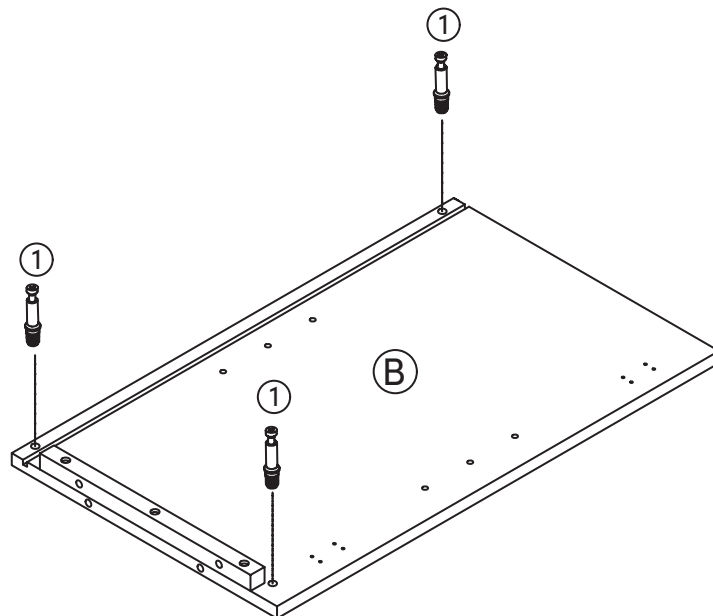
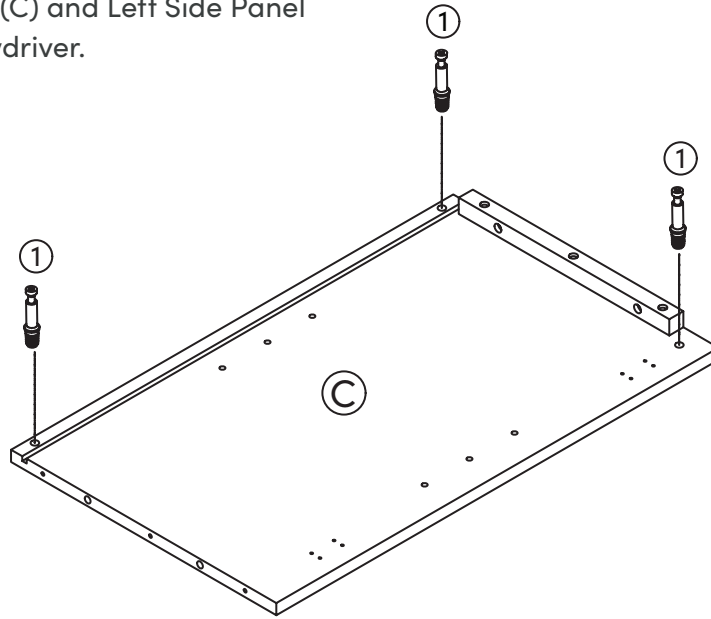

Step 2

Put the Wooden Dowels (5) into the Top Panel (A). Next, attach the Right Side Panel (C) and Left Side Panel (B) to the Top Panel by sliding a Flat Washer (3) onto a Hex Button Head Bolt (2), then use the Allen key to tighten. Repeat this process four times as shown below.

Don't go Hulk-smash on the tightening just yet, aim for a gentle 75%.

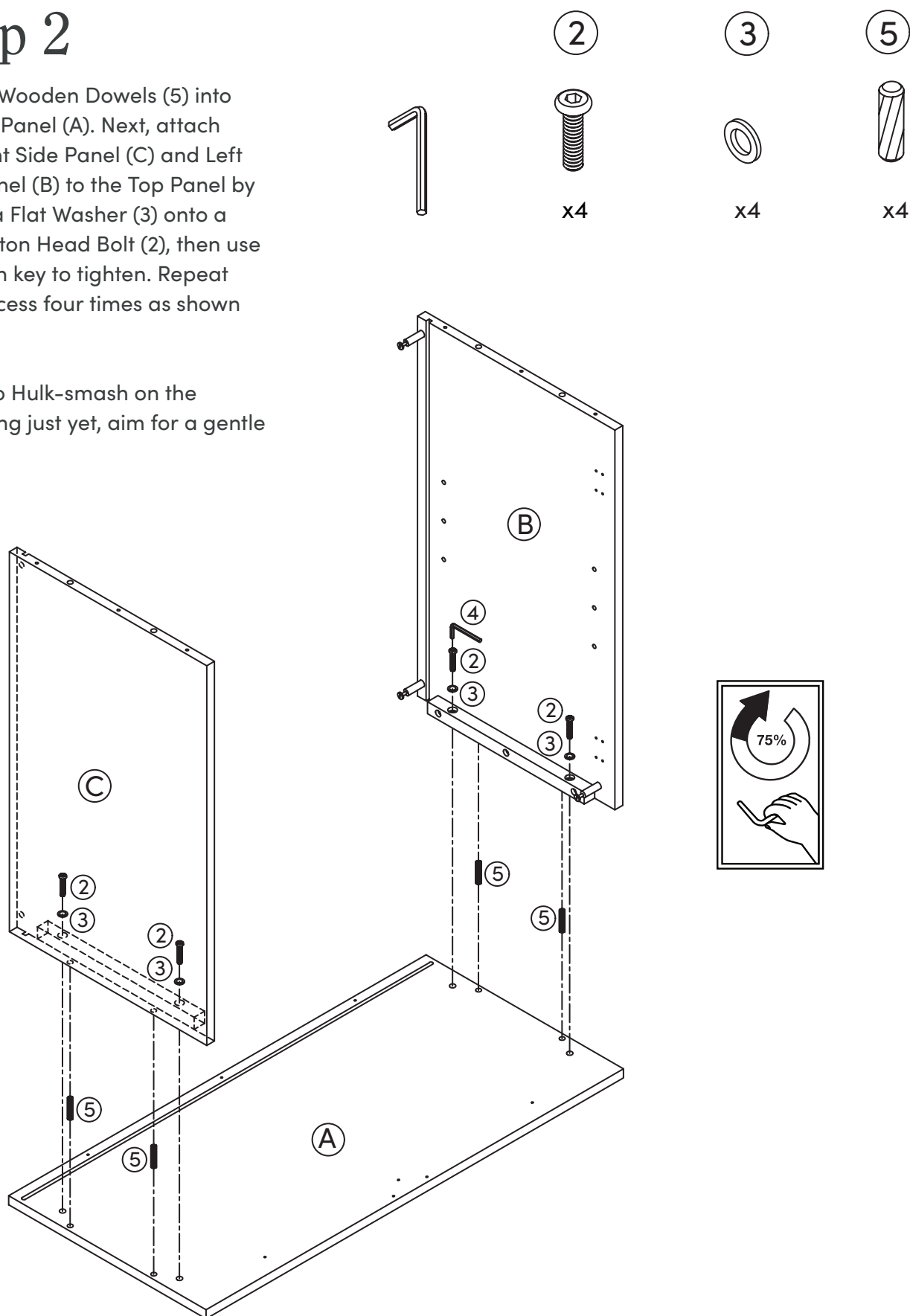

Step 3

It's cam lock time! Insert the Cam Locks (6) into the Top Back Stretcher (E) and Top Front Stretcher (D) and tighten with a screwdriver, as pictured below.

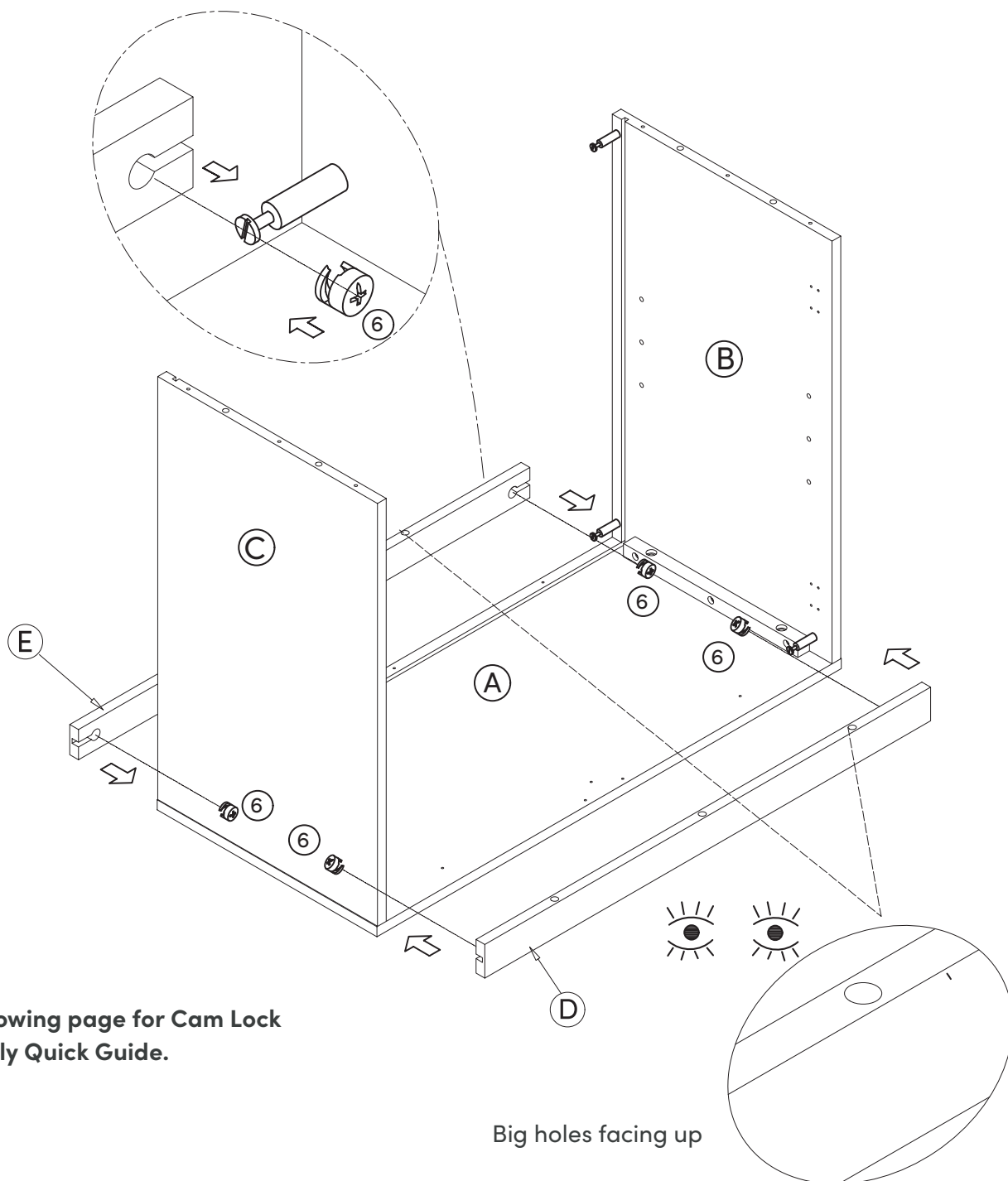
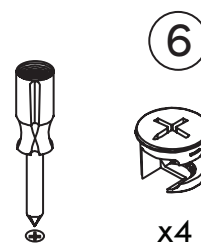

See following page for Cam Lock Assembly Quick Guide.

How to use cam locks

Did you know?

Cam locks are used to join two panels together, usually the edge of one to the flat side of another.

First, your cam bolt (or cam pin) will need to be properly inserted into the flat side of the board.

Important Note: Only tighten the cam bolt until it is secure. Do not over-tighten.

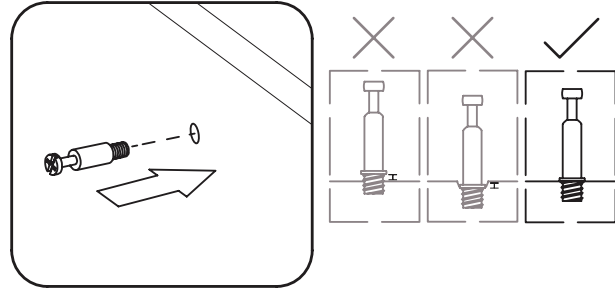

Next, you will fit the proper hole on the edge of the associated joining panel over the cam bolt.

Important Note: When installed properly, the head of the cam bolt will be visible through the larger hole on the side of the joining panel.

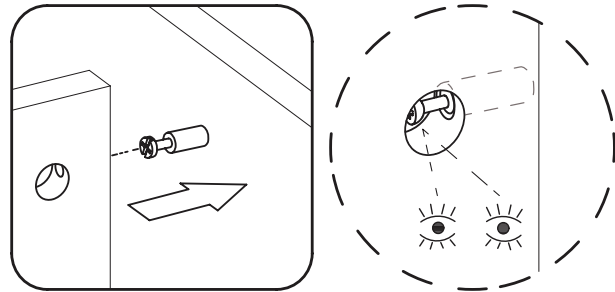

Next, you will notice the cam lock has a “C” shaped back. Commonly, an arrow on the front of the cam lock points in the same direction as the open section on back.

Using these as your cue, insert the cam lock into the large hole so the opening of the “C” fits over the head of the cam bolt.

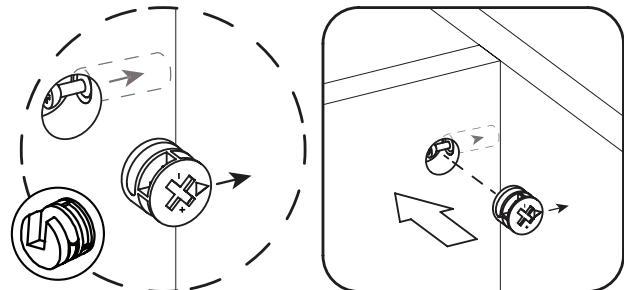

Using a screwdriver, you will turn the cam lock until it stops, usually between 130° or 180°. You will feel the panels pulling closer until they are secured.

Important Note: Only turn the cam lock until the panels are fully engaged & feel secure. Turning too far may lead to hardware failure.

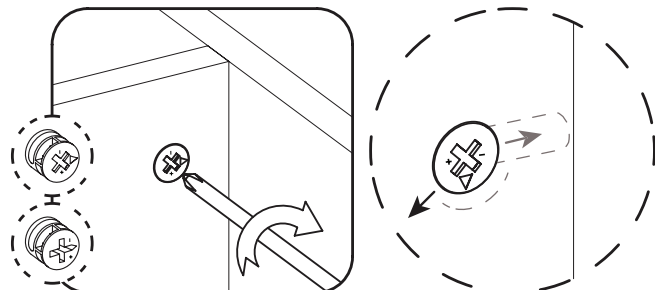

Still having issues?

If a cam lock seems to be spinning in place or is not “catching” or pulling the panels together as expected, first remove the cam lock & try again while making sure that everything is properly positioned & oriented .

If you are still having issues getting things work ing as expected, first remove the cam lock then unscrew the cam bolt slightly (less than 1 complete turn) to see if that helps with the alignment of the cam lock & bolt.

Step 4

Secure the stretchers with six M4*40mm Screws (7) and a screwdriver.



7



x6

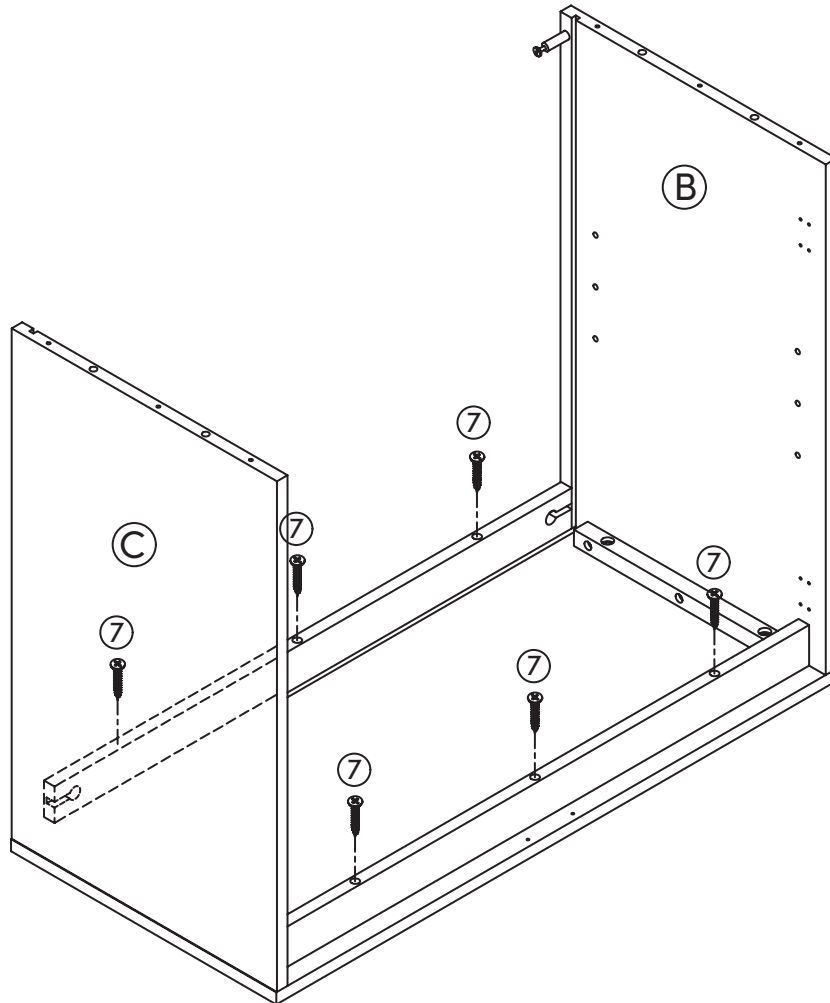

Step 5

Next, attach the Magnetic Catch (9) to the Top Front Stretcher (D) with two M3*15mm Screws (8).



8



x2

9

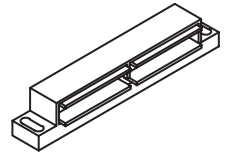

x1

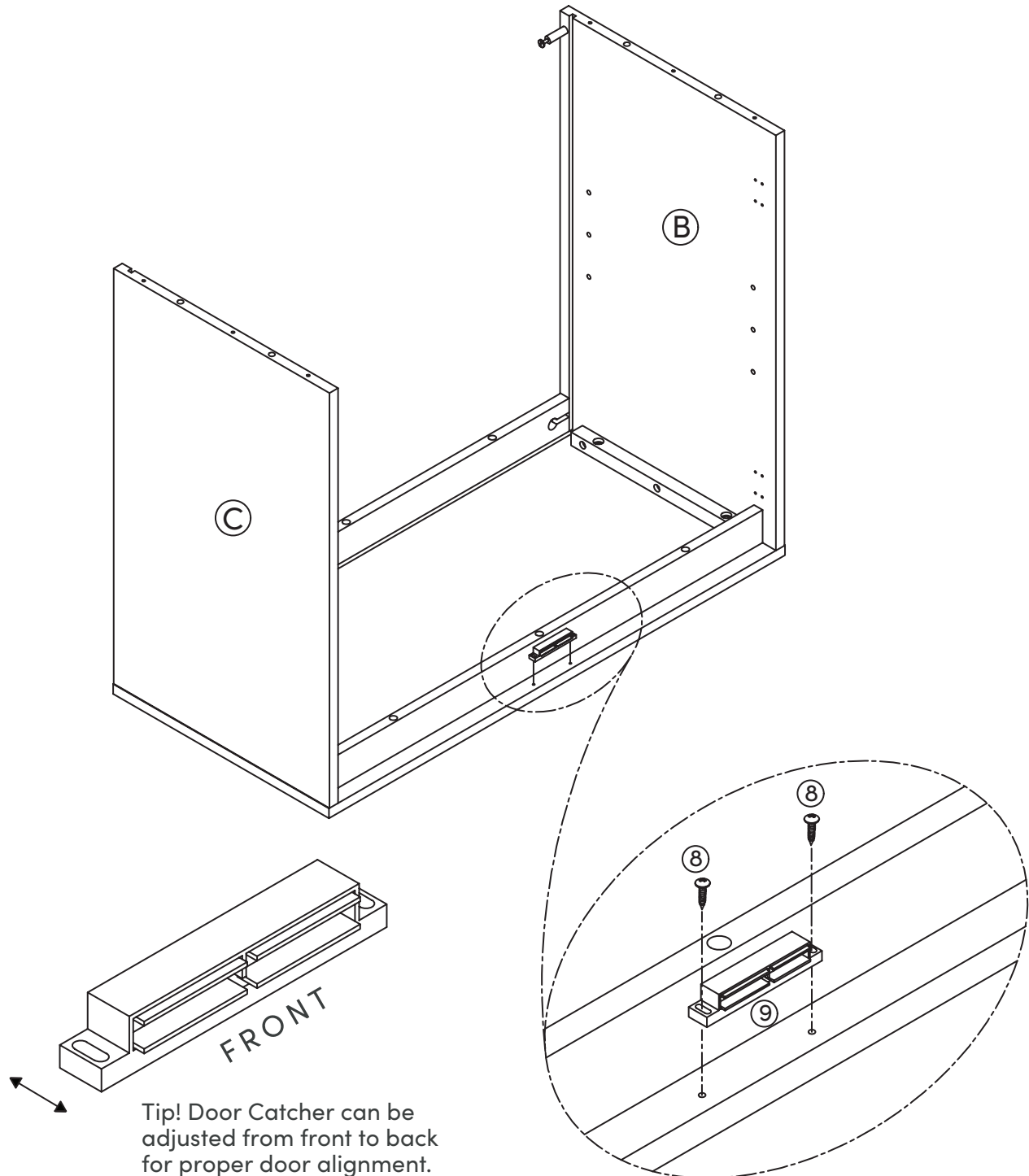

Step 6

We meet again, Cam Locks! With the small holes facing up, secure the Bottom Back Stretcher (F) to the Side Panels using the Cam Locks (6).



Small holes facing up

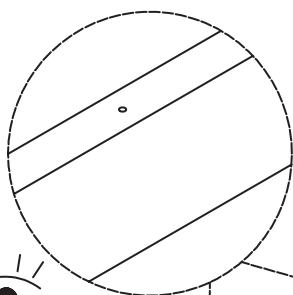

(F)

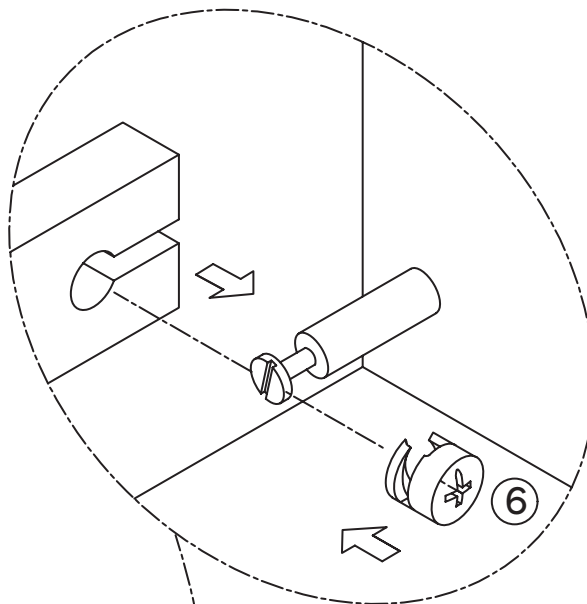
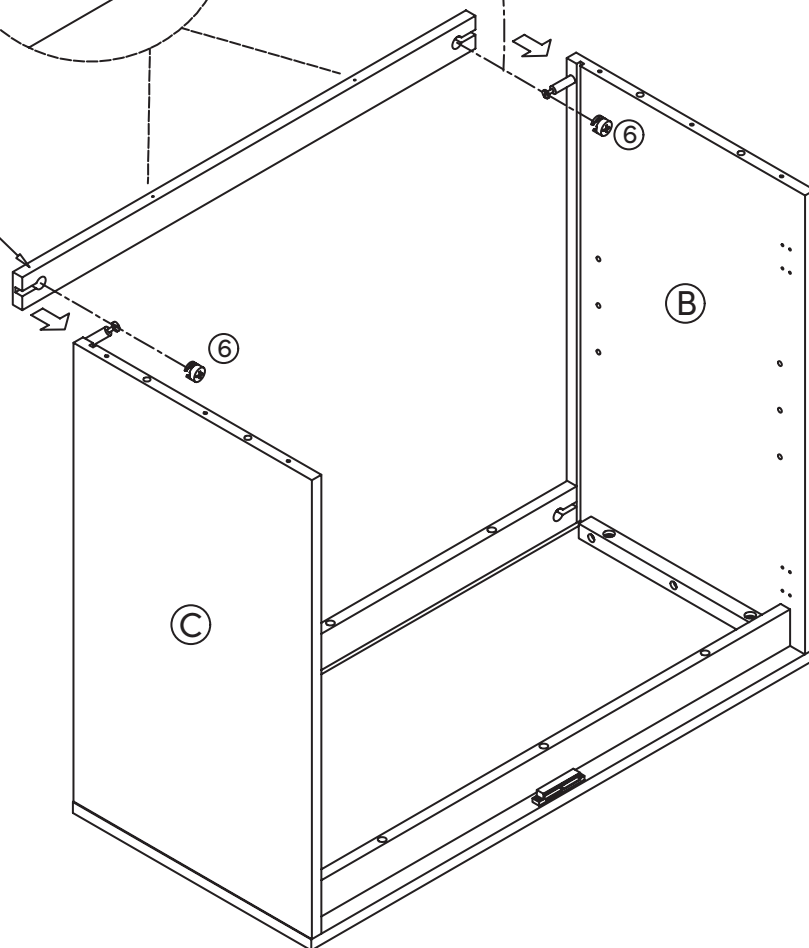

Refer to Page 8 for a how-to Cam Lock refresher!

6



x2

Step 7

Cha-cha slide in the Back Panel (G).

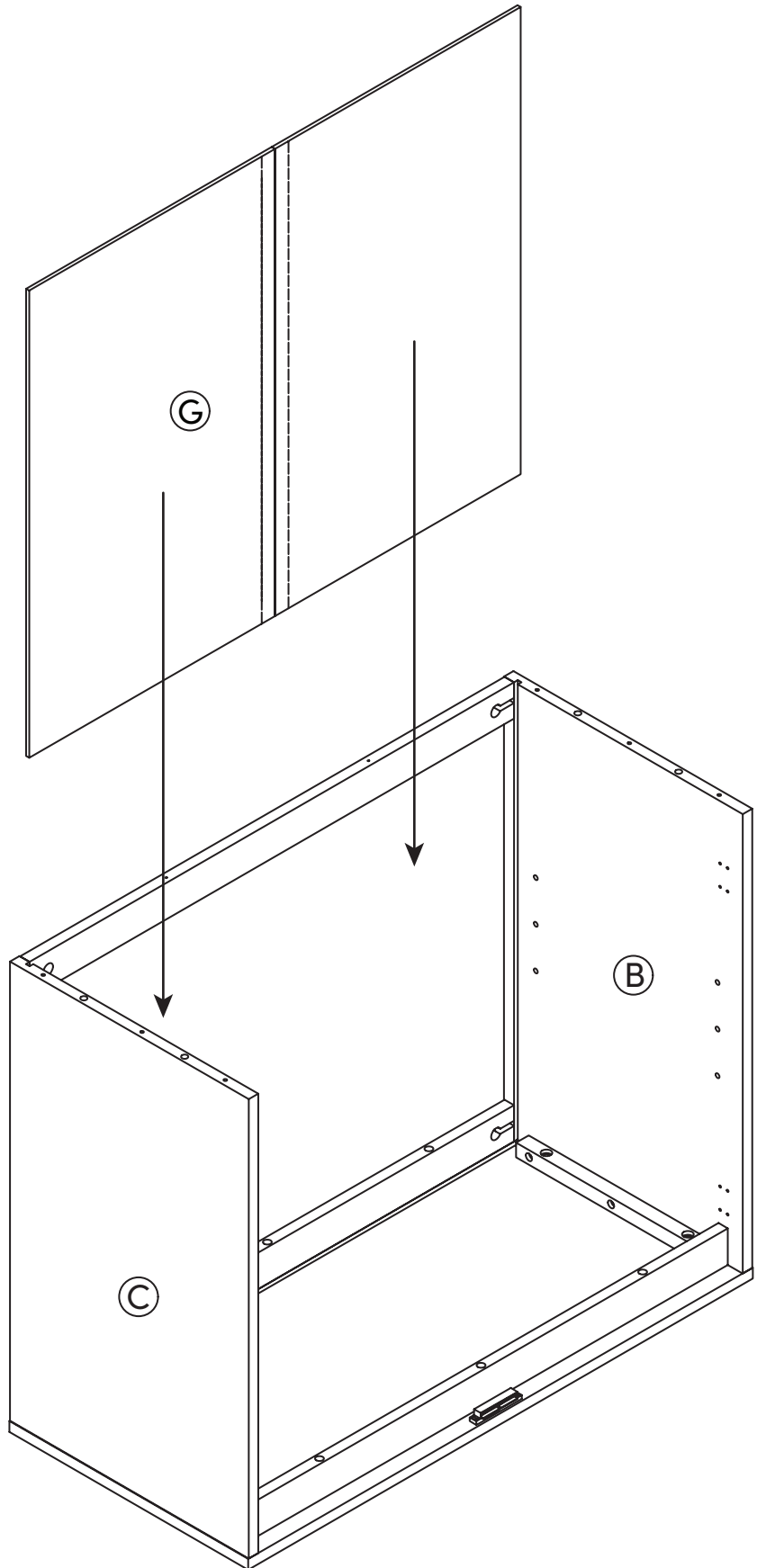

Step 8

Bottoms up! Secure the Bottom Panel (H) to the unit using four Wooden Dowels (5) and eight M4*40mm Screws (7).

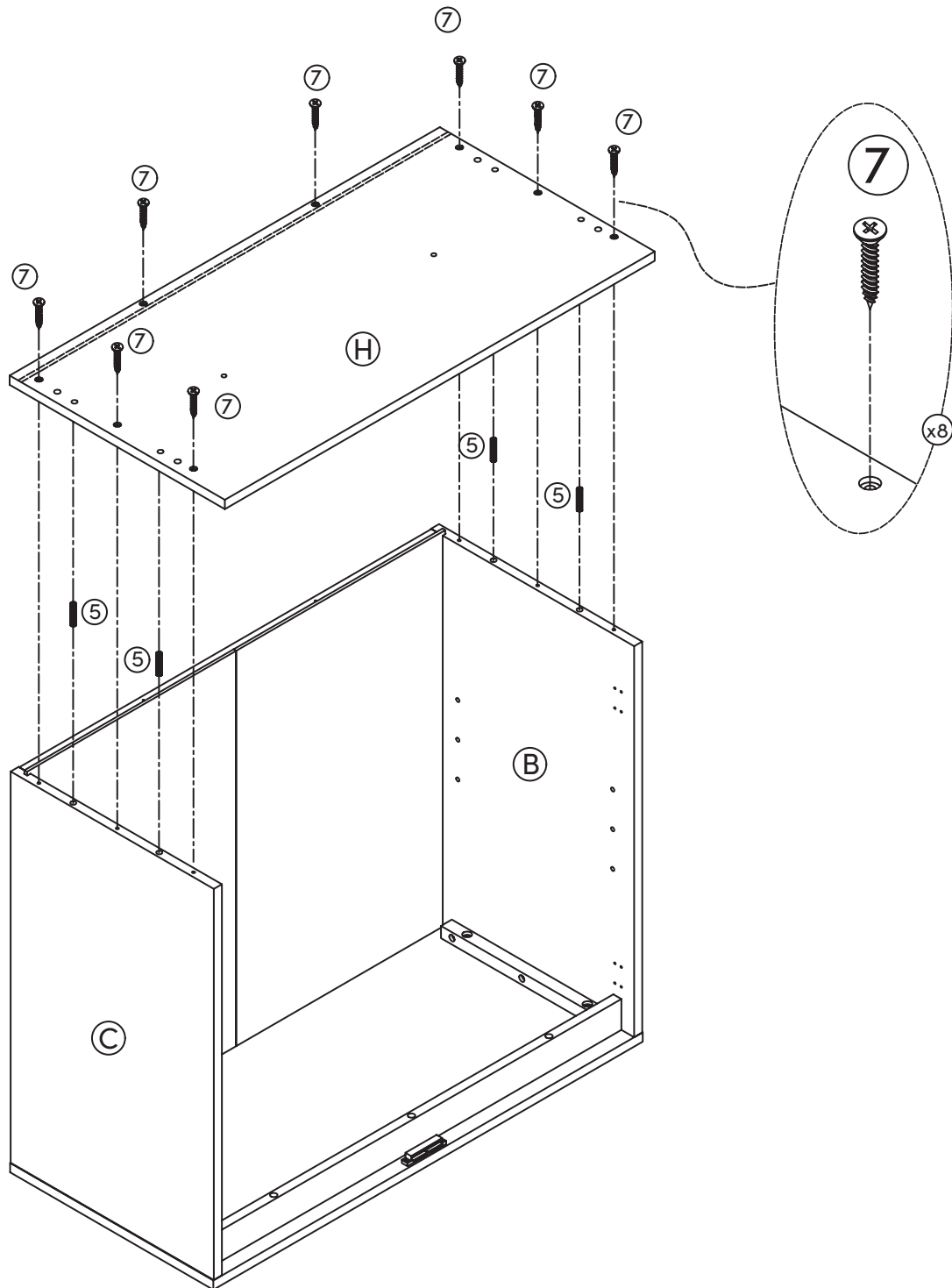

Step 9

You're halfway there! Attach the Right Leg Frame (J) and Left Leg Frame (I) to the Stretchers (K) (L) using four Wooden Dowels (5) inserted into the pre-drilled holes. Secure them in place with four sets of 1/4" * 55mm Hex Button Head Bolts (11) passed through Crescent Spacers (13), then tighten.



5



x4

11



x4

13



x4

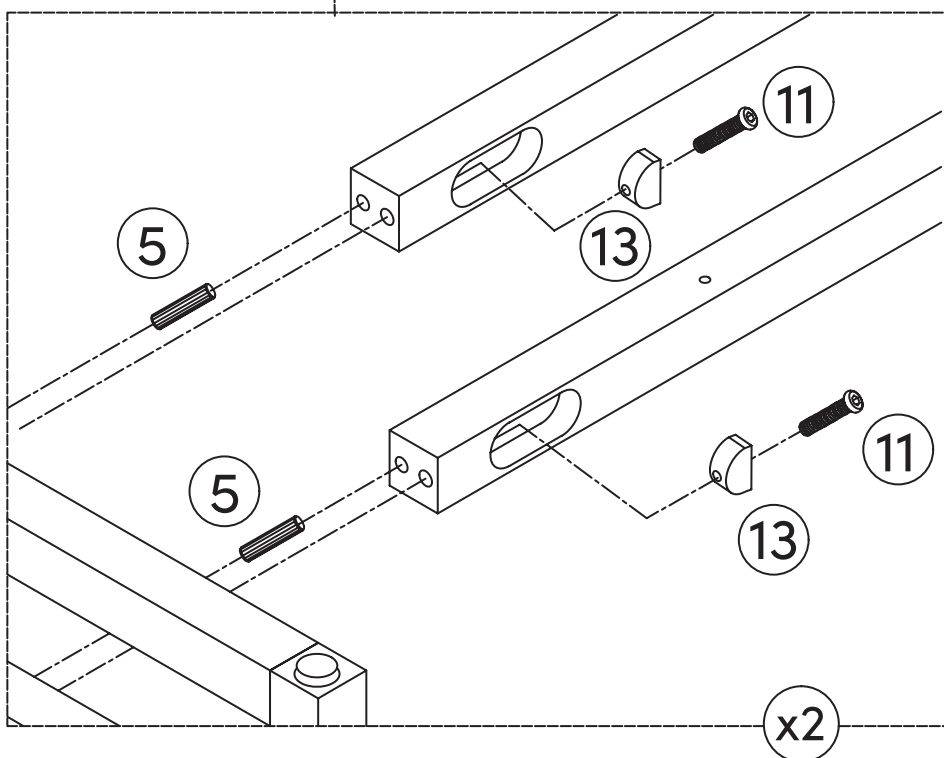
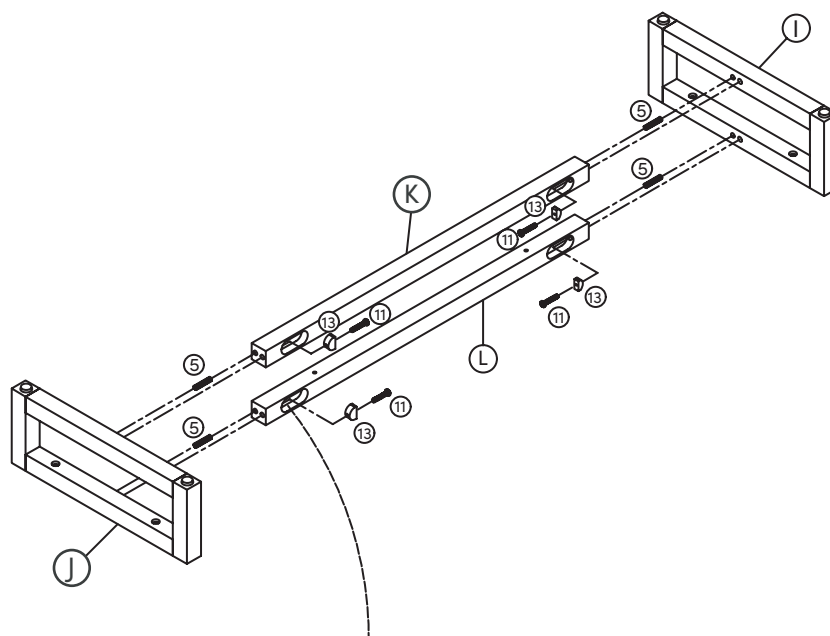
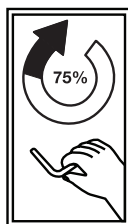

Step 10

Put the Wooden Dowels (5) into the Bottom Panel (H). To secure the leg frame from Step 9 to the unit, slide a 1/4"×13mm Flat Washer (3) onto a Hex Button Head Bolt (12), then use the Allen key to tighten in the spots shown below. Repeat this process six times.



3



x6

5



x4

12

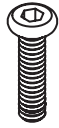

x6

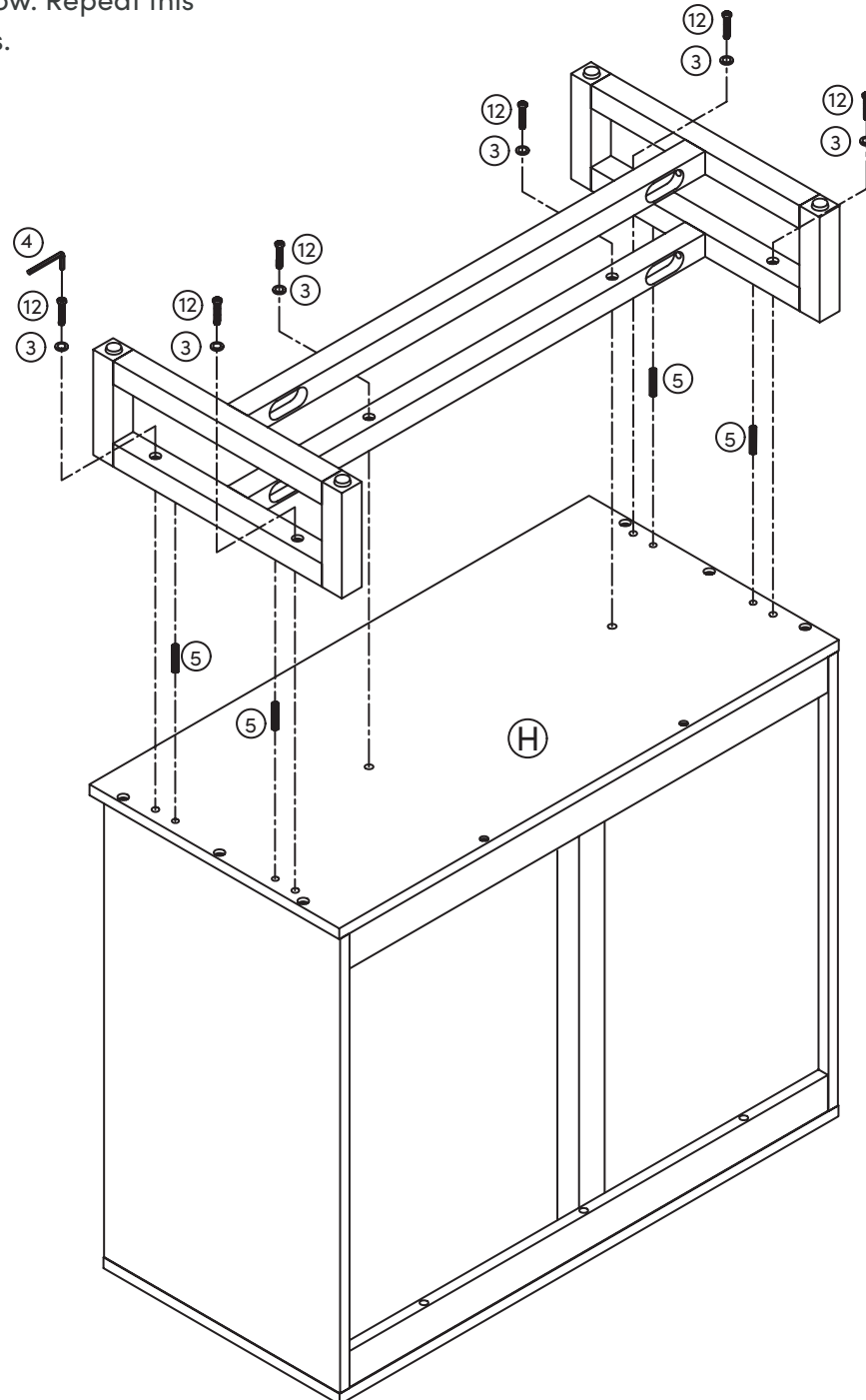

Step 11

Carefully flip the unit over and secure the Magnetic Catch to the inside bottom of the unit using two M3*15mm Screws (8).



8



x2

9

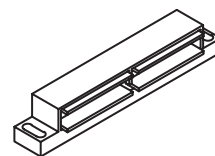

x1

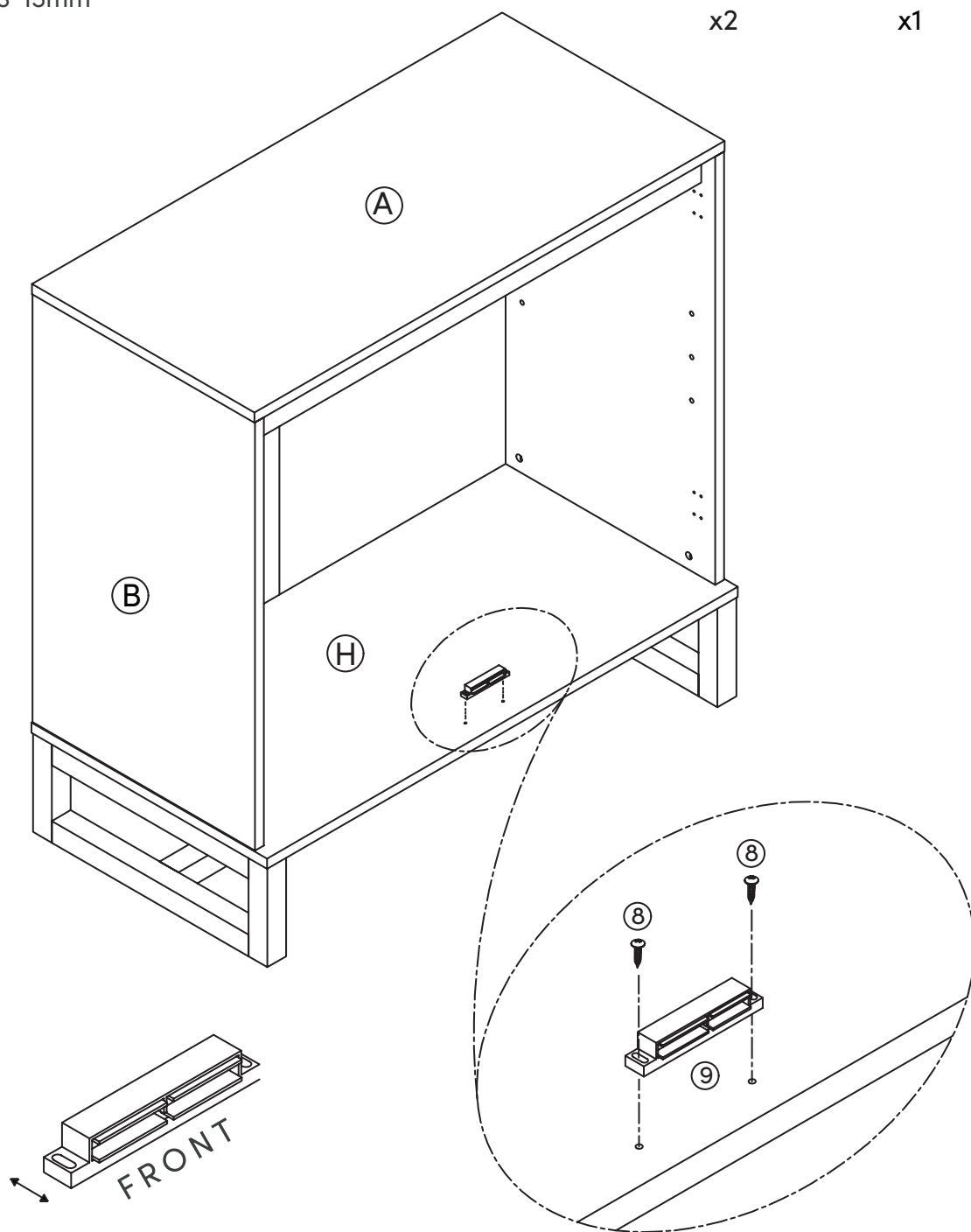

Tip! Door Catcher can be adjusted from front to back for proper door alignment.

Step 12

Secure the four Hinges (14) to the Left and Right Doors using eight M4*14mm Screws (15).

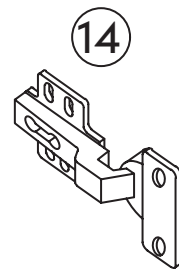

x4



x8

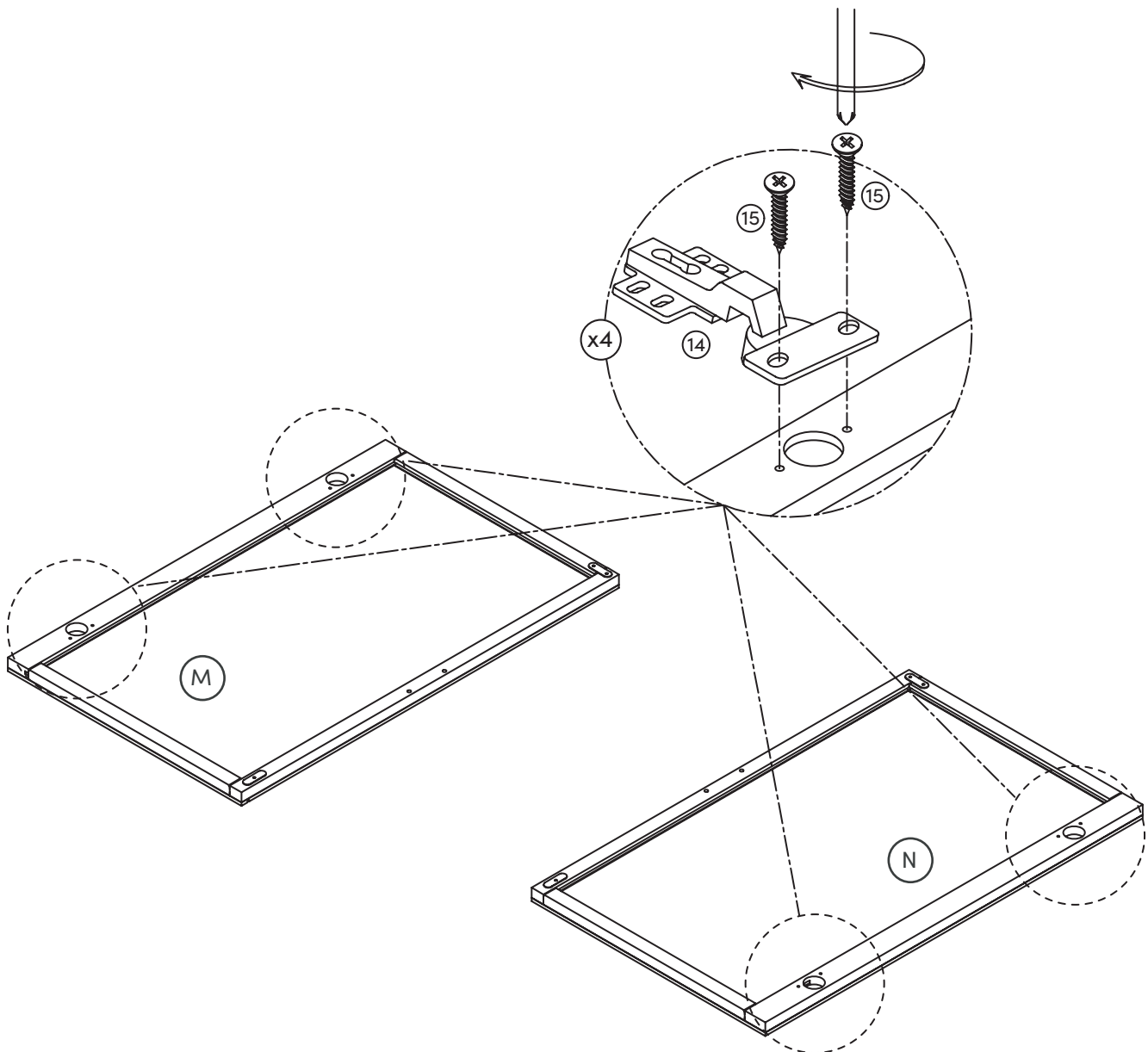

Step 13

Grab 16 M4*14mm Screws (15) and play matchmaker by securing the doors to the unit via their trusty hinges. Then, attach the Handles (17) to the doors using four Hex Button Head Bolts (16).

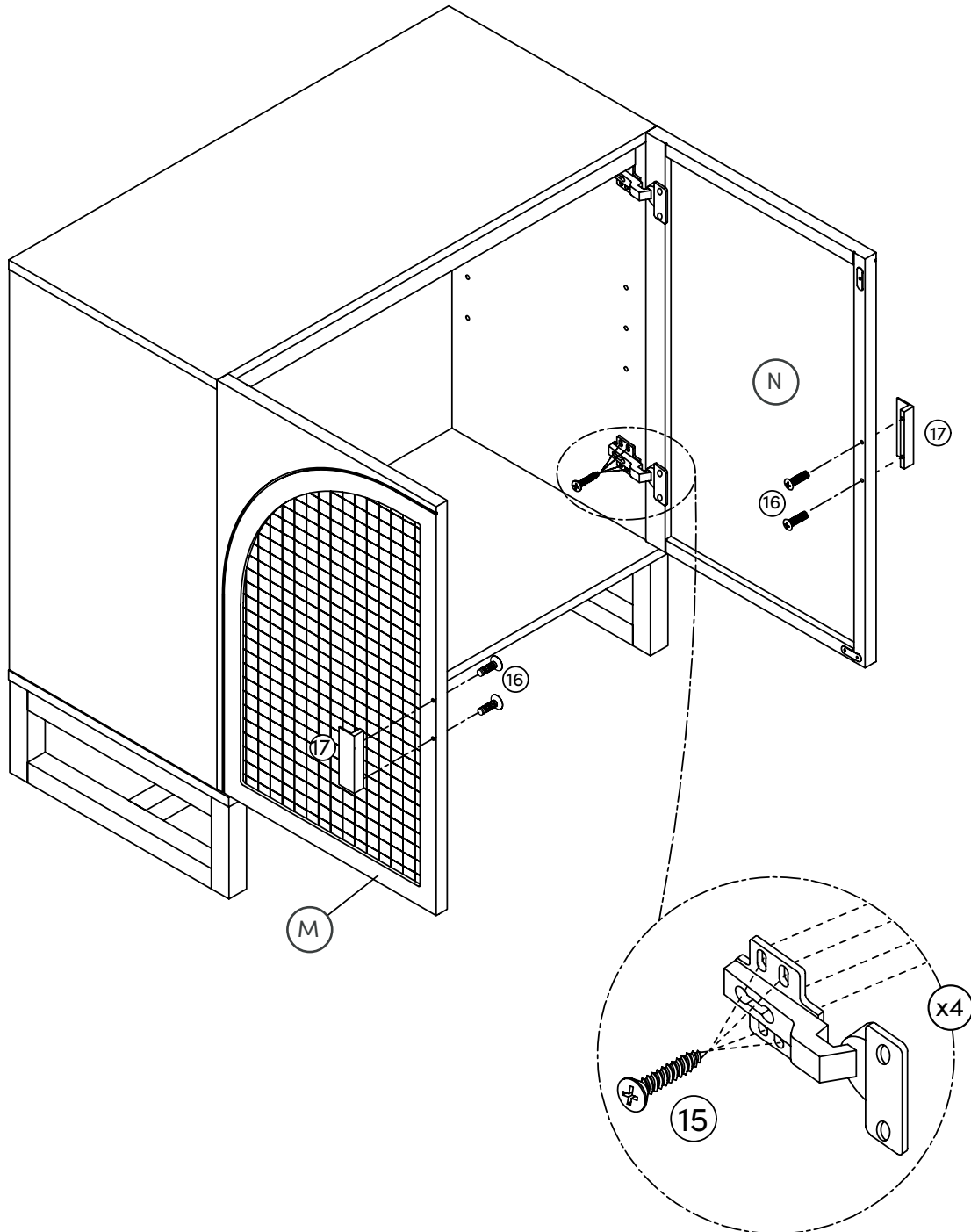
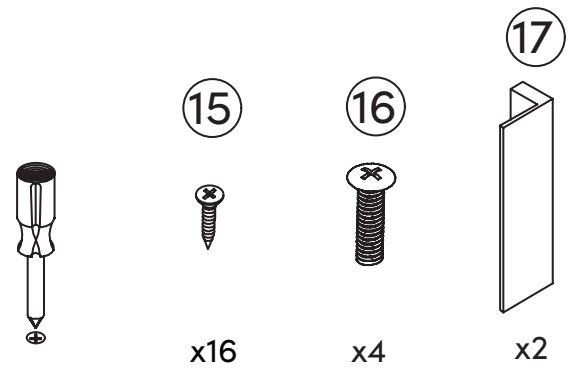

Is your cabinet door looking crooked or unevenly spaced?

Then you've come to the right place. Follow the illustrations below to get your cabinet door aligned and ready for action.

If your door is too low or too high...

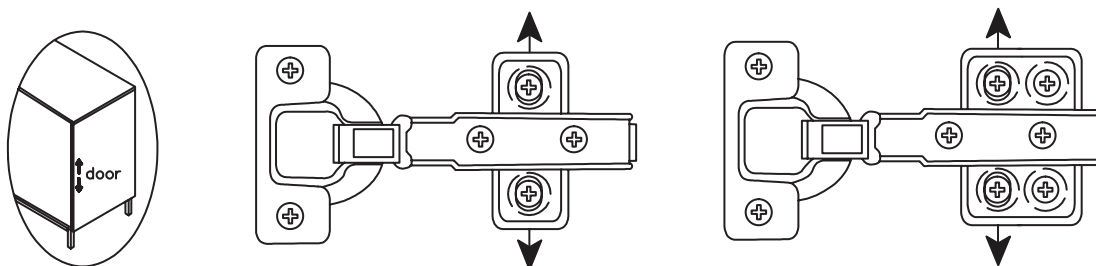

Loosen the height screws, then move the door up or down to make it **level**.

If the space between your doors is off...

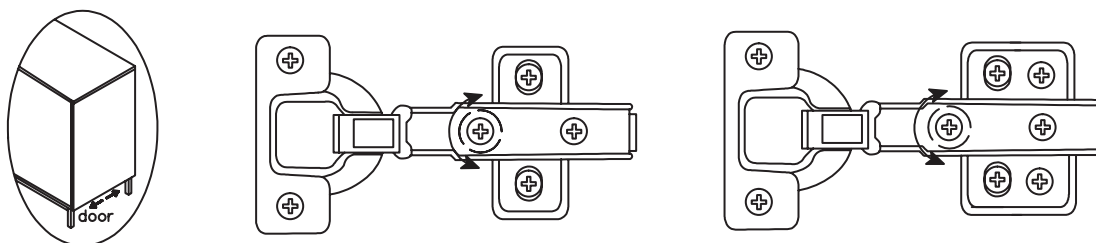

Loosen the side-to-side screws, then screw counter-clockwise to make the gap wider or clockwise to close any gaps.

If you need to adjust the depth of the doors...

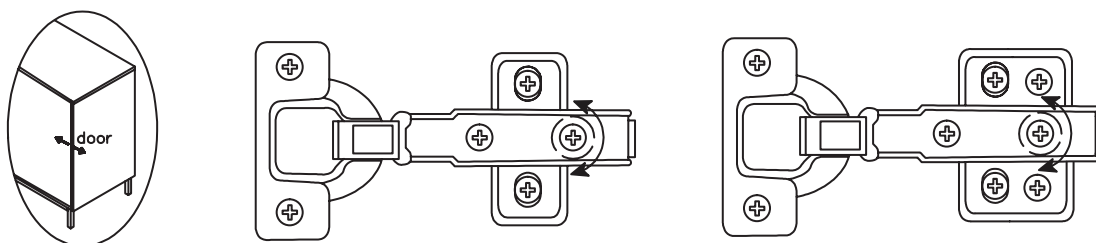

Adjust the in-and-out screws until the door is **aligned** with the side of the cabinet.

Is your cabinet door looking crooked or unevenly spaced? (Cont.)

If you're still having trouble lining everything up, your next step should be to adjust the leveling glides to square up the cabinet and doors and make sure things are level. Follow the instructions below:

If the right door appears to be hanging low, you can adjust the adjustable leveler on the front right until the door is better aligned.

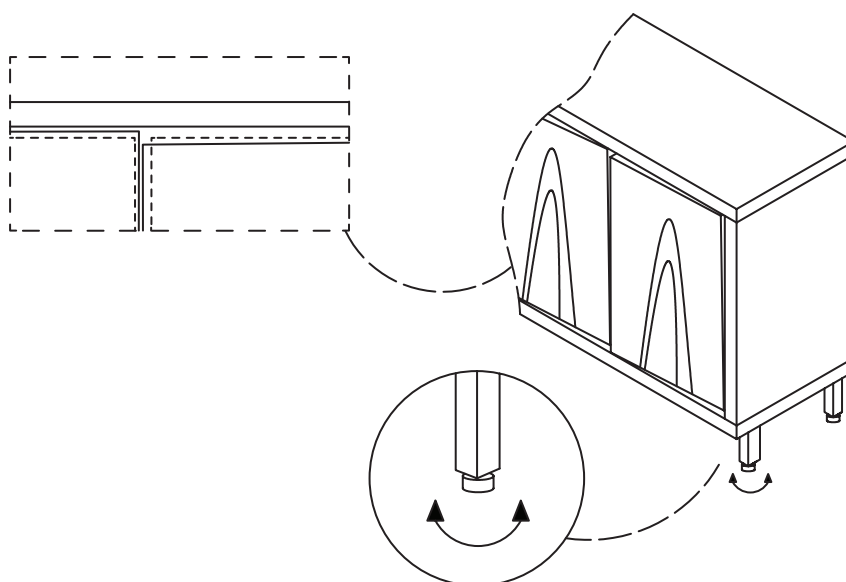

If the left door appears to be hanging low, you can adjust the adjustable leveler on the front left until the door is better aligned.

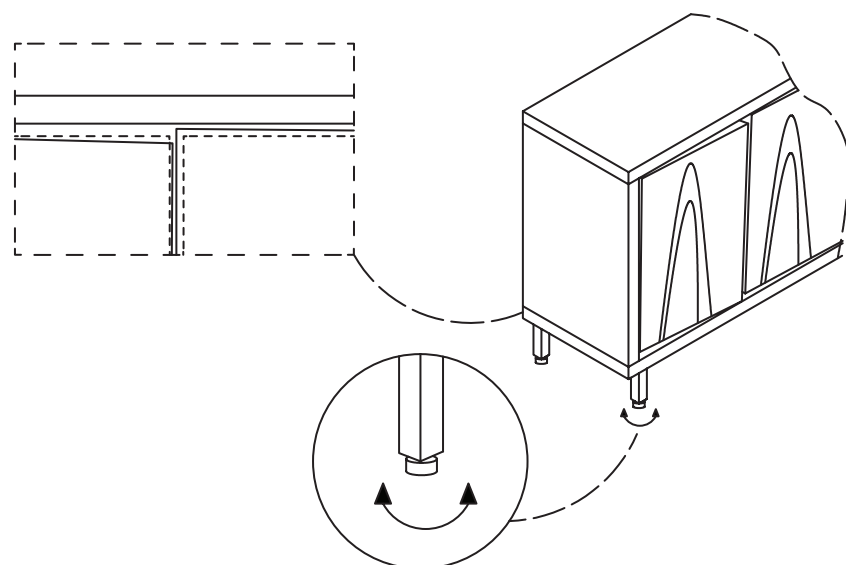

Step 14

Twist on the four Shelf Pins (18) at your desired shelf height and then angle the Shelf (O) at a 35 degree angle to properly fit it into the unit.

18



x4

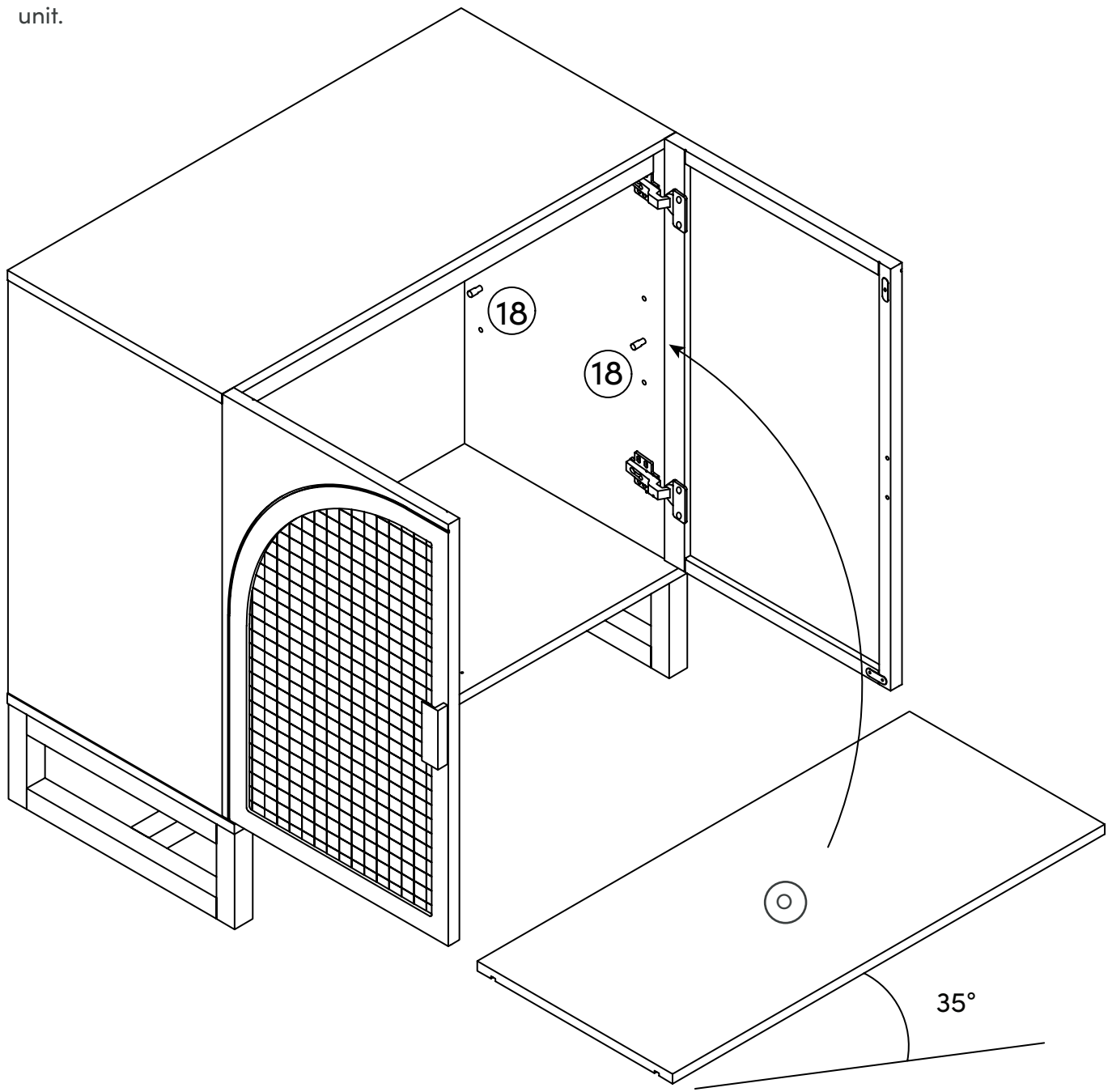

Step 15

Safety first! Secure the Plastic Bracket (20) to the back of the unit using two M5*15mm Screws (19) and then loop the Plastic Tether (21) through the Bracket.



19



x2

20



x1

21



x1

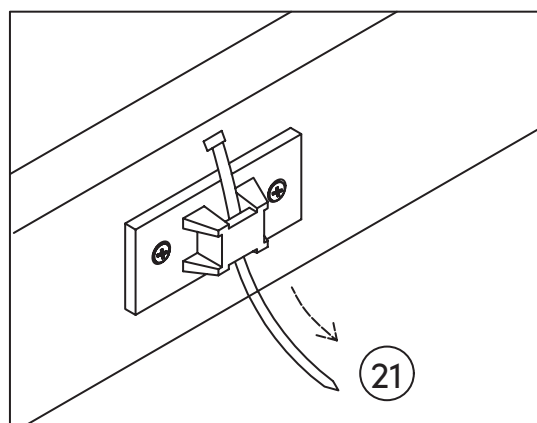
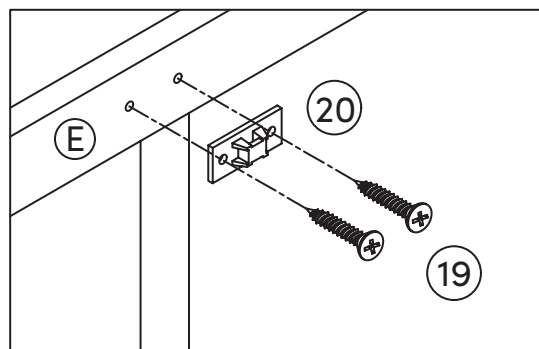
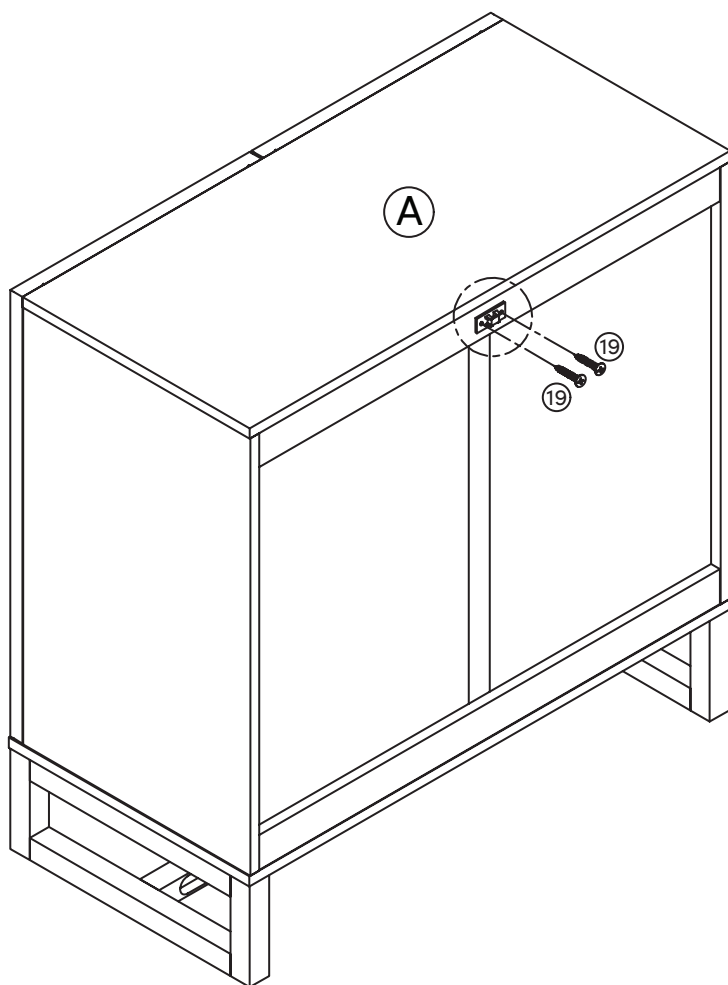

Step 16

Find where you want your storage unit to live and then mount the Plastic Bracket (20) to the wall using the provided Wall Anchors (10) and M4*40mm Screws (22). We recommend using a 1/4" drill bit.



20

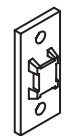

x1

10



x2

22



x2

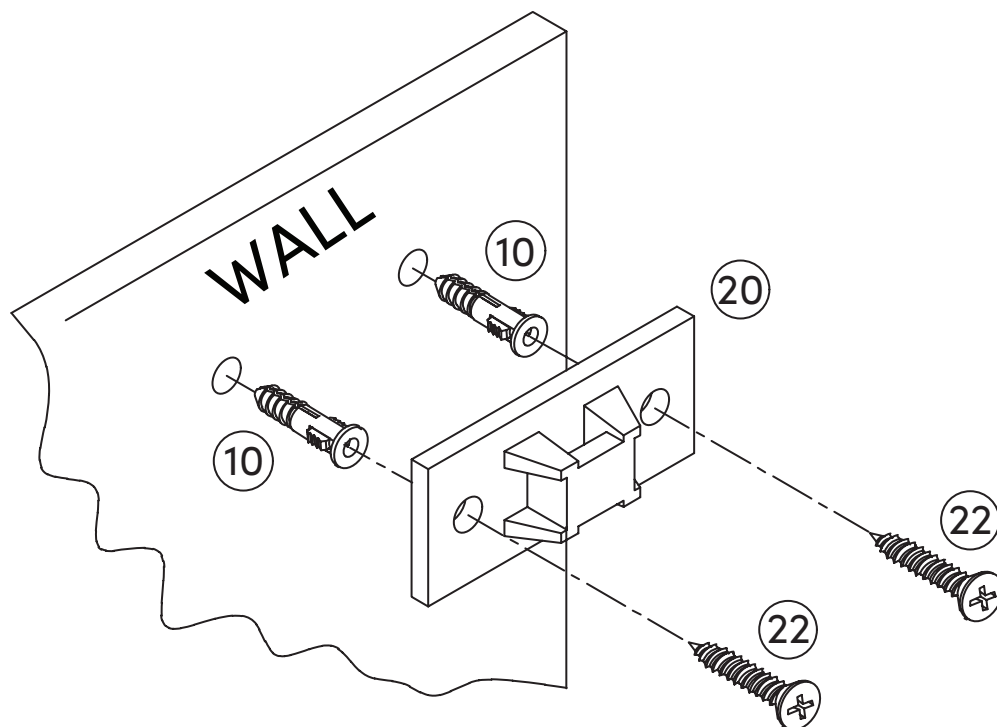

IMPORTANT NOTE:

Recommended Drill Bit = 1/4"

Step 17

Last, but not least, loop the Plastic Tether (21) through both brackets (20) to safely secure the unit to the wall.

You did it! Time for a celebratory pizza? The answer to that is always yes!

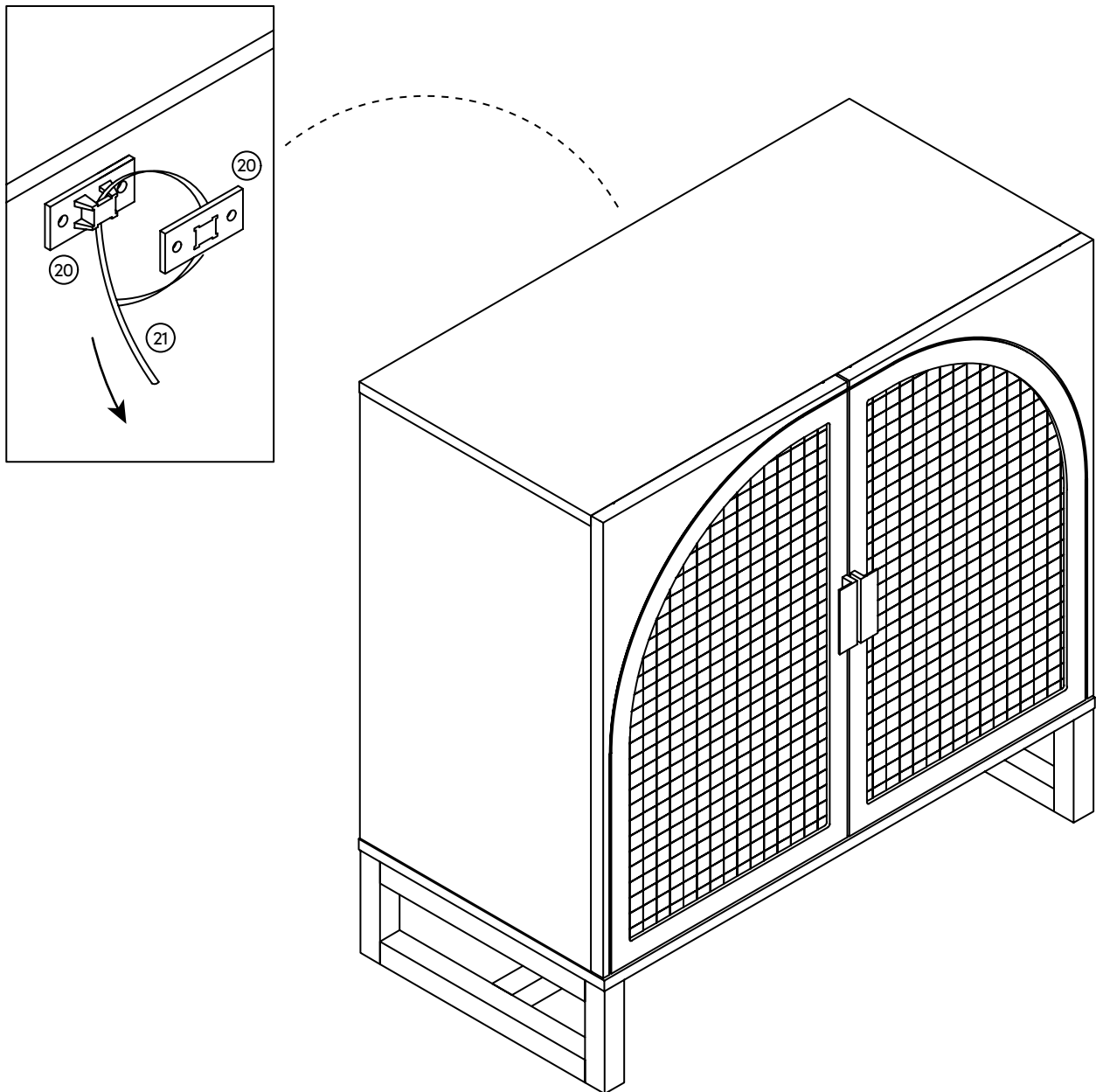

No heartburn, when we handle the return

Give us a call **1-866-619-1004** or shoot us a message at **help@nathanjames.com** we will issue you a free replacement with **zero hassle**.

Our way



Give us a call



Replacement



You

Their way



Re-package item



Schedule pick up



Track package



Replacement



You

We really don't want you to go through the hassle of re-packaging your item and sending it back, because let's be honest...nobody has time for that.

Safety first, fun later

We want your product to last as long as possible, so we recommend that you tighten the screws 2 weeks after assembly and for added safety check the tightness of all screws every 2 months.

For proper care and treatment, please check our website at NathanJames.com/products

Safe use of this product starts with you.

Use this product responsibly with the primary concern for your safety. Follow assembly instructions carefully and inspect product upon receipt and each use.

Nathan James and its parent companies cannot be held legally responsible for any injuries or death resulted from failure to follow instructions or improper use of this product.

Do not modify the structure of this product in any way.

Our products have been tested to meet specific safety measures as they were originally intended to be sold. Any modifications will present the risk of creating significant safety issues which NJ will not be responsible for.

Proper use

- | | |
|---------------|-----------------------------------|
| DO NOT | use for commercial purposes |
| DO NOT | frolic on storage unit |
| DO NOT | use storage unit as foot stool |
| DO NOT | leave spilled liquid on table top |
| DO NOT | use storage unit if damaged |
| DO NOT | make temporary repairs |
| DO NOT | use outdoors |

We are only in business if you're happy

For starters, thanks for being you.

☎ Toll-free at 1-866-619-1004

✉ Help@nathanjames.com

🌐 NathanJames.com/help

We do our best to ensure your furniture arrives without any problems, but occasionally mistakes happen—as humans we are imperfect beings. In the event that a part is damaged or missing, we will be more than happy to provide you with replacement part(s) for free.

Warranty

This product comes with a lifetime warranty from the date of purchase. Please use your phone to scan the QR code to register your product or visit <https://goo.gl/i9dk3q>



Did we do alright? Please spread the love!

If you are happy with your product, tell your friends and family about us or even better leave us a review online. Spreading the word gives us the opportunity to make more people happy and keep our prices low for your next purchase.

Brooklyn Burdon

Founder, Nathan James