

Item NO.:SA60062-DS Instruction Manual

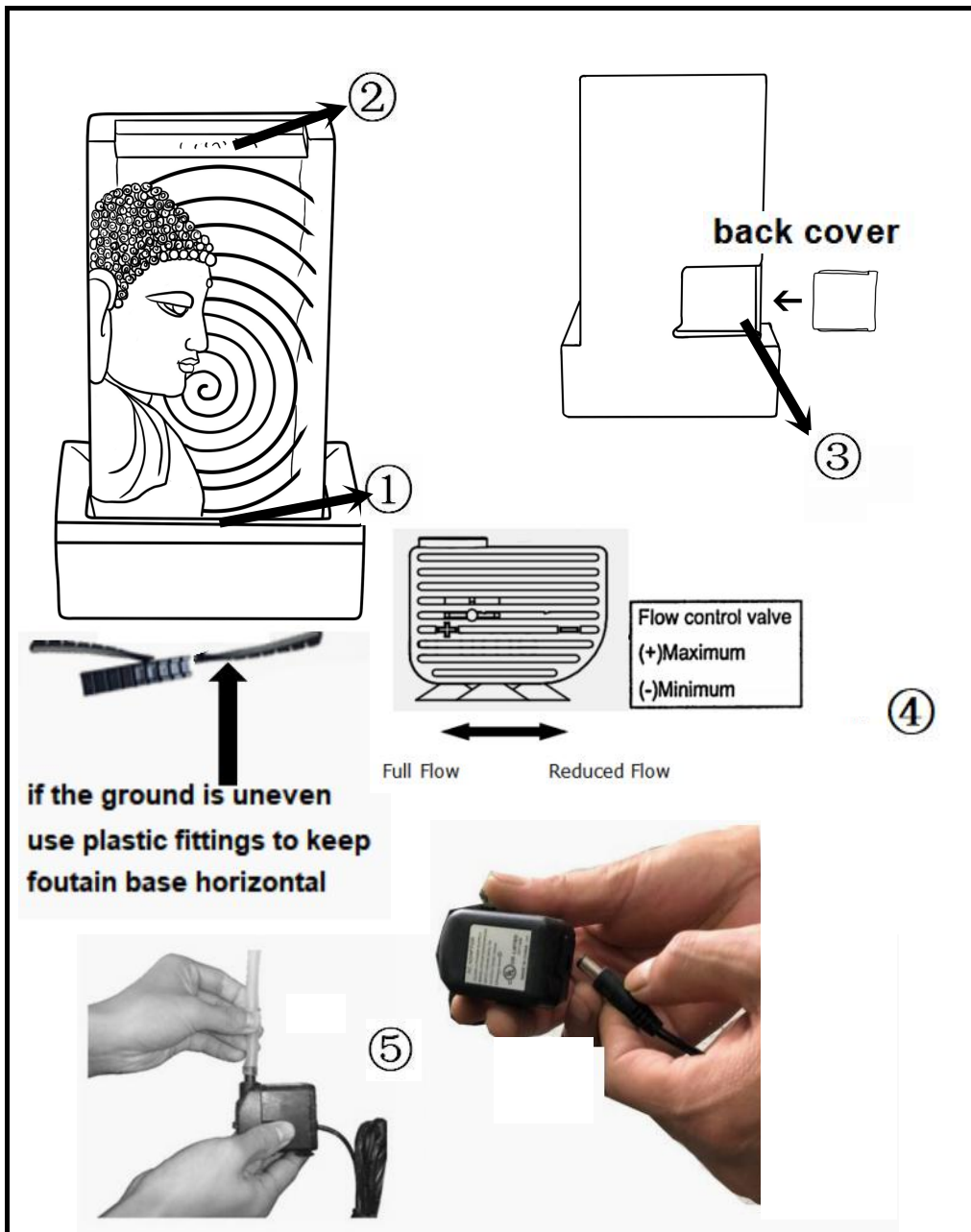

Remarks:

- ① The location of adding water
- ② Water flow out location
- ③ Back door for electrical wire & pump pass through

Process:

- Place the fountain on the ground.
- Pull out the PVC tube from location ③, then connect with the pump, showed as photo ⑤
- Pull out the cable line of light and pump from location ③, and Connect the cable of light with the adaptor, showed as photo ⑤
- Add clean water on location ①, adjust the flow control of the pump, show as ④, close the back cover, showed as photo ③
- Processing the plug of pump and adaptor into the circuit, then after a short while, the water would flow out from the location ②

Caution:

The pump must be fully submerged in the water to operate properly and prevent pump & humidifier from overheating.