

ASSEMBLY INSTRUCTION

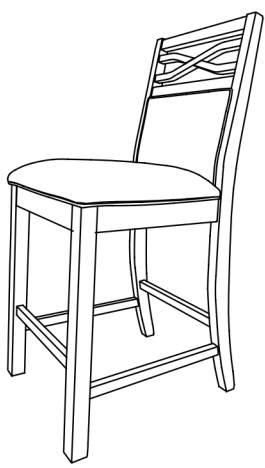

Thank you for purchasing the product. Please take time to read and follow the instructions below. Check that you have all parts and hardware before assembly. Parts apparently missing are often found in the packing materials. If you do not have all the parts listed, have your dealer contact us and they will be sent to you immediately.

It is recommended to install protective pads under all legs and supports to avoid damage or scratches when placing furniture on a wood floor or other hard surface, and to limit indentation and prevent discoloration if placing on carpet.

Hardware may loosen over time. Periodically check to make sure all connections are tight. Re-tighten if necessary.

PARTS LIST				HARDWARE LIST				
No	Sketch	Description	Quantity	No	Description	Size	Sketch	Quantity
1		Chair Back	1PC	A	JCBC Bolt	M6X80mm		4PCS
2		Cushion Seat With Frame	1PC	B	JCBC Bolt	M6X60mm		4PCS
3A 3B		3A-LSF Leg 3B-RSF Leg	1PC 1PC	C	JCBC Bolt	M6X40mm		3PCS
4		Front Stretcher	1PC	D	Spring Washer	M8X13mm		11PCS
5A 5B		5A-LSF Stretcher 5B-RSF Stretcher	1PC 1PC	E	Flat Washer	M8X18mm		11PCS
				F	Wood Screw	M5X38mm		6PCS
				G	Allen Key	M4		1PC

STEP 1

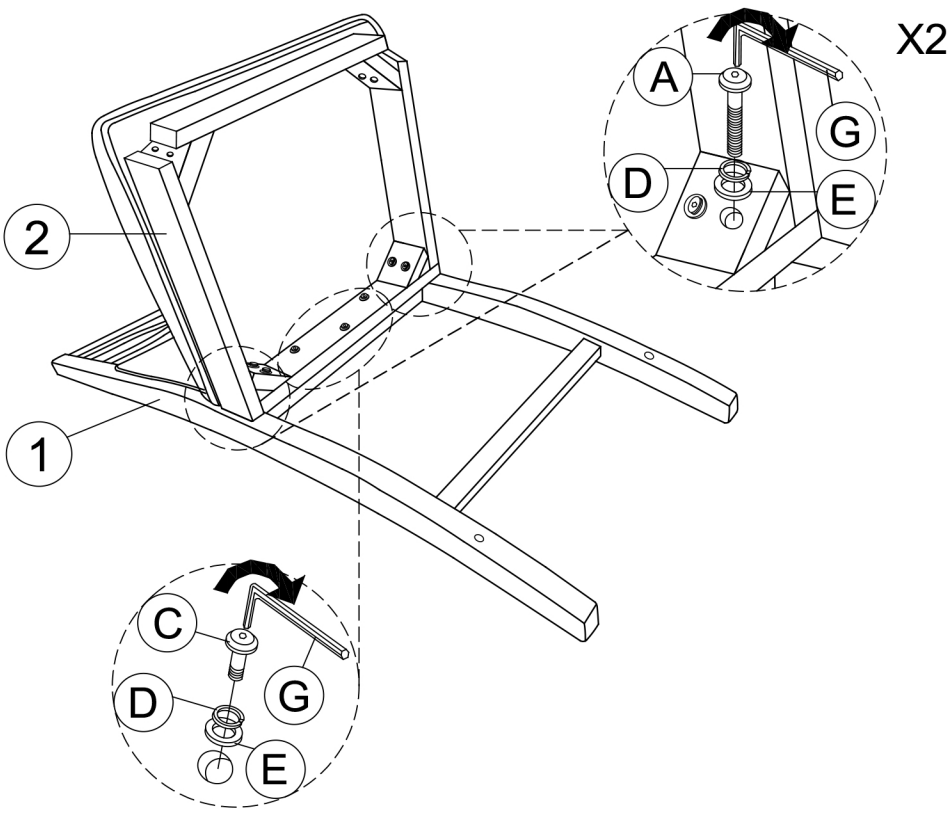

STEP 2

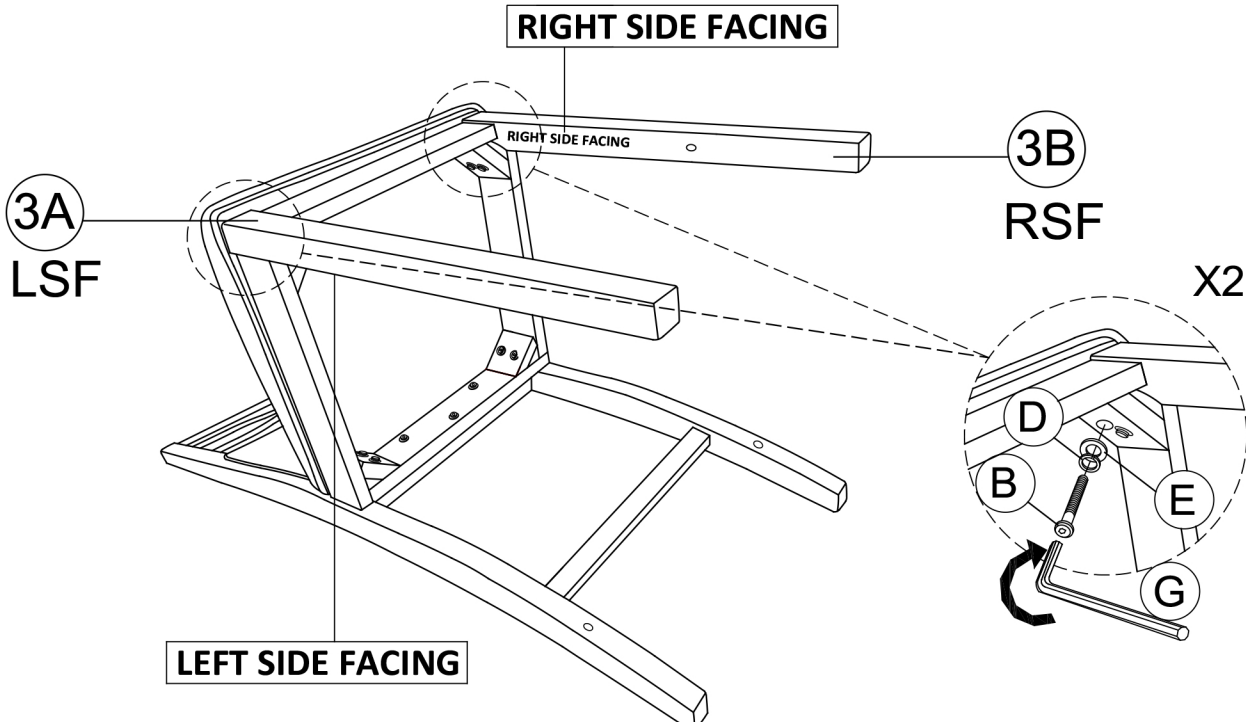

STEP 3

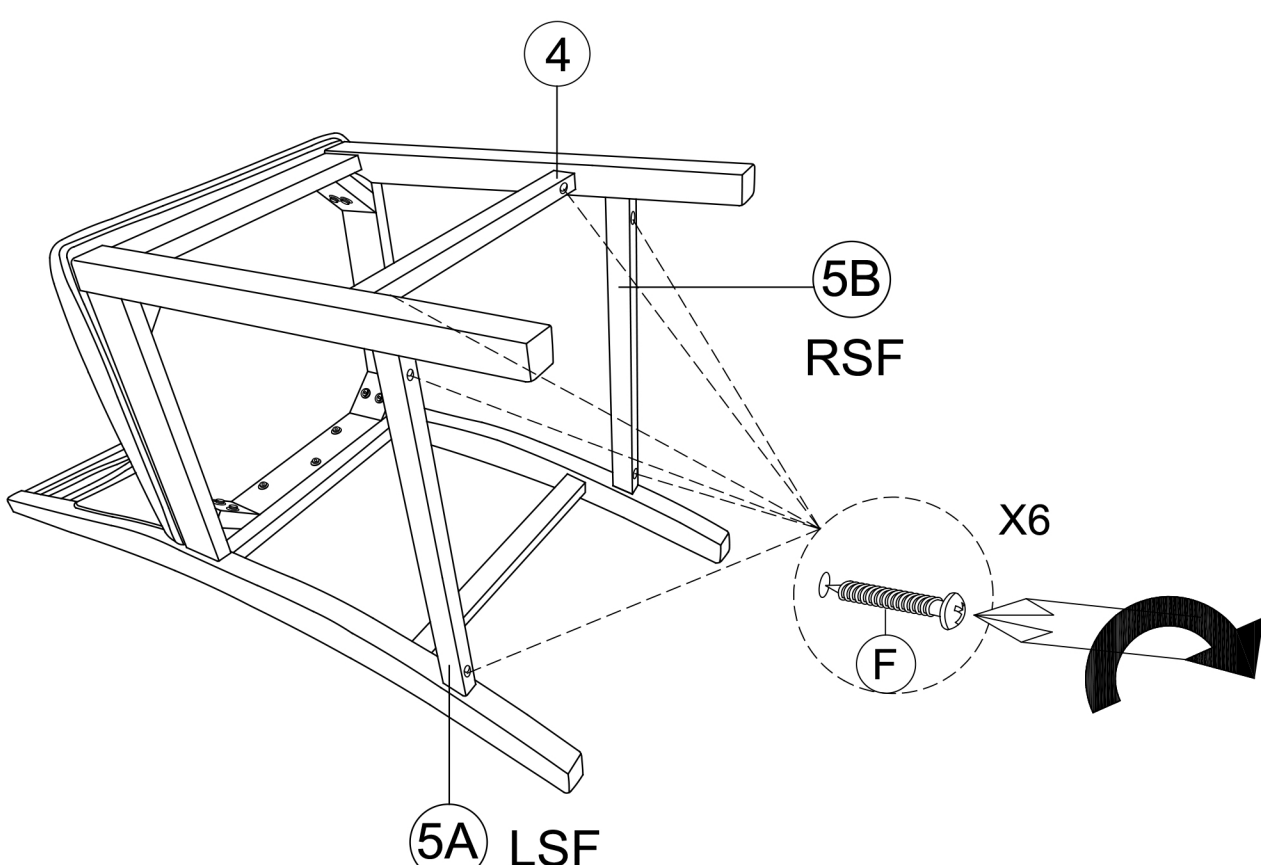

STEP 4
COMPLETED

