

# ASSEMBLY INSTRUCTIONS

---

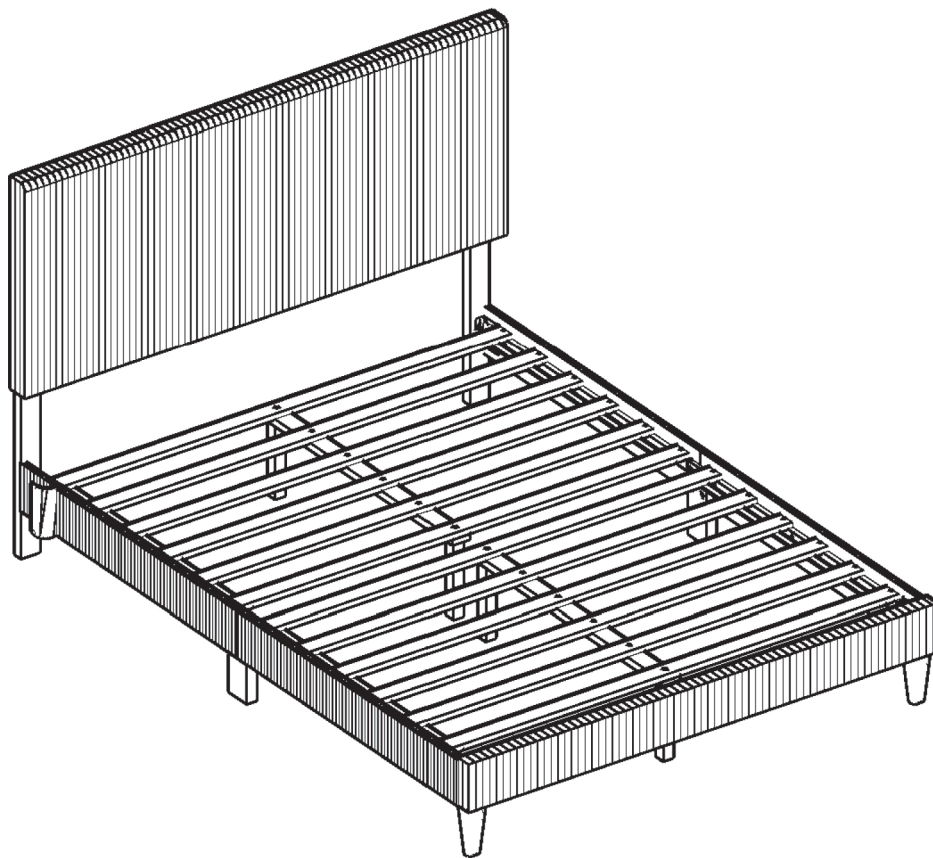

## TOOLS REQUIRED

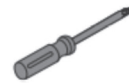

Screwdriver  
( Not included)

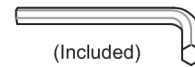

(Included)  
Allen Wrench



2 - People

## ASSEMBLY RATING



EASY —————> DIFFICULT

The Assembly Rating is a 5-point system showing the level of effort needed to assemble a specific product.



## **CHECK BEFORE STARTING**

☐

### **Are you missing anything?**

Double-check all parts, hardware and accessories listed are all accounted for.

☐

### **Check out our Quick Tips!**

We recommend reviewing the pre-assembly handouts. Even experts need a refresher now and then!

☐

### **Should we send any replacements?**

Are there any irregularities or flaws in the parts? We can send replacements!

☐

### **Prep Time!**

Please review the assembly instructions and all diagrams prior to assembling.

# PRE ASSEMBLY INTRODUCTION

We understand building ready-to-assemble furniture can be a challenging experience for some. To help avoid confusion, we have provided some helpful tips that may speed up the process.



## Teamwork

ALWAYS have at least two people to help with transporting and assembling the product to avoid potential injury and/or damage.

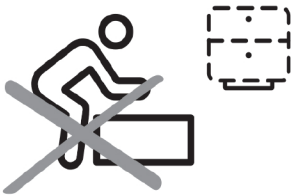

## Suitable Location

Assembling near the area of the intended location is highly recommended.



## Sufficient Space

Make sure you have enough space to move around during the assembly.



## Avoid Scratches

Use cardboard, blankets or a carpeted area while assembling furniture to prevent to prevent scratches and damages.



## Flat Surface

Make sure the furniture rests on a flat and level surface with each leg evenly touching the floor.

# ASSEMBLY AND CARE ADVICE



**FAILURE TO FOLLOW THE GUIDELINES BELOW MAY  
RESULT IN INJURY AND/OR PROPERTY DAMAGE.**



Position each part correctly  
and insert screws or bolts into  
their respective holes.

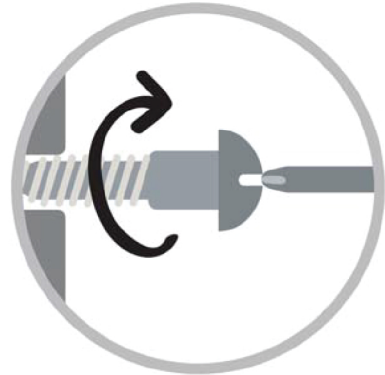

Turn clockwise to tighten and  
only tighten when step is  
completed or when instructed  
to do so.



Save the instructions and store  
any supplied tools for later  
maintenance.

Use the appropriate hand tools  
or power tools for assembly.  
Select steps, such as tightening  
screws and/or bolts, may require  
hand tools to avoid causing  
damage during assembly.

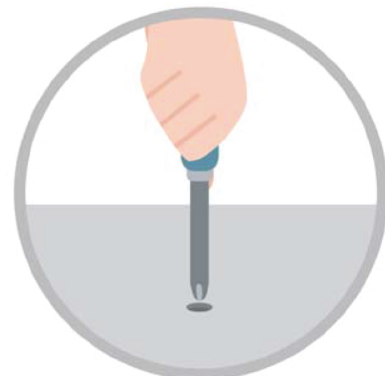

After two weeks, check and  
tighten any loose hardware and  
repeat again every six months  
thereafter.

**IT IS THE USER'S RESPONSIBILITY TO MAINTAIN THE FURNITURE. THE HARDWARE MAY LOOSEN OVER TIME AND MAY CAUSE THE FURNITURE TO BE WOBBLY AND UNABLE TO SUPPORT ITS INTENDED WEIGHT CAPACITY. THIS MAY LEAD TO COLLAPSE AND MAY CAUSE SERIOUS INJURY.**

# BED

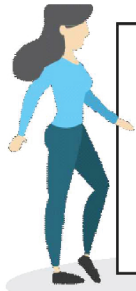

- Please keep instructions for future reference.
- Check the quantity and irregularity of parts and hardware before you start.

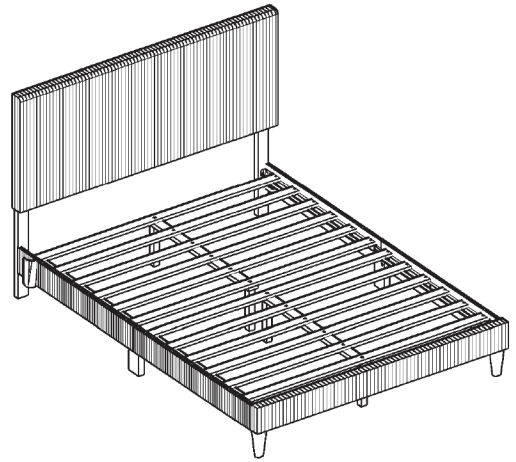

## PARTS

1

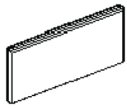

Headboard  
1 pc.

2L



Headboard  
Leg (Left)  
1 pc.

2R

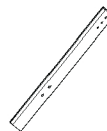

Headboard  
Leg (Right)  
1 pc.

3L



Side Rail 1  
2 pcs.

3R



Side Rail 2  
2 pcs.

4



Footboard  
1 pc.

5



Center Rail  
2 pcs.

6



Center Leg  
4 pcs.

7

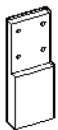

Side Rail Leg  
2 pcs.

8



Bed Leg  
2 pcs.

9



Slat  
12 pcs(2set).

10



Headboard  
Fabric  
1 pc.

11



Side Rail &  
Footboard Fabric  
1 pc.

## HARDWARE

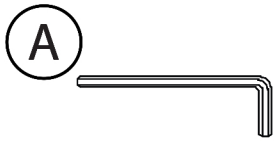

Allen Key M4

1 pc.

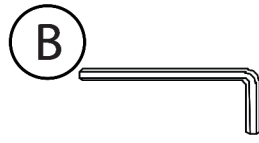

Allen Key M5

1 pc.

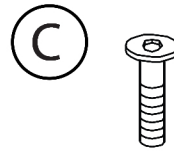

JCBC Bolt  
M6 x 50mm  
4 pcs.

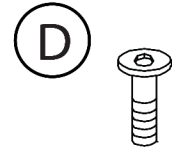

JCBC Bolt  
M6 x 45mm  
6 pcs.

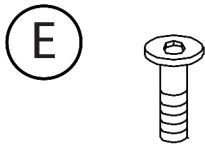

JCBC Bolt  
M6 x 25mm  
8 pcs.

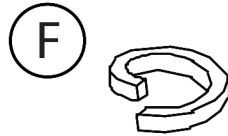

M6 Spring  
Washer  
6 pcs.

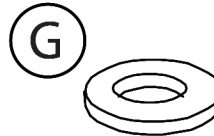

M6 Flat Washer  
6 pcs.

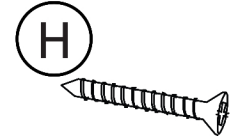

Wood Screw  
M4 x 25mm  
32 pcs.

# ASSEMBLY INSTRUCTIONS

1

Attach the Side Rails (#3) to Side Rail Leg (#7) using Bolt (#E).

Part #3L x 2pcs  
Part #3R x 2pcs  
Part #7 x 2pcs  
Hardware #E x 8pcs

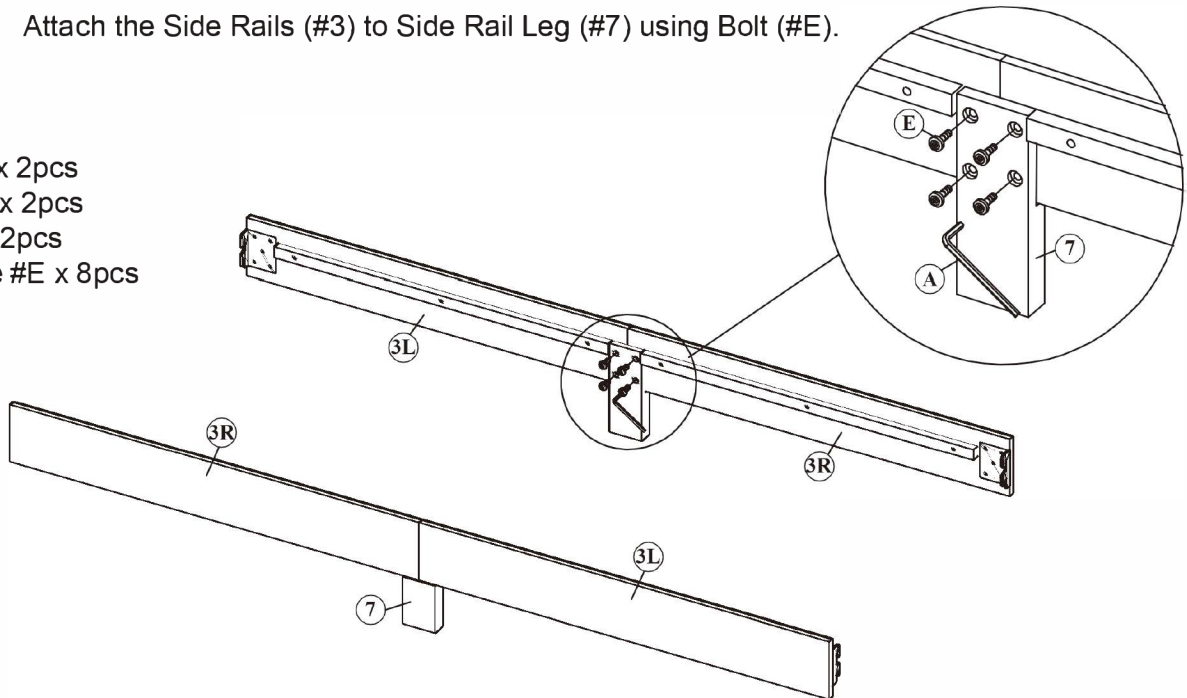

2

- I. Attach the Headboard Legs (#2L, 2R) to Headboard (#1) using Bolt (#D) with Spring Washer (#F) and Flat Washer (#G).
- II. Align the Bed Legs (#6) under the Footboard (#4) and turn clockwise to attach.

Part #1 x 1pc  
Part #2L x 1pc  
Part #2R x 1pc  
Part #4 x 1pc  
Part #8 x 2pcs  
Hardware #D x 6pcs  
Hardware #F x 6pcs  
Hardware #G x 6pcs

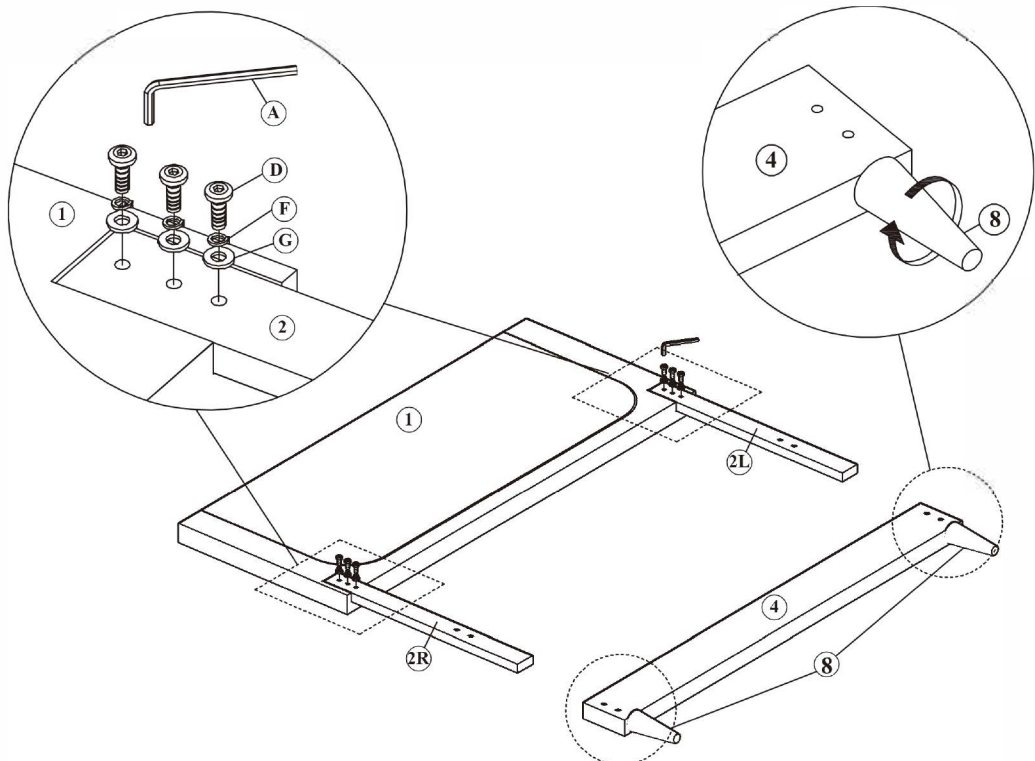

# ASSEMBLY INSTRUCTIONS

## 3

Align one Side Rail (#3L) with Headboard Leg (#2R) and hook pre-attached bracket onto the protruding bolts. Align Side Rail (#3R) with Footboard (#4) and hook pre-attached bracket onto the protruding bolts. Tighten bolts with provided Allen Wrench (#B).

Align Side Rail (#3R) with Headboard Leg (#2L) and hook pre-attached bracket onto the protruding bolts. Align Side Rail (#3L) with Footboard (#4) and hook pre-attached bracket onto the protruding bolts. Tighten bolts with provided Allen Wrench (#B).

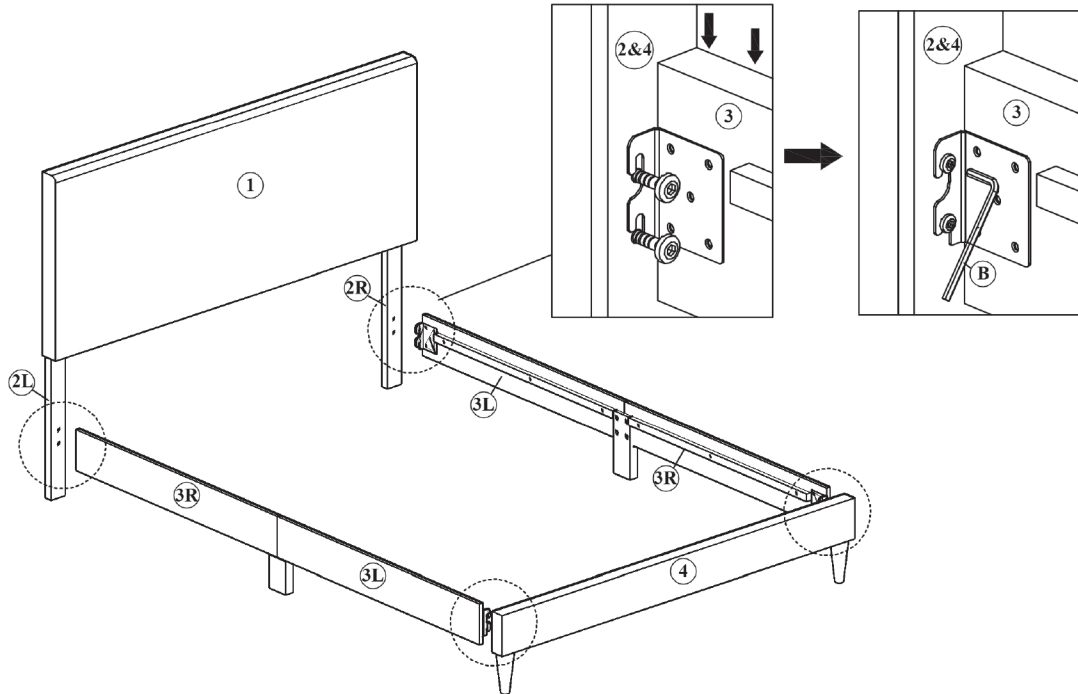

## 4

Align one Center Rail (#5) atop two Center Legs (#6). Place 1 set of Slats (#9) on top and secure the first and last slats with Bolts (#C). Repeat for other set.

Part #5 x 2pcs  
Part #6 x 4pcs  
Part #9 x 2sets  
Hardware #C x 4pcs

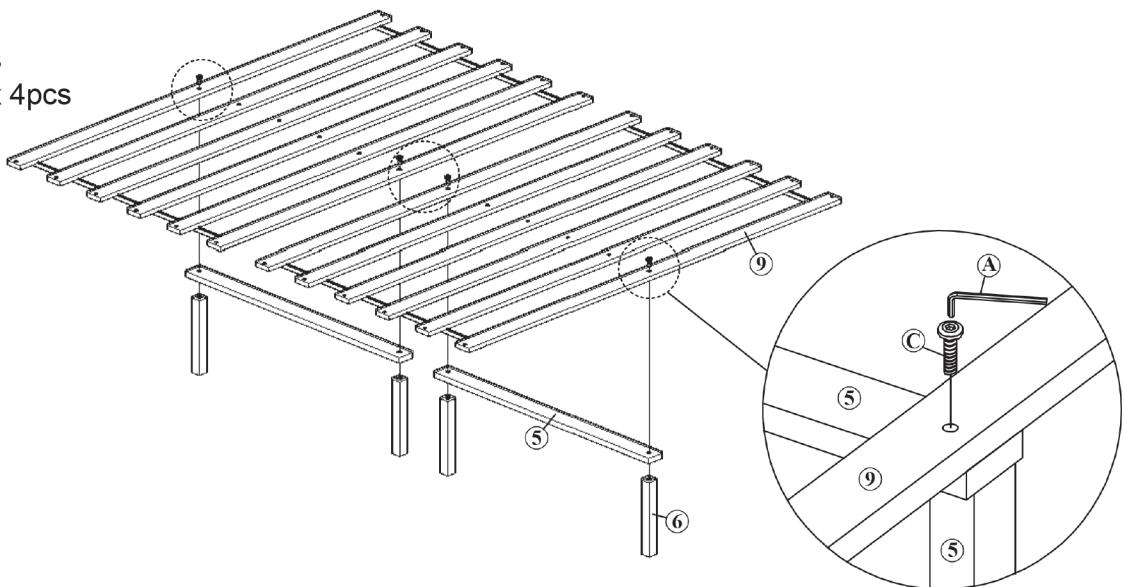

# ASSEMBLY INSTRUCTIONS

5

Place assembled Slats over the Side Rails. Secure every outer end of an individual slat to the Side Rails with Wood Screws (#H). Secure the center of each inner slat to the Center Rail (#5) with Wood Screws (#H).

Hardware #H x 32pcs

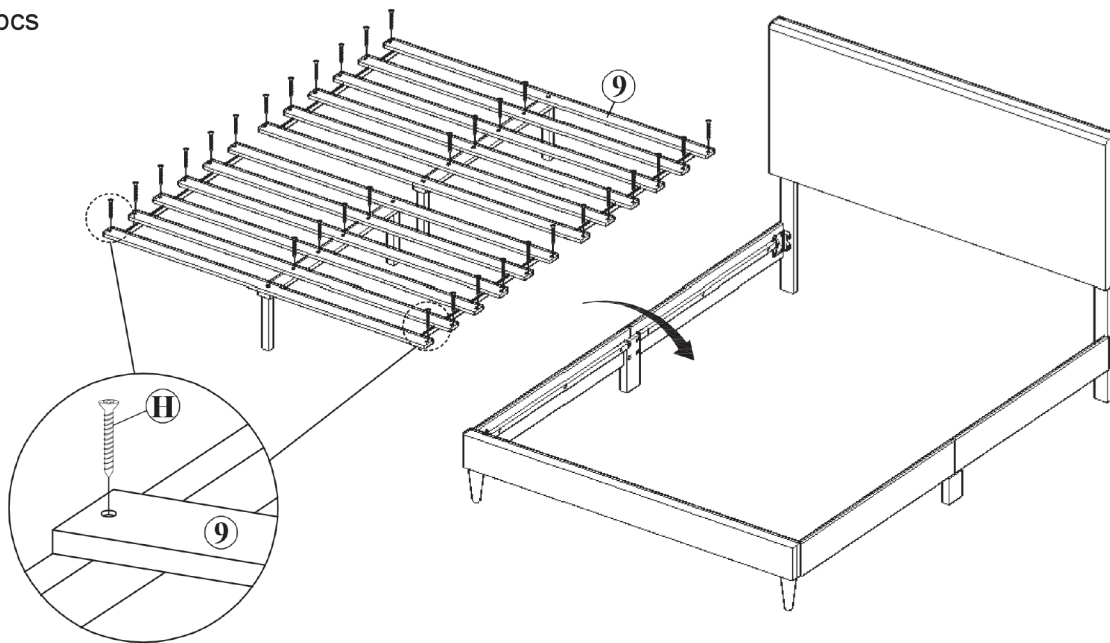

6

Part #10 x 1pc

Slide Headboard Fabric (#10) over the Headboard Panel (#1).

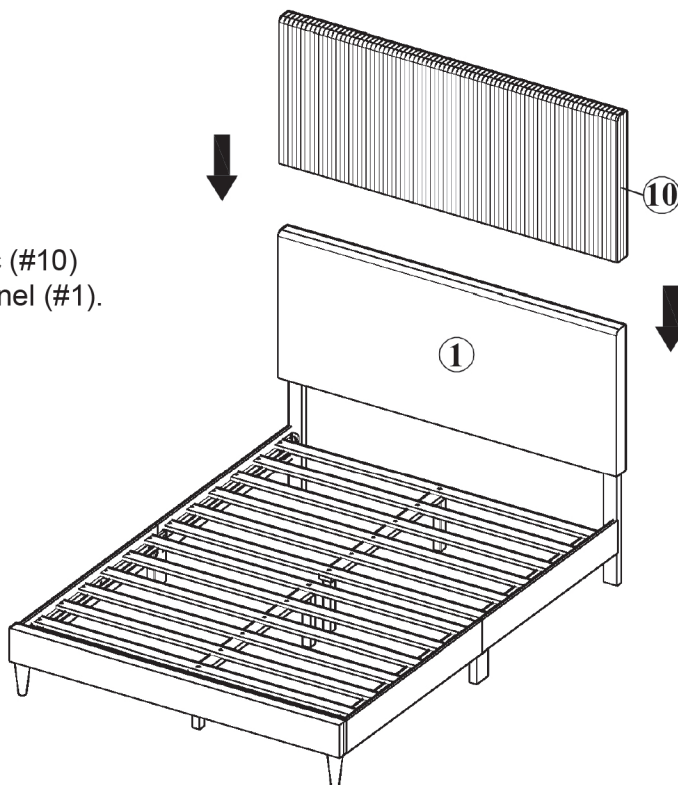

# ASSEMBLY INSTRUCTIONS

## 7

Attach the Side Rail & Footboard Fabric (#11) using the Velcro adhesive.

Part #11 x 1pc

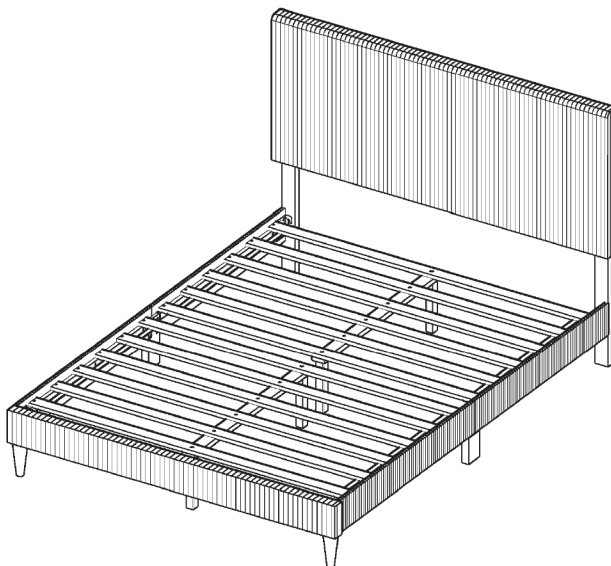
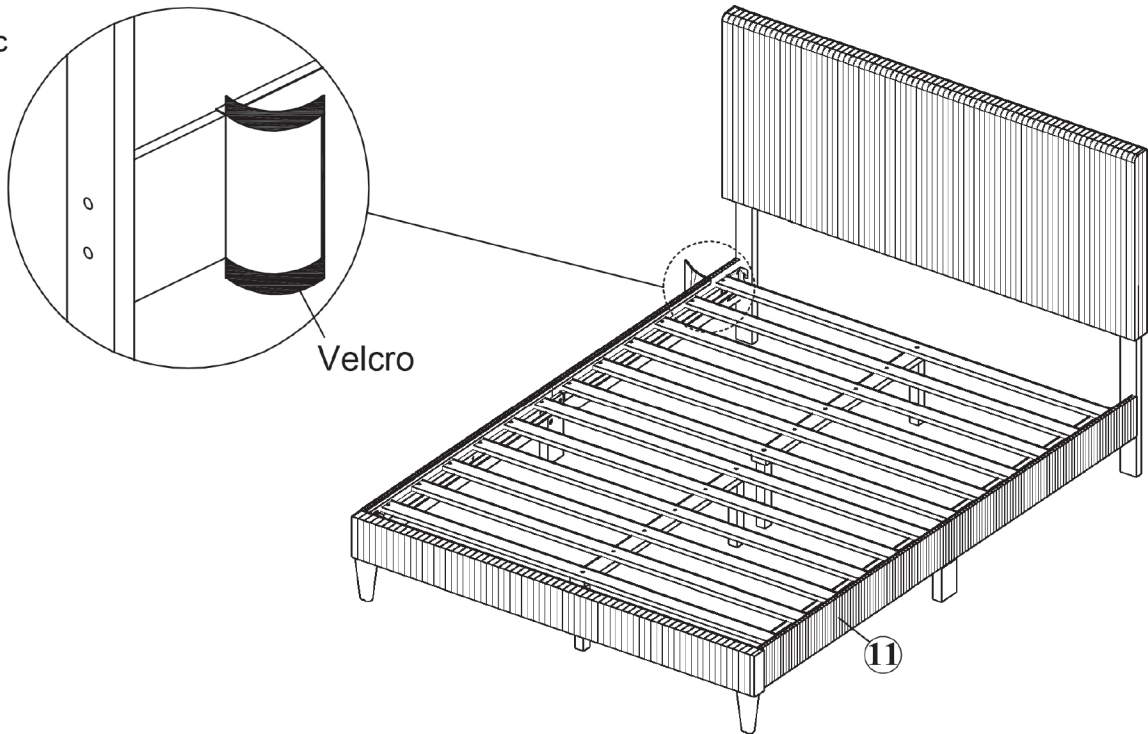

### ASSEMBLY COMPLETED



Please ensure the furniture rests on an even and flat surface. If the product wobbles or feels loose, double-check all bolts and/or screws are properly tightened and secured.



#### Keep this handy!

Please retain this instruction manual and any order-related information for future reference.



#### Lift, don't drag!

To avoid damage to product please always LIFT the product when transporting or adjusting the placement.