

ASSEMBLY INSTRUCTIONS

Thank you for purchasing this product. Please take time to read and follow the instructions below. Check that you have all parts and hardware before assembly. Parts apparently missing are often found in the packing materials. If you do not have all the parts listed, have your dealer contact us and they will be sent to you immediately.

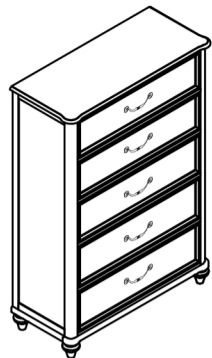

It is recommended to install protective pads under all legs and supports to avoid damage or scratches when placing furniture on a wood floor or other hard surface, and to limit indentation and prevent discoloration if placing on carpet.

Hardware may loosen over time. Periodically check to make sure all connections are tight. Re-tighten if necessary.

PART LISTS			
No.	Sketch	Description	Q'ty
1		Chest	1PC
2		Leg	4PCS

HARDWARE LISTS				
No.	Description	Size	Sketch	Q'ty
A	Tipping restraint			1SET

STEP 1

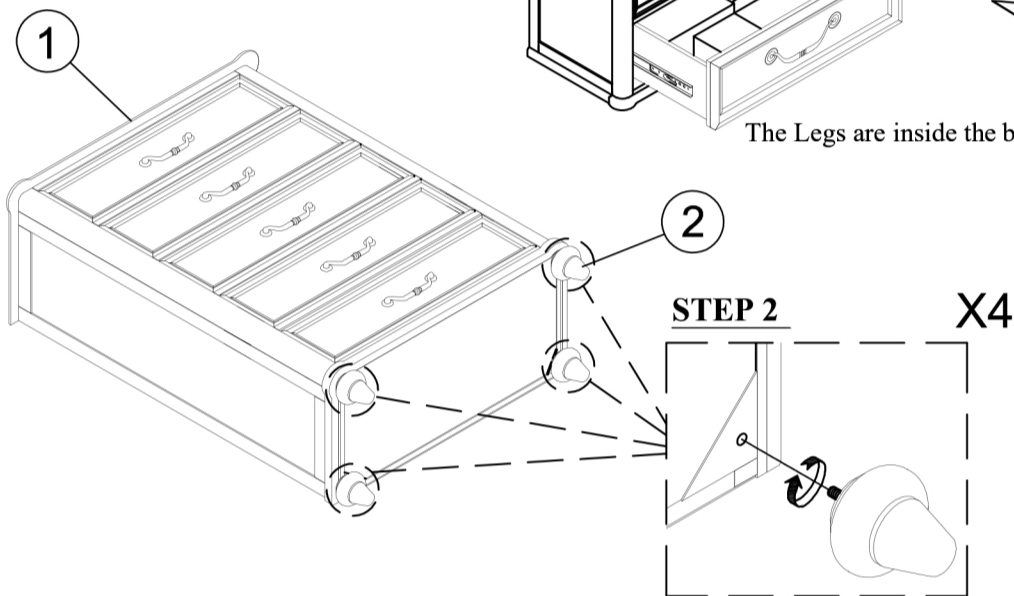
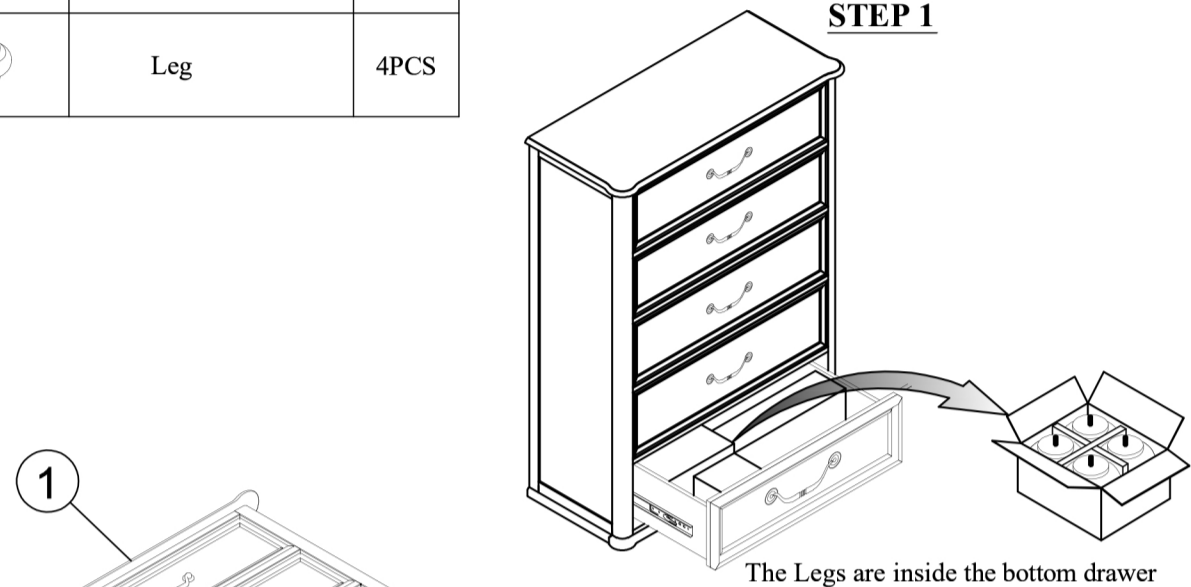

PAGE : 1 OF 2

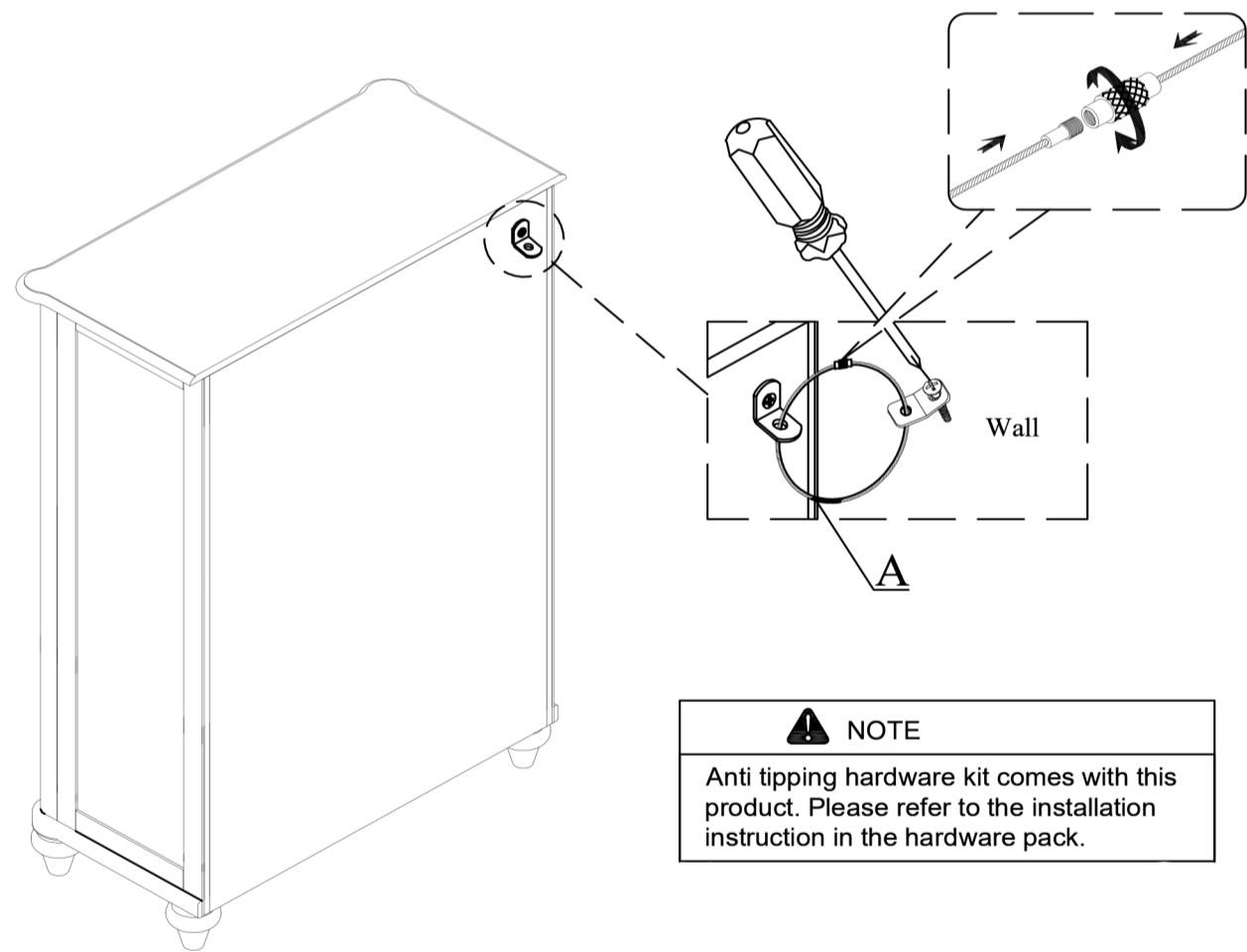

NOTE

Anti tipping hardware kit comes with this product. Please refer to the installation instruction in the hardware pack.

COMPLETED ASSEMBLY

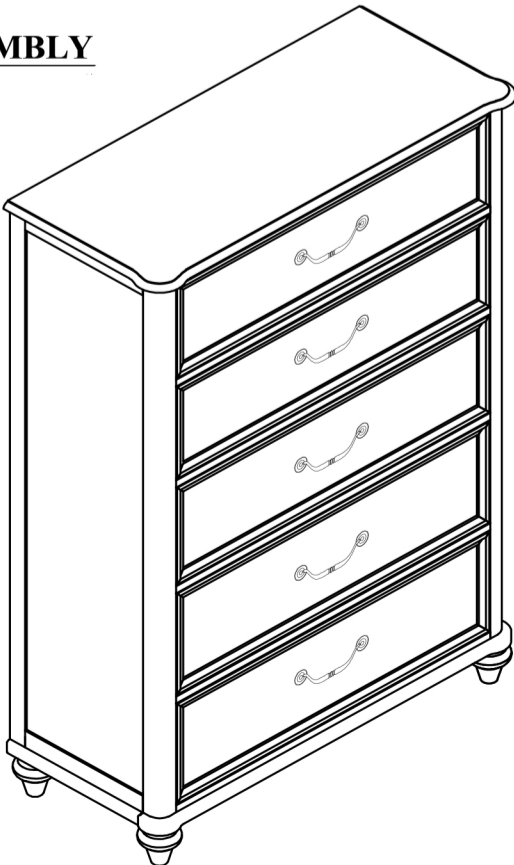

PAGE : 2 OF 2