

# ASSEMBLY INSTRUCTIONS

---

## TOOLS REQUIRED



Allen Wrench  
(Included)



2 - People

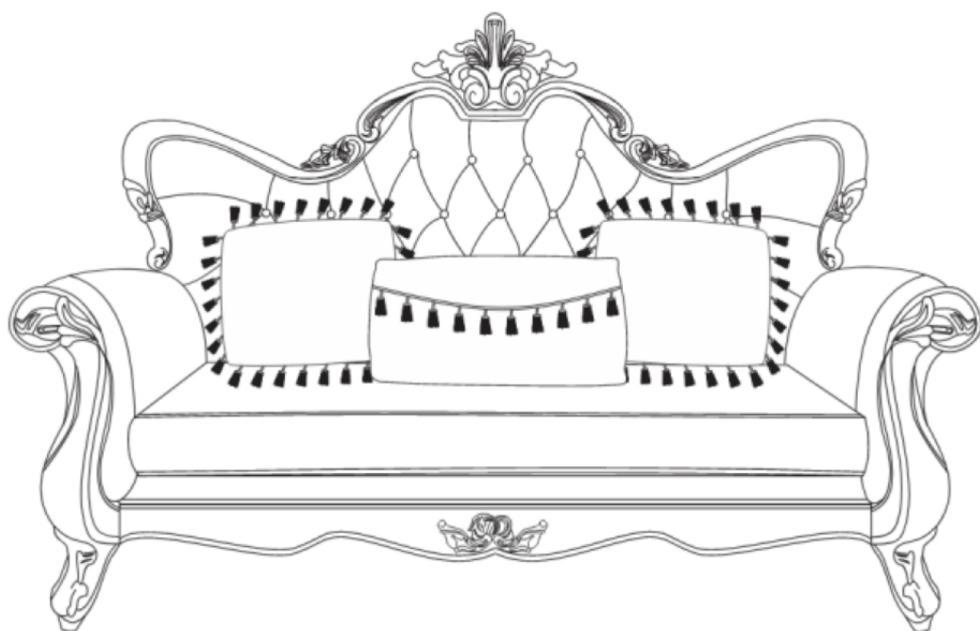

## ASSEMBLY RATING



EASY —————> DIFFICULT

The Assembly Rating is a 5-point system showing the level of effort needed to assemble a specific product.



## **CHECK BEFORE STARTING**

☐

### **Are you missing anything?**

Double-check all parts, hardware and accessories listed are all accounted for.

☐

### **Check out our Quick Tips!**

We recommend reviewing the pre-assembly handouts. Even experts need a refresher now and then!

☐

### **Should we send any replacements?**

Are there any irregularities or flaws in the parts? We can send replacements!

☐

### **Prep Time!**

Please review the assembly instructions and all diagrams prior to assembling.

# PRE ASSEMBLY INTRODUCTION

We understand building ready-to-assemble furniture can be a challenging experience for some. To help avoid confusion, we have provided some helpful tips that may speed up the process.



## Teamwork

ALWAYS have at least two people to help with transporting and assembling the product to avoid potential injury and/or damage.

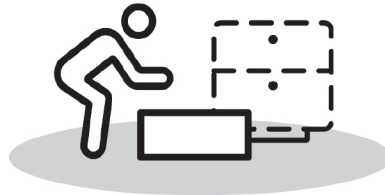

## Suitable Location

Assembling near the area of the intended location is highly recommended.



## Sufficient Space

Make sure you have enough space to move around during the assembly.



## Avoid Scratches

Use cardboard, blankets or a carpeted area while assembling furniture to prevent to prevent scratches and damages.



## Flat Surface

Make sure the furniture rests on a flat and level surface with each leg evenly touching the floor.

# ASSEMBLY AND CARE ADVICE



**FAILURE TO FOLLOW THE GUIDELINES BELOW MAY  
RESULT IN INJURY AND/OR PROPERTY DAMAGE.**



Position each part correctly  
and insert screws or bolts into  
their respective holes.

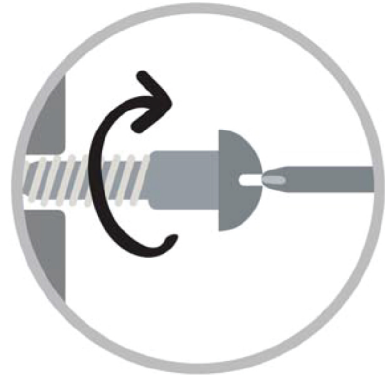

Turn clockwise to tighten and  
only tighten when step is  
completed or when instructed  
to do so.



Save the instructions and store  
any supplied tools for later  
maintenance.

Use the appropriate hand tools  
or power tools for assembly.  
Select steps, such as tightening  
screws and/or bolts, may require  
hand tools to avoid causing  
damage during assembly.

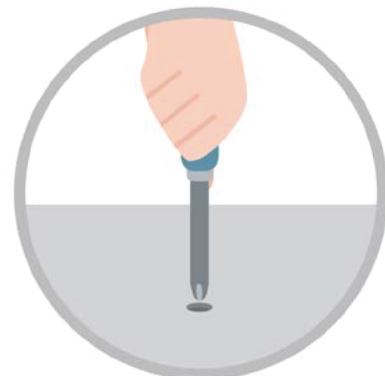

After two weeks, check and  
tighten any loose hardware and  
repeat again every six months  
thereafter.

**IT IS THE USER'S RESPONSIBILITY TO MAINTAIN THE FURNITURE. THE HARDWARE MAY LOOSEN OVER TIME AND MAY CAUSE THE FURNITURE TO BE WOBBLY AND UNABLE TO SUPPORT ITS INTENDED WEIGHT CAPACITY. THIS MAY LEAD TO COLLAPSE AND MAY CAUSE SERIOUS INJURY.**



# LOVESEAT

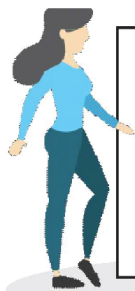

- Please keep instructions for future reference.
- Check the quantity and irregularity of parts and hardware before you start.

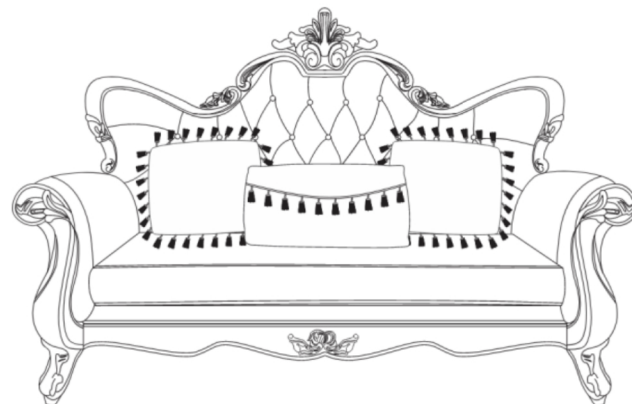

## PARTS

Ⓐ



SEAT FRAME

1 pc.

Ⓑ



LEFT SIDE FACING  
(LSF) ARM

1 pc.

Ⓒ



RIGHT SIDE FACING  
(RSF) ARM

1 pc.

Ⓓ

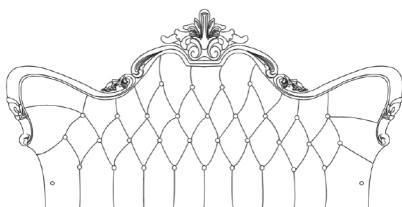

BACKREST

1 pc.

Ⓔ

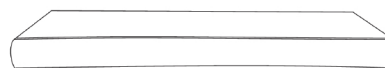

SEAT CUSHION

1 pc.

Ⓕ



LEG

2 pc.

Ⓖ



RECTANGLE PILLOW

1 pc.

Ⓖ

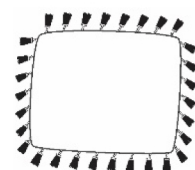

BIG SQUARE PILLOW

2 pc.

## HARDWARE

①



FLAT WASHER  
Ø5/16 x 22mm  
14 pc.

②

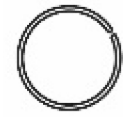

LOCK WASHER  
Ø5/16  
14 pc.

③



BOLT  
Ø5/16 x 2"  
6 pc.

④



ALLEN KEY M5  
Ø5/16  
1 pc.

⑤



BOLT  
Ø5/16 x 3¼"  
6 pc.

⑥

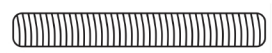

THREAD BOLT  
Ø5/16 x 3¼"  
2 pc.

⑦



HEX NUT  
Ø5/16 x 1/2"  
2 pc.

⑧

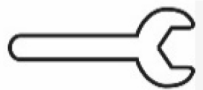

WRENCH  
12mm  
1 pc.

⑨



SCREWS  
#4 x 70mm  
4 pc.

# ASSEMBLY INSTRUCTIONS

1

Part #A x 1pc  
 Part #F x 2pcs  
 Hardware #1 x 4pcs  
 Hardware #2 x 4pcs  
 Hardware #3 x 4pcs  
 Hardware #4 x 1pc

Align the Leg (#F) to the Seat frame (#A) and secure by using Bolts (#3) with Lock washer (#2) and Flat washer (#3).

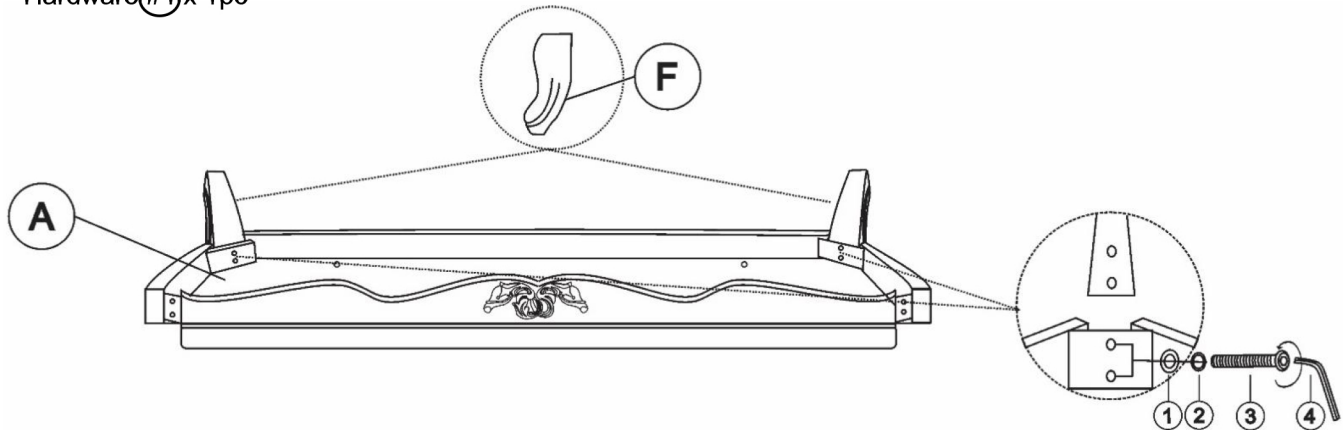

2

Part #B x 1pc  
 Part #C x 1pc  
 Hardware #1 x 6pcs  
 Hardware #2 x 6pcs  
 Hardware #5 x 6pcs

Attach the Left/right Facing Arm (#B,#C) Leg to the Seat frame (#A) corner by using Bolt (#5) with Lock washer (#2) and Flat washer (#1).  
 Secure the back side of the arm to the seat by using Bolt (#5) with Lock washer (#2) and Flat washer (#1).

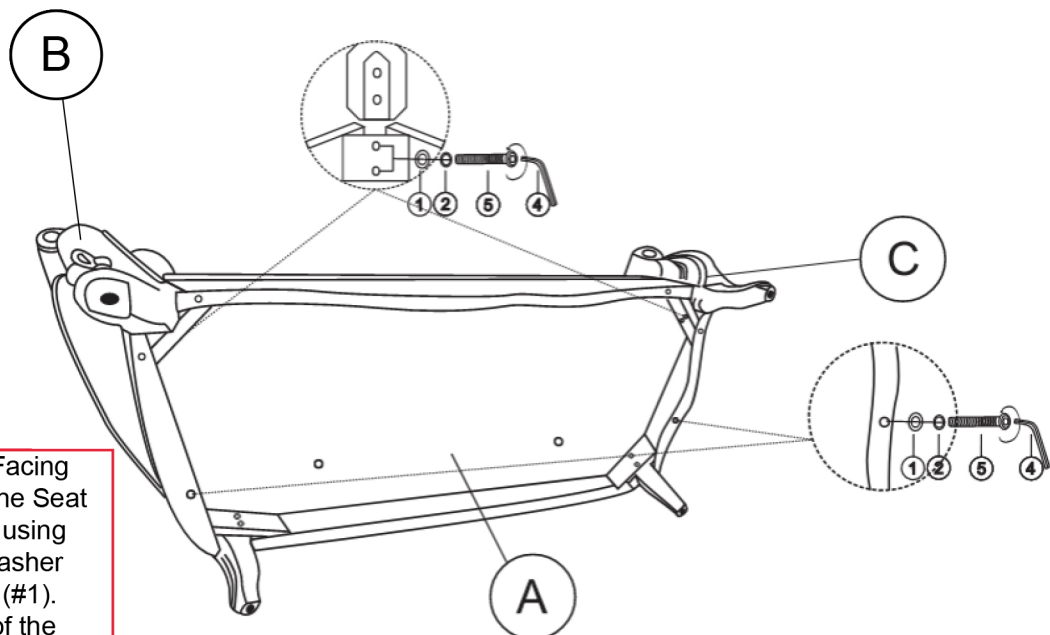

## ASSEMBLY INSTRUCTIONS

3

Hardware **#9** x 4pcs

Secure the arms (**#B**,**#C**) at the corner by using Screw (**#9**).

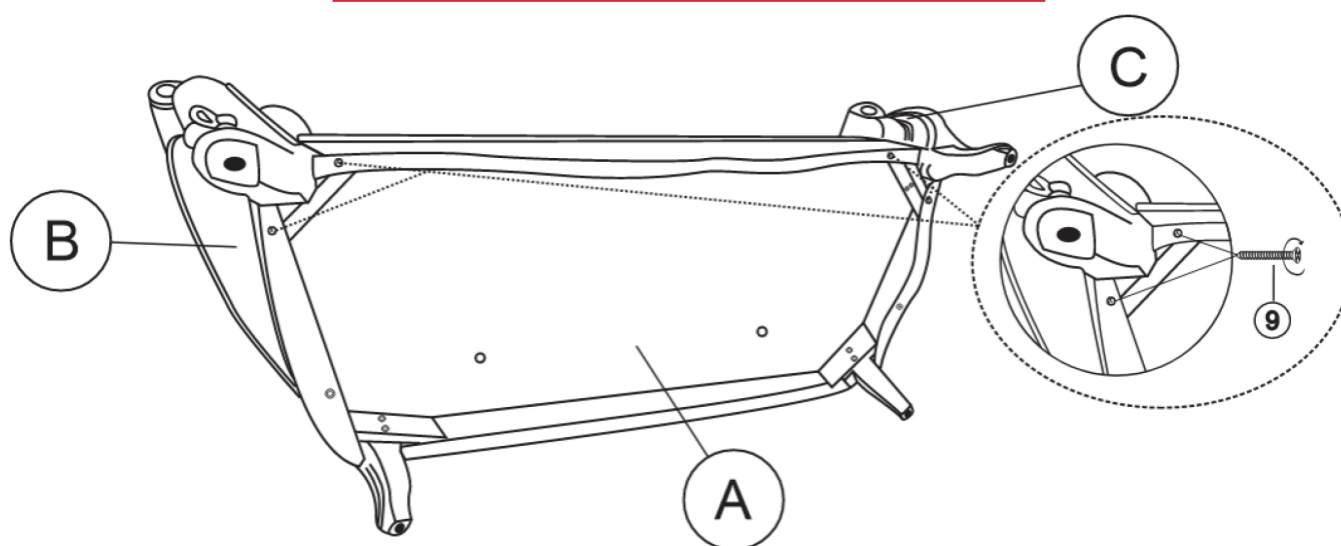

4

Part **#D** x 1pc  
Hardware **#6** x 2pcs

Prepare the Backrest (**#D**) by attaching the Threaded bolt (**#6**).

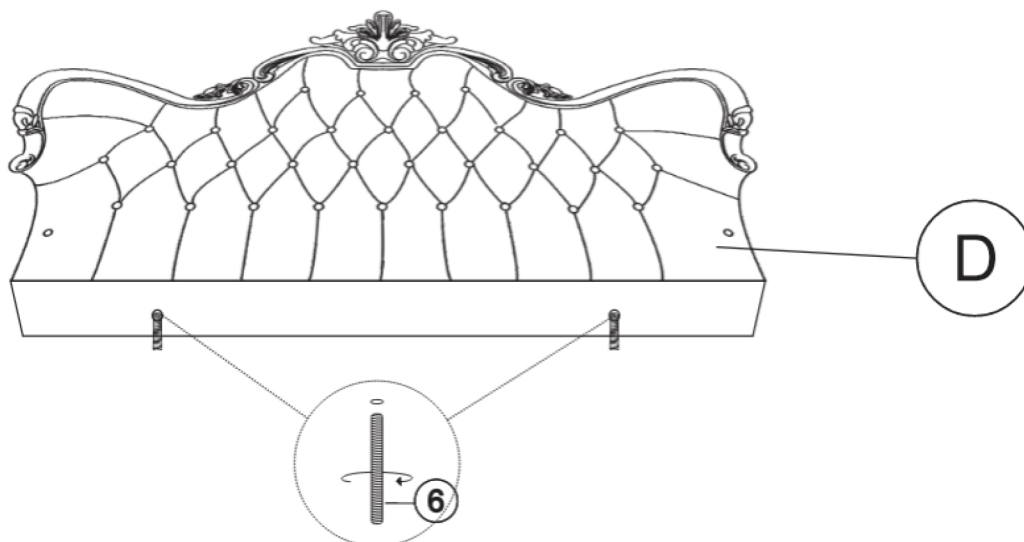

# ASSEMBLY INSTRUCTIONS

5

Part #D x 1pc

Align and insert the Backrest (#D) into the Seat frame (#A).

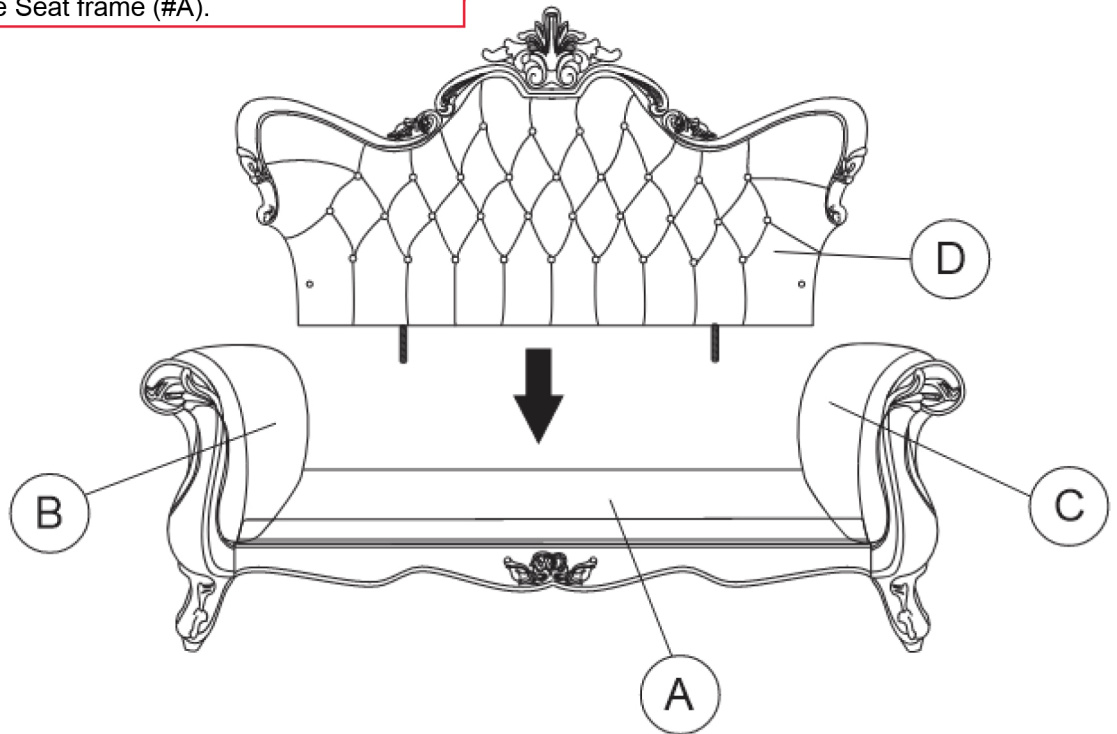

6

Hardware #1 x 2pcs  
Hardware #2 x 2pcs  
Hardware #3 x 2pcs

Lift Velcro and secure the Backrest (#D) to the arms by using Bolts (#3) with Lock washer (#2) with Flat washer (#1).

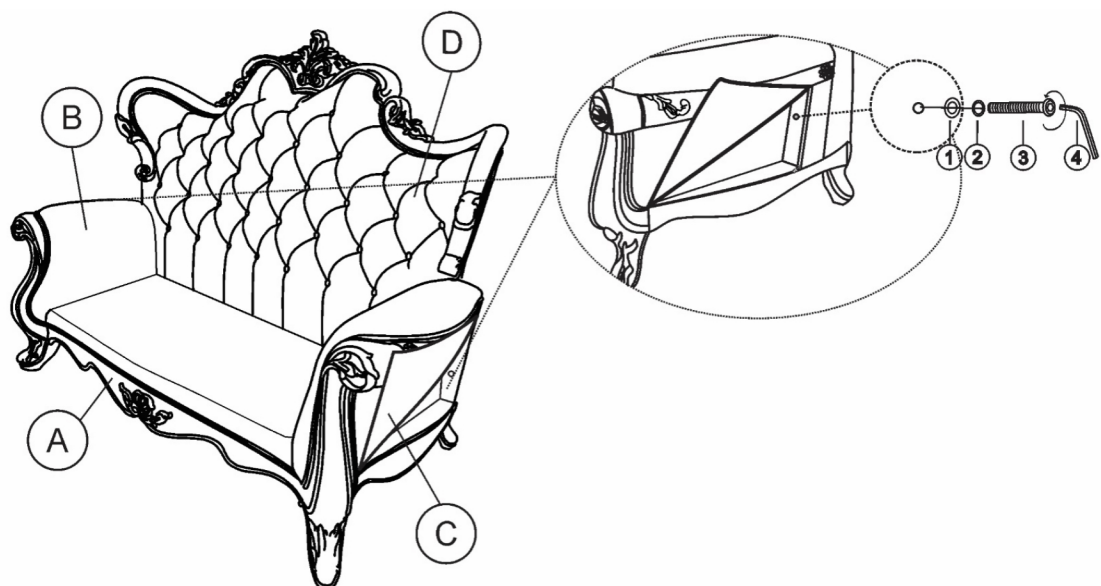

# ASSEMBLY INSTRUCTIONS

7

Hardware **#1** x 2pcs  
Hardware **#2** x 2pcs  
Hardware **#7** x 2pcs

Secure Backrest (#D) under the Seat frame (#A)  
by using Lock washer (#2) with Flat washer (#1).

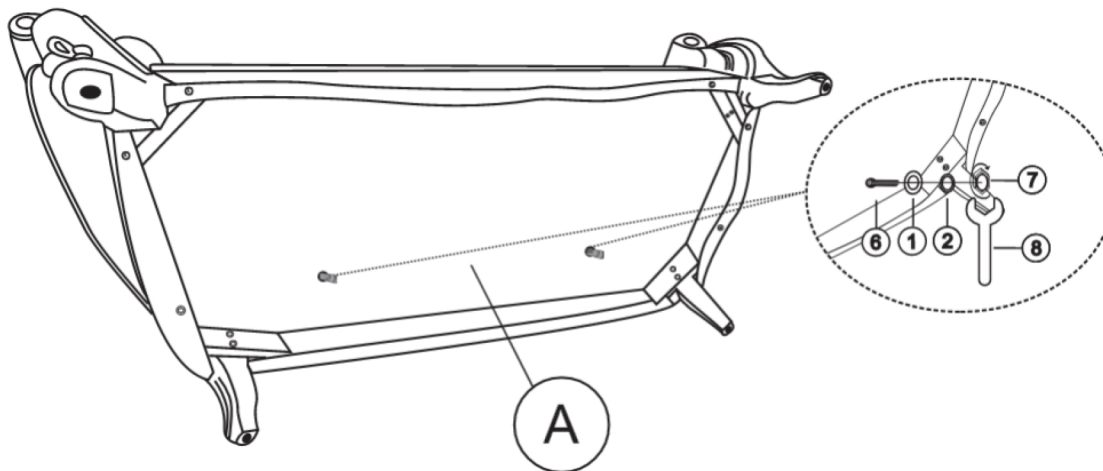

8

Part **#E** x 1pc

Place the Seat cushion (#E).

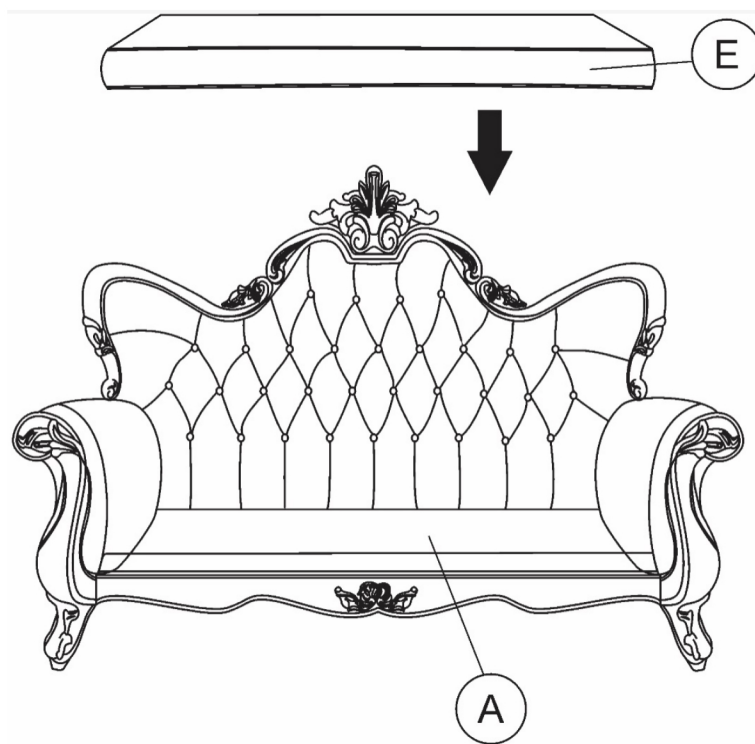

# ASSEMBLY INSTRUCTIONS

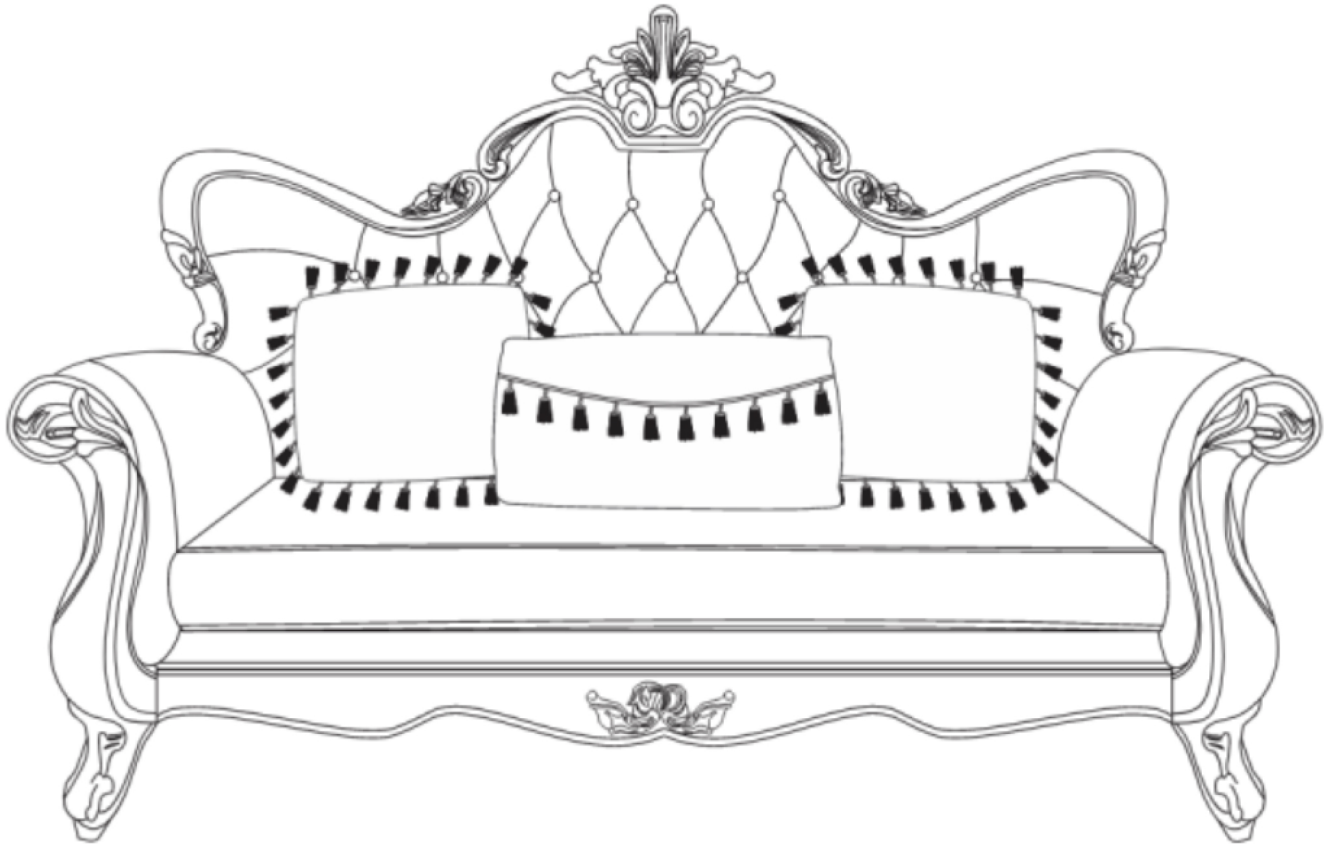

## ASSEMBLY COMPLETED



Please ensure the furniture rests on an even and flat surface. If the product wobbles or feels loose, double-check all bolts and/or screws are properly tightened and secured.



### Keep this handy!

Please retain this instruction manual and any order-related information for future reference.



### Lift, don't drag!

To avoid damage to product please always LIFT the product when transporting or adjusting the placement.