

1. Let the wire go through the hanging tube ① and round plate set ②, rotate to install both to the fixture, fixed the tube ② to the fixture with grub screw ④ by rotate hex key ⑤, and fixed the round plate set to the tube with mini screw.

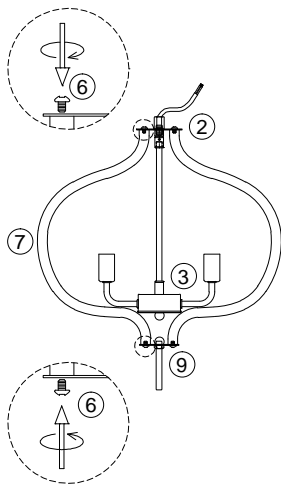

2. Install the metal profile ⑦ from hole of round plate ② to hole of bottom round plate ⑨ with bolt screw ⑥.

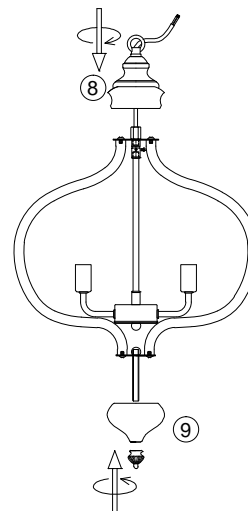

3. Let the wire go through the top cover group, rotate to install to the fixture, close the bottom cover with end cap ⑨.

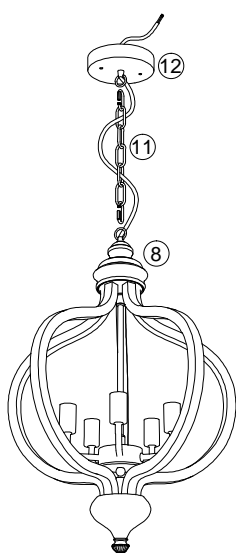

4. Hang the fixture to the canopy ⑫ with chain ⑪, let the wire go through the chain ⑪ and canopy ⑫.

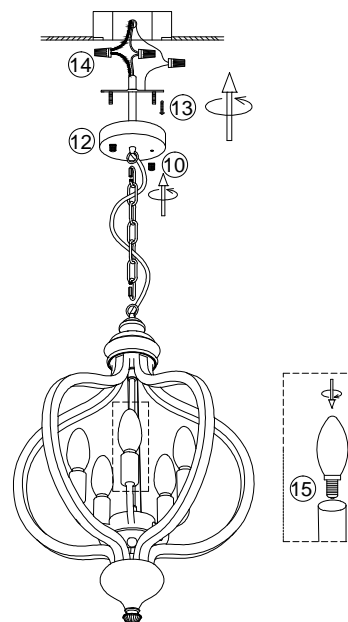

5. Install the bracket to the ceiling junction box with screw ⑬.
 6. Connect the wire to your home line with cap connector ⑭.
 7. Install the fixture to the bracket with cap nut ⑩.
 8. Install the bulb ⑮.

D0175-5

Please read carefully before installation!!!

Note : Please make sure that the electricity is powered off during installation !

Only a professional electrician should install this kind of product !