

# ASSEMBLY INSTRUCTION

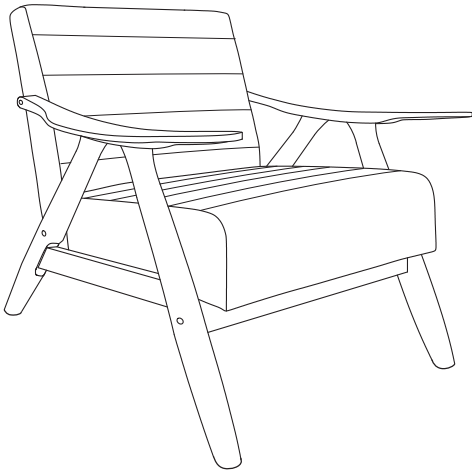

Thank you for purchasing this product. Please take time to read and follow the instructions below. Check that you have all parts and hardware before assembly. Parts apparently missing are often found in the packing materials. If you do not have all the parts listed, have your dealer contact us and they will be sent to you immediately.



It is recommended to install protective pads under all legs and supports to avoid damage or scratches when placing furniture on a wood floor or other hard surface, and to limit indentation and prevent discoloration if placing on carpet.



Hardware may loosen over time. Periodically check to make sure all connections are tight. Re-tighten if necessary.

PARTS LIST			
NO	DESCRIPTION	SKETCH	QTY
1	Back Rest		1 pc
2	Seat		1 pc
3	LSF Arm		1 pc
4	RSF Arm		1 pc
5	Cross Bar		1 pc

\*DO NOT TIGHTEN BOLTS UNTIL COMPLETELY ASSEMBLED.

HARDWARE LIST			
NO	DESCRIPTION	SKETCH	QTY
A	JCBC Bolt M6 x 80mm		6 pcs
B	Barrel Nut M6 x 13mm		2 pcs
C	Wood Dowel M8 x 30mm		4 pcs
D	Allen Key		1 pc
E	JCBC Bolt M6 x 40mm		2 pcs
F	Flat Washer M6 x 19mm		2 pcs

\*ABOVE HARDWARE ARE PACKED IN 1287 GY/BU/PE-1.

## STEP 1

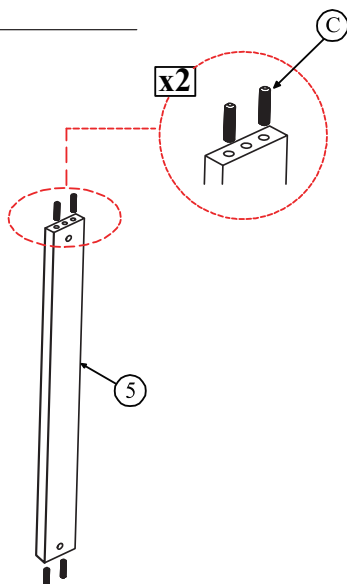

## STEP 2

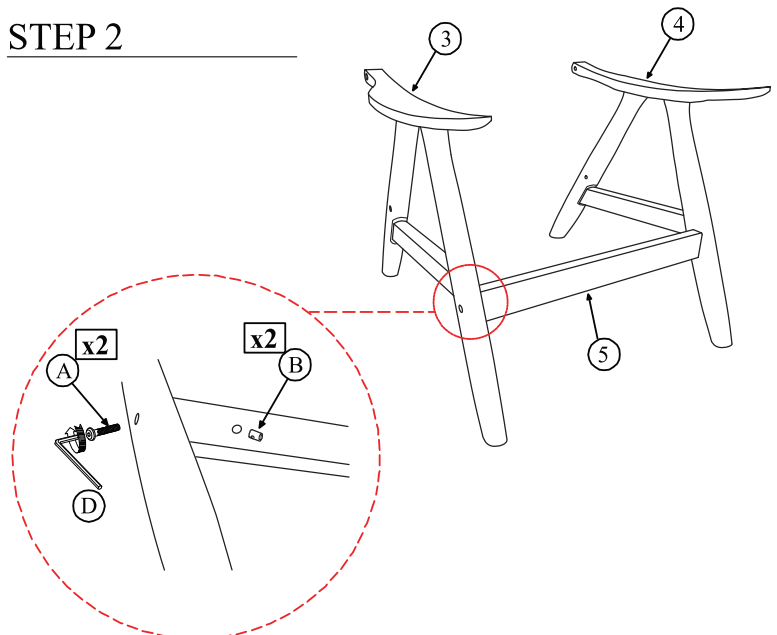

### STEP 3

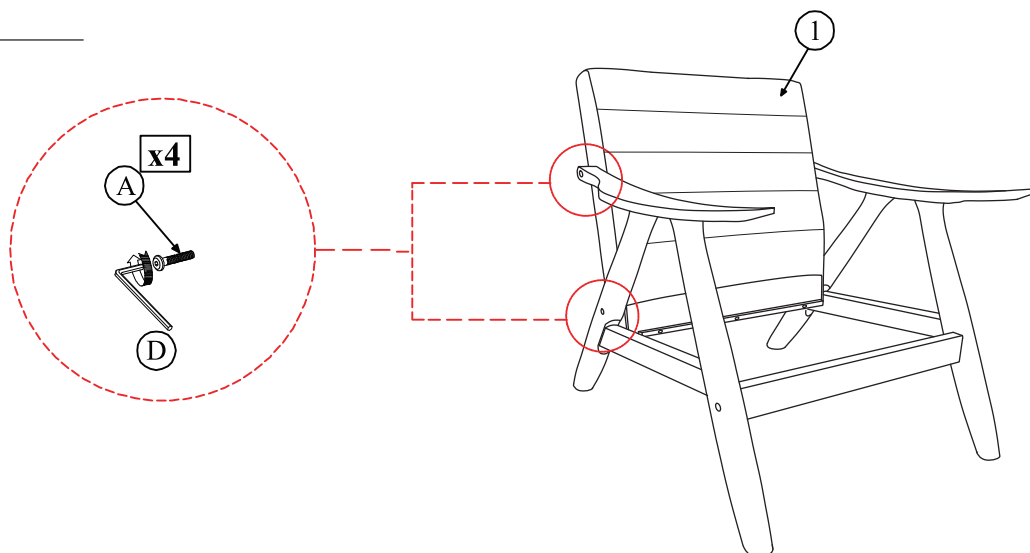

### STEP 4

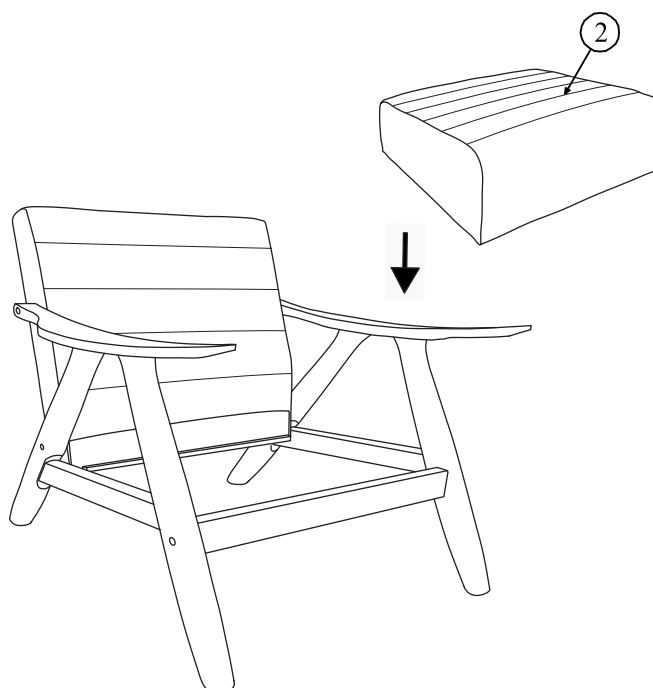

Push the seat cushion to the end,  
adjust the seat cushion pre-drilled  
hole onto back cushion support bar properly

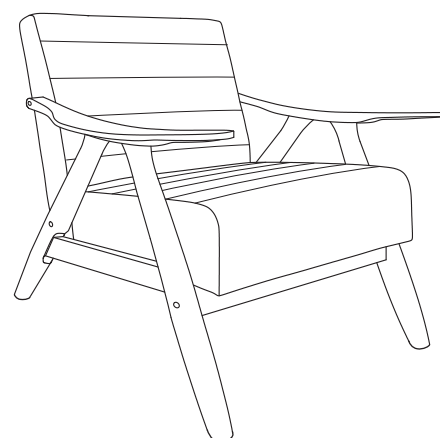
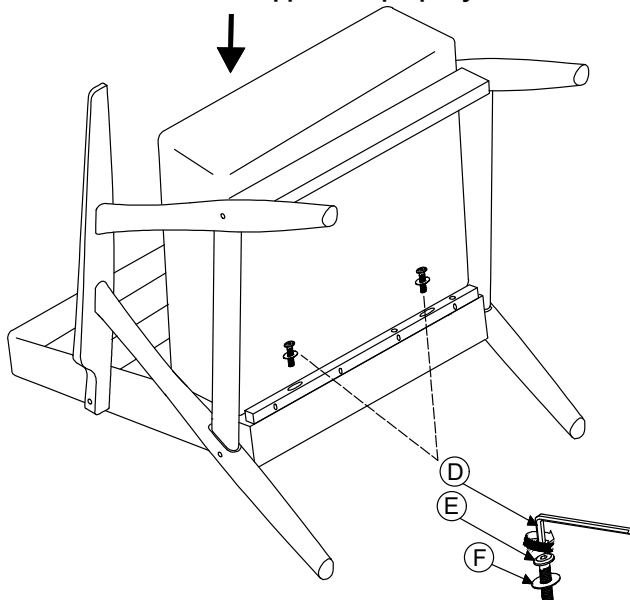

ASSEMBLY COMPLETED