

Assembly Instructions

COCKTAIL TABLE

Thank you for purchasing this quality product. Be sure to check all packing material carefully for small parts which may have come loose inside the carton during shipment. Identify and count all parts and compare with the Parts List below.



For items use on wooden floor, hard surfaces or carpets, it is recommended to Install protective pads under all legs and supports to avoid/ prevent from damages/ scratches and discoloration.

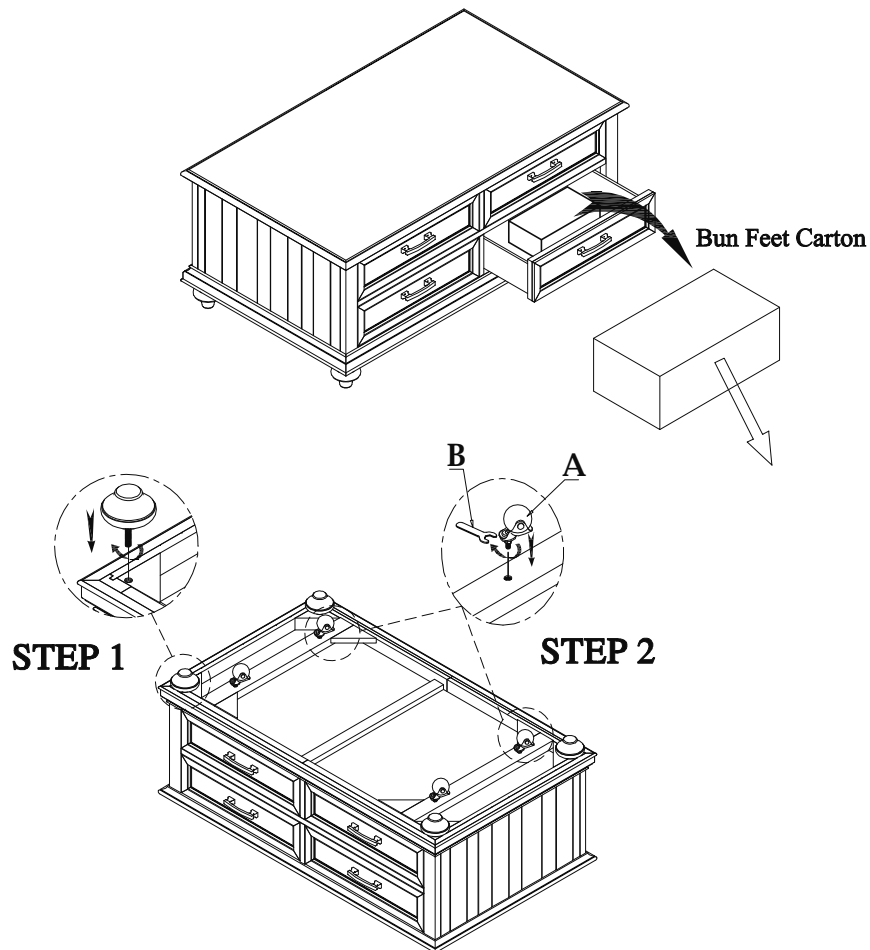

HARDWARE LIST

NO.	DRAWING	Q'TY	DESCRIPTION
A		4	CASTER
B		1	16mm OPEN WRENCH

PARTS LIST

NO.	DRAWING	QTY	DESCRIPTION
1		4	BUN FEET