

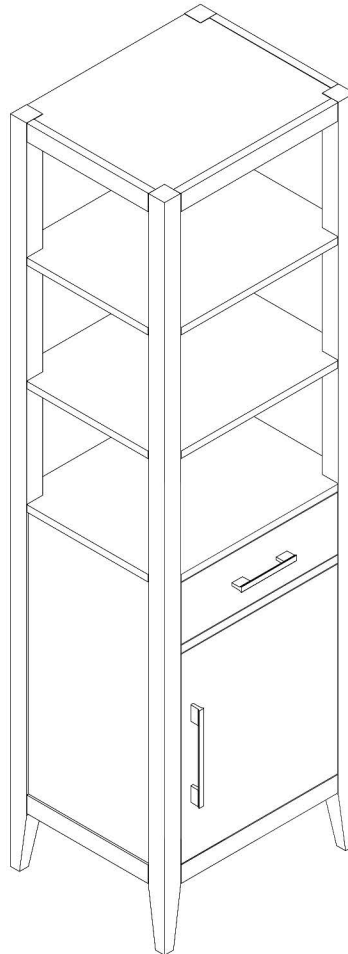

QUALITY BATHROOM FURNITURE

ASSEMBLY INSTRUCTIONS

VA90-LC, VANITY



Questions, problems, missing parts?
Before returning this product,
please call 833-9VANITY or email
info@vanityart.com

VANITYART.COM

THANK YOU

*We appreciate the trust and confidence you have placed in Vanityart by purchasing this vanity.
We strive to create quality products designed to enhance your home continually.
Visit our online store to see our full line of products available for your home improvement needs.
Thank you for choosing Vanityart.*

ASSEMBLY INSTRUCTIONS

VA90-LC

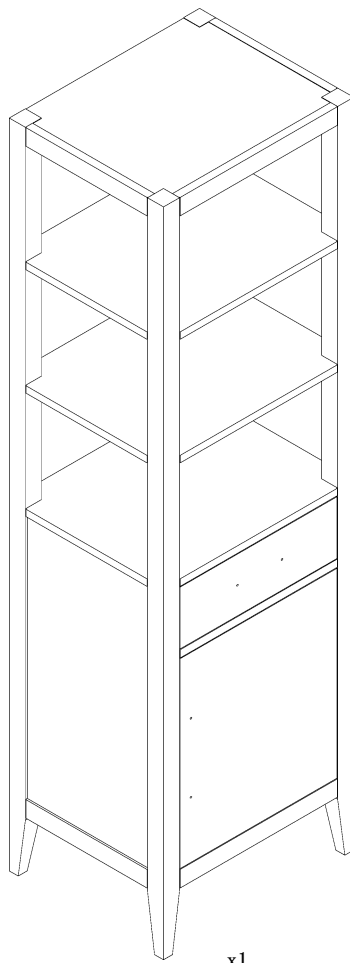

x1



Ax2



Bx3



Cx4



Cx6

Assembly Instructions

Step 1. Place the cabinet at its desired location and adjust the cabinet's height by rotating the adjustable leveler located on the bottom of each foot.

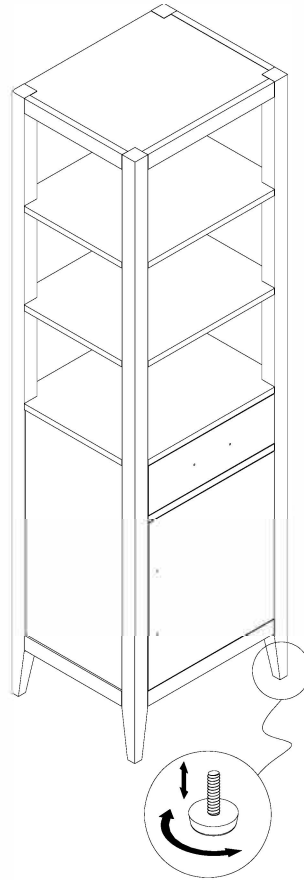

Step 2.

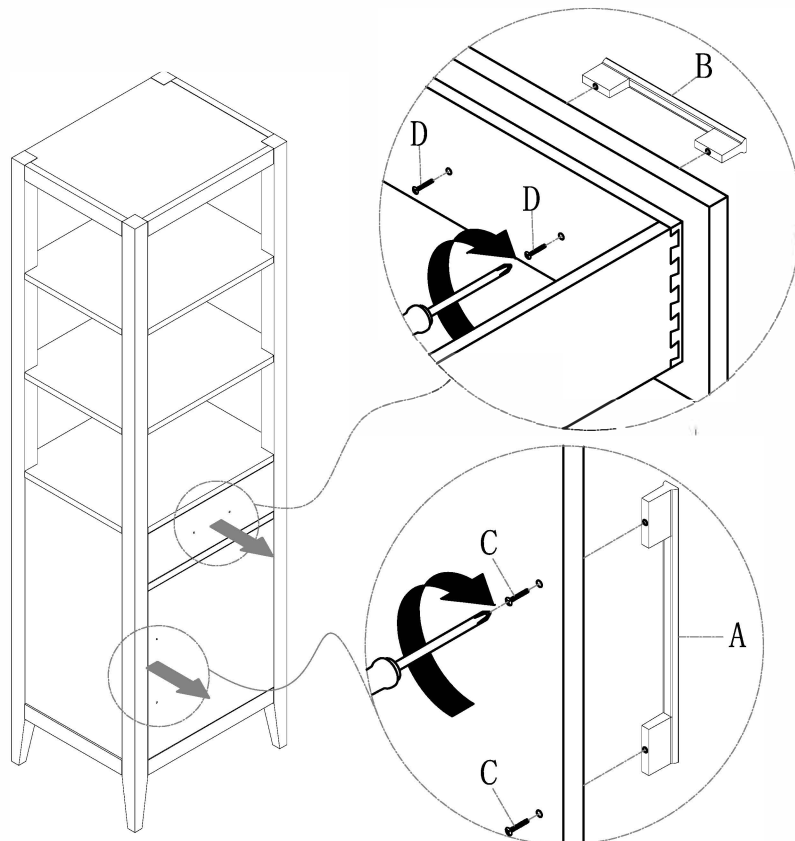

Assembly Instructions

Step 3. Mount the cabinet to the wall with appropriate hardware (hardware not included in the package).

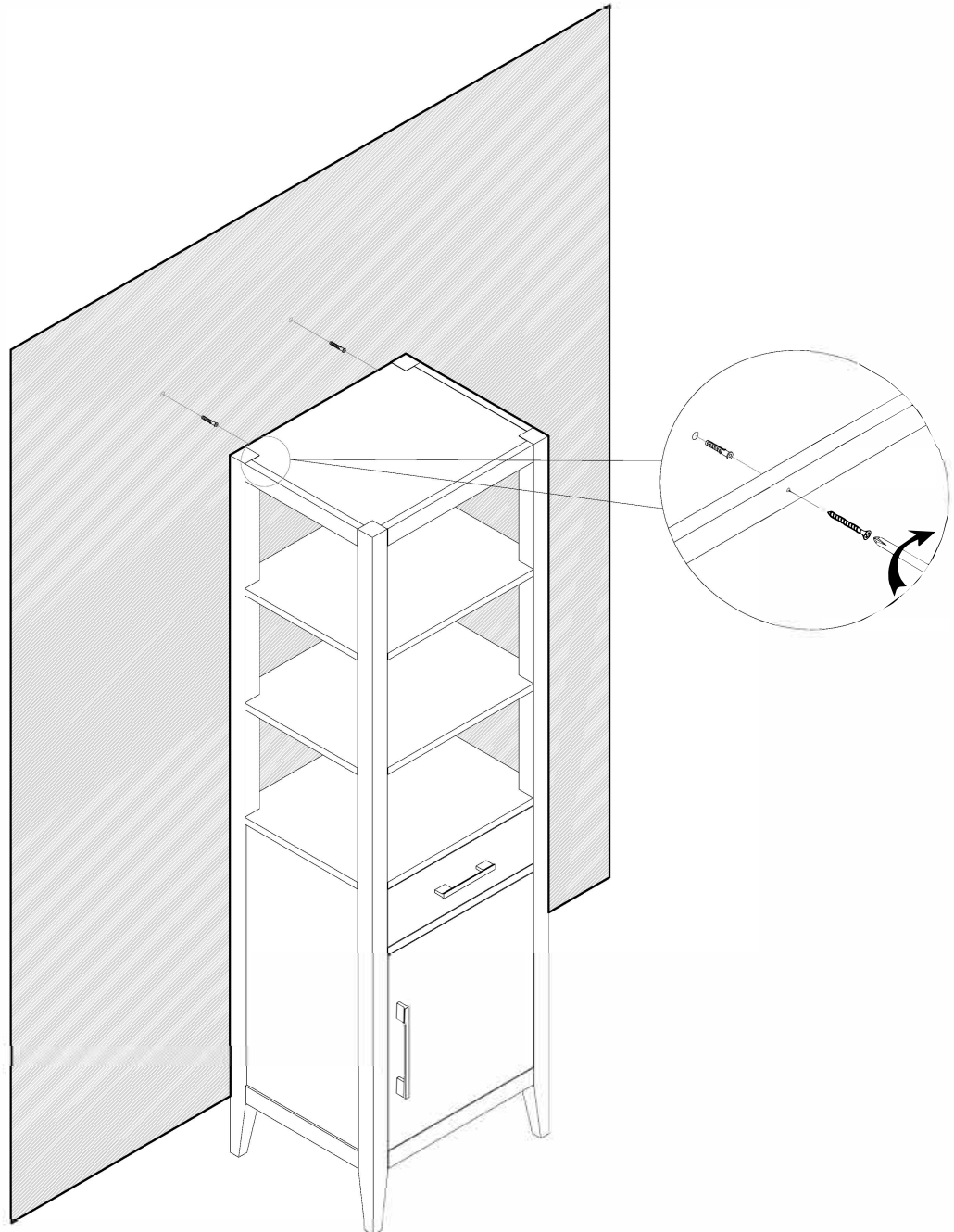

Assembly Instructions

To remove the drawer:

- Locate the clips on both sides of the bottom of the drawer.
- Press the clips simultaneously and gently lift the drawer.
- Remove the drawer from the slide rails and pull it out.

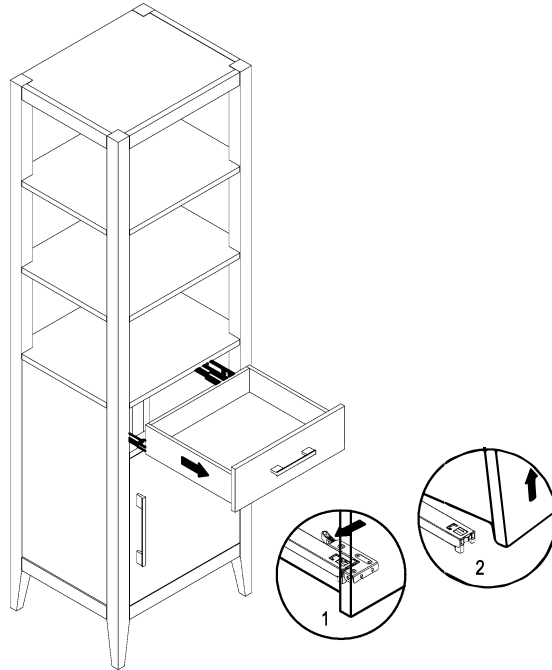

To insert the drawer:

- Fully extend the drawer slide tracks.
- Gently place the drawer into the hook on the back of the slide track.
- Lower the drawer onto the extended slide tracks.
- Slide the drawer until it is fully inserted.

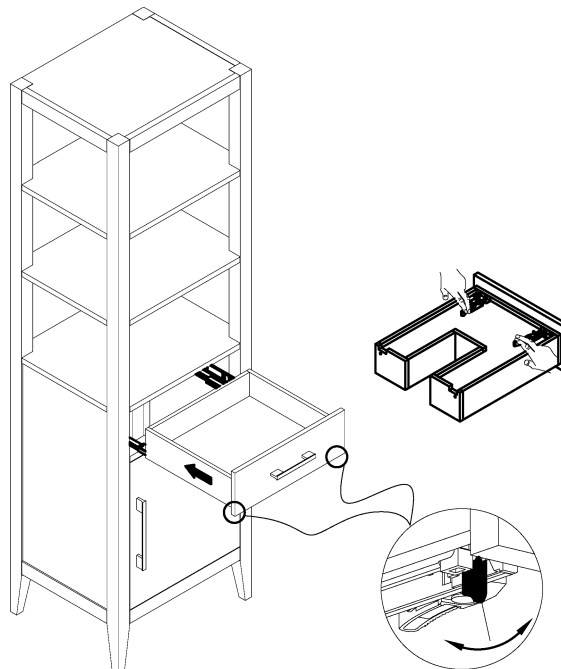

Assembly Instructions

The door comes pre-mounted on the right side but can be moved to the left side depending on your choice. Follow the guidance on how to remove/install/adjust the hinges on the next page.

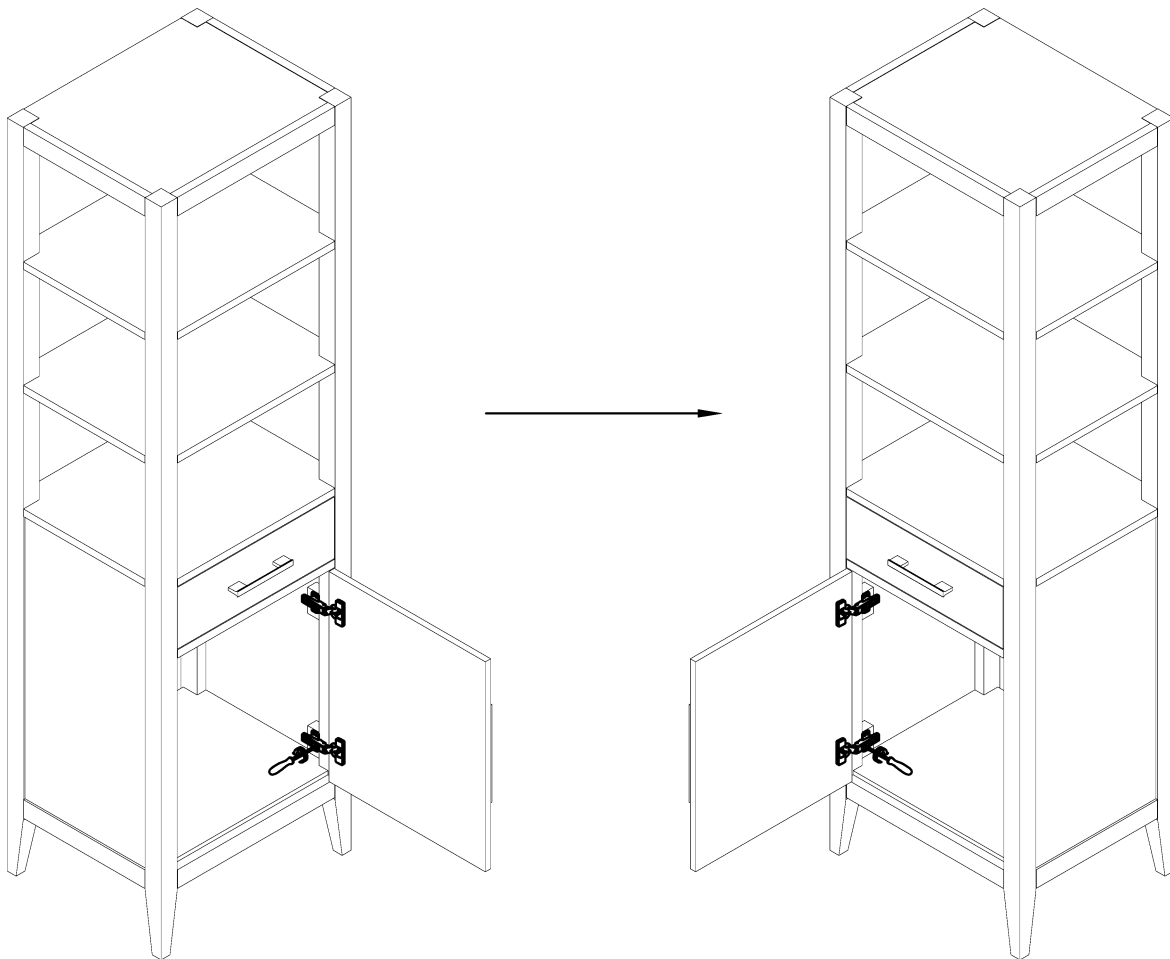

Assembly Instructions

To adjust the door:

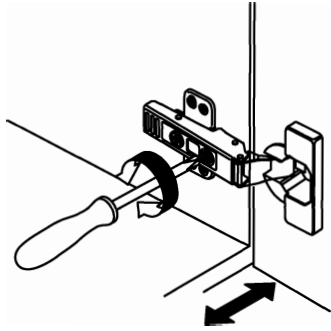

In & out adjustment

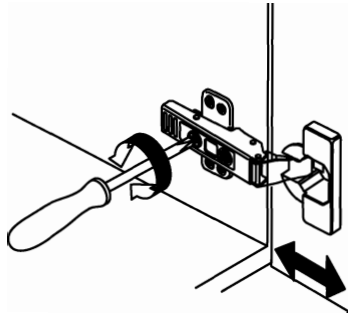

Left & right adjustment

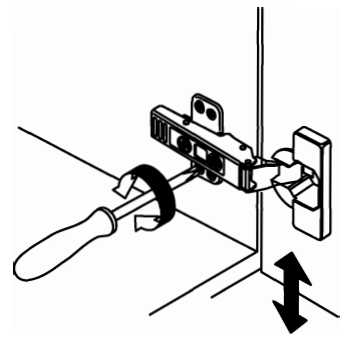

up & down adjustment

To remove or install the hinges:

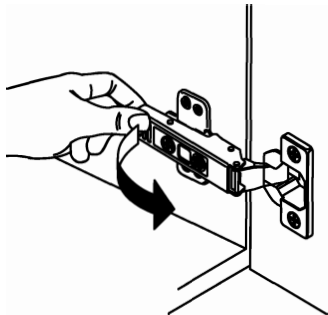

Remove

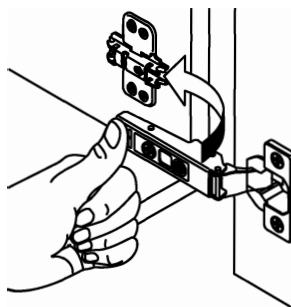

Install



QUALITY BATHROOM FURNITURE

**Questions, problems, missing parts?
Before returning this product,
please call 833-9VANITY or email
info@vanityart.com**

VANITYART.COM

Retain this manual for future use.