

1. Adjust the light arms to suitable position like picture showed.
2. Let the wire of the fixture ① go through the hanging tube ②, rotate the tube ② to install it to the light fixture ①, use hex key ⑩ to rotate the grub screw to fix the tube ②.
3. Let the wire go through the small crown ring ⑦ and the chain ③, rotate the ring of the chain ③ to install the crown ring ⑦ and chain ③ to the fixture ①.

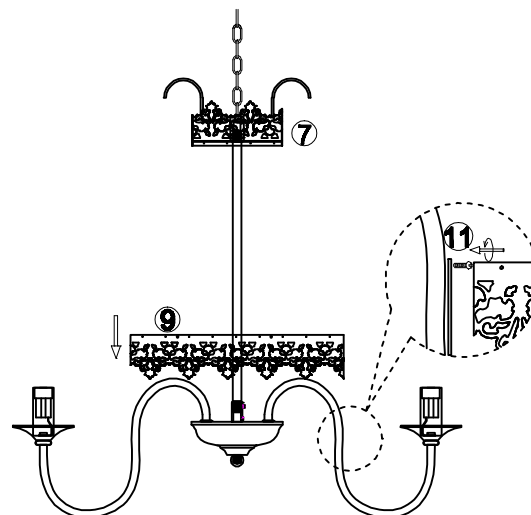

4. Put the big crown ring ⑨ to the light arms, fixed the ring ⑨ to the light arms with bolt screw ⑪.

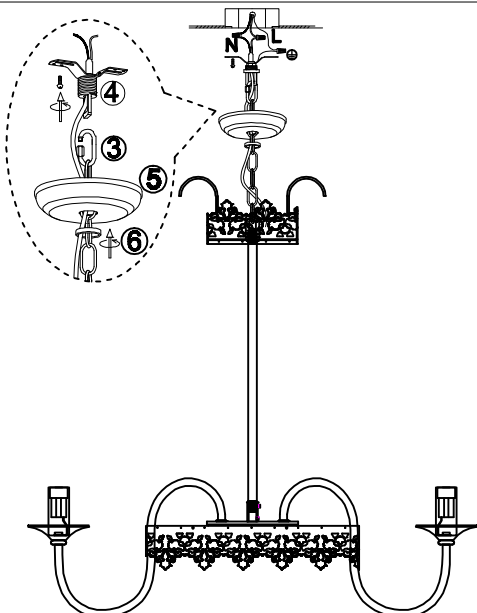

5. Install the bracket ④ to the ceiling junction box with screw.
6. Let the wire and the chain ③ go through the ring ⑥ and canopy ⑤, hang the fixture to the bracket with chain ③.
7. Connect the wire to your home line with cap connectors.
8. Push the canopy ⑤ up to the bracket ④ and lock it with ring ⑥.

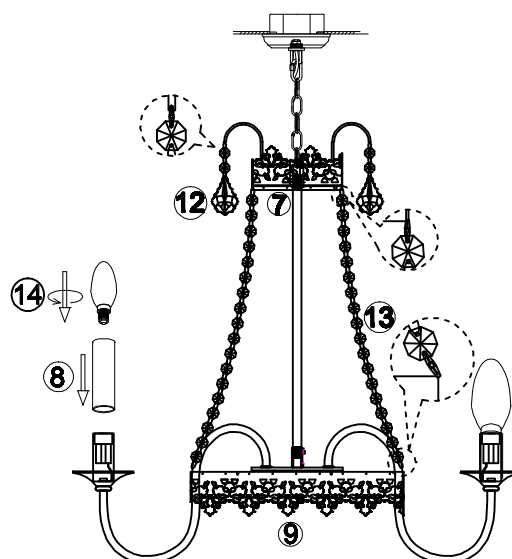

9. Hang the long crystal chain ⑬ from small crown ring ⑦ to big crown ring ⑨.
10. Hang the short crystal chain ⑫ to the ears of small crown ring ⑦.
11. Put the cylinder tube ⑧ to the bulb holder and install the bulbs ⑭.

**ZJD00051-6**

Please read carefully before installation!!!

Note : Please make sure that the electricity is powered off during installation !

Only a professional electrician should install this kind of product !