

Let's build the

Kayden Chair

SKU 28602

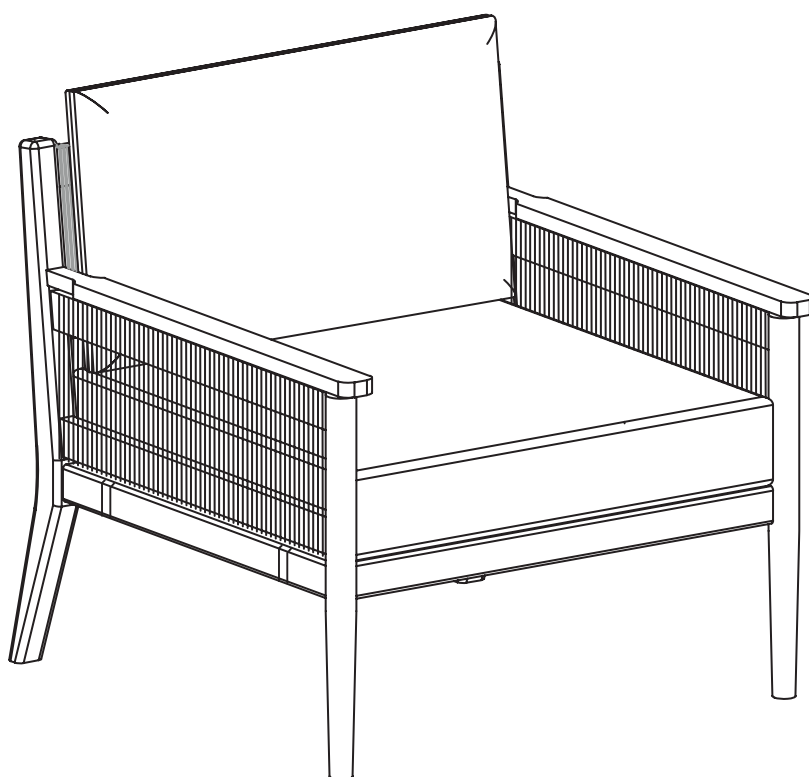

Scan me!

Free Lifetime
Warranty

nathan james

24-0129-VN

Ok, let's get rolling

This should be easy, just follow our instructions and you will be back to Netflix in no time.

Estimated time for assembly



30:00

What you need

- Some of your favourite bubbly or your preferred relaxant
- Use the packaging carton as a working surface to prevent product damage during assembly

Do not use a drill



Weight Limitation



300
lbs

Toll-free at 1-866-619-1004
Help@nathanjames.com
Nathanjames.com/help

What's included

Description		Qty
A	Side Frame Assembly (Left)	1
B	Side Frame Assembly (Right)	1
C	Back Frame	1
D	Seat Frame	1
E	Back Cushion	1
F	Seat Cushion	1
1	Ø1/4" x 1-3/4" Hex Button Head Bolt	4
2	Ø1/4" x 1/2" Spring Washer	10
3	Ø1/4" x 1/2" Flat Washer	10
4	Ø1/4" x 1-3/8" Hex Button Head Bolt	6
5	Allen Key	1
6	Wooden Dowel 10x30mm	8
7	Plastic Nailhead Footpad (Extra)	4

Scan me!

Free Lifetime
Warranty



The goods

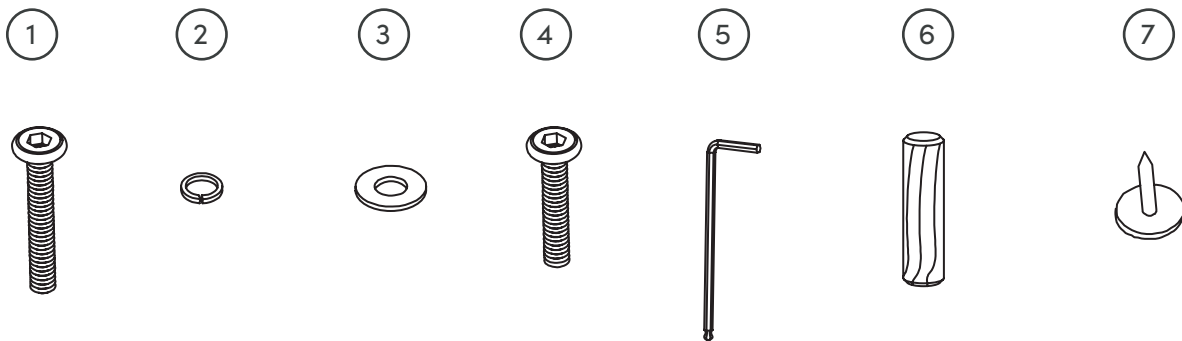
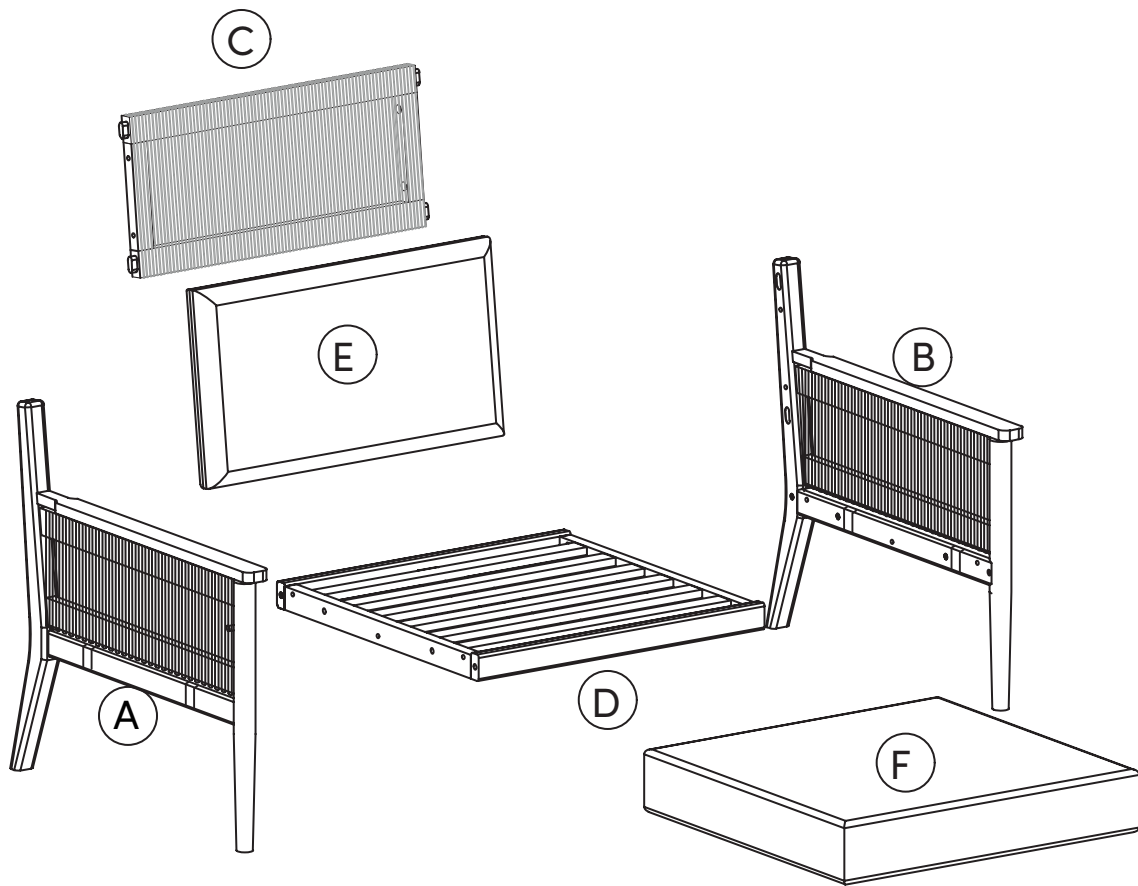

IMPORTANT

1. Do not tighten bolts / screws completely until all bolts / screws are lined up and inserted into holes.
2. Do not over tighten screws and bolts to avoid stripping.
3. Please use hand tools to assemble this product. Do not use power tools.

Step 1

Let's get this thing fired up! Insert the wooden dowels (6) into the Seat Frame (D).

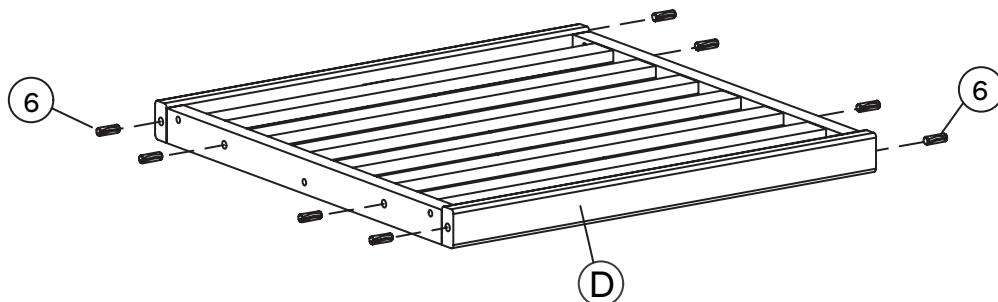

Step 2

Attach the Back Frame (C) to the Side Frame Assembly (A) using a $\text{Ø}1/4"$ x $1/2"$ Flat Washer (3), $\text{Ø}1/4"$ x $1/2"$ Spring Washer (2), and a $\text{Ø}1/4"$ x $1-3/4"$ Hex Button Head Bolt (1). Make sure the Top and Front arrows are facing the correct direction.

Tighten all bolts to 75%

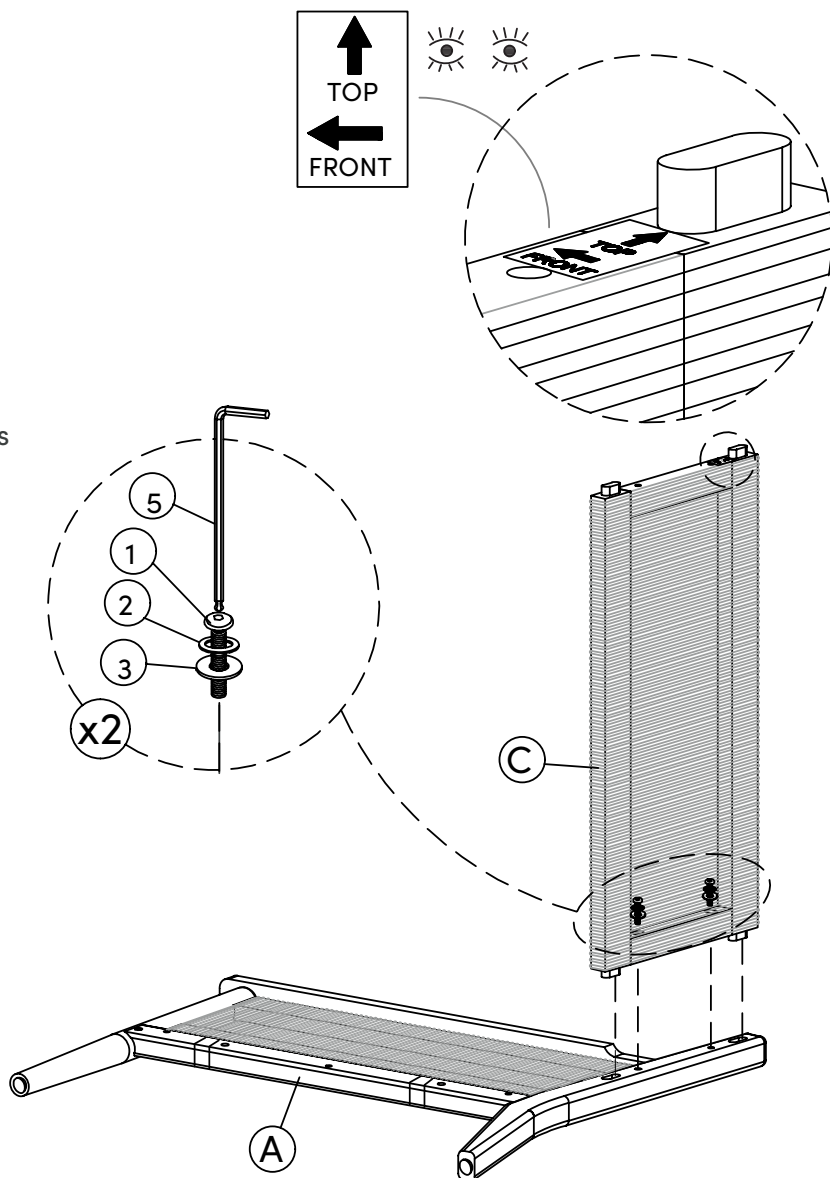
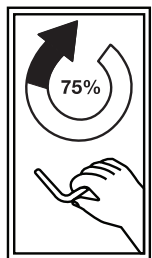

Step 3

Attach the Seat Frame (D) to the Side Frame Assembly (A) using three sets of the $\varnothing 1/4"$ x $1/2"$ Flat Washer (3), $\varnothing 1/4"$ x $1/2"$ Spring Washer (2), and $\varnothing 1/4"$ x $1-3/8"$ Hex Button Head Bolt (4), as shown below.

Tighten to 75%

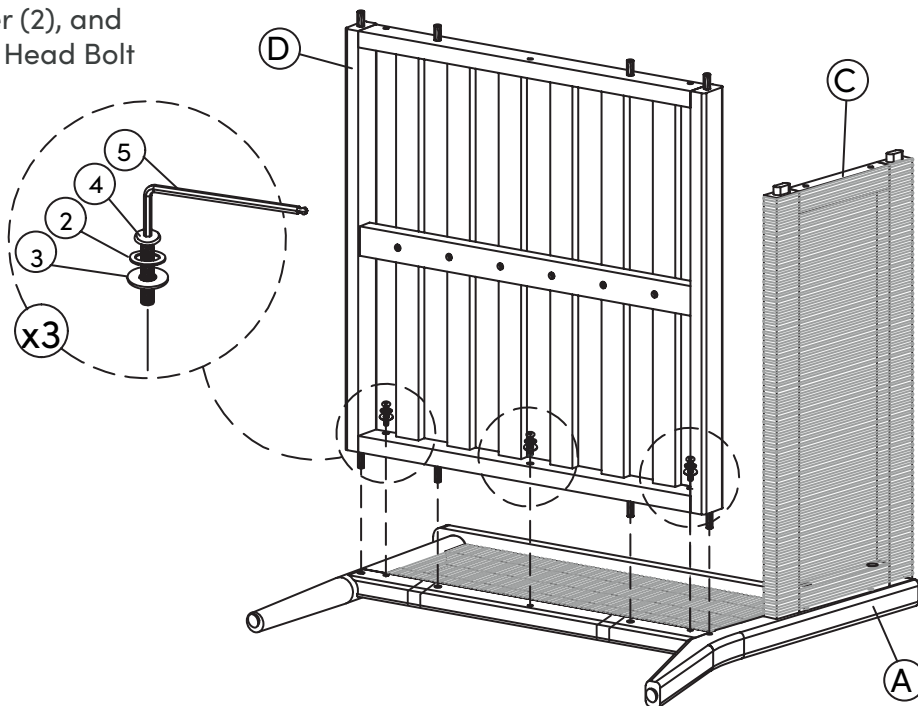
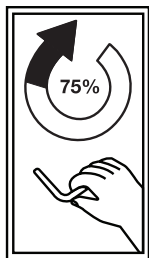

Step 4

Attach the Side Frame Assembly (Right) (B), as shown below.

Tighten to 75%

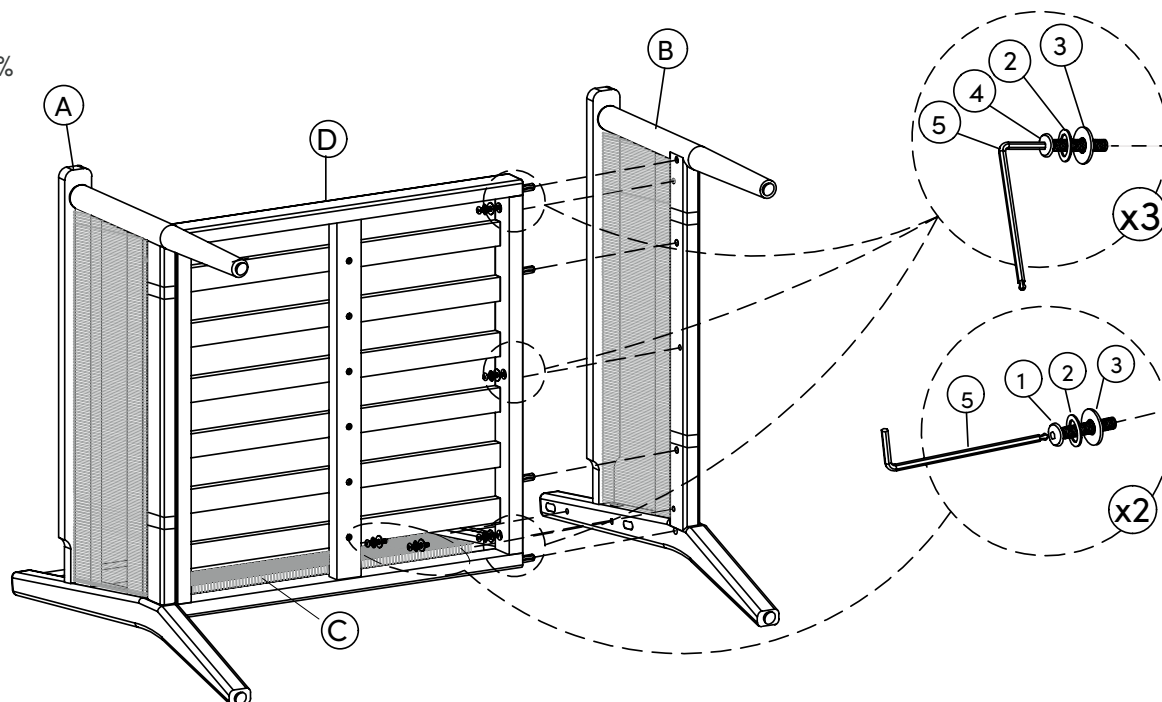
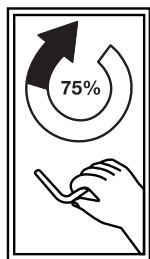

Step 5

You're within minutes of sitting back, relaxing,
and turning on your favorite Netflix show!

Tighten everything to 100%!

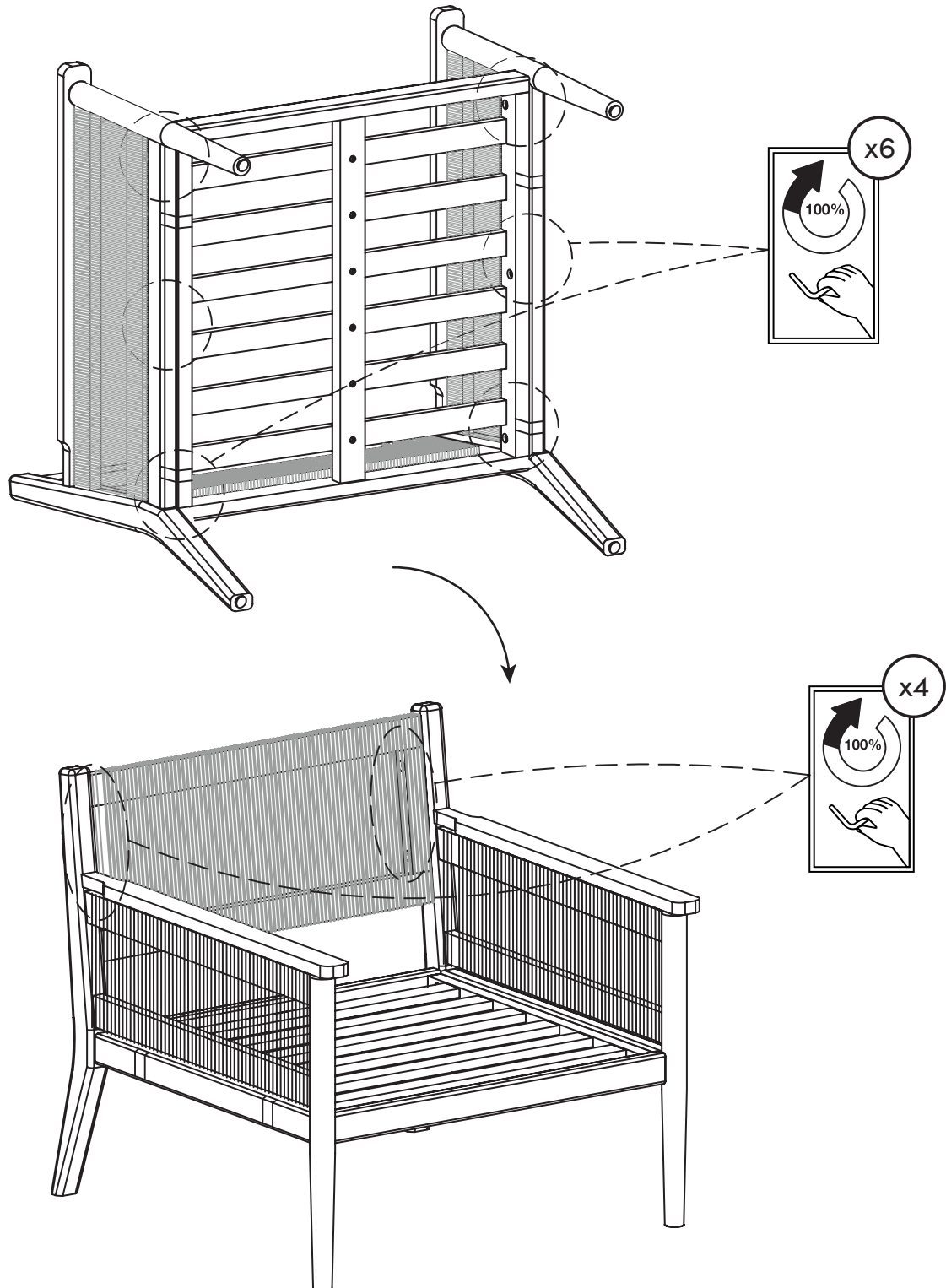

Step 6

Snack break? You deserve it.

Put down the Seat Cushion (F).

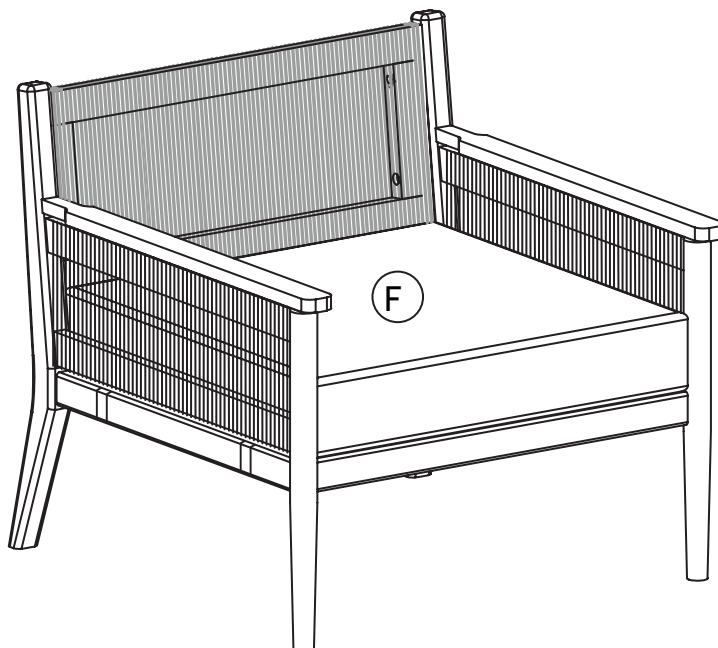

Step 7

Slide in the Back Cushion (E).
Cue the party music! You did it, have a seat!

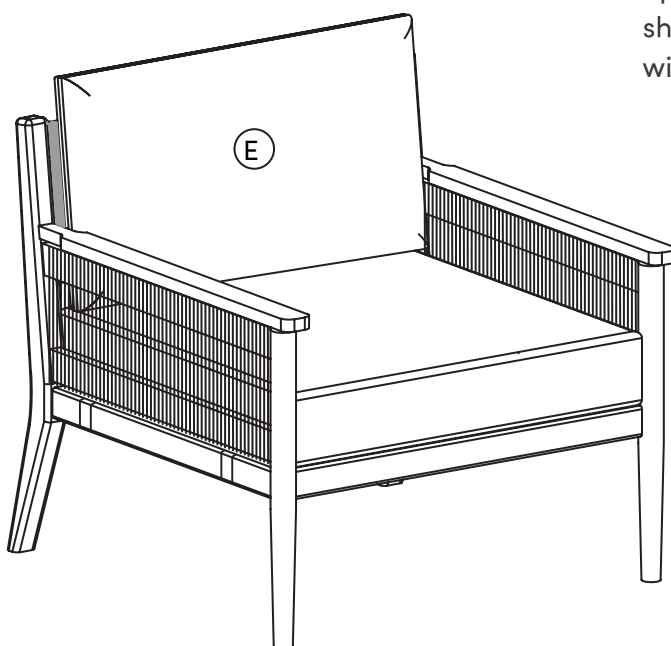

The back cushion is vacuum-packed, which may cause it to appear flat and compressed upon arrival. To restore its shape, gently fluff the cushion with your hands.

No heartburn, when we handle the return

Give us a call **1-866-619-1004** or shoot us a message
at **help@nathanjames.com** we will issue you a free
replacement with **zero hassle**.

Our way



Give us a call



Replacement



You

Their way



Re-package item



Schedule pick up



Track package



Replacement



You

We really don't want you to go through the hassle of re-packaging your item
and sending it back, because let's be honest...nobody has time for that.

Safety first, fun later

We want your product to last as long as possible, so we recommend that you tighten the screws 2 weeks after assembly and for added safety check the tightness of all screws every 2 months.

For proper care and treatment, please check our website at NathanJames.com/products

Safe use of this product starts with you.

Use this product responsibly with the primary concern for your safety. Follow assembly instructions carefully and inspect product upon receipt and each use.

Nathan James and its parent companies cannot be held legally responsible for any injuries or death resulted from failure to follow instructions or improper use of this product.

Do not modify the structure of this product in any way.

Our products have been tested to meet specific safety measures as they were originally intended to be sold. Any modifications will present the risk of creating significant safety issues which NJ will not be responsible for.

Proper use

- | | |
|---------------|----------------------------------|
| DO NOT | use for commercial purposes |
| DO NOT | frolic on loveseat |
| DO NOT | use loveseat as foot stool |
| DO NOT | leave spilled liquid on loveseat |
| DO NOT | use loveseat if damaged |
| DO NOT | make temporary repairs |

We are only in business if you're happy

For starters, thanks for being you.

☎ Toll-free at 1-866-619-1004

✉ Help@nathanjames.com

🌐 NathanJames.com/help

We do our best to ensure your furniture arrives without any problems, but occasionally mistakes happen—as humans we are imperfect beings. In the event that a part is damaged or missing, we will be more than happy to provide you with replacement part(s) for free.

Warranty

This product comes with a lifetime warranty from the date of purchase. Please use your phone to scan the QR code to register your product or visit <https://goo.gl/i9dk3q>

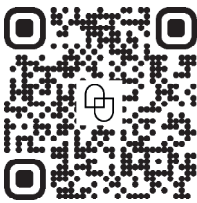

Did we do alright? Please spread the love!

If you are happy with your product, tell your friends and family about us or even better leave us a review online. Spreading the word gives us the opportunity to make more people happy and keep our prices low for your next purchase.

Brooklyn Burdon

Founder, Nathan James