



ASSEMBLY INSTRUCTIONS

COASTER FINE FURNITURE



Fine Furniture for every stage of life

709677
End Table

REVISION 0 : 10/12/2023
REVISION 1 : 12/26/2023

PAGE 1 OF 3

COASTERFURNITURE.COM

ITEM: **709677**



ASSEMBLY INSTRUCTIONS

ASSEMBLY TIPS :

1. Remove hardware from box and sort by size.
2. Please check to see that all hardware and parts are present prior to start of assembly.
3. Please follow attached instructions in the same sequence as numbered to assure fast & easy assembly.



WARNING !

1. Don't attempt to repair or modify parts that are broken or defective. Please contact the store immediately.
2. This product is for home use only and not intended for commercial establishments.

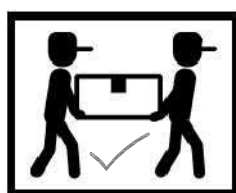

ASSEMBLY TIME

15 MINUTES

PARTS IDENTIFICATION

A	TOP		1PC
B	LEG		3PCS
C	METAL PLATE		3PCS

HARDWARE IDENTIFICATION

1	ALLEN WRENCH (M4 x 63mm - BLK)		1PC
2	BOLT (M6 x 20mm - RBW)		12PCS
3	HEX HEAD SCREW (M5 x 38mm - RBW)		9PCS
4	LOCK WASHER (1/4" - BLK)		12PCS

ITEM: **709677**
ASSEMBLY INSTRUCTIONS



STEP 1

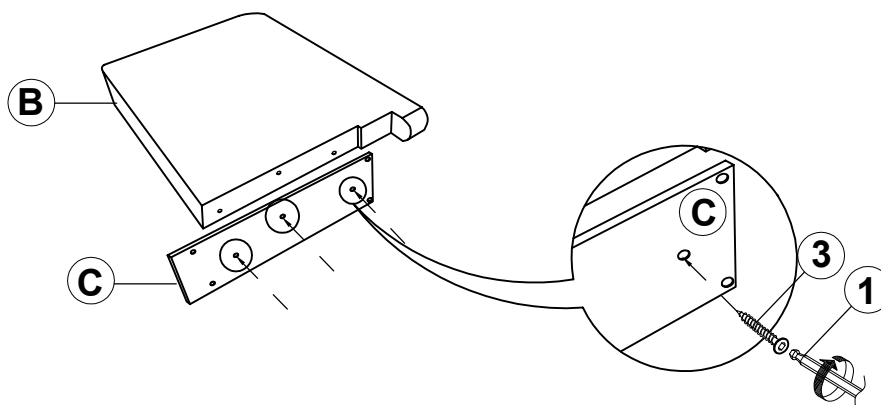

STEP 2

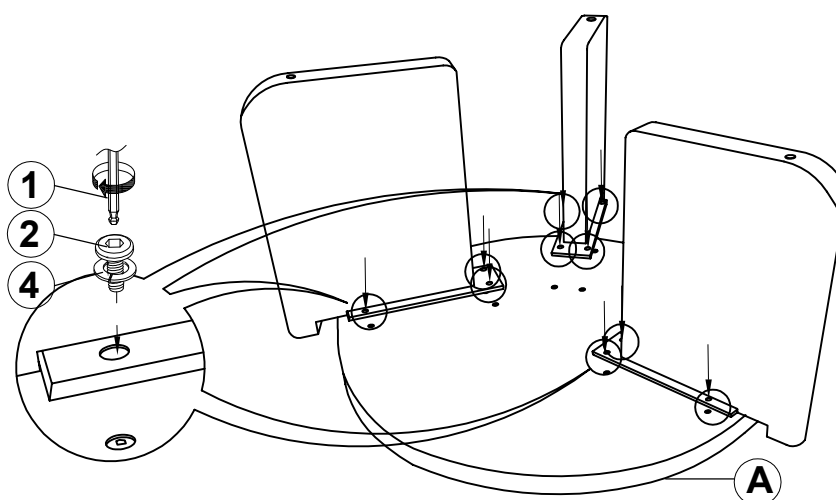

STEP 3
COMPLETE

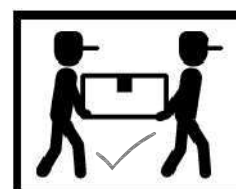
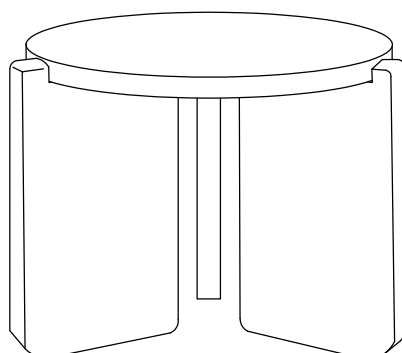

ITEM: **709677**

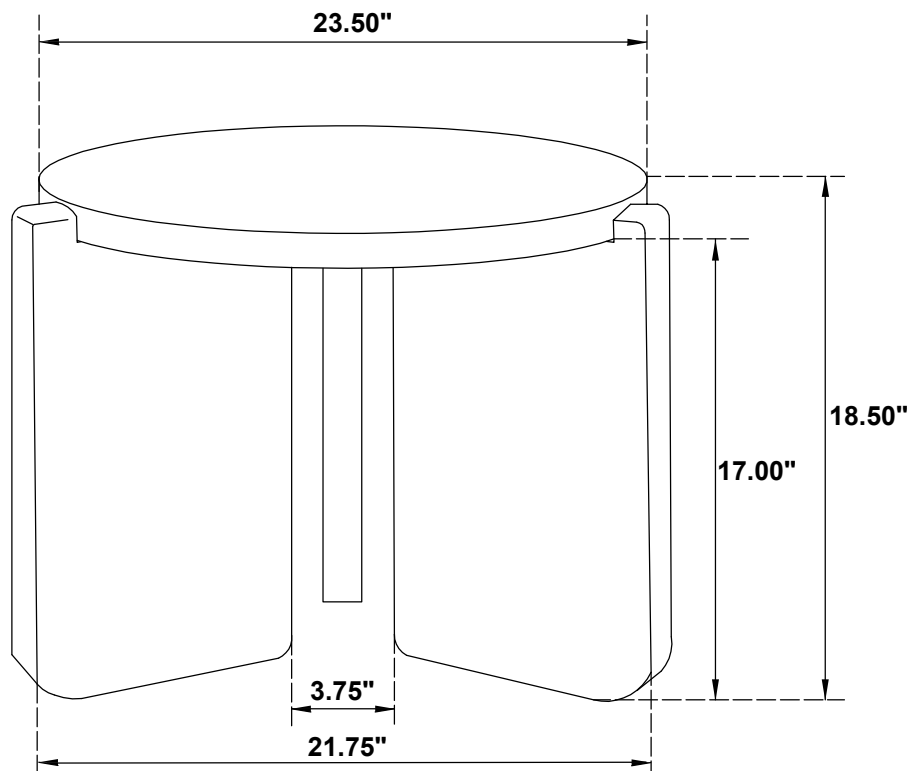

Note: Dimension tolerance $\pm 5\%$