

1. Install the arms on the base 1 with nut and ring.

1. Pull the orange operating handle A to open the inlet hole, insert the wire B.
2. Press the operating handle A to finish wiring.
(Note: one inlet hole can put 2 or 3 wires inside)

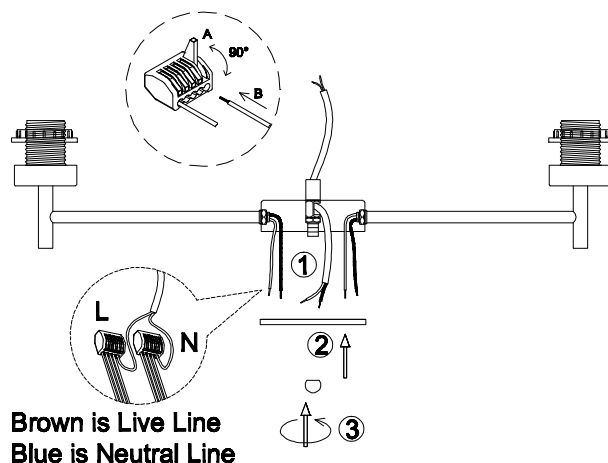

2. Connect all the wires by parallel with connectors 2 (all live line-L use one connector, and neutral Line-N use another connector)
3. Fix the cover 2 on the base 1 with nut 3.

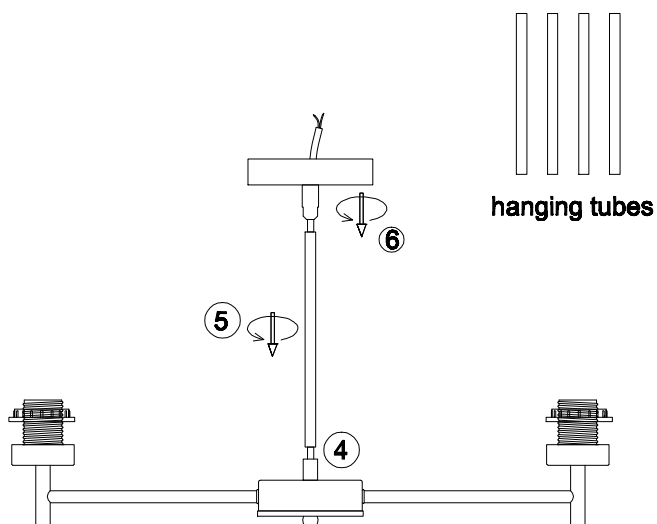

4. Let the main wire 4 go through the tube 5 and the canopy 6, turn to fix them.

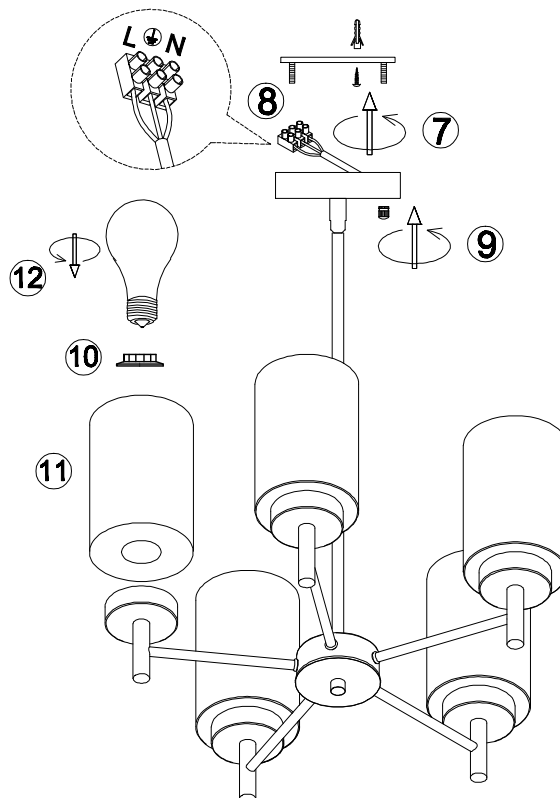

5. Install the bracket on the ceiling with screw and explore tube 7.
6. Connect the wire with connector 8 to your home line
7. Install the whole fixture to the bracket with nuts 9
8. Install the glass lampshade 11 on the bulbholder with ring 10, and install the bulbs 12

D0069/5 series Installation Manuel

Please read carefully before installation!!!

Note : Please make sure that the electricity is powered off during installation !

Only a professional electrician should install this kind of product !