

1. Install the arms ② to the bottom plate ③ by grub screw ①, and adjust the arms to the right position.

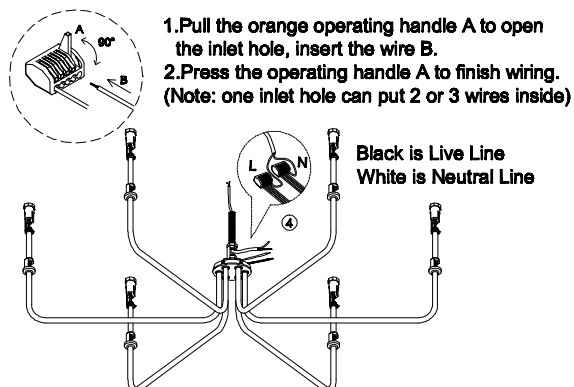

2. Connect all the wires by parallel with connectors ④ (all live line-L use one connector, and neutral Line-N use another connector).

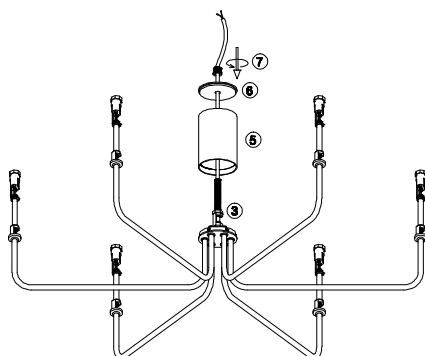

3. Install the cover ⑧ and the tube ⑤ on the bottom plate ③ with thread rod ⑦.

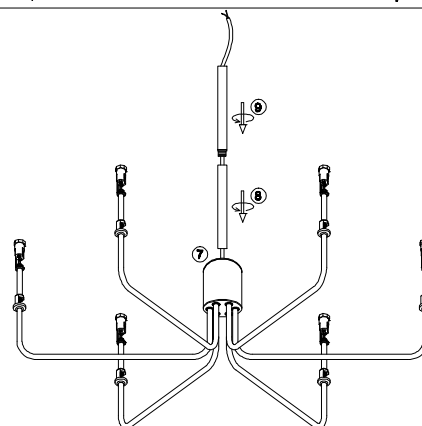

4. Let the wire go through the tube ⑧ and tube ⑨, rotate to fix two tubes on thread rod ⑦.

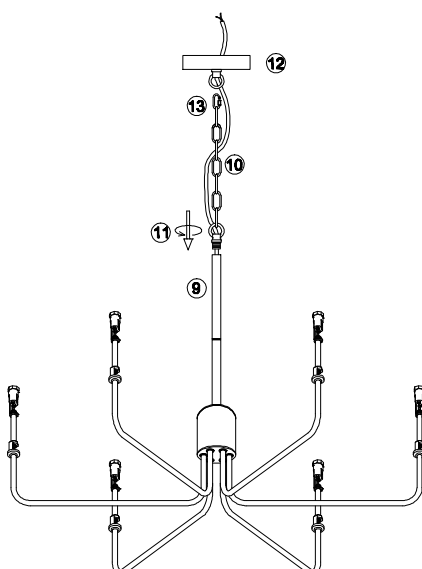

5. Let the wire go through the ring ⑪ of the chain ⑩, rotate the ring ⑪ to fix chain ⑩ to the fixture, connect the chain ⑩ to the canopy ⑫ by carabiner hook screw connection ⑬, let the wire go through the chain ⑩ and canopy ⑫.

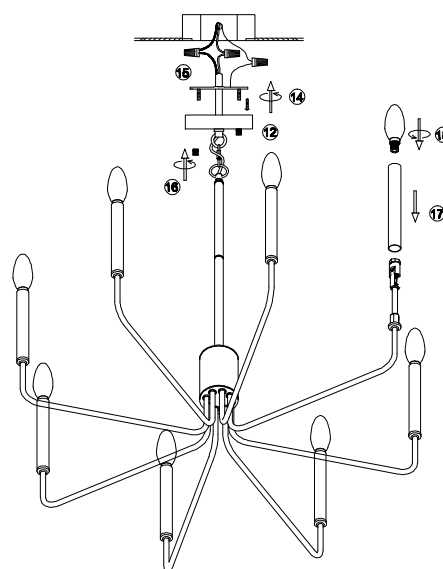

5. Install the bracket ⑭ to the ceiling junction box.
6. Connect the wire ⑮ to your home line.
7. Install the fixture to the bracket with cap nuts ⑯.
8. Put the cylinder tubes ⑰ on the lampholder and install the bulbs ⑱.

D0133/6/8

Please read carefully before installation!!!

Note : Please make sure that the electricity is powered off during installation !

Only a professional electrician should install this kind of product !