



Before You Begin

Check to make sure you have the following:



(2) BOLT M6 x 40 mm



(2) BOLT M6 x 65 mm

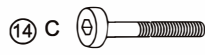

(2) BOLT M8 x 60 mm

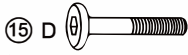

(6) BOLT M6 x 60 mm



(4) BOLT M6 x 35 mm



(4) SCREW ST4.2 x 16 mm



(38) WASHER d6.5 x D13 x 1.0 mm



(2) WASHER d8.5 x 17 x 1.6 mm



(14) JAM NUT M6 x 1.0mm



(4) LEG CAP



(8) BOLT M6 x 15 mm



(2) SUSPENSION SPRING



(2) PLASTIC SCREW



(2) CANOPY/FRAME CONNECTOR



(3) PILLOW



(1) CANOPY



(3) BACK CUSHION



(3) SEAT CUSHION



(2) BOLT M6 x 57 mm

Tools



I



II



III

Part Identity

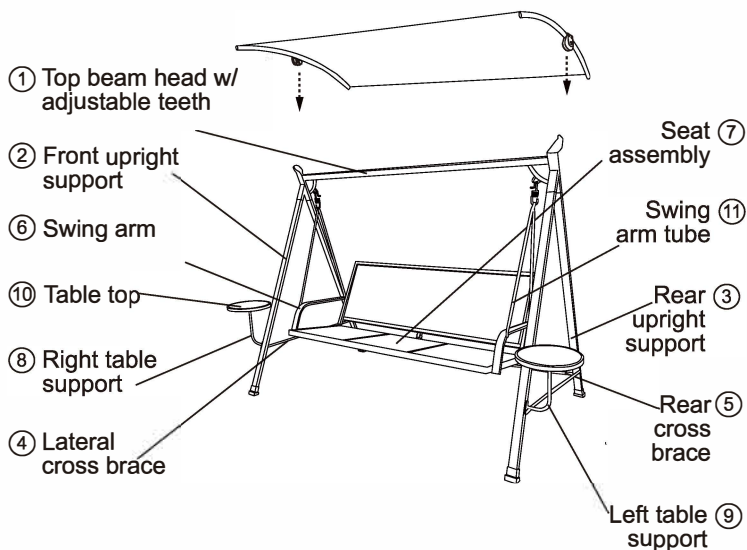

Preparation

- Remove all parts from packaging. Check your quantities with chart to the left.
- Spread out all parts on a soft, level surface to avoid scratching parts.
- **Do not tighten nuts with wrench until assembly is complete.**

WARNING

- Use the correct bolts as indicated. Do not tighten any of the bolts until the table is completely assembled.
- Do not discard any of the packaging until you have checked that you have all of the parts and fittings required.
- Keep children away during assembly. This item contains small parts that can be swallowed by children.
- Children should always be under direct adult supervision while using this product.
- Retain these assembly instructions for future reference.
- Quote the following FQC NO. When contacting the service center.

ATTENTION: THIS PRODUCT IS NOT FOR COMMERCIAL USE INTENDED FOR RESIDENTIAL USE ONLY

Assembly Instructions

Note:

When fastening with bolts and nuts, always use a washer (G and H) between the tube and the bolt and the tube and the nut.

Step 1:

Insert the upright supports into the top cross beam w/adjustable teeth. Fasten them by using bolts (E), washers (G) and jam nuts (I). Keep the bolts loose. Do the same procedure for both sides. See Fig. A – Step 1 and Step 2.

Step 2:

Fasten the left table support labelled “L” to the front upright support by using bolts (B and D), washers (G) and jam nuts (I). Fasten one lateral cross brace to the rear upright supports by using bolts (D), washers (G) and jam nuts (I). Do the same procedure for the other side. See Figure A – Step 3.

Note:

The labels marked “L” and “R” on the table supports should coincide with Figure A - Step 3 to ensure proper assembly.

Step 3:

Fasten the rear cross brace to the rear upright supports by using bolts (A), washers (G), and jam nuts (I). See Figure A – Step 4.

Step 4:

Insert the leg caps (J) into all of the base feet. See Fig. A – Step 5.

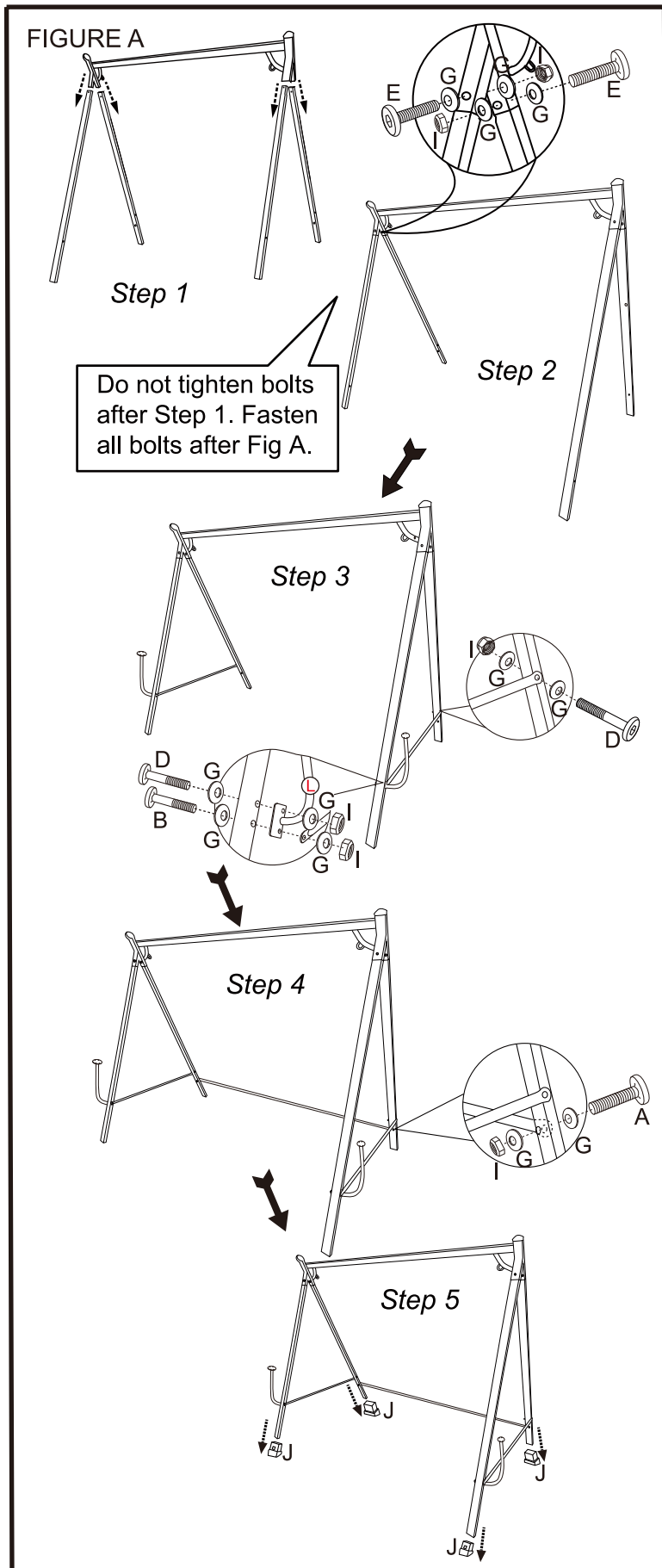

Assembly Instructions

Step 5:

Fasten the table top to the table supports by using bolts (K) and washers (G).

Tighten all of the nuts and bolts.

See Figure B - Step 6.

FIGURE B

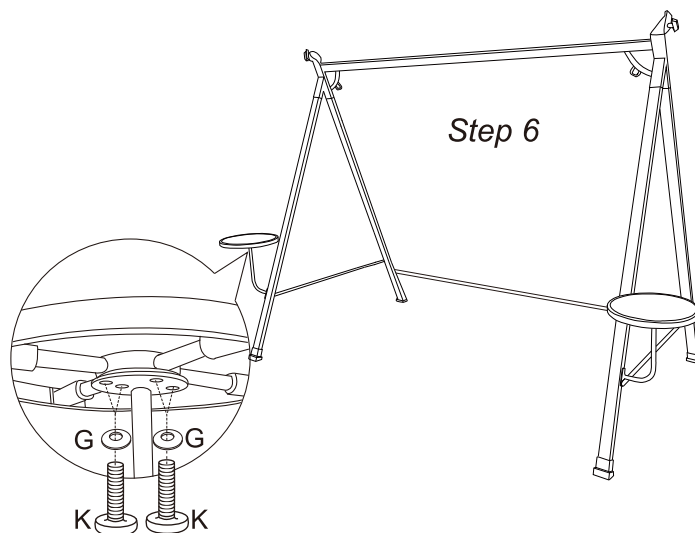

Step 6:

Open the seat assembly and fasten a swing arm tube and a swing arm to the seat back by using bolt (D), and washers (G). Do the same procedure for both sides. Fasten another swing arm tube to the swing arm at the front bend by using bolt (S), washers (G), and jam nut (I). Do the same procedure for both sides. Fasten the other end of the swing arm to the front of the seat assembly by using bolt (C), and washers (H). Do the same procedure for both sides. See Figure C.

FIGURE C

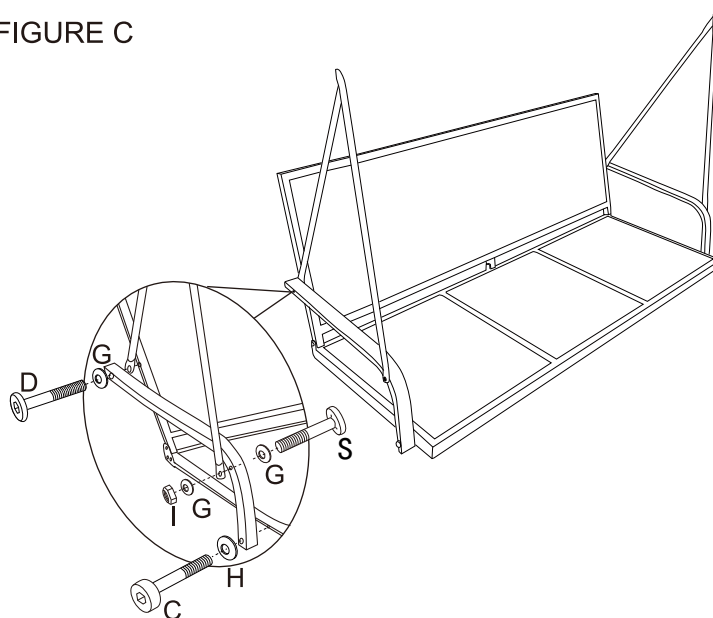

Assembly Instructions

Step 7:

Hook the suspension spring (L) into the top of both swing arm tubes.

Do the same procedure for both sides.

See Figure D.

FIGURE D

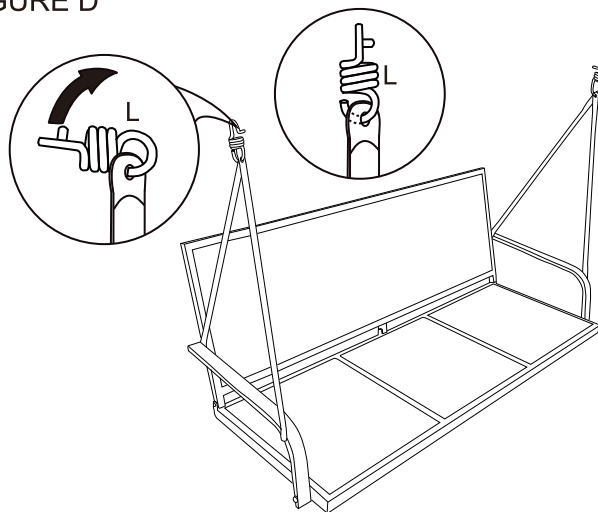

Step 8:

Hang the other side of the suspension spring (L) into the hole located on the angled brace on the top cross beam with adjustable teeth.

Do the same procedure for both sides.

See Figure E.

Warning:

Make sure that both ends of the suspension springs (L) go completely through the holes in the angled braces on the top cross beam with adjustable teeth and the swing arm tubes.

FIGURE E

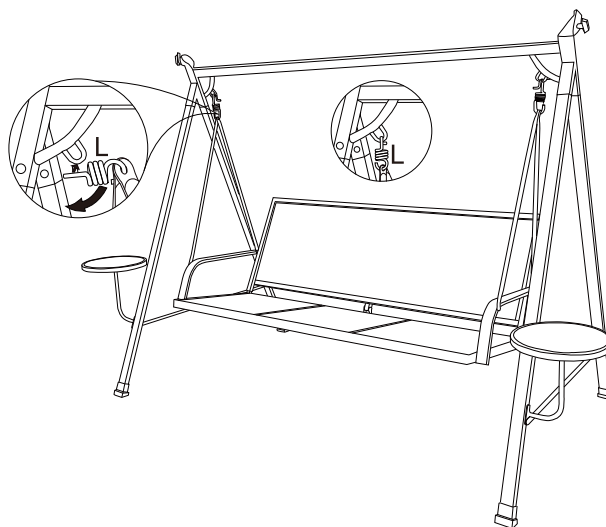

Assembly Instructions

Step 9:

Slide the canopy/frame connectors (N) into the canopy (P). Fasten them together by using screws (F) in the pre-drilled holes. Make sure that the teeth of the canopy/frame connectors are facing toward the inside of the frame. See Figure F - Step A and Step B.

FIGURE F

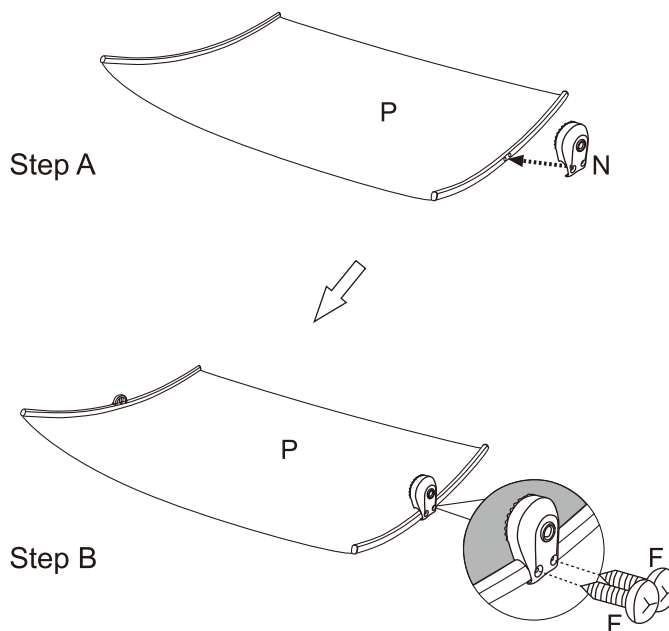

Step 10:

Fasten the canopy/frame connectors (N) to the adjustable teeth on the top cross beam w/ adjustable teeth by using a plastic screw (M). Repeat this procedure for both sides. See Figure G.

Step 11:

Re-check and re-tighten all of the nuts and bolts to assure stability.

FIGURE G

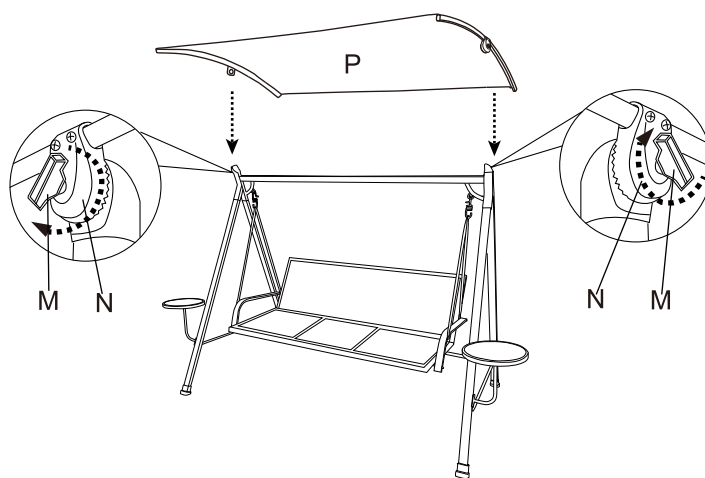

Assembly Instructions

Step 12:

Place the back cushions (Q) seat cushions (R) and the pillows (O) onto the seat assembly. Secure the cushions to the seat assembly by using the velcro straps.

Note:

To avoid danger of suffocation, always keep plastic bags or small parts away from babies and children.

FIGURE H

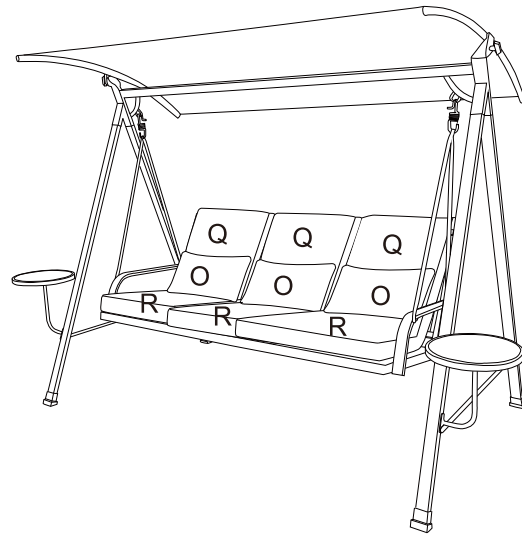

Special Warnings:

1. The user of this swing should always inspect it before each use.
2. It is essential to place this swing on level ground and not less than six feet from any obstruction, such as fences, garages, houses, overhanging branches, laundry lines or electrical wires.
3. Check the tightness of all nuts and bolts on a regular basis.
4. Always remove the canopy in heavy wind conditions. Otherwise, the canopy may tip over and cause damage to its parts.
5. Oil all of the metal parts that move during usage season.
6. The manufacturer will not accept responsibility for unauthorized repairs or modifications to the swing or its parts.
7. Make sure that the suspension springs are properly secured before each use.
8. Weight limit is 750 lb (340 kg).