

ASSEMBLY INSTRUCTIONS

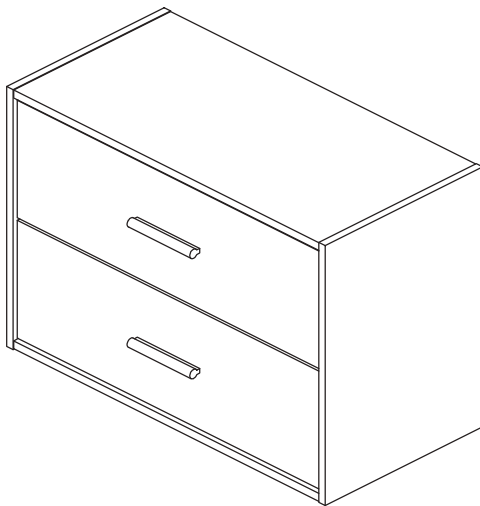

TOOLS REQUIRED



Philips Screwdriver

(Not Included)



Power Tool

(Not Included)



2 - People Recommended

DRAWER CABINET

PRE ASSEMBLY INTRODUCTION

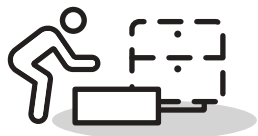

Assemble near the area of the intended location.



Make sure you have enough space to move around.



Use cardboard or blankets to prevent scratches.



Ensure the furniture rests on a flat and level surface.

ASSEMBLY AND CARE ADVICE



FAILURE TO FOLLOW THE GUIDELINES BELOW MAY RESULT IN INJURY AND/OR PROPERTY DAMAGE.



Position each part correctly and insert screws or bolts into their respective holes.

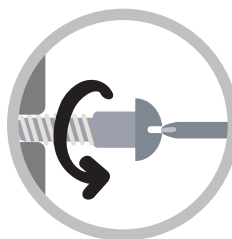

Turn clockwise to tighten and only tighten when step is completed or when instructed to do so.



Use the appropriate hand tools or power tools for assembly.

Select steps, such as tightening screws and/or bolts, may require hand tools to avoid causing damage during assembly.

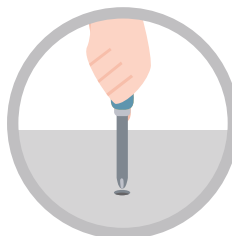

After two weeks, check and tighten any loose hardware and repeat again every six months thereafter.

ASSEMBLY INSTRUCTIONS

PARTS

A 2PCS



Top & Bottom Panels
(single-edge groove)

B 2PCS

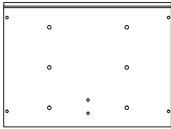

Side Panels

C 1PC



Support Beam

D 2PCS



Back Panels (thin)

E 2PCS

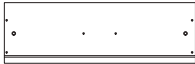

Drawer Fronts
(handle holes)

F 2PCS



Drawer Backs

G 2PCS



Left Drawer Panels

H 2PCS



Right Drawer Panels

I 2PCS



Bottom Drawer Panels (thin)

HARDWARE

1 20PCS

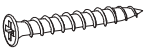

2 4PCS



3 12PCS



Drawer Slides & Matching Screws

4 2PCS



5 4PCS



Handles & Matching Screws

6 4PCS



7 8PCS



8 1PC

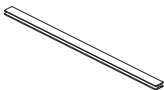

9 12PCS



10 16PCS



11 1PC



12 6SETS

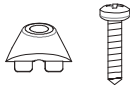

13 1SET

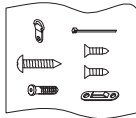

ASSEMBLY INSTRUCTIONS

- 1** Align grooves of Left Drawer Panel (#G), Drawer Back (#F) and Right Drawer Panel (#H) together, and secure with screws (#1). Insert Bottom Drawer Panel (#I) between the grooves. Insert wooden dowels (#9) into panels (#G, H) and align with Drawer Front (#E). Affix L-connectors (#6) to inner sides of panels (#G, H) and secure with screws (#7). Attach handle (#4) to Drawer Front (#E) and secure with screws (#5).

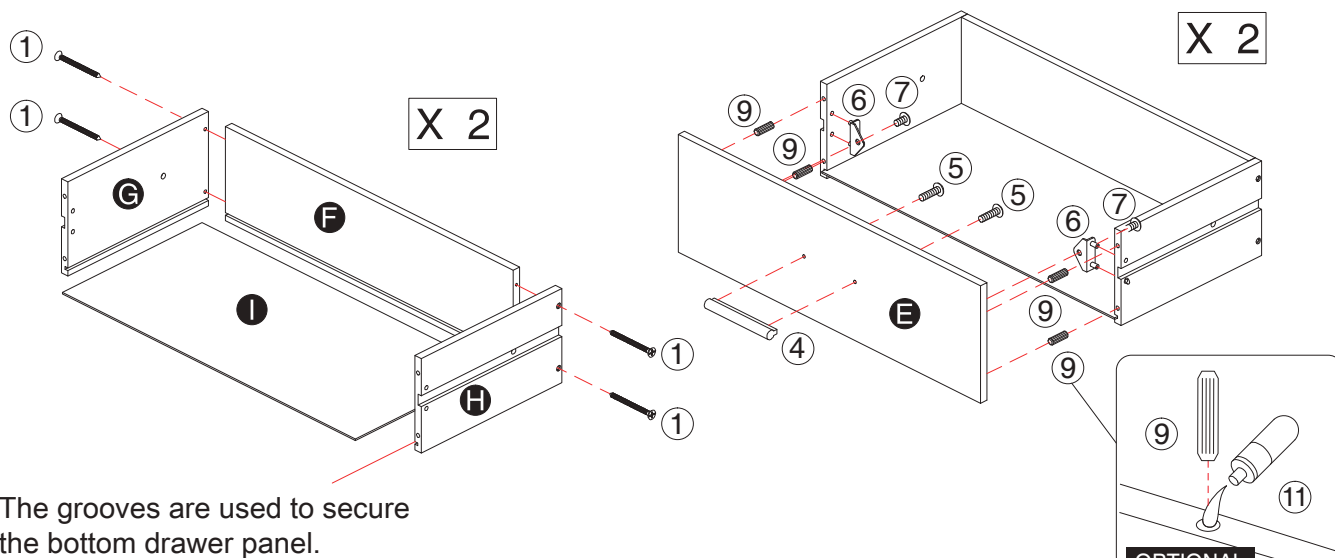

- 2** Carefully install plastic slides (#2) into Side Panels (#B) and secure with screws (#3).

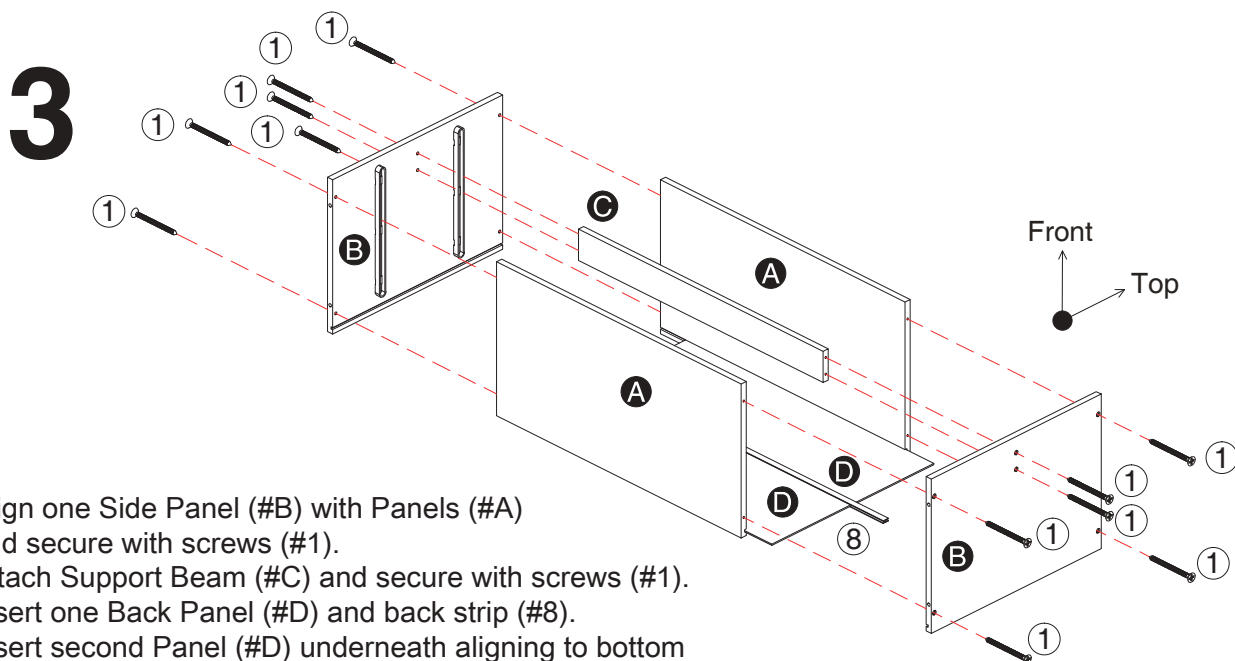
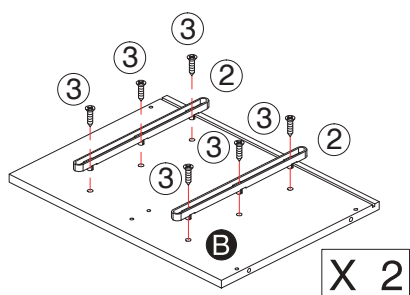

- 3** Align one Side Panel (#B) with Panels (#A) and secure with screws (#1). Attach Support Beam (#C) and secure with screws (#1). Insert one Back Panel (#D) and back strip (#8). Insert second Panel (#D) underneath aligning to bottom groove of (#A). Align second Panel (#B) to Panels (#A) and secure with screws (#1) into the groove on Panel (#A).

ASSEMBLY INSTRUCTIONS

- 4** Stand the cabinet upright and insert drawers. Keep drawers slightly open to insert and secure screws (#7).

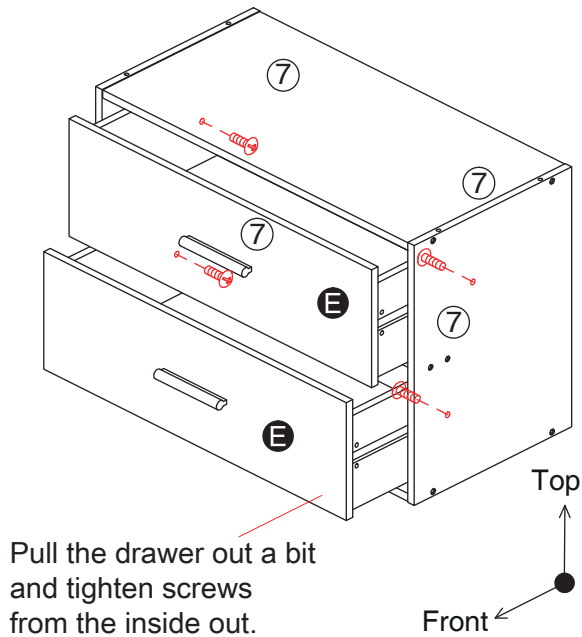

5

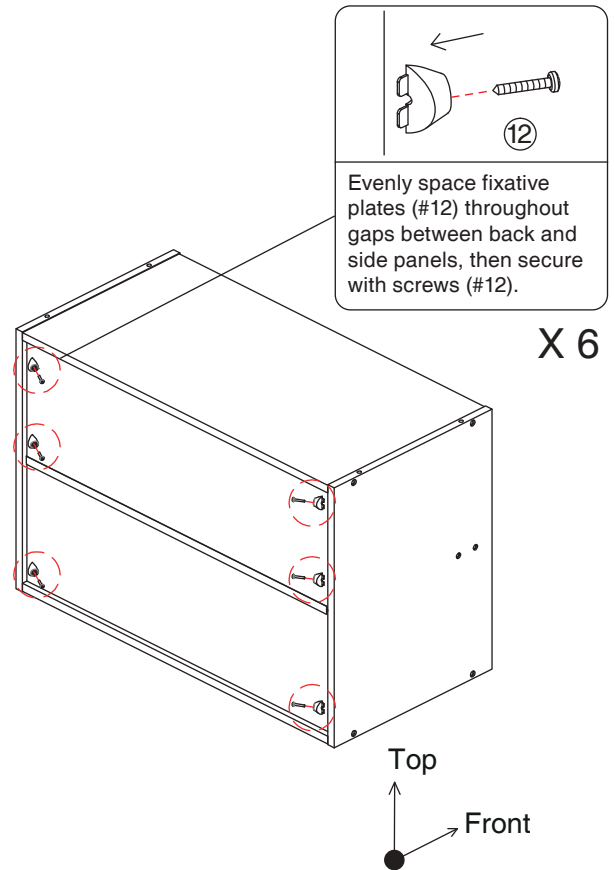

6

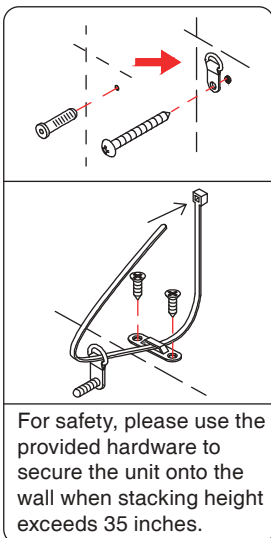
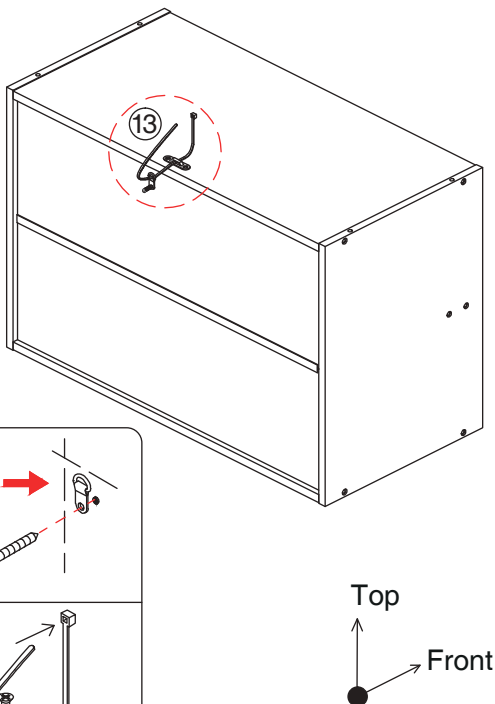

7

- Use provided stickers (#10) to cover any exposed holes.

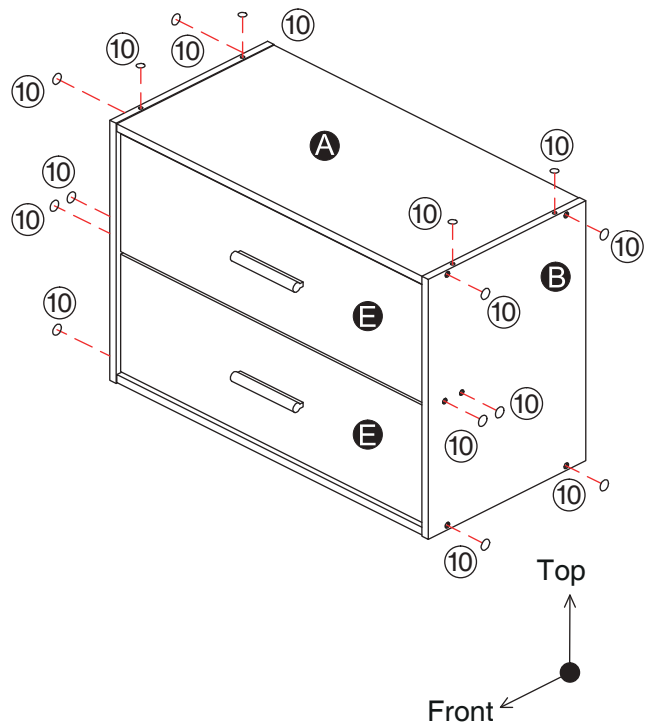

ASSEMBLY
COMPLETED



Safety Measures for Stacking

A maximum of **2** units
can be stacked.

The total stacked
height cannot exceed **70.6"**

The use of wooden dowels and anti-tip hardware is required when stacking height exceeds **35.0"**

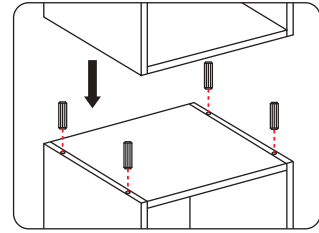

**Refrain from drilling
holes on your own.**

Please make sure to use the pre-drilled
holes and dowels (#9) for stacking.

Mix, Match & Stack

This item can be stacked with other compatible pieces in the collection. Configurations shown may include multiple units, which are sold separately unless otherwise stated.

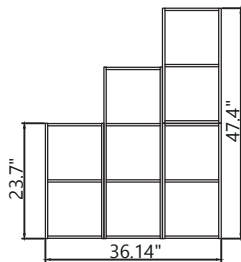

2S
2S · 3S · 2S

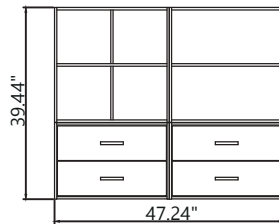

4S · 2L
2D · 2D

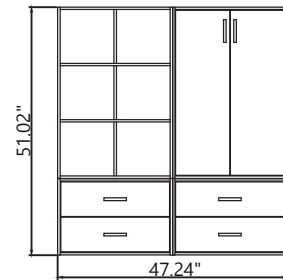

6S · DC
2D · 2D

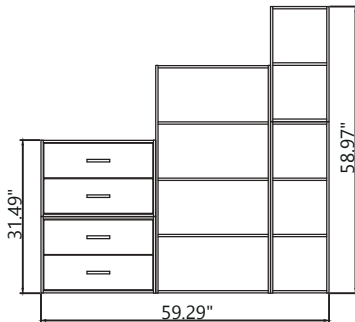

2D · 2S
2D · 4L · 3S

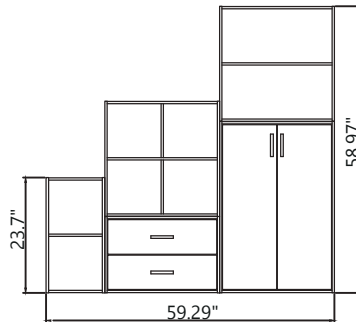

4S · 2L
2S · 2D · DC

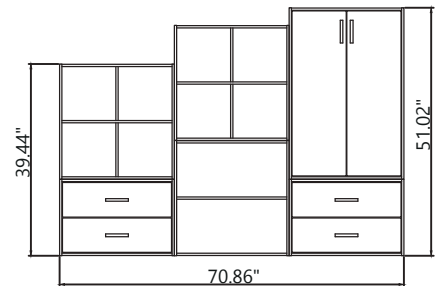

4S · 4S · DC
2D · 2L · 2D

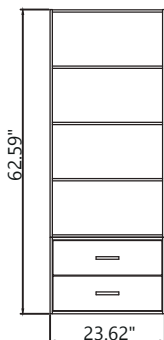

4L
2D



2L · 3L · 4L
2D · 2D · 2D

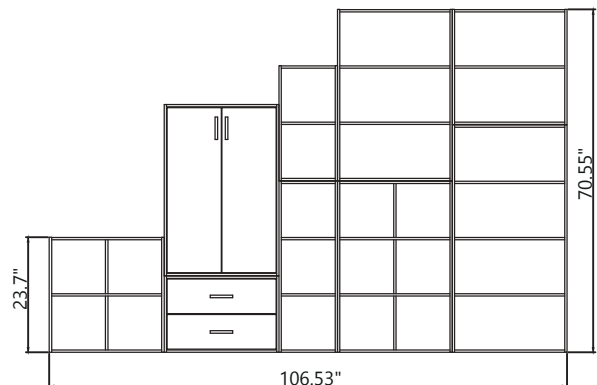

DC · 2S · 3L · 2L
4S · 2D · 3S · 6S · 4L