

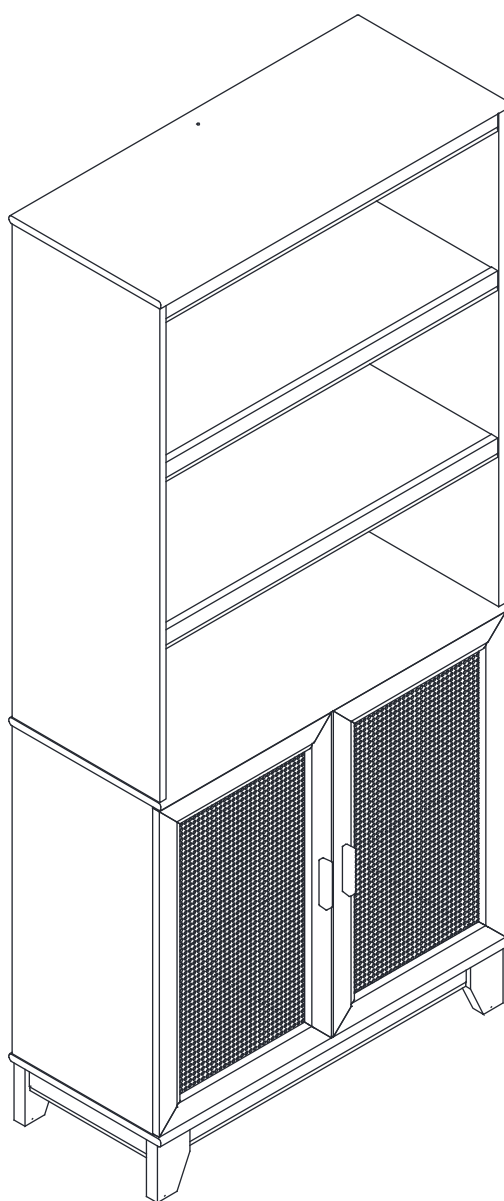

MANHATTAN
COMFORT

Sheridan Bookcase Cabinet BC-6GLF





STOP!

Before beginning the assembly process,
ensure all boxes and parts have been delivered.

FOR BEST RESULTS:

- Do not throw away packaging materials until assembly is complete.
- Assemble item on a soft surface, such as cardboard or carpet, to protect finish.
- Proper assembly requires two people.

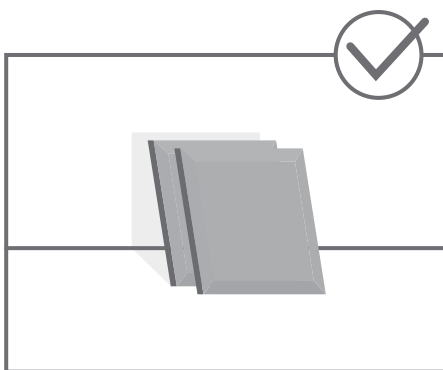
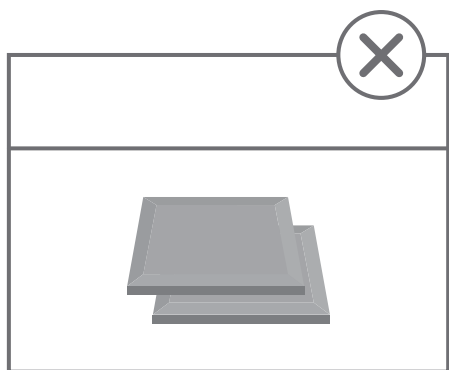
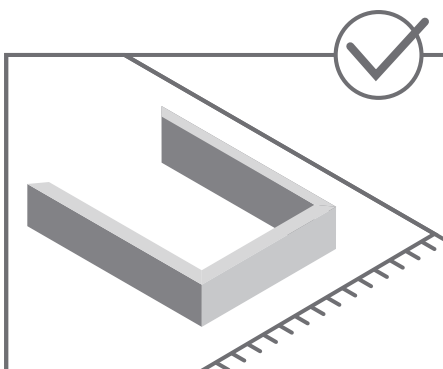
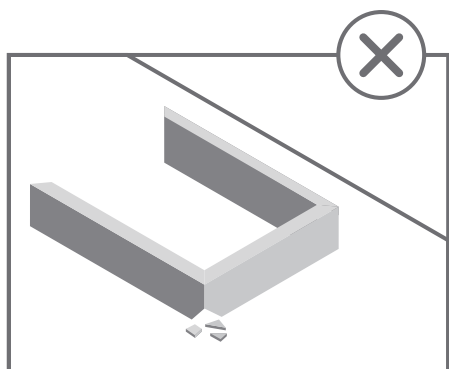

TOOLS REQUIRED

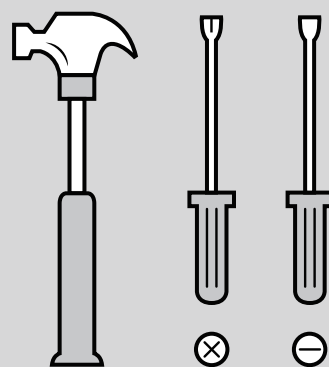

View our assembly video online:
WWW.MANHATTANCOMFORT.COM



Stuck? Question? We are here to help.
tel 908-888-0818
e-mail: help@manhattancomfort.com

Included in this package:

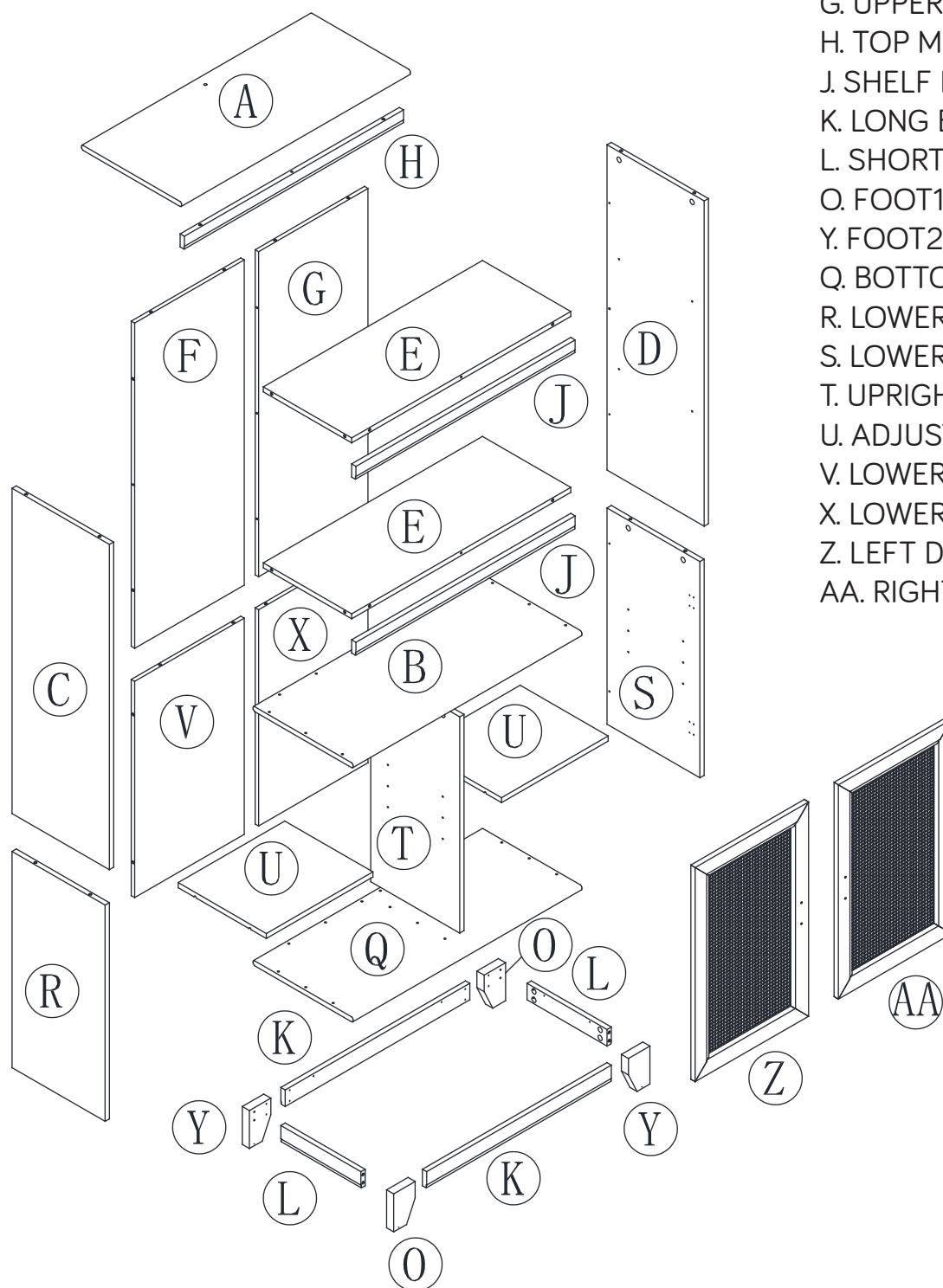

- A. TOP(1)
- B. LARGE SHELF(1)
- C. UPPER LEFT END(1)
- D. UPPER RIGHT END(1)
- E. SHELF(2)
- F. UPPER LEFT BACK(1)
- G. UPPER RIGHT BACK(1)
- H. TOP MOLDING(1)
- J. SHELF MOLDING(2)
- K. LONG BRACE(2)
- L. SHORT BRACE(2)
- O. FOOT1(2)
- Y. FOOT2(2)
- Q. BOTTOM(1)
- R. LOWER LEFT END(1)
- S. LOWER RIGHT END(1)
- T. UPRIGHT(1)
- U. ADJUSTBLE SHELF(2)
- V. LOWER LEFT BACK (1)
- X. LOWER RIGHT BACK(1)
- Z. LEFT DOOR(1)
- AA. RIGHT DOOR(1)

Hardware Identification

① CAM SCREW - 50pcs

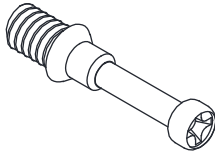

② HIDDEN CAM - 50pcs

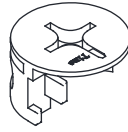

③ APPLIQUE CARD - 9pcs

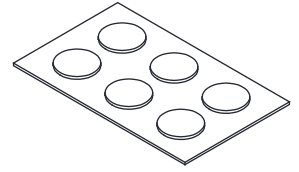

④ METAL PLATE - 4pcs

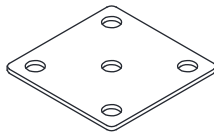

⑤ METAL PIN - 8pcs

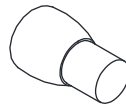

⑥ PULL - 2pcs

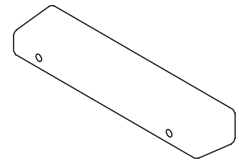

⑦ BRACKET - 8pcs

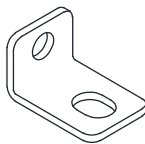

⑧ WOOD DOWEL - 15pcs

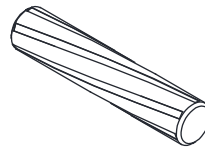

⑨ Tape - 1PC

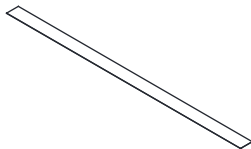

⑨6 FURNITURE TIPPING
RESTRAIN KIT - 1pc

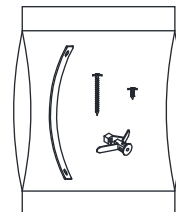

⑩ BUMPER CARD - 1pc

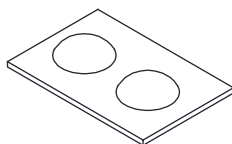

⑪ HINGE - 4pcs

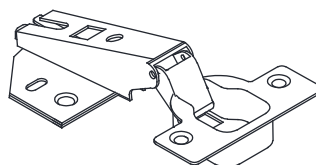

⑬ PAN HEAD SCREW
M5*30mm - 18PCS

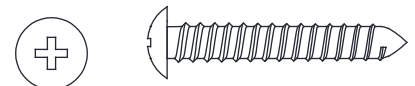

⑭ PAN HEAD SCREW
M4*20mm - 4PCS

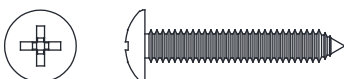

⑮ FLAT HEAD SCREW
M4*12mm - 24pcs



⑯ PAN HEAD SCREW
M4*12MM - 32pcs





MANHATTAN COMFORT

WARRANTY POLICY

All Manhattan Comfort furniture products are warranted, to the original purchaser at the time of purchase and for a period of 30 days thereafter.

Our warranty is limited to new products purchased in factory sealed cartons. This warranty is valid in the United States of America and Canada.

In order to provide you with timely assistance, please thoroughly inspect your furniture for missing or defective parts immediately after opening the carton.

Manhattan Comfort offers a 30-day parts replacement warranty on all items.

Our furniture products are not intended for outdoor use.

THE WARRANTY DOES NOT COVER:

- Defects/damages by improper assembly or disassembly.
- Defects/damages caused by shipping. Claims for damage during transit should be placed immediately to the transportation company.
- Defects/damages caused by inappropriate use of the furniture.



319 Ridge Rd. Dayton, NJ 08810

908-888-0818

Step 1

- ◆ Turn fifty CAM SCREWS (1) into the TOP (A), LARGE SHELF (B), ENDS (C, D, R and S), SHELF MOLDING (J), and the FEET (O and Y).

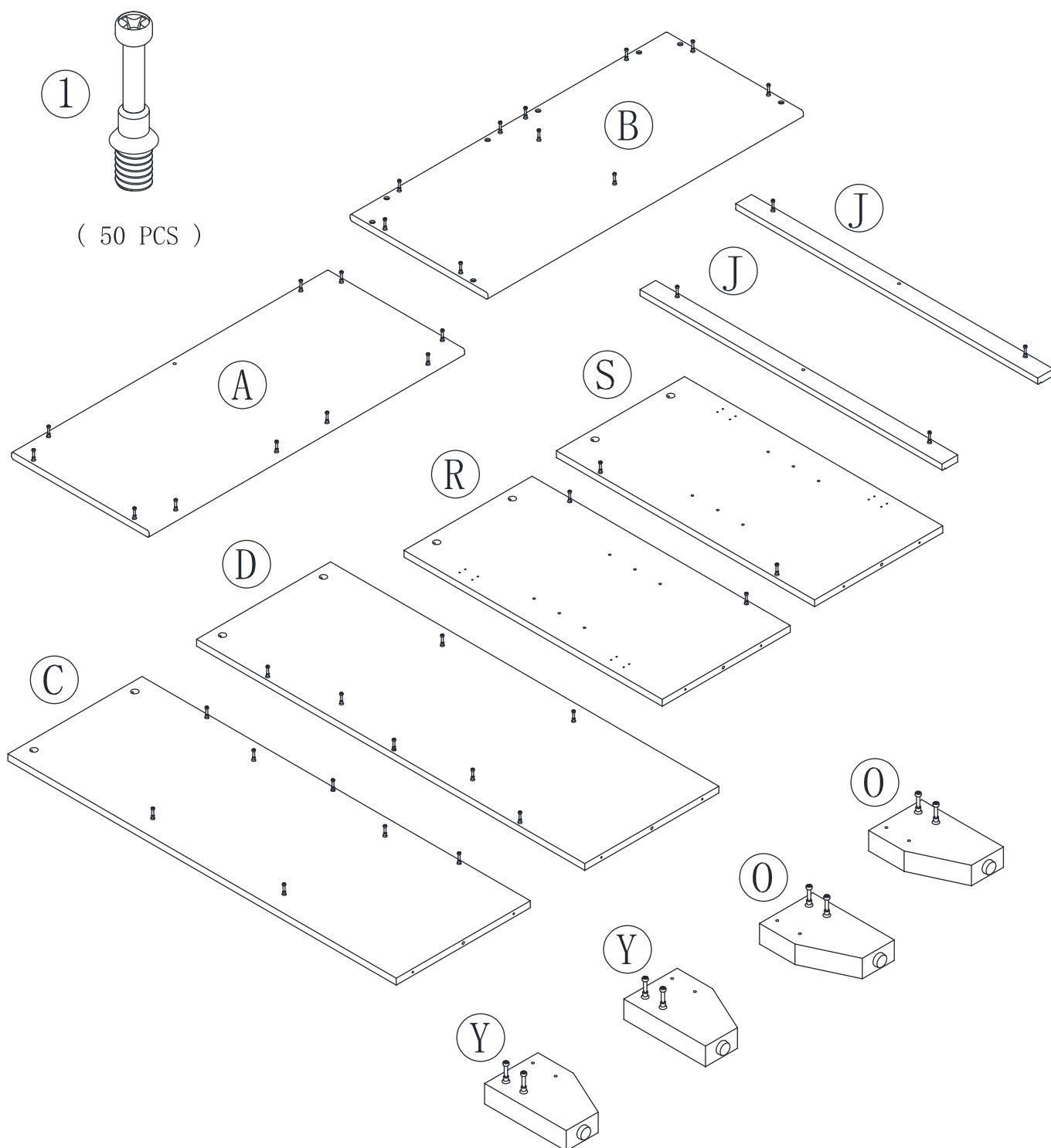
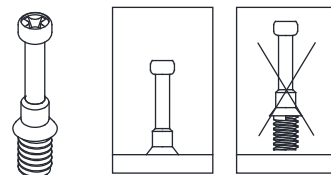

Step 2

- ◆ Push fourteen HIDDEN CAMS (2) into the ENDS (C and D) and BACK (G and F).

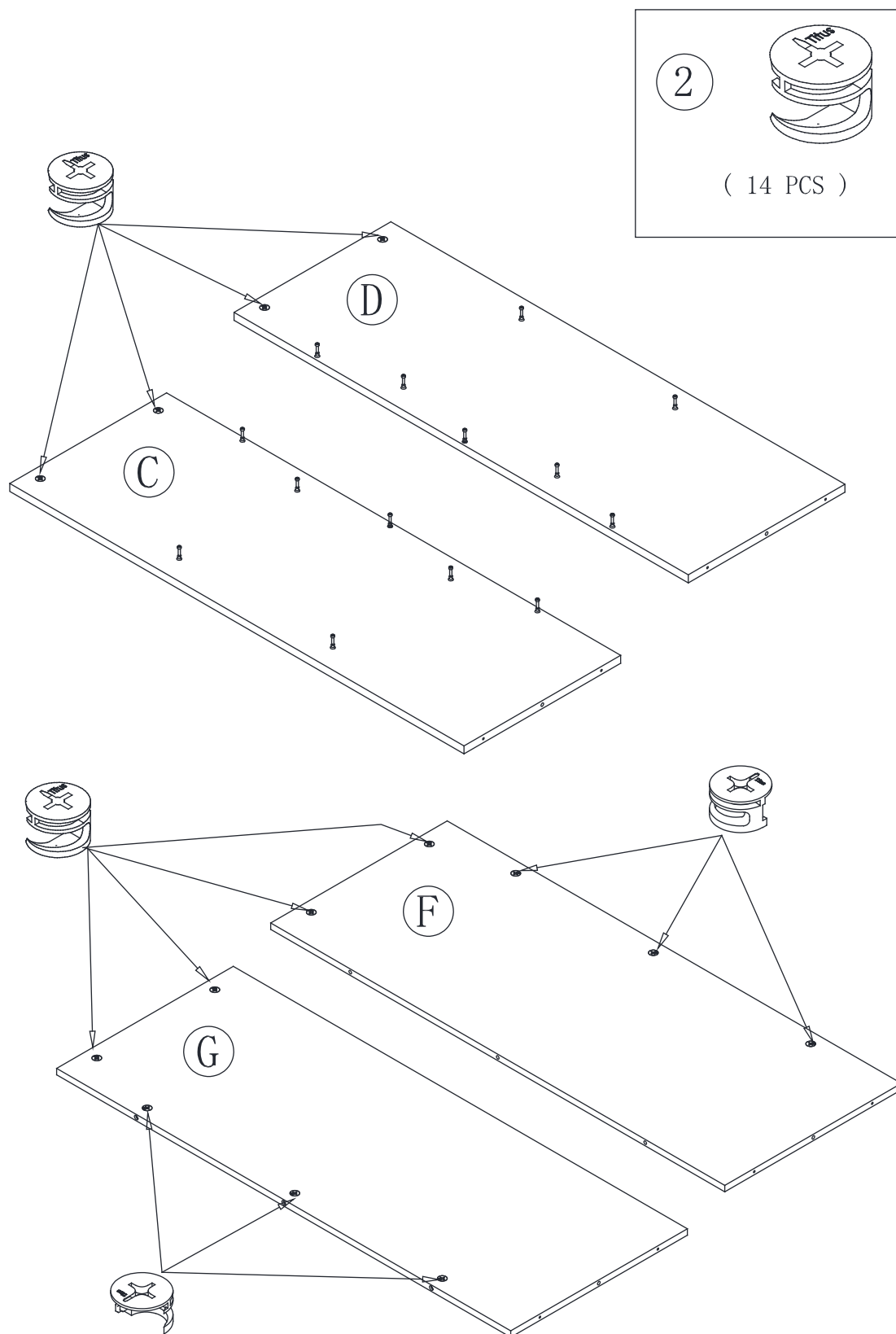

Step 3

- ◆ Push twelve HIDDEN CAMS (2) into the ENDS (R and S) and BACK (V and X).

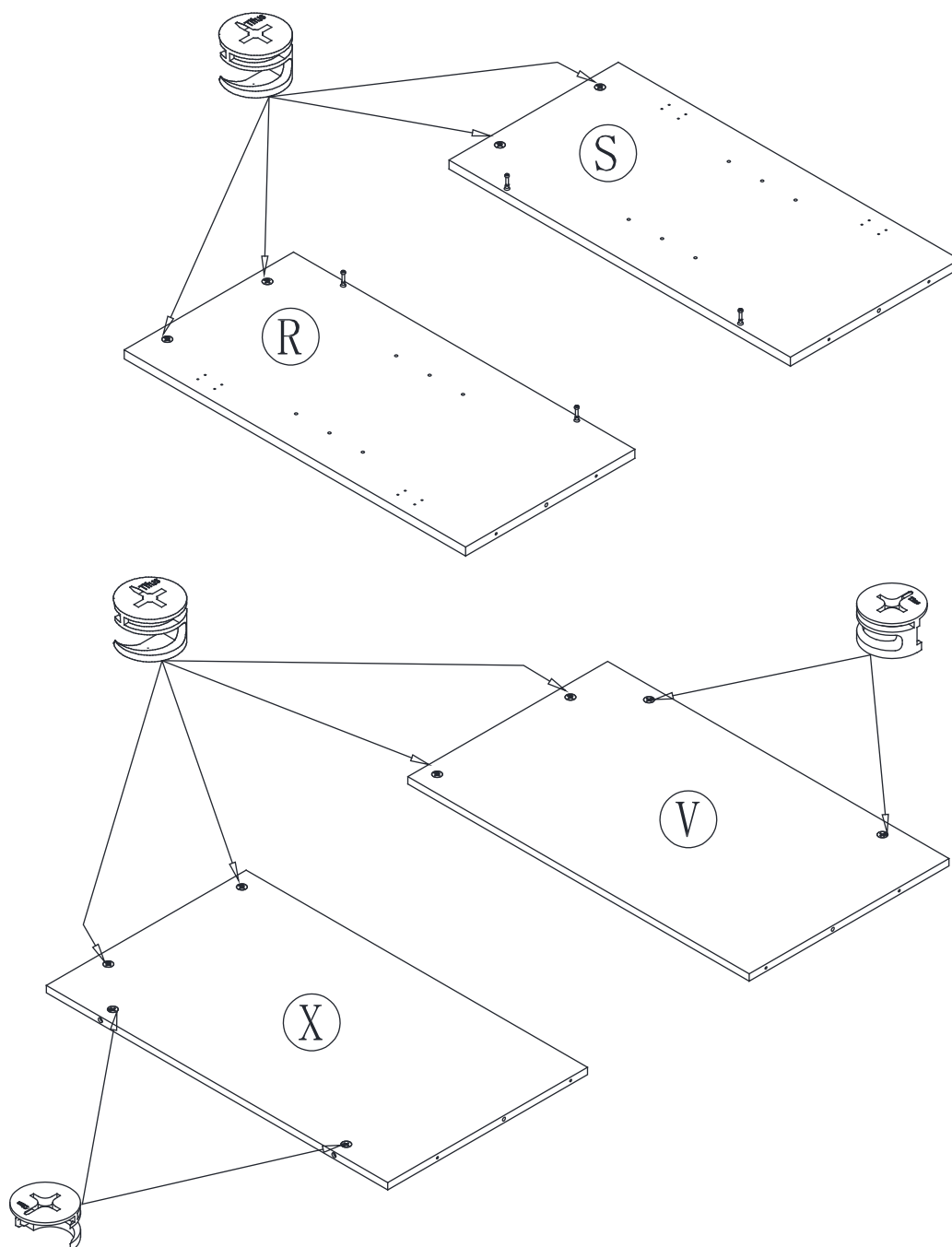
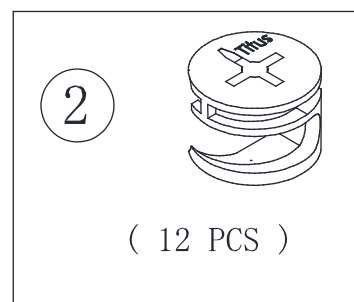

Step 4

- ◆ Push twenty-four HIDDEN CAMS (2) into the SHELF (E), UPRIGHT (T), TOP MOLDING (H) and SHORT BRACE (L)

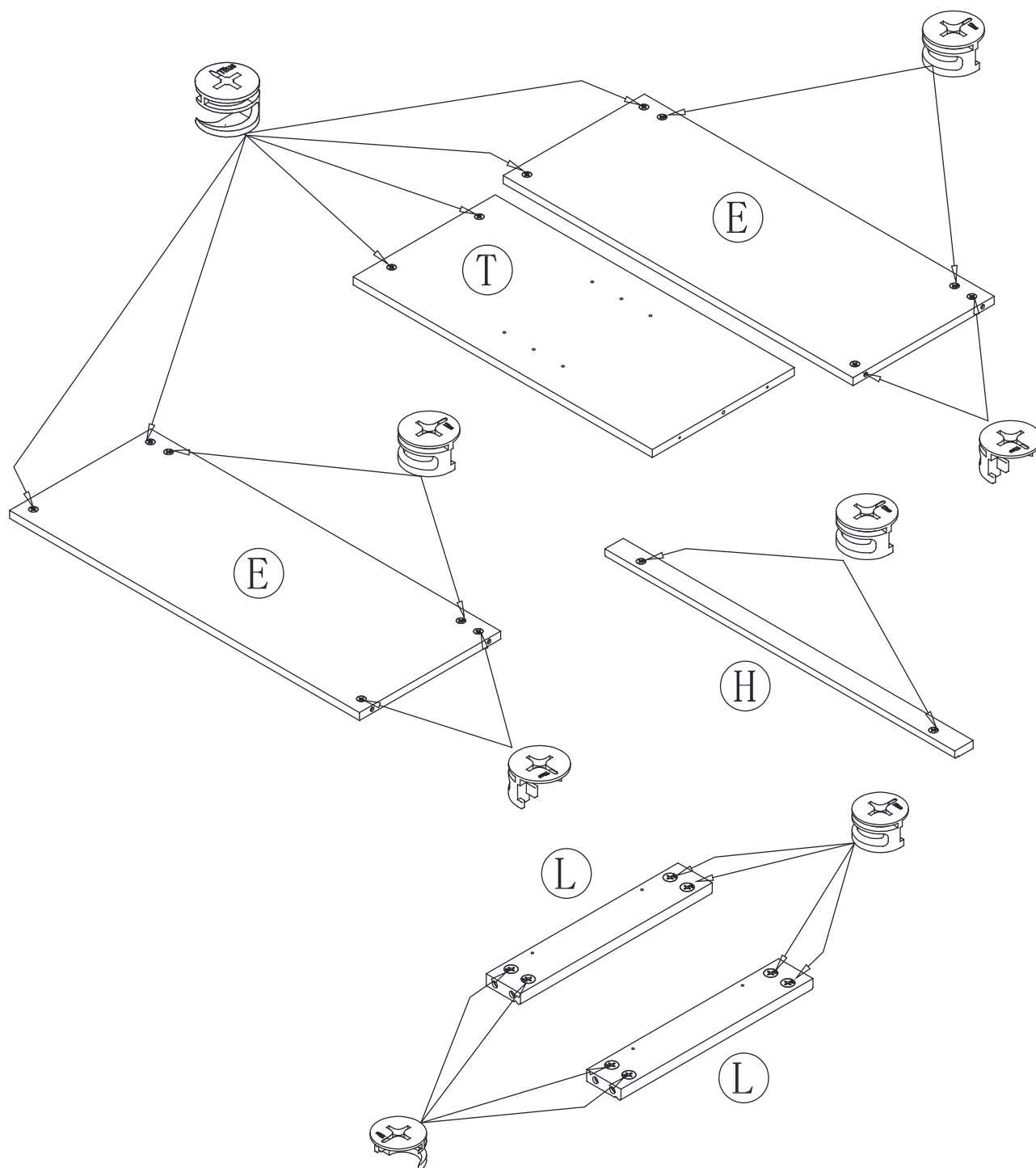
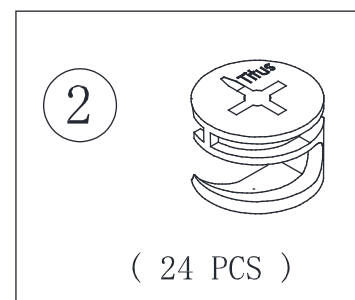

Step 5

◆ Fasten the UPPER LEFT BACK (F) to the UPPER LEFT END (C). Tighten two HIDDEN CAMS.

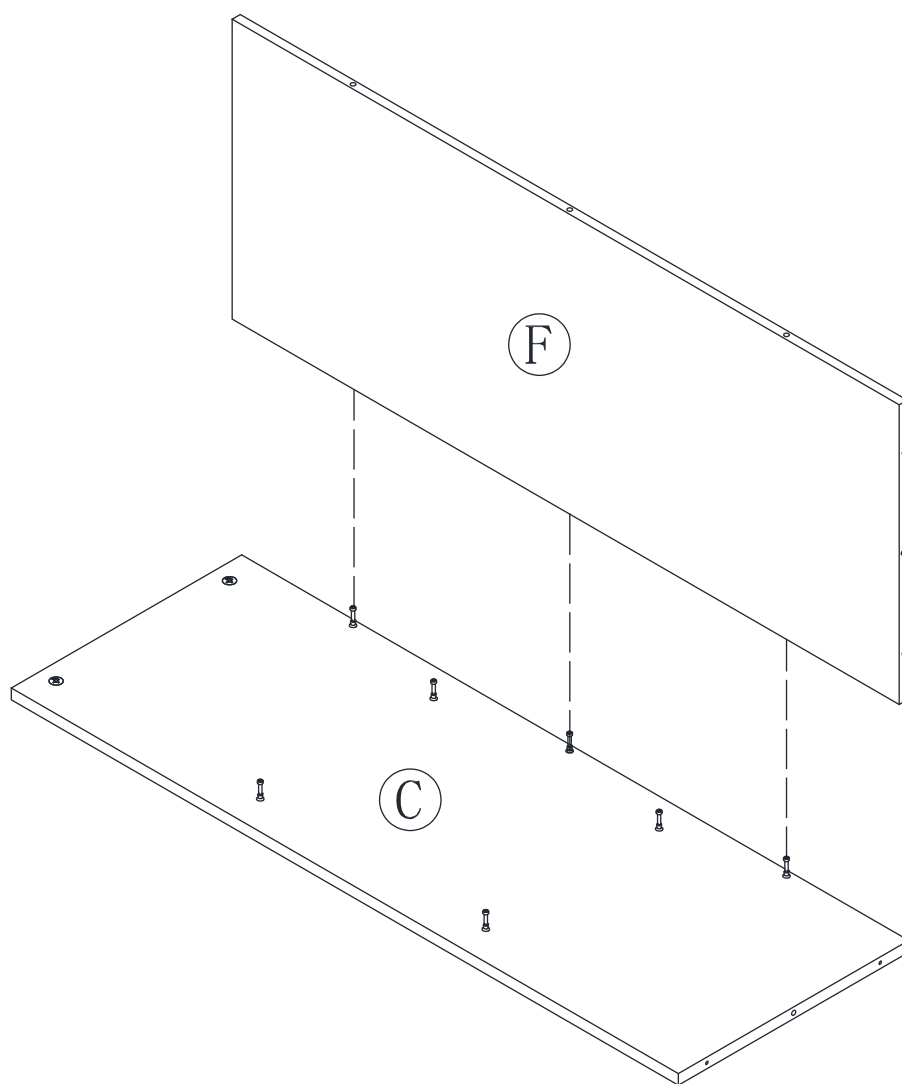
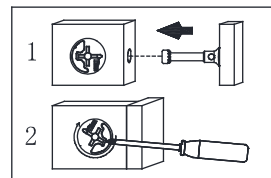
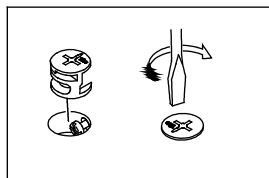
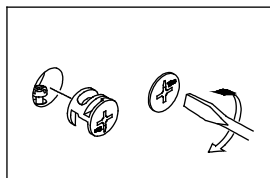

Step 6

- ◆ Insert the WOOD DOWEL (8) into the SHELF (E).
- ◆ Fasten the SHELF MOLDING (J) to the SHELF (E). Tighten four HIDDEN CAMS.

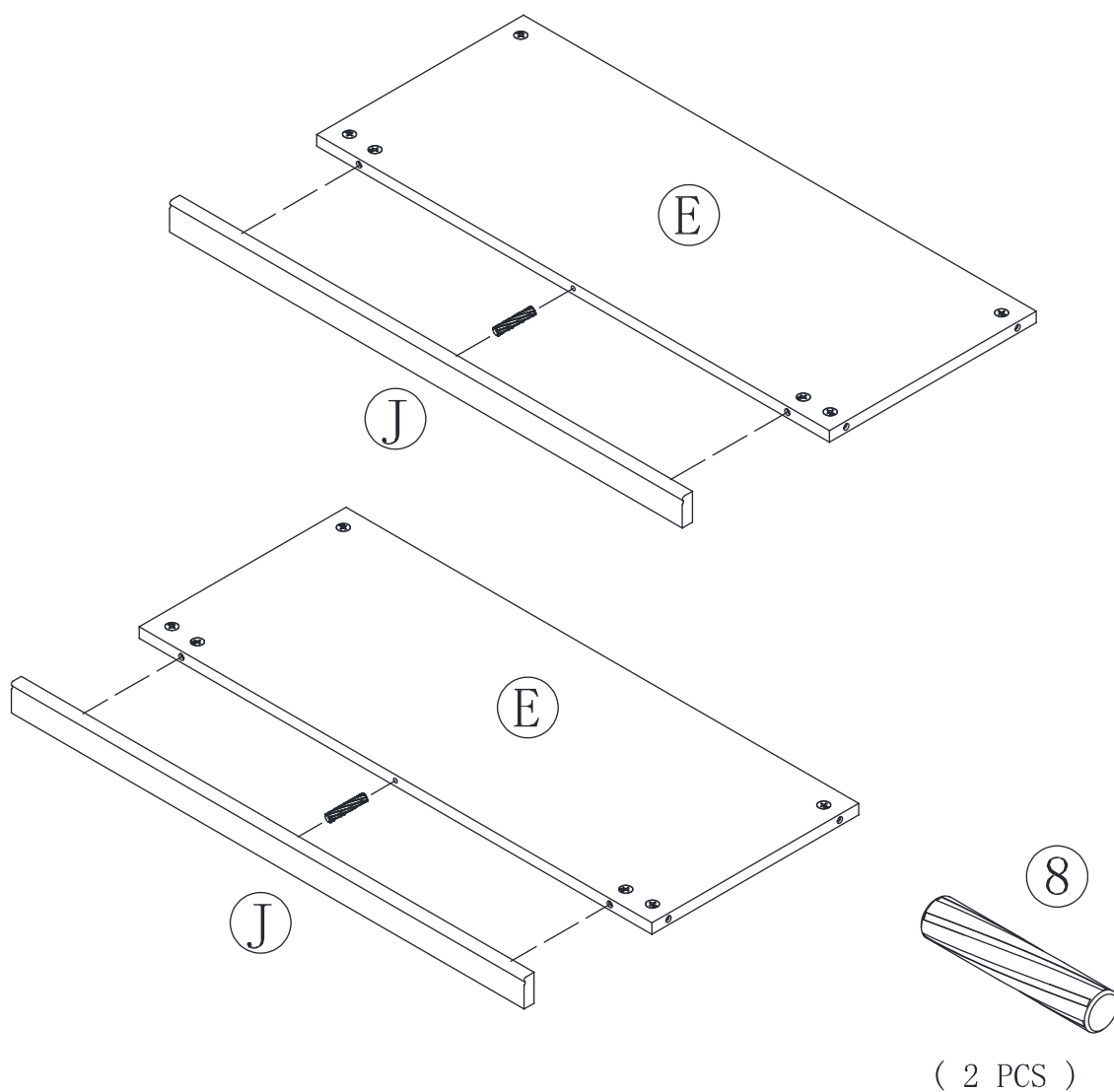
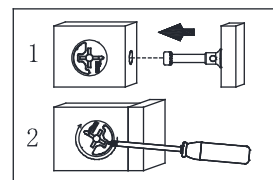
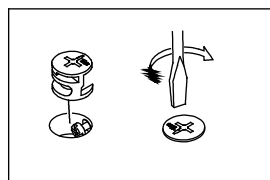
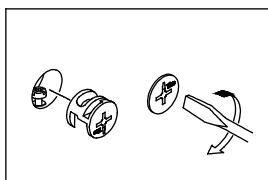

Step 7

- ◆ Fasten the SHELVES (E) to the UPPER LEFT END (C). Tighten four HIDDEN CAMS

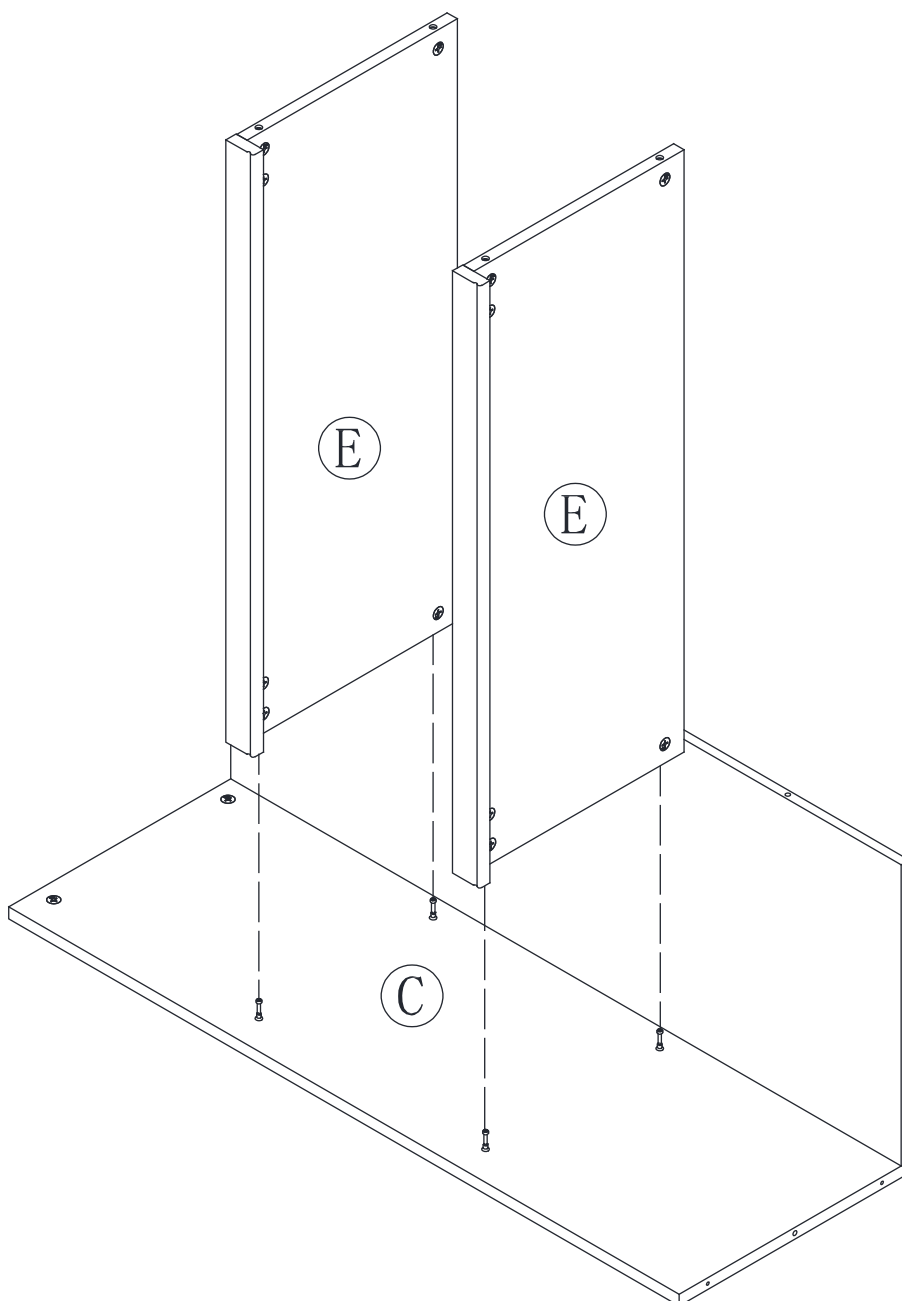
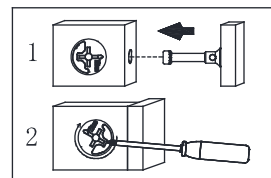
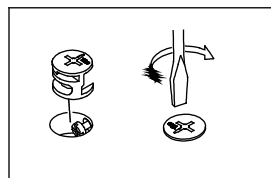
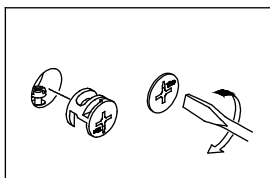

Step 8

- ◆ Insert three WOOD DOWELS (8) into the UPPER LEFT BACK.
- ◆ Attached the UPPER RIGHT BACK (G) to the UPPER LEFT BACK (F).

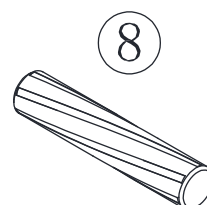
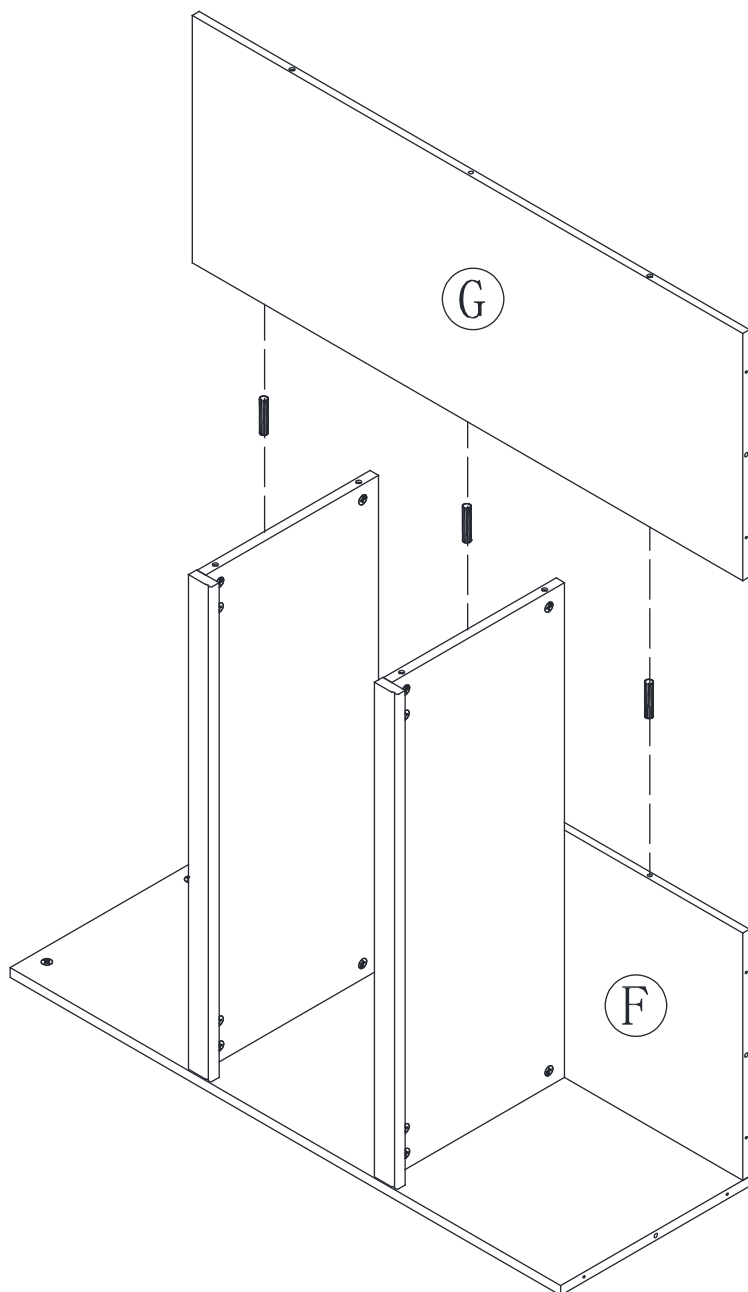

(3 PCS)

Step 9

- ◆ Fasten the UPPER RIGHT END (D) to the SHELVES (E) and the UPPER RIGHT BACK (G).
Tighten six HIDDEN CAMS.

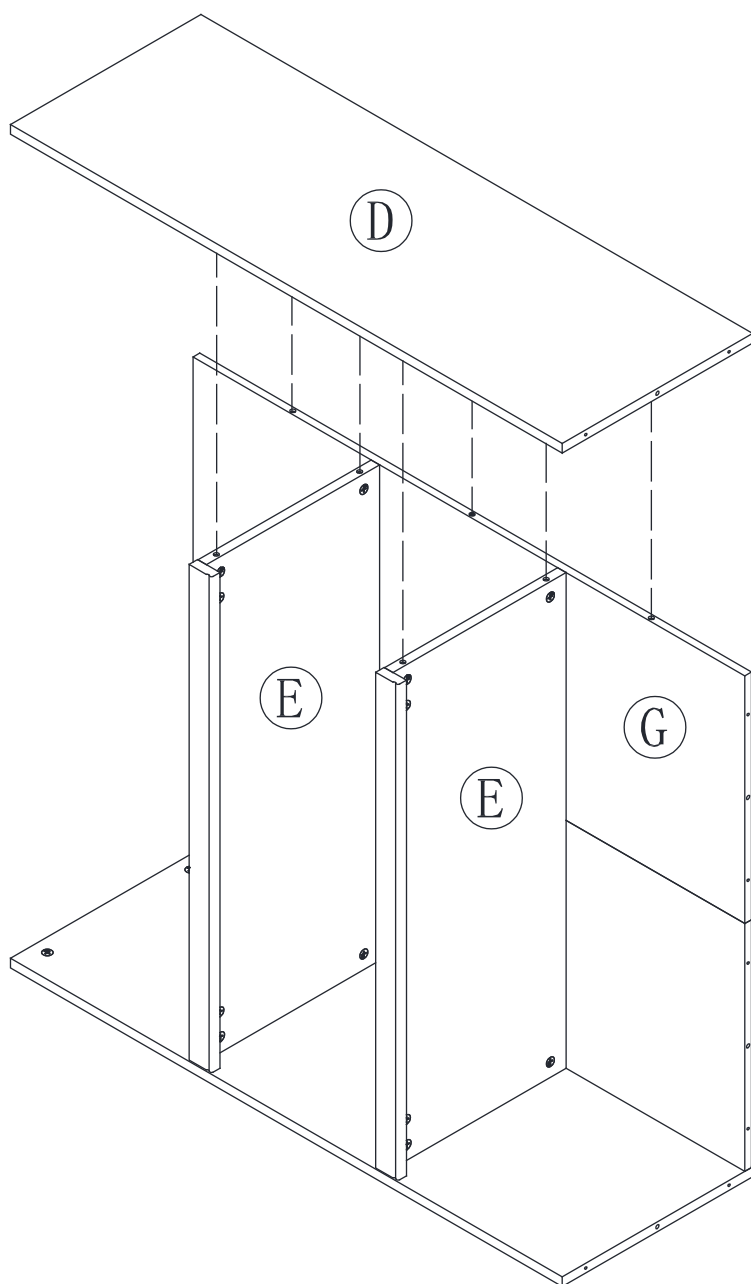
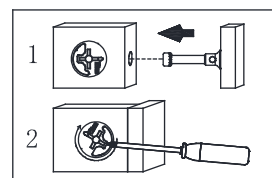
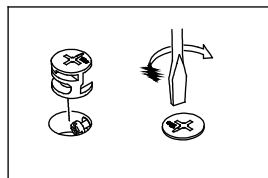
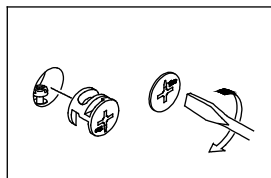

Step 10

- ◆ Insert four WOOD DOWELS (8) into the UPPER BACKS (G and F) and the UPPER ENDS (C and D).
- ◆ Fasten the LARGE SHELF (B) to the UPPER BACKS (G and F) and the UPPER ENDS (C and D).
Use eight PAN HEAD SCREWS (13).

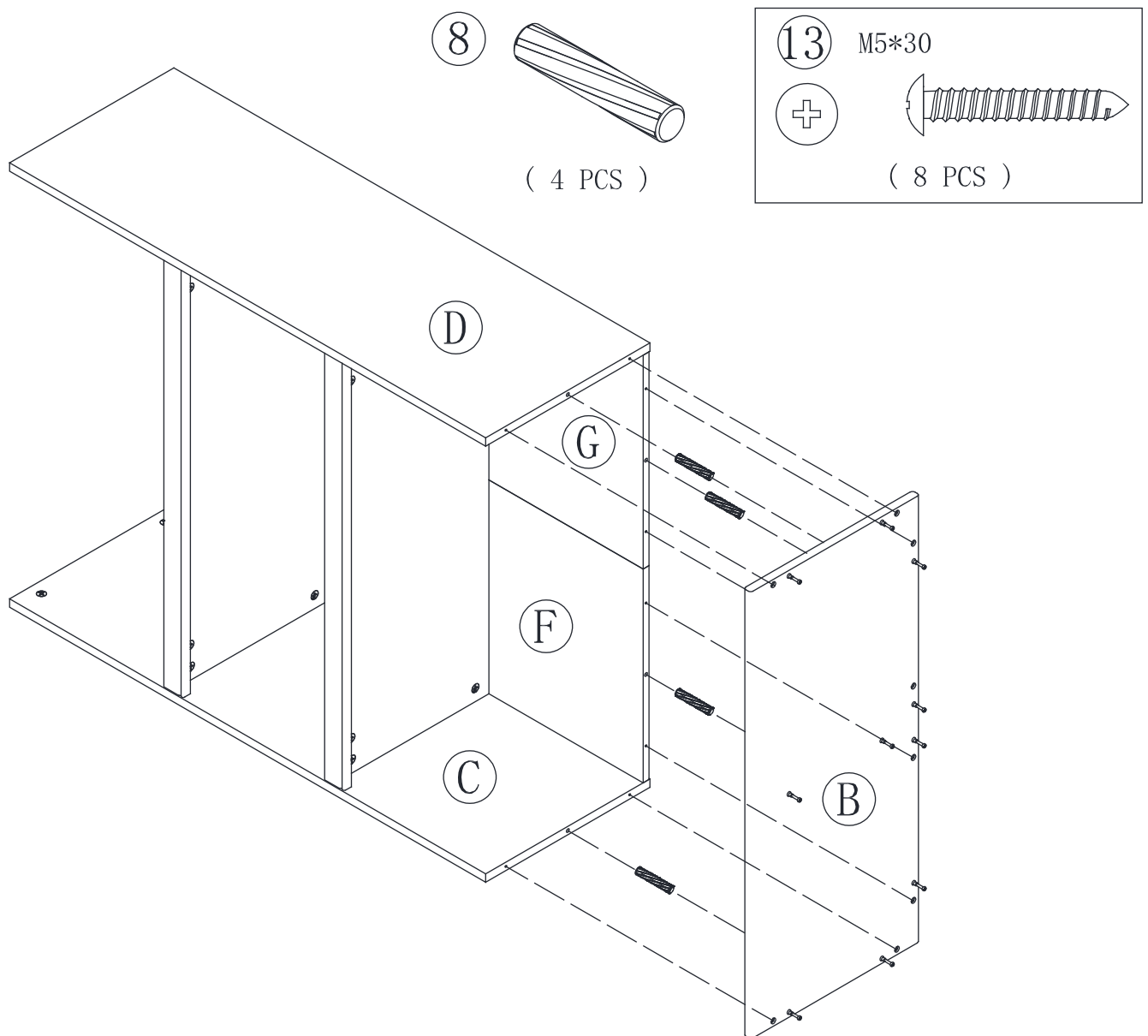

Step 11

- ◆ Insert one WOOD DOWEL (8) into the TOP (A).
- ◆ Fasten the TOP MOLDING (H) to the TOP (A). Tighten two HIDDEN CAMS.

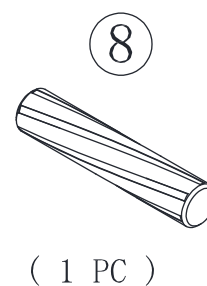
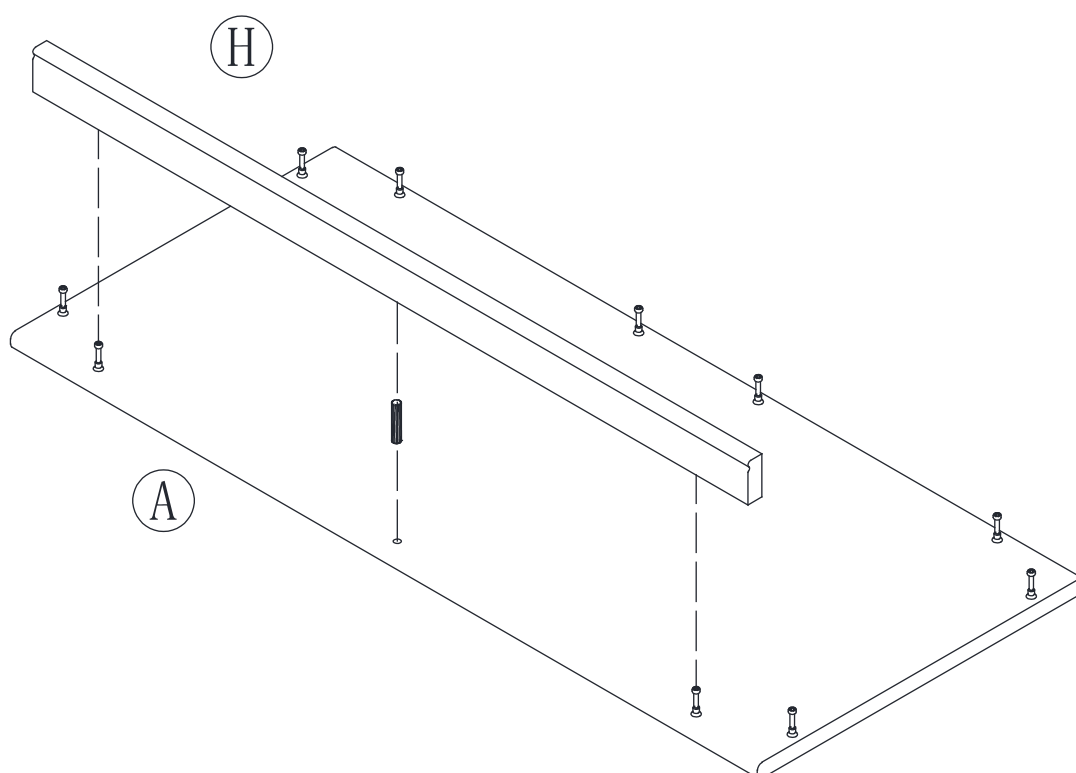
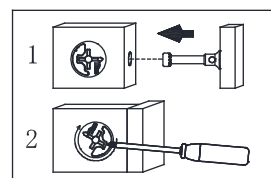
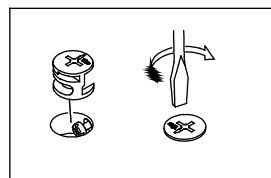
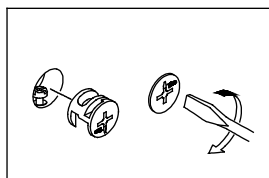

Step 12

- ◆ Fasten the TOP (A) to the UPPER ENDS (C and D) and the UPPER BACK (F and G).
Tighten eight HIDDEN CAMS.

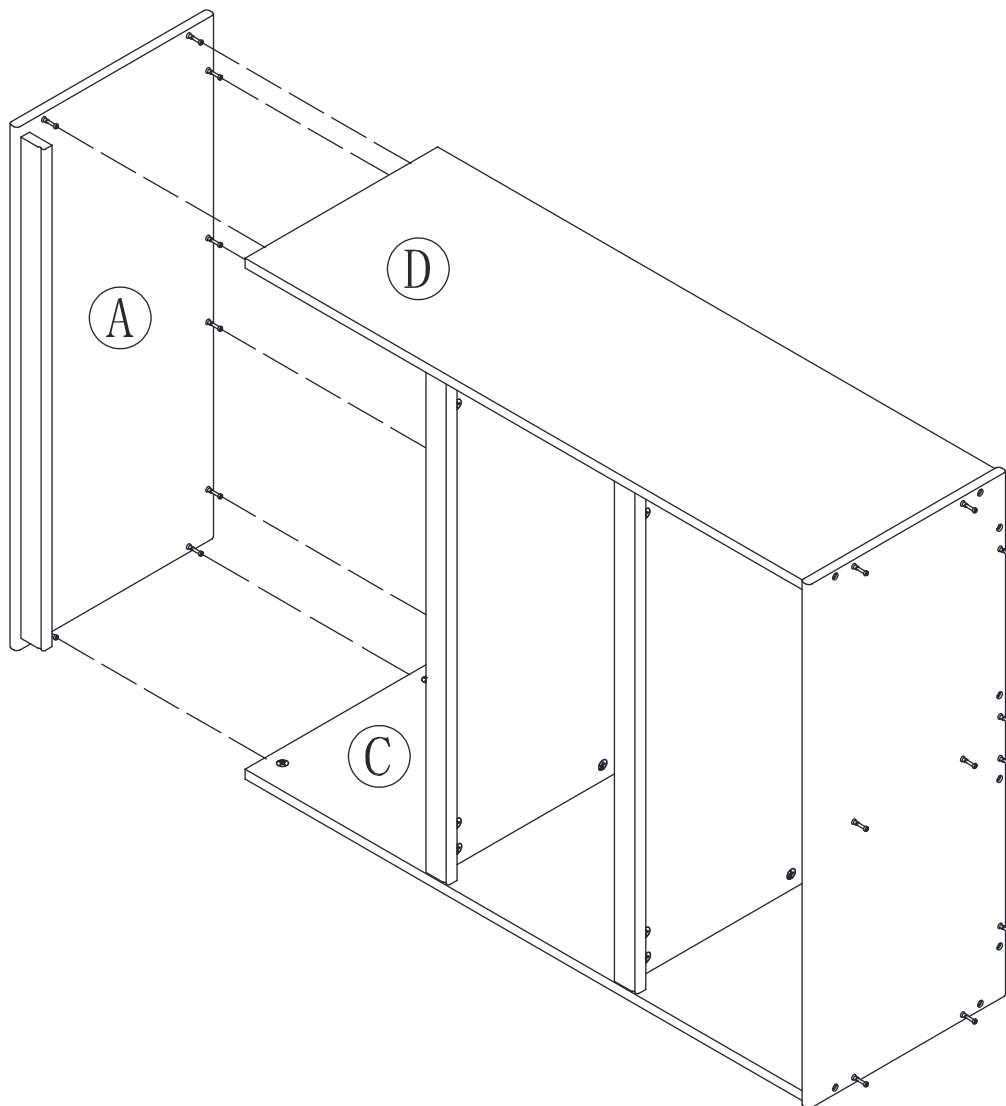
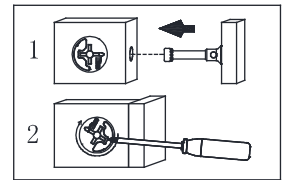
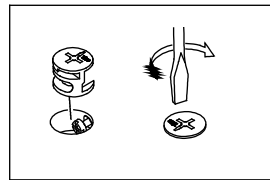
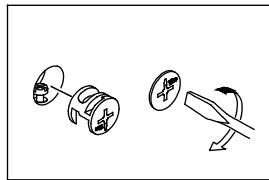

Step 13

- ◆ Fasten two LOWER LEFT BACK (V) to the LOWER LEFT END (R). Tighten two HIDDEN CAMS.

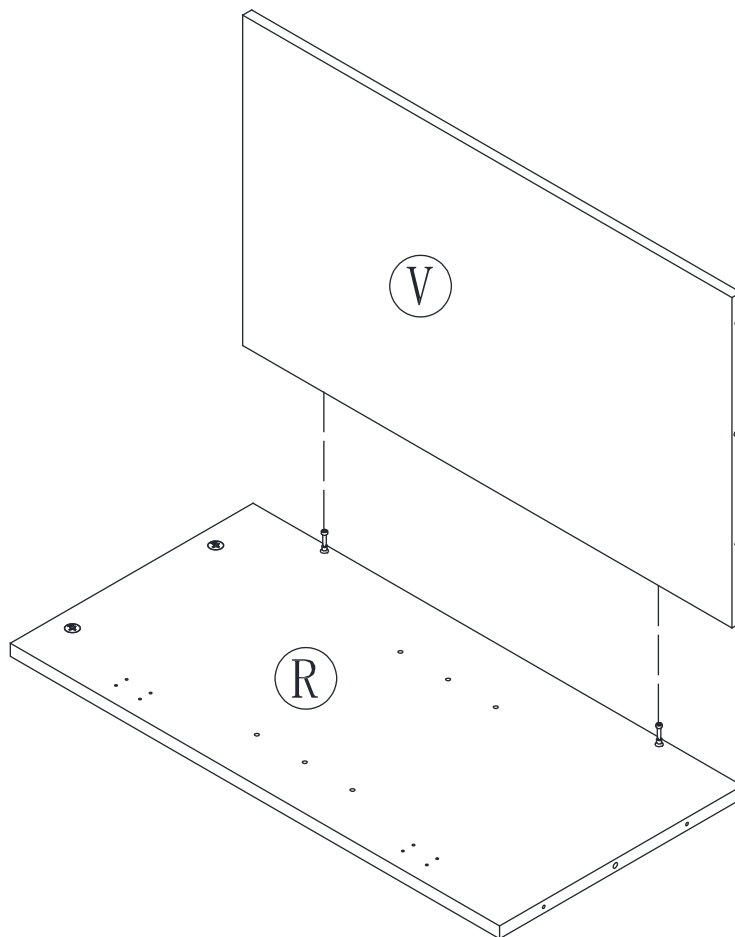
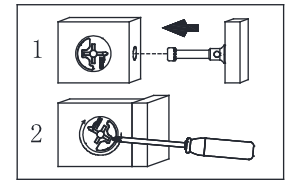
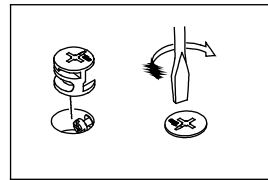
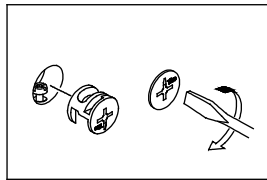

Step 14

◆ Fasten the LOWER RIGHT BACK to the LOWER RIGHT END (S). Tighten two HIDDEN CAMS.

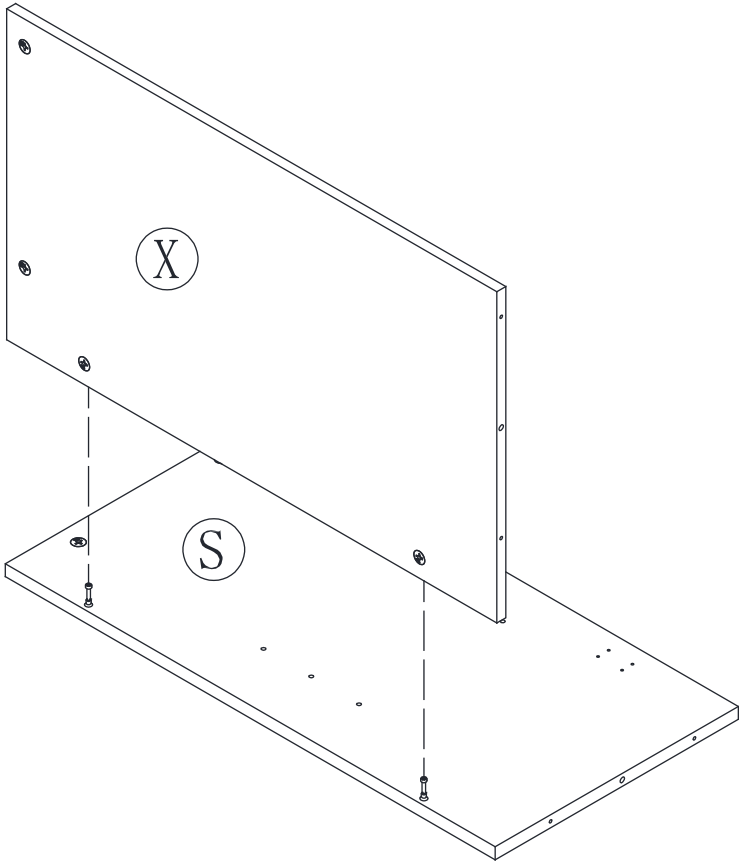
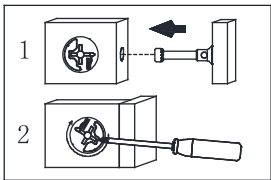
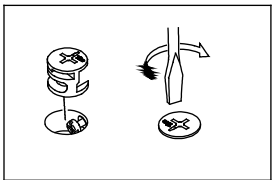
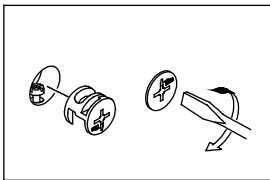

Step 15

- ◆ Fasten the LOWER LEFT END (R) and the LOWER LEFT BACK (V) to the LARGE SHELF (B).
Tighten two HIDDEN CAMS.

NOTE : Please tighten two HIDDEN CAMS in the LOWER LEFT BACK (V) after you stand your unit upright on step 23.

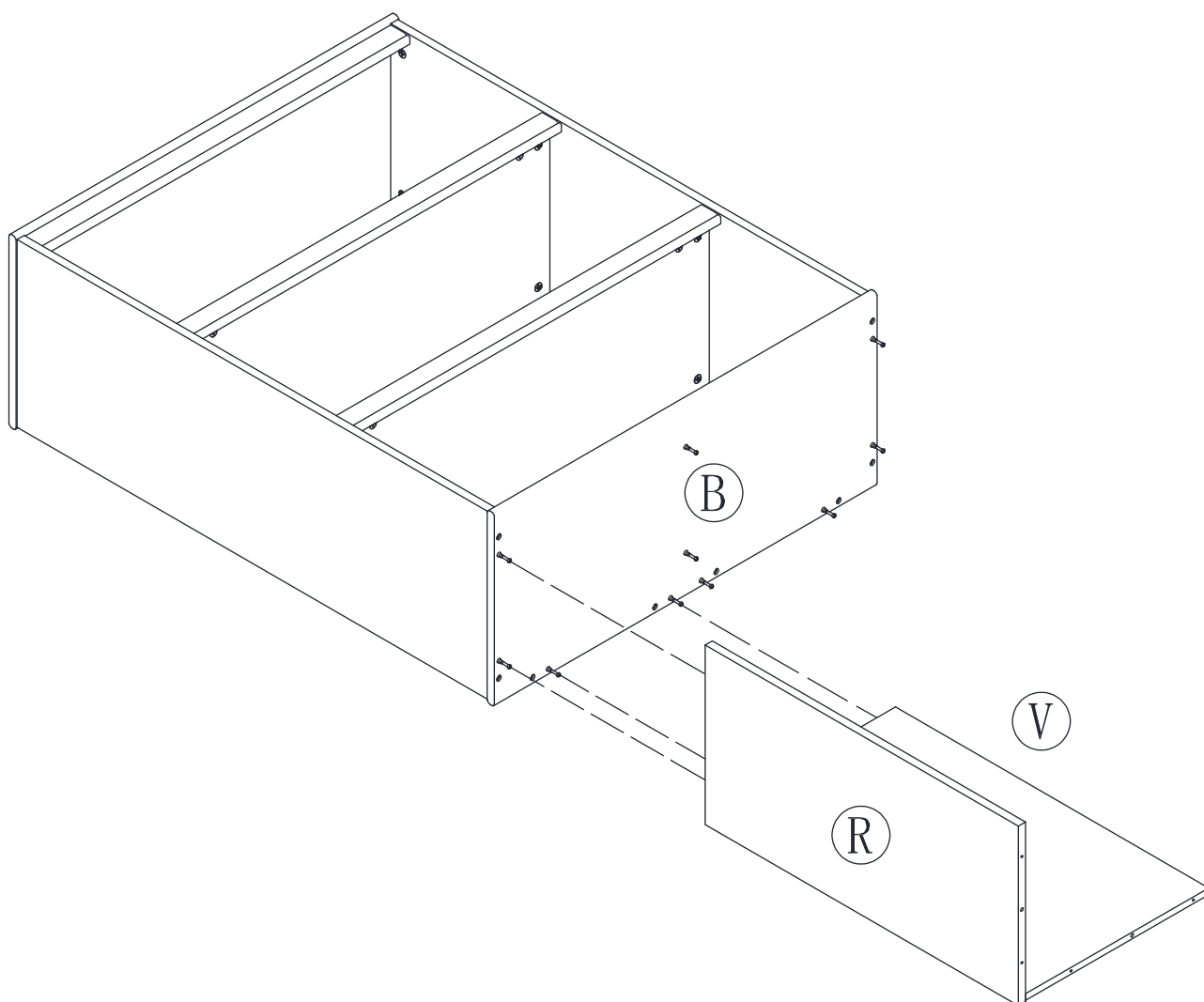
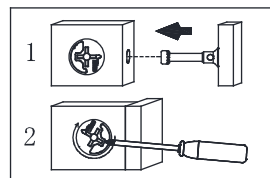
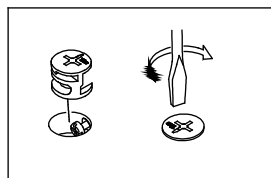
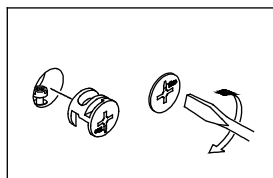

Step 16

- ◆ Fasten the LOWER RIGHT END (S) and the LOWER RIGHT BACK (X) to the LARGE SHELF (B).
Tighten four HIDDEN CAMS.

NOTE : Please tighten two HIDDEN CAMS in the LOWER RIGHT BACK (X) after you stand your unit upright on step 23.

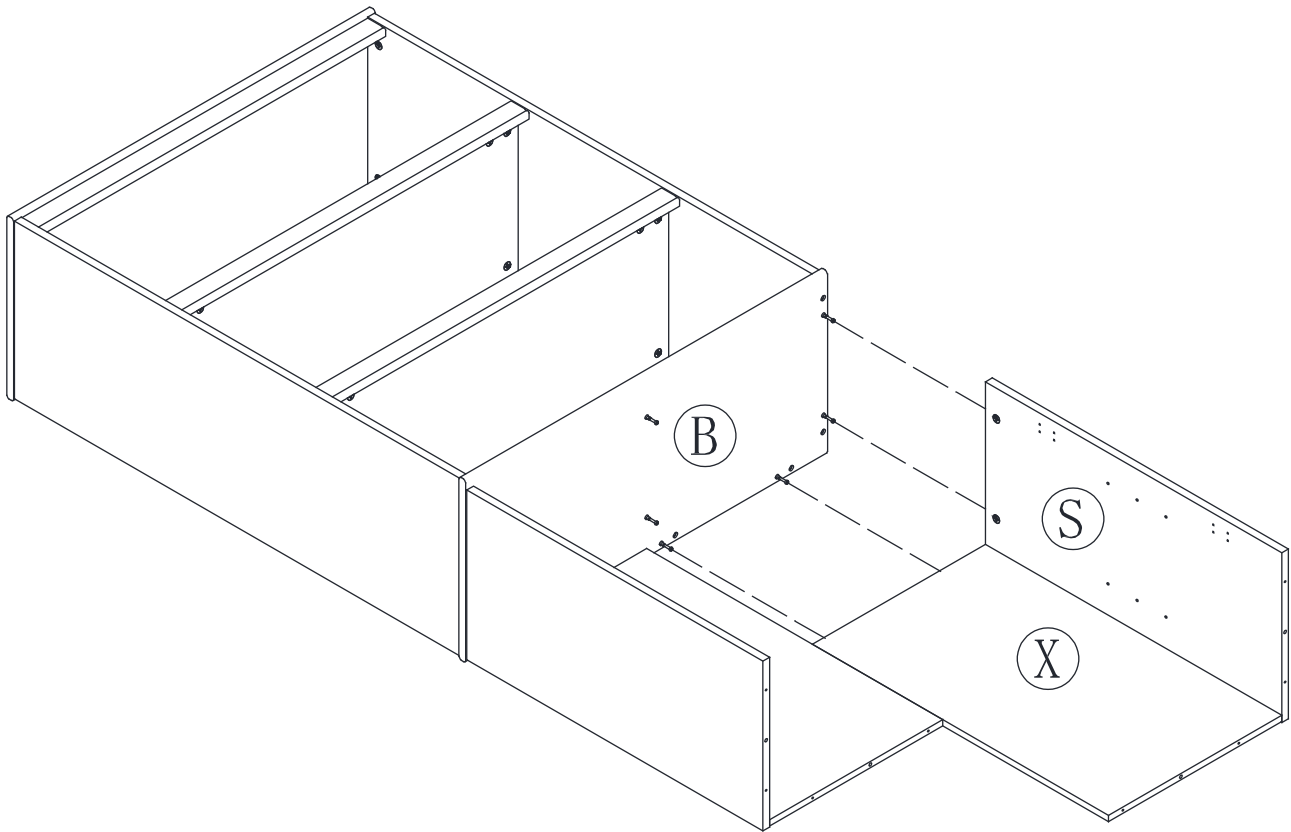
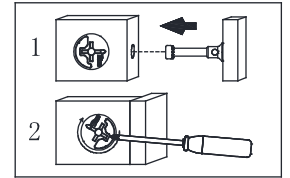
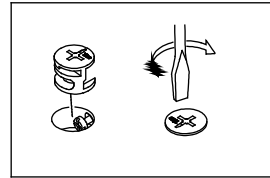
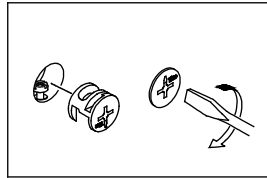

Step 17

- ◆ Fasten the UPRIGHT (T) to the LARGE SHELF (B). Tighten two HIDDEN CAMS.

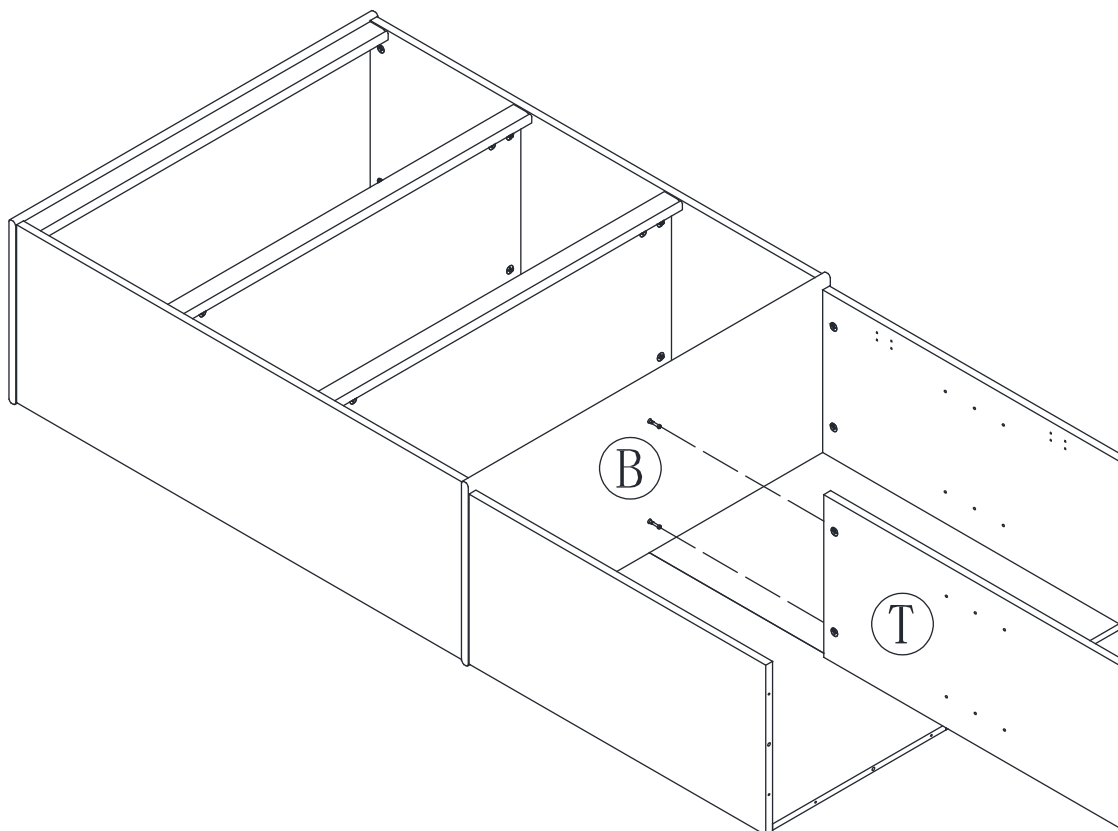
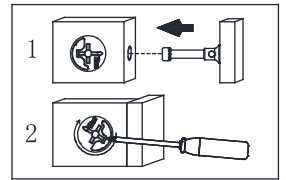
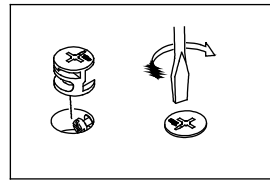
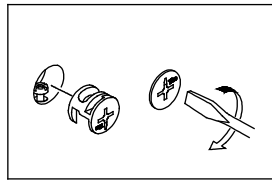

Step 18

- ◆ Insert five WOOD DOWELS (8) into the LOWER BACKS (V and X), LOWER ENDS (R and S) and the UPRIGHT (T).
- ◆ Fasten the BOTTOM (Q) to the LOWER BACKS (V and X), LOWER ENDS (R and S) and the UPRIGHT (T).
Use ten PAN HEAD SCREWS (13).

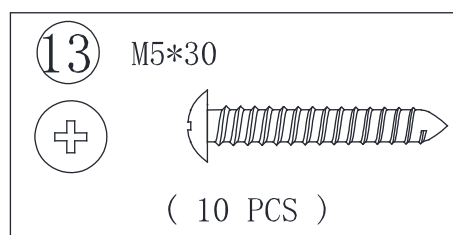
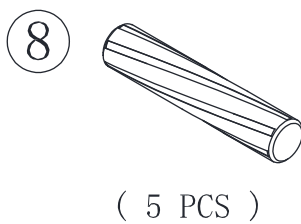
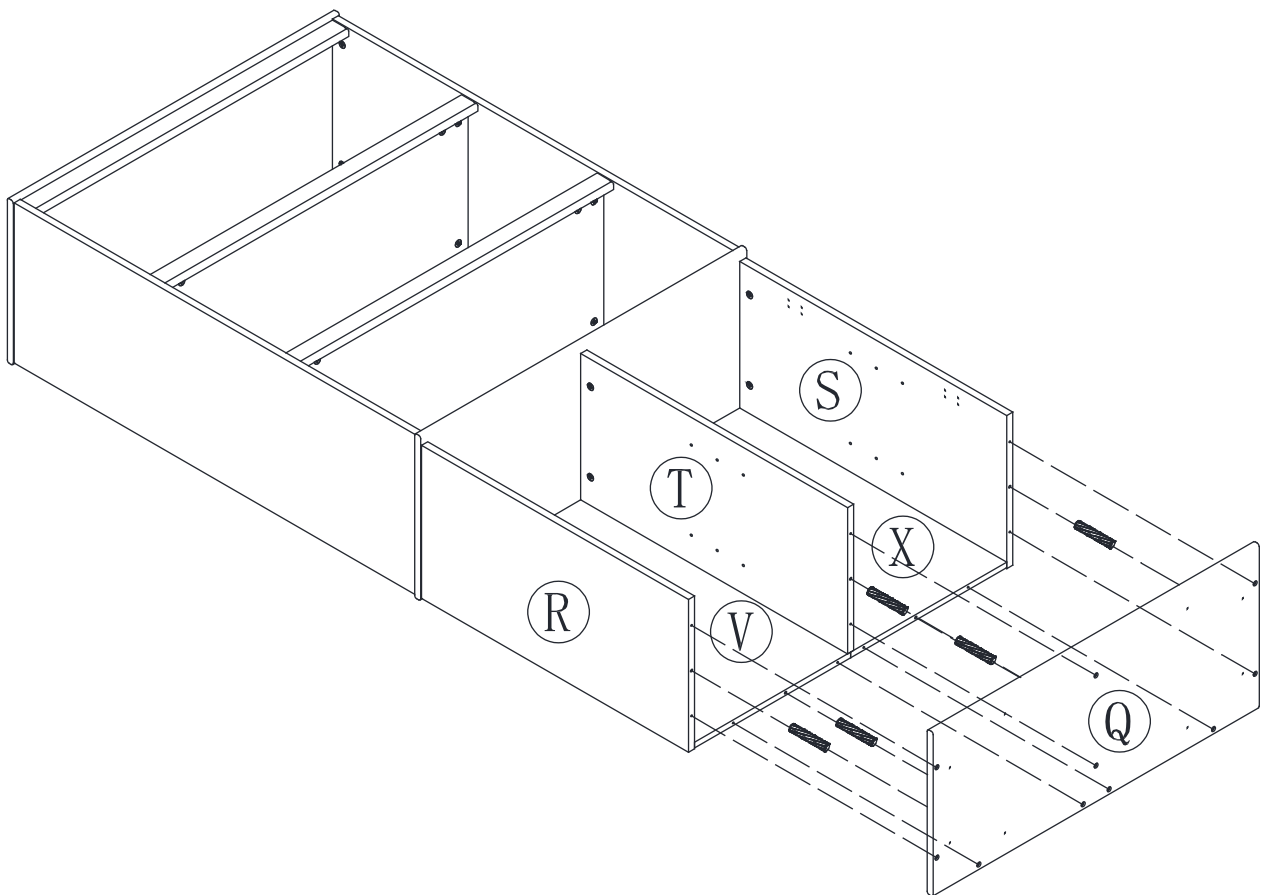
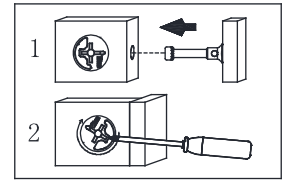
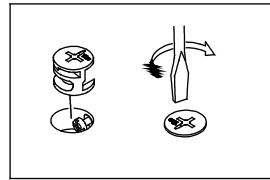
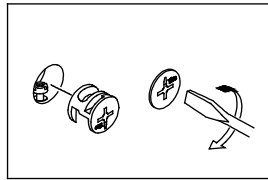

Step 19

- ◆ Fasten four METAL PLATES (4) to the FEET (O and Y) and the LONG BRACES (K).
Use sixteen PAN HEAD SCREWS (16)

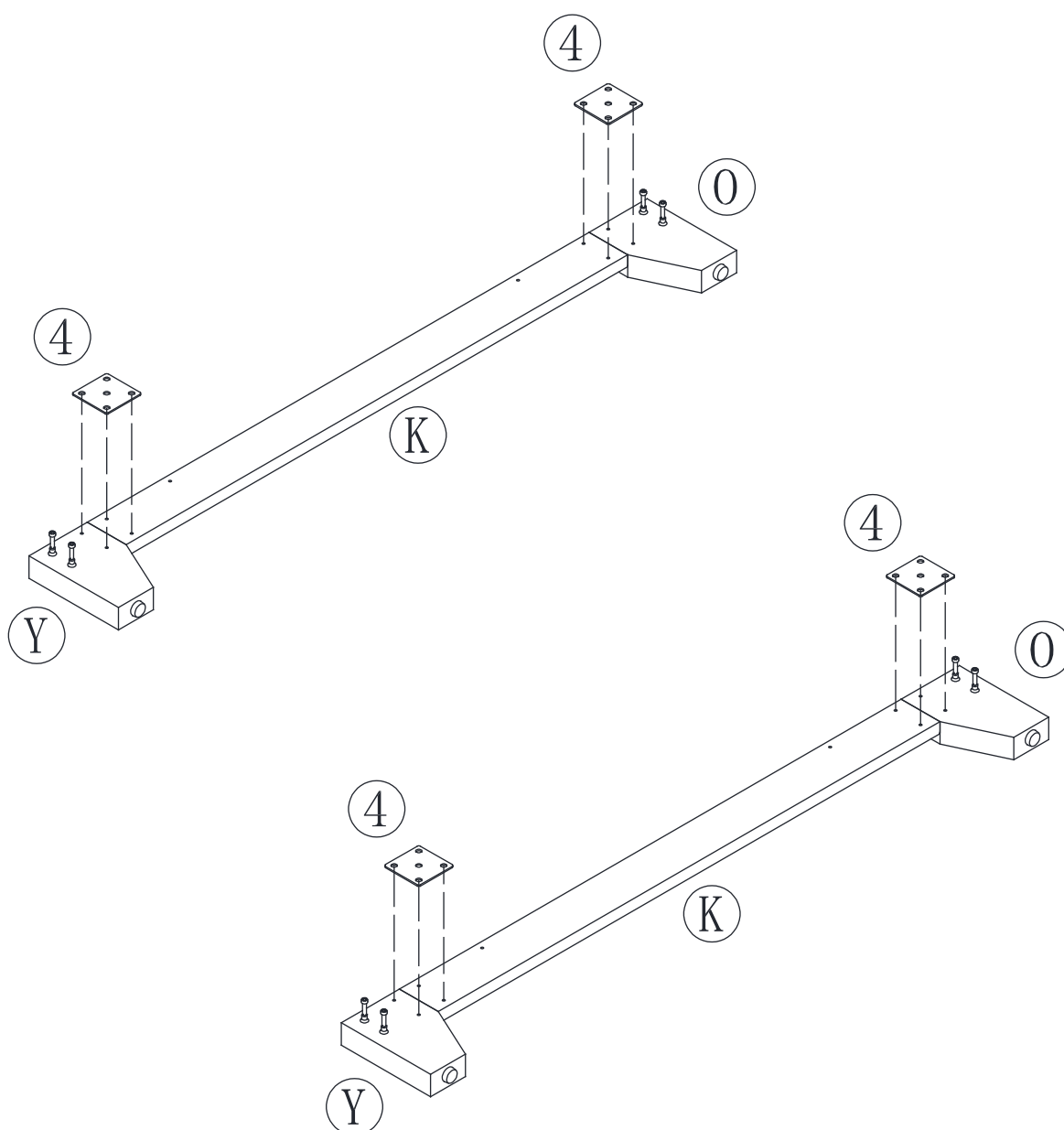
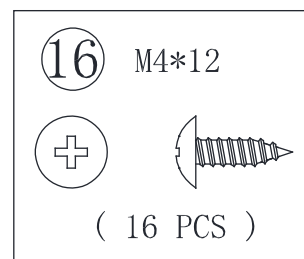

Step 20

- ◆ Fasten eight BRACKETS (7) to the LONG BRACES (K) and the SHORT BRACES (L).
Use eight PAN HEAD SCREWS (16)

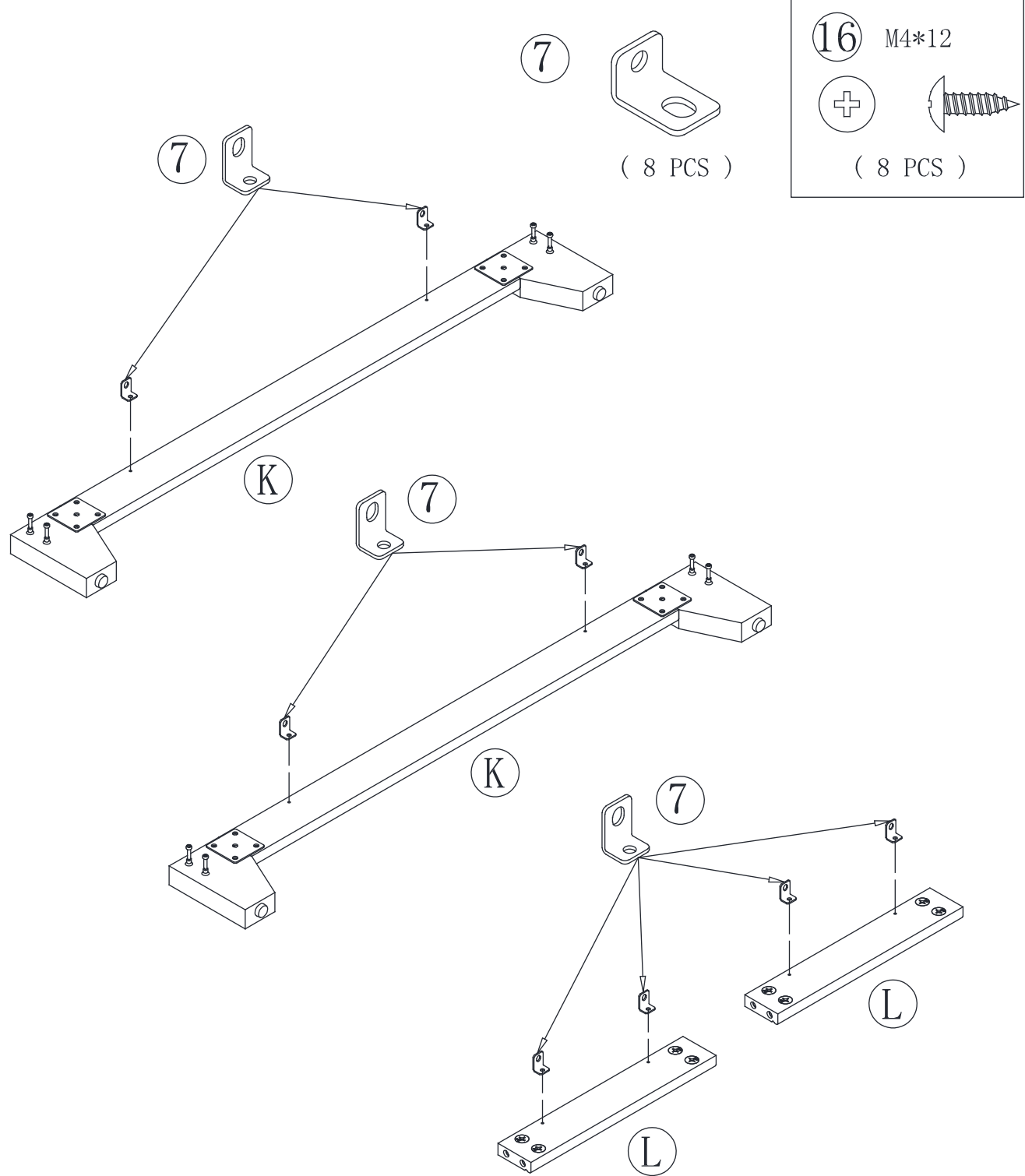

Step 21

◆ Faten two SHORT BRACES (L) to the FEET (Y and O). Tighten eight HIDDEN CAMS

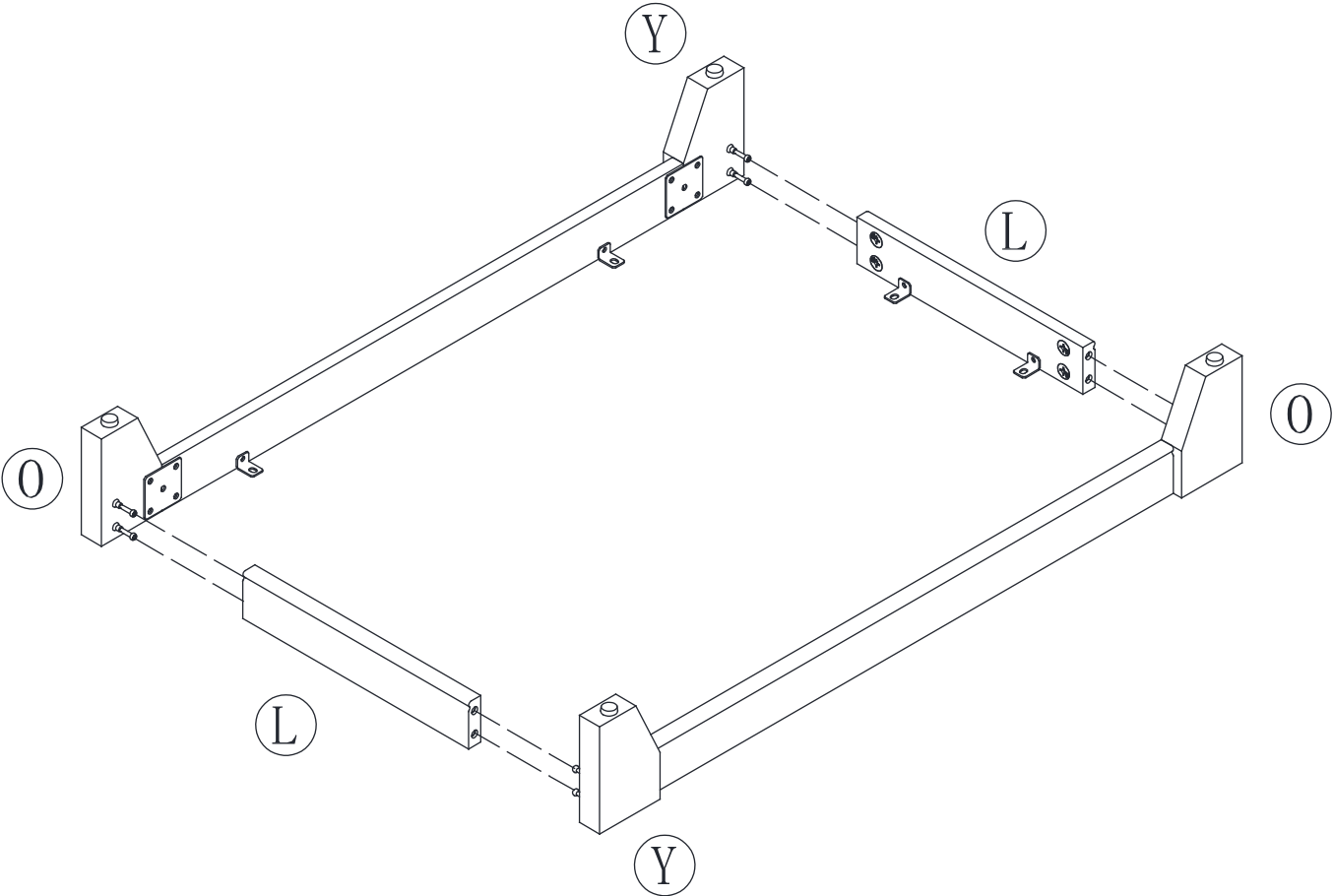
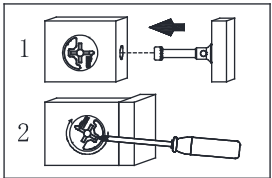
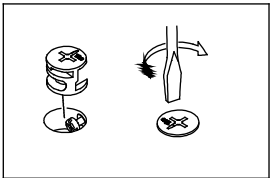
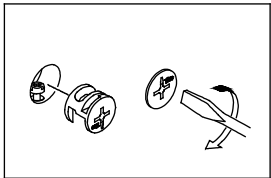

Step 22

- ◆ Fasten the BASE to the BOTTOM (Q). Use eight PAN HEAD SCREWS (16).

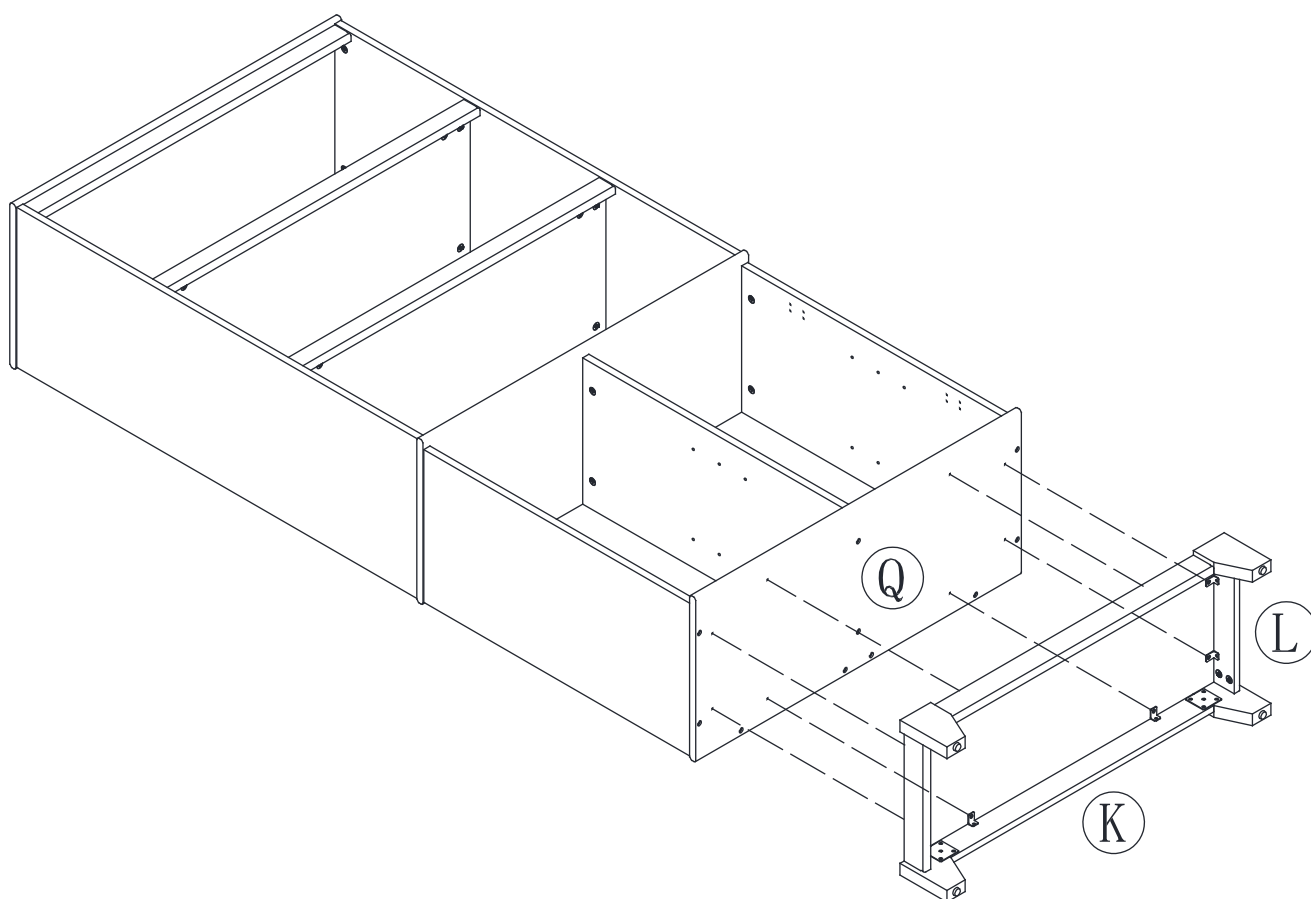
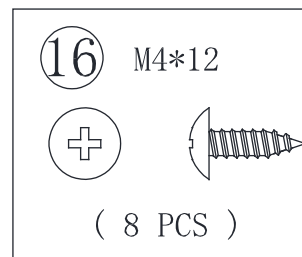

Step 23

- ◆ Carefully stand your unit upright.
- ◆ Tighten four HIDDEN CAMS in the LOWER BACKS (X and V).

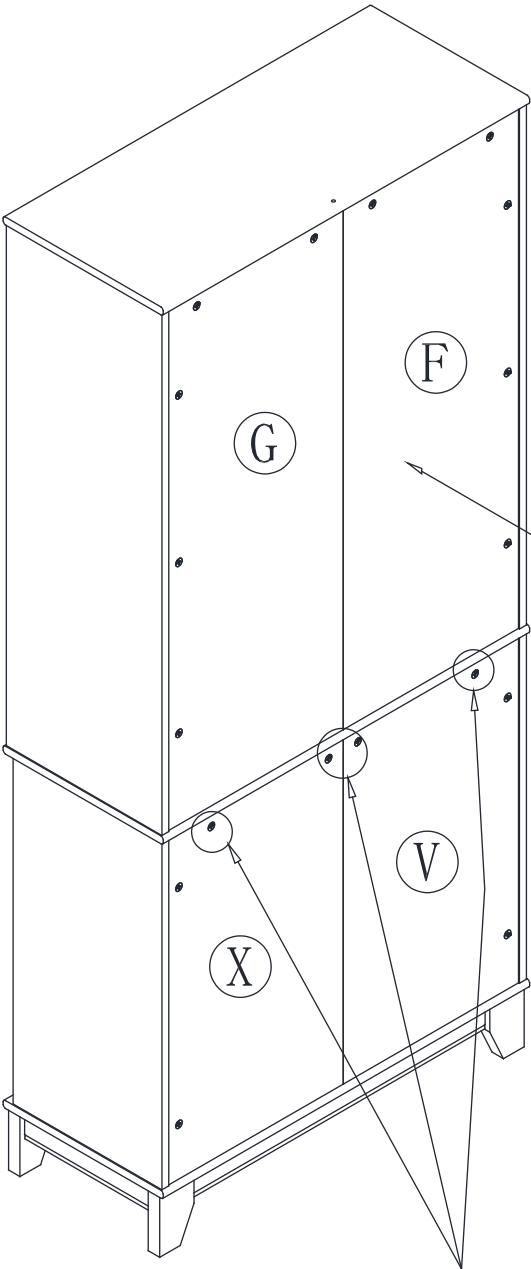
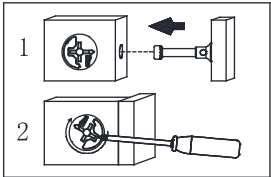
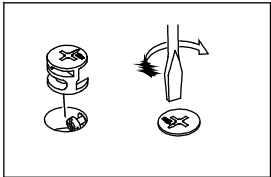
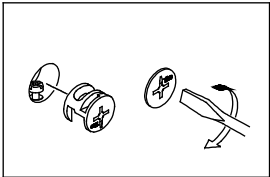

将9号布基胶带
贴在上左右背板的
中间接缝上



Step 24

- ◆ Insert eight METAL PINS (5) into the hole locations of your choice in the ENDS (R and S) and UPRIGHT (T).
- ◆ Set the ADJUSTABLE SHELVES (U) onto the METAL PINS (5)

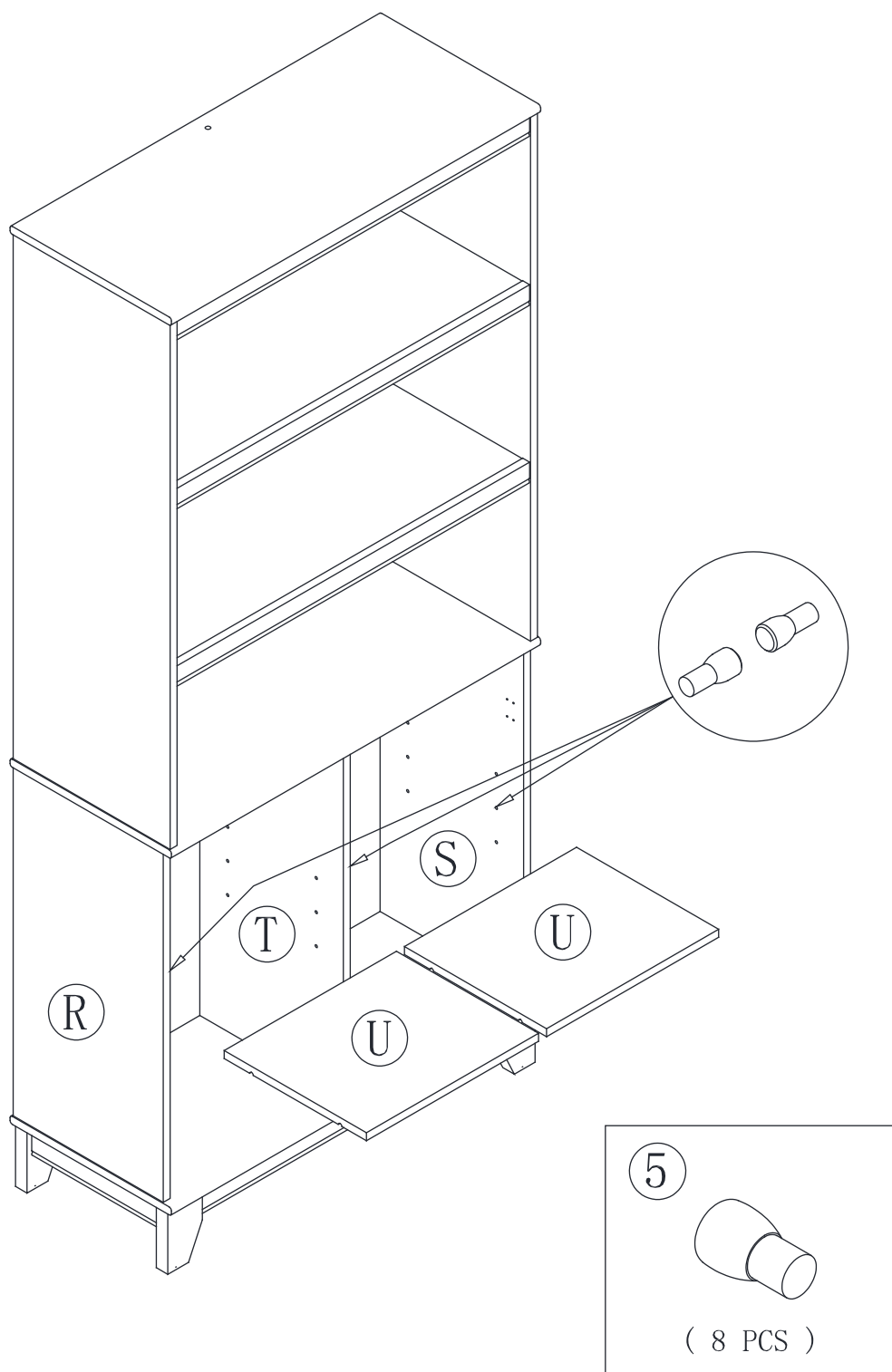

Step 25

- ◆ Fasten the HINGE (11) to the DOORS (AA and Z). Use eight FLAT HEAD SCREWS (15).
- ◆ Fasten the PULLS (6) to the DOORS (AA and Z). Use four PAN HEAD SCREWS (14)

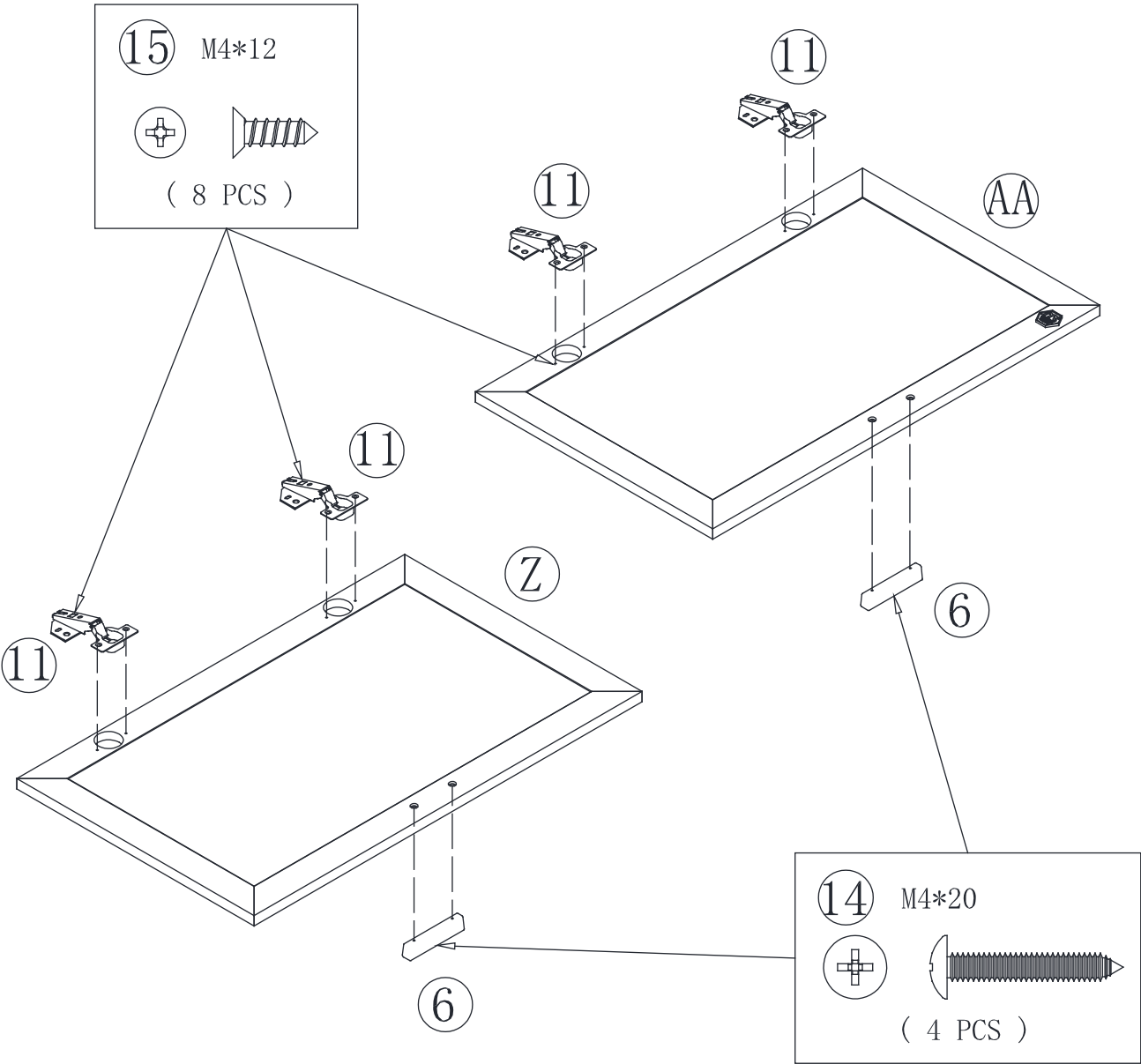

Step 26

- ◆ Fasten the DOOR (AA and Z) to the ENDS (R and S). Use sixteen FLAT HEAD SCREWS (15) through the round holes in each HINGE.
- ◆ Peel the BUMPERS from the BUMPER CARDS (10) and stick them onto the edges of the SHELVES (U)

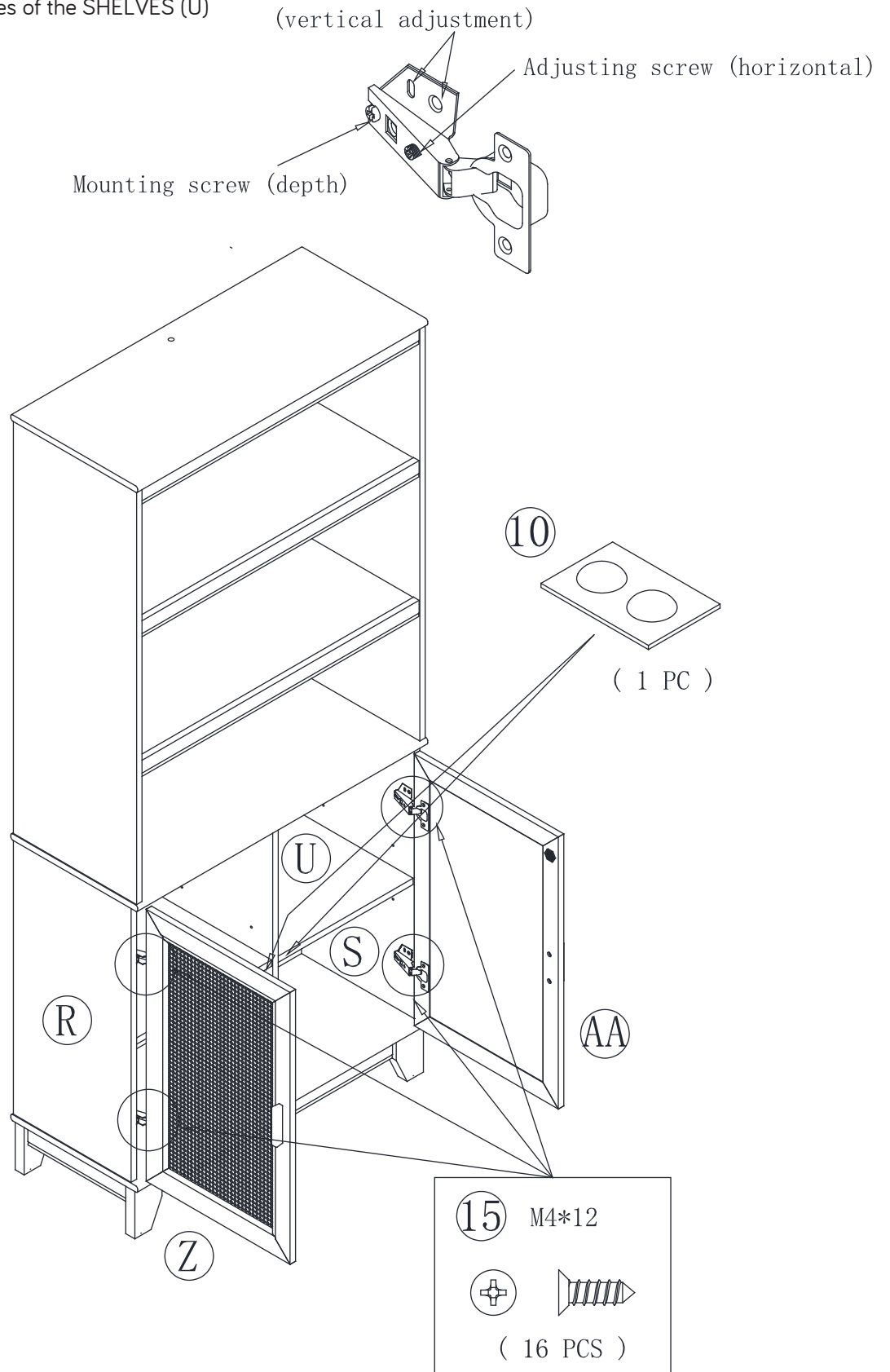

Step 27

- ◆ Place your unit in its final location.

The following instructions show your unit being fastened to a wall stud.

If you are fastening your unit to a wall stud, go to the next step now.

1st- With your pencil, strike a mark through the center of the hole in the SAFETY STRAP.

- ◆ 2nd- Drill a 3/8" hole on the mark.

3rd- While you squeeze the wings together, gently tap the WALL ANCHOR from the FURNITURE TIPPING RESTRAINT KIT (96) into the hole until it is even with the surface of the wall.

4th- Turn the LONG SCREW through the hole in the SAFETY STRAP and into the WALL ANCHOR.

NOTE: You will need to turn the LONG SCREW multiple turns to completely tighten and secure your unit to the wall.

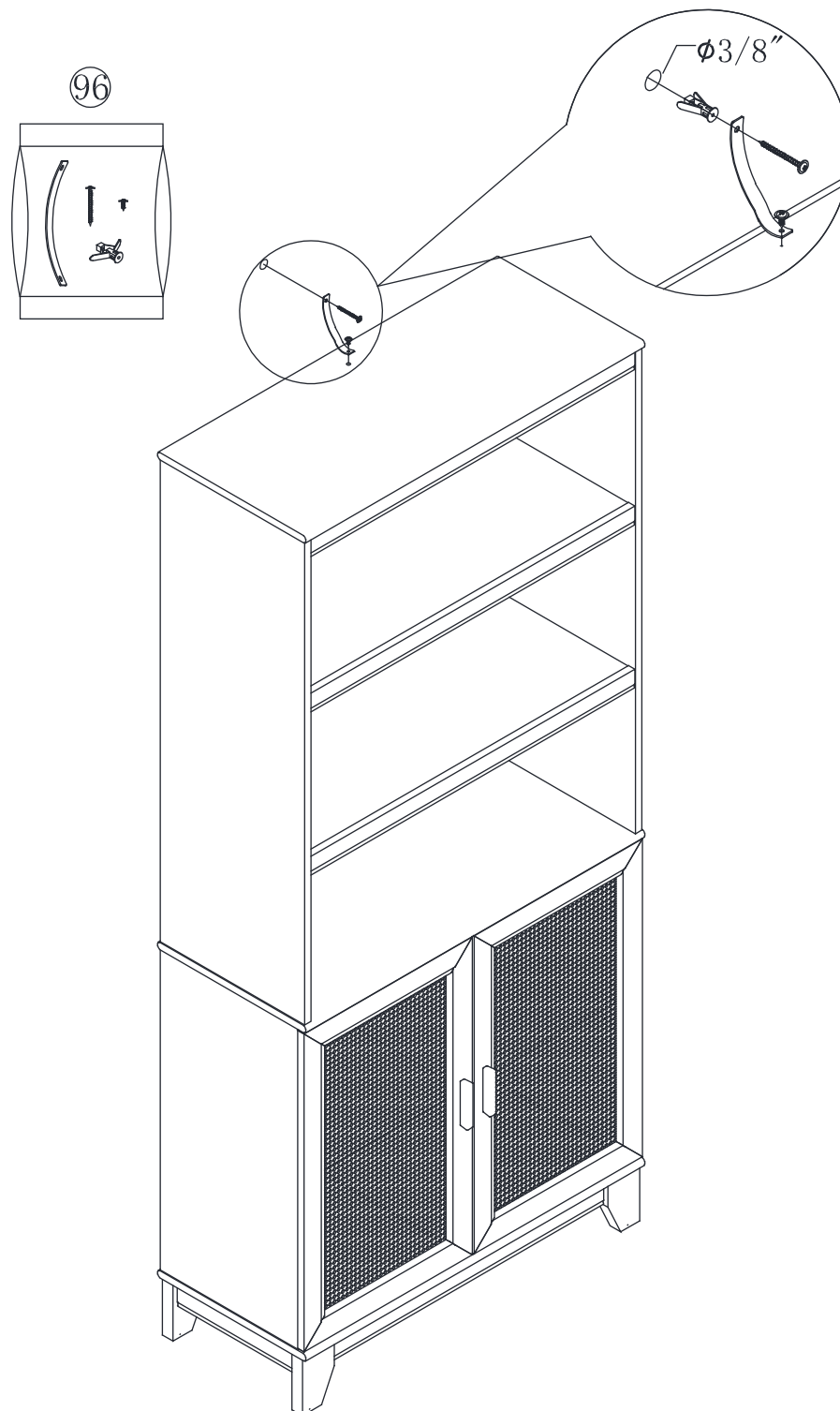

Step 28

- ◆ Place your unit in its final location.

1st - Locate the center of a stud in your wall near your unit and mark it with a pencil just below the top surface of your unit so the SAFETY STRAP will not be visible.

- ◆ 2nd- Drill a 1/8" hole on the mark and into the stud in your wall.
3rd- Fasten the unit to the wall. Use the LONG SCREW through the other end of the SAFETY STRAP and into the 1/8" hole.

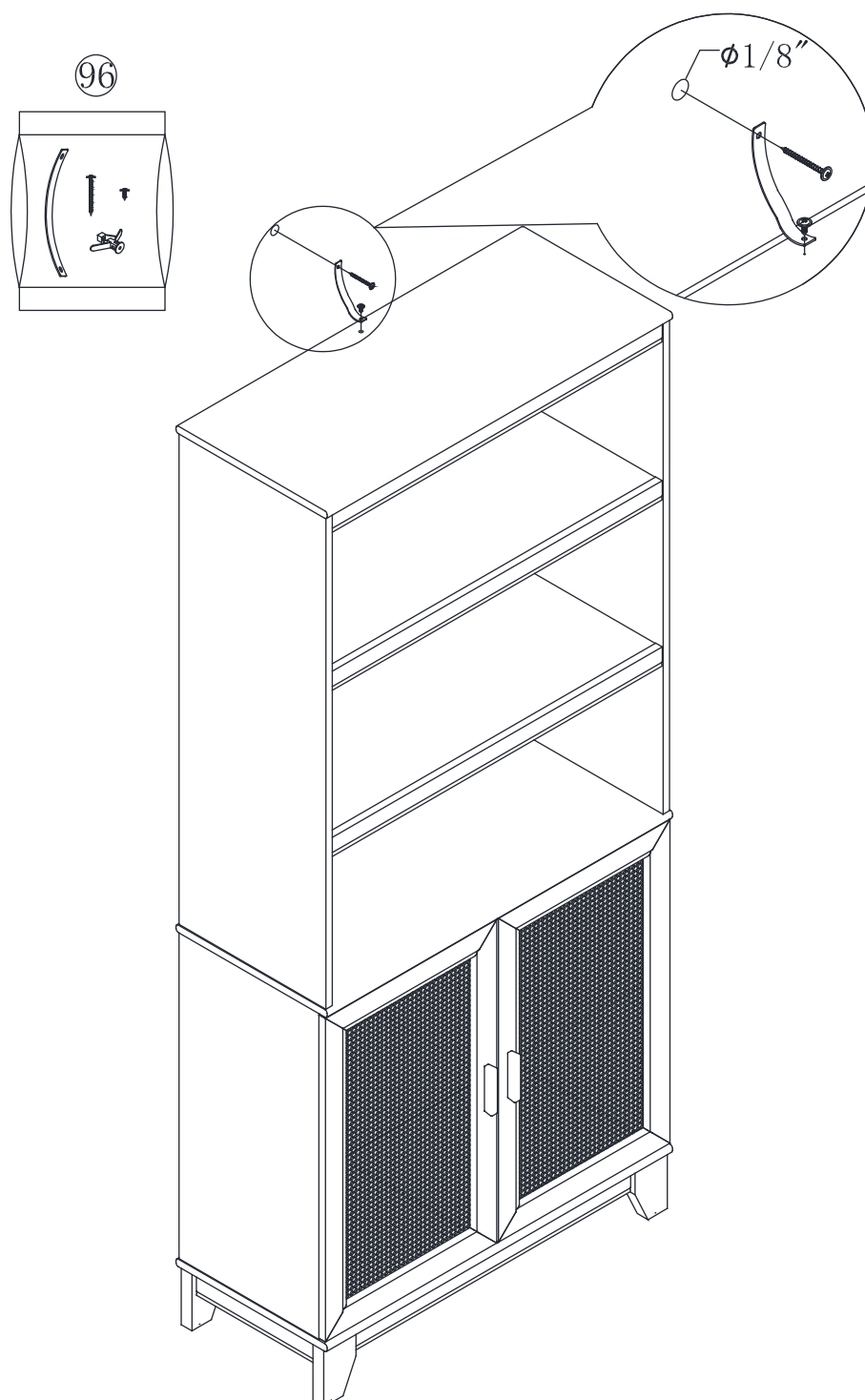

Step 29

- ◆ Peel APPLIQUES from the APPLIQUE CARDS (3) and stick them onto each visible HIDDEN CAM.

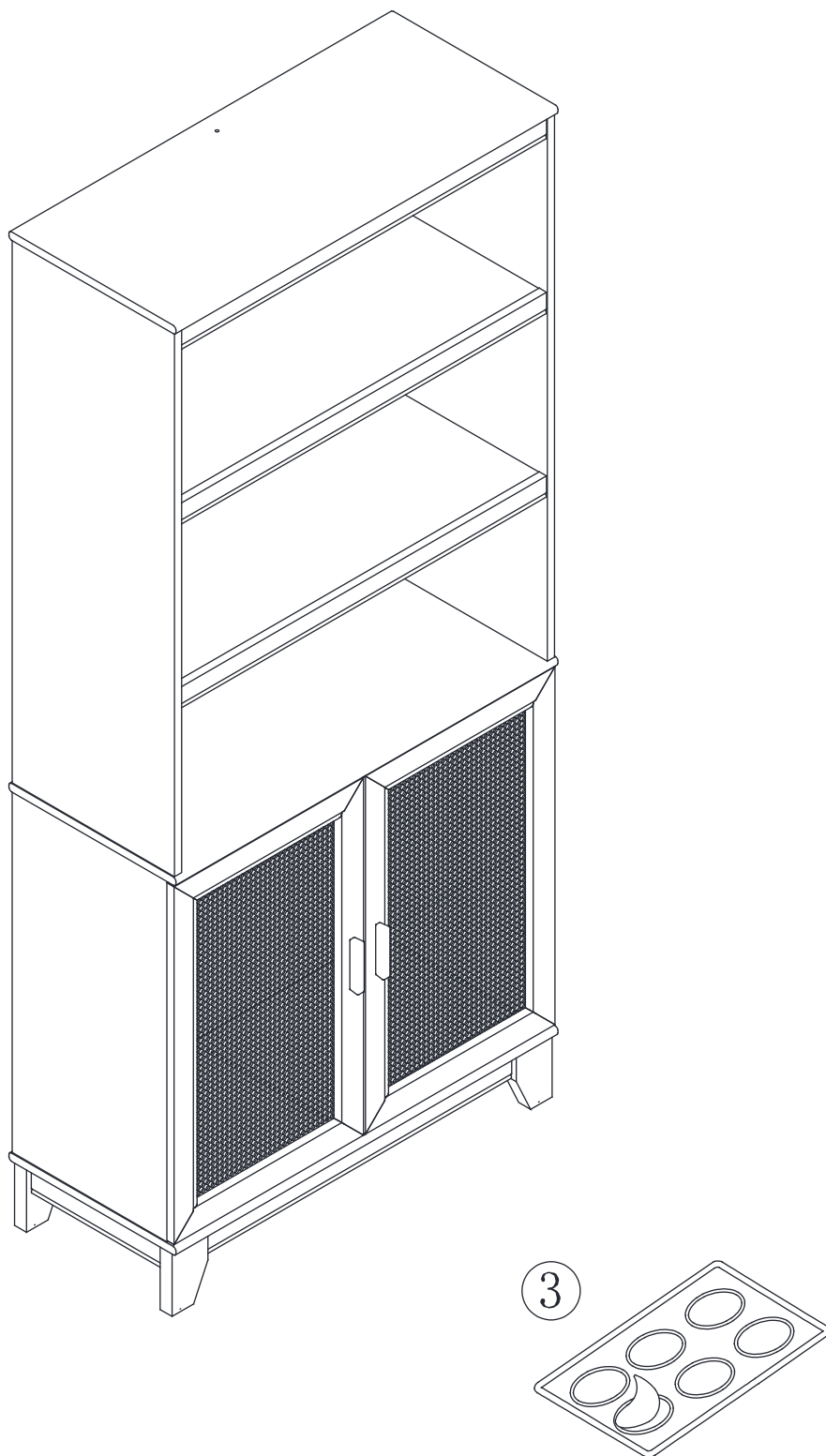

Step 30

