

# ASSEMBLY INSTRUCTIONS

## FULL UPH HEADBOARD

## FULL UPH FOOTBOARD W/ SLATS

## FULL UPH SIDE RAIL

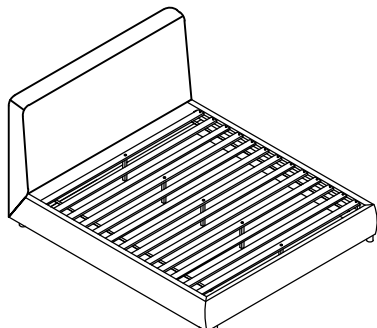

Thank you for purchasing this product. Please take time to read and follow the instructions below. Check that you have all parts and hardware before assembly. Parts apparently missing are often found in the packing materials. If you do not have all the parts listed, have your dealer contact us and they be sent to you immediately.



It is recommended to install protective pads under all legs and support to avoid damage or scratches when placing furniture on a wood floor or other hard surface, and to limit Indentation and prevent discoloration if placing on carpet.

\* DO NOT TIGHTEN BOLTS UNTIL COMPLETELY ASSEMBLED

### 191B1931F-1 PARTS LISTS

NO.	SKETCH	DESCRIPTION	QTY
A		Headboard	1 PC
B		Bun foot	2 PCS

### HARDWARE LISTS

NO.	SKETCH	DESCRIPTION	SIZE	QTY
1		Thread Bolt	Ø5/16"-18 x 3-1/8"L	6 PCS
2		Flat washer	Ø5/16" x 23/32" x 2mmT	6 PCS
3		Hex Nut	Ø5/16"x1/2"x5/8"L	6 PCS
4		Open Wrench	1/2" x 3-1/2"L	1 PC

### 191B1931F-2 PARTS LISTS

B		Bun foot	2 PCS
C		Footboard	1 PC
D		Slat	1 ROLL/ 13 PCS
E		Slat Support Leg	5 PCS

\* ABOVE HARDWARE ARE PACKED IN #191B1931F-1 FOR ASSEMBLY

### HARDWARE LISTS

5		Bolt	Ø5/16"-18 x 1-1/4"L	8 PCS
6		Spring washer	Ø5/16" x 13/32" x 2mmT	8 PCS
7		Flat washer	Ø5/16" x 23/32" x 2mmT	8 PCS
8		Allen Key	1/6" x 2-3/8"L	1 PC
9		Metal Connector	7-4/5" x 2" x 2" x 2mmT	2 PCS
10		Screw	M4-13 x 1-1/4"L	26 PCS
		Screwdriver	Not Provided	

\* ABOVE HARDWARE ARE PACKED IN #191B1931F-2 FOR ASSEMBLY

### 191B1931F-3 PARTS LISTS

F		LSF Side Rail	1 PC
G		RSF Side Rail	1 PC

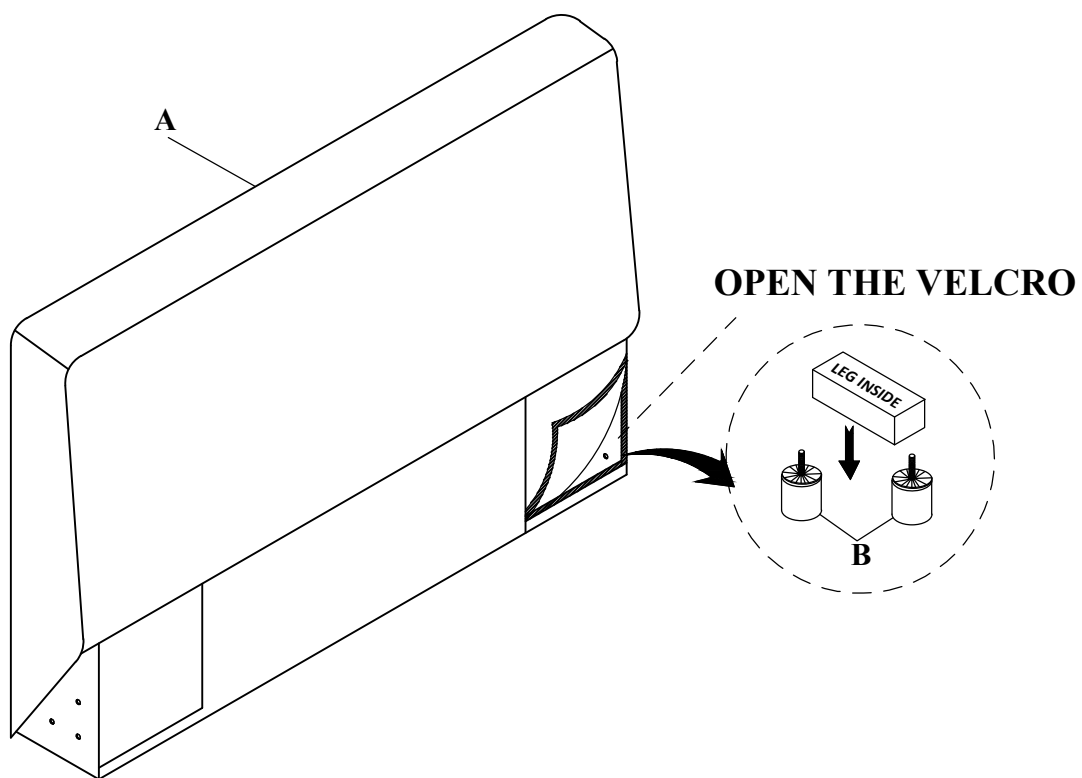

STEP 2:

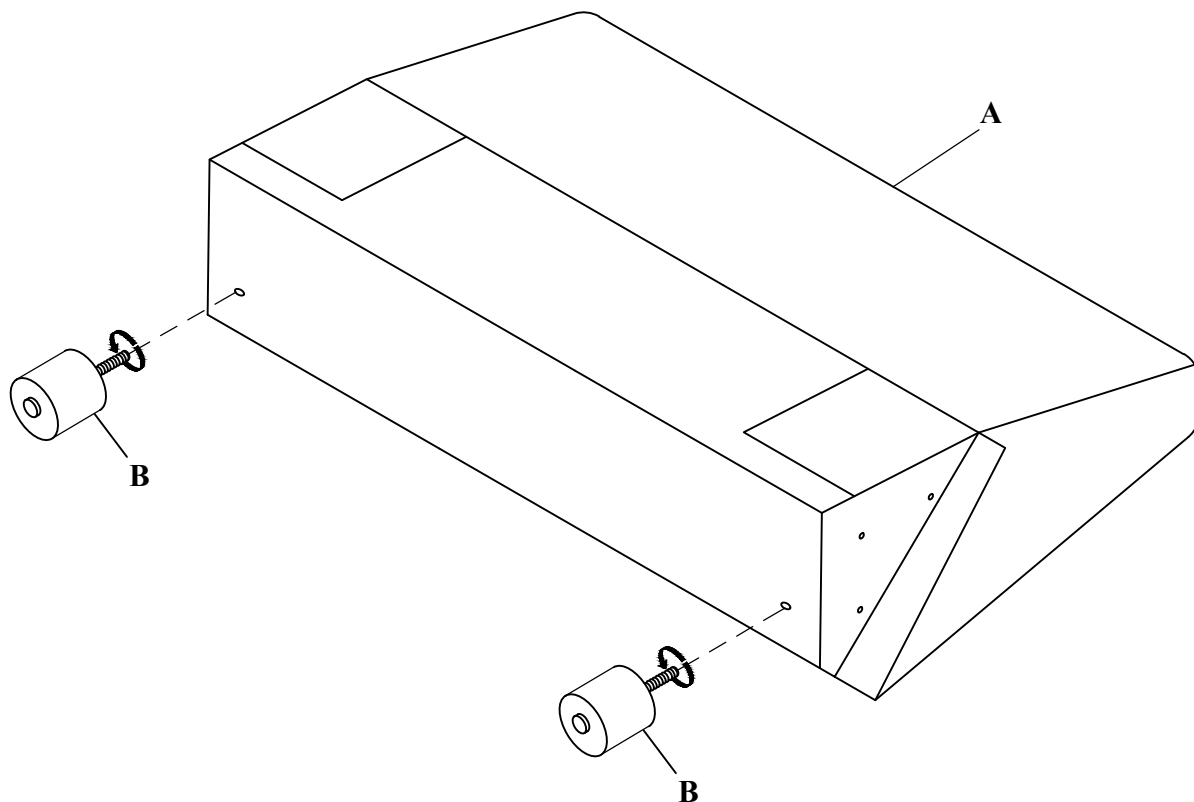

STEP 3:

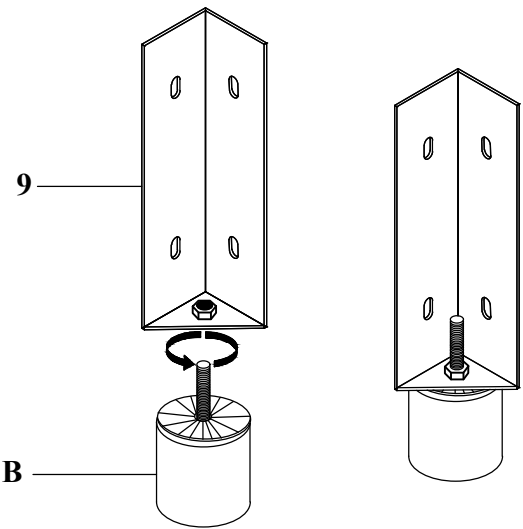

STEP 4:

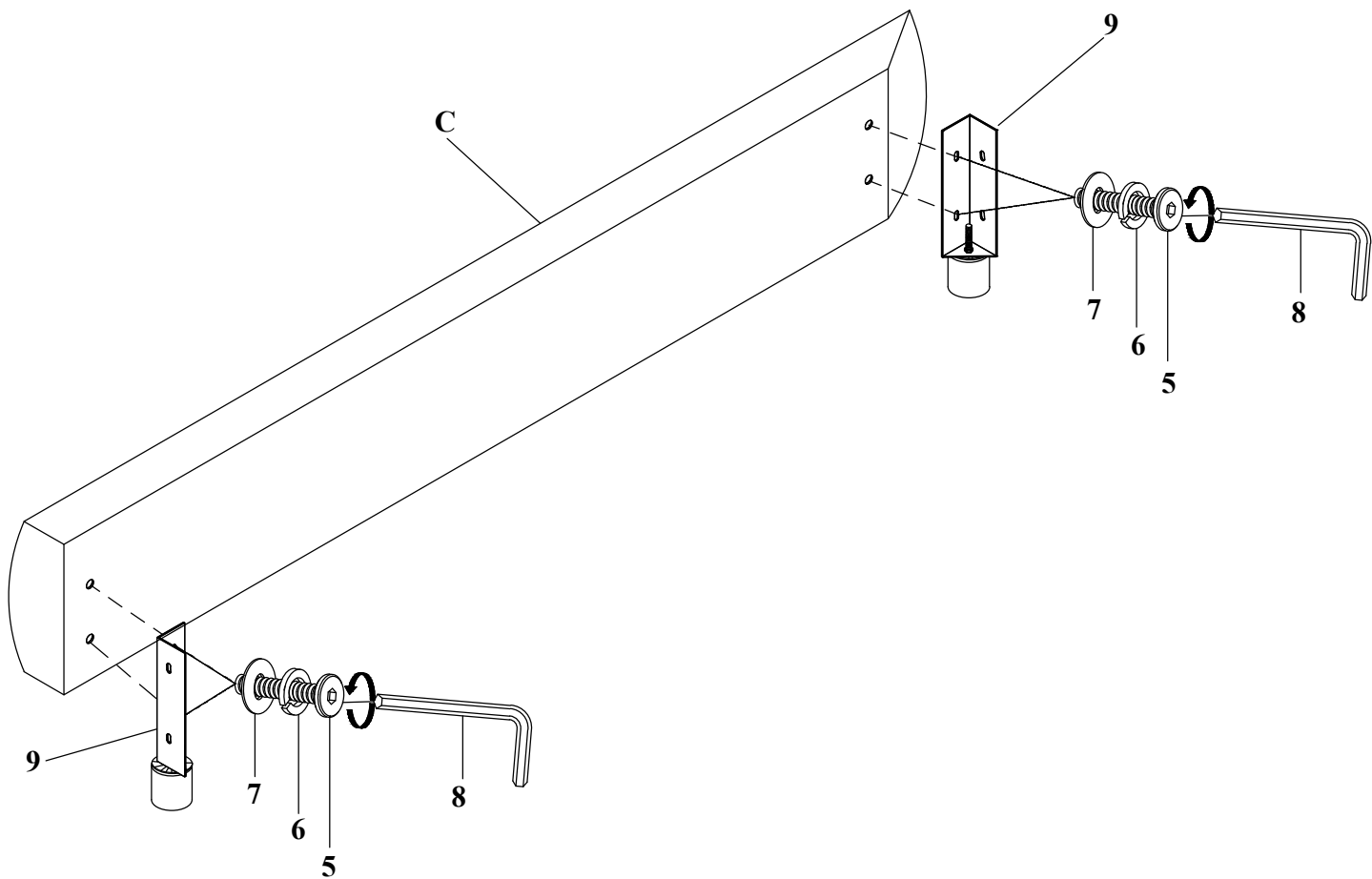

**STEP 5:**

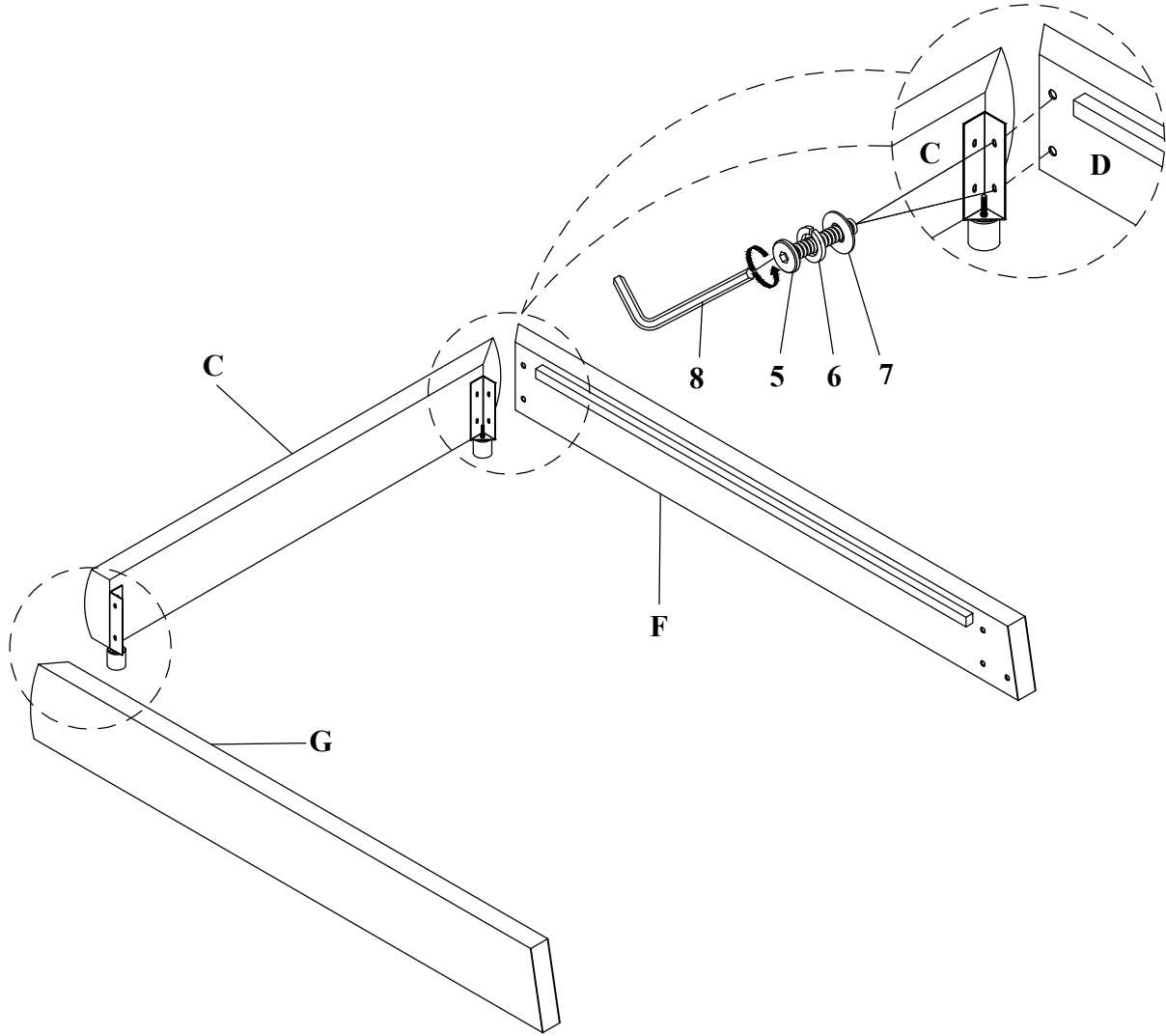

**STEP 6:**

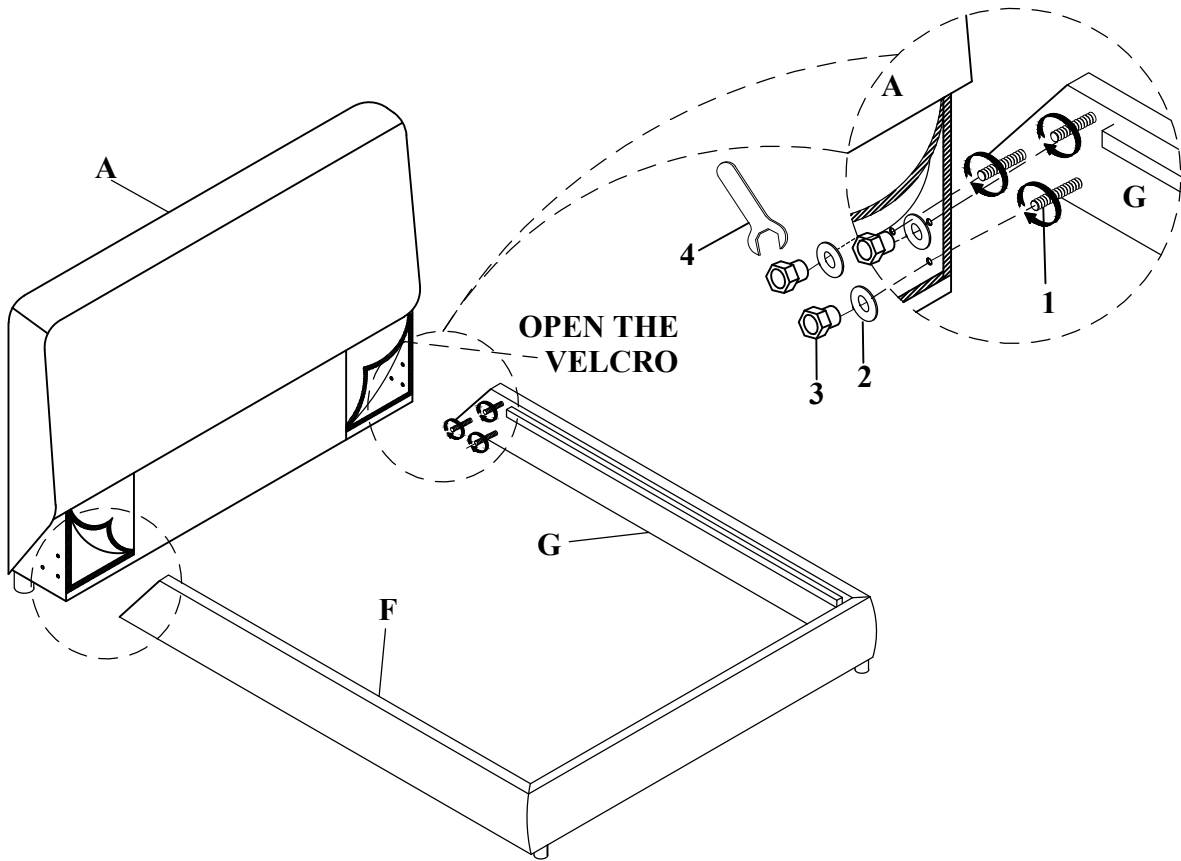

**STEP 7:**

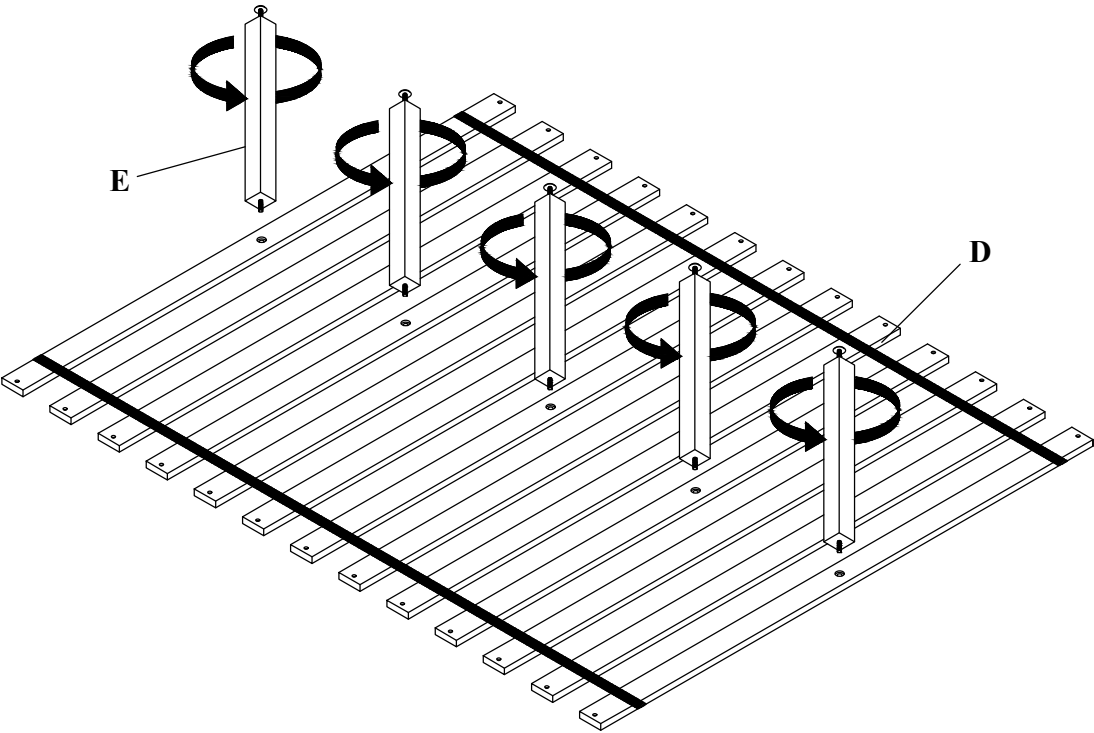

**STEP 8:**

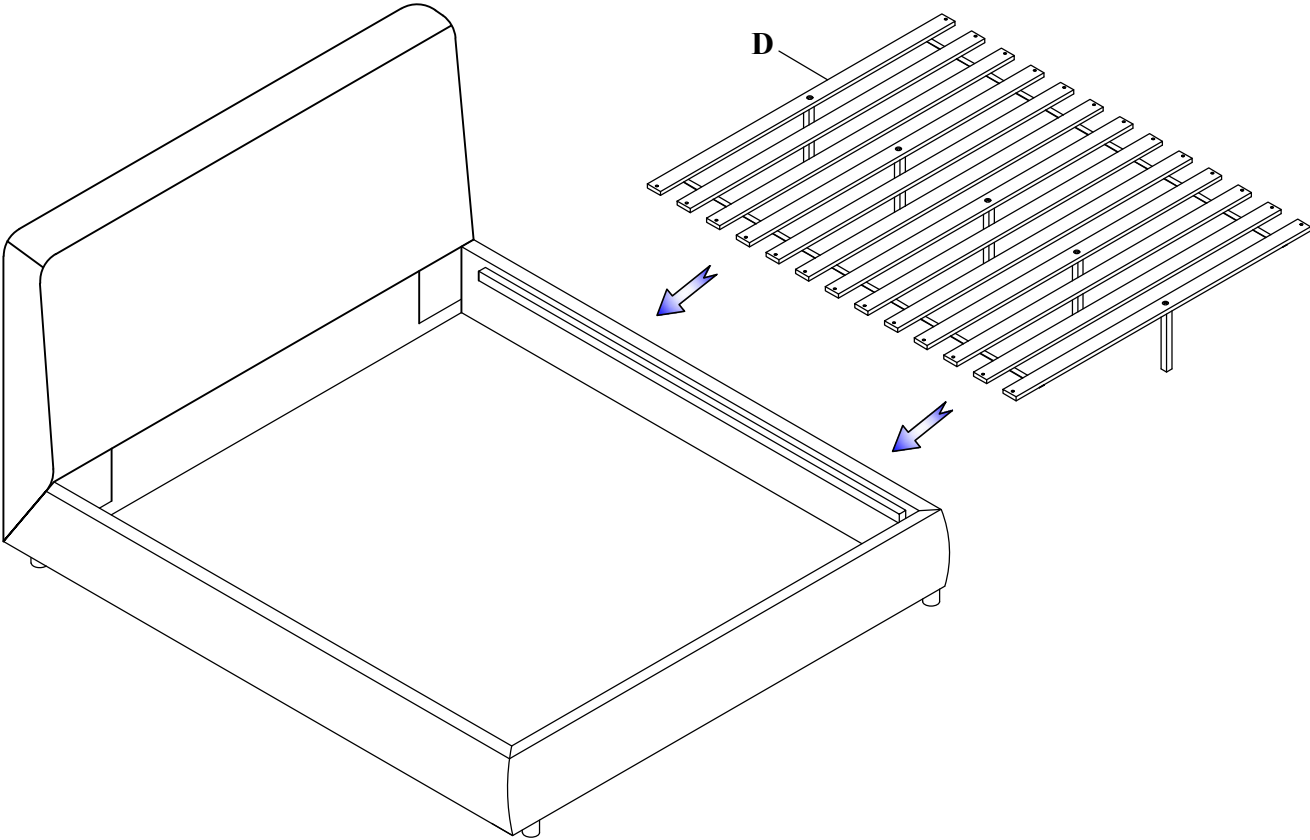

**STEP 9:**

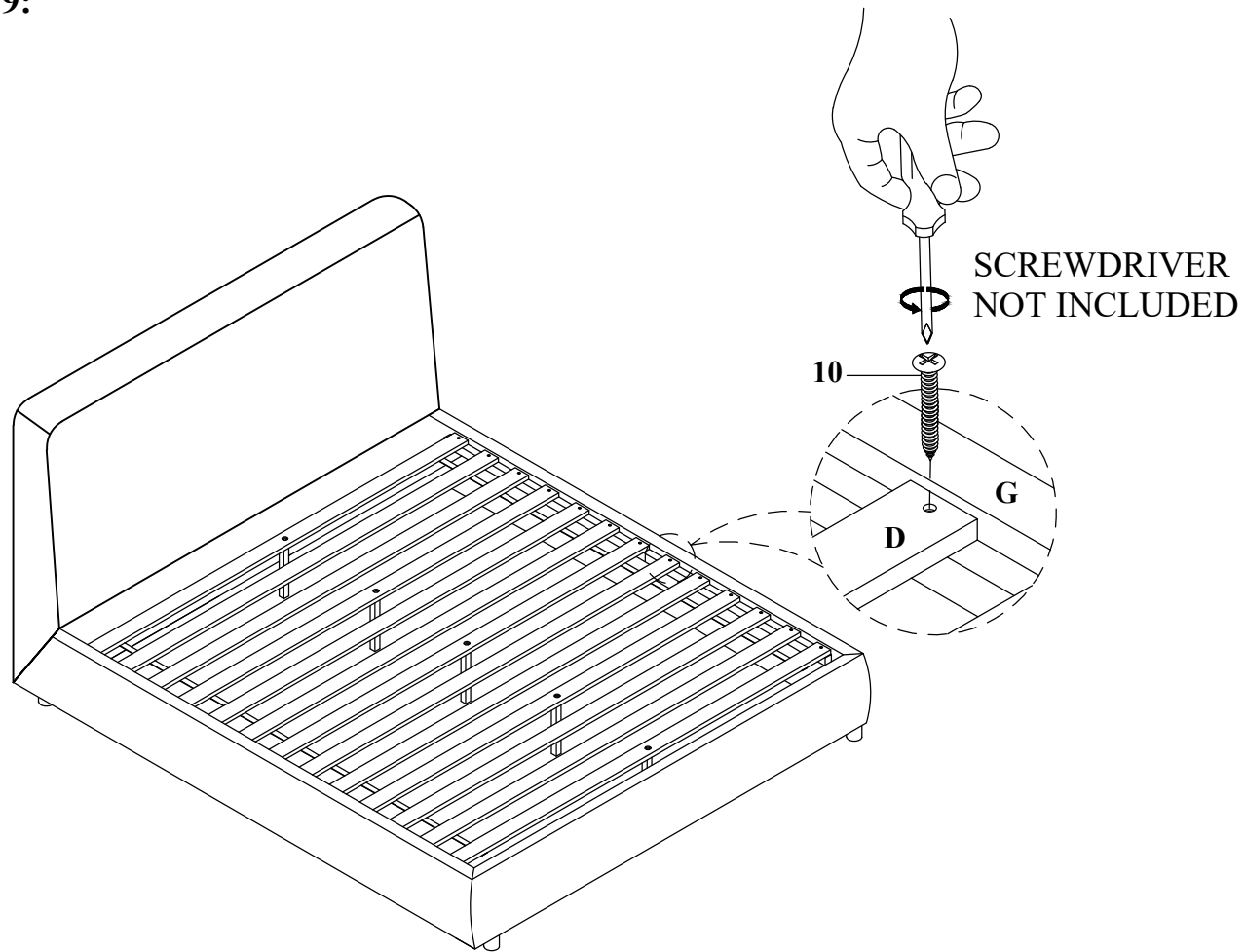

**COMPLETED**

