

Let's build the

Thatcher Bench

SKU 22701

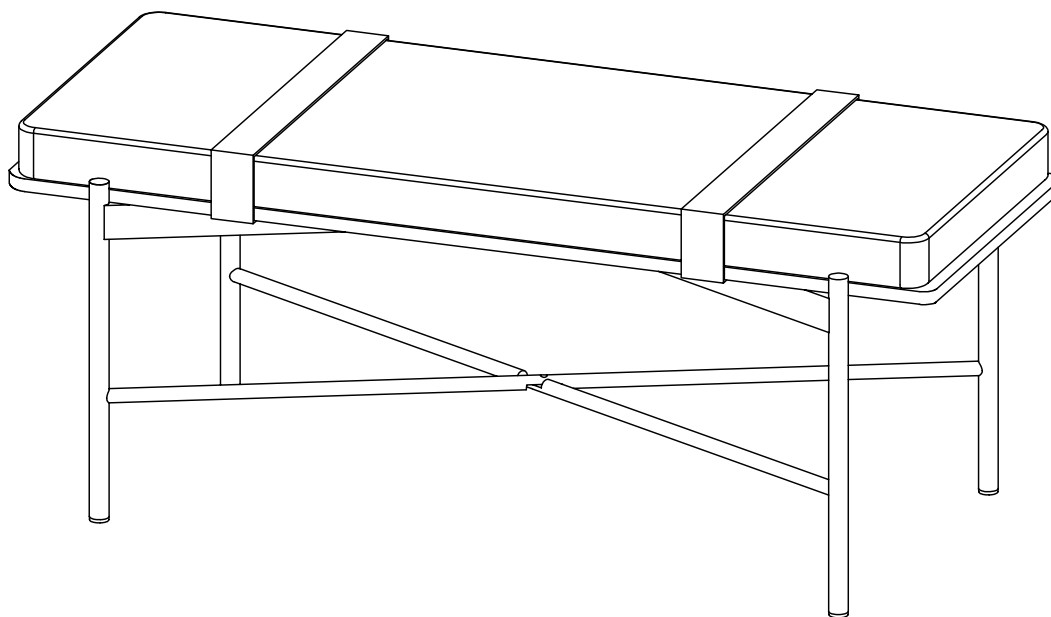

Scan me!

Free Lifetime
Warranty

nathan james

23-0512

Ok, let's get rolling

This should be easy, just follow our instructions and you will be back to Netflix in no time.

Estimated time for assembly



15:00

What you need

- Some of your favourite bubbly or your preferred relaxant
- Use the packaging carton as a working surface to prevent product damage during assembly

Do not use a drill



Weight Limitation



330
lbs

Toll-free at 1-866-619-1004
Help@nathanjames.com
Nathanjames.com/help

What's included

Description		Qty
A	Allen Key	1
B	M6*25mm Bolt	1
C	M6*55mm Bolt	8
D	Spring Washer	8
E	Flat Washer	8
F	Nut	1
G	Wrench	1
H	M6*12mm Bolt	4
1	Lower Frame	1
2	Upper Frame	1
3	Bench Platform	1
4	Seat Cushion	1
5	Strap	2

Scan me!

Free Lifetime
Warranty



The goods

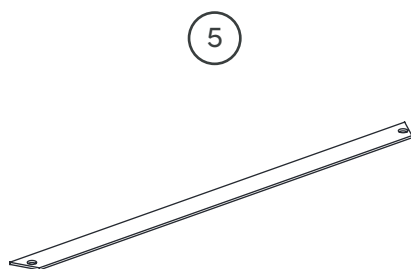
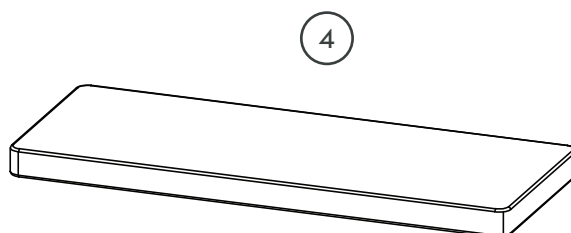
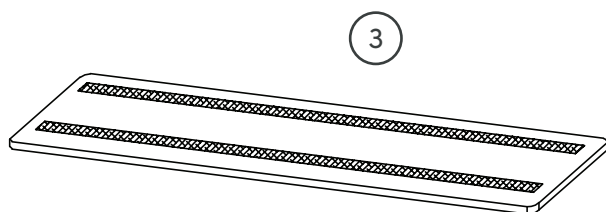
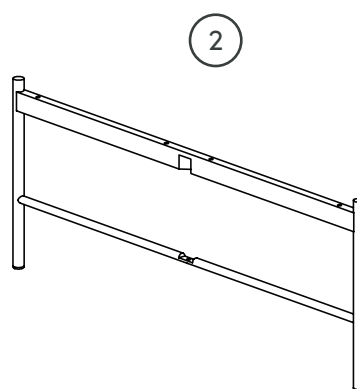
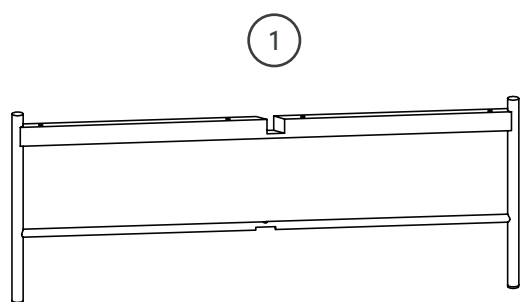
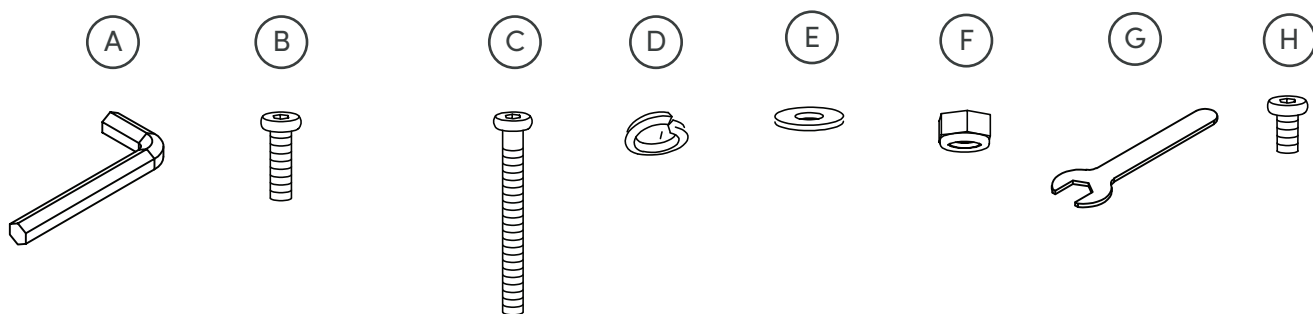

IMPORTANT

1. Do not tighten bolts / screws completely until all bolts / screws are lined up and inserted into holes.
2. Do not over tighten screws and bolts to avoid stripping.
3. Please use hand tools to assemble this product. Do not use power tools.

Step 1

Let's get this thing fired up! To start, assemble the frame by sliding the Lower Frame (1) inside the Upper Frame (2). Then rotate the Lower Frame so that the notches in it align with the notches in the Upper Frame.

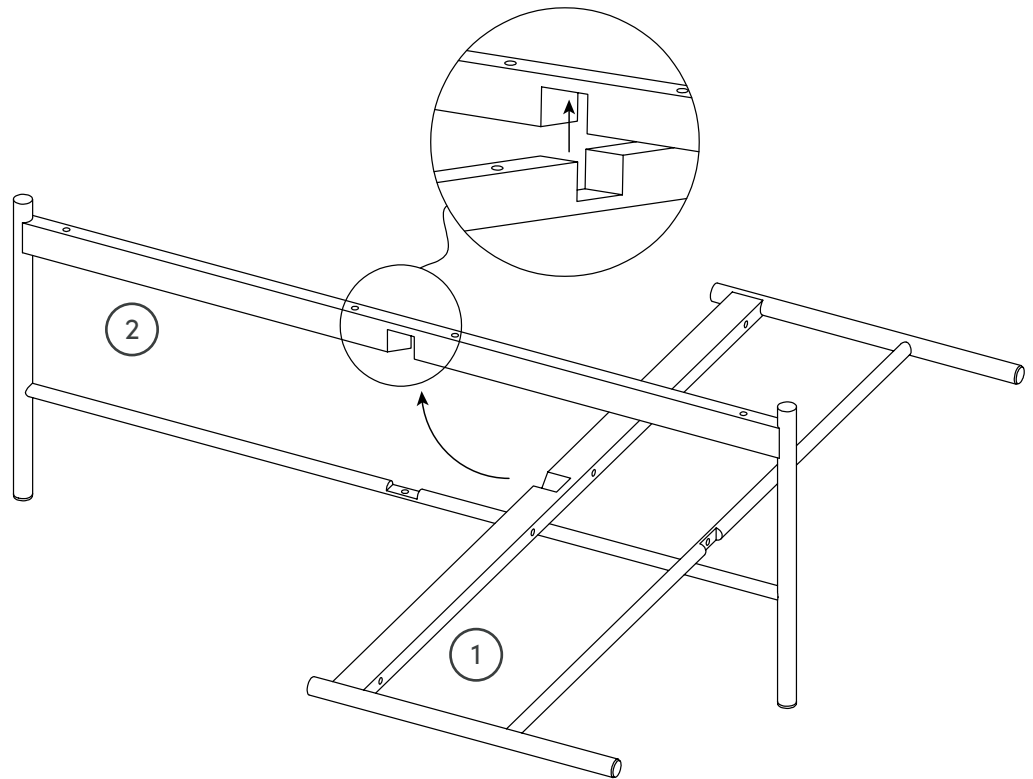

Step 2

Once in place, the frame should form an "X" shape. Once it's aligned into place, secure by slotting the M6*25mm Bolts (B) through the aligned holes in the Frames. Tighten using the Allen Key (A). On the underside, secure in place using a Nut (F) and tighten using the Wrench (G).

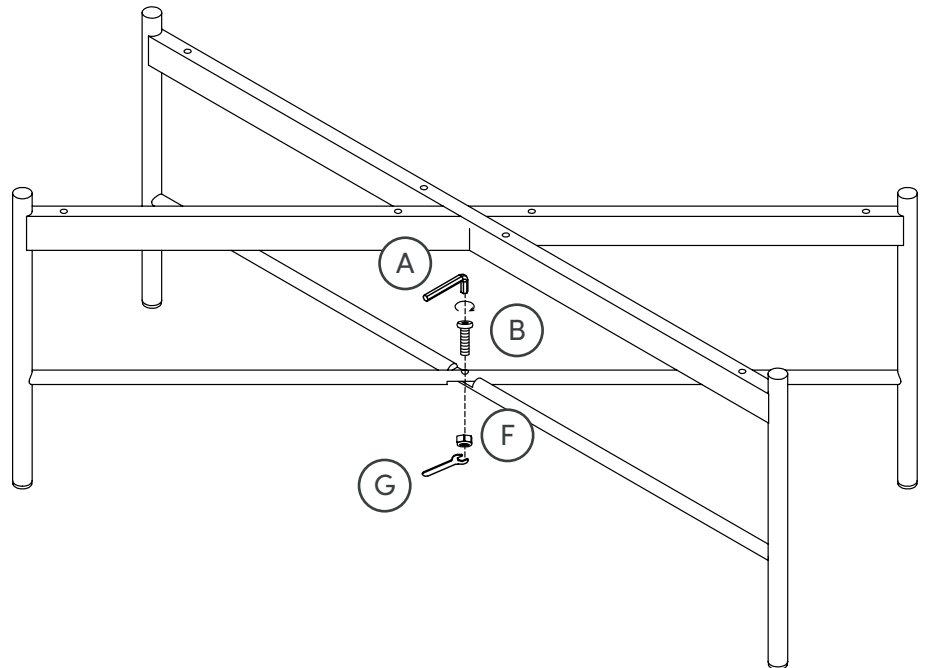

Step 3

You're already at step 3?! Wow, we're impressed.

Now it's time to attach the frame to the Bench Platform (3) using the M6*55mm Bolts (C). Don't forget to place a Flat Washer (E) down first, then a Spring Washer (D) before threading the Bolts.

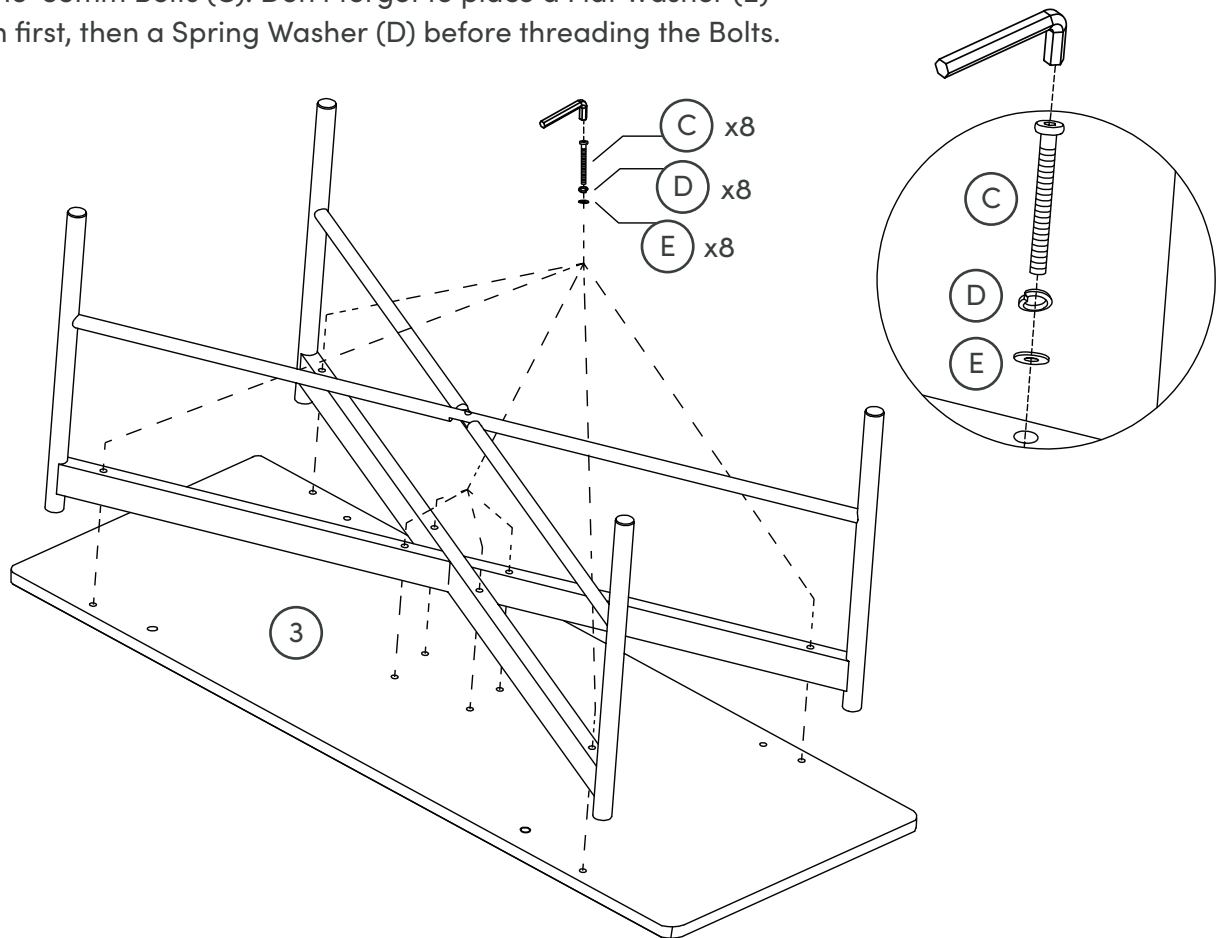

Step 4

We made this step super easy. Just place the Seat Cushion (4) on top of the Bench Platform (3).

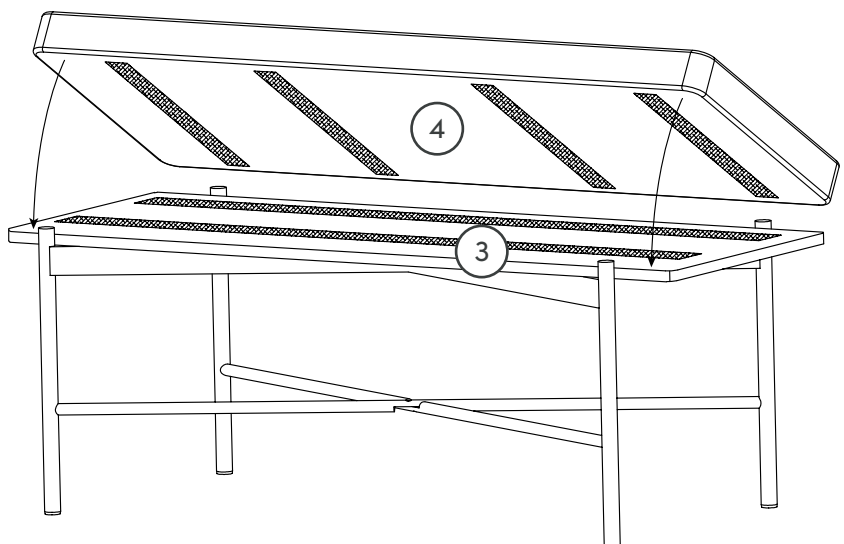

Step 5

And now for the final step! Install the Straps (5) by wrapping them over the Seat Cushion (4) and attach the straps with the bolt (H) on the underside of the Bench Platform (3).

To prevent a wobbly bench, tighten or loosen the footpads until level.

Now it's time to take a seat and relax, you're all done!

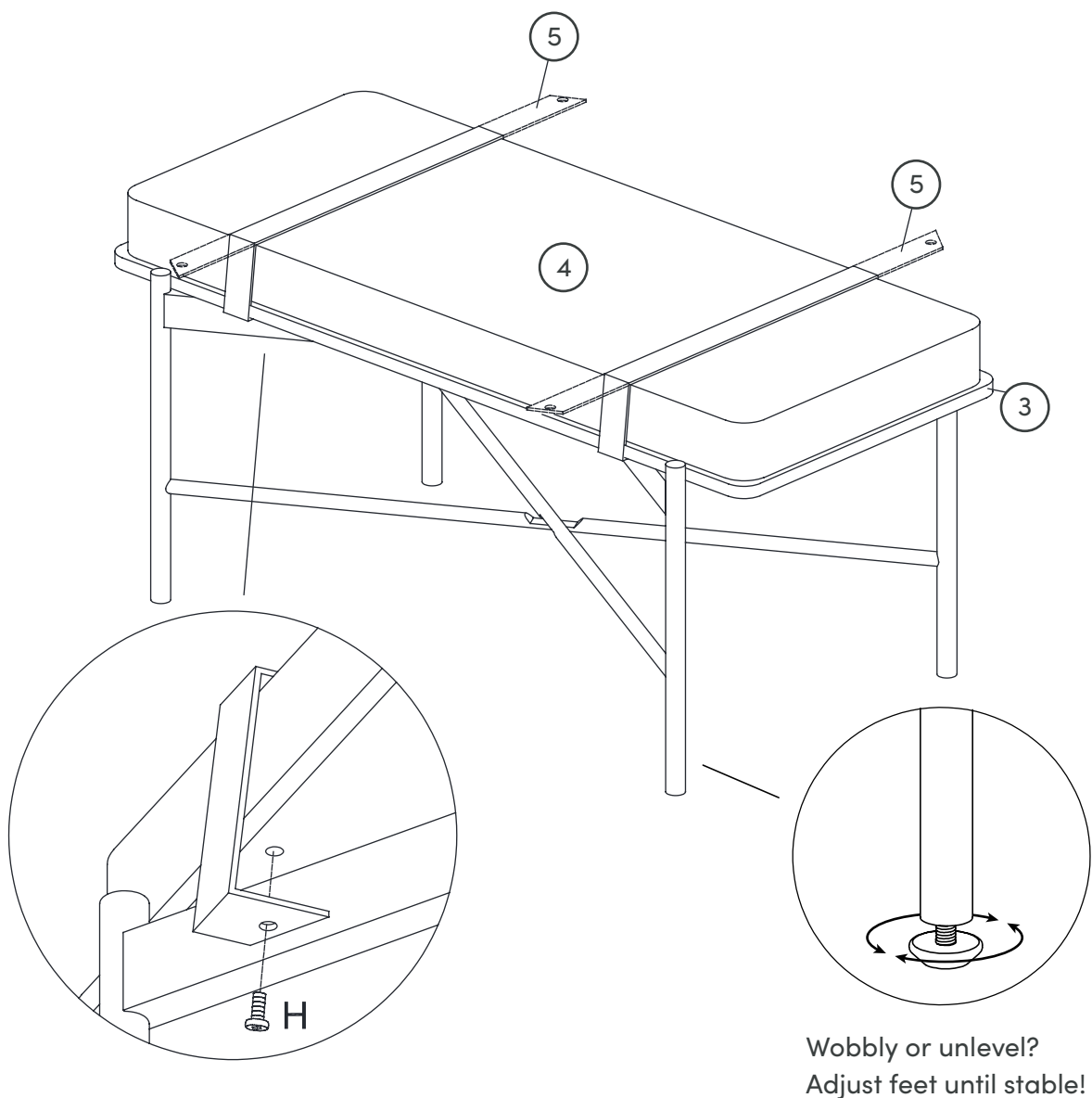

No heartburn, when we handle the return

Give us a call **1-866-619-1004** or shoot us a message
at **help@nathanjames.com** we will issue you a free
replacement with **zero hassle**.

Our way



Give us a call



Replacement



You

Their way



Re-package item



Schedule pick up



Track package



Replacement



You

We really don't want you to go through the hassle of re-packaging your item
and sending it back, because let's be honest...nobody has time for that.

Safety first, fun later

We want your product to last as long as possible, so we recommend that you tighten the screws 2 weeks after assembly and for added safety check the tightness of all screws every 2 months.

For proper care and treatment, please check our website at NathanJames.com/products

Safe use of this product starts with you.

Use this product responsibly with the primary concern for your safety. Follow assembly instructions carefully and inspect product upon receipt and each use.

Nathan James and its parent companies cannot be held legally responsible for any injuries or death resulted from failure to follow instructions or improper use of this product.

Do not modify the structure of this product in any way.

Our products have been tested to meet specific safety measures as they were originally intended to be sold. Any modifications will present the risk of creating significant safety issues which NJ will not be responsible for.

Proper use

DO NOT	use for commercial purposes
DO NOT	frolic on bench
DO NOT	use bench as foot stool
DO NOT	leave spilled liquid on seat
DO NOT	use bench if damaged
DO NOT	make temporary repairs
DO NOT	use outdoors

We are only in business if you're happy

For starters, thanks for being you.

☎ Toll-free at 1-866-619-1004

✉ Help@nathanjames.com

🌐 NathanJames.com/help

We do our best to ensure your furniture arrives without any problems, but occasionally mistakes happen—as humans we are imperfect beings. In the event that a part is damaged or missing, we will be more than happy to provide you with replacement part(s) for free.

Warranty

This product comes with a lifetime warranty from the date of purchase. Please use your phone to scan the QR code to register your product or visit <https://goo.gl/i9dk3q>

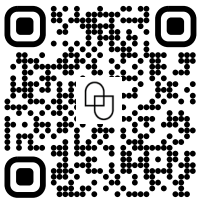

Did we do alright? Please spread the love!

If you are happy with your product, tell your friends and family about us or even better leave us a review online. Spreading the word gives us the opportunity to make more people happy and keep our prices low for your next purchase.

Brooklyn Burdon

Founder, Nathan James