

Let's build the

Kai Wall Light

SKU 15204

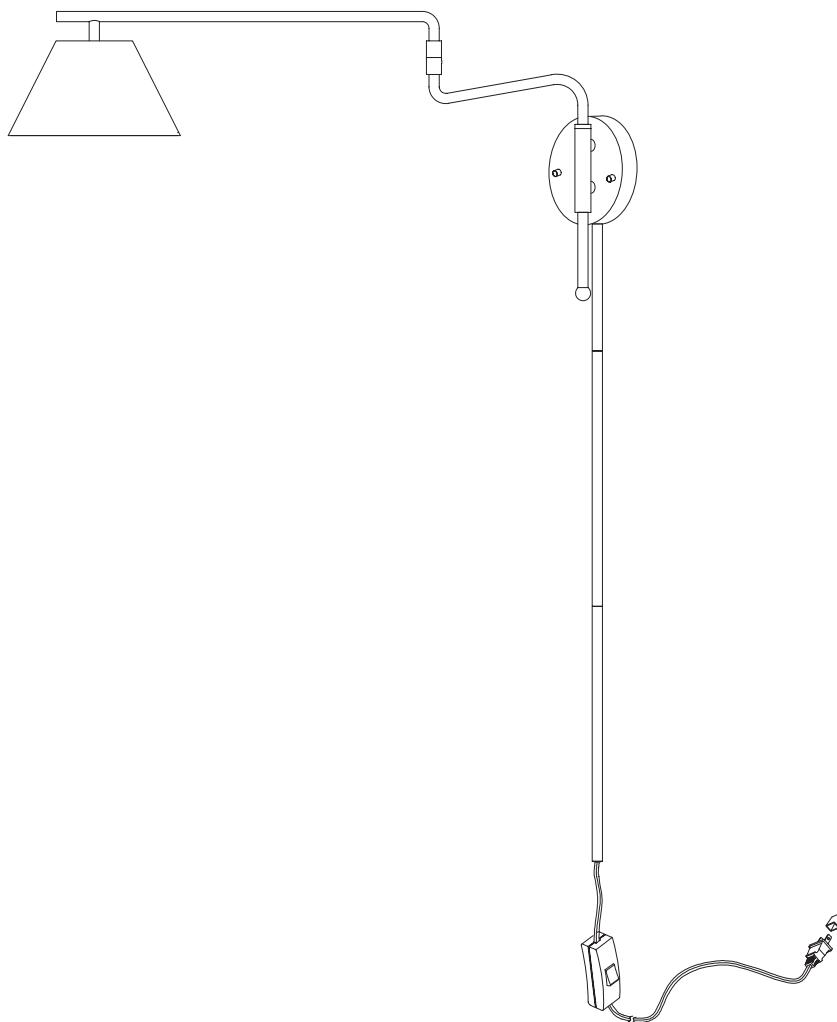

Scan me!

Free Lifetime
Warranty

nathan james

23-1127-CN

Ok, let's get rolling

This should be easy, just follow our instructions and you will be back to Netflix in no time.

Estimated time for assembly



35:00

What you need

- Your favorite snack or energy bar (Save the bubbly for once your fixture is safely installed!)
- Use the packaging carton as a working surface to prevent product damage during assembly
- Phillips head screwdriver
- Pencil
- Electric drill
- 1/4" Drill bit (for non-drywall)
- 5/16" Drill bit (for drywall)
- Mallet or hammer (for plug-in installation)
- Wire strippers
- Wire cutters

Toll-free at 1-866-619-1004
Help@nathanjames.com
Nathanjames.com/help

What's included

Description		Qty
1	Fixture	1
2	Shade	1
3	Stem (6")	1
4	Stem (12")	1
5	Stem (12")	1
6	Decorative Fixture Stem	1
A	Mounting Plate	1
B	Finial Nuts	2
C	M4*25MM Mounting Screws	2
D	Wire Connectors	1
E	M3.5*35MM Screws	3
F	Non-drywall Anchors	3
G	Mounting Unit	1
H	Drywall Anchors	3
I	Plastic Cap	1
J	Plastic Plug	1
K	M3.5*50mm Screws	3
L	M10*25MM Threaded Insert	2
M	Allen Key	1

Scan me!

Free Lifetime
Warranty



Safety first, fun later

Safe use of this product starts with you.

Use this light fixture responsibly with the primary concern for your safety. Follow assembly instructions carefully and inspect product upon receipt and each use.

Nathan James and its parent companies cannot be held legally responsible for any injuries or death resulted from failure to follow instructions or improper use of this product.

Do not modify the structure of this product in any way.

Our products have been tested to meet specific safety measures as they were originally intended to be sold. Any modifications will present the risk of creating significant safety issues which Nathan James will not be responsible for.

Proper use

- DO NOT** use for commercial purposes
- DO NOT** leave spilled liquid on fixture
- DO NOT** use light fixture if damaged
- DO NOT** make temporary repairs
- DO NOT** use outdoors



WARNING

Inspect the wire insulation for any cuts, abrasions, or exposed copper that may have occurred during shipping. If there is a defect in the wire, do not attempt installation. Please reach out to our Customer Happiness team at help@nathanjames.com or 1-866-619-1004



WARNING: RISK OF ELECTRIC SHOCK

Before starting the installation, disconnect the power by turning off the circuit breaker or by removing the appropriate fuse at the fuse box. Turning the power off at the switch is NOT SUFFICIENT to prevent electrical shock. PLEASE CONSULT A QUALIFIED ELECTRICIAN IF YOU HAVE ANY ELECTRICAL QUESTIONS.

The goods

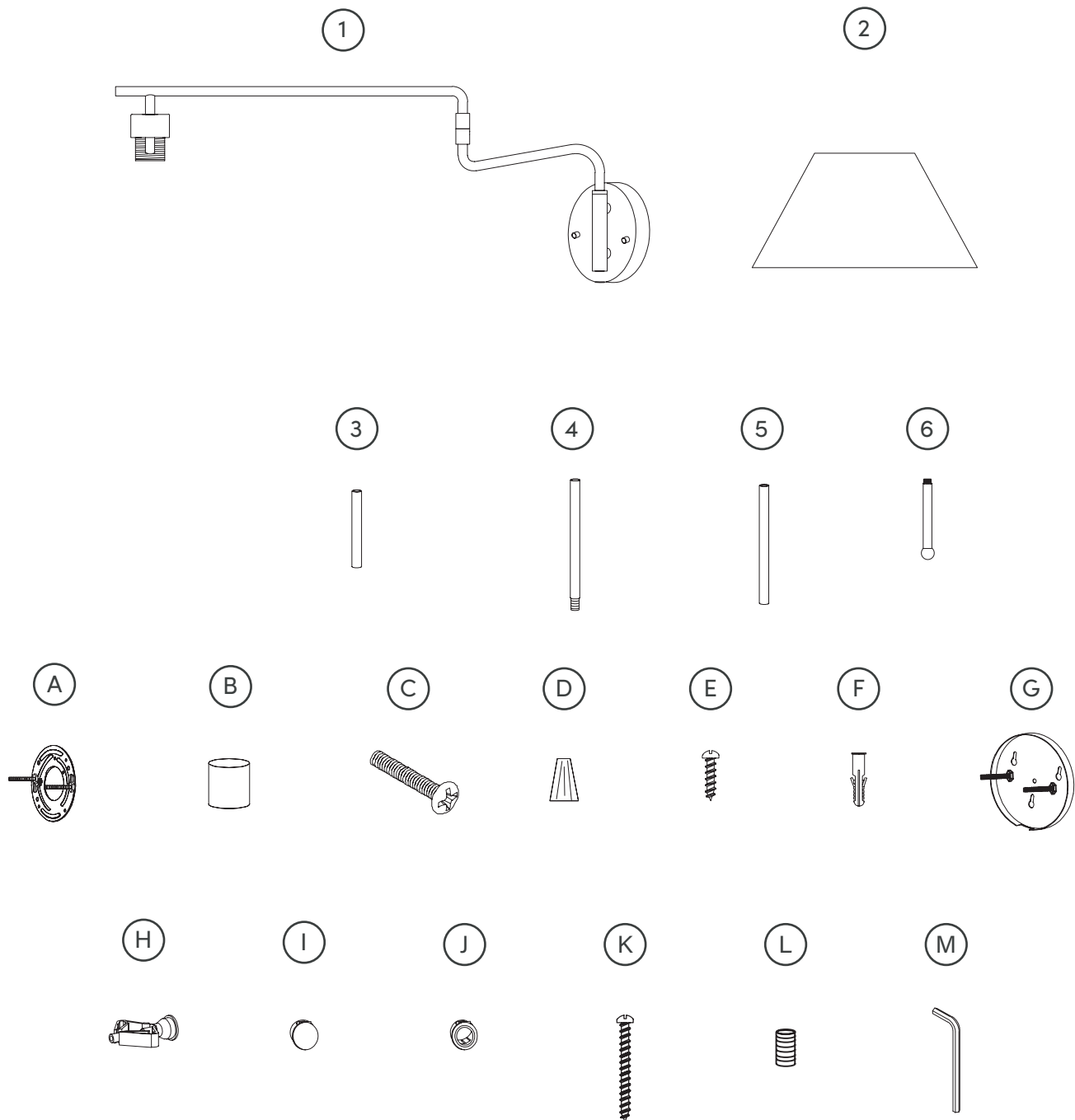

IMPORTANT

1. Do not tighten bolts / screws completely until all bolts / screws are lined up and inserted into holes.
2. Do not over tighten screws and bolts to avoid stripping.
3. Please use hand tools to assemble this product. Do not use power tools.

Pre-Installation

- Read all instructions prior to beginning assembly.
- To avoid damaging this product, assemble it on a soft, non-abrasive surface such as carpet or cardboard.
- Keep the receipt and these instructions for proof of purchase.
- Suggested Bulb: A19 LED 60 Watt Equivalent | E26 Medium Base | Dimmable
- Fixture Max Wattage: 60W

Plug-in option

The following steps 1–15 are intended for wall mounted plug-in use only. Skip ahead to page 15 for directions on how to hardwire this light into your existing electrical box.

Step 1

It's as easy as it looks!
Separate the Fixture (1) from the Mounting Unit (G) by removing the Finial Nuts (B).

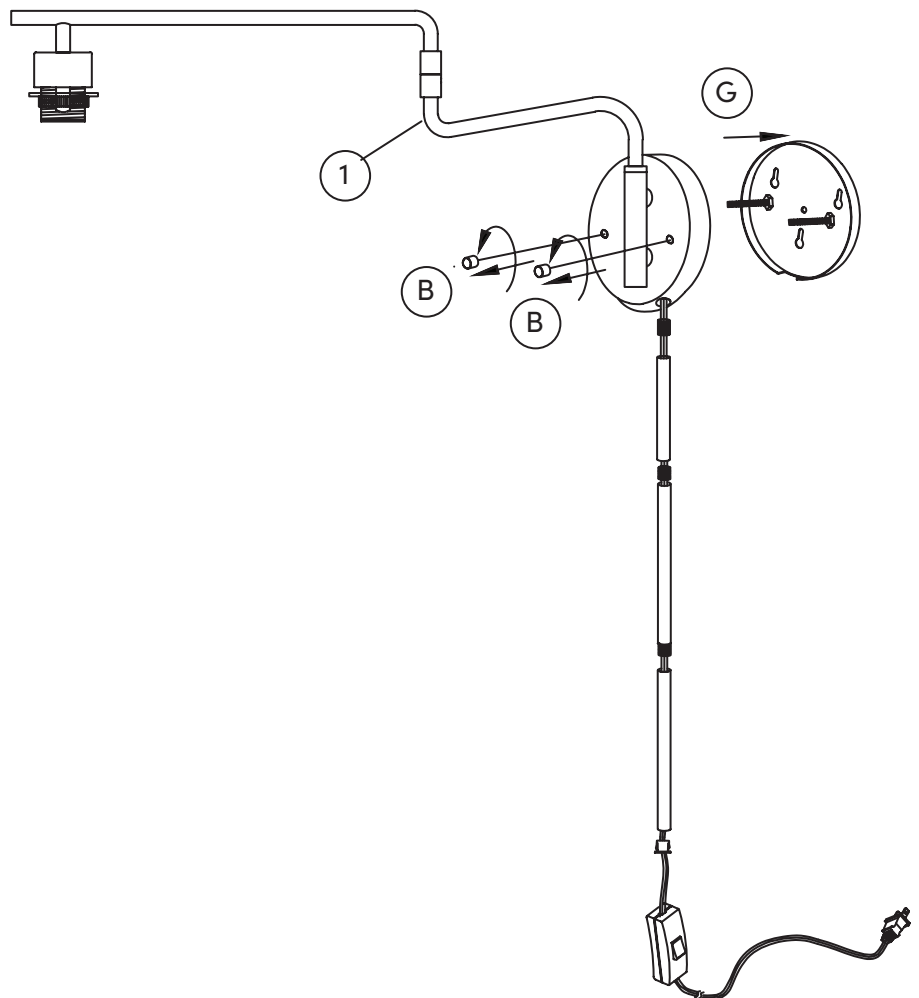

Step 2

You've successfully cleared the path by removing the mounting unit. Now, behold the wire compartment!

Carefully raise the flap on the wire connector to release the clear wire. Repeat this step on the second connect so that both clear wires have been removed and the black and white wires remain attached to the Fixture (1).

Once the wires have been disconnected, prepare yourself for the grand unraveling! Untie the knot that has kept the two clear wires intertwined.

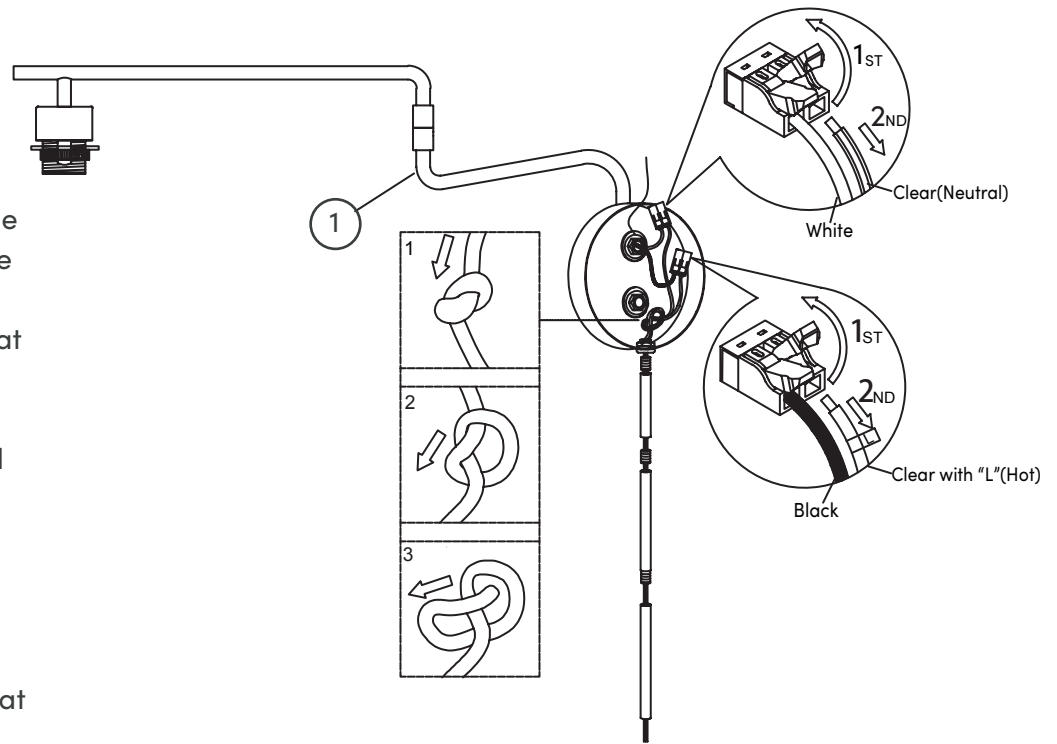

Step 3

Voila! With the knot untied, it's time for you to take charge. Carefully pull the cord through the bottom hole of the Fixture (1), giving it a gentle tug to guide it. Watch as it follows your lead, making its way out.

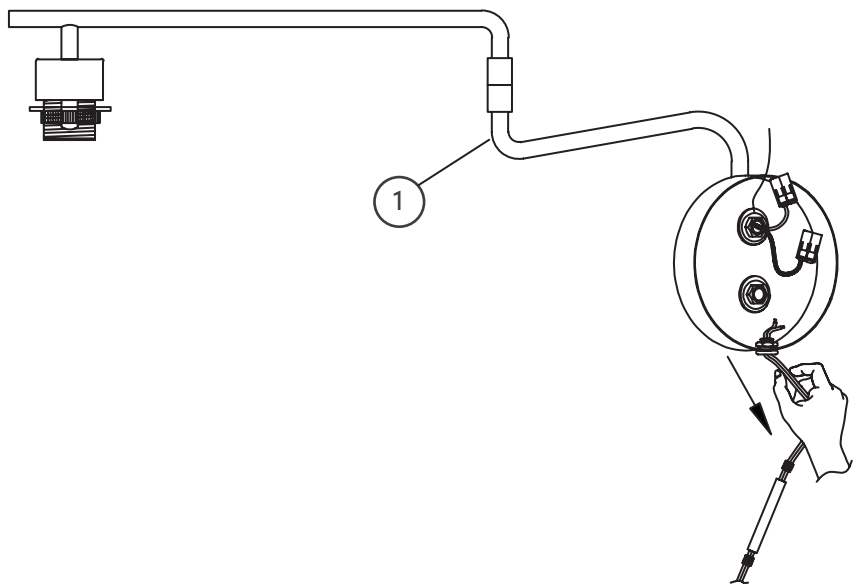

Step 4

Now comes the fun part: deciding how tall your fixture should be. You have the power to choose the perfect length by mixing and matching various Stem lengths or leaving some out completely.

Once you've settled on the ideal length, start by placing the Plastic Plug (J) onto cord. After that, twist on the Stems without connecting them just yet. Once you've got all the Stems in place, add the Thread Insert (L) to the end of the tubes.

6" cord: (L) (3) (J)

12" cord: (L) (5) (J)

18" cord: (L) (3) (L) (5) (J)

24" cord: (L) (4) (5) (J)

30" cord: (L) (3) (L) (4) (5) (J)

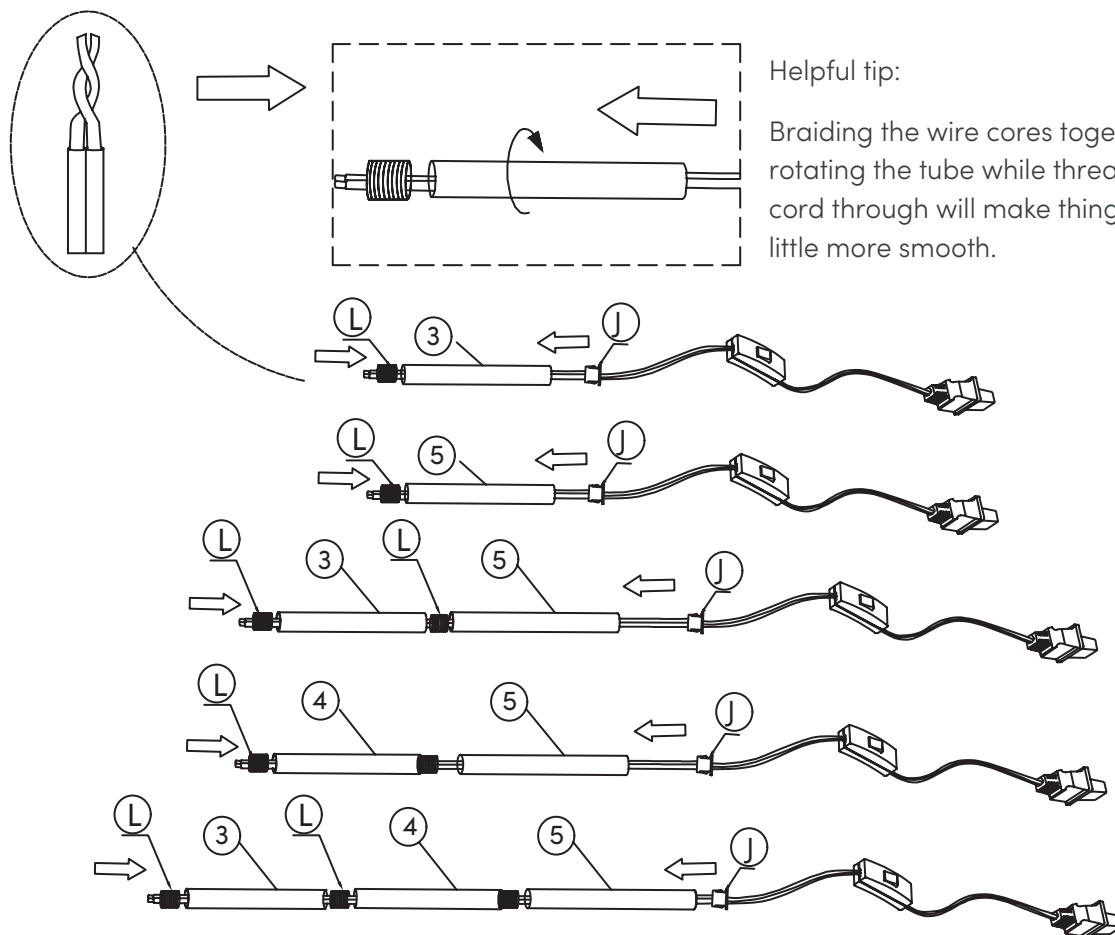
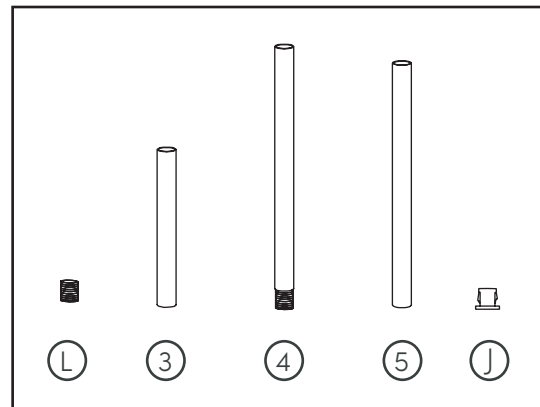

Helpful tip:

Braiding the wire cores together and rotating the tube while threading the cord through will make things go a little more smooth.

Step 5

Take the wires and guide them back through the hole at the bottom of the Fixture (1) - it's like threading a needle.

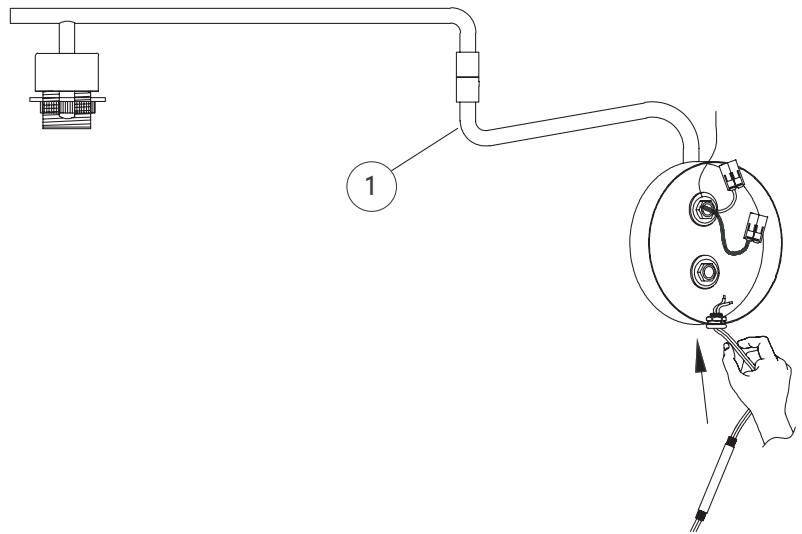

Step 6

Time to tie a knot and secure those wires like a pro! Inside the electrical compartment create a knot that will hold the wires securely in place.

Leave about 70 mm of wire from the knot to the end. This clever maneuver ensures you'll have enough space to reconnect the wires to their initial spot under the flaps.

It's all about keeping things organized and making sure your wires feel right at home!

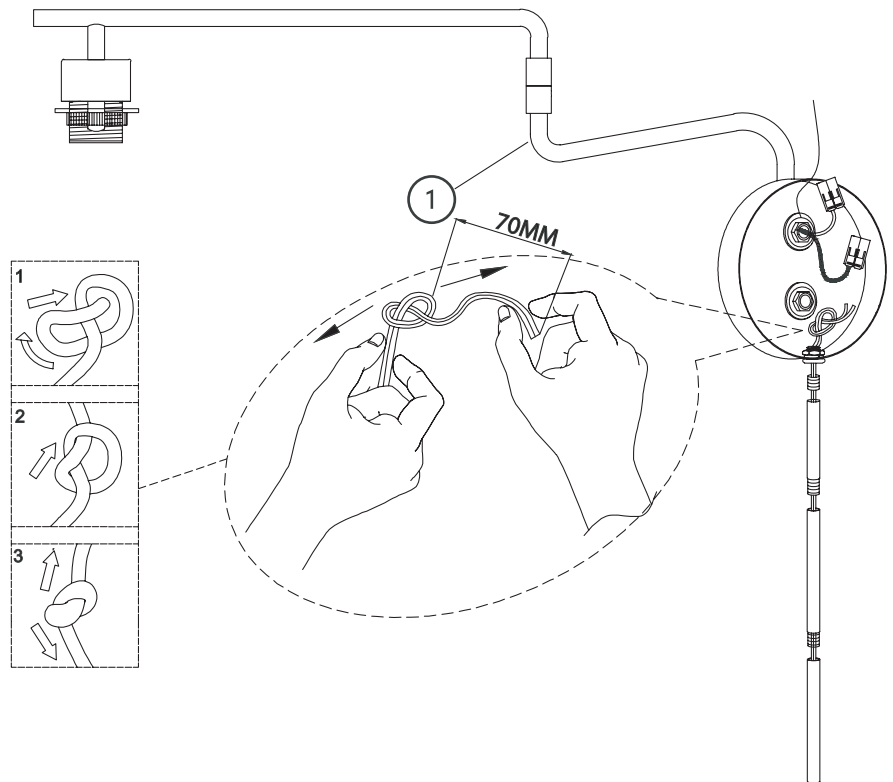

Step 7

To proceed, open the flaps once again. Insert the clear neutral wire alongside the white wire. Place the hot wire (marked with an L) next to the black wire.

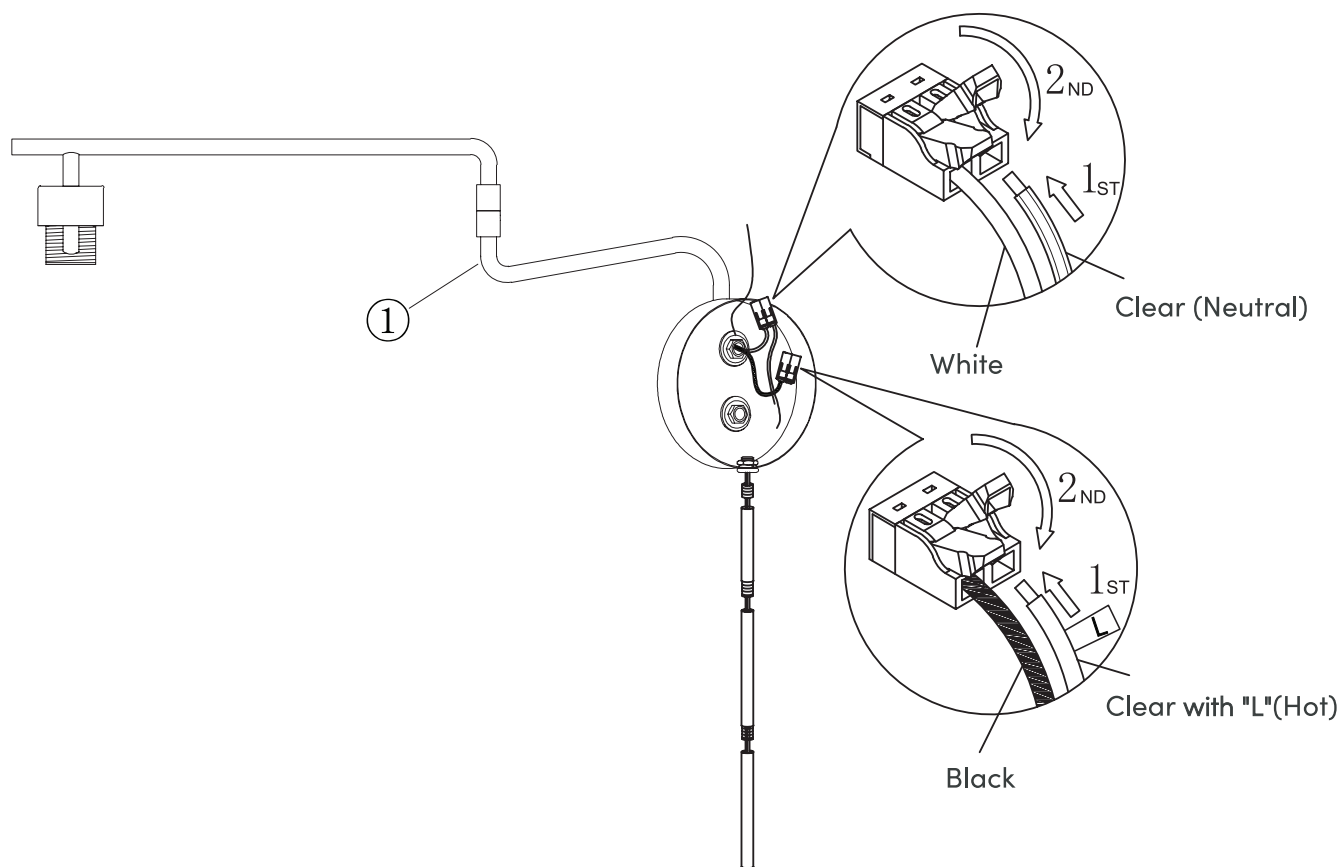

Step 8

Position the Decorative Fixture Stem (6) under the front of the Fixture (1) so that they align properly.

Rotate the Decorative Fixture Stem (6) in a counter-clockwise direction to secure it to the Fixture (1).

Next, attach the M10*25mm Thread Insert (L) to the first Stem over the cord. Turn it in a counter-clockwise direction until it is securely fastened.

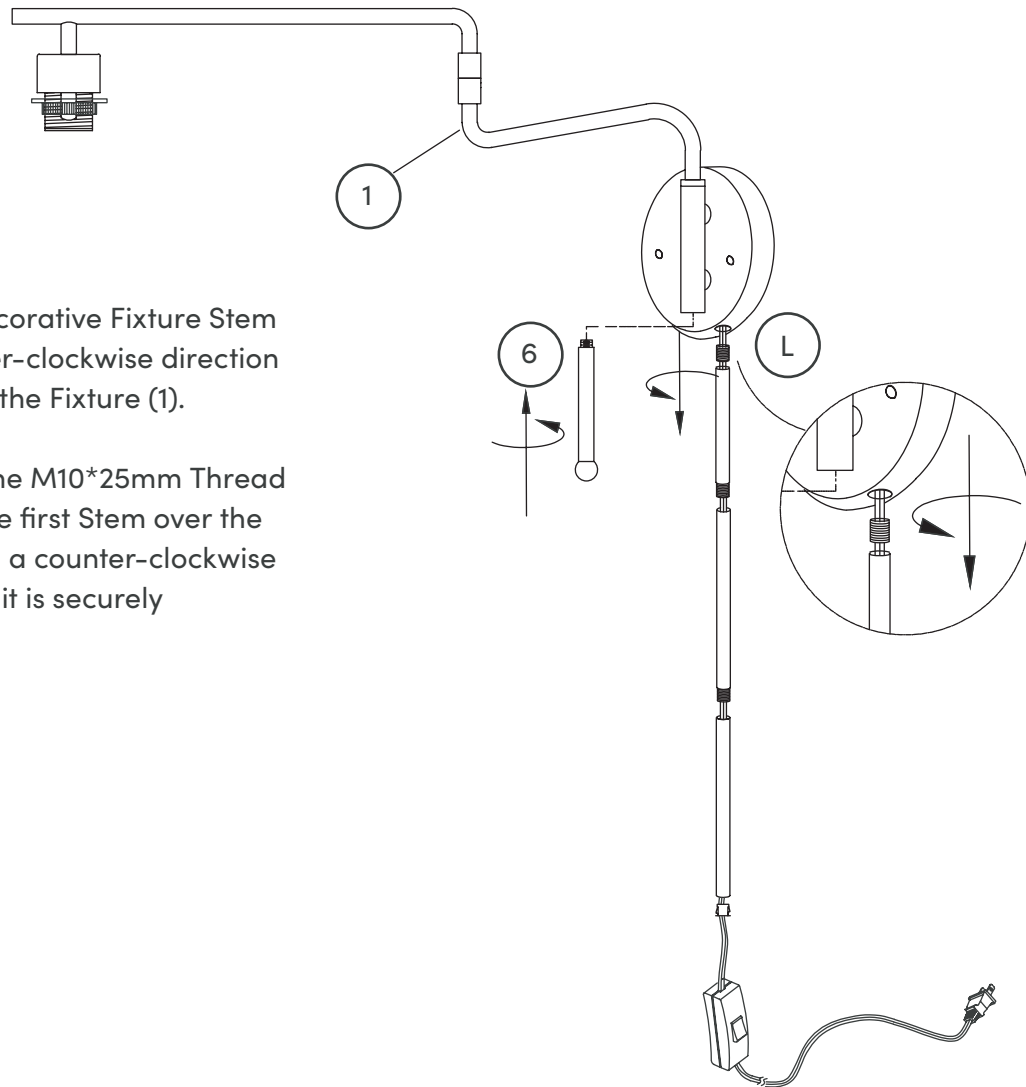

Step 9

Now, it's time to bring all the Stems together in perfect harmony! Let's start from the top.

Hold onto the first tube that's already connected and get ready to attach the second one. Carefully rotate the second Stem counterclockwise onto the first one, just like fitting puzzle pieces together.

Repeat this process for the rest of the tubes, linking them in the same way.

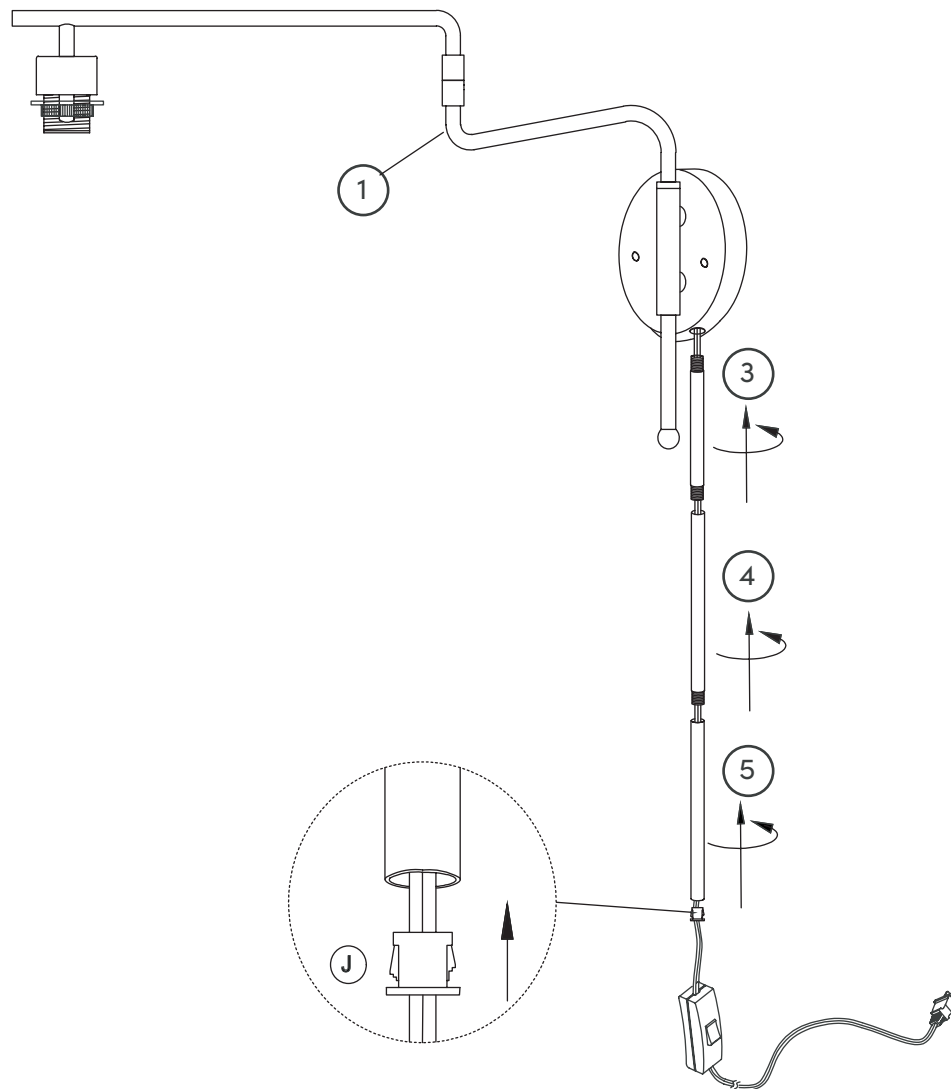

Step 10

With Mounting Unit (G) as a guide, use a level and pencil to mark within the keyholes where you want it on the wall.

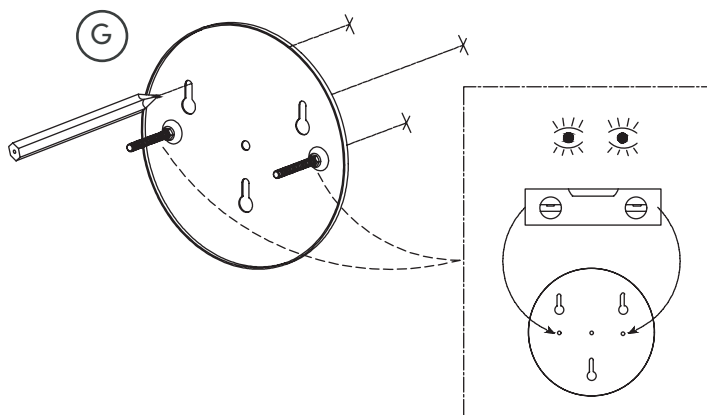

Step 11

Using a drill, the proper drill bit, and the reference marks from the previous step, drill 3 holes into the wall.

Important note:

Non-drywall = 1/4" Drill bit

Drywall = 5/16" Drill bit

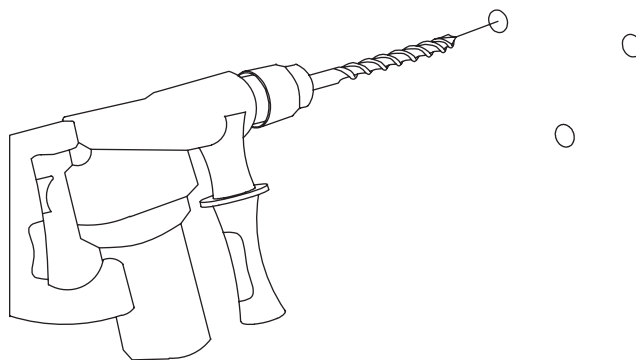

Step 12

Tap the Wall Anchors (F) or (H) into place in the new holes you just drilled.

You may be able to push them into place with your thumb.

Important note:

Non-drywall = F

Drywall = H

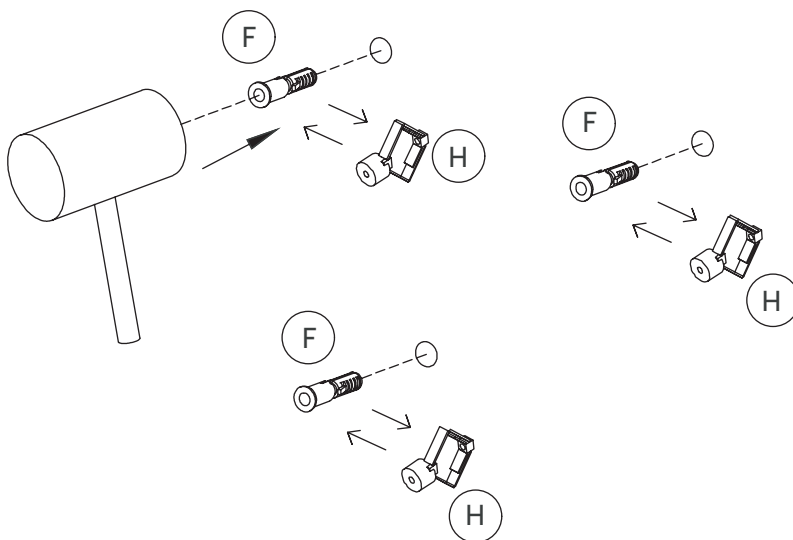

Step 13

To attach the Mounting Unit (G) to the wall, you can use either the K or E Screws, depending on the type of wall.

Important note:

E for Non-drywall anchors

K for Drywall anchors

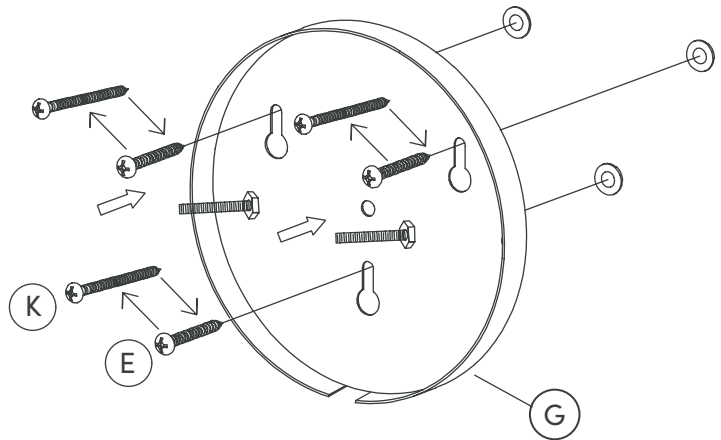

Step 14

Attach Fixture (1) to Mounting Unit (G). Align the holes on the fixture with the exposed screws. Tighten them securely using the Final Nuts (B). Turn the Final Nuts (B) in a counter-clockwise direction.

Unscrew the collar fitting from the Fixture (1) by turning it clockwise until it comes off.

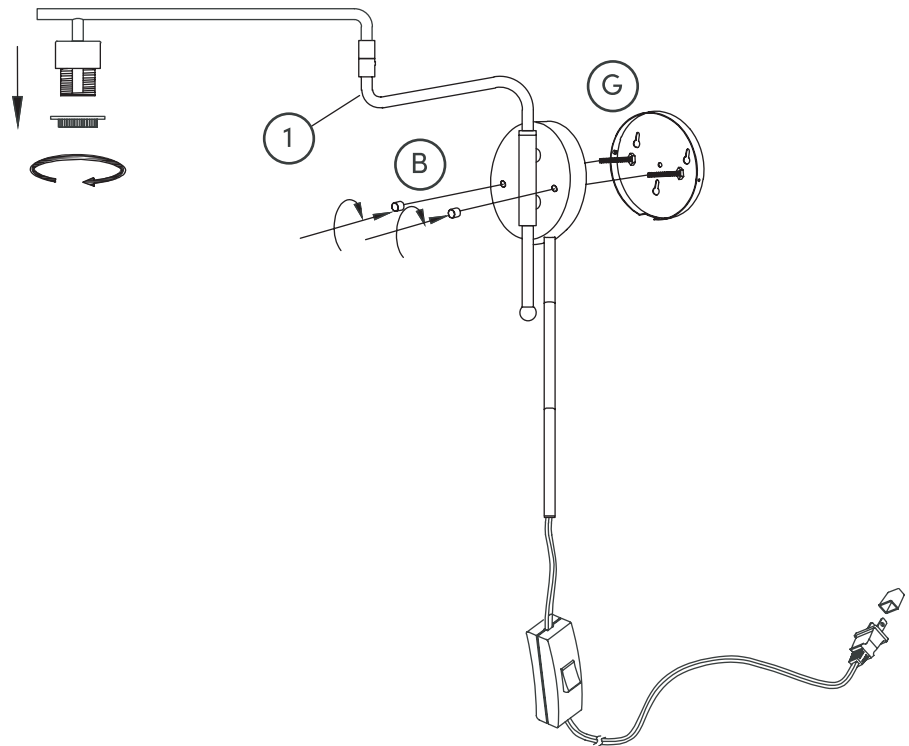

Step 15

Install the Shade (2) by setting it in place with the shade collar fitting that you removed in step 14.

Thread the collar fitting back onto the socket with the shade sandwiched between the collar fitting and socket.

Next, screw in your light bulb. We recommend using one Type A19 light bulb. 120V 60Hz AC only.

Finally, set the Fixture (1) to the desired orientation by adjusting each component with the Allen Key (M) at the set swivel points.

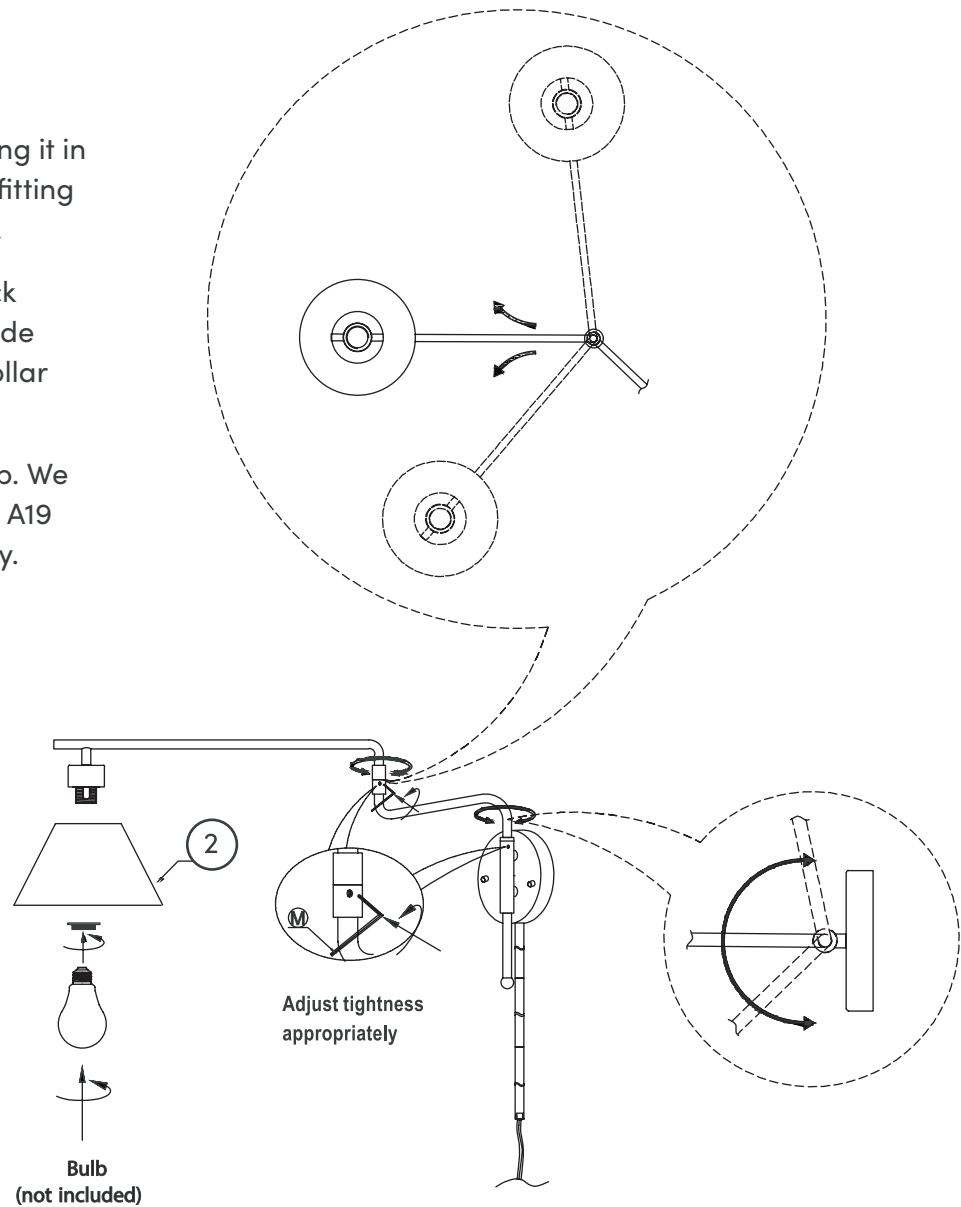

Troubleshooting

Problem	Possible Causes	Solutions
The bulb will not light.	The bulb is burned out.	Replace the light bulb.
	The power is off.	Ensure the power supply is on.
	The circuit breaker is off.	Ensure the circuit breaker is in the ON position.
The fuse blows or circuit breaker blows when the light is turned on.	There is an exposed wire.	Discontinue use of the light. Contact a qualified electrician or reach out to our Customer Happiness team at help@nathanjames.com or 1-866-619-1004.

Hardwired option

The following steps 1–8 are intended for hardwire mounting to your existing electrical box. Skip back to page 5 for directions on how to mount this light on your wall as a plug-in light.

Step 1

Let's get this thing fired up! Or should we say, lit? Separate the Fixture (1) from the Mounting Unit (G) by removing the Finial Nuts (B).

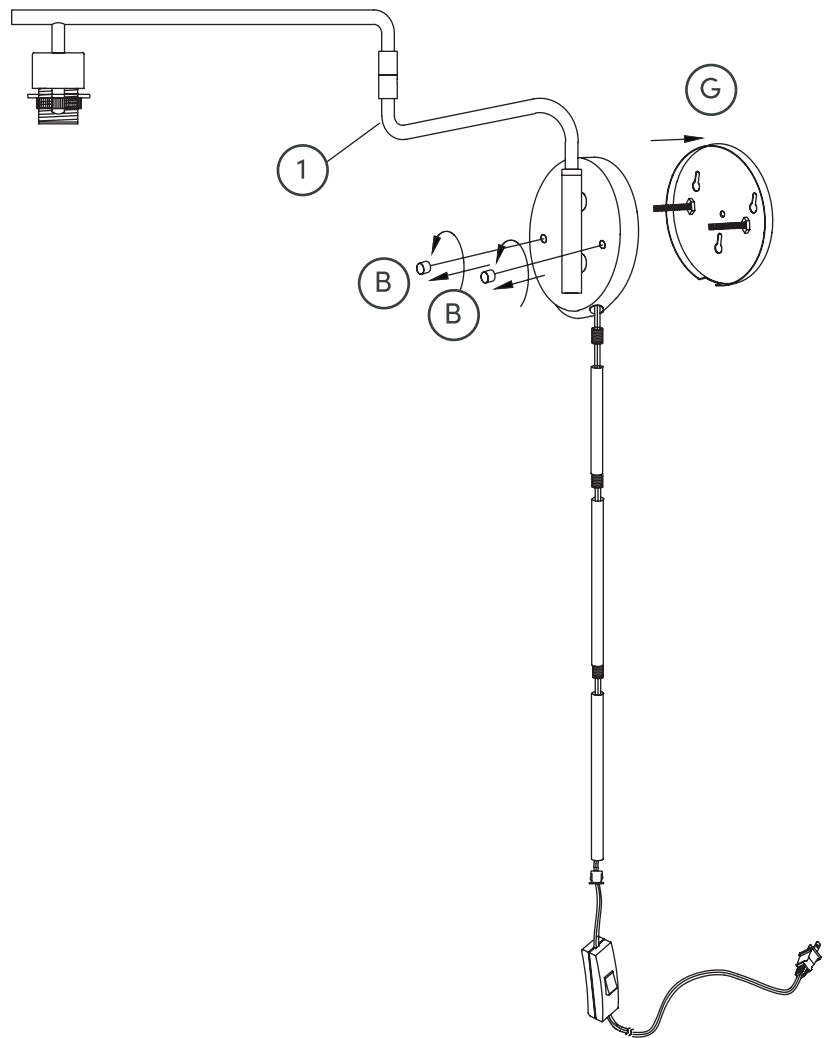

Step 2

Carefully raise the flap on the wire connector to release the clear wire. Repeat this step on the second connect so that both clear wires have been removed and the black and white wires remain attached to the Fixture (1).

Once the wires have been disconnected, prepare yourself for the grand unraveling! Untie the knot that has kept the two clear wires intertwined.

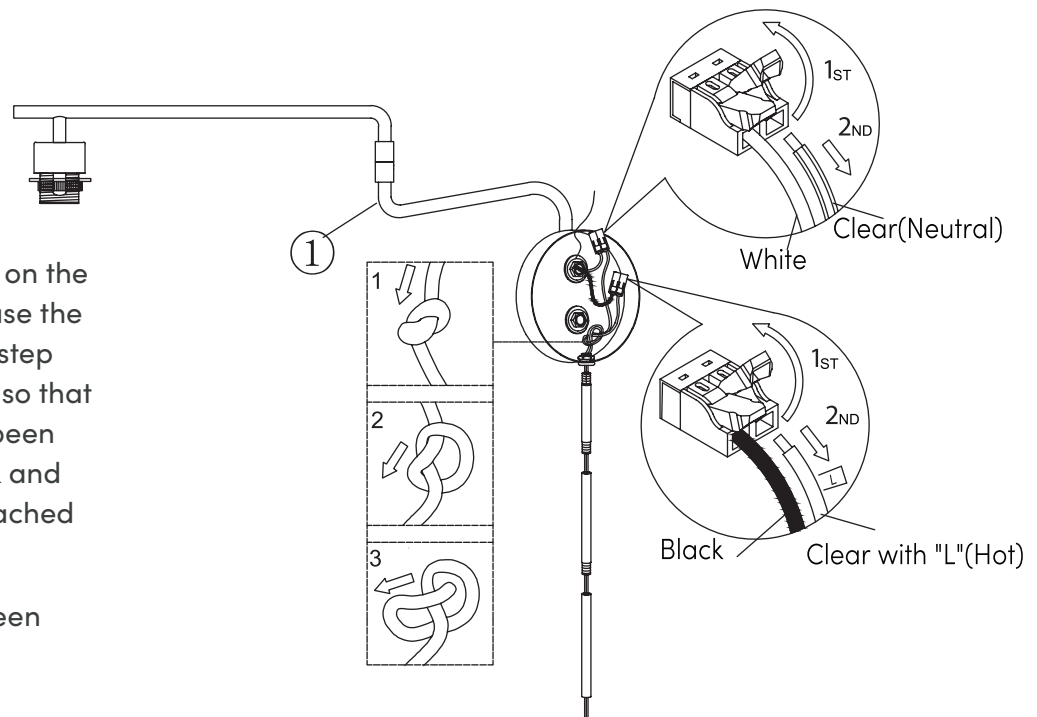

Step 3

Voila! With the knot untied, carefully pull the cord through the bottom hole of the Fixture (1), giving it a gentle tug to guide it.

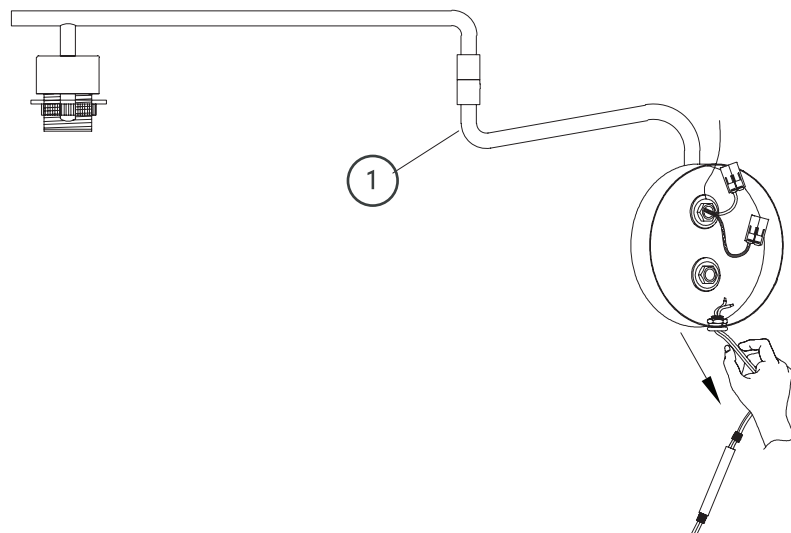

Step 4

Insert the Plastic Cap (1) into the bottom of the Fixture to cap off the hole. Twist on the Decorative Fixture Stem (6) to the bottom of the Fixture.

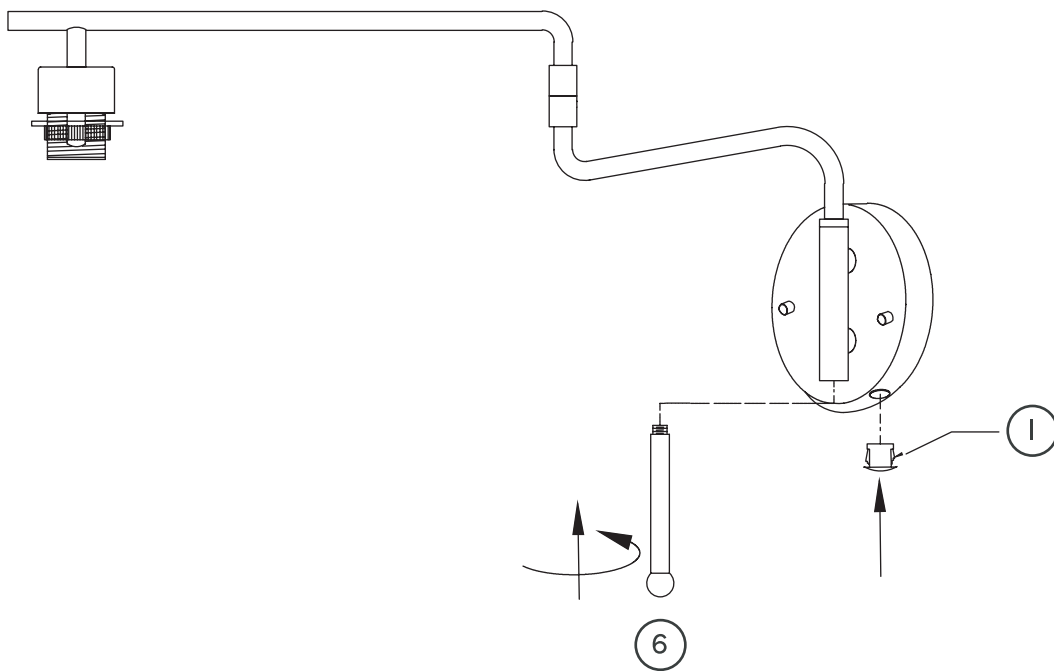

Step 5

Mount the Mounting Plate (A)
to the electrical box using the
Mounting Screws M4*25mm (C).

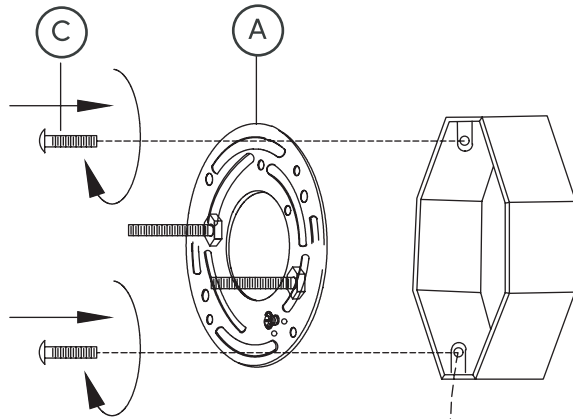

Note: Be sure that you are only making the connections to a 120V 60Hz AC circuit. If you do not have a pre-existing electrical box, we strongly advise using a certified electrician.

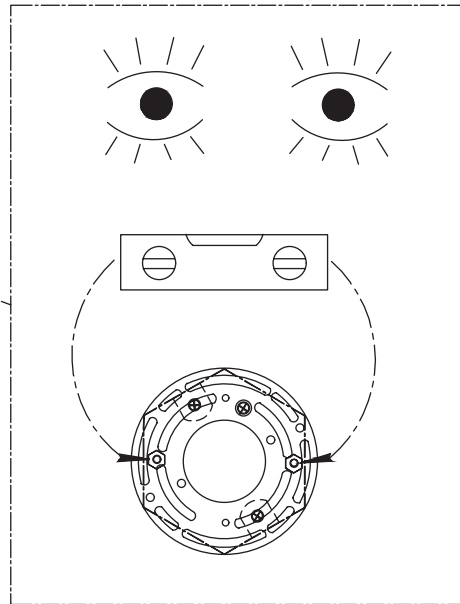

Step 6

First, wrap the ground wire from the Fixture (1) around the grounding screw on the Mounting Plate (A) and then secure it in place by tightening the grounding screw.

Next, use the Wire Nut (D) to join the ground wires from the Fixture (1) and from the electrical box.

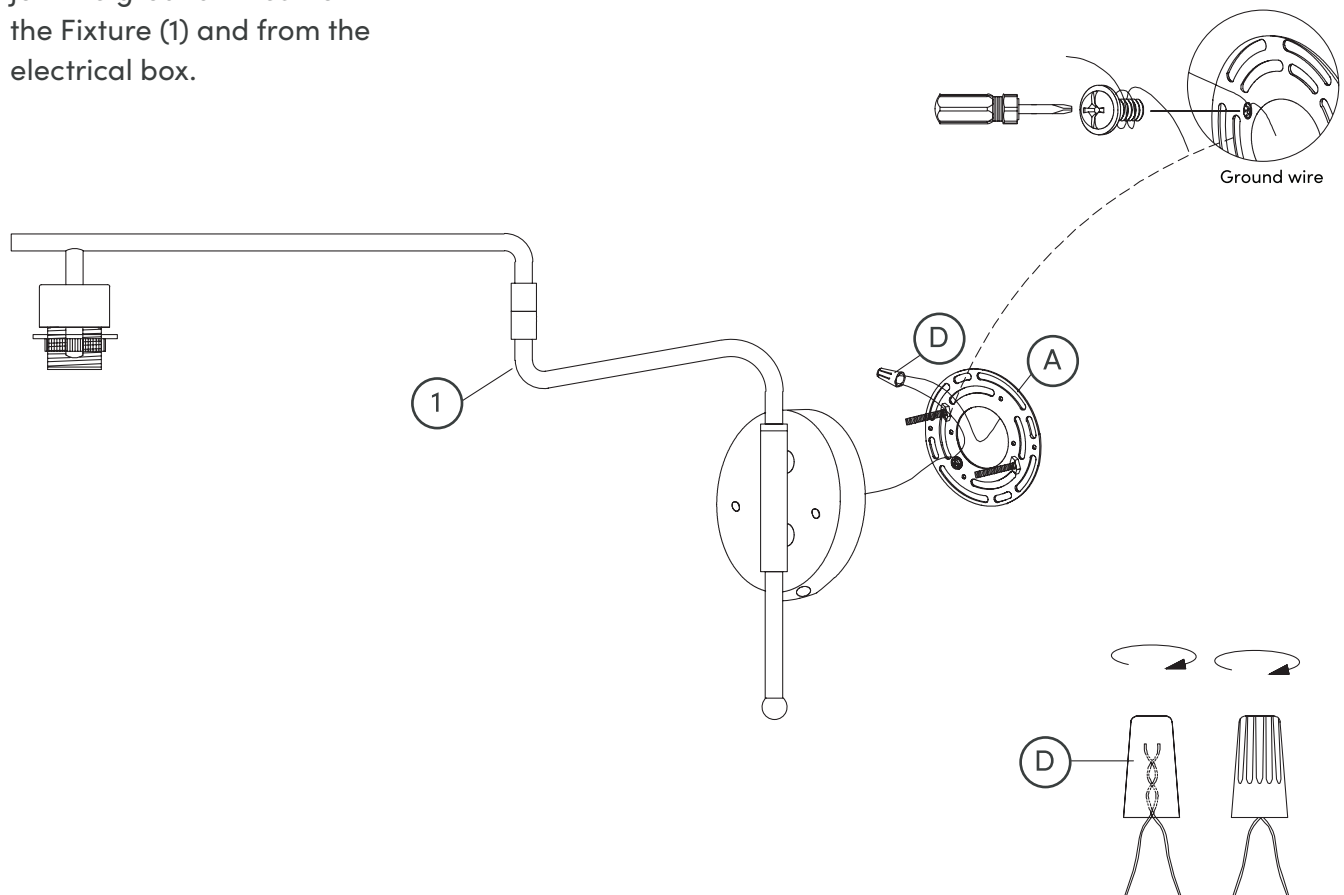

Step 7

Feed the designated wires into their respective wire connectors, as shown below. Attach Fixture (1) to the Mounting Unit (A). Align the holes on the Fixture with the exposed screws. Tighten them securely using the Finial Nuts (B). Turn the Finial Nuts (B) in a counter-clockwise direction. Unscrew the collar fitting from the Fixture (1) by turning it clockwise until it comes off.

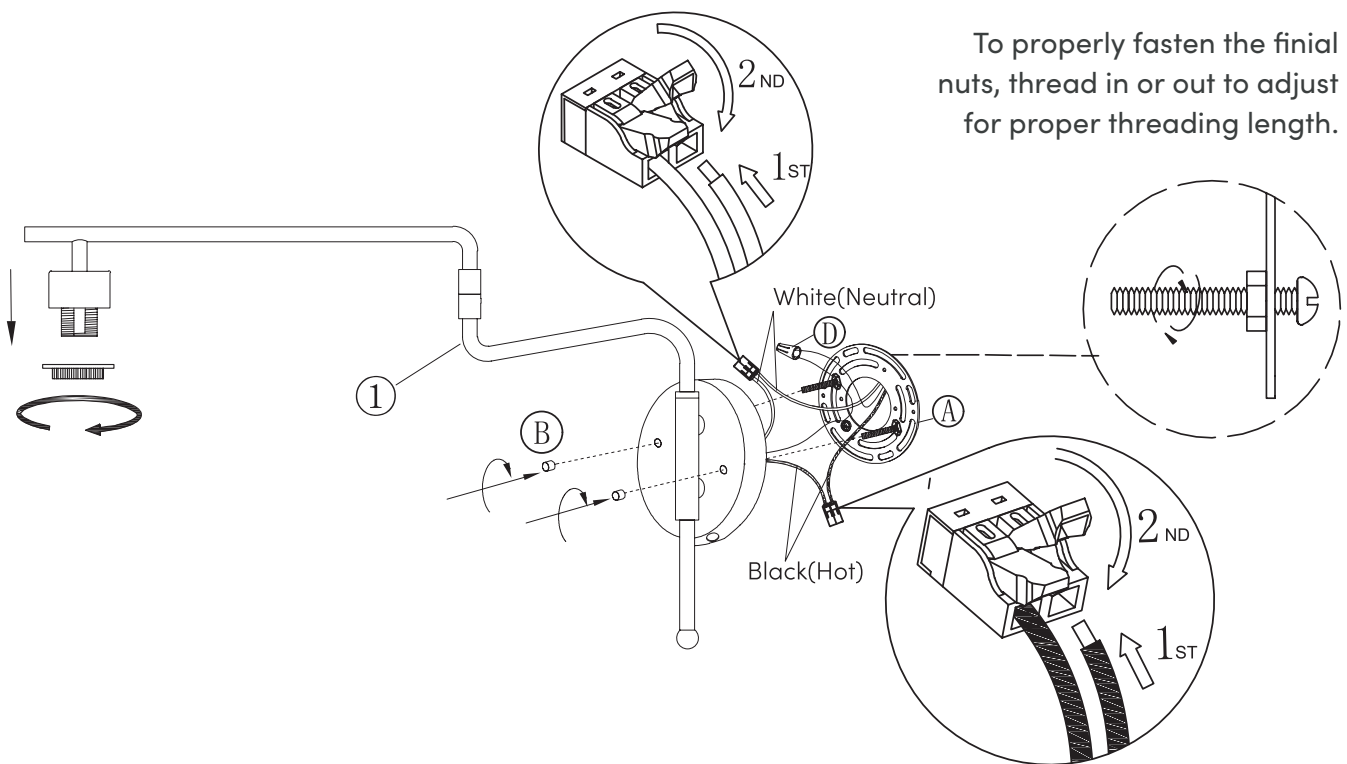

Step 8

Install the Shade (2) by setting it in place with the shade collar fitting.

Thread the collar fitting back onto the socket with the shade sandwiched between the collar fitting and socket.

Next, screw in your light bulb. We recommend using one Type A19 light bulb. 120V 60Hz AC only.

Finally, set the Fixture (1) to the desired orientation by adjusting each component with the Allen Key (M) at the set swivel points.

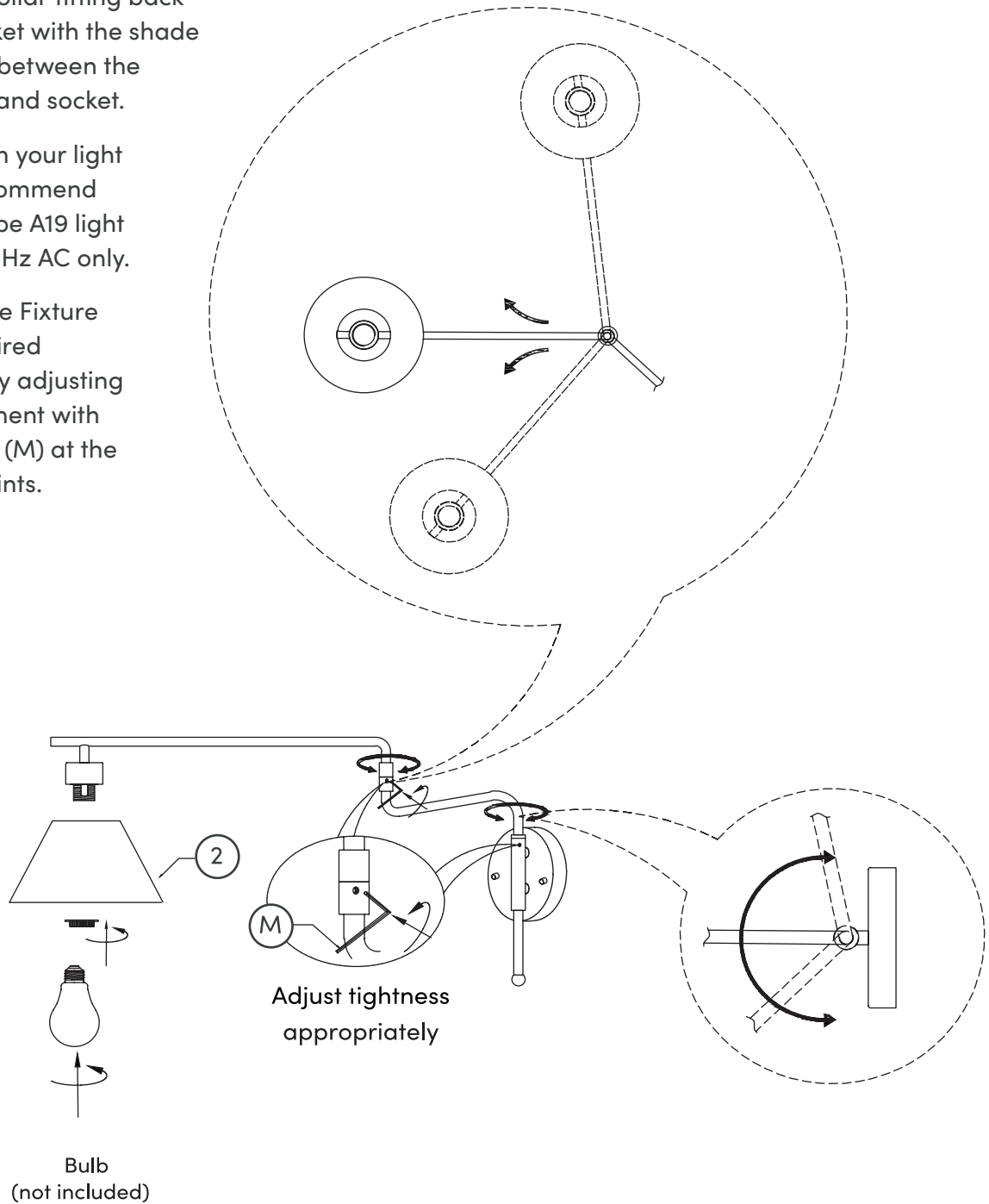

Questions? Don't worry, we've got the answers

What other light bulbs can fit in this light?

The bulb must not be greater than the max wattage for the fixture. It must match the base size, and the diameter of any area of the bulb should be less than diameter of any area of shade, so that it can fit.

Can I use an LED light bulb?

Yes, so long that the base size matches and the diameter of any area of bulb is less than diameter of any area of shade, so that it can fit.

Is this UL/ETL certified?

Yes, all our products are either UL or ETL.

Do I need an electrician to set up the hardwire?

We recommend using a certified electrician for all hardwiring, although all of our fixtures can be set up without an electrician, as long as you are replacing an existing fixture or have an existing junction box ready for a fixture installation. ENSURE POWER IS OFF WHEN INSTALLING. For all new constructions, please use a certified electrician.

Can I retrofit this hard-wired to a plug-in or vice-versa?

Yes, a plug-in fixture can be turned into a hardwire fixture and a hardwire fixture can become a plug-in fixture. For many products we will provide all the necessary hardware to make these changes, if not, you will need to purchase the necessary hardware.

Is this light compatible outside North America?

Our lighting is only warranted in Canada and the United States.

What do I do if the product is not working?

Try a different light bulb and confirm proper installation.

Can these lights work on a dimmer?

Dimmability is related to the light bulb and the wall switch, not the light fixture. All our hardwire fixtures are compatible with dimmable light bulbs. We recommend using a dimmer switch, as it extends the life of the bulb and allows for energy saving and great ambiance. If using a LED bulb, please ensure both your LED bulb and dimmer switch are compatible.

Can I use the fixture outdoors?

No, this product was not designed to be used outdoors.

No heartburn, when we handle the return

Give us a call **1-866-619-1004** or shoot us a message at **help@nathanjames.com** we will issue you a free replacement with **zero hassle**.

Our way



Give us a call



Replacement



You

Their way



Re-package item



Schedule pick up



Track package



Replacement



You

We really don't want you to go through the hassle of re-packaging your item and sending it back, because let's be honest...nobody has time for that.

We are only in business if you're happy

For starters, thanks for being you.

☎ Toll-free at 1-866-619-1004

✉ Help@nathanjames.com

🌐 NathanJames.com/help

We do our best to ensure your product arrives without any problems, but occasionally mistakes happen—as humans we are imperfect beings. In the event that a part is damaged or missing, we will be more than happy to provide you with replacement part(s) for free.

Warranty

This product comes with a lifetime warranty from the date of purchase. Please use your phone to scan the QR code to register your product or visit <https://goo.gl/i9dk3q>

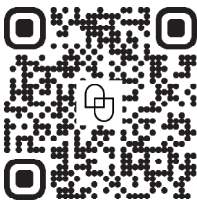

Did we do alright? Please spread the love!

If you are happy with your product, tell your friends and family about us or even better leave us a review online. Spreading the word gives us the opportunity to make more people happy and keep our prices low for your next purchase.

Brooklyn Burdon

Founder, Nathan James